

SEZIONI TIPOLOGICHE IMPIANTO DI ILLUMINAZIONE ESTERNA. Includes tables for SEZIONE MAD1 - SINGOLO C4 40m - CARREGGIATA 5m and SEZIONE MAD1 - SINGOLO C2 20m - CARREGGIATA 5m.

LEGENDA SIMBOLI. Legend for symbols used in the lighting plan, including various lighting fixture types and their specific characteristics.

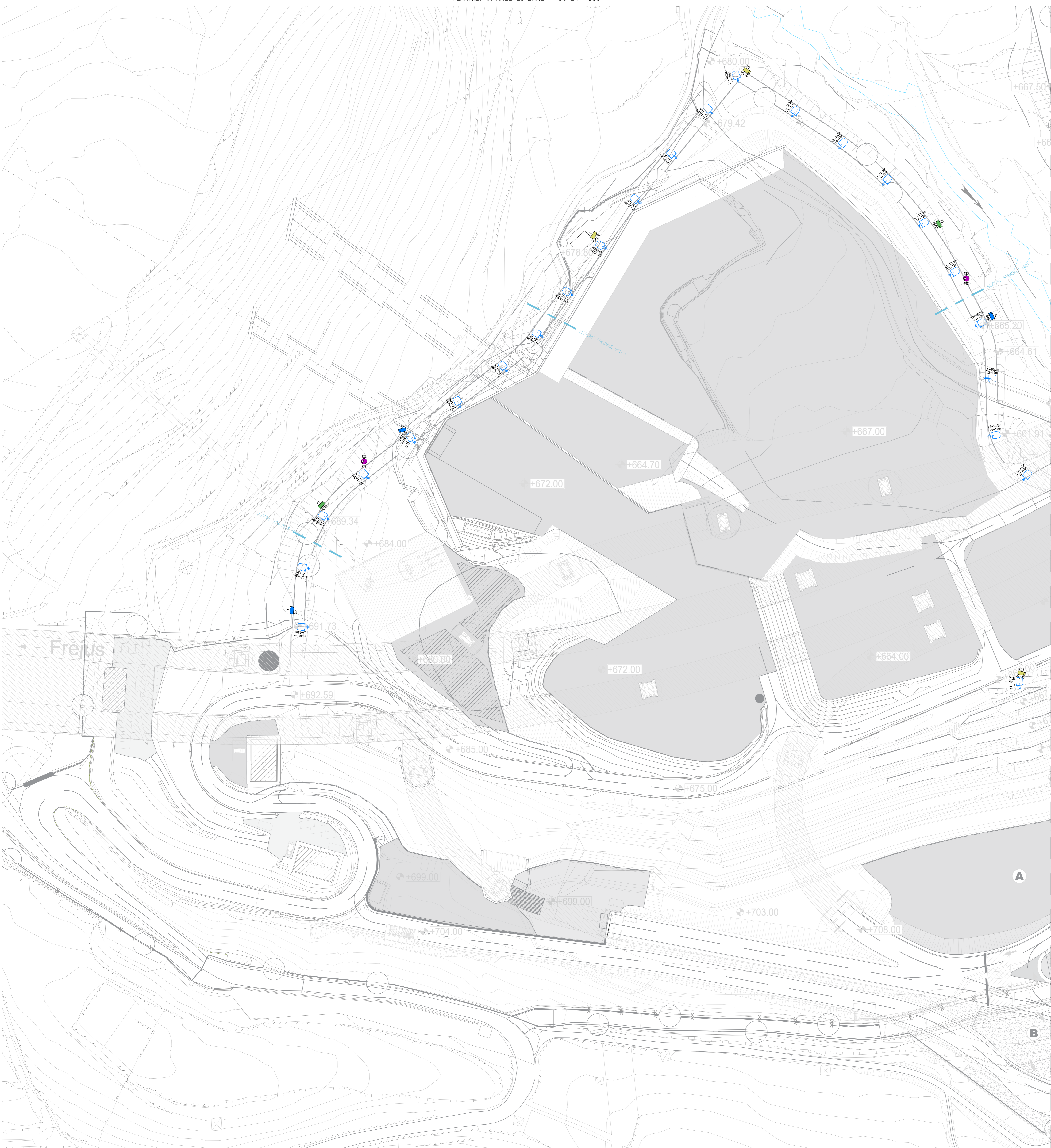

ZONE ILLUMINOTECNICHE SECONDO UNI 11248 e UNI 13201-2. Table detailing technical lighting zones with columns for reference, speed, luminance, and illuminance.

NOTA BENE: IN ACCORDO CON LA COMMISSIONE LE ZONE ILLUMINOTECNICHE SONO STATE CLASSIFICATE COME SEGUI:

- ELABORATI DI RIFERIMENTO. List of technical drawings and reports used as references, including plans, sections, and reports on lighting design.

LEGENDA SIMBOLI. Legend for symbols used in the key map, including different types of telecameras and their locations.

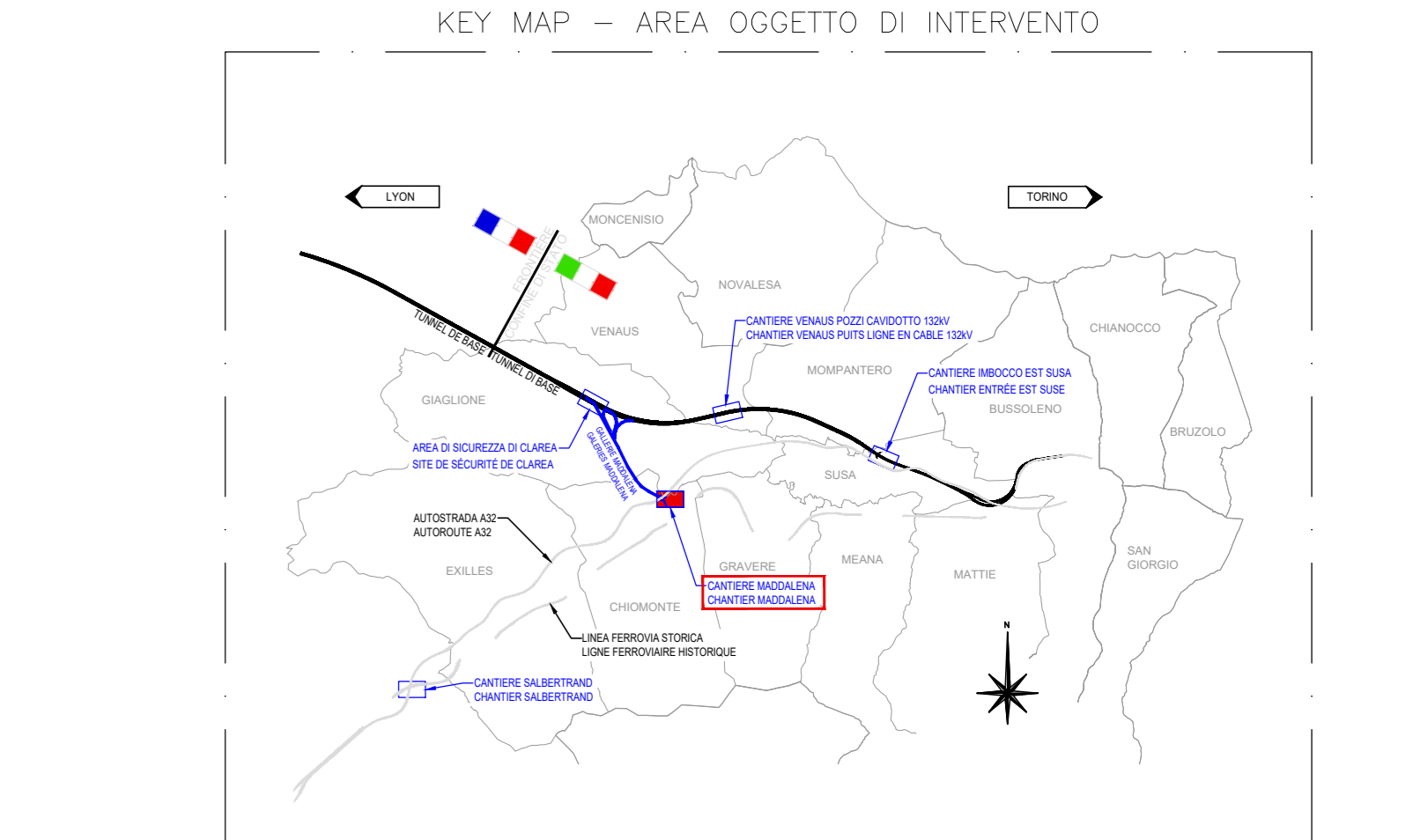
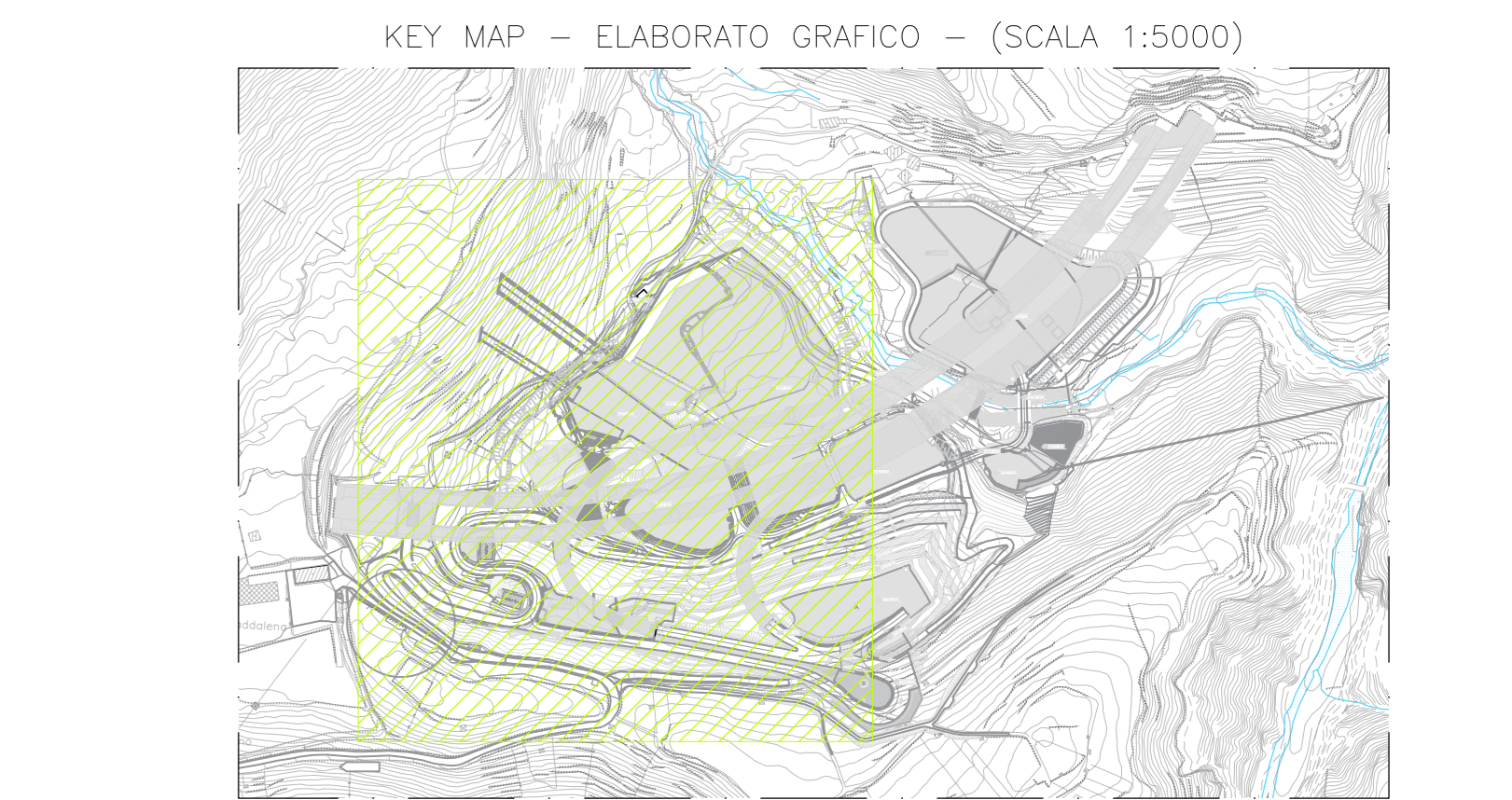

LEGENDA MATERIALE TELECAMERE. Detailed legend for camera materials, describing types such as PTZ and fixed cameras with their technical specifications.

TELECAMERA TIPO 1 - SPEED DOME PTZ 360. Technical specifications for the PTZ camera model, including resolution, sensor type, and lens details.

TELECAMERA TIPO 2 - TELECAMERA CON SISTEMA DI SENSORI MULTI FOCALI. Technical specifications for the multi-focal sensor system camera model.

Project information block including logos for TUNEL EURALPIN LYON TURIN and INGEGNERIA GÖTTSCHEW. Includes a Gantt chart showing project phases, a technical drawing code '0402080910CN24F4', a scale '1:500', and contact information for the engineering firm.