

PLANIMETRIA
Scala 1:100

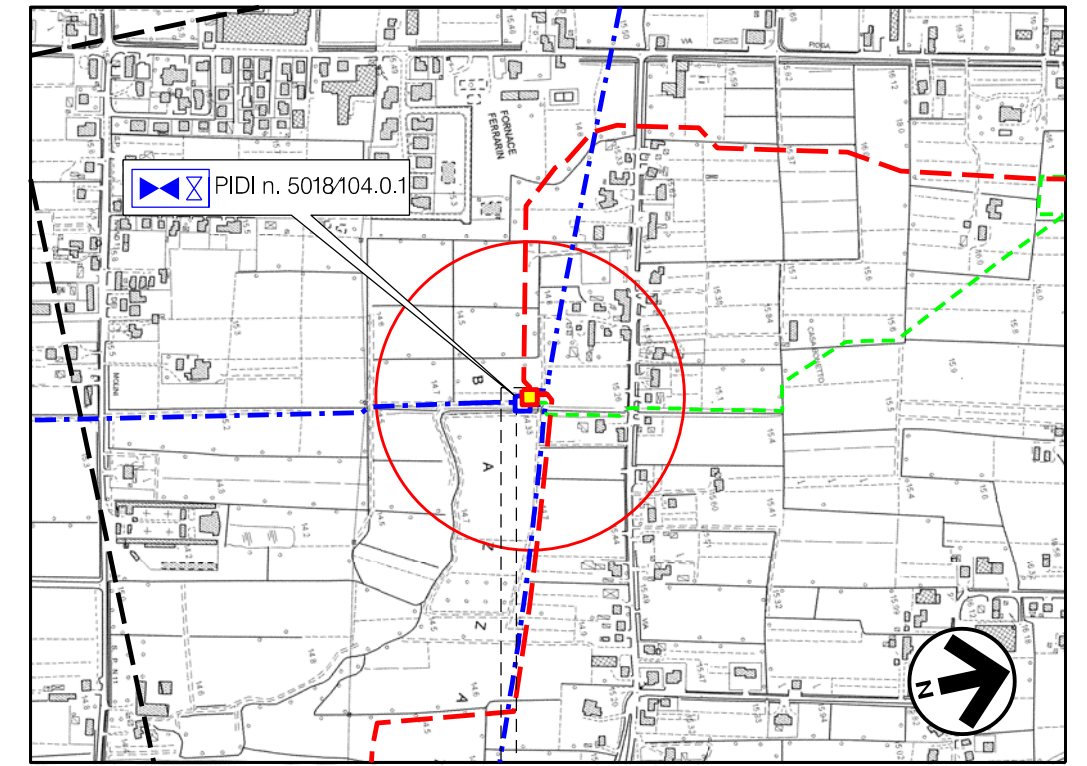

Com. di CAMPODARSEGO - CTR n.126080
STRALCIO PLANIMETRICO 1:10000

- SIEPE ARBOREO/ARBUSTIVA
- INERBIMENTO

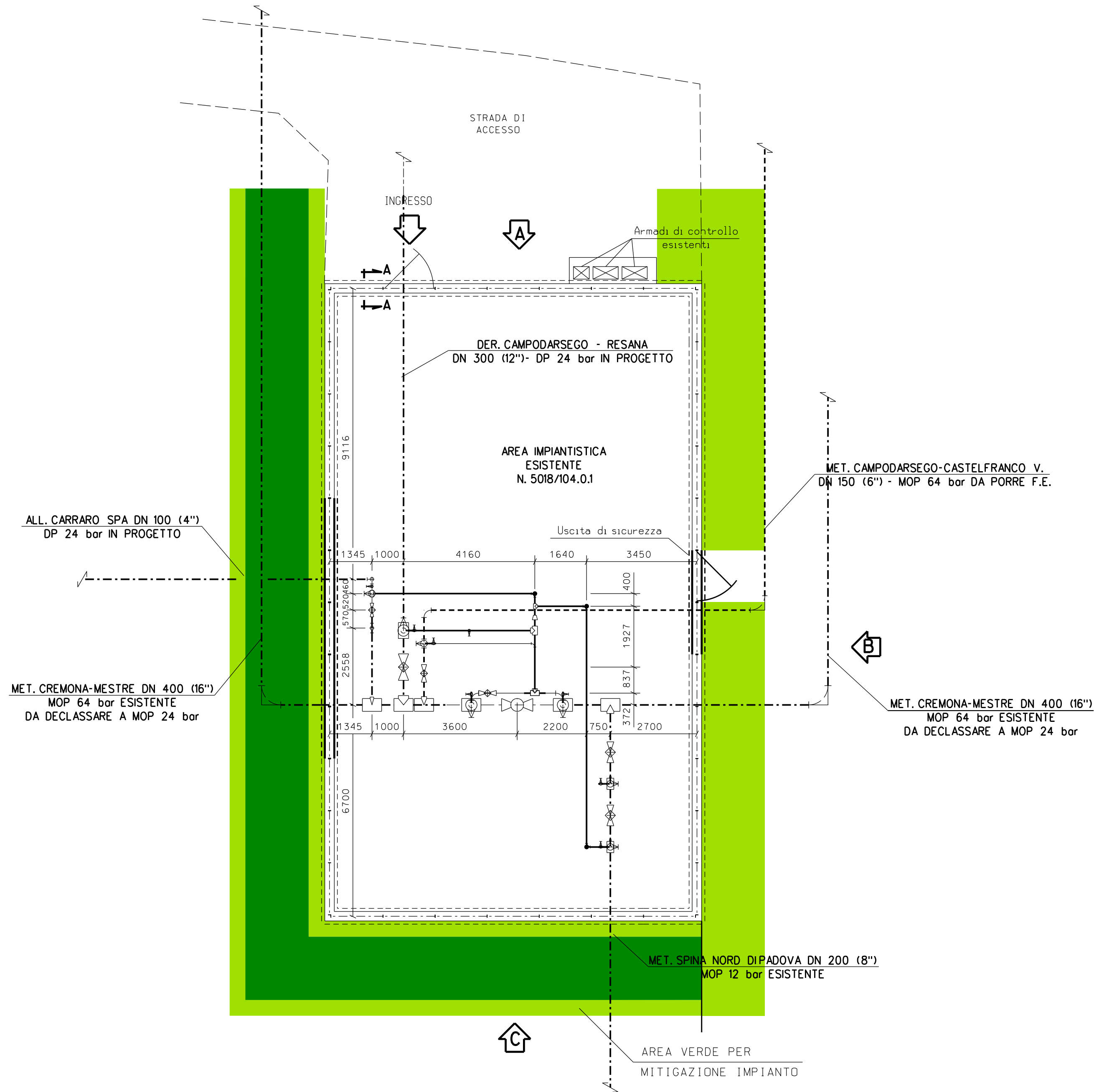

NOTE :
- LE MISURE SONO ESPRESSE IN MILLIMETRI

1	11/03/21	AGGIORNAMENTO	IEMBO	LUMINARI	MONTALBANO
0	04/11/20	AGGIORNAMENTO	IEMBO	LUMINARI	MONTALBANO
REV.	DATA	DESCRIZIONE	DISEGN.	CONTR.	APPROV.
Proprietario		Progettista		DISEGNO	
				MI-9110575-01 Fg. 1 di 3	
Metanodotto: Rif. Met. Campodarsego-Castelfranco (1^ Tratto Campodarsego-Resana) DP 24 bar DER. CAMPODARSEGO - RESANA DN 300 (12") - DP 24 bar			Comm. NR/16025		
INDICE			Scala 1:100		
Sostituisce il			Sostituito dal		
PROGETTO DI MASCHERAMENTO IMPIANTO (P.I.D.I.) N. 5018/104.01					

PROSPETTO A



MET. CREMONA - MESTRE DN 400 (16") - DP 24 bar
VARIANTE PER STACCHI DA P.I.D.I. N. 5018/104.0.1

COMMESSA
NR/16025/R-L01
COD. TEC.
9110575

Fg. 2 di 3

PROGETTO DI MASCHERAMENTO IMPIANTO

MI-9110575-01

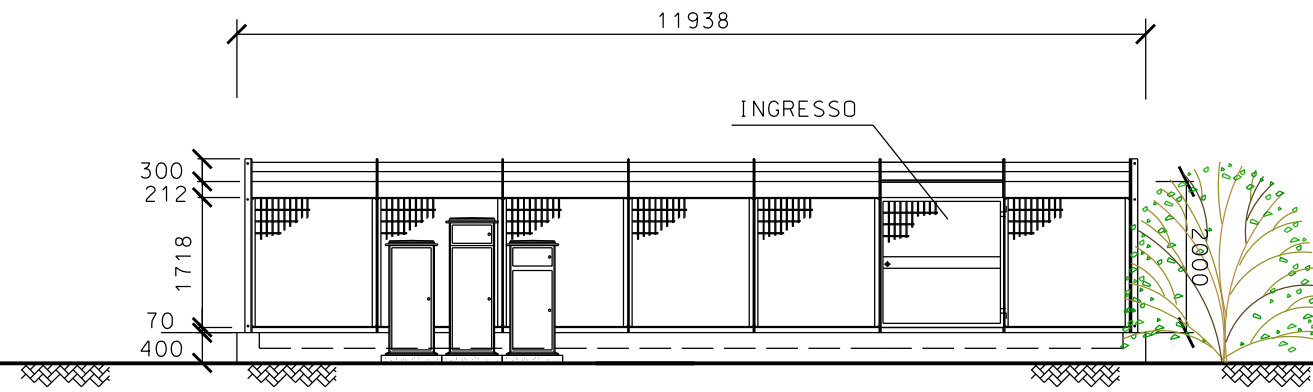

PROSPETTO B

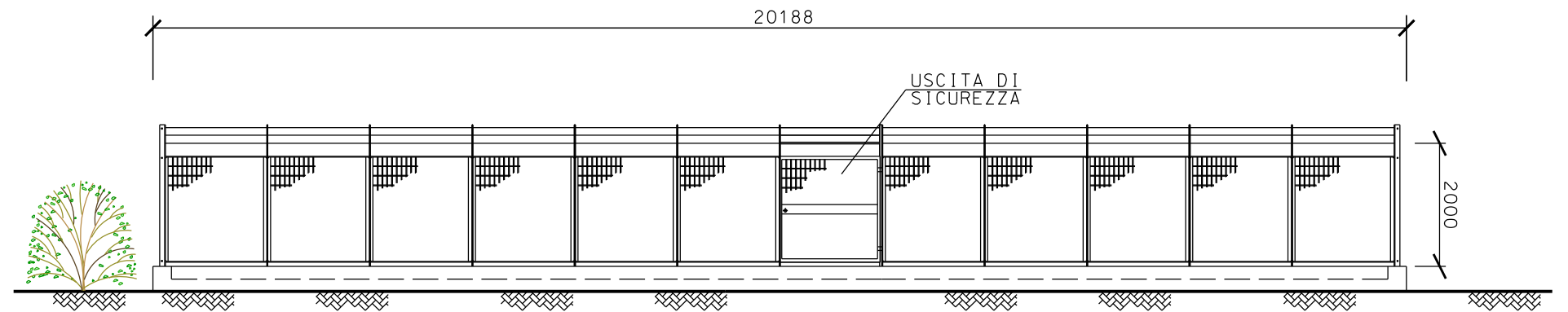

PROSPETTO C

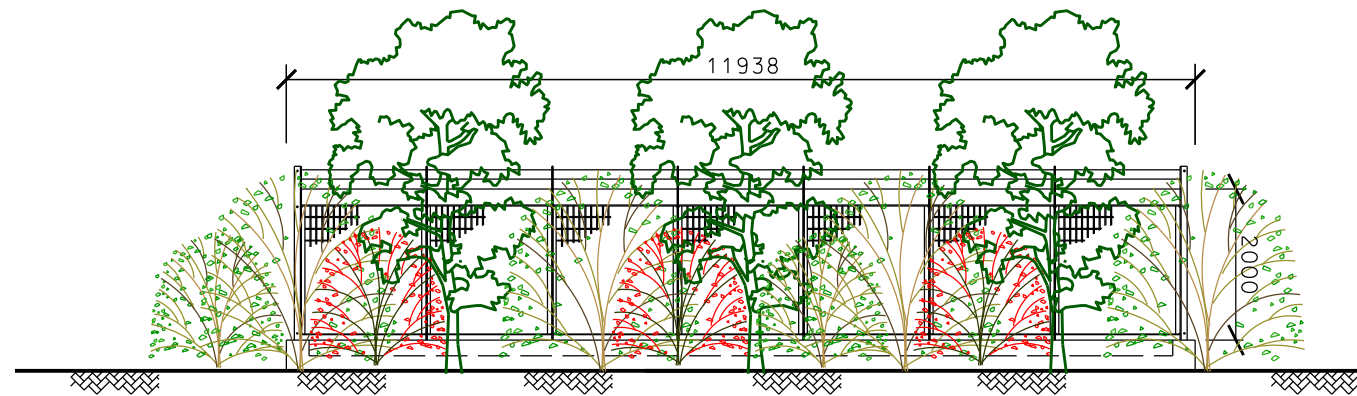



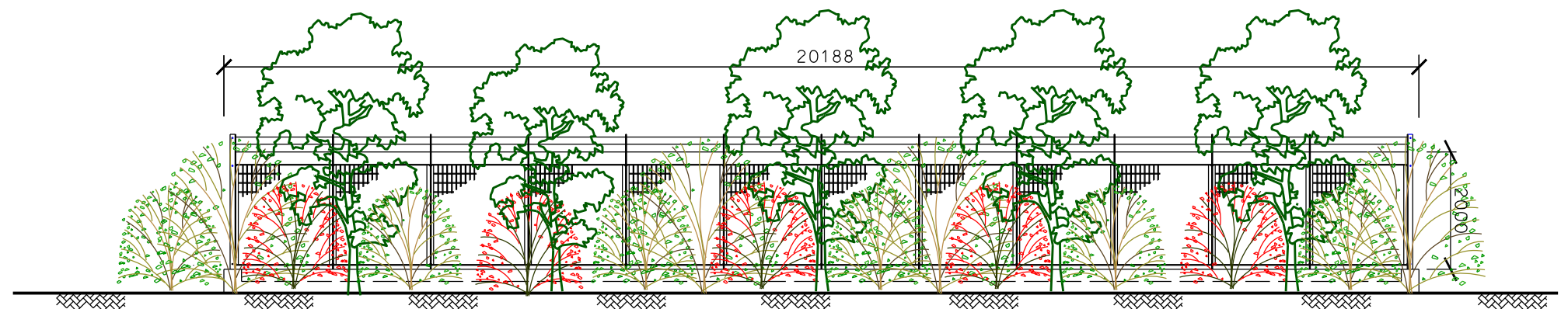



PROSPETTO D

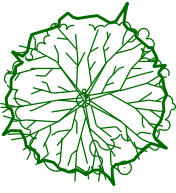

NOTE :

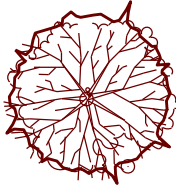
- LE MISURE SONO ESPRESSE
IN MILLIMETRI

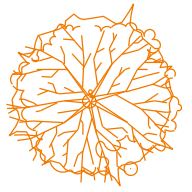

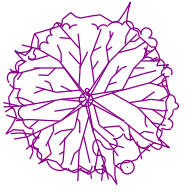
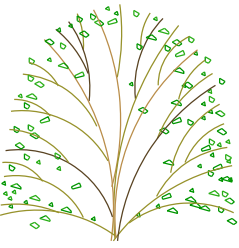
		ACERO CAMPESTRE (n. 8)
		BERRETTA DA PRETE (n. 8)
		SANGUINELLA (n. 9)
		CORNILOLO (n. 9)

34

NOTE:

- Mettere a dimora le piante come riportato in planimetria
- Utilizzare piante arboree / arbustive h. 1.00 - 1.25 m
- Le misure sono espresse in millimetri

