

Interventi di naturalizzazione delle aree in dismissione della viabilità primaria e secondaria - scala 1:100

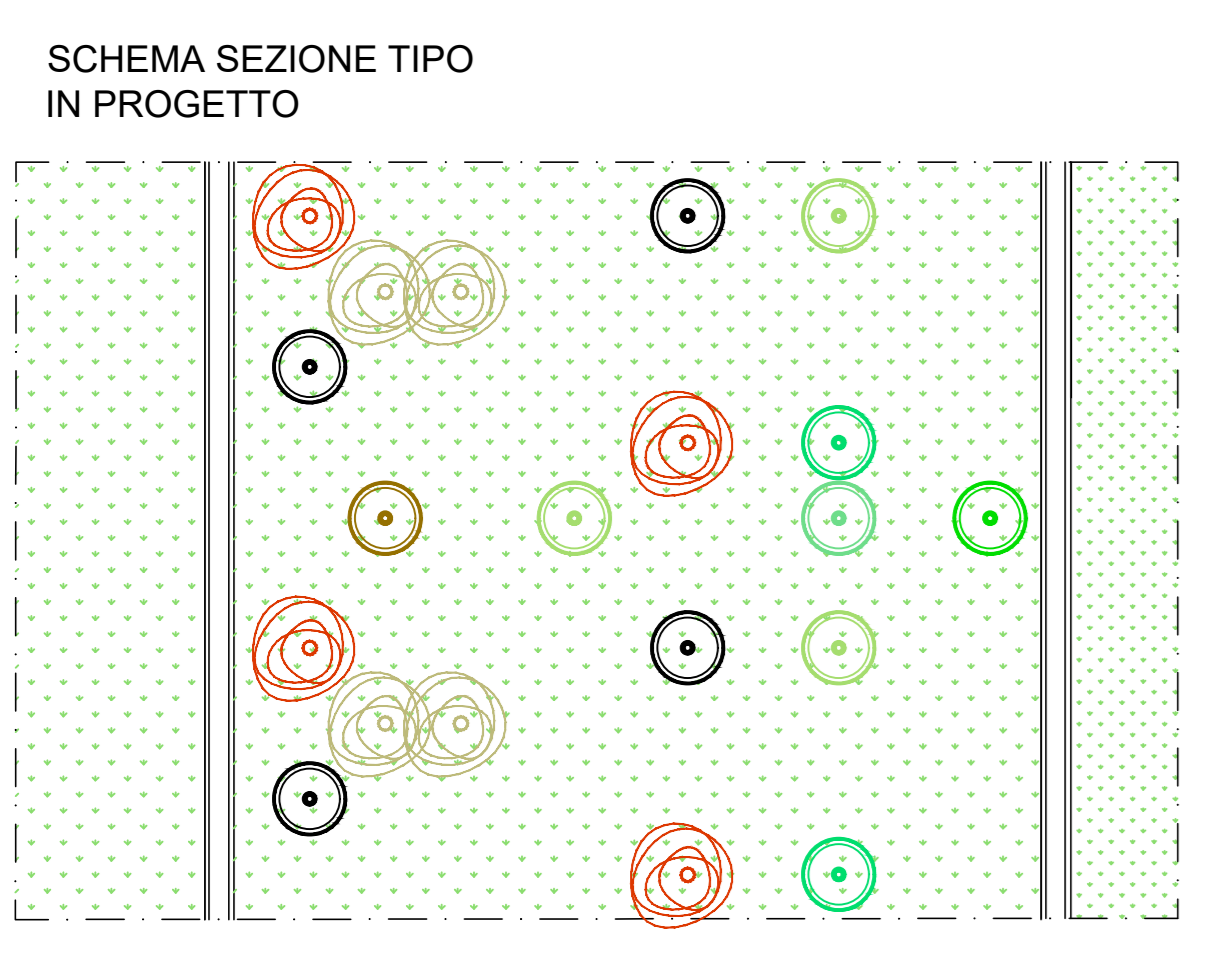

ST2 NATURALIZZAZIONE E RIMODELLAMENTO

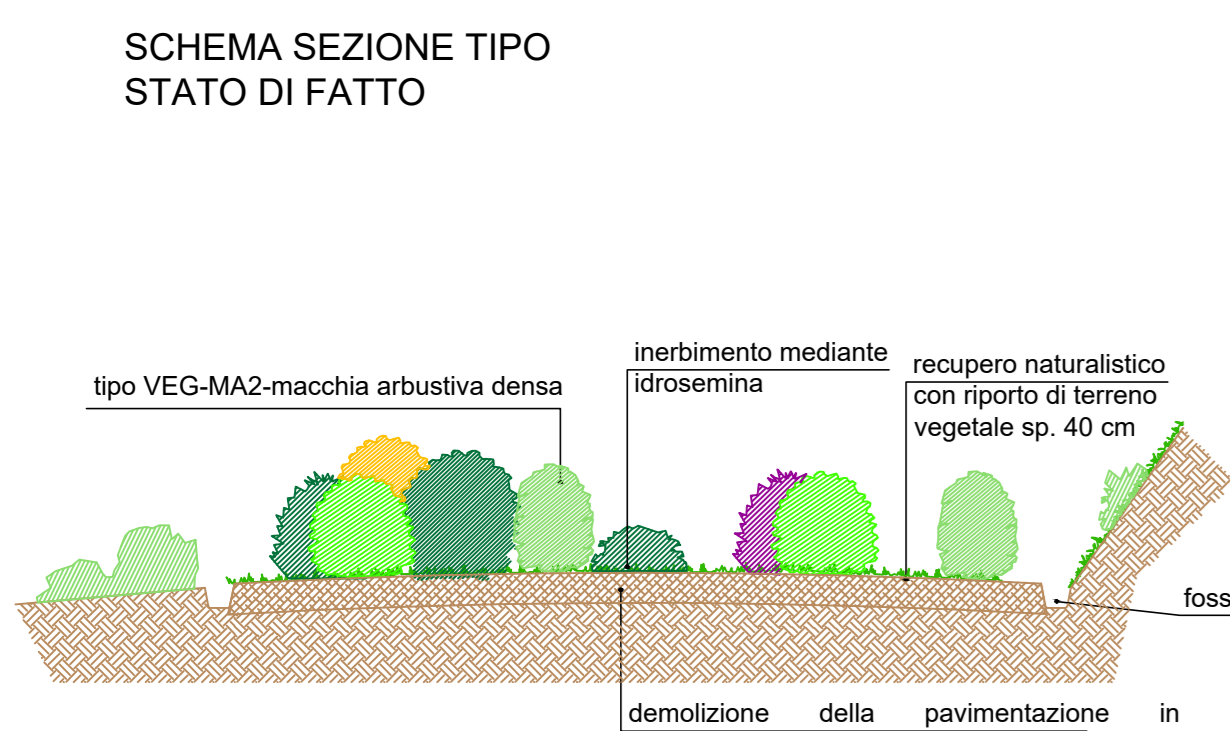
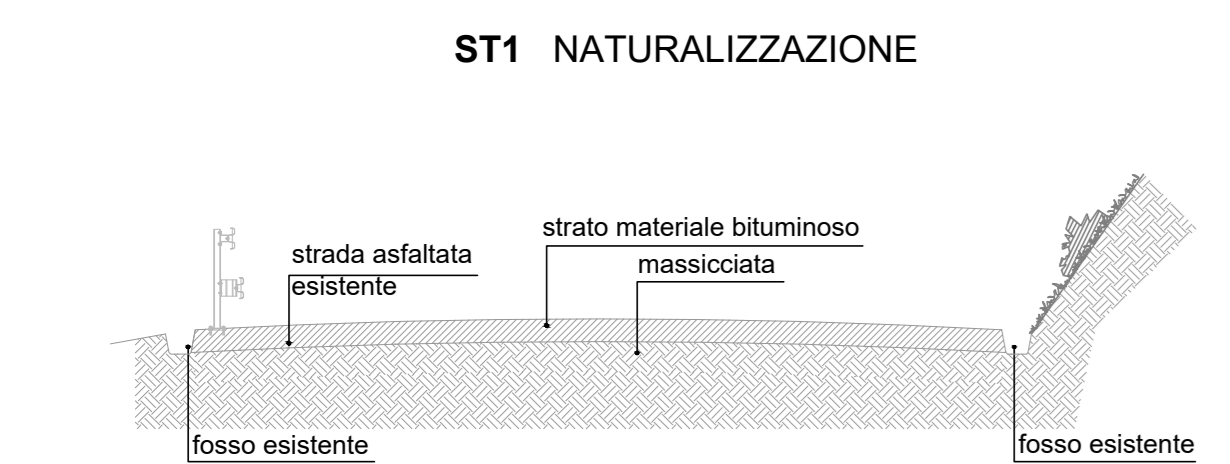
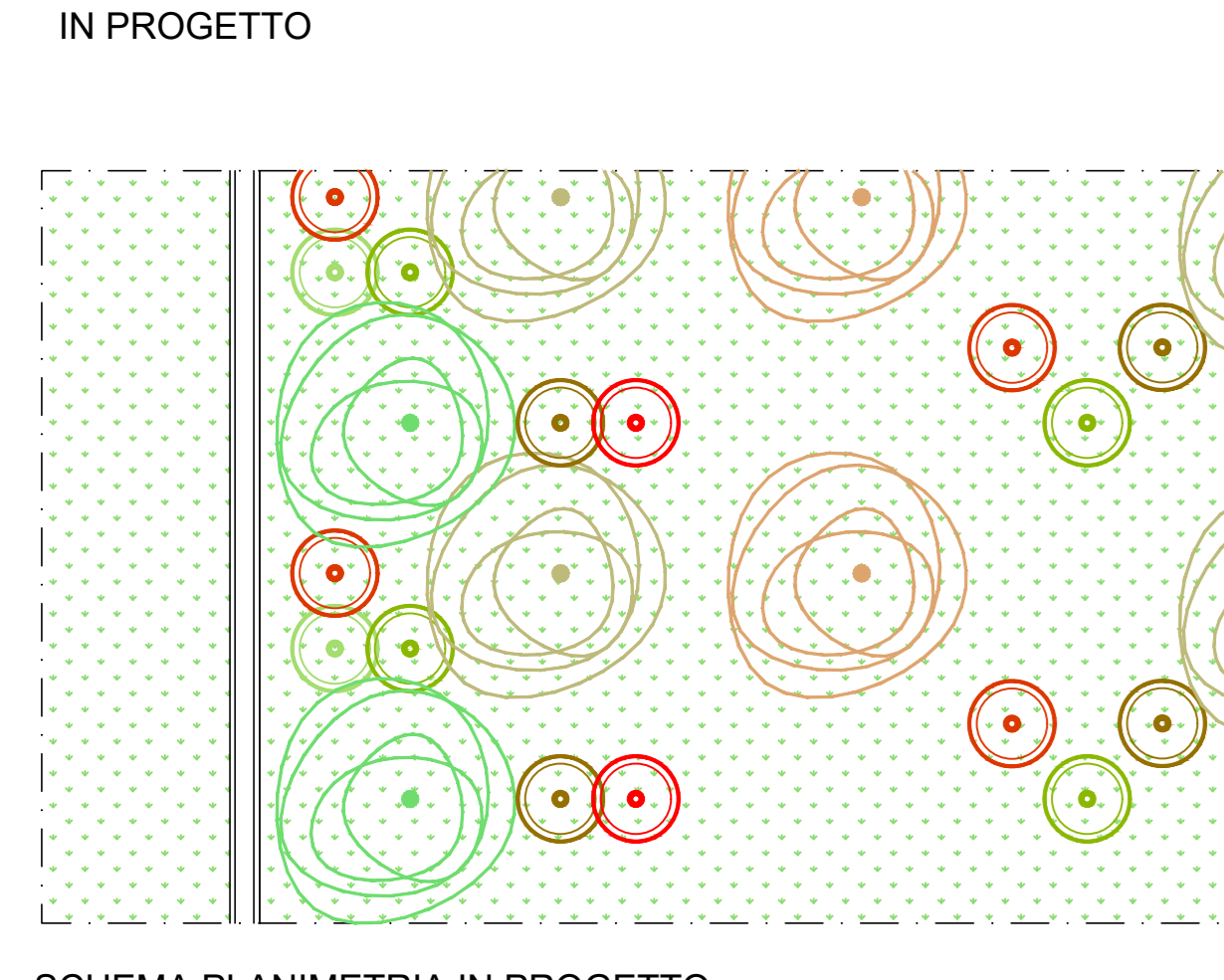
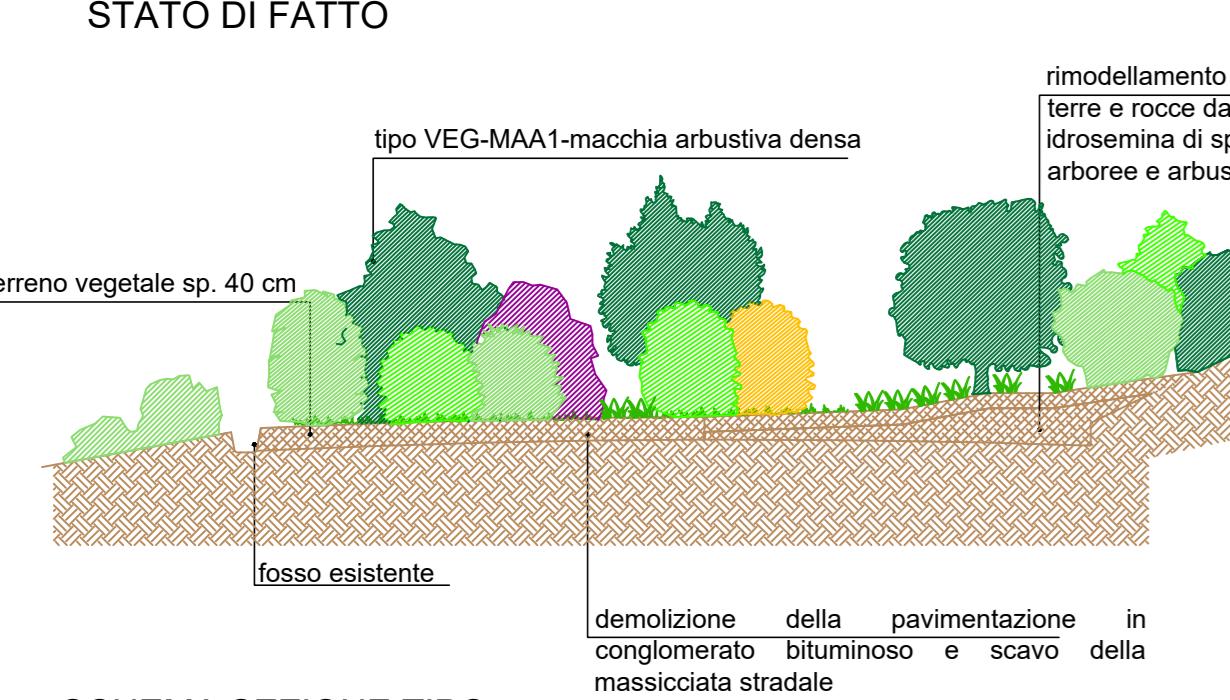

Interventi di ingegneria naturalistica - scala 1:50

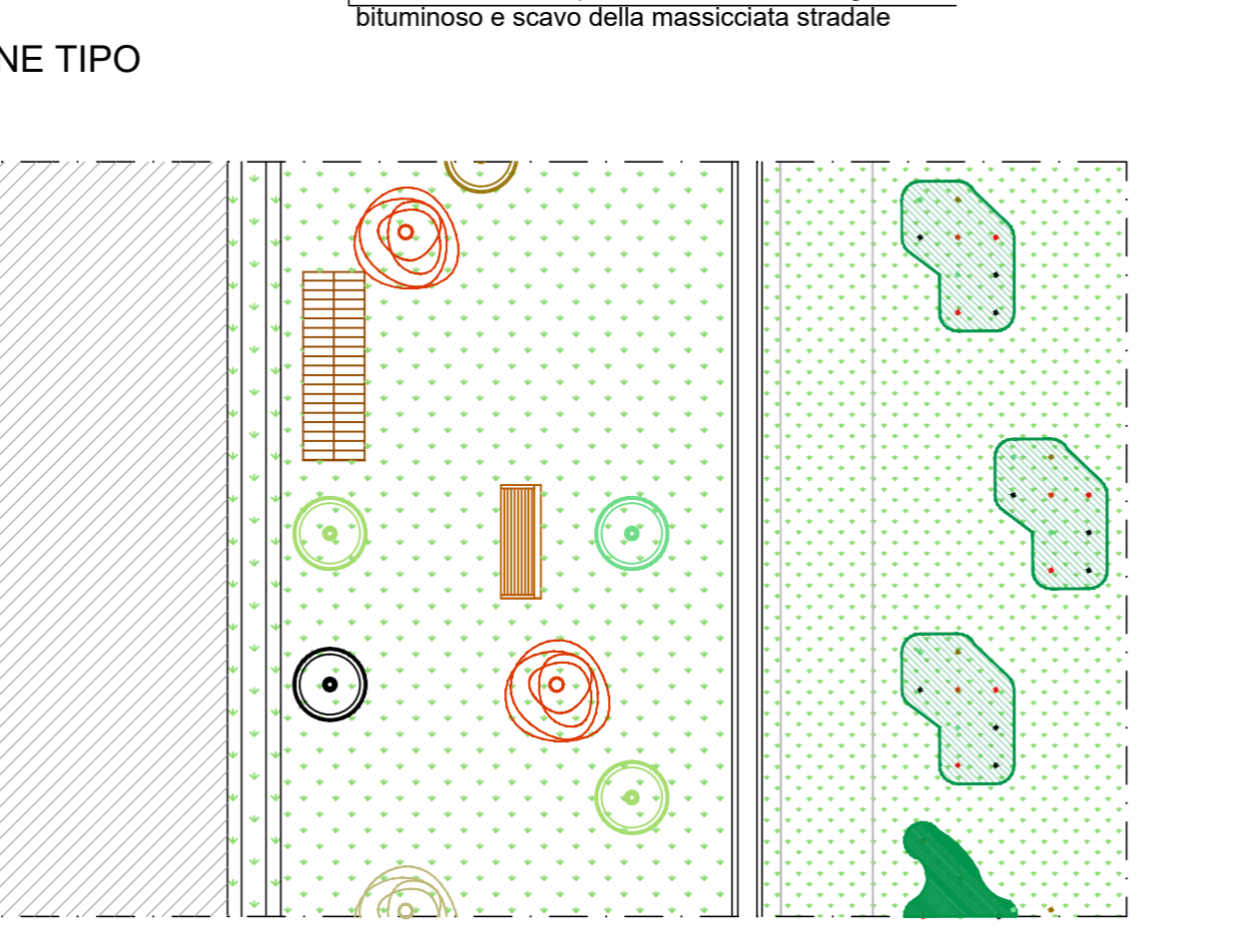
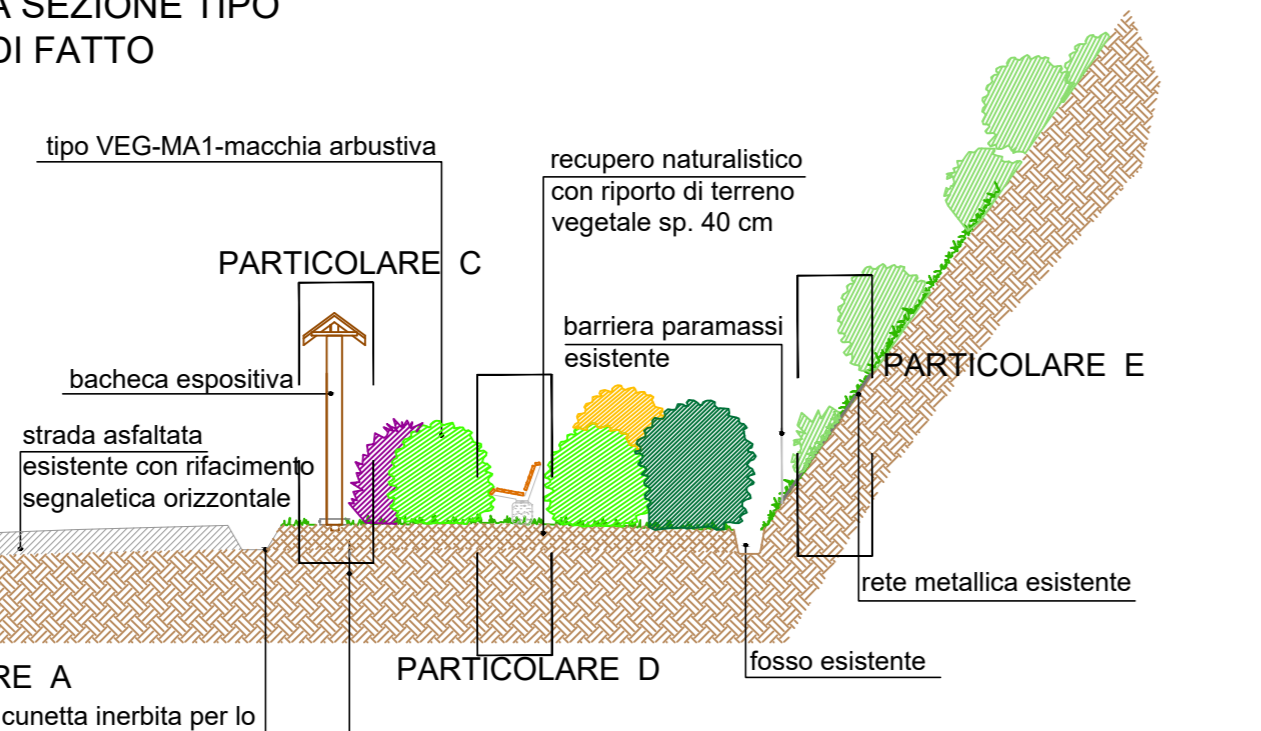
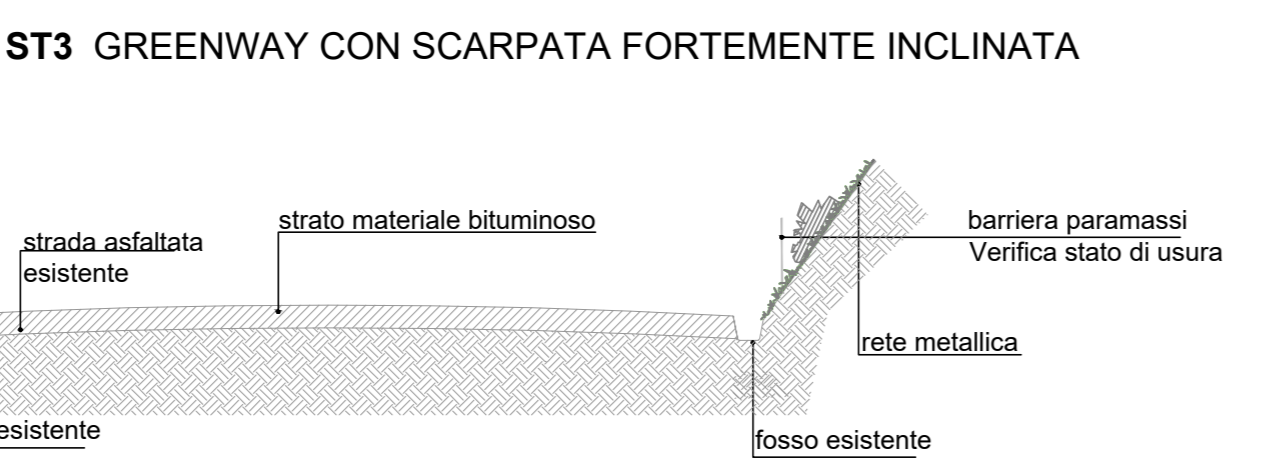
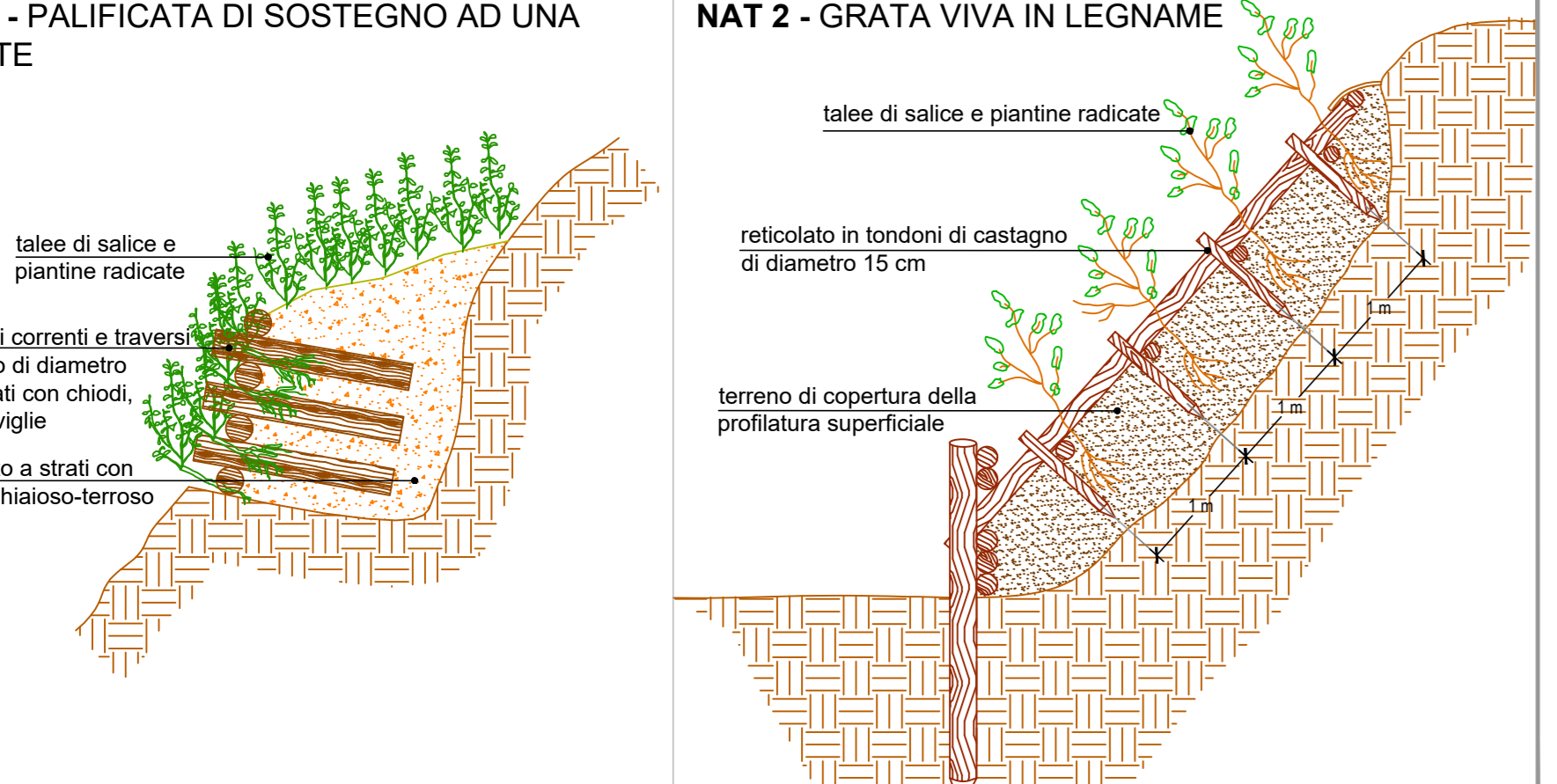

ST4 GREENWAY CON SCARPATA MODERATAMENTE INCLINATA

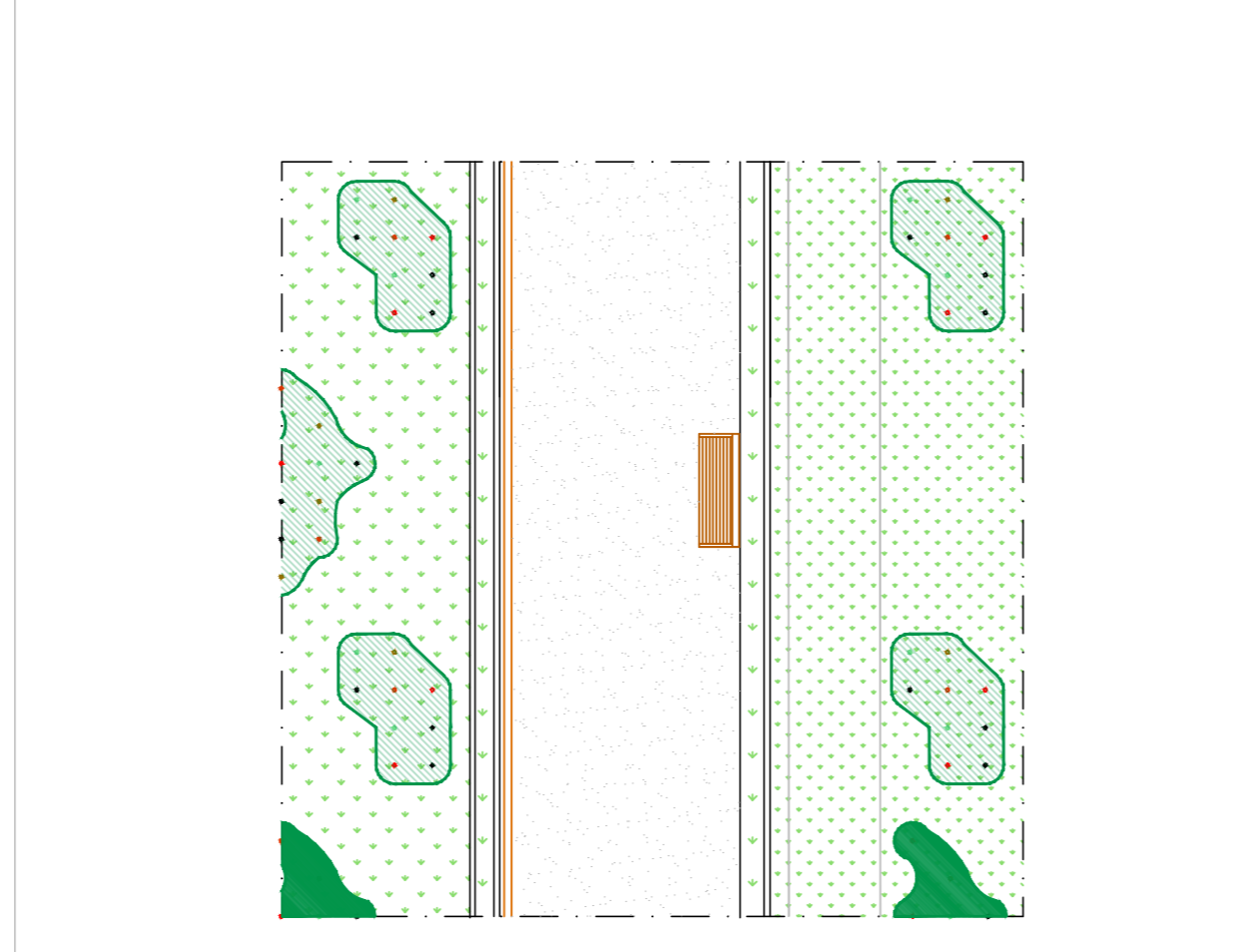
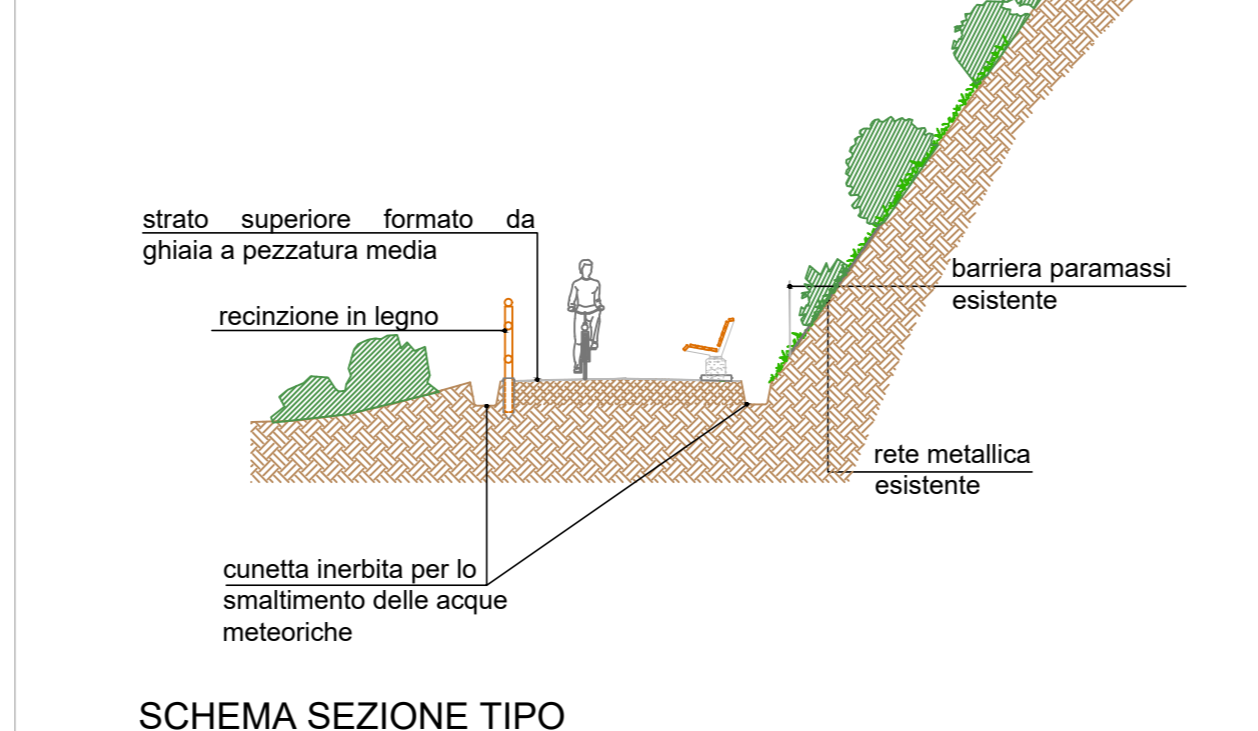
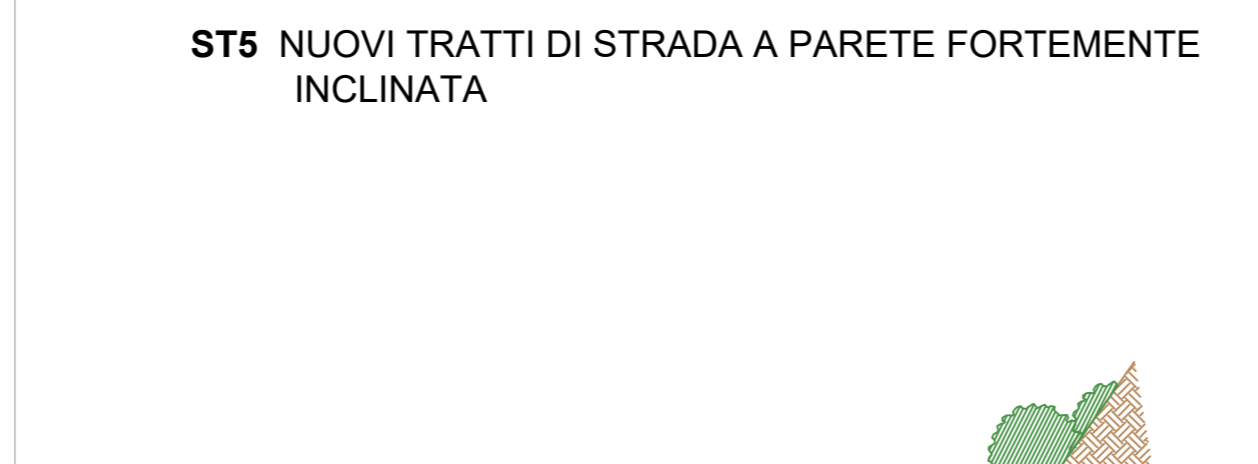
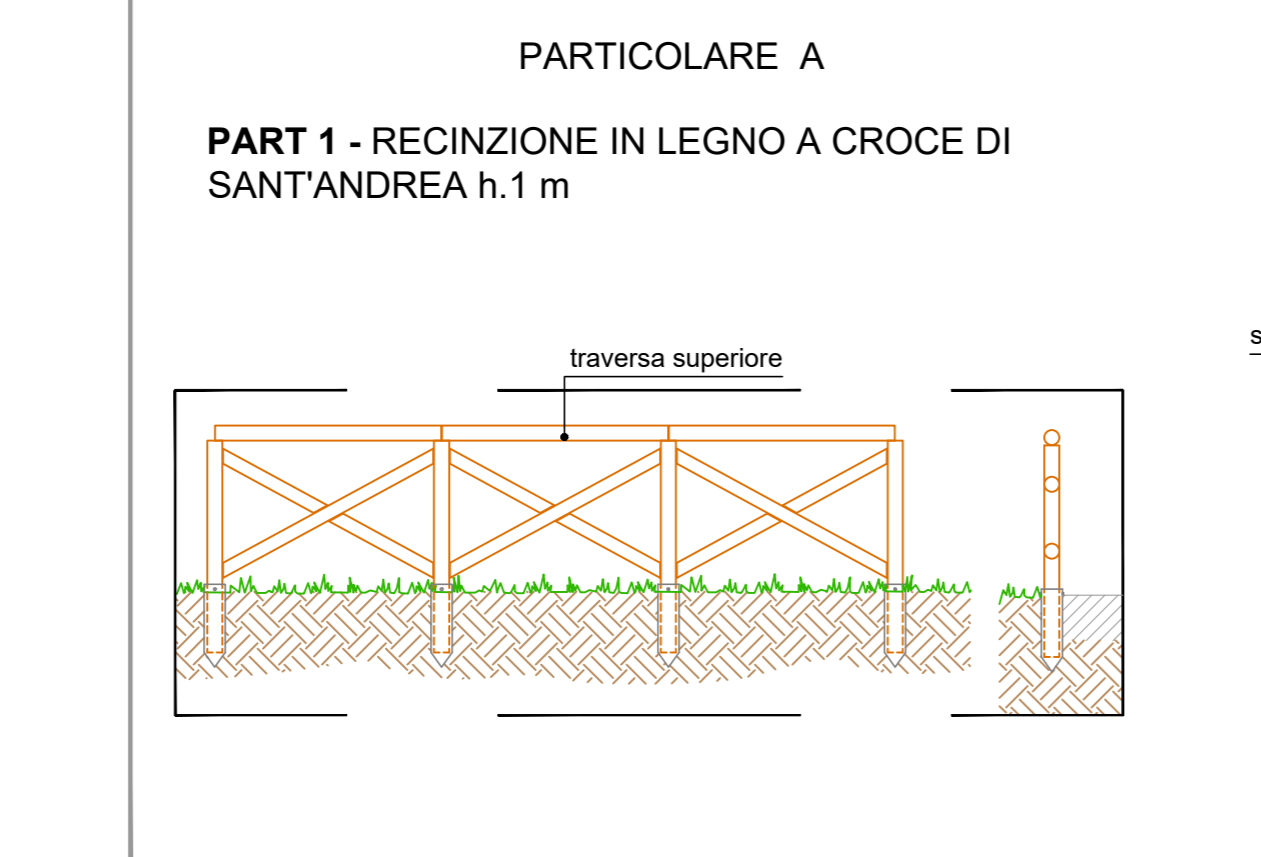
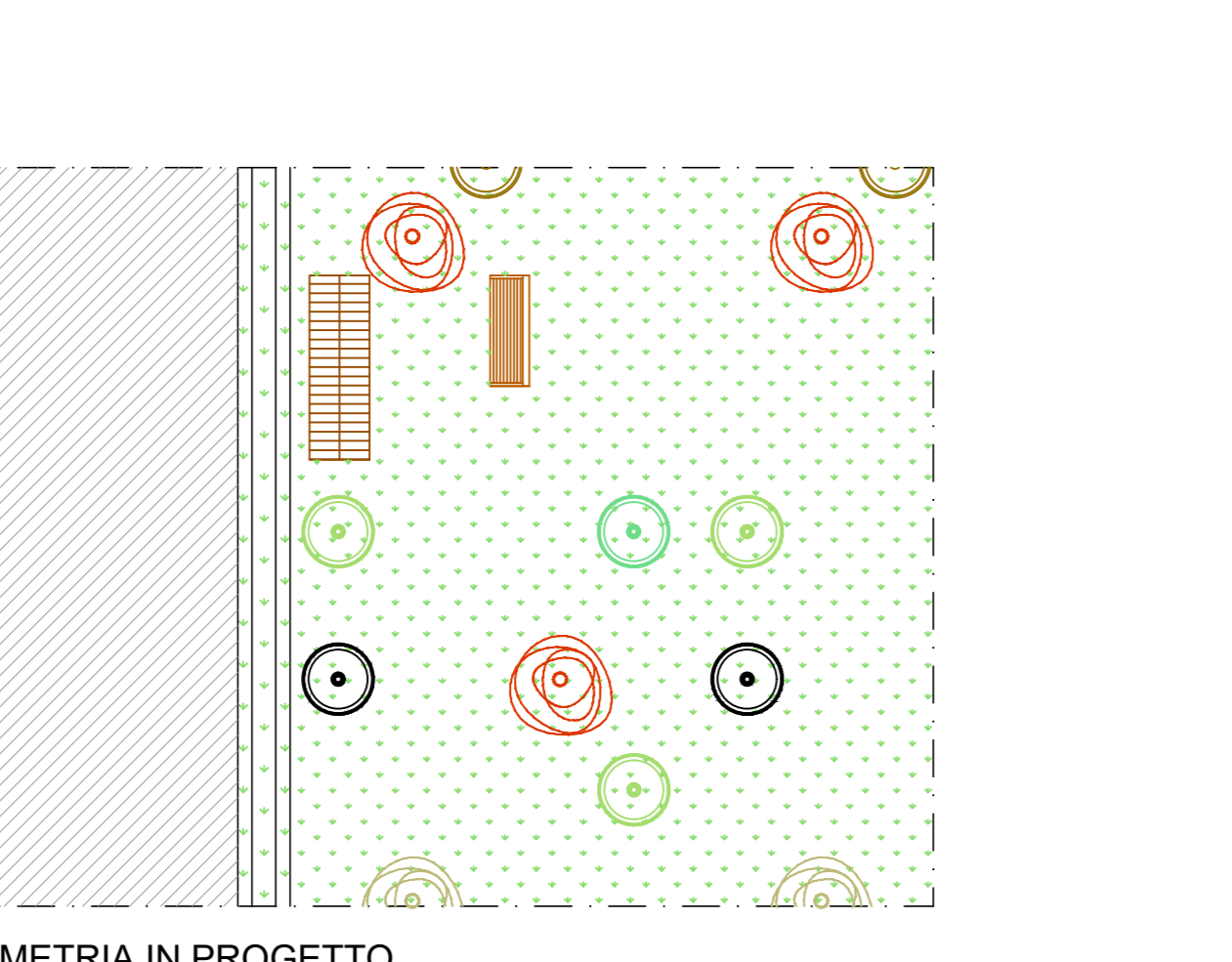
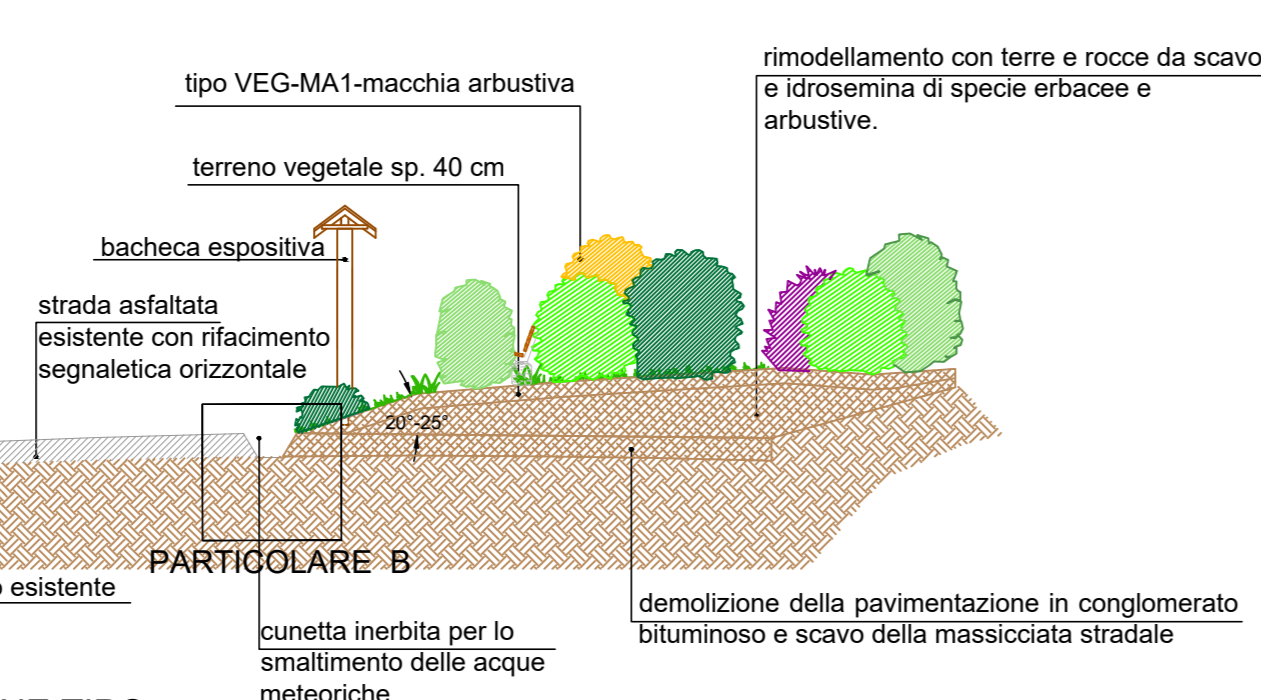
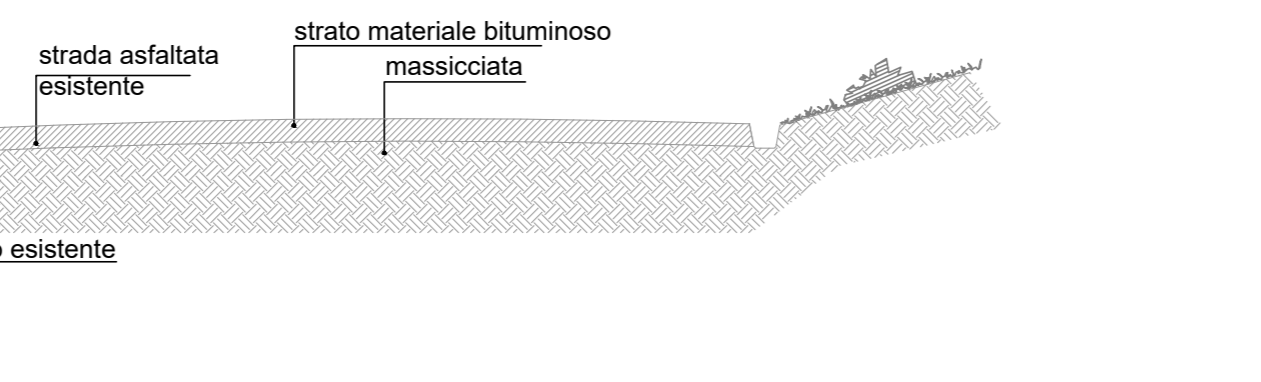

ST6 Greenway con gabbionata

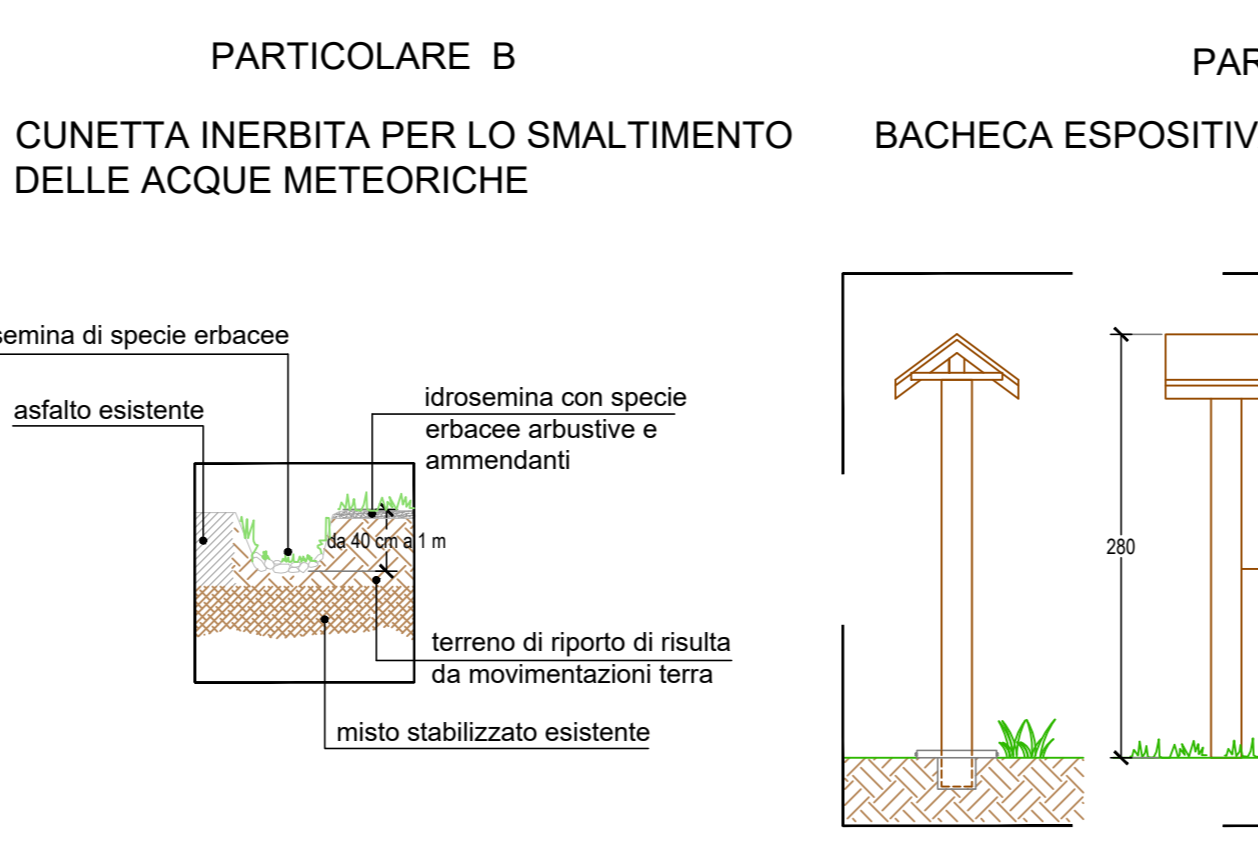
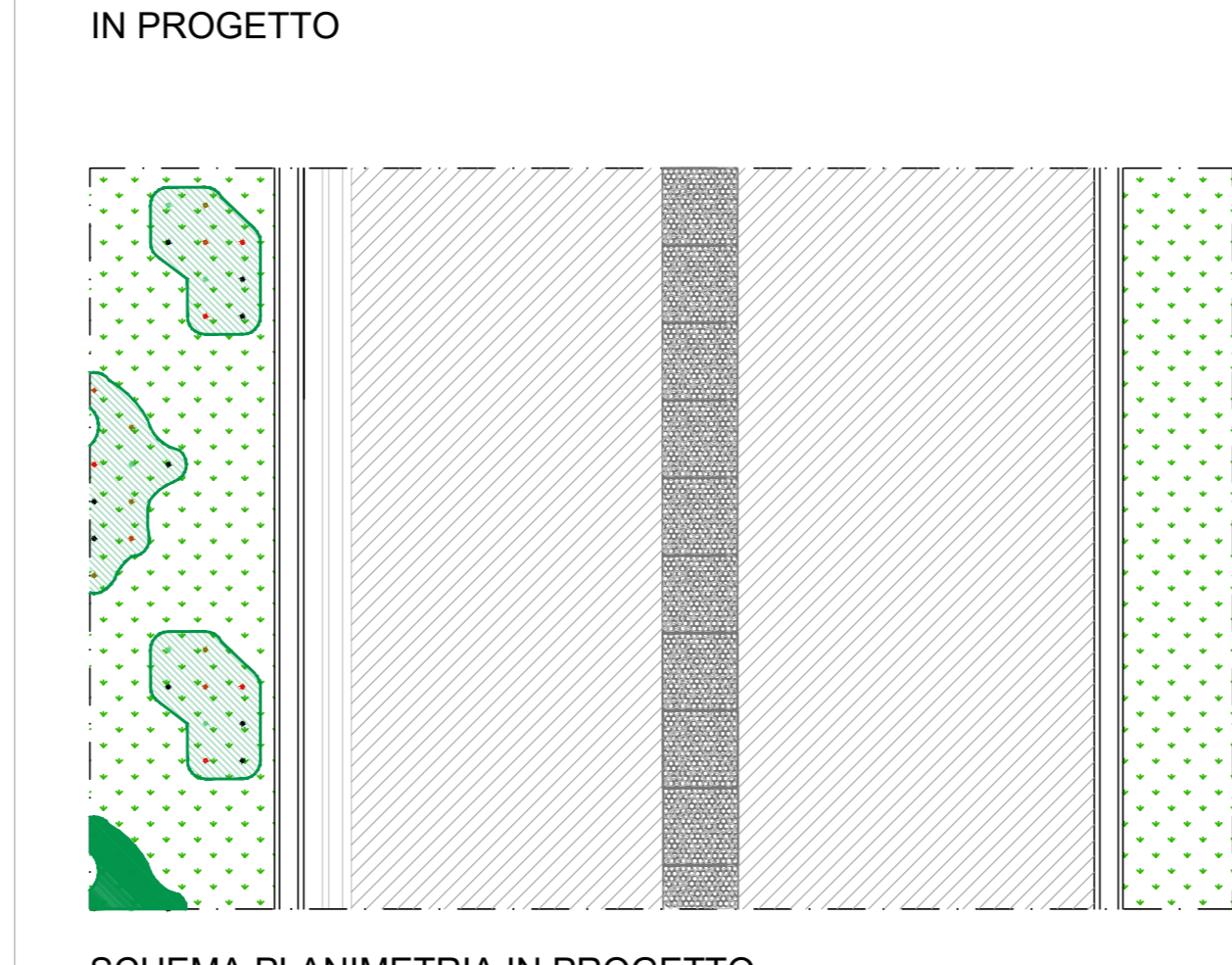
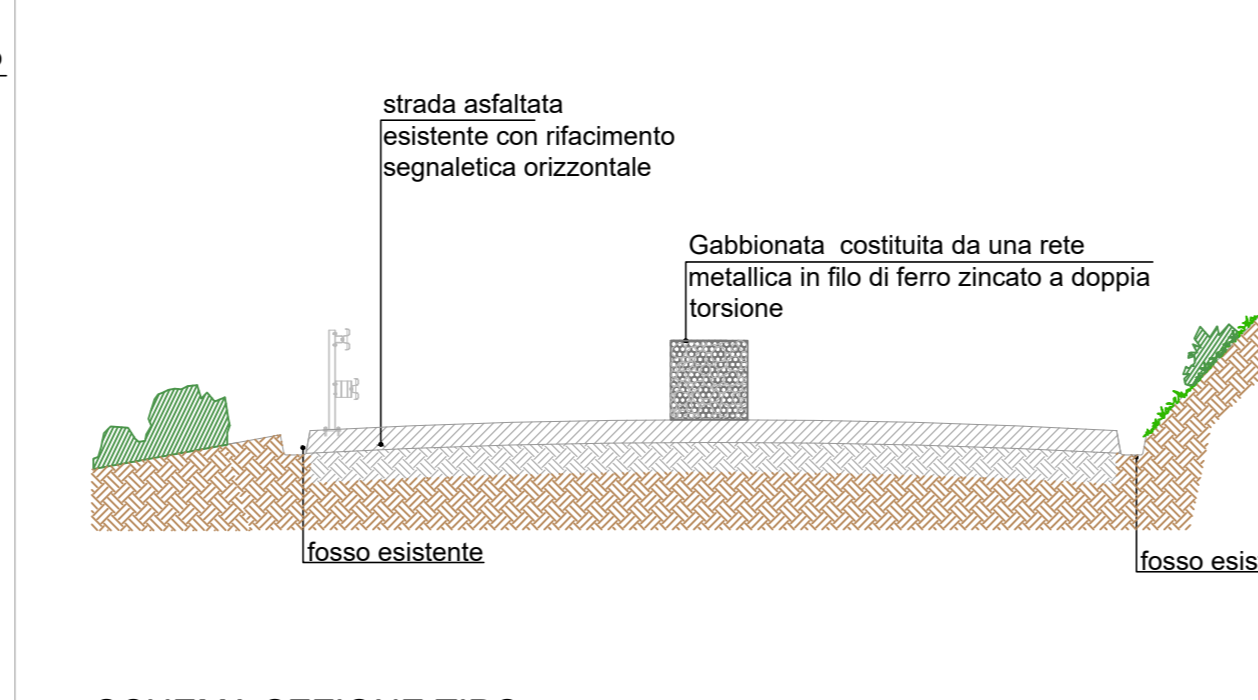
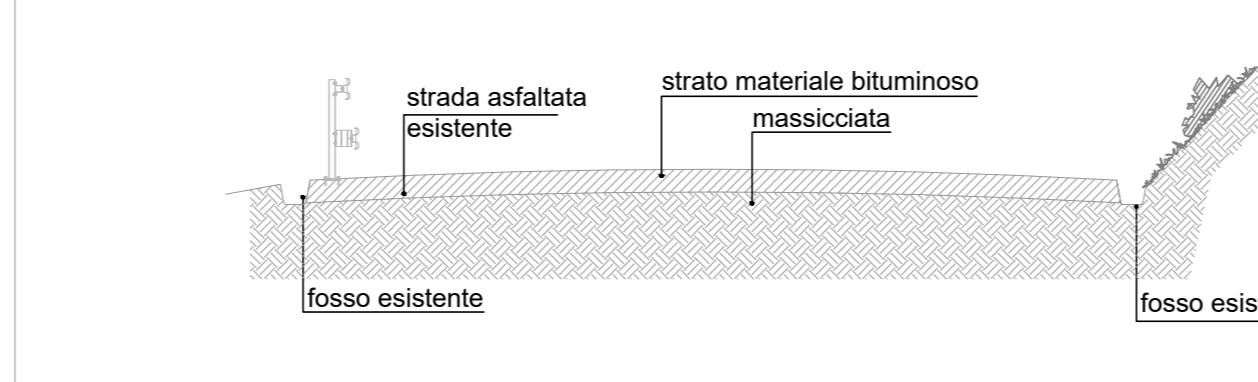

Interventi di integrazione delle opere accessorie - scala 1:100

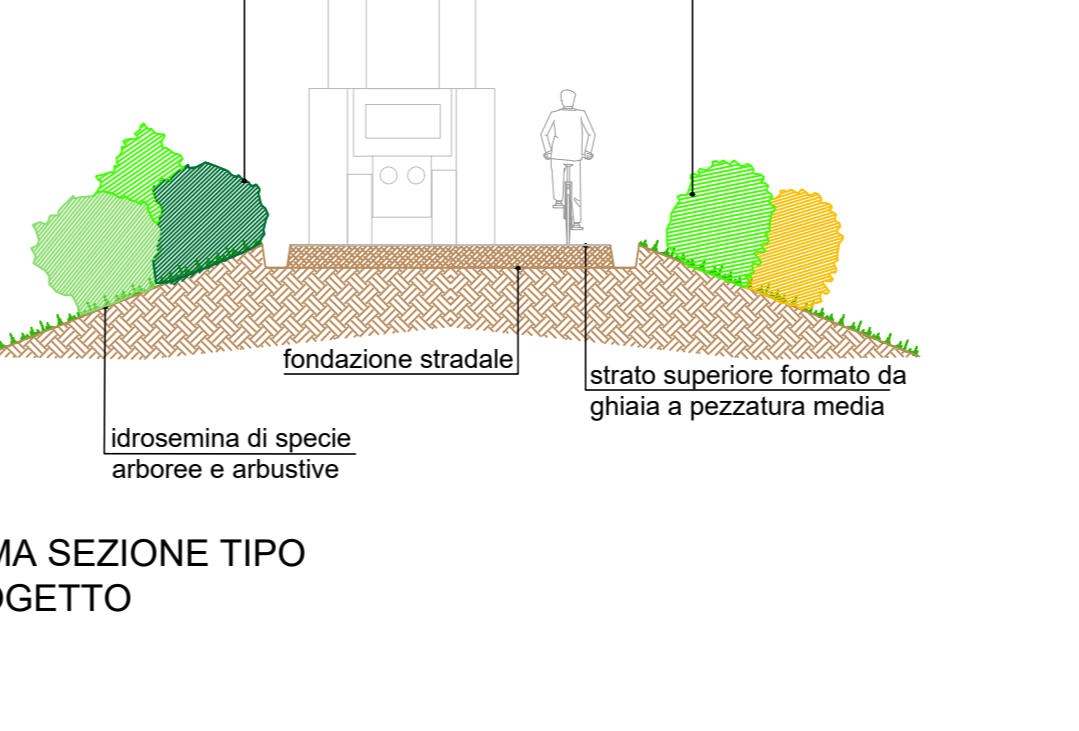
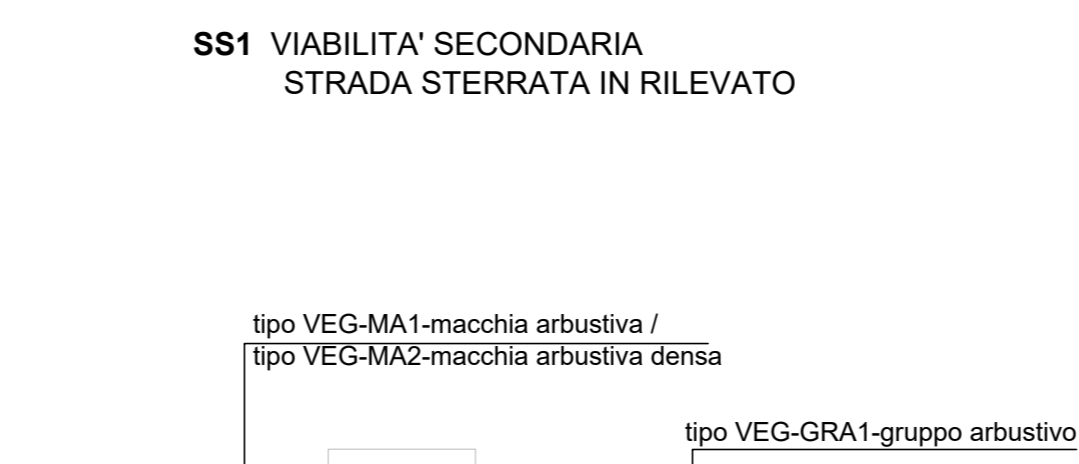

SS2 VIABILITA' SECONDARIA STRADA STERRATA IN TRINCEA

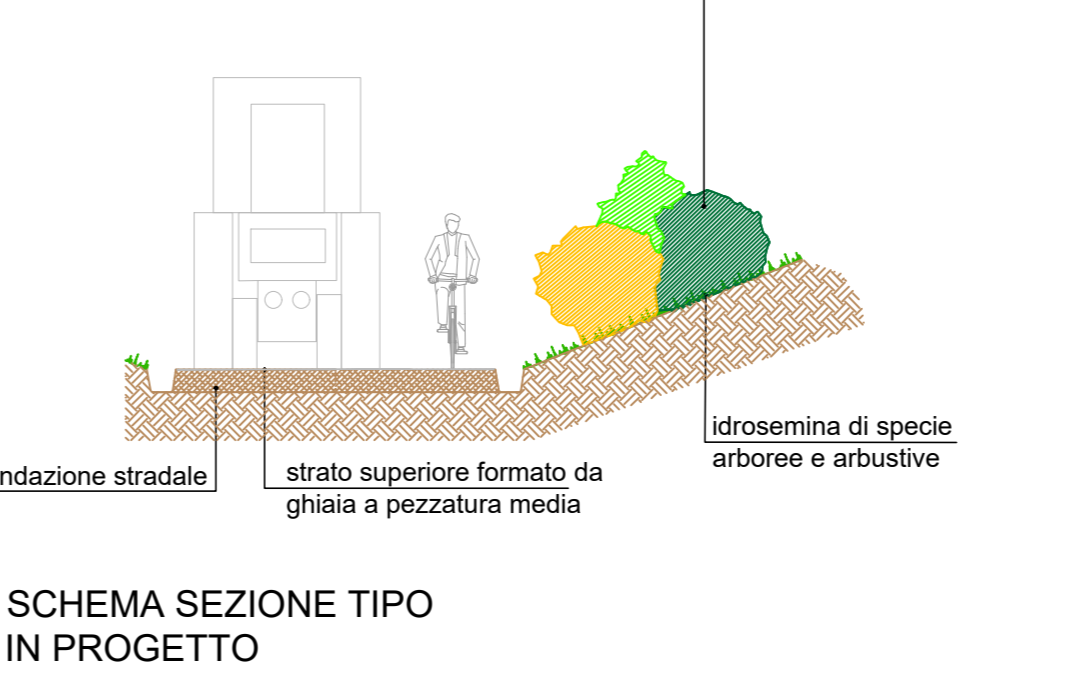
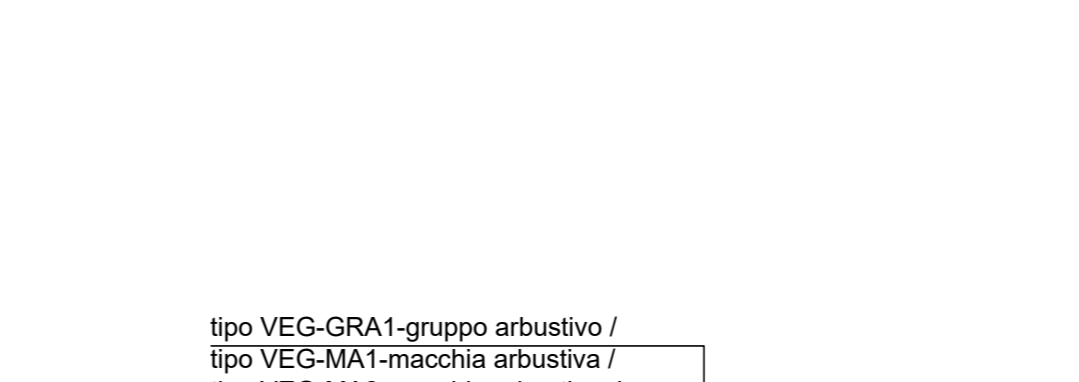

Interventi di integrazione delle opere accessorie - scala 1:100

SS1 VIABILITA' SECONDARIA STRADA STERRATA IN TRINCEA

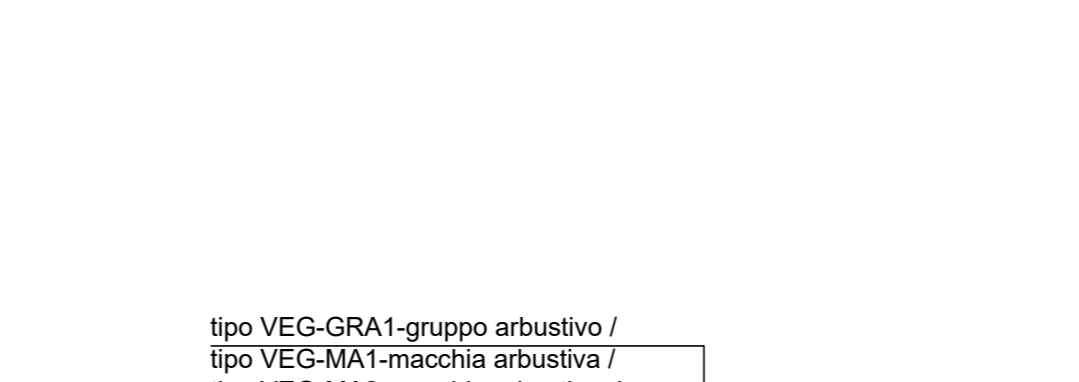

SS2 VIABILITA' SECONDARIA STRADA ASFALTATA IN RILEVATO

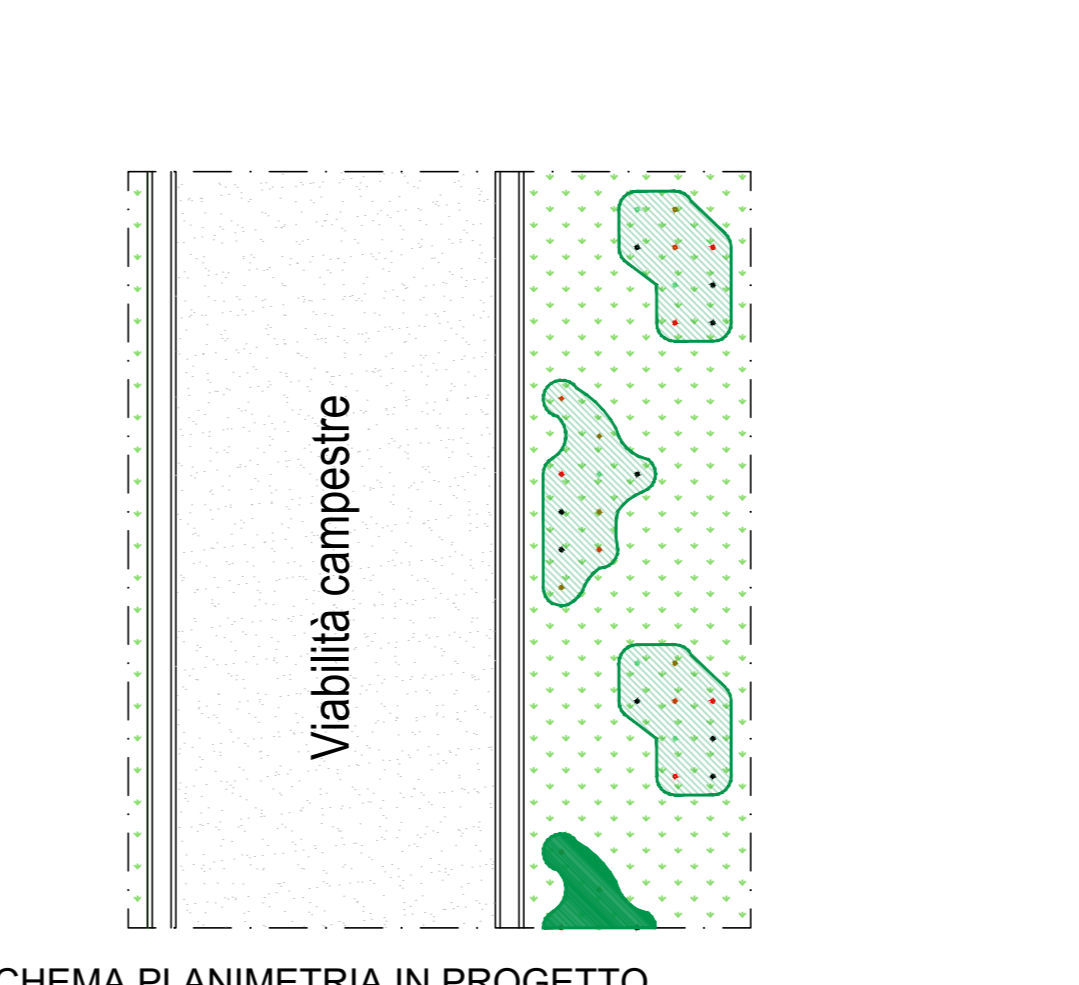
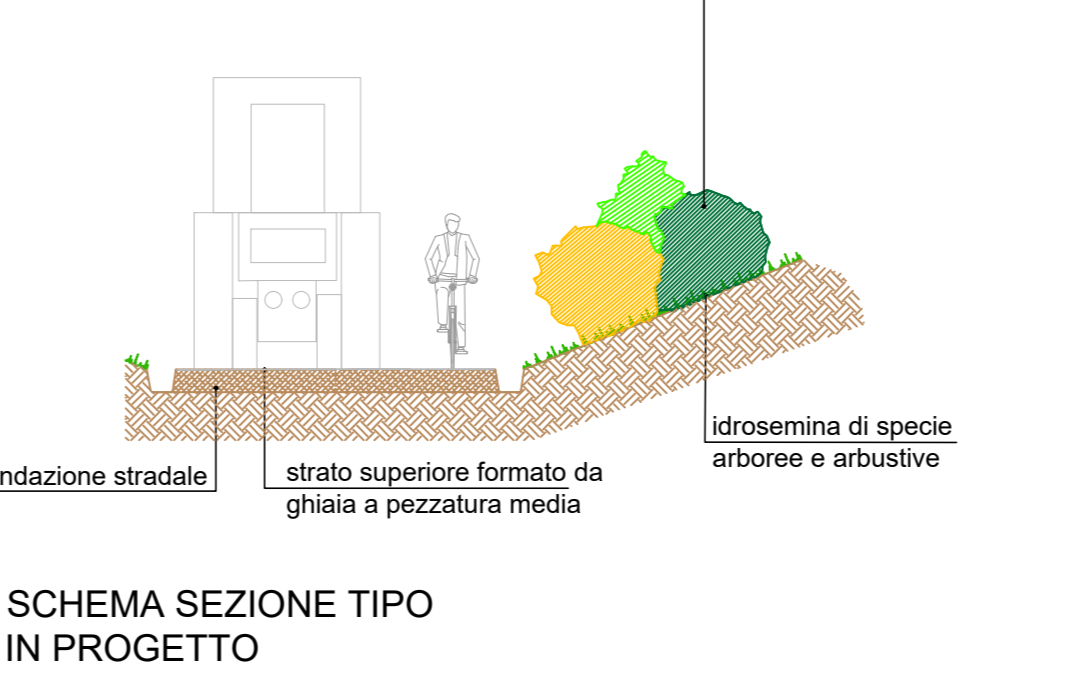
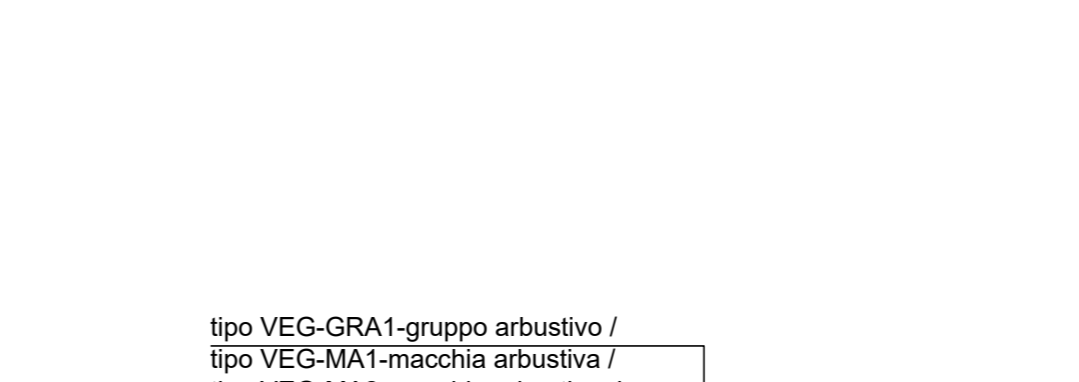

SS2 VIABILITA' SECONDARIA STRADA ASFALTATA IN TRINCEA

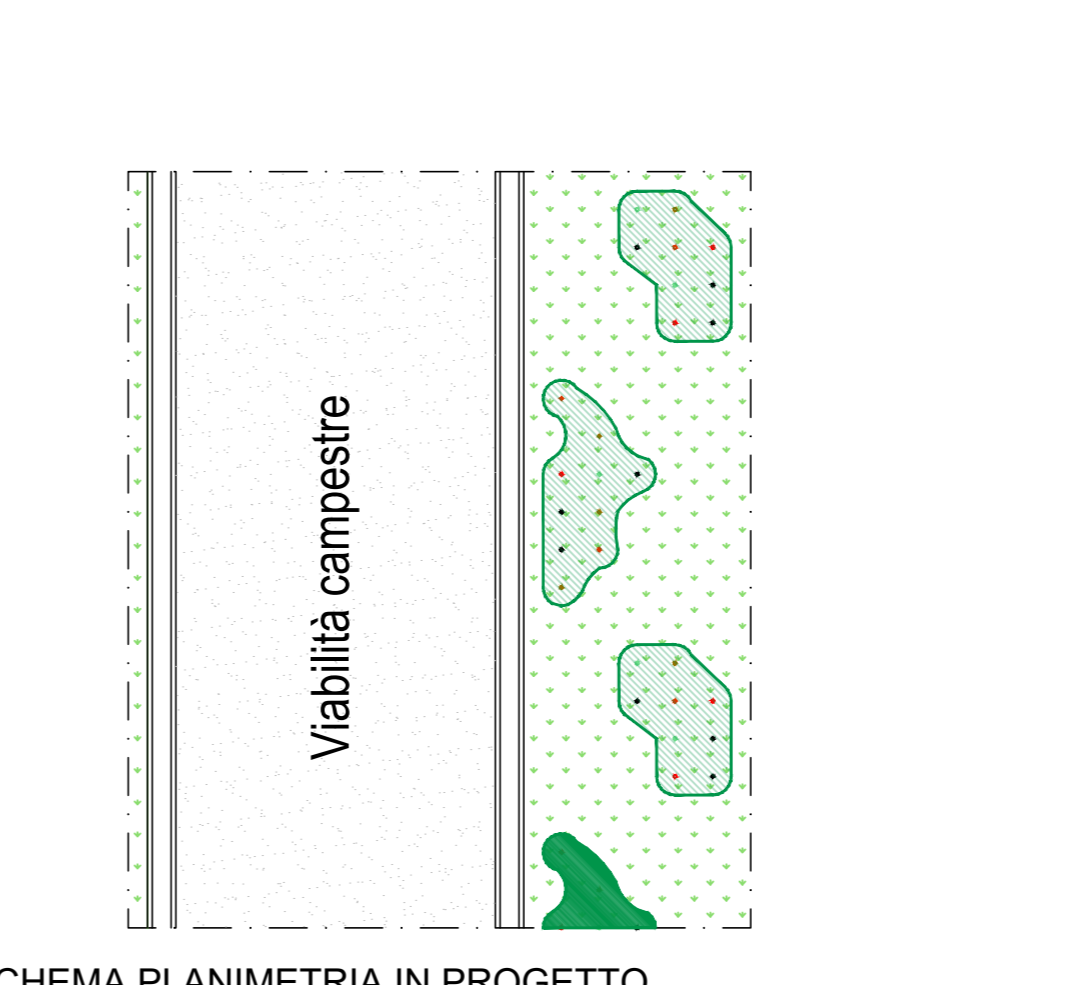
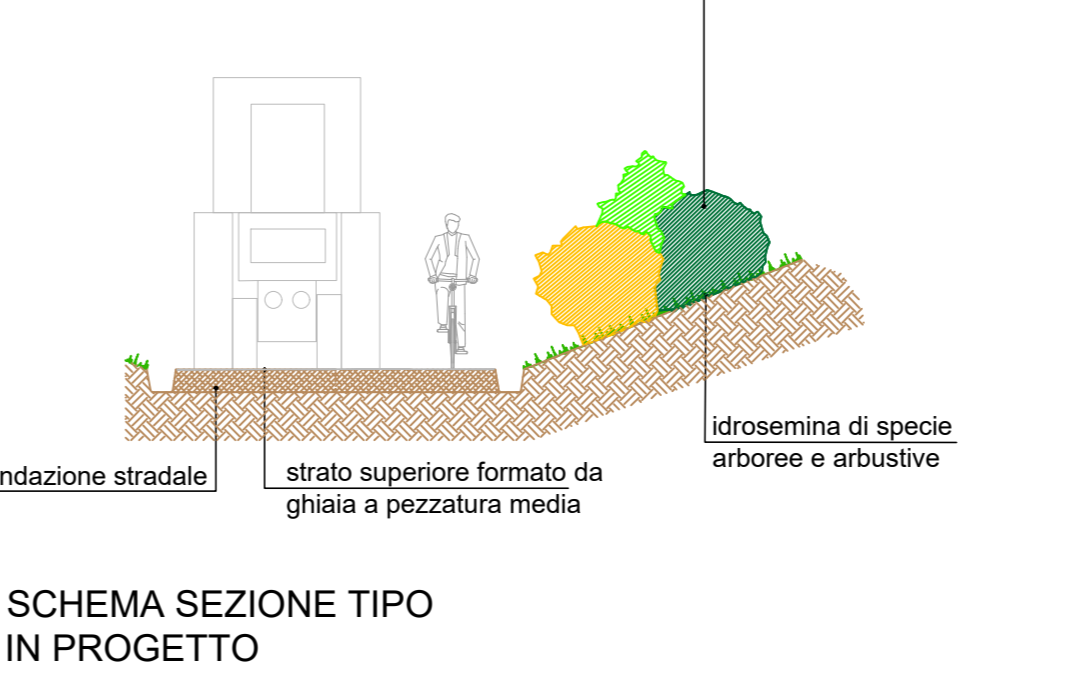
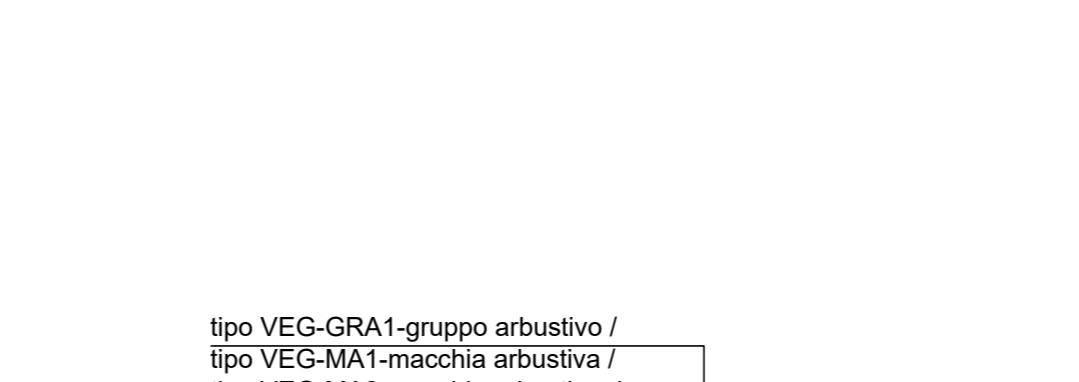

Dettagli progettuali - scala 1:50

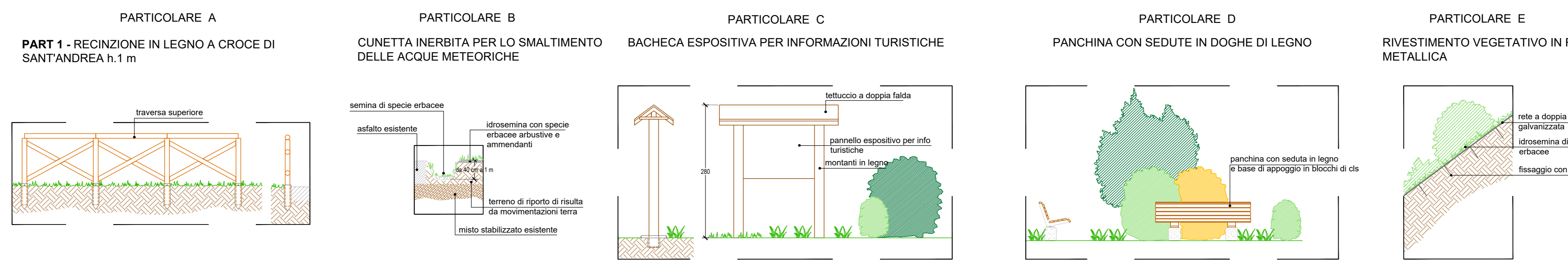

Sanas
GRUPPO FS ITALIANE

Direzione Progettazione e Realizzazione Lavori

ITINERARIO RAGUSA-CATANIA
Collegamento viario compreso tra lo Svincolo della S.S. 514 "di Chiaromonte" con la S.S. 115 e lo Svincolo della S.S. 194 "Ragusana"
LOTTO 1 - Dallo svincolo n. 1 sulla S.S. 115 (compreso) allo svincolo n. 3 sulla S.P. 5 (escluso)

PROGETTO ESECUTIVO COD. PA895

PROGETTAZIONE: ATTI SINTAGMA - GP INGEGNERIA - COOPROGETTI-GDG-ICARIA - OMNISERVICE

PROGETTISTA RESPONSABILE DELL'INTEGRAZIONE DELLE PRESTAZIONI: **intagma**

SPECIALISTICHE: **CEP** **ICARIA** **OMNISERVICE**

IL COORDINATORE PER LA SICUREZZA IN FASE DI PROGETTAZIONE: **ICARIA**

IL RESPONSABILE DI PROGETTO: **ICARIA**

AMBIENTE E PIANO DI UTILIZZO
INTERVENTI D'INSERIMENTO PAESAGGISTICO - AMBIENTALE
Interventi di rinaturalizzazione della viabilità esistente, greenways e nuova viabilità

CODICE PROGETTO: **L0408Z E 2101** NOVE FILE: **7074654857024** REVISIONE: **A** SCALA: **Varie**

PRODOTTO	LIV. MOD.	N. MOD.	CODICE ELAB.	T011A05AMBST02
D				
C				
B				
A	EMISSIONE	GRUPPO 2021	A. Di Stefano	E.A.E. Di Stefano
REV.	DESCRIZIONE	DATA	REDATTO	VERIFICATO