

Spalla Sp2
Pianta spiccato
Scala 1:50

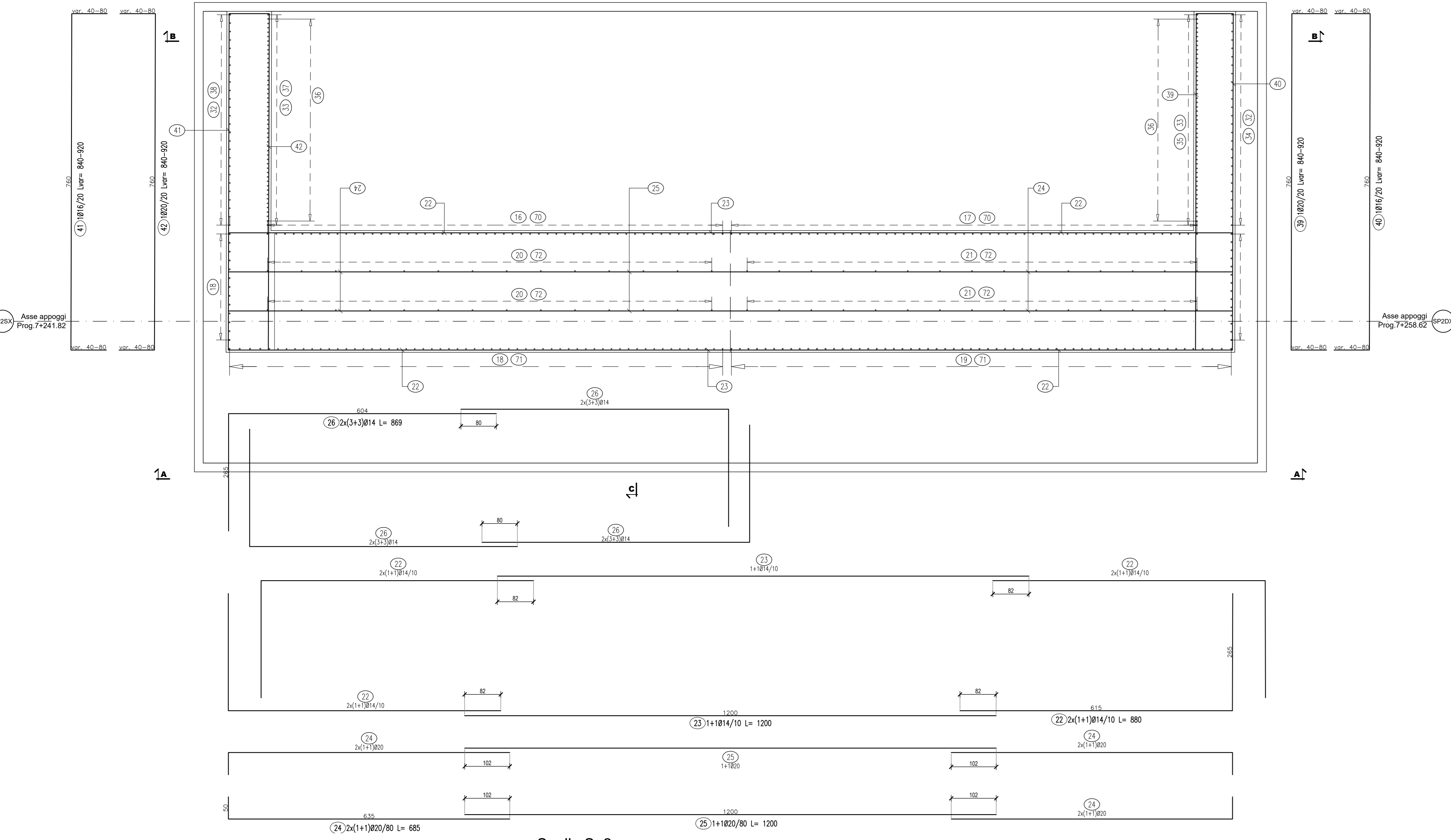

Spalla Sp2
Vista A-A
Scala 1:50

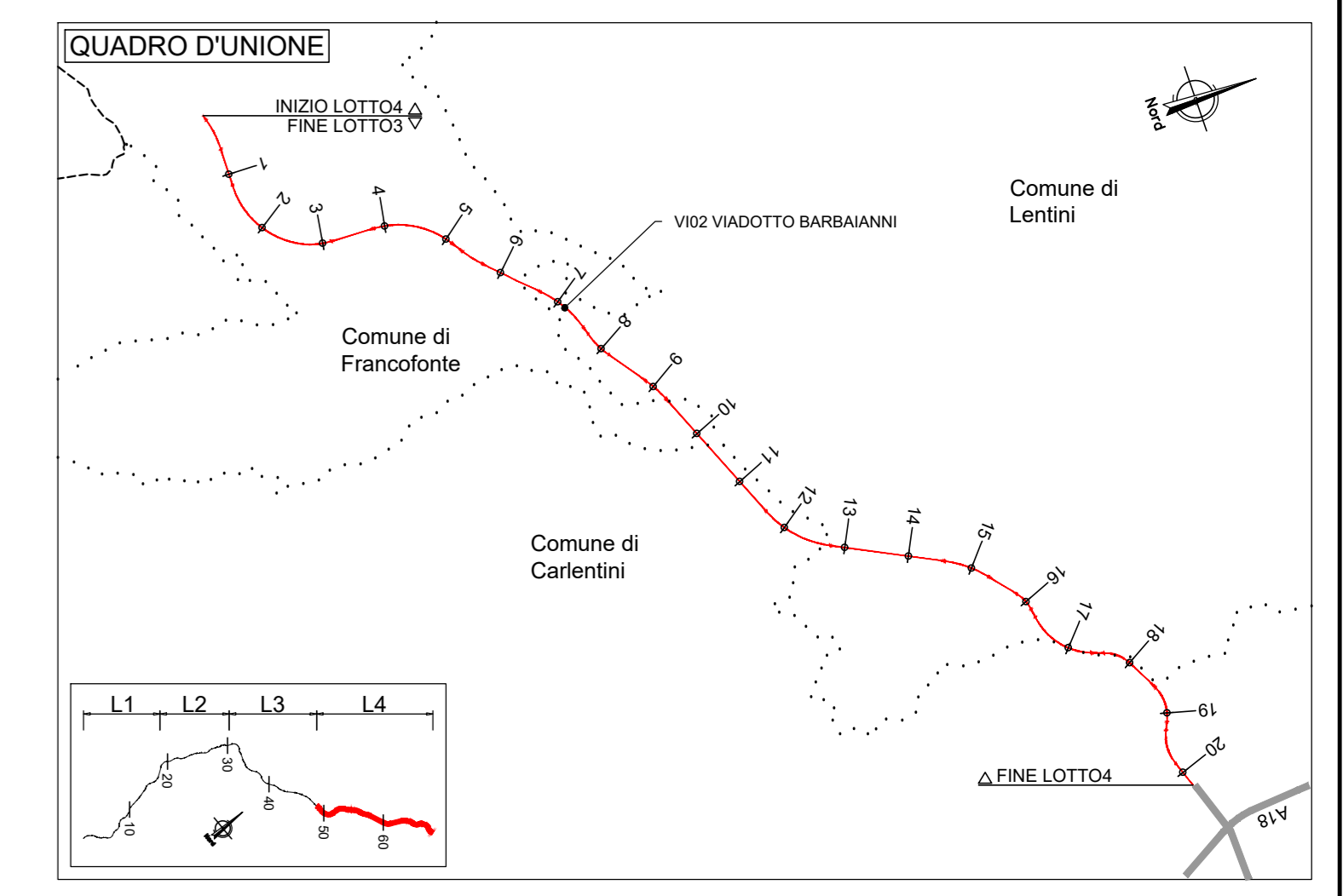
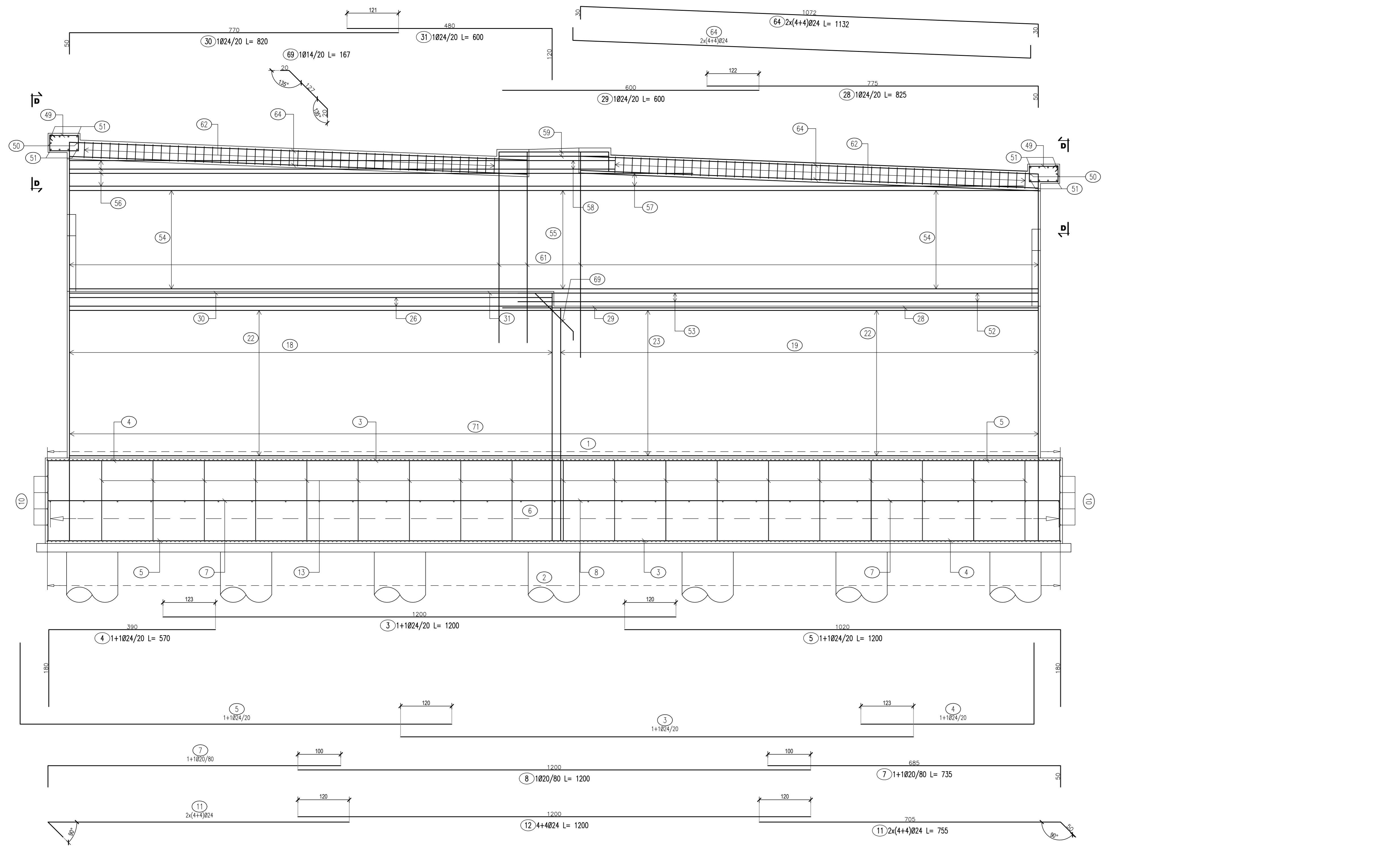

Pos.	Dia #	Ferri	Totale Ferri	Lung(cm)	kg/m	Sagomatura	Tot. Kg	
1	24	1	239	1107	3.551	[Diagram]	9395.0	
2	24	1	239	1107	3.551	[Diagram]	9395.0	
3	24	1+1	104	1200	3.551	[Diagram]	4431.6	
4	24	1+1	104	570	3.551	[Diagram]	2105.0	
5	24	1+1	104	1200	3.551	[Diagram]	4431.6	
6	20	1	31	1107	2.466	[Diagram]	846.3	
7	20	1+1	28	735	2.466	[Diagram]	507.5	
8	20	1	14	1200	2.466	[Diagram]	414.3	
9	24	1+1	478	292	3.551	[Diagram]	4956.3	
10	24	4+4	8	1107	3.551	[Diagram]	314.5	
11	24	2x(4+4)	16	755	3.551	[Diagram]	429.0	
12	24	4+4	8	1200	3.551	[Diagram]	340.9	
13	20	1	168	550	2.466	[Diagram]	2278.6	
14	20	1+1	32	500	2.466	[Diagram]	394.6	
15	20	1+1	80	574	2.466	[Diagram]	1132.4	
16	24	1	54	434	3.551	[Diagram]	832.2	
17	24	1	54	399	3.551	[Diagram]	765.1	
18	24	1	71	434	3.551	[Diagram]	1094.2	
19	24	1	71	381	3.551	[Diagram]	960.6	
20	20	1+1	28	434	2.466	[Diagram]	299.7	
21	20	1+1	28	399	2.466	[Diagram]	275.5	
22	14	2x(1+1)	148	880	1.208	[Diagram]	1573.3	
23	14	1+1	74	1200	1.208	[Diagram]	1072.7	
24	20	2x(1+1)	22	685	2.466	[Diagram]	371.6	
25	20	1+1	11	1200	2.466	[Diagram]	325.5	
26	14	2x(3+3)	12	869	1.208	[Diagram]	126.0	
27	24	1	115	462	3.551	[Diagram]	1886.6	
28	24	1	18	825	3.551	[Diagram]	527.3	
29	24	1	18	600	3.551	[Diagram]	383.5	
30	24	1	18	820	3.551	[Diagram]	524.1	
31	24	1	18	600	3.551	[Diagram]	383.5	
32	20	1+1	52	345	2.466	[Diagram]	442.4	
33	20	1+1	52	345	2.466	[Diagram]	442.4	
34	20	1	26	Var.699-696	2.466	[Diagram]	447.2	
35	20	1	26	Var.747-744	2.466	[Diagram]	478.0	
36	20	1+1	52	595	2.466	[Diagram]	783.0	
37	20	1	26	Var.819-816	2.466	[Diagram]	524.1	
38	20	1	26	Var.775-772	2.466	[Diagram]	495.9	
39	20	1	19	Var.840-920	2.466	[Diagram]	412.3	
40	16	1	19	Var.840-920	1.578	[Diagram]	263.8	
41	16	1	21	Var.840-920	1.578	[Diagram]	291.6	
42	20	1	21	Var.840-920	2.466	[Diagram]	455.7	
43	16	1	14	Var.575-625	1.578	[Diagram]	132.6	
44	20	1	14	Var.575-625	2.466	[Diagram]	207.1	
45	20	1	16	Var.575-625	2.466	[Diagram]	236.7	
46	16	1	16	Var.575-625	1.578	[Diagram]	151.5	
47	12	1	529	299	0.888	[Diagram]	1404.6	
48	10	1	361	Var.55-124	0.617	[Diagram]	199.3	
49	16	1+1	60	252	1.578	[Diagram]	238.6	
50	24	2+2	4	700	3.551	[Diagram]	99.4	
51	24	2x(4+4)	16	632	3.551	[Diagram]	359.1	
52	14	3+3	6	745	1.208	[Diagram]	54.0	
53	14	3+3	6	600	1.208	[Diagram]	43.5	
54	14	2x(1+1)	96	665	1.208	[Diagram]	771.2	
55	14	1+1	48	1200	1.208	[Diagram]	695.8	
56	14	7+7	14	1200	1.208	[Diagram]	202.9	
57	14	4+4	8	Var.390-1160	1.208	[Diagram]	74.9	
58	14	3+3	6	205	1.208	[Diagram]	14.9	
59	14	2+2	4	356	1.208	[Diagram]	17.2	
60	24	1	115	Var.475-525	3.551	[Diagram]	2041.8	
61	24	1	115	Var.475-525	3.551	[Diagram]	2041.8	
62	20	1	99	280	2.466	[Diagram]	683.6	
63	10	1	413	84	0.617	[Diagram]	214.0	
64	24	2x(4+4)	16	1132	3.551	[Diagram]	643.2	
65	14	2+2	4	541	1.208	[Diagram]	26.1	
66	14	2x(1+1)	32	275	1.208	[Diagram]	106.3	
67	14	2x(1+1)	48	270	1.208	[Diagram]	156.6	
68	8	9	68	44	0.394	[Diagram]	11.8	
69	14	1	115	167	1.208	[Diagram]	232.0	
70	24	1	108	361	3.551	[Diagram]	1384.5	
71	24	1	142	361	3.551	[Diagram]	1820.3	
72	20	1+1	56	341	2.466	[Diagram]	470.9	
TOTALE PESO							Kg	72526.8

NOTE:
1) Per la tabella materiali fare riferimento all'appendice T04/05/06/07/08/09/10/11/12/13/14/15/16/17/18/19/20/21/22/23/24/25/26/27/28/29/30/31/32/33/34/35/36/37/38/39/40/41/42/43/44/45/46/47/48/49/50/51/52/53/54/55/56/57/58/59/60/61/62/63/64/65/66/67/68/69/70/71/72/73/74/75/76/77/78/79/80/81/82/83/84/85/86/87/88/89/90/91/92/93/94/95/96/97/98/99/100/101/102/103/104/105/106/107/108/109/110/111/112/113/114/115/116/117/118/119/120/121/122/123/124/125/126/127/128/129/130/131/132/133/134/135/136/137/138/139/140/141/142/143/144/145/146/147/148/149/150/151/152/153/154/155/156/157/158/159/160/161/162/163/164/165/166/167/168/169/170/171/172/173/174/175/176/177/178/179/180/181/182/183/184/185/186/187/188/189/190/191/192/193/194/195/196/197/198/199/200/201/202/203/204/205/206/207/208/209/210/211/212/213/214/215/216/217/218/219/220/221/222/223/224/225/226/227/228/229/230/231/232/233/234/235/236/237/238/239/240/241/242/243/244/245/246/247/248/249/250/251/252/253/254/255/256/257/258/259/260/261/262/263/264/265/266/267/268/269/270/271/272/273/274/275/276/277/278/279/280/281/282/283/284/285/286/287/288/289/290/291/292/293/294/295/296/297/298/299/300/301/302/303/304/305/306/307/308/309/310/311/312/313/314/315/316/317/318/319/320/321/322/323/324/325/326/327/328/329/330/331/332/333/334/335/336/337/338/339/340/341/342/343/344/345/346/347/348/349/350/351/352/353/354/355/356/357/358/359/360/361/362/363/364/365/366/367/368/369/370/371/372/373/374/375/376/377/378/379/380/381/382/383/384/385/386/387/388/389/390/391/392/393/394/395/396/397/398/399/400/401/402/403/404/405/406/407/408/409/410/411/412/413/414/415/416/417/418/419/420/421/422/423/424/425/426/427/428/429/430/431/432/433/434/435/436/437/438/439/440/441/442/443/444/445/446/447/448/449/450/451/452/453/454/455/456/457/458/459/460/461/462/463/464/465/466/467/468/469/470/471/472/473/474/475/476/477/478/479/480/481/482/483/484/485/486/487/488/489/490/491/492/493/494/495/496/497/498/499/500/501/502/503/504/505/506/507/508/509/510/511/512/513/514/515/516/517/518/519/520/521/522/523/524/525/526/527/528/529/530/531/532/533/534/535/536/537/538/539/540/541/542/543/544/545/546/547/548/549/550/551/552/553/554/555/556/557/558/559/560/561/562/563/564/565/566/567/568/569/570/571/572/573/574/575/576/577/578/579/580/581/582/583/584/585/586/587/588/589/590/591/592/593/594/595/596/597/598/599/600/601/602/603/604/605/606/607/608/609/610/611/612/613/614/615/616/617/618/619/620/621/622/623/624/625/626/627/628/629/630/631/632/633/634/635/636/637/638/639/640/641/642/643/644/645/646/647/648/649/650/651/652/653/654/655/656/657/658/659/660/661/662/663/664/665/666/667/668/669/670/671/672/673/674/675/676/677/678/679/680/681/682/683/684/685/686/687/688/689/690/691/692/693/694/695/696/697/698/699/700/701/702/703/704/705/706/707/708/709/710/711/712/713/714/715/716/717/718/719/720/721/722/723/724/725/726/727/728/729/730/731/732/733/734/735/736/737/738/739/740/741/742/743/744/745/746/747/748/749/750/751/752/753/754/755/756/757/758/759/760/761/762/763/764/765/766/767/768/769/770/771/772/773/774/775/776/777/778/779/780/781/782/783/784/785/786/787/788/789/790/791/792/793/794/795/796/797/798/799/800/801/802/803/804/805/806/807/808/809/810/811/812/813/814/815/816/817/818/819/820/821/822/823/824/825/826/827/828/829/830/831/832/833/834/835/836/837/838/839/840/841/842/843/844/845/846/847/848/849/850/851/852/853/854/855/856/857/858/859/860/861/862/863/864/865/866/867/868/869/870/871/872/873/874/875/876/877/878/879/880/881/882/883/884/885/886/887/888/889/890/891/892/893/894/895/896/897/898/899/900/901/902/903/904/905/906/907/908/909/910/911/912/913/914/915/916/917/918/919/920/921/922/923/924/925/926/927/928/929/930/931/932/933/934/935/936/937/938/939/940/941/942/943/944/945/946/947/948/949/950/951/952/953/954/955/956/957/958/959/960/961/962/963/964/965/966/967/968/969/970/971/972/973/974/975/976/977/978/979/980/981/982/983/984/985/986/987/988/989/990/991/992/993/994/995/996/997/998/999/1000

anas
GRUPPO FS ITALIANE

Direzione Progettazione e Realizzazione Lavori

ITINERARIO RAGUSA-CATANIA
Collegamento viario compreso tra lo Svincolo della S.S. 514 "di Chiaramonte" con la S.S. 115 e lo Svincolo della S.S. 194 "Ragusana"
LOTTO 4 - Dallo svincolo n. 8 "Francoforte" (compreso) allo svincolo della "Ragusana"(escluso)

PROGETTO ESECUTIVO COD. **PA898**

PROGETTISTA RESPONSABILE DELL'INTEGRAZIONE DELLE PRESTAZIONI SPECIALISTICHE:
Dott. Ing. Nando Granieri
Ordine degli Ingegneri della Prov. di Perugia n° A351

IL GRUPPO DI PROGETTAZIONE:
MANDATARIA:
Sintagma
Mandatari:
Dott. Ing. N. Granieri
Dott. Ing. F. Duranti
Dott. Ing. A. Duranti
Dott. Ing. L. Duranti
Mandatari:
Dott. Ing. G. Duranti
Dott. Ing. A. Duranti
Dott. Ing. F. Duranti
Dott. Ing. L. Duranti
Mandatari:
Dott. Ing. G. Duranti
Dott. Ing. A. Duranti
Dott. Ing. F. Duranti
Dott. Ing. L. Duranti
Mandatari:
Dott. Ing. G. Duranti
Dott. Ing. A. Duranti
Dott. Ing. F. Duranti
Dott. Ing. L. Duranti

IL GEOLOGO:
Dott. Geol. Giorgio Carruggini
Ordine dei Geologi della Regione Umbria n° 188

IL COORDINATORE PER LA SICUREZZA IN FASE DI PROGETTAZIONE:
Dott. Ing. Filippo Pambianco
Ordine degli Ingegneri della Provincia di Perugia n° A373

VISTO IL RESPONSABILE DEL PROCEDIMENTO
Dott. Ing. Luigi Mupo

VIADOTTI
VIADOTTO BARBAIANI - CARR. SX
Armatura spalla S2- Tav. 1/2

CODICE PROGETTO: L0408Z E 2101
NOME FILE: 7044022704049
REVISIONE: B
SCALA: 1:50

REV.	DESCRIZIONE	DATA	REDATTO	VERIFICATO	APPROVATO
B	Revisione a seguito di Rapporto di Verifica	Nov 2021	S. Piccoli	F. Duranti	M. Granieri
A	Emissione	Giù 2021	S. Piccoli	F. Duranti	M. Granieri