

**CORRIDOIO PLURIMODALE ADRIATICO
ITINERARIO MAGLIE - SANTA MARIA DI LEUCA**

S.S. N° 275 "DI S. MARIA DI LEUCA"

LAVORI DI AMMODERNAMENTO E ADEGUAMENTO ALLA SEZ. B DEL D.M. 5.11.2001

S.S. 16 dal km 981+700 al km 985+386 - S.S. 275 dal Km 0+000 al km 37+000

1° Lotto: Dal Km 0+000 di prog. al Km 23+300 di prog.

PROGETTO DEFINITIVO

COD. BA283

PROGETTAZIONE: ANAS - STRUTTURA TERRITORIALE PUGLIA

I PROGETTISTI

Ing. Alberto SANCHIRICO - Progettista e Coordinatore

Ing. Simona MASCIULLO - Progettista

COLLABORATORI

Geom. Andrea DELL'ANNA

Geom. Massimo MARTANO

Geom. Giuseppe CALO'

IL COORDINATORE IN FASE DI PROGETTAZIONE

Ing. Alberto SANCHIRICO

IL RESPONSABILE DEL PROCEDIMENTO

Ing. Gianfranco PAGLIALUNGA

RESPONSABILE PROJECT MANAGEMENT E PROGETTI SPECIALI

Ing. Nicola MARZI

IL COMMISSARIO STRAORDINARIO

Ing. Vincenzo MARZI

ESTENSORE SIA



**VARIANTI LOCALIZZATIVE
STUDIO DI IMPATTO AMBIENTALE
Dossier della vegetazione**

CODICE PROGETTO		NOME FILE		REVISIONE	SCALA:
PROGETTO	LIV. PROG.	N. PROG.	T00IA00AMBCT11_A		
L0503A	D	1701	CODICE ELAB. T00IA00AMBCT11	A	1:5000
A	EMISSIONE		Marzo 2022	L. Morra	A. Fernandez S. Airaghi
REV.	DESCRIZIONE		DATA	REDATTO	VERIFICATO APPROVATO

LEGENDA:

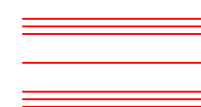

Progetto 2019



Progetto 2005

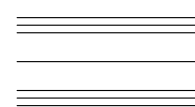

Viabilità esistente a cui si raccordano gli interventi in progetto

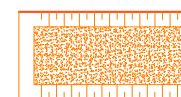

Vasche di smaltimento acque di piattaforma



Vasche di compensazione idraulica

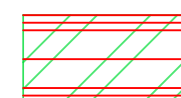















Variante localizzativa

VEGETAZIONE:

-  141, aree verdi urbane
-  223, uliveti
-  243, aree prevalentemente occupate da coltura agrarie con presenza di spazi naturali
-  244, aree agroforestali
-  311, boschi di latifoglie
-  312, boschi di conifere
-  313, boschi misti di conifere e latifoglie
-  314, prati alberati, pascoli alberati
-  321, aree a pascolo naturale, praterie, incolti
-  322, cespuglieti e arbusteti
-  323, aree a vegetazione sclerofilla
-  334, aree interessate da incendi o altri eventi dannosi
-  3241, aree a ricolonizzazione naturale
-  3242, aree a ricolonizzazione artificiale (rimboschimenti nella fase di novelleto)
-  411, paludi interne
-  5112, canali e idrovie
-  5121, bacini senza manifeste utilizzazioni produttive
-  5122, bacini con prevalente utilizzazione per scopi irrigui

Rilievo:

-  Jr Juglans regia
-  Ma Morus alba
-  Aa Aa - Ailanthus altissima
-  Cs Cupressus sempervirens
-  Ec Eucalyptus camaldulensis
-  Ppr Pinus pinaster
-  Pp Pinus pinea
-  Ps Prunus sp.
-  Sa Salix alba
-  Oe Olea europaea
-  Fc Ficus carica
-  Qi Quercus ilex
-  Qs Quercus sp.
-  n.d. Non definito

 Siepe arbustiva

 Filare alberato
 Rp - Robinia pseudoacacia
 Cs - Cupressus sempervirens
 Ec - Eucalyptus camaldulensis
 Ppr - Pinus pinaster
 plur - plurispecifico

 Area boscata

0623E04-BA283 Maglie Leuca

SV1 - SVINCOLO MAGLIE NORD

Scala 1:5000

DOSSIER DELLA VEGETAZIONE

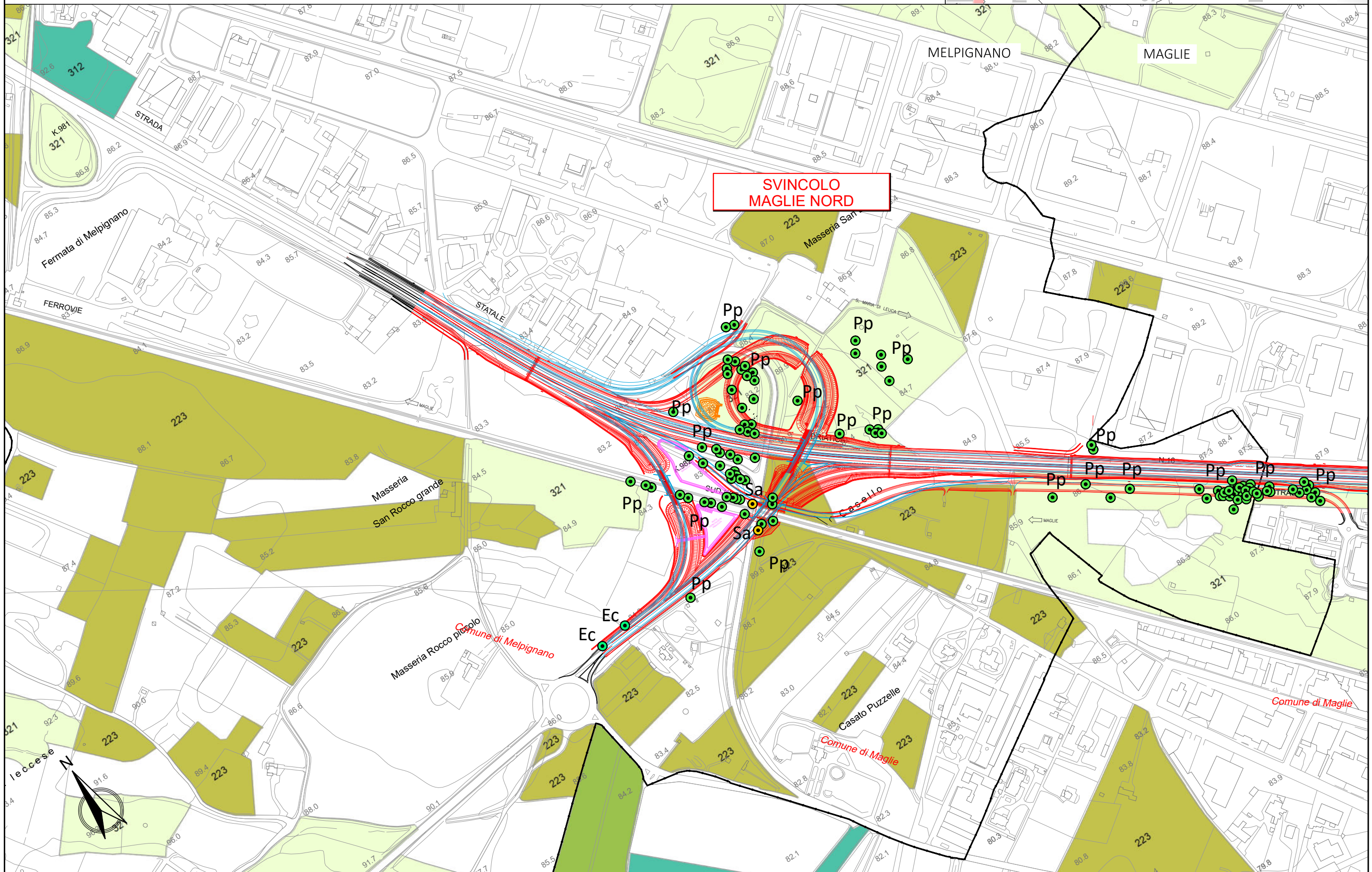
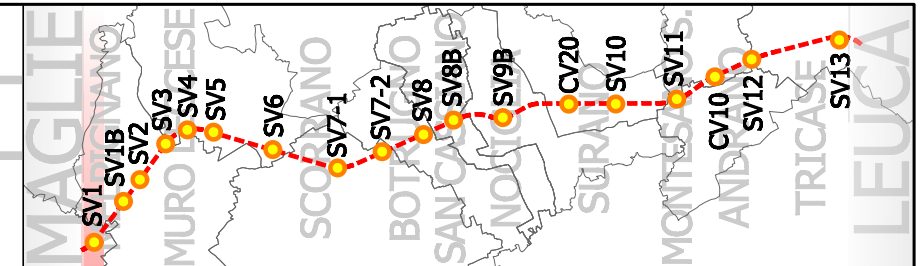

0623E04-BA283 Maglie Leuca

SV4 - SANTA CESAREA TERME

DOSSIER DELLA VEGETAZIONE

Scala 1:5000

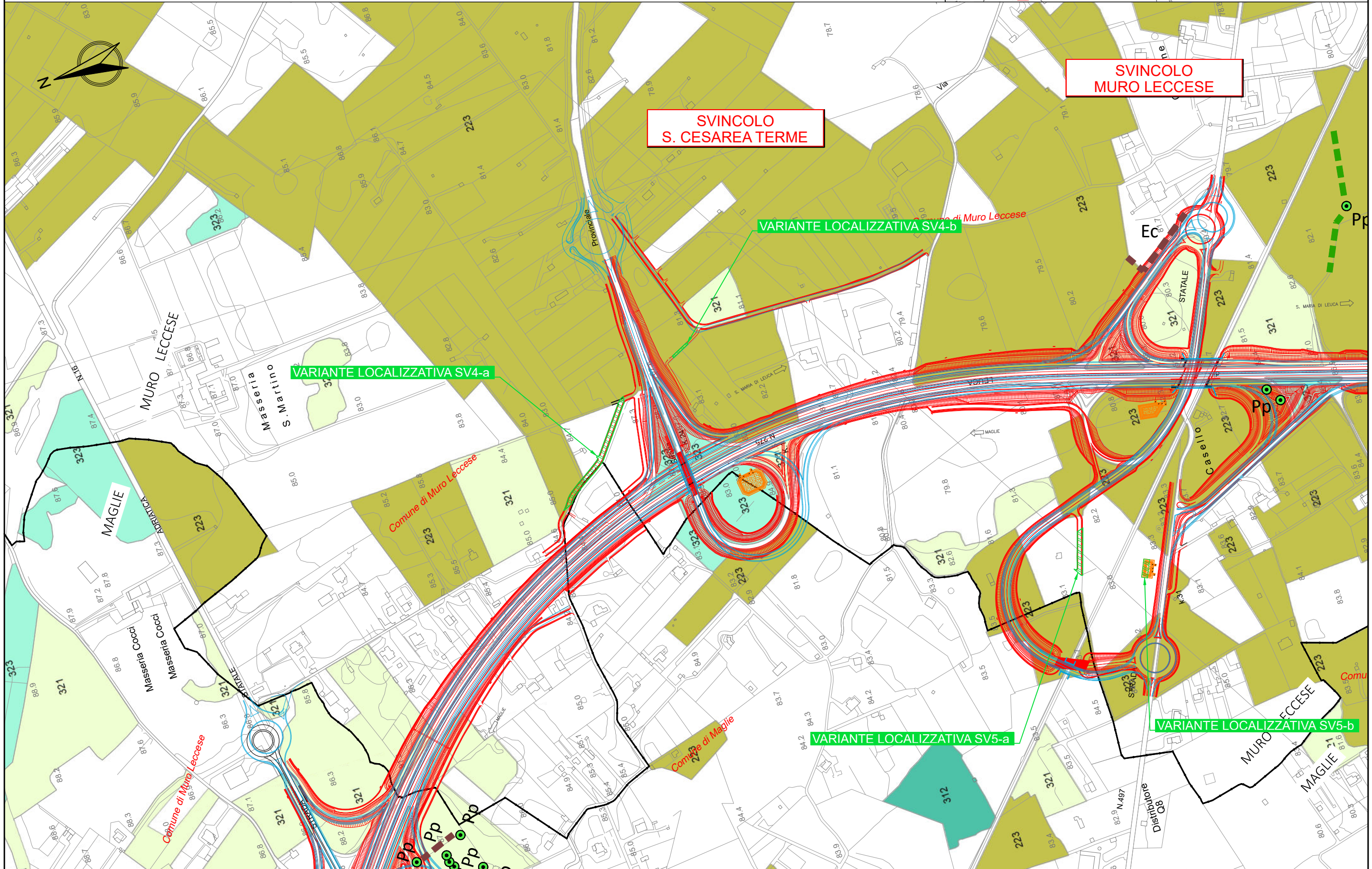
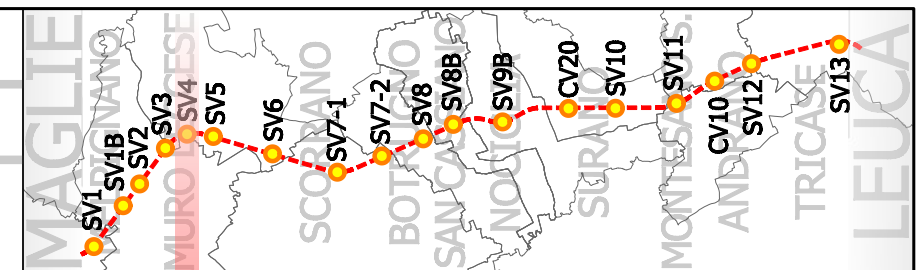

0623E04-BA283 Maglie Leuca

SV5 - MURO LECCESE

Scala 1:5000

DOSSIER DELLA VEGETAZIONE

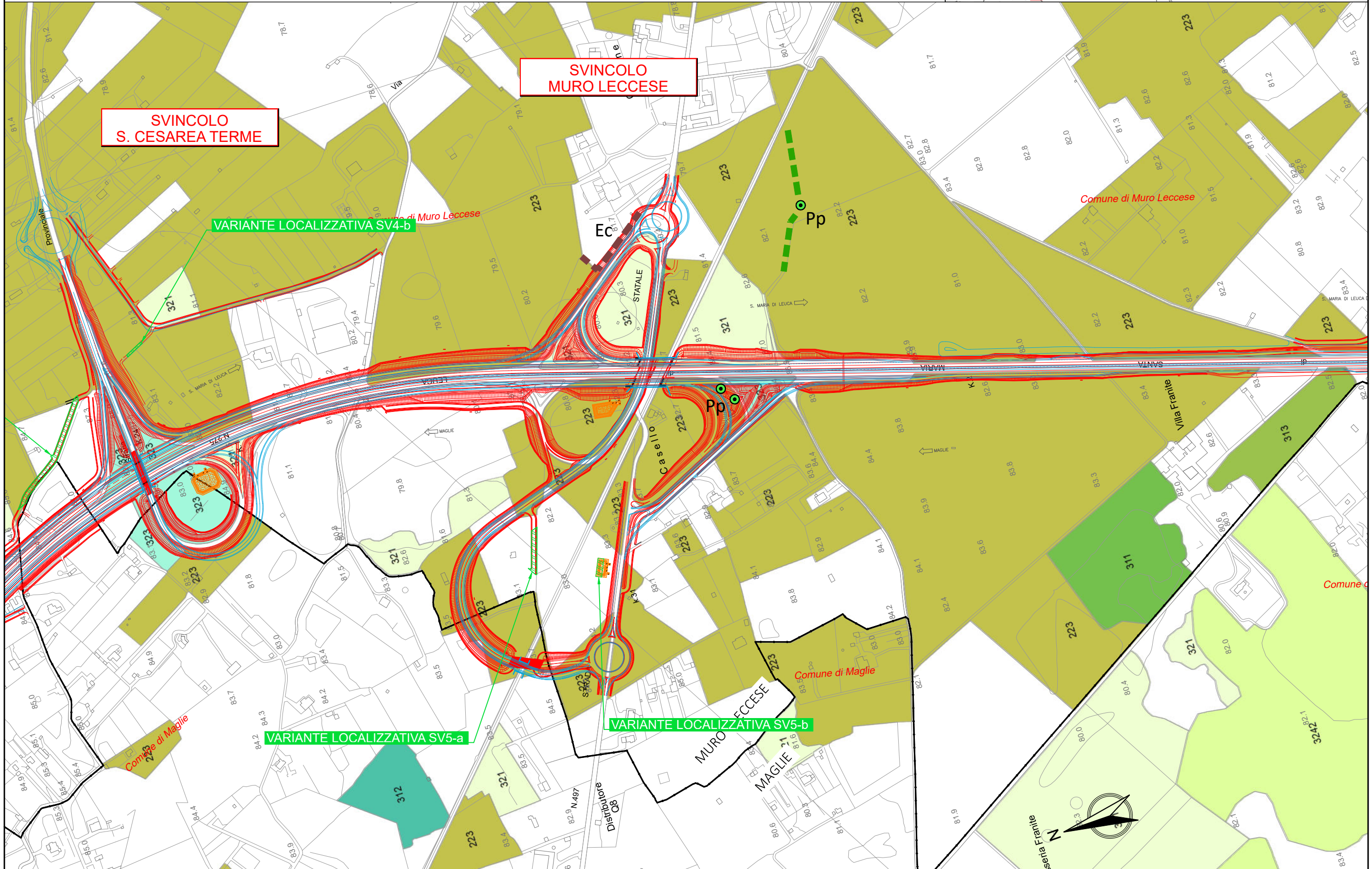
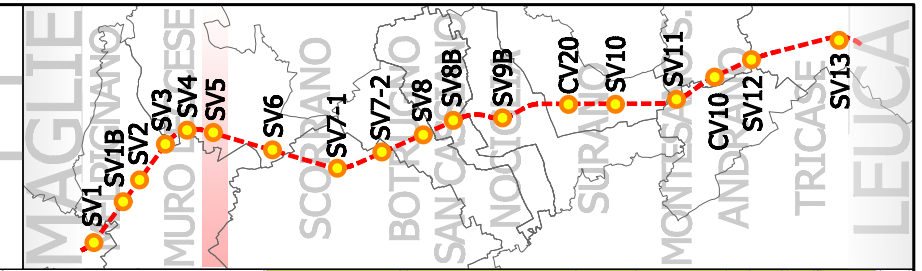

0623E04-BA283 Maglie Leuca

SV6 - SCORRANO

Scala 1:5000

DOSSIER DELLA VEGETAZIONE

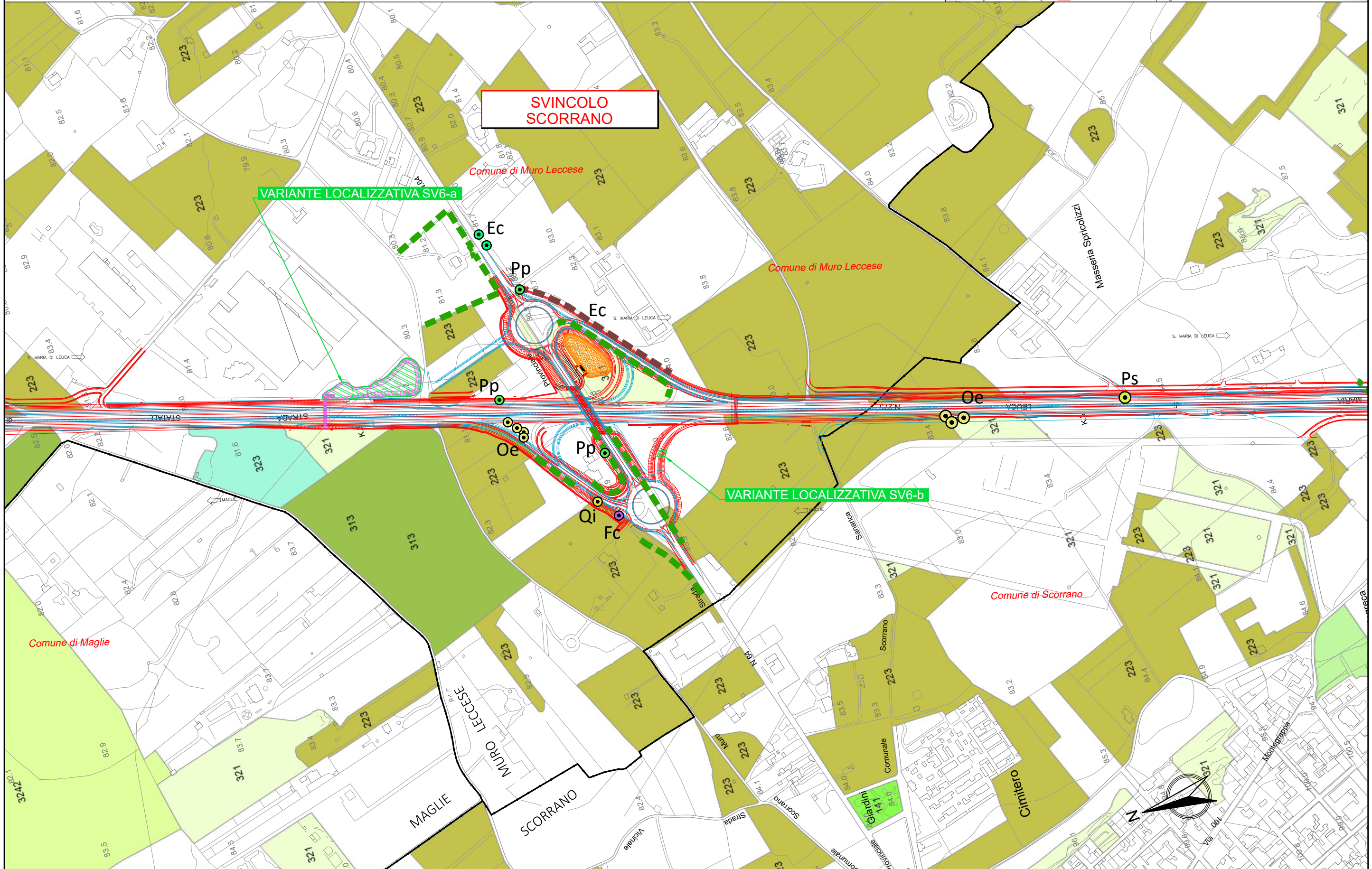
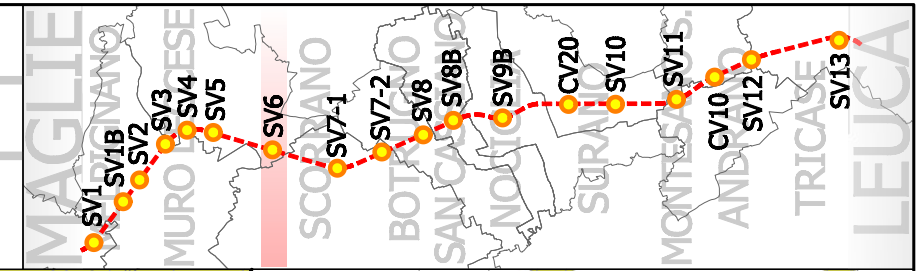

0623E04-BA283 Maglie Leuca

SV7 - 1 - SCORRANO SUD

Scala 1:5000

DOSSIER DELLA VEGETAZIONE

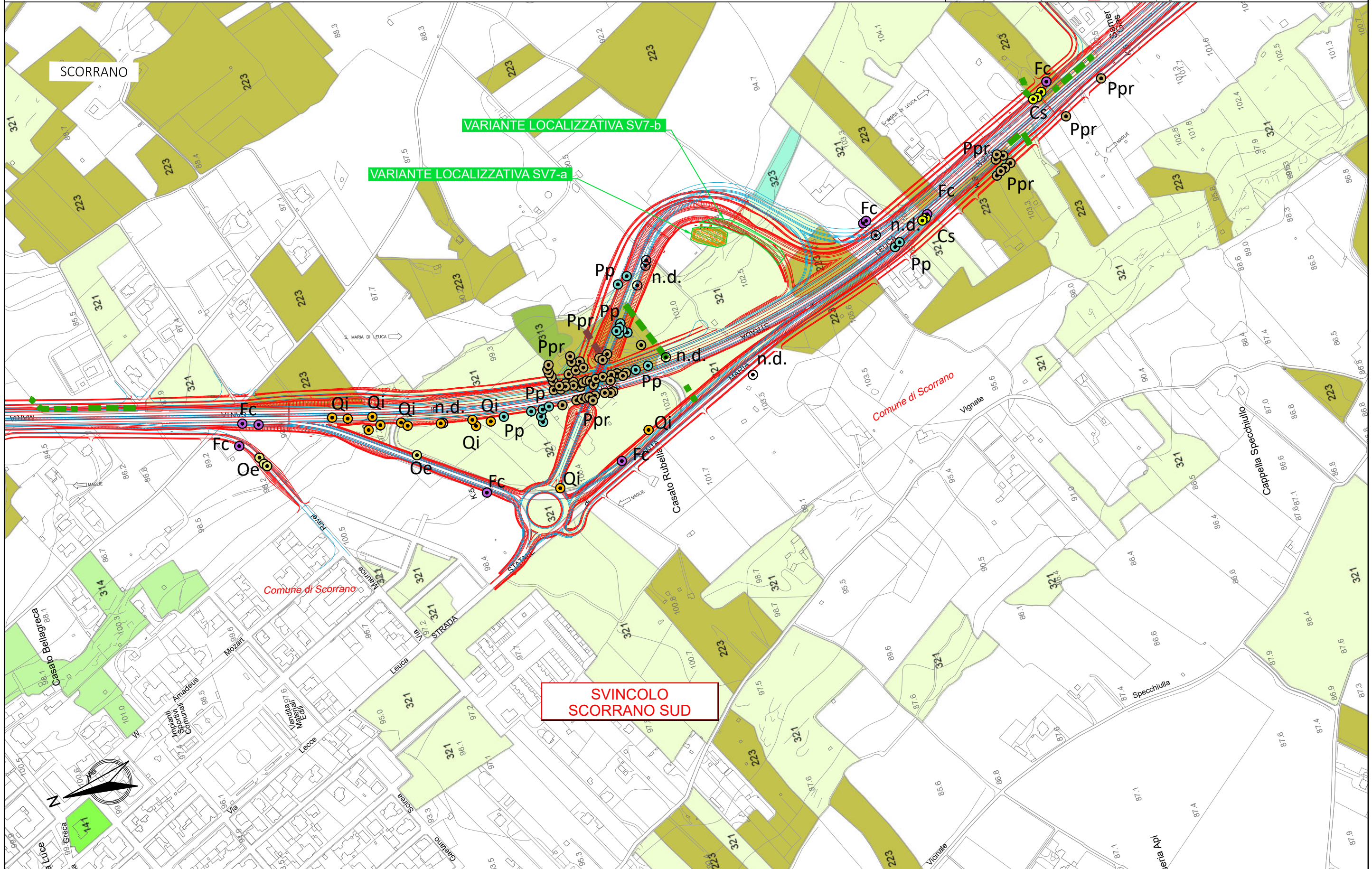
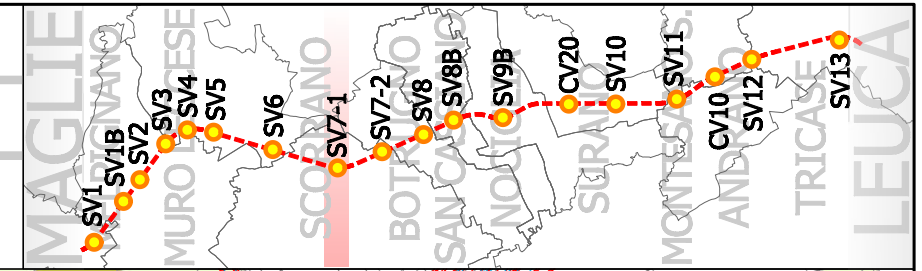

SCORRANO

VARIANTE LOCALIZZATIVA SV7-b

VARIANTE LOCALIZZATIVA SV7-a

SVINCOLO SCORRANO SUD

Comune di Scorrano

Comune di Scorrano

DOSSIER DELLA VEGETAZIONE

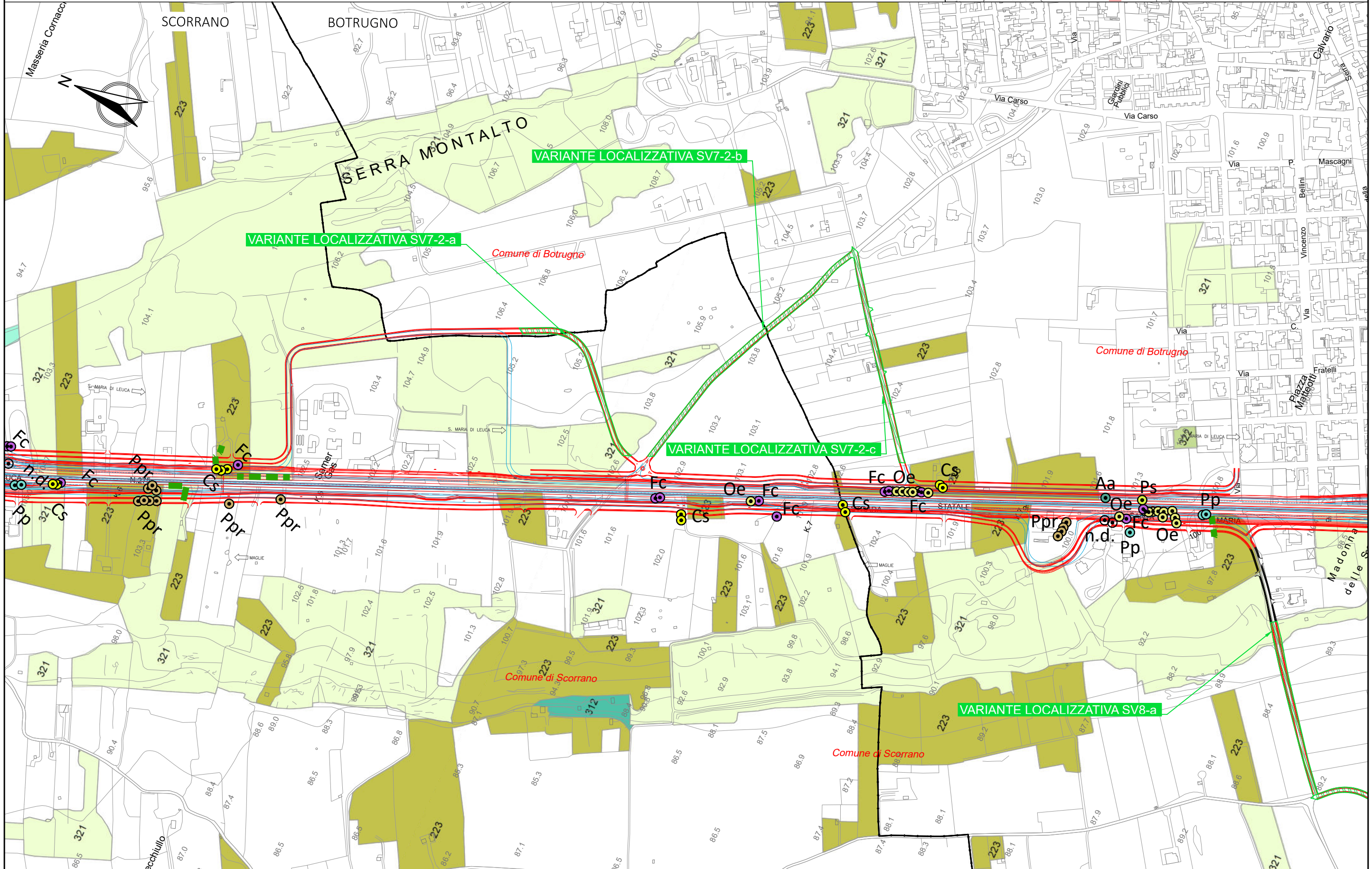
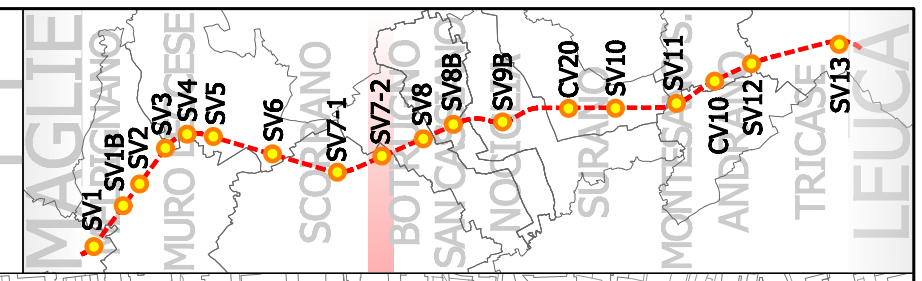

0623E04-BA283 Maglie Leuca

SV8 - BOTRUGNO

Scala 1:5000

DOSSIER DELLA VEGETAZIONE

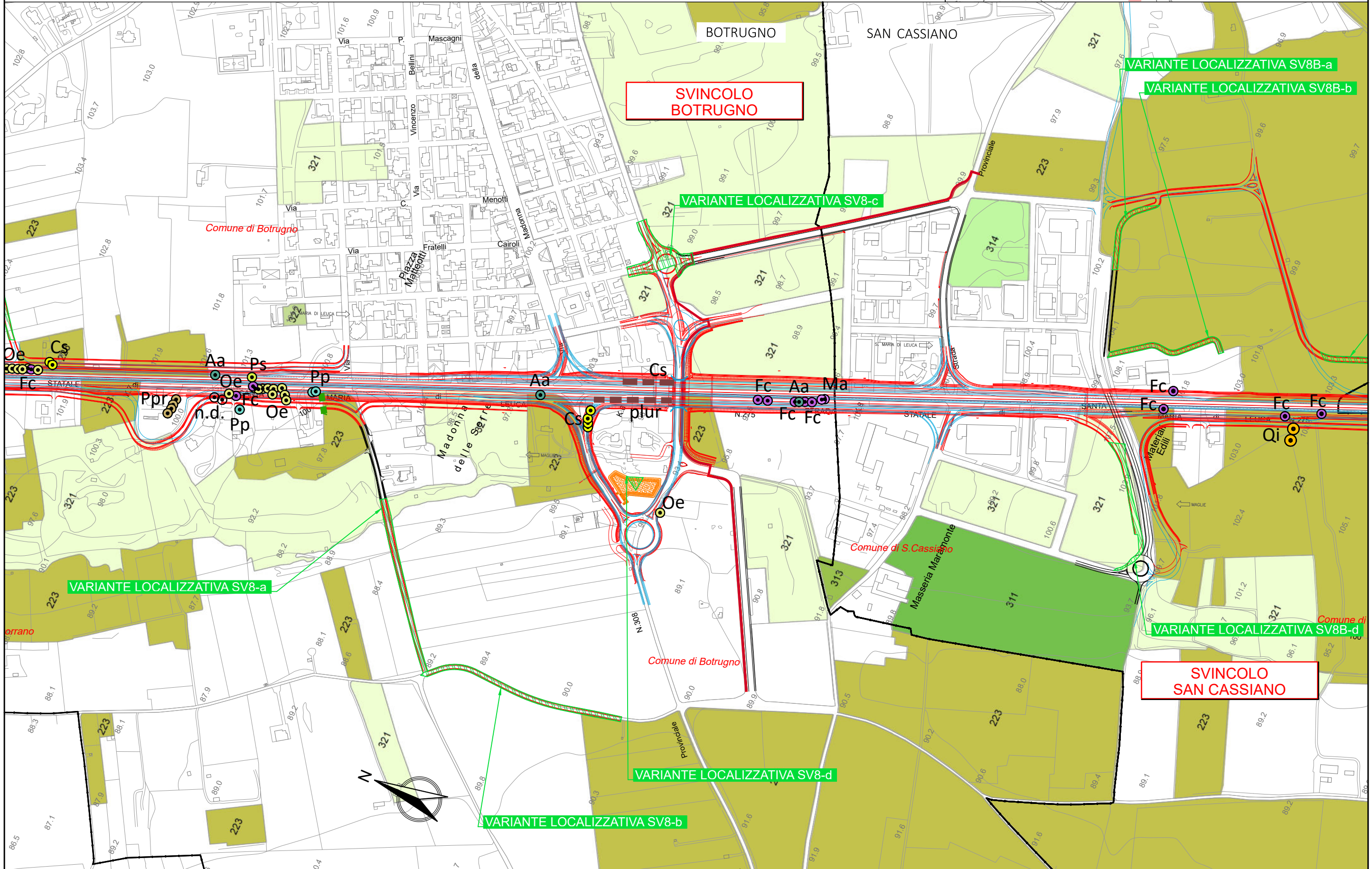
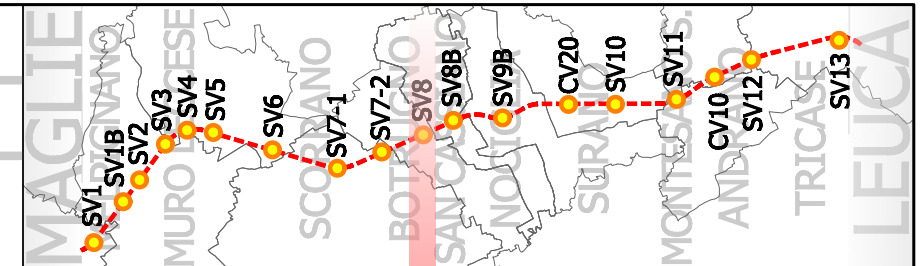

0623E04-BA283 Maglie Leuca

CV20 - SCAVALCO 2

Scala 1:5000

DOSSIER DELLA VEGETAZIONE

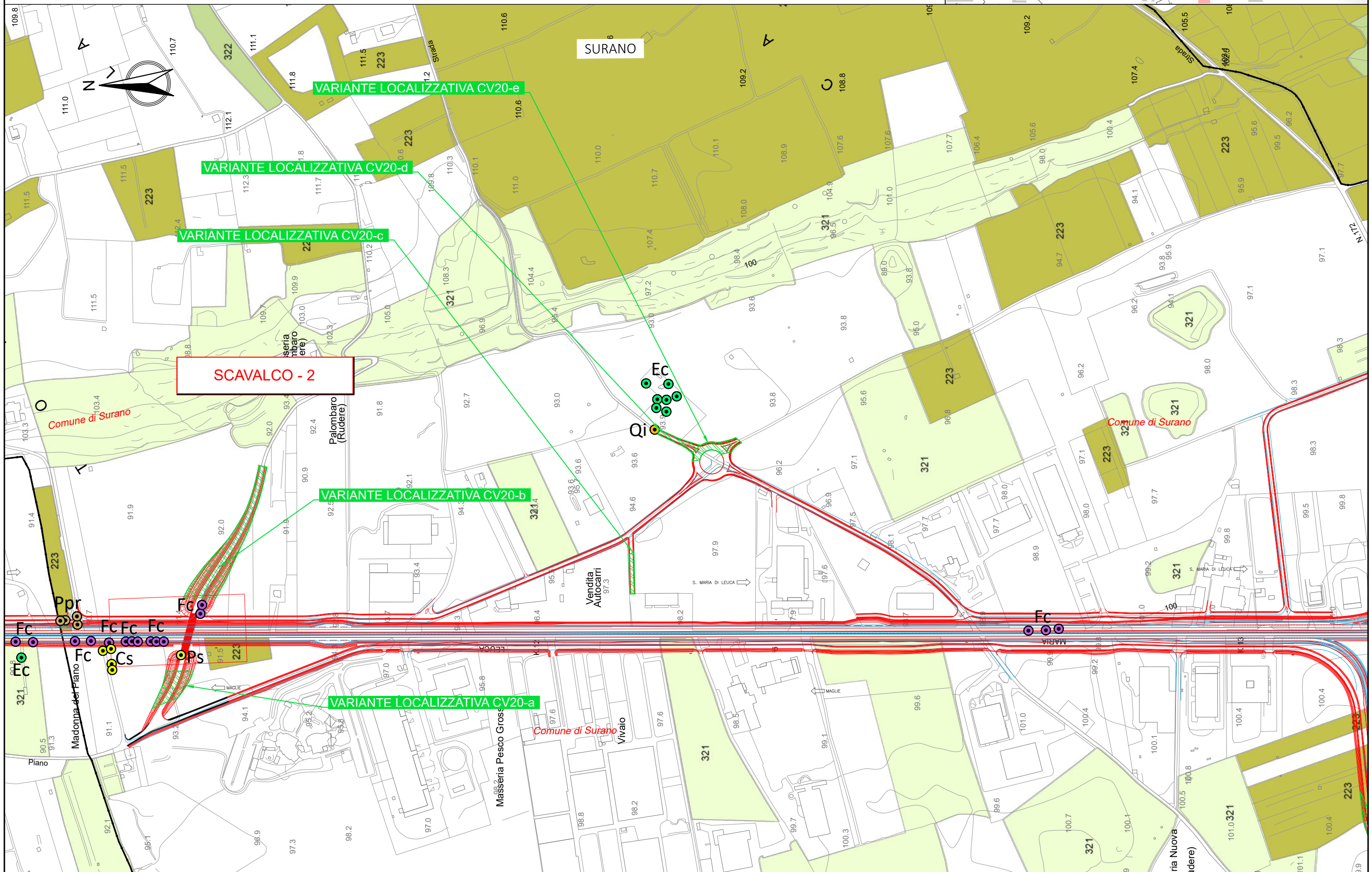
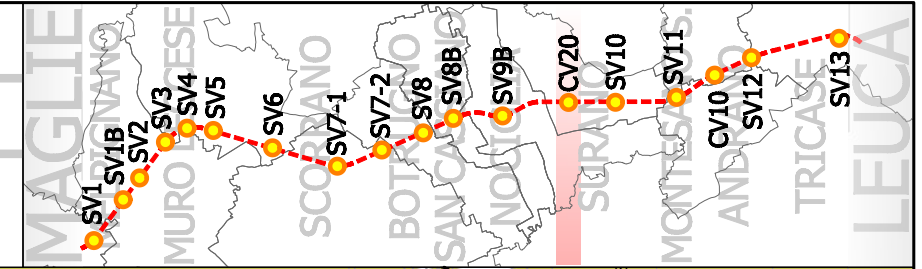

0623E04-BA283 Maglie Leuca

SV10 - SURANO-RUFFANO

Scala 1:5000

DOSSIER DELLA VEGETAZIONE

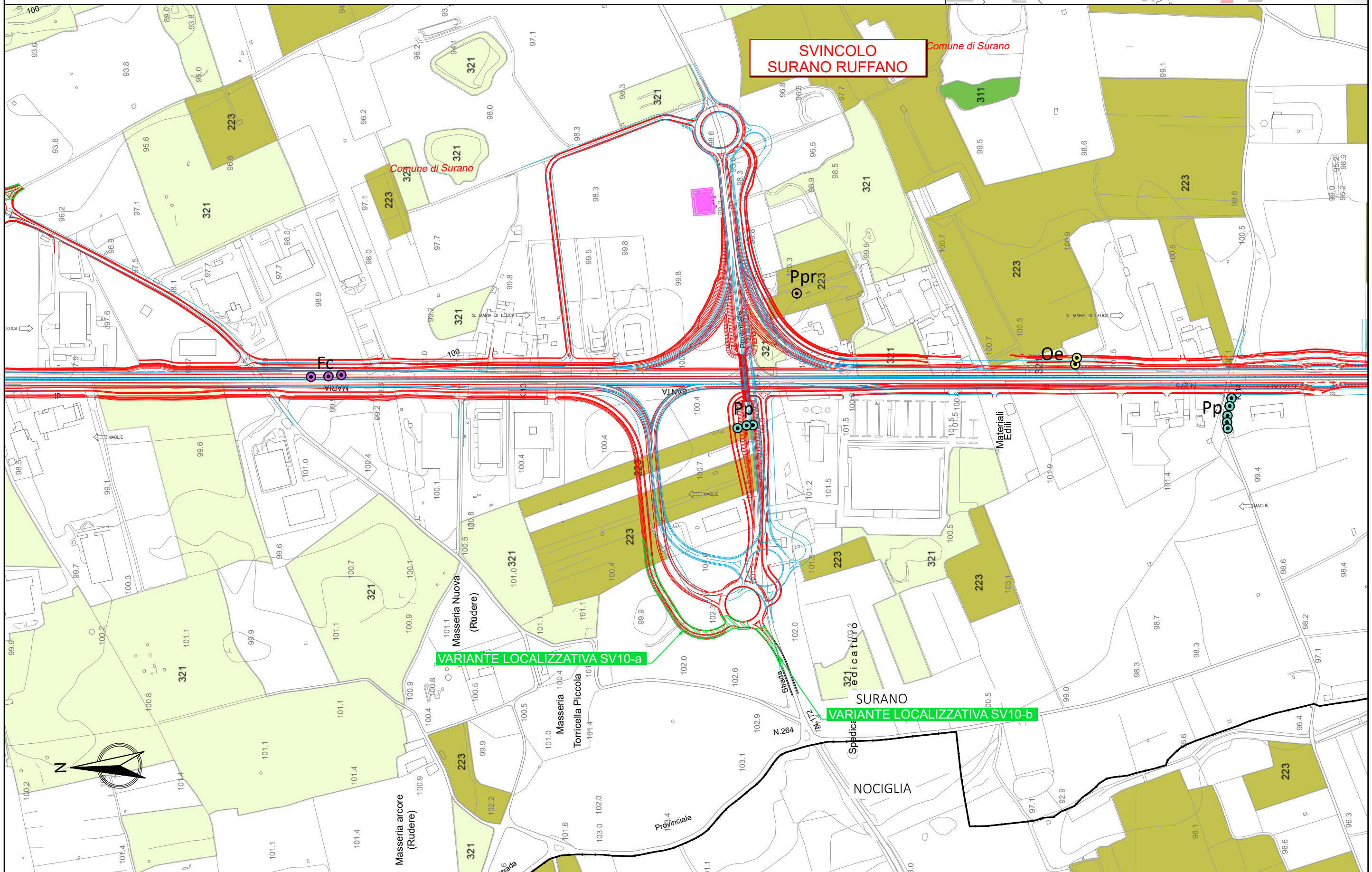
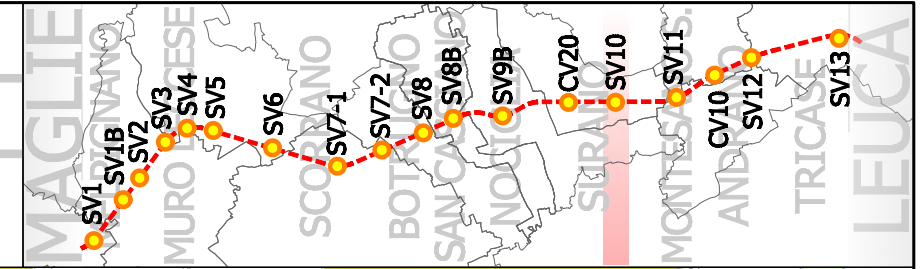

0623E04-BA283 Maglie Leuca

SV11 - MONTESANO NORD

Scala 1:5000

DOSSIER DELLA VEGETAZIONE

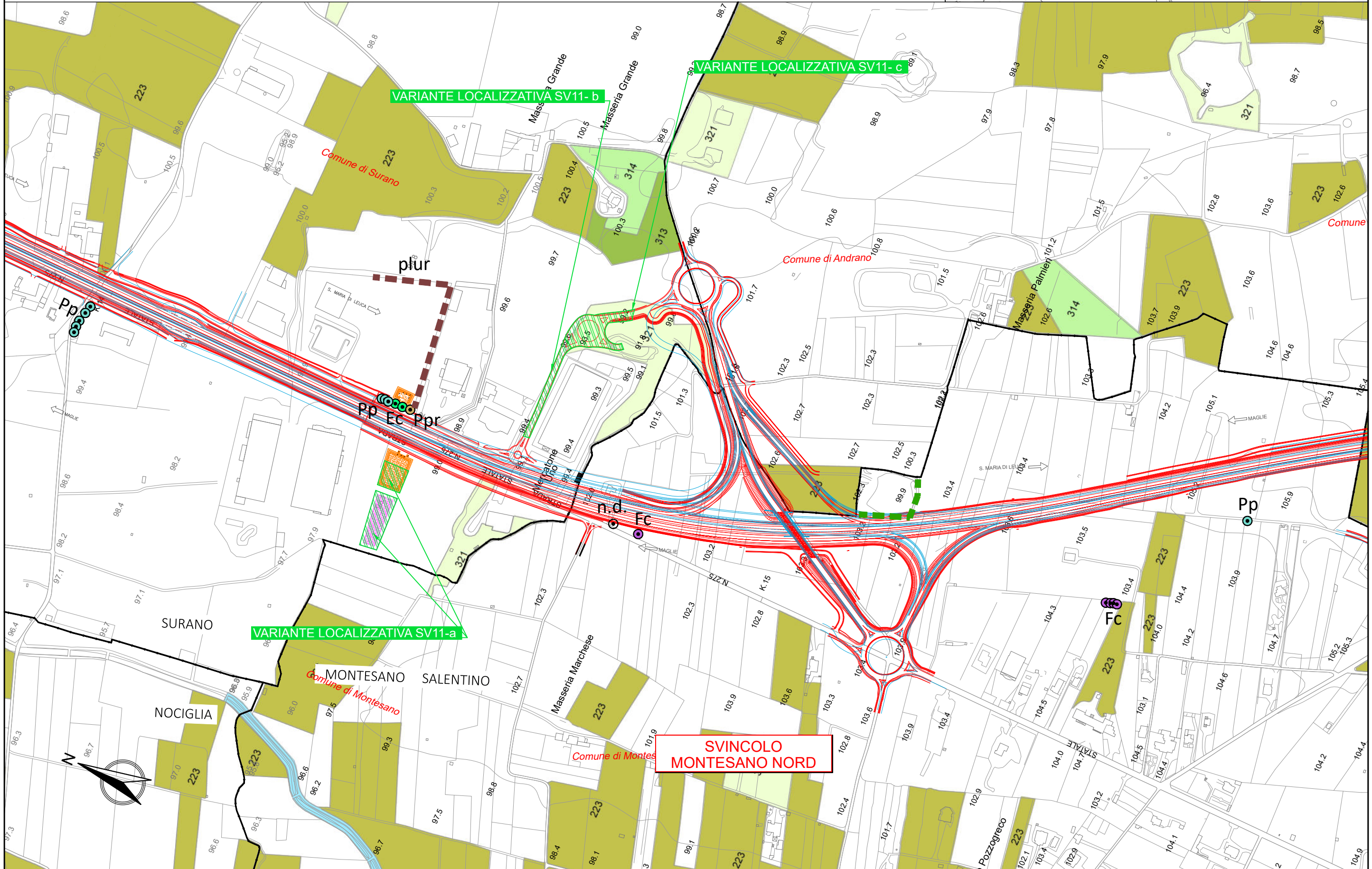
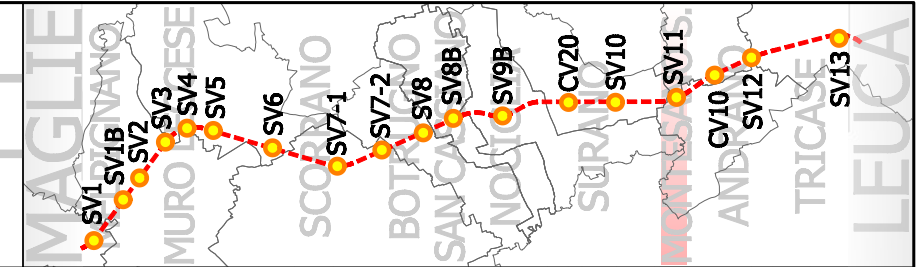

0623E04-BA283 Maglie Leuca

SV12 - MONTESANO-ANDRANO

Scala 1:5000

DOSSIER DELLA VEGETAZIONE

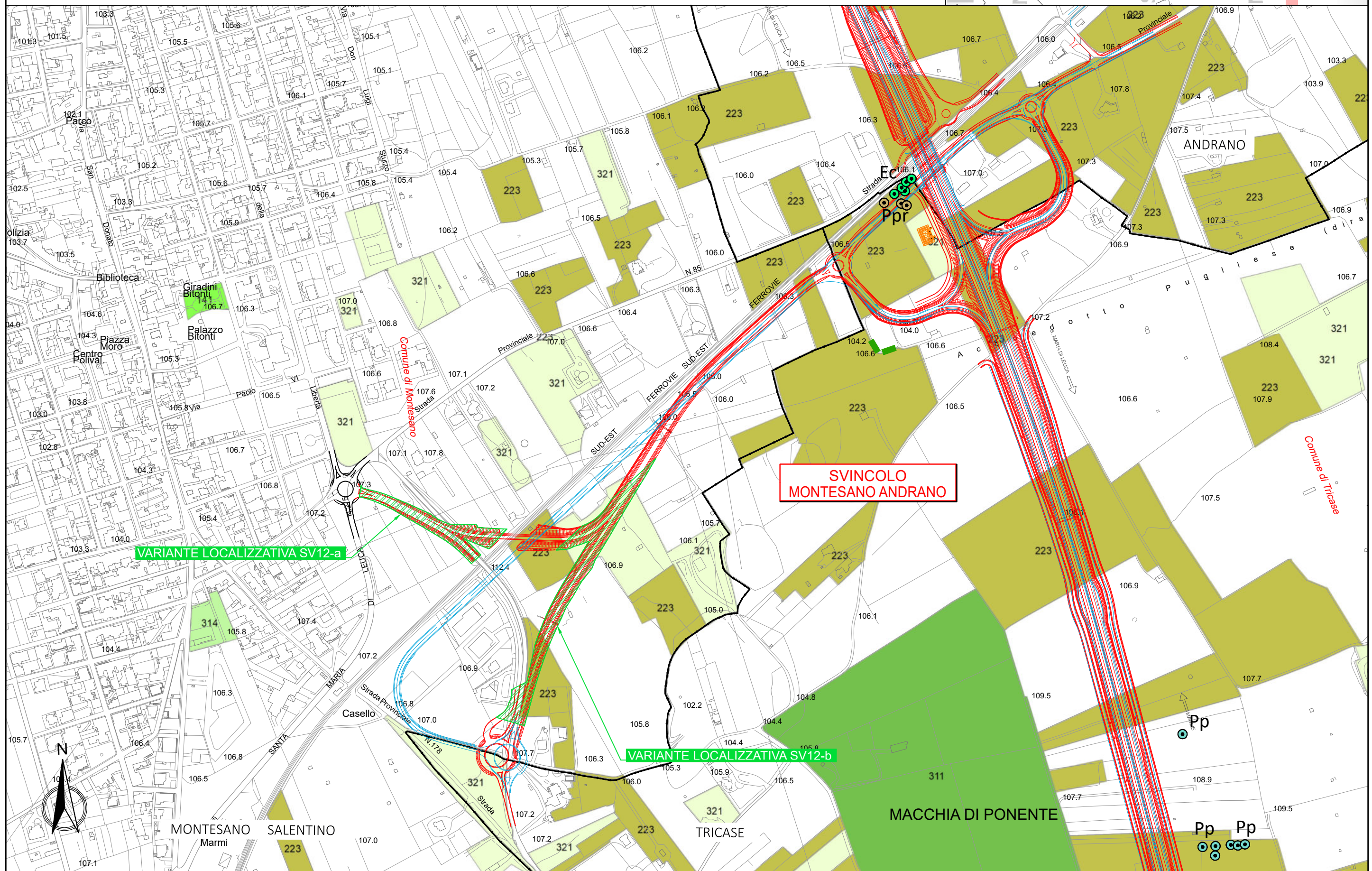
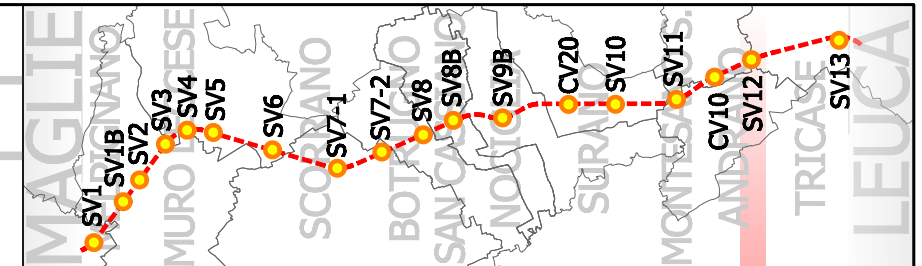

0623E04-BA283 Maglie Leuca

SV13 - TRICASE

Scala 1:5000

DOSSIER DELLA VEGETAZIONE

