

- 1** - Edificio sala macchine TG1 e TG2 (43°22'54.29"N 10°26'59.43"E)
- 2** - Area torri di raffreddamento (43°22'50.47"N 10°26'58.93"E)
- 3** - Sala pompe (zona interboiler) (43°22'55.73"N 10°26'57.99"E)
- 4a** - Camino gruppo 1 (43°22'56.28"N 10°26'56.58"E)
- 4b** - Camino gruppo 2 (43°22'57.06"N 10°26'57.72"E)
- 5a** - GVR1 (43°22'55.64"N 10°26'57.47"E)
- 5b** - GVR2 (43°22'55.94"N 10°26'58.50"E)
- 6** - Sala macchine TV (43°22'53.57"N 10°26'57.67"E)

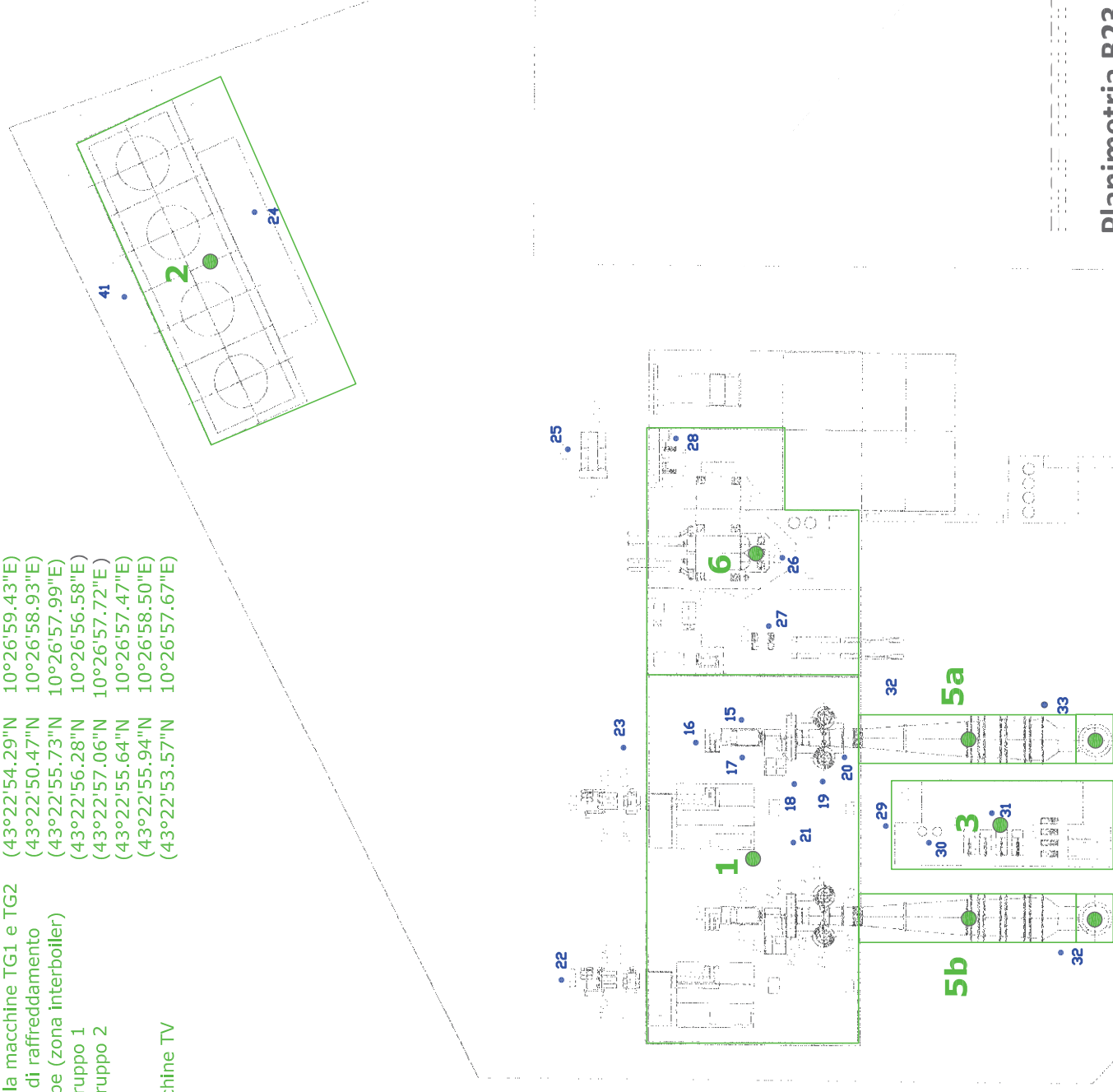

Planimetria B23 - foglio B

Ubicazione delle Sorgenti Sonore
all'interno della Centrale – quota 0.00

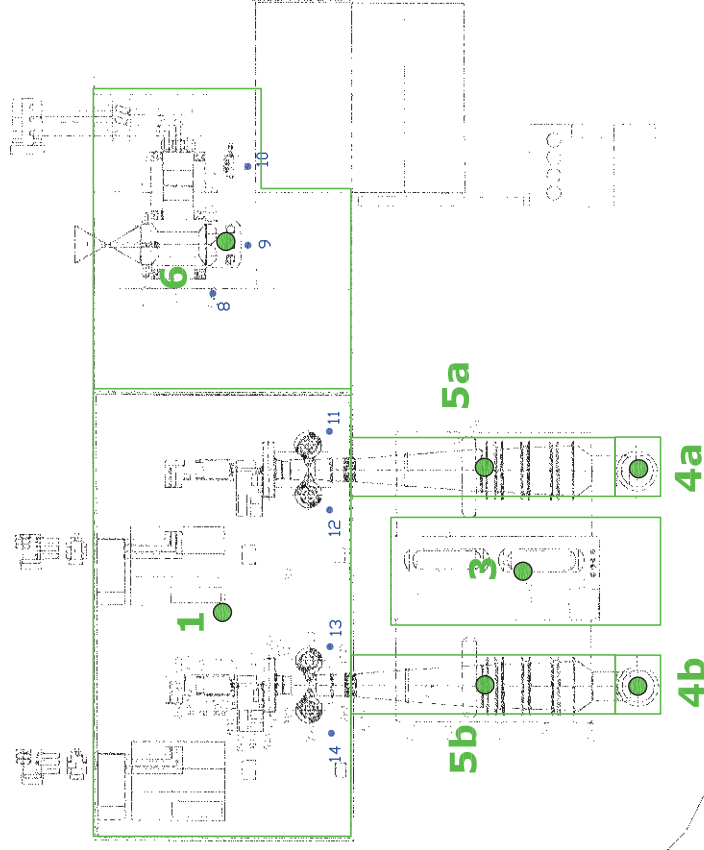
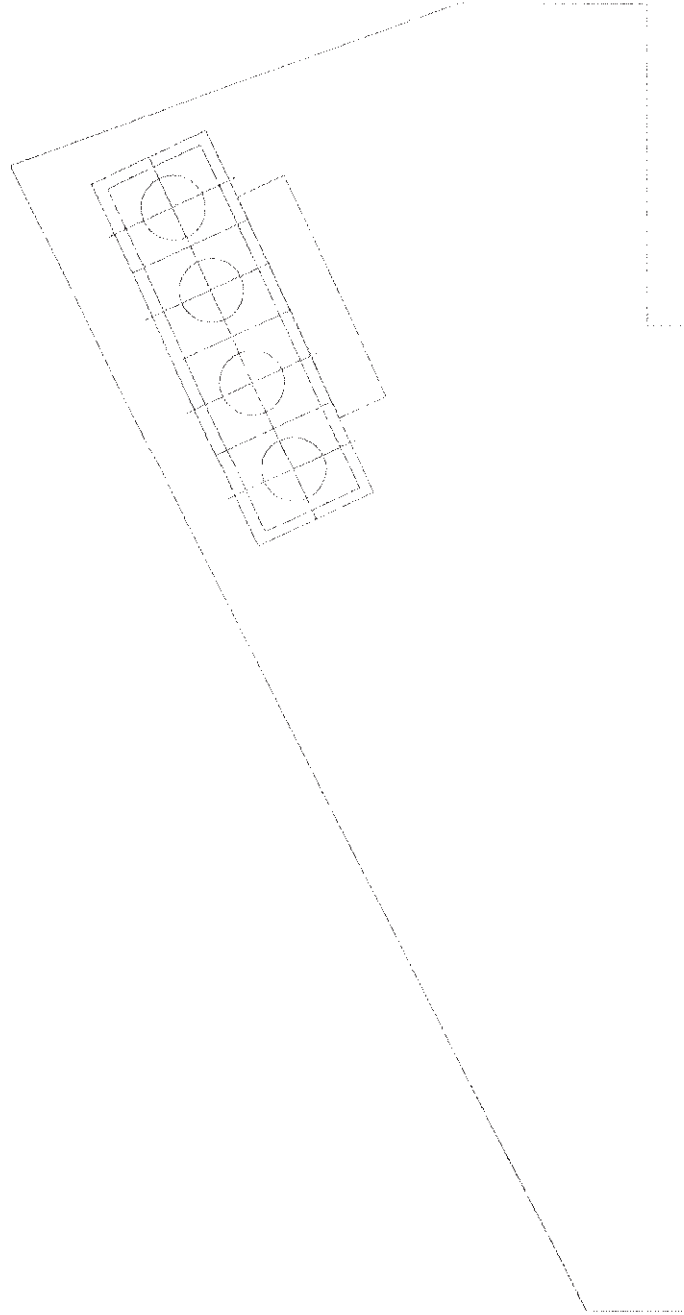

Planimetria B23 - foglio B

Ubicazione delle Sorgenti Sonore
all'interno della Centrale – quota 4.30–6.10

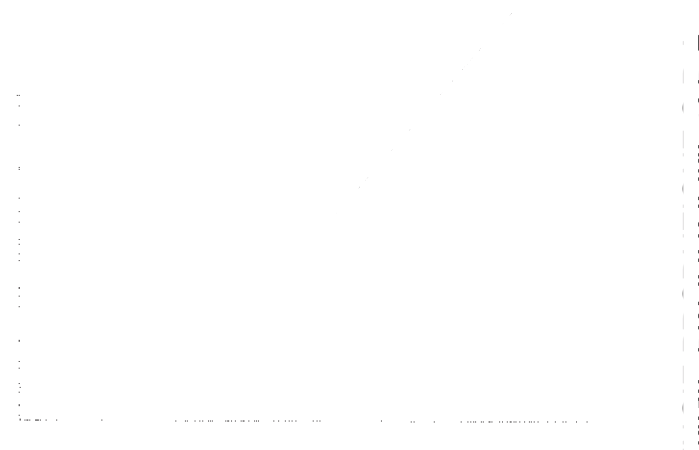
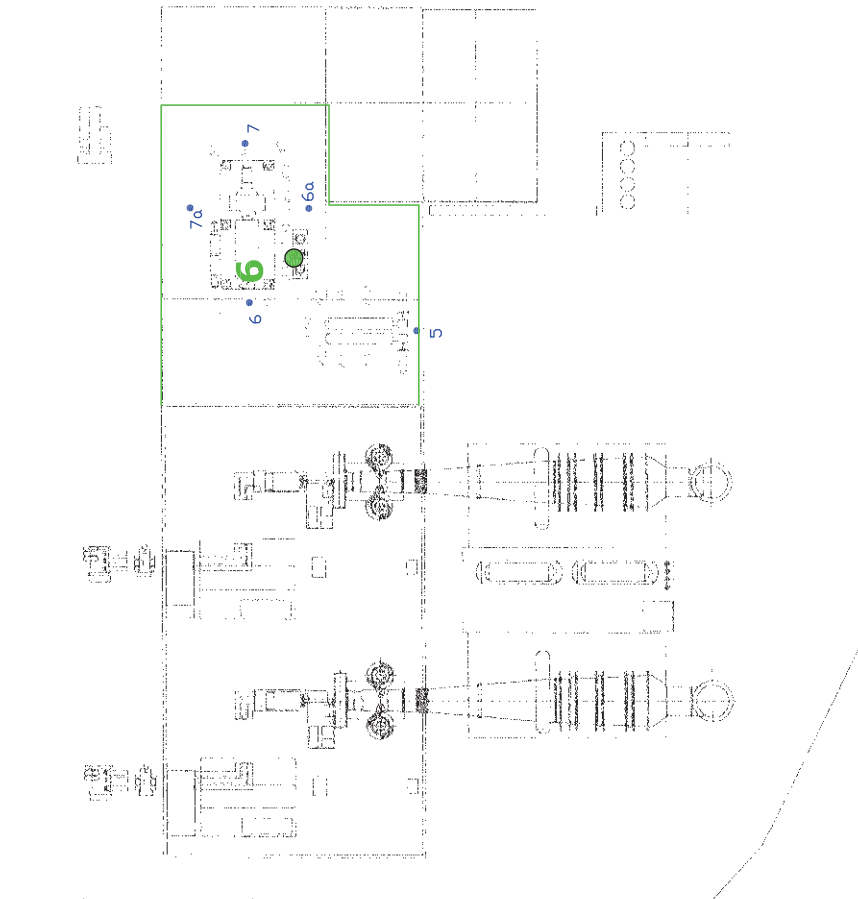
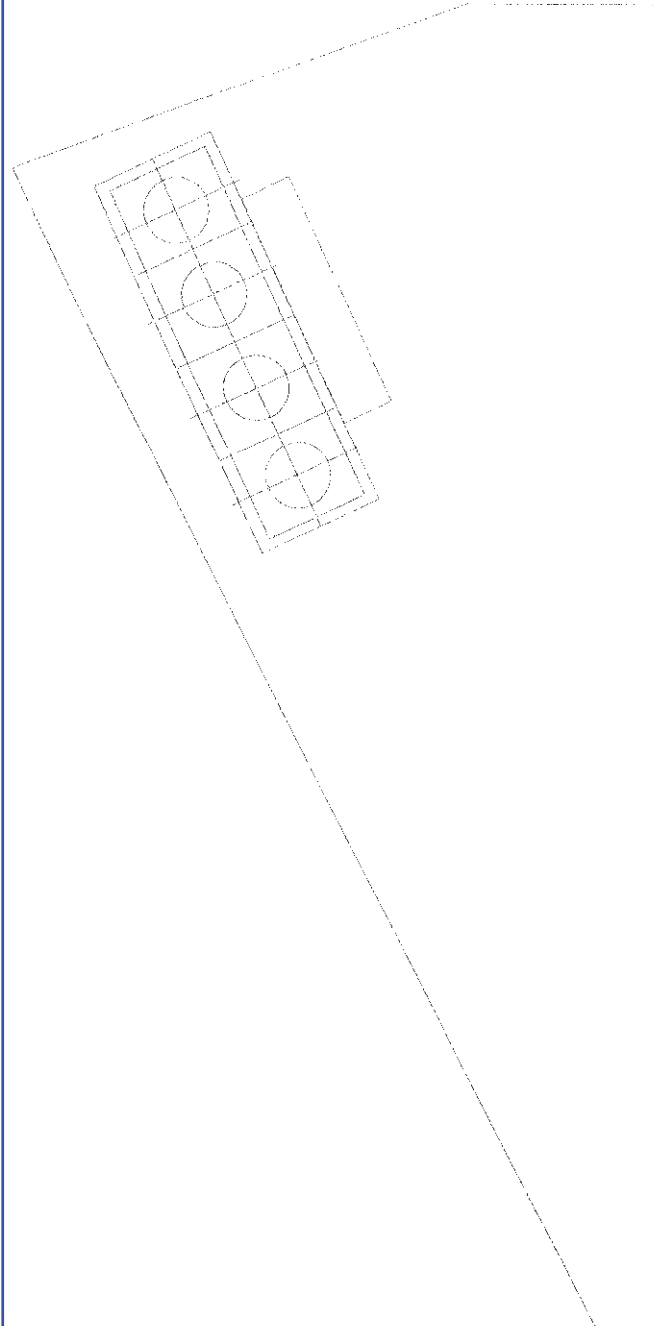

Planimetria B23 - foglio B
Ubicazione delle Sorgenti Sonore
all'interno della Centrale – quota 9.60 –10.80

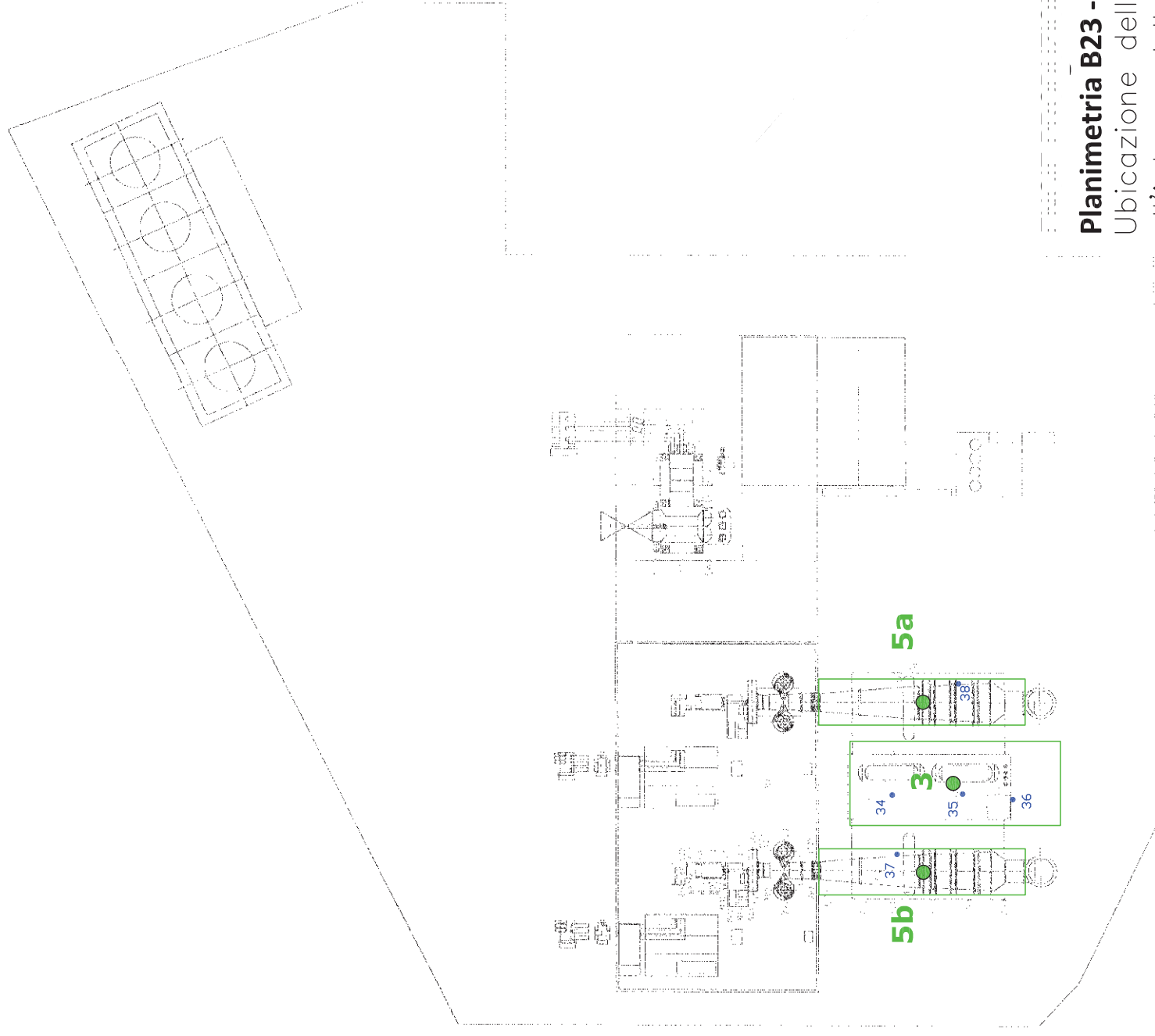

Planimetria B23 - foglio B

Ubicazione delle Sorgenti Sonore
all'interno della Centrale – quota 35.00

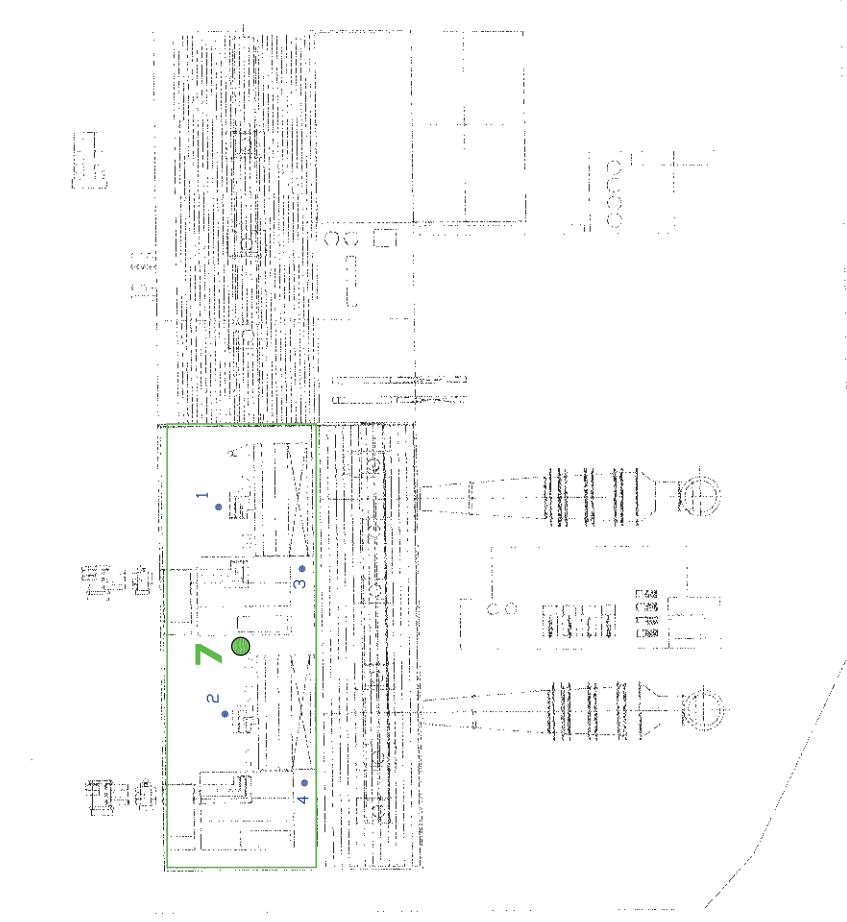
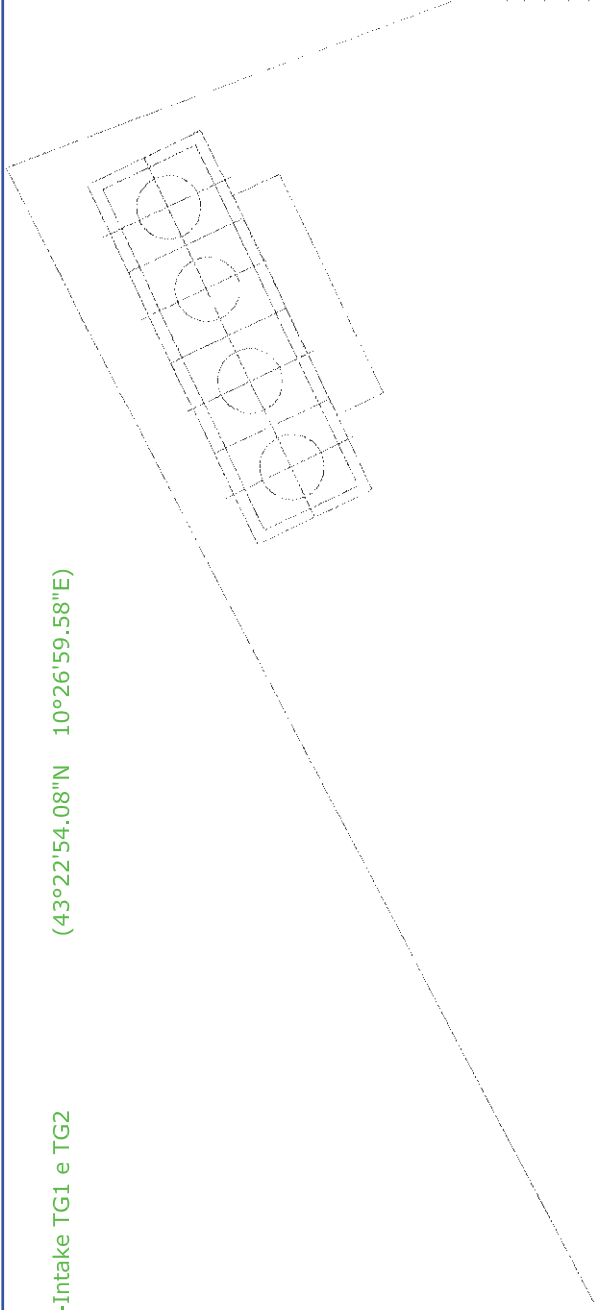

Planimetria B23 - foglio B
Ubicazione delle Sorgenti Sonore
all'interno della Centrale – quota tetto