

Xv 607055,857
Yv 438798,950
Az.In 363,715097313718

Nv 1
Xv 607034,051
Yv 438819,114
Alfa_Tot 4,053682
Az.In 363,715097
Az.Out 363,69142

Nv 2
Xv 606683,455
Yv 4390158,96
Alfa_Tot 106,219635
Az.In 363,69142
Az.Out 283,441771

Lr 33,340
R(m) 1500,000
Lc(km) 42,173
Alfa 2,839
V(Kmh) 100
h(mm) 50
Lr 33,340

Lr 20,000
R(m) 8270,000
Lc(km) 330,437
Alfa 3,355
V(Kmh) 140
h(mm) 70,000

Lr 70,000
R(m) 1584,000
Lc(km) 438,711
Alfa 17,561
V(Kmh) 140
h(mm) 20,000

Lr 20,000
R(m) 1000,000
Lc(km) 702,049
Alfa 27,834
V(Kmh) 140
h(mm) 80,000

Lr 20,000
R(m) 1584,000
Lc(km) 505,832
Alfa 20,279
V(Kmh) 140
h(mm) 50,000

Lr 50,000
R(m) 1000,000
Lc(km) 316,241
Alfa 7,785
V(Kmh) 140
h(mm) 80,000

Lr 40,000
R(m) 1500,000
Lc(km) 182,956
Alfa 7,785
V(Kmh) 140
h(mm) 100,000

Nv 3
Xv 604493,628
Yv 439970,248
Alfa_Tot 2,581564
Az.In 283,441771
Az.Out 286,023392

Nv 4
Xv 604232,856
Yv 439918,013
Alfa_Tot 2,581564
Az.In 286,023392
Az.Out 283,441771

Lr 50,000
R(m) 2800,000
Lc(km) 83,543
Alfa 1,445
V(Kmh) 140
h(mm) 50
Lr 50,000

Lr 50,000
R(m) 2700,000
Lc(km) 89,488
Alfa 1,453
V(Kmh) 140
h(mm) 50
Lr 50,000

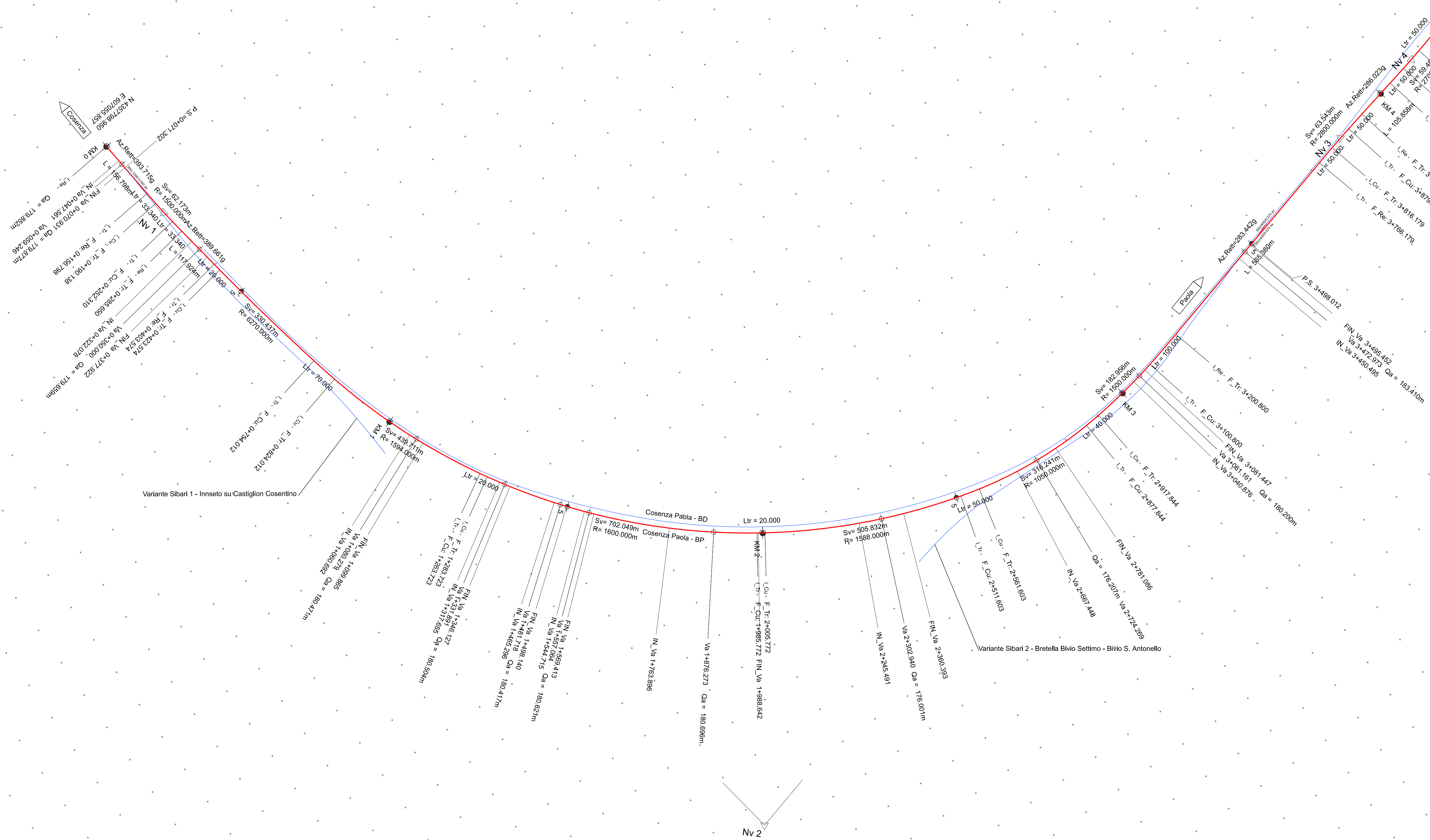
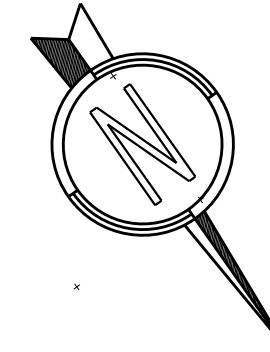

INDIZIO	N_VPI 1	N_VPI 2	N_VPI 3	N_VPI 4	N_VPI 5	N_VPI 6	N_VPI 7	N_VPI 8
Pv_J	182,348	150,600	1080,278	1331,891	1481,318	1557,264	1876,273	2332,340
Qv	179,877	179,859	180,471	180,504	180,417	180,621	180,696	176,001
Pc	0,00042	-0,00075	0,00111	0,00013	-0,00058	0,00020	0,00024	-0,01100
Pu	-0,00075	0,00111	0,00113	-0,00058	0,00020	0,00024	-0,01100	0,00049
DP	0,00117	0,00186	0,00098	0,00071	-0,00047	0,00047	0,01148	0,01148
R	2000,000	3200,000	8200,000	8200,000	1000,000	1000,000	2000,000	-1000,000
T	11,685	27,922	19,596	14,236	16,422	12,349	112,380	57,454
F	0,003	0,013	0,005	0,003	0,013	0,008	0,016	0,165
Pv_J	47,561	322,078	1080,692	1317,855	1485,296	1544,715	1763,896	2245,491
Pv_I	70,101	371,722	1089,886	1346,127	1498,140	1568,413	1888,642	2360,393

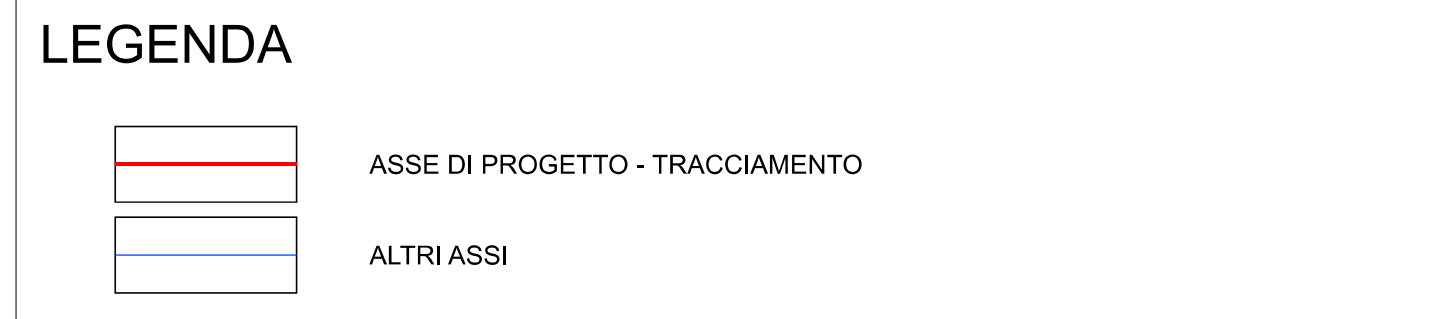
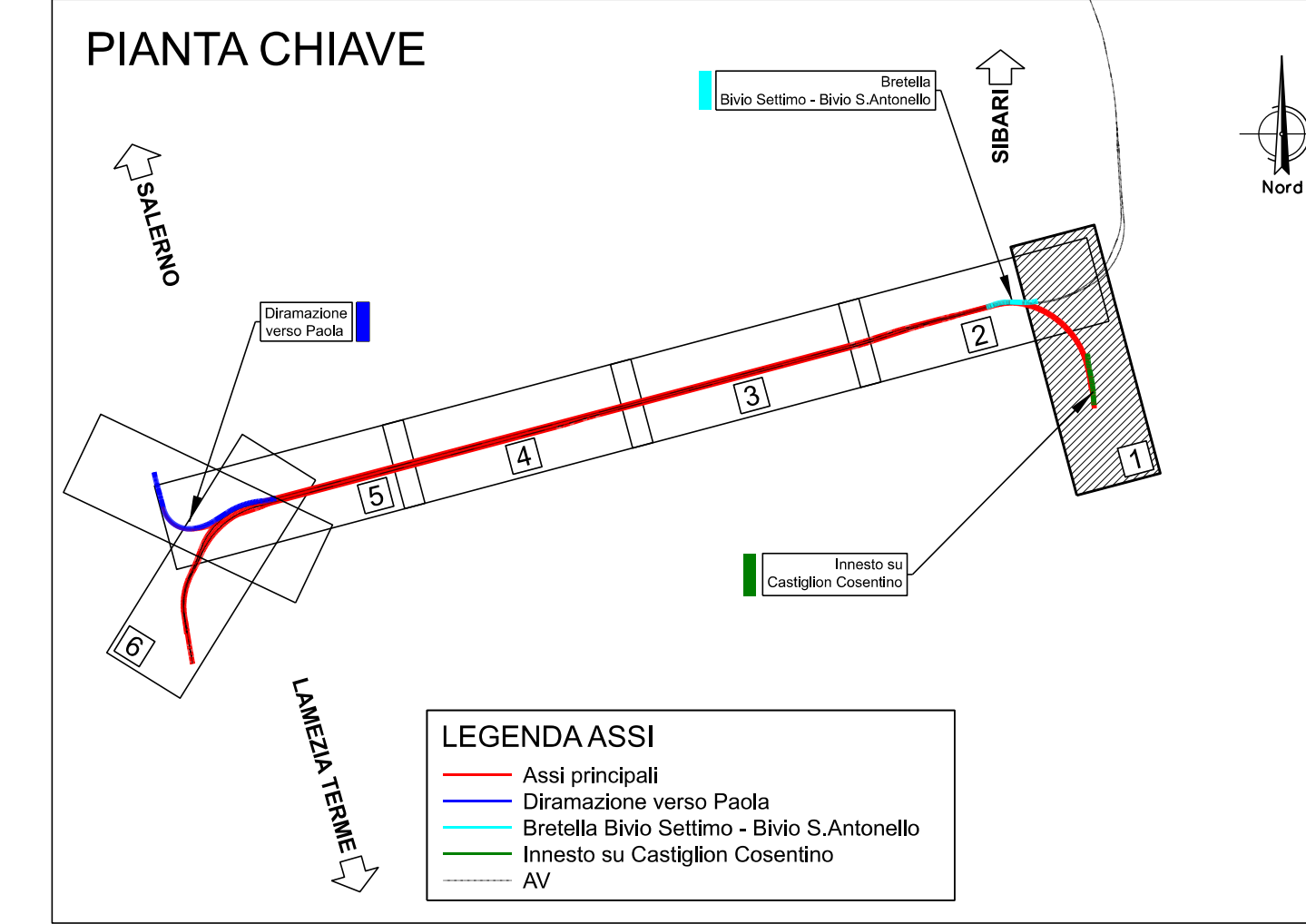

COMMITTENTE: **RFI**
RETE FERROVIARIA ITALIANA
GRUPPO FERROVIE DELLO STATO ITALIANE

PROGETTAZIONE: **ITALFERR**
GRUPPO FERROVIE DELLO STATO ITALIANE

U.O. COORDINAMENTO DI SISTEMA E PFTE
PROGETTO DI FATTIBILITA' TECNICO ECONOMICA

LINEA COSENZA - PAOLA / S. LUCIDO
NUOVA LINEA AV SALERNO - REGGIO CALABRIA
RADDOPPIO COSENZA - PAOLA / S. LUCIDO

Elaborati di Linea
Planimetria di Tracciamento BP - Tav. 1 di 6

SCALA: 1:5000

COMMESSA LOTTO FASE ENTE TIPO DOC. OPERA/DISCIPLINA PROGR. REV.
RC1C 03 R 10 P5 IF 00 08 001 A

Revis.	Descrizione	Redatto	Data	Verificato	Data	Approvato	Data	Autorizzato	Data
A	Emissione Esecutiva	S. Casella	10/2021	M. Fabbri	10/2021	L. D'Amore	10/2021	G. Ingrassia	10/2021