

PA1 - INVERDIMENTO ARBOREO ARBUSTIVO PER MITIGAZIONE ECOLOGICA

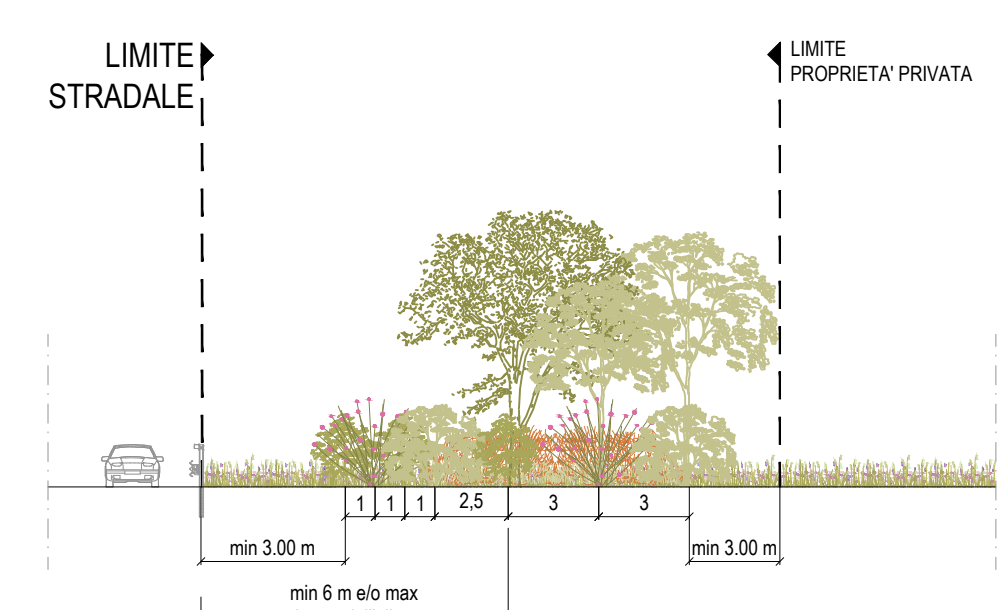
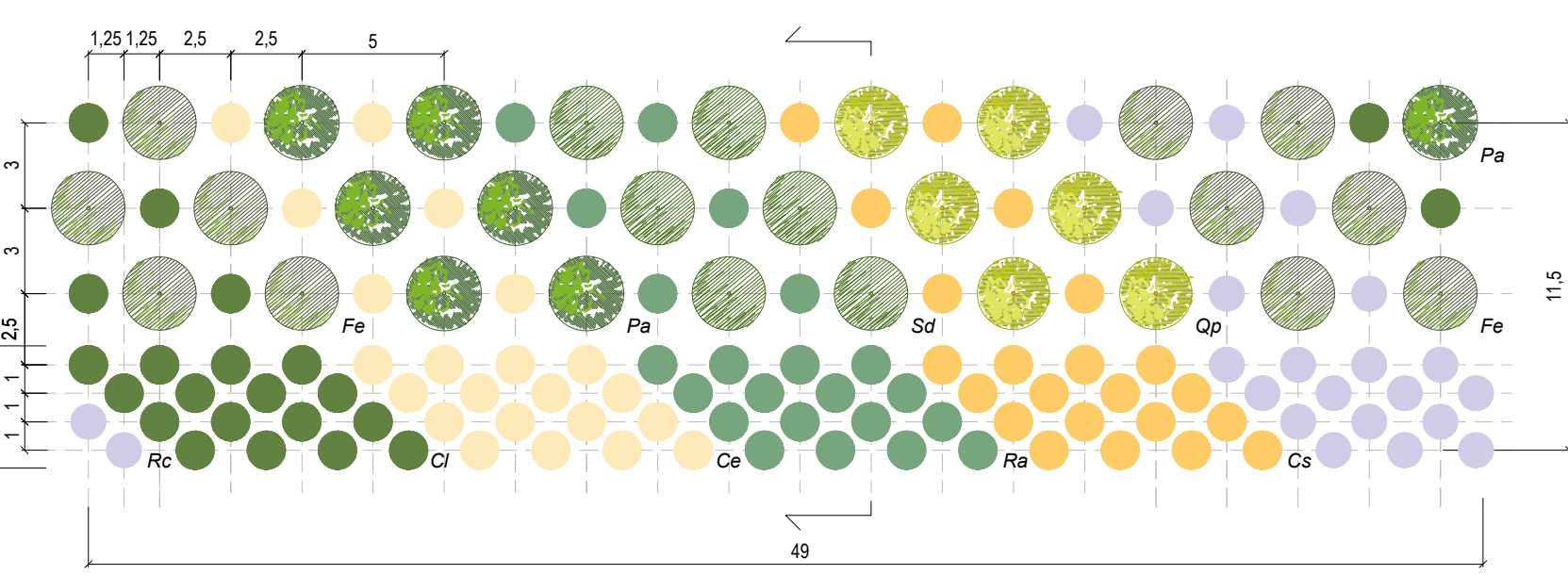

- Legend for PA1: Alberi (Fraxinus excelsior, Populus alba, Quercus pubescens, Sorbus domestica, Coronilla emerus, Crataegus laevigata, Cytisus scoparius, Rhamnus alaternus, Rosa canina) and Arbusti (Ce, Cs, Ra, Rc, Coronilla emerus, Cytisus scoparius, Rhamnus alaternus, Rosa canina).

01 PAESAGGIO AGRICOLO

Table VE01 for PA1: Species list including Fraxinus excelsior, Populus alba, Quercus pubescens, Sorbus domestica, Coronilla emerus, Crataegus laevigata, Cytisus scoparius, Rhamnus alaternus, Rosa canina, with area and total plant counts.

Table VE02 for PA1: Species list including Fraxinus excelsior, Populus alba, Quercus pubescens, Sorbus domestica, Coronilla emerus, Crataegus laevigata, Cytisus scoparius, Rhamnus alaternus, Rosa canina, with area and total plant counts.

Table VE03 for PA1: Species list including Fraxinus excelsior, Populus alba, Quercus pubescens, Sorbus domestica, Coronilla emerus, Crataegus laevigata, Cytisus scoparius, Rhamnus alaternus, Rosa canina, with area and total plant counts.

Table VE04 for PA1: Species list including Fraxinus excelsior, Populus alba, Quercus pubescens, Sorbus domestica, Coronilla emerus, Crataegus laevigata, Cytisus scoparius, Rhamnus alaternus, Rosa canina, with area and total plant counts.

Table VE05 for PA1: Species list including Fraxinus excelsior, Populus alba, Quercus pubescens, Sorbus domestica, Coronilla emerus, Crataegus laevigata, Cytisus scoparius, Rhamnus alaternus, Rosa canina, with area and total plant counts.

Summary table INR-Prato for PA1: Area Tot. (mq) 327.239, N° totale piante 3196.

Summary table INS-Prato Idrosirena for PA1: Area Tot. (mq) 303.004, N° totale piante 4748.

05 PRATO RUSTICO

06 PRATO RUSTICO SU SACRATA

PF1 - INVERDIMENTO ARBOREO ARBUSTIVO PER MITIGAZIONE ECOLOGICA

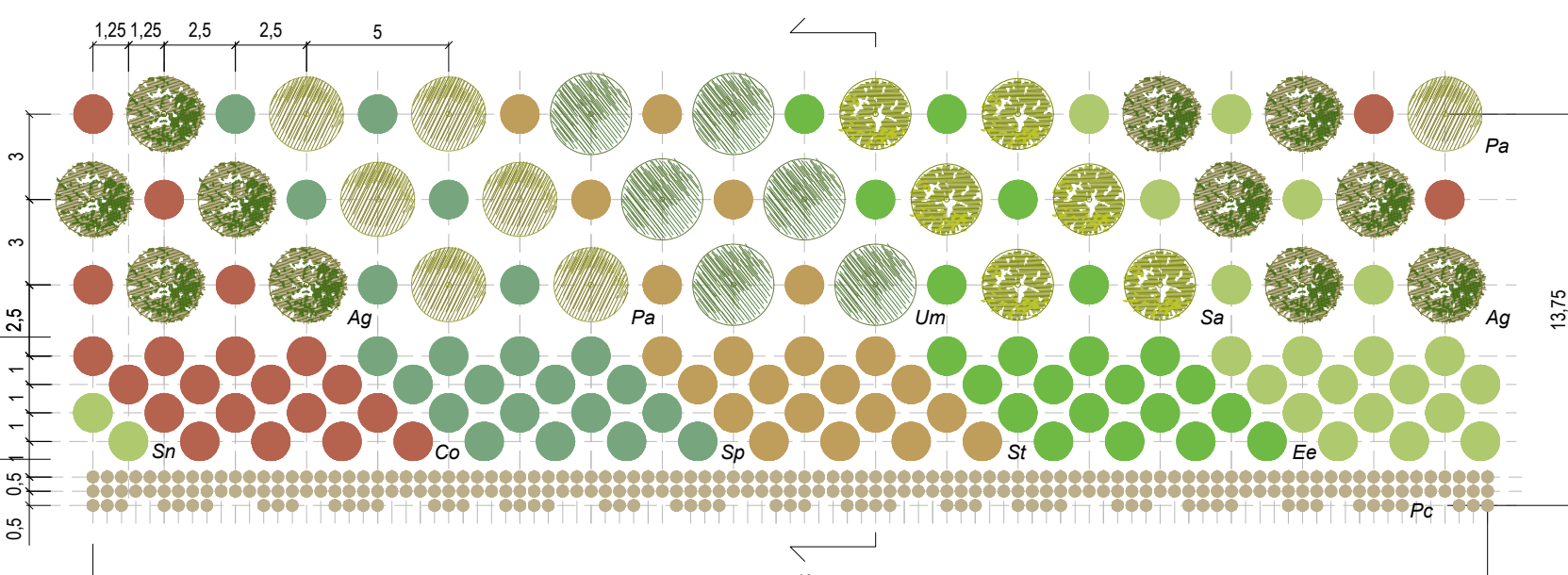

- Legend for PF1: Alberi (Alnus glutinosa, Populus alba, Salix alba, Ulmus minor, Cornus mas, Euonymus europaeus, Salix purpurea, Salix triandra, Sambucus nigra, Phragmites communis) and Arbusti (Co, Ee, Sp, St, Sn, Pc, Cornus mas, Euonymus europaeus, Salix purpurea, Salix triandra, Sambucus nigra, Phragmites communis). ERBACEE: Pc, Phragmites communis.

02 PAESAGGIO FLUVIALE

Table VE01 for PF1: Species list including Alnus glutinosa, Populus alba, Salix alba, Ulmus minor, Cornus mas, Euonymus europaeus, Salix purpurea, Salix triandra, Sambucus nigra, Phragmites communis, with area and total plant counts.

Table VE02 for PF1: Species list including Alnus glutinosa, Populus alba, Salix alba, Ulmus minor, Cornus mas, Euonymus europaeus, Salix purpurea, Salix triandra, Sambucus nigra, Phragmites communis, with area and total plant counts.

Table VE03 for PF1: Species list including Alnus glutinosa, Populus alba, Salix alba, Ulmus minor, Cornus mas, Euonymus europaeus, Salix purpurea, Salix triandra, Sambucus nigra, Phragmites communis, with area and total plant counts.

Table VE04 for PF1: Species list including Alnus glutinosa, Populus alba, Salix alba, Ulmus minor, Cornus mas, Euonymus europaeus, Salix purpurea, Salix triandra, Sambucus nigra, Phragmites communis, with area and total plant counts.

Table VE05 for PF1: Species list including Alnus glutinosa, Populus alba, Salix alba, Ulmus minor, Cornus mas, Euonymus europaeus, Salix purpurea, Salix triandra, Sambucus nigra, Phragmites communis, with area and total plant counts.

Summary table PIG-Ghiaia for PF1: Area Tot. (mq) 1.694, N° totale piante 1509.

Summary table INC-Prato ripristino for PF1: Area Tot. (mq) 139.532, N° totale piante 1258.

07 PAVIMENTAZIONE IN GHIAIA

08 PRATO RUSTICO RIPRISTINO AREE CANTIERE

PH - INVERDIMENTO ARBOREO ARBUSTIVO PER MITIGAZIONE ECOLOGICA

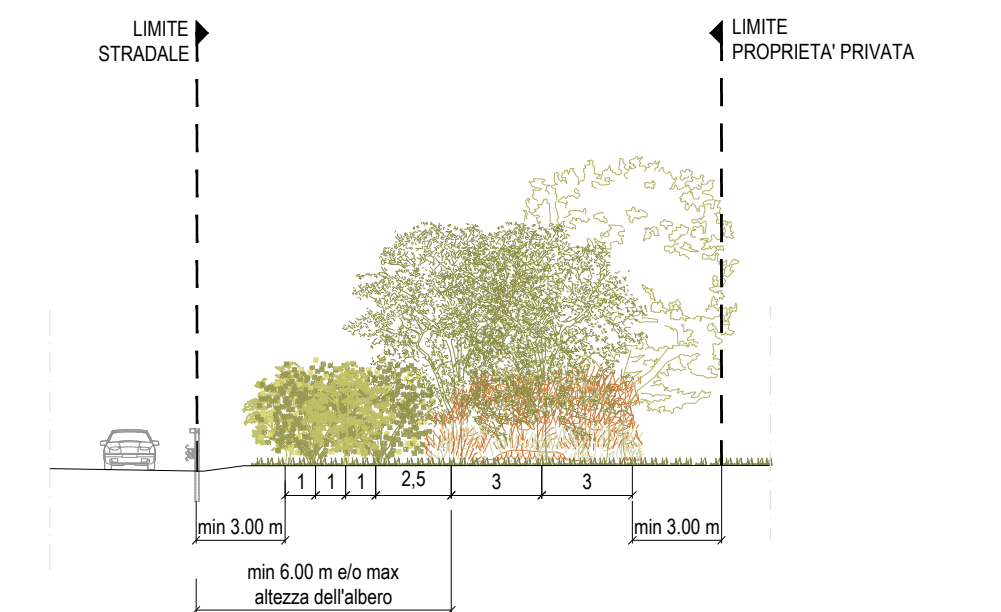
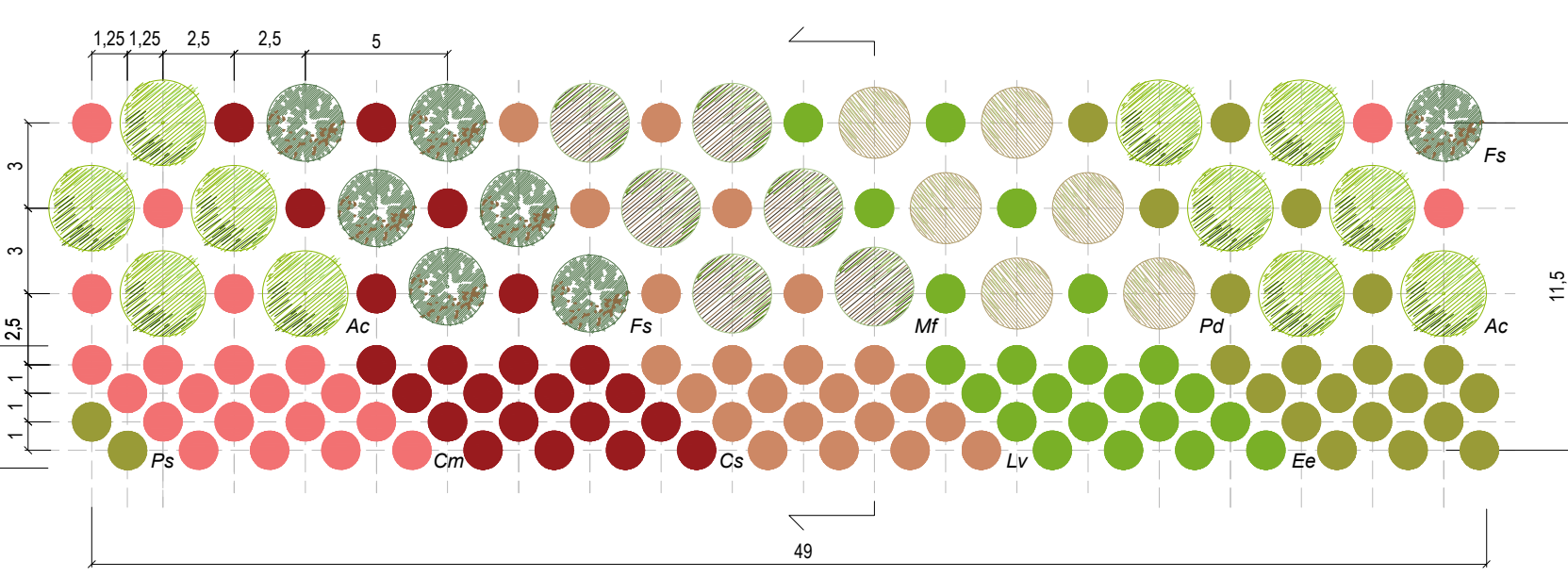

- Legend for PH: Alberi (Acer campestre, Fagus sylvatica, "Purpurea", Malus floribunda, Prunus padus, Cornus sanguinea, Crataegus monogyna, Euonymus europaeus, Ligustrum vulgare, Prunus spinosa) and Arbusti (Cs, Cm, Ee, Lv, Ps, Cornus sanguinea, Crataegus monogyna, Euonymus europaeus, Ligustrum vulgare, Prunus spinosa).

03 PAESAGGIO INFRASTRUTTURALE

Table VE01 for PH: Species list including Acer campestre, Fagus sylvatica, "Purpurea", Malus floribunda, Prunus padus, Cornus sanguinea, Crataegus monogyna, Euonymus europaeus, Ligustrum vulgare, Prunus spinosa, with area and total plant counts.

Table VE02 for PH: Species list including Acer campestre, Fagus sylvatica, "Purpurea", Malus floribunda, Prunus padus, Cornus sanguinea, Crataegus monogyna, Euonymus europaeus, Ligustrum vulgare, Prunus spinosa, with area and total plant counts.

Table VE03 for PH: Species list including Acer campestre, Fagus sylvatica, "Purpurea", Malus floribunda, Prunus padus, Cornus sanguinea, Crataegus monogyna, Euonymus europaeus, Ligustrum vulgare, Prunus spinosa, with area and total plant counts.

Table VE04 for PH: Species list including Acer campestre, Fagus sylvatica, "Purpurea", Malus floribunda, Prunus padus, Cornus sanguinea, Crataegus monogyna, Euonymus europaeus, Ligustrum vulgare, Prunus spinosa, with area and total plant counts.

Table VE05 for PH: Species list including Acer campestre, Fagus sylvatica, "Purpurea", Malus floribunda, Prunus padus, Cornus sanguinea, Crataegus monogyna, Euonymus europaeus, Ligustrum vulgare, Prunus spinosa, with area and total plant counts.

Table VE06 for PH: Species list including Acer campestre, Fagus sylvatica, "Purpurea", Malus floribunda, Prunus padus, Cornus sanguinea, Crataegus monogyna, Euonymus europaeus, Ligustrum vulgare, Prunus spinosa, with area and total plant counts.

Table VE07 for PH: Species list including Acer campestre, Fagus sylvatica, "Purpurea", Malus floribunda, Prunus padus, Cornus sanguinea, Crataegus monogyna, Euonymus europaeus, Ligustrum vulgare, Prunus spinosa, with area and total plant counts.

Table VE08 for PH: Species list including Acer campestre, Fagus sylvatica, "Purpurea", Malus floribunda, Prunus padus, Cornus sanguinea, Crataegus monogyna, Euonymus europaeus, Ligustrum vulgare, Prunus spinosa, with area and total plant counts.

Table VE09 for PH: Species list including Acer campestre, Fagus sylvatica, "Purpurea", Malus floribunda, Prunus padus, Cornus sanguinea, Crataegus monogyna, Euonymus europaeus, Ligustrum vulgare, Prunus spinosa, with area and total plant counts.

Table VE10 for PH: Species list including Acer campestre, Fagus sylvatica, "Purpurea", Malus floribunda, Prunus padus, Cornus sanguinea, Crataegus monogyna, Euonymus europaeus, Ligustrum vulgare, Prunus spinosa, with area and total plant counts.

Sanas GRUPPO FS ITALIANE Direzione Progettazione e Realizzazione Lavori

S.S.80 - "Raccordo di Teramo"
Tratta stradale Teramo mare Variante alla S.S. 80 dalla A14 (Mosciano S. Angelo) alla S.S. 16 (Giulianova) - LOTTO IV

PROGETTO DEFINITIVO

Logos for RIFA, AMBERG ENGINEERING, ETACONS S.p.A., and cdb INGENIERI ASSOCIATI.

PROGETTISTI: Arch. Andrea Altar - Graziella Arch. Mellini n.12559
PROGETTISTA E DIRETTORE TECNICO LAND Italia Srl
GEOLOGO: Geol. Roberto Padone - Graziella Geol. Ugnario n. 163
RESPONSABILE DELL'INTEGRAZIONE DELLE DISCIPLINE SPECIALISTICHE: Ing. Alessandro Alotta - Graziella Ing. Genova n.79954
COORDINATORE DELLA SICUREZZA: Arch. Giorgio Hilli - Graziella Arch. Paolo n.645
VISTO: IL RESPONSABILE DEL PROCEDIMENTO Ing. CARLO BUCI

STUDIO DI IMPATTO AMBIENTALE INQUADRAMENTO PROGETTUALE Dettagli tipologici opere a verde

Table with project details: CODICE PROGETTO (DFA00016), NOME FILE (TO01A30AMBDC01\_A), REVISIONE (A), SCALA (varie).

PI2 - INVERDIMENTO ARBUSTIVO

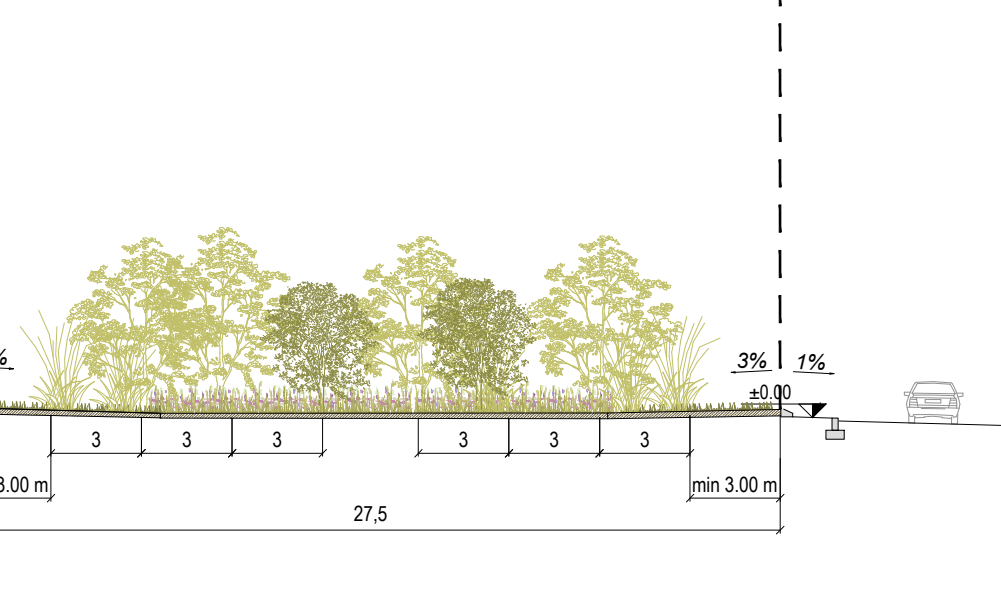
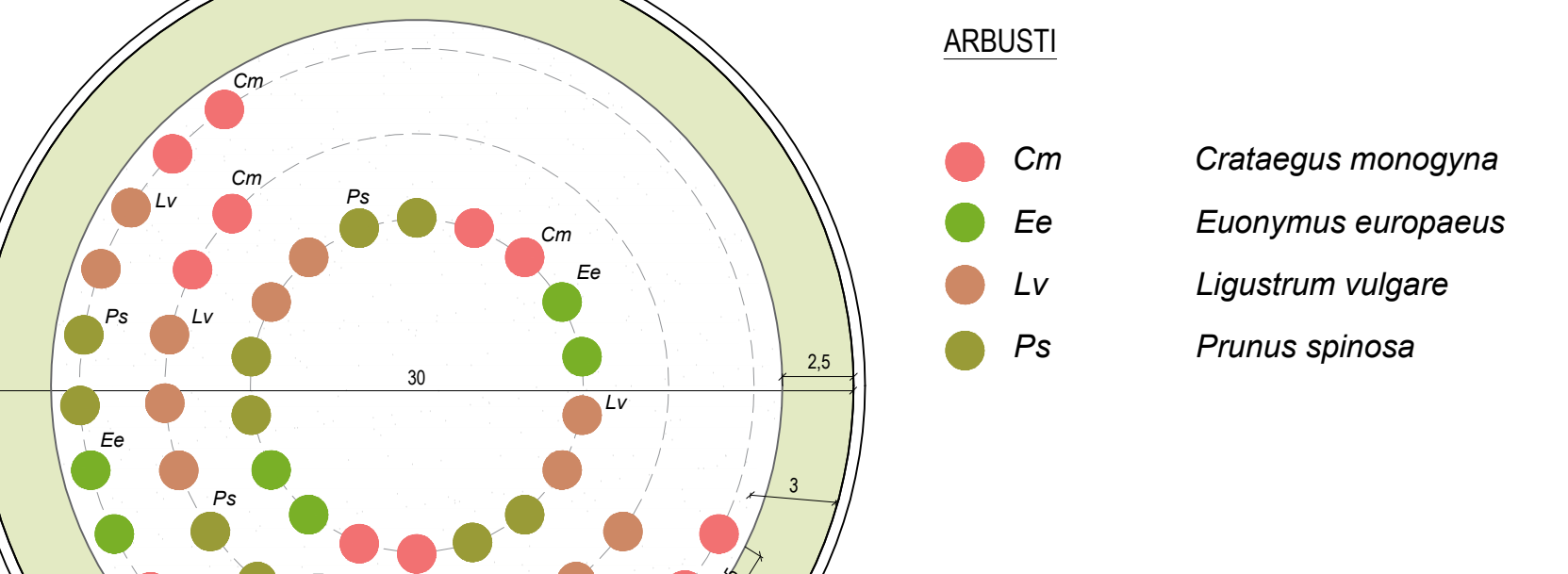

- Legend for PI2: Arbusti (Cm, Ee, Lv, Ps, Crataegus monogyna, Euonymus europaeus, Ligustrum vulgare, Prunus spinosa).

04 PAESAGGIO INFRASTRUTTURALE ROTATORIE

Table VE01 for PI2: Species list including Crataegus monogyna, Euonymus europaeus, Ligustrum vulgare, Prunus spinosa, with area and total plant counts.

Table VE02 for PI2: Species list including Crataegus monogyna, Euonymus europaeus, Ligustrum vulgare, Prunus spinosa, with area and total plant counts.

Table VE03 for PI2: Species list including Crataegus monogyna, Euonymus europaeus, Ligustrum vulgare, Prunus spinosa, with area and total plant counts.

Table VE04 for PI2: Species list including Crataegus monogyna, Euonymus europaeus, Ligustrum vulgare, Prunus spinosa, with area and total plant counts.

Table VE05 for PI2: Species list including Crataegus monogyna, Euonymus europaeus, Ligustrum vulgare, Prunus spinosa, with area and total plant counts.

Table VE06 for PI2: Species list including Crataegus monogyna, Euonymus europaeus, Ligustrum vulgare, Prunus spinosa, with area and total plant counts.

Table VE07 for PI2: Species list including Crataegus monogyna, Euonymus europaeus, Ligustrum vulgare, Prunus spinosa, with area and total plant counts.

Table VE08 for PI2: Species list including Crataegus monogyna, Euonymus europaeus, Ligustrum vulgare, Prunus spinosa, with area and total plant counts.

Table VE09 for PI2: Species list including Crataegus monogyna, Euonymus europaeus, Ligustrum vulgare, Prunus spinosa, with area and total plant counts.

Table VE10 for PI2: Species list including Crataegus monogyna, Euonymus europaeus, Ligustrum vulgare, Prunus spinosa, with area and total plant counts.

Table with revision details: REV. (A), DESCRIZIONE (EMISSIONE), DATA (Aprile 2022), REDATTO (LAND Italia), VERIFICATO (S. Muro), APPROVATO (A. Ripa).