

Planimetria Generale - Imbocco galleria di accesso

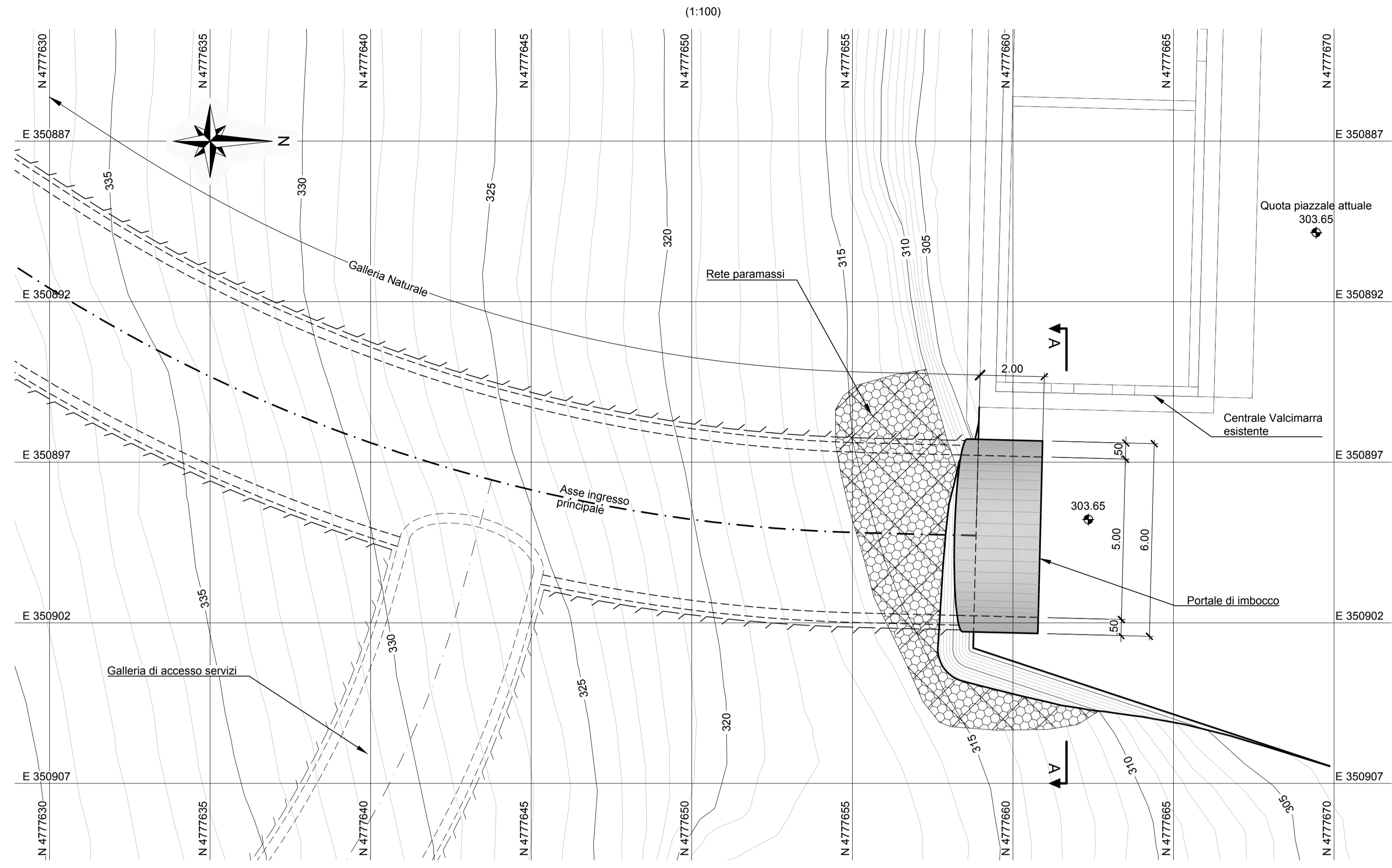

Profilo Longitudinale - Imbocco galleria di accesso

(1:100)

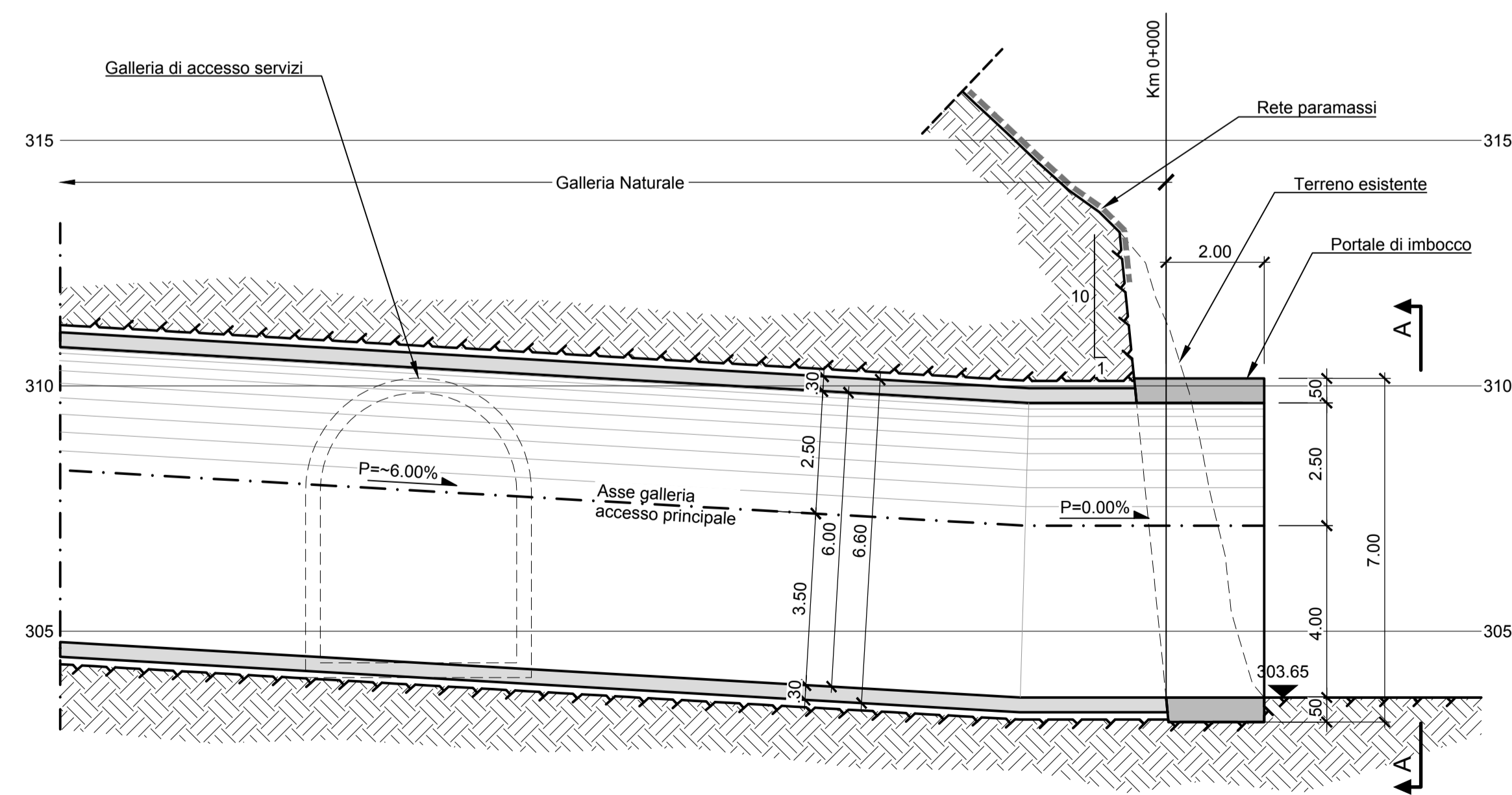

Vista frontale - A-A

(1:100)

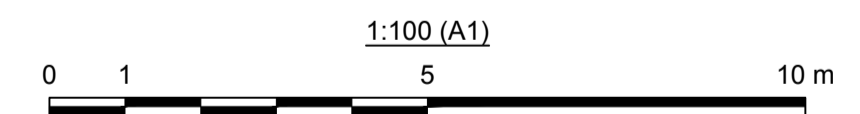
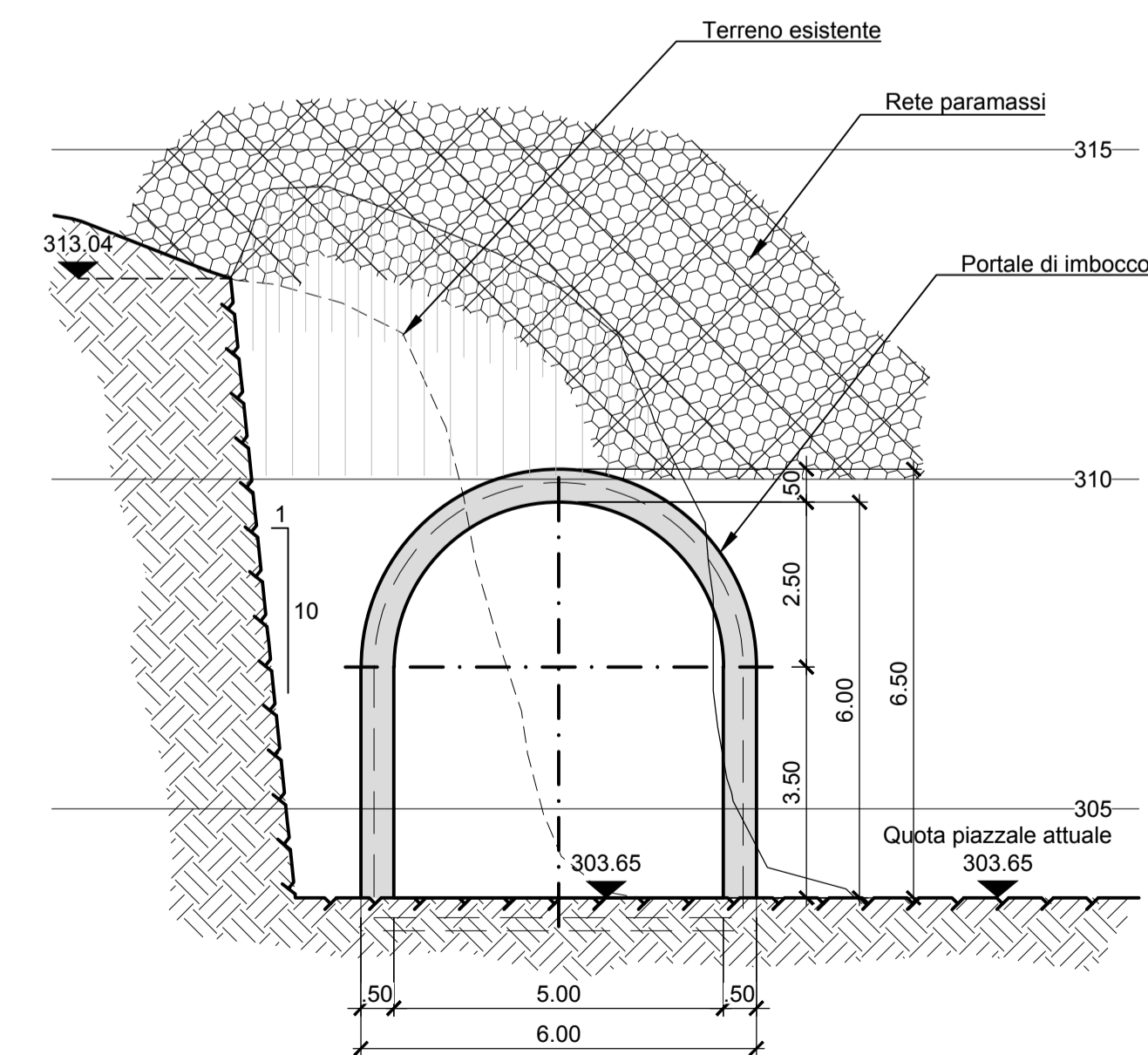

00	30/05/2022	Emissione per Revisione Cliente	L. Botiglieri	C. Pocrini / F. Maugliani	A. Balestra
REV.	DATE	DESCRIPTION	PREPARED	CHECKED	APPROVED
CONTRACTOR'S LOGO		PROJECT: IMPIANTO DI VALCIMARRA II INSTALLAZIONE DI NUOVO GRUPPO REVERSIBILE			
Lombardi		FILE NAME (EGP CODE): GRE.EEC.D.99.IT.H.17168.00.025.00	LOMBARDI CODE: 2021.0047.008-GC-PSP-DW-024		
enel Green Power		CLASSIFICATION: Public	FORMAT: A1	SCALE: 1:100	PLOT SCALE: 1:1
HGT Design & Execution EGP VALIDATION		UTILIZATION SCOPE: Progetto Definitivo per Autorizzazione		TITLE: Stato di Progetto Imbocco galleria di accesso	
VALIDATED BY:	Project Engineer: G. Ripellino				
VERIFIED BY:	Support Team: Podio				
COLLABORATORS:		EGP CODE			
GROUP:	FUNCTION:	TYPE:	ISSUER:	COUNTRY:	TEC. PLANT SYSTEM PROGRESSIVE REVISION
GREEC	D99	ITH	17168	00025	00
This document is property of Enel Green Power SpA. It is strictly forbidden to reproduce this document, in whole or in part, and to provide to others any related information without the previous written consent by Enel Green Power SpA.					