

SISTEMA DI ACCUMULO - CONTAINER BATTERIA

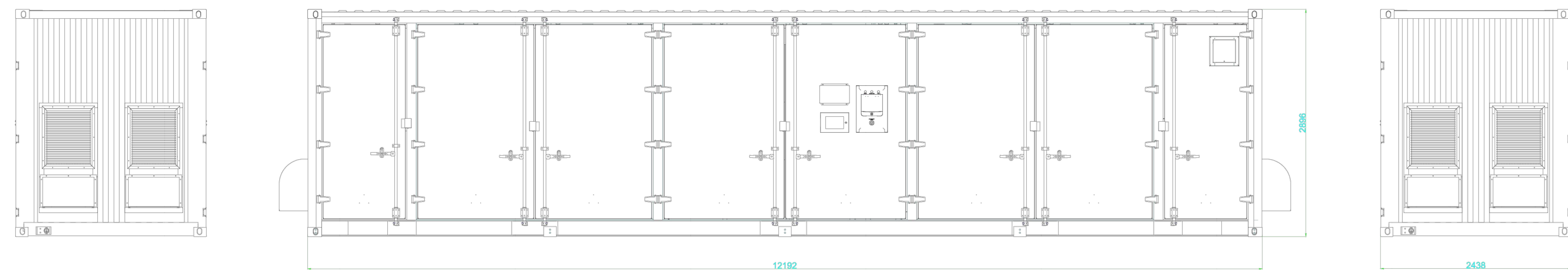

Right view

Front view

Left view

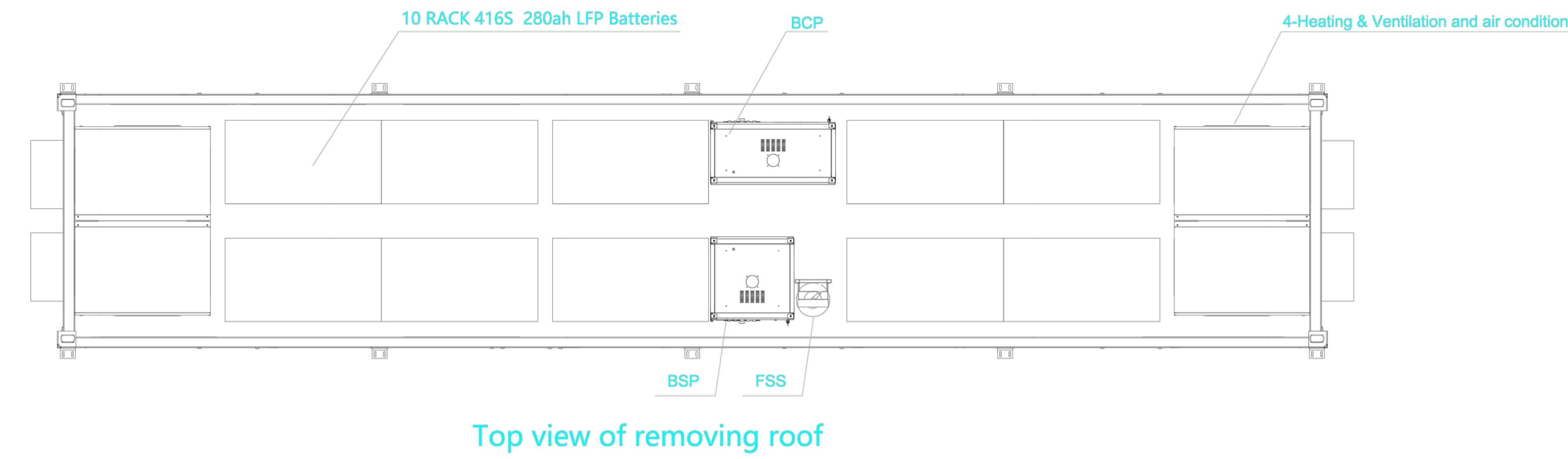

Top view of removing roof

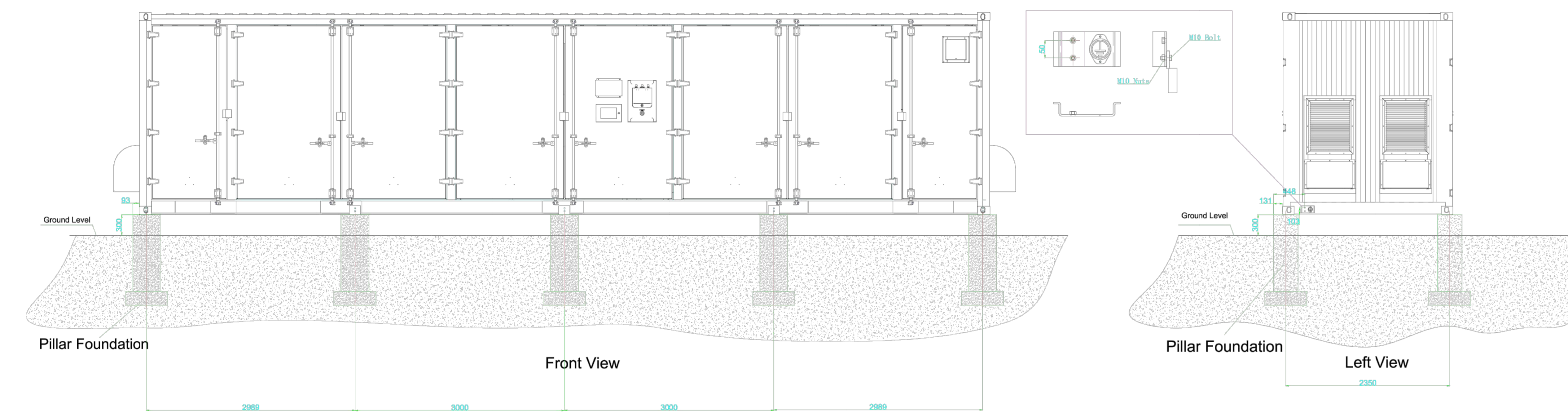

Pillar Foundation

Front View

Pillar Foundation

Left View

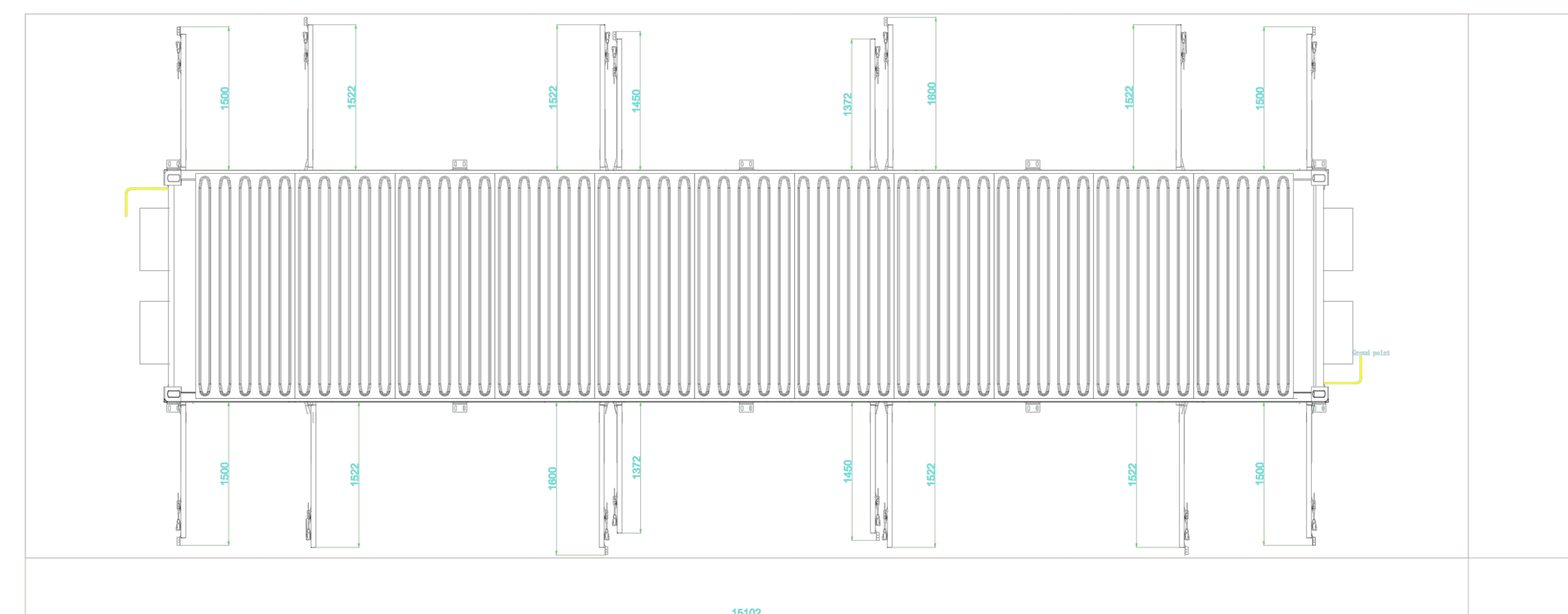
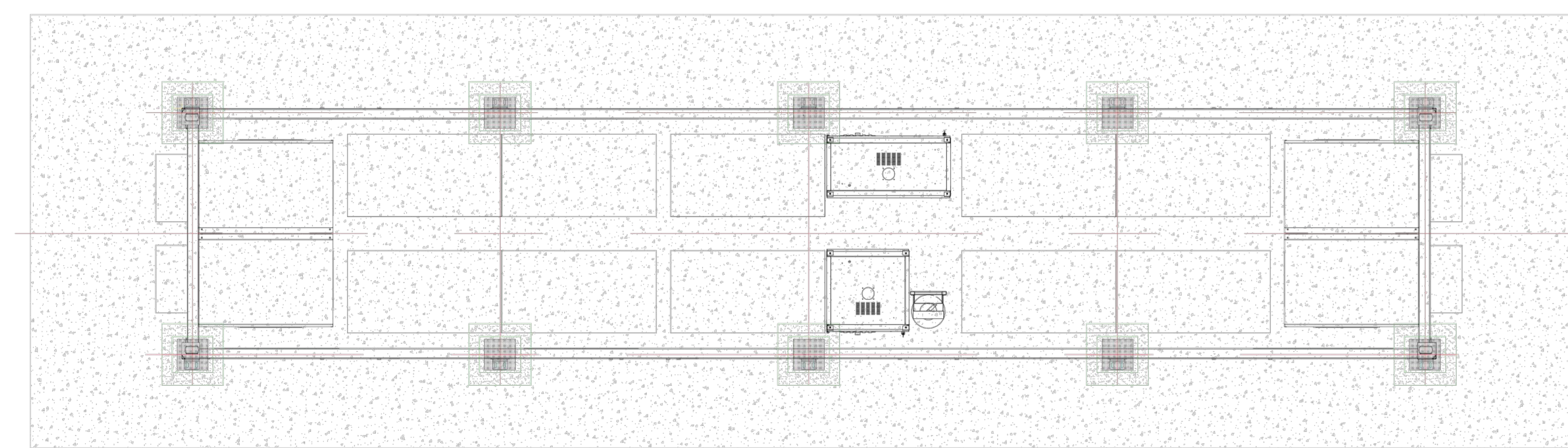

Top view of open all doors

SISTEMA DI ACCUMULO - CONTAINER TRASFORMATORE

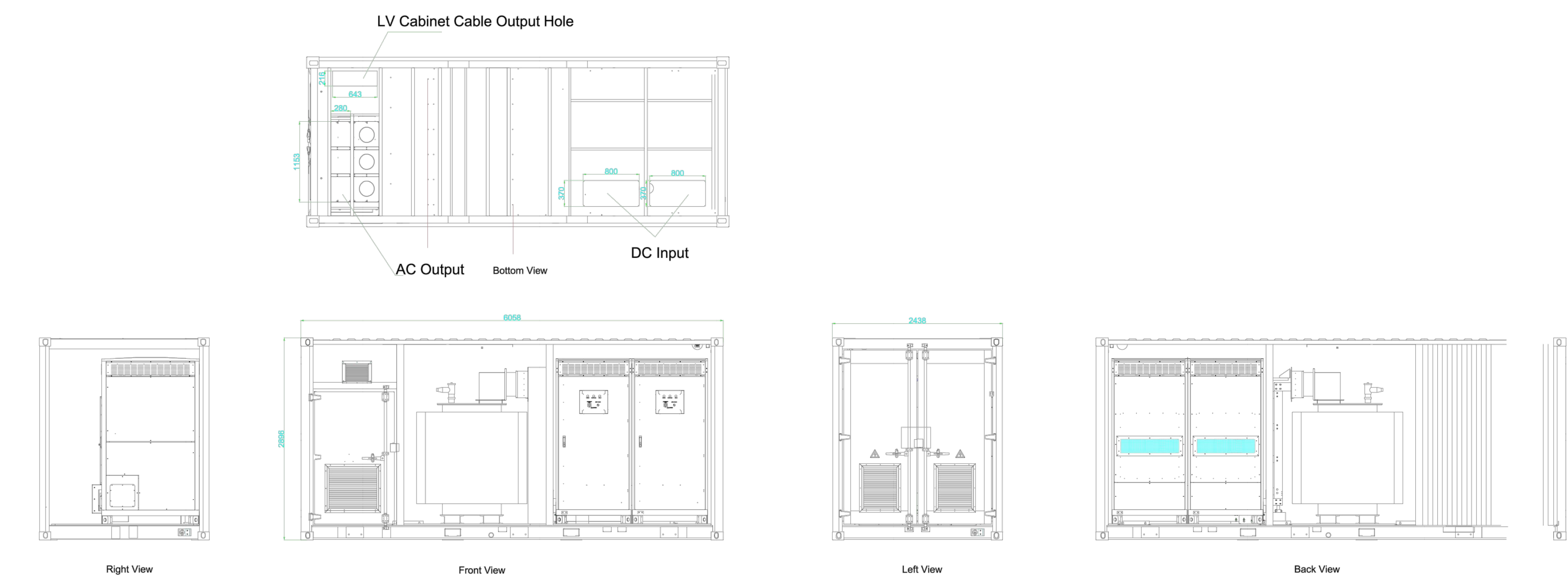

Right View

Front View

Left View

Back View

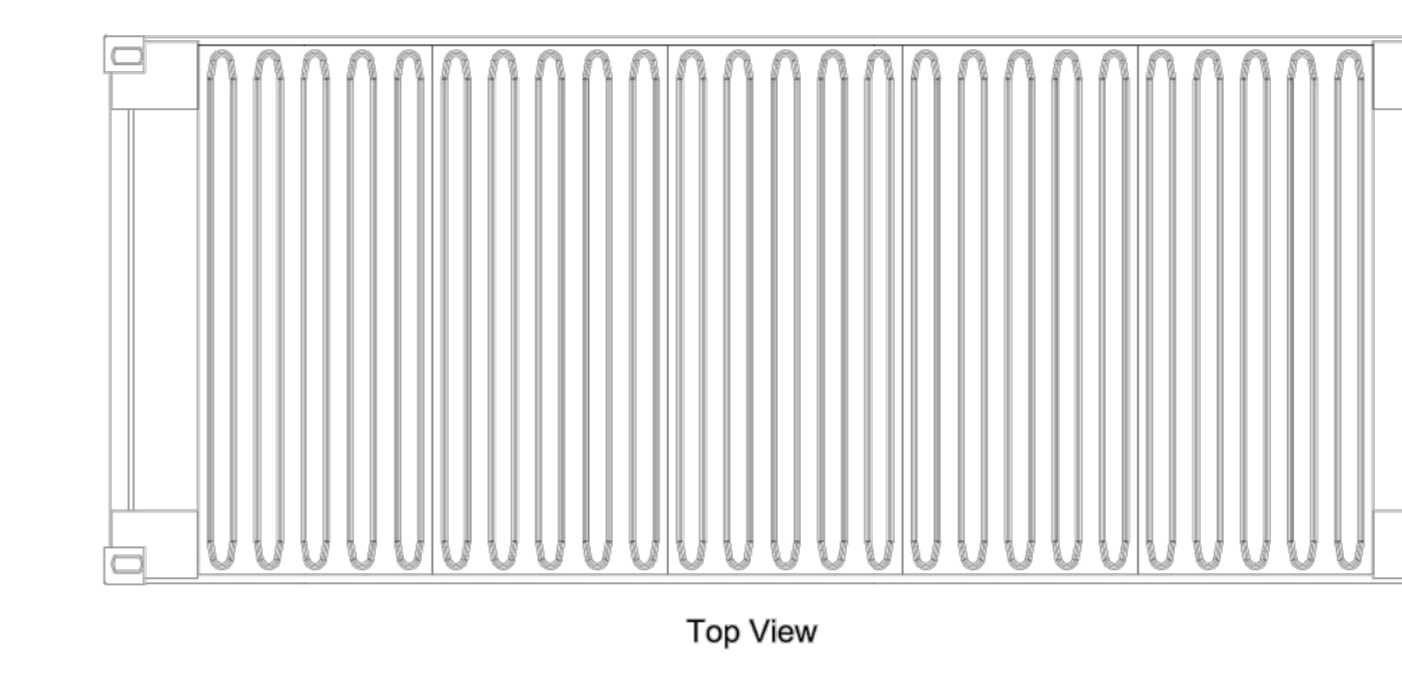

Top View

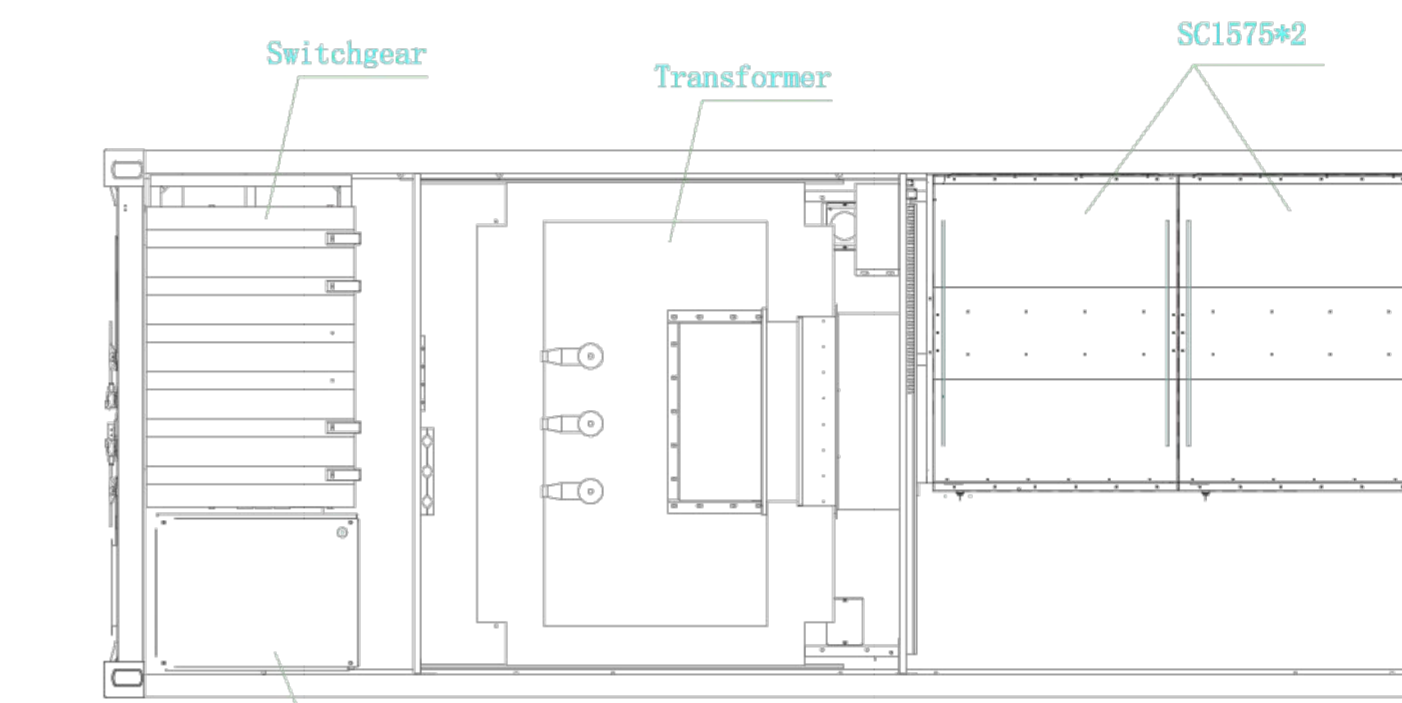

Top View (Without Roof)

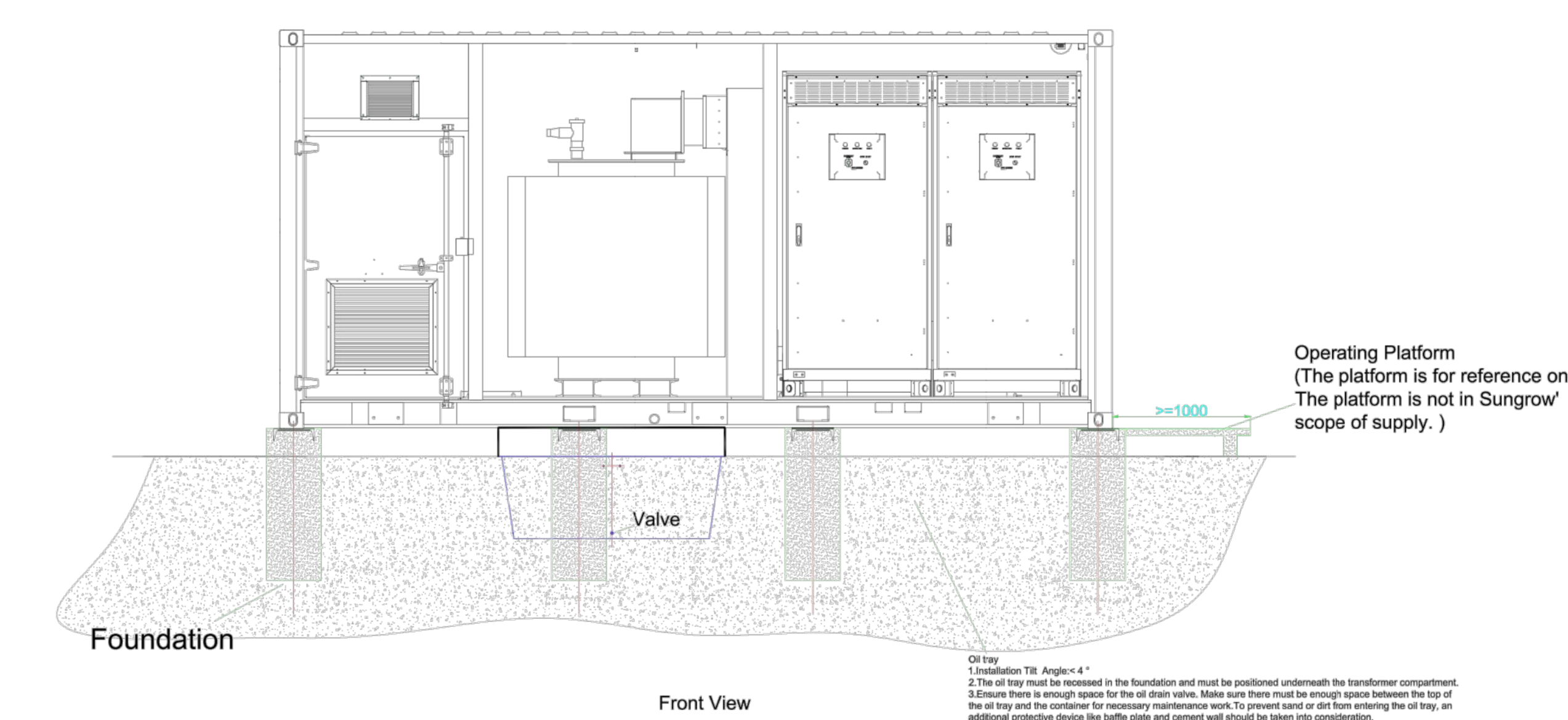
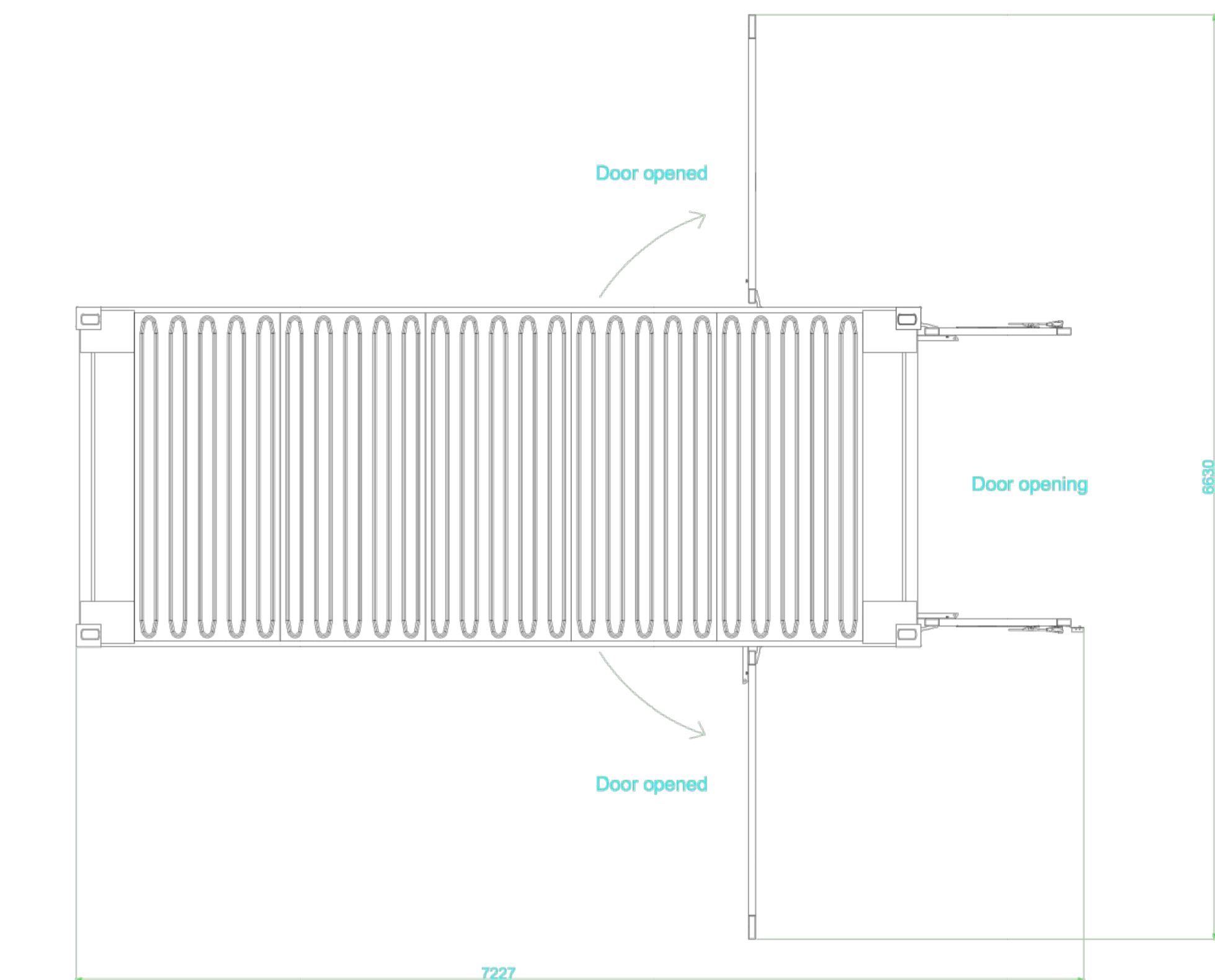

Foundation

Front View

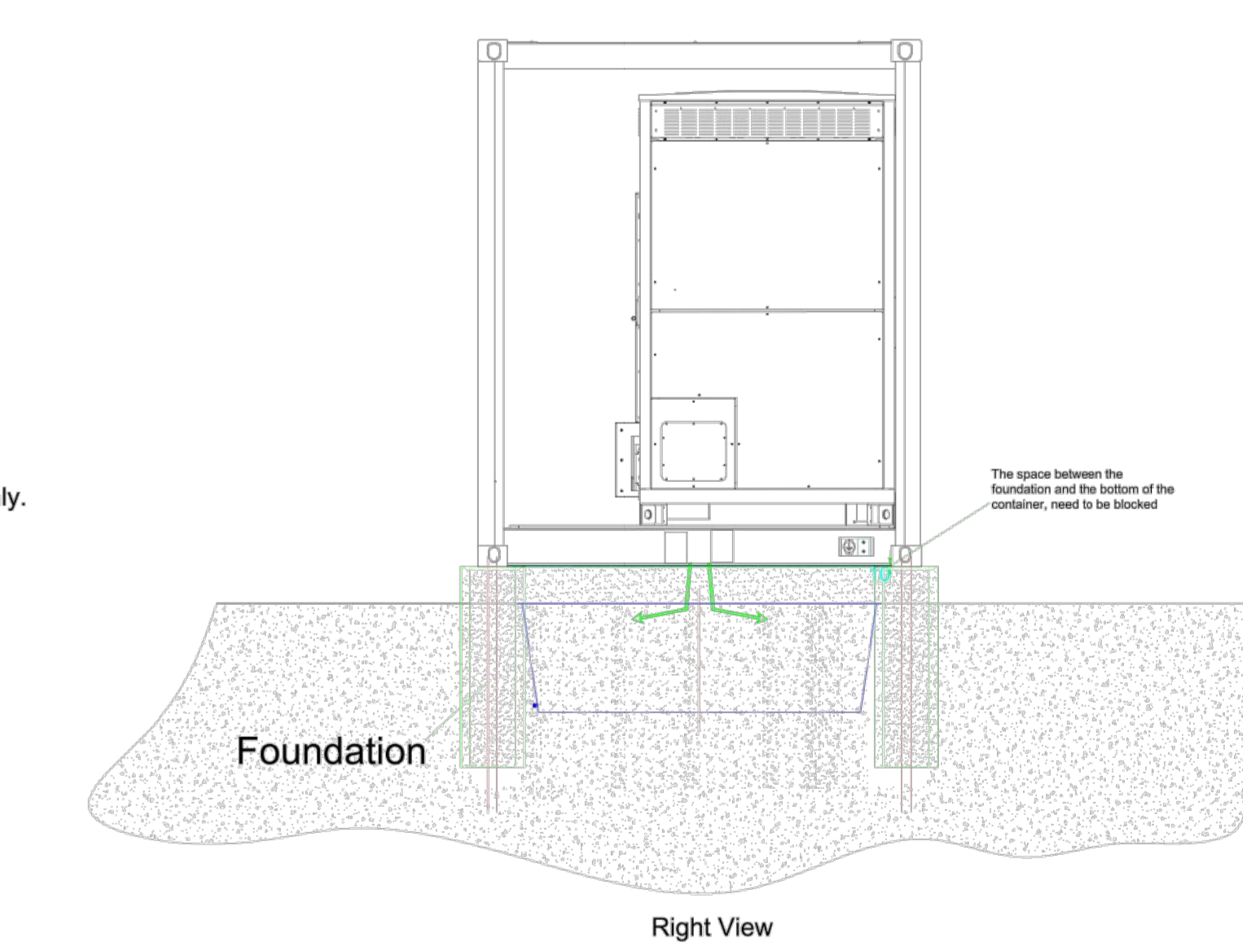

Foundation

Right View

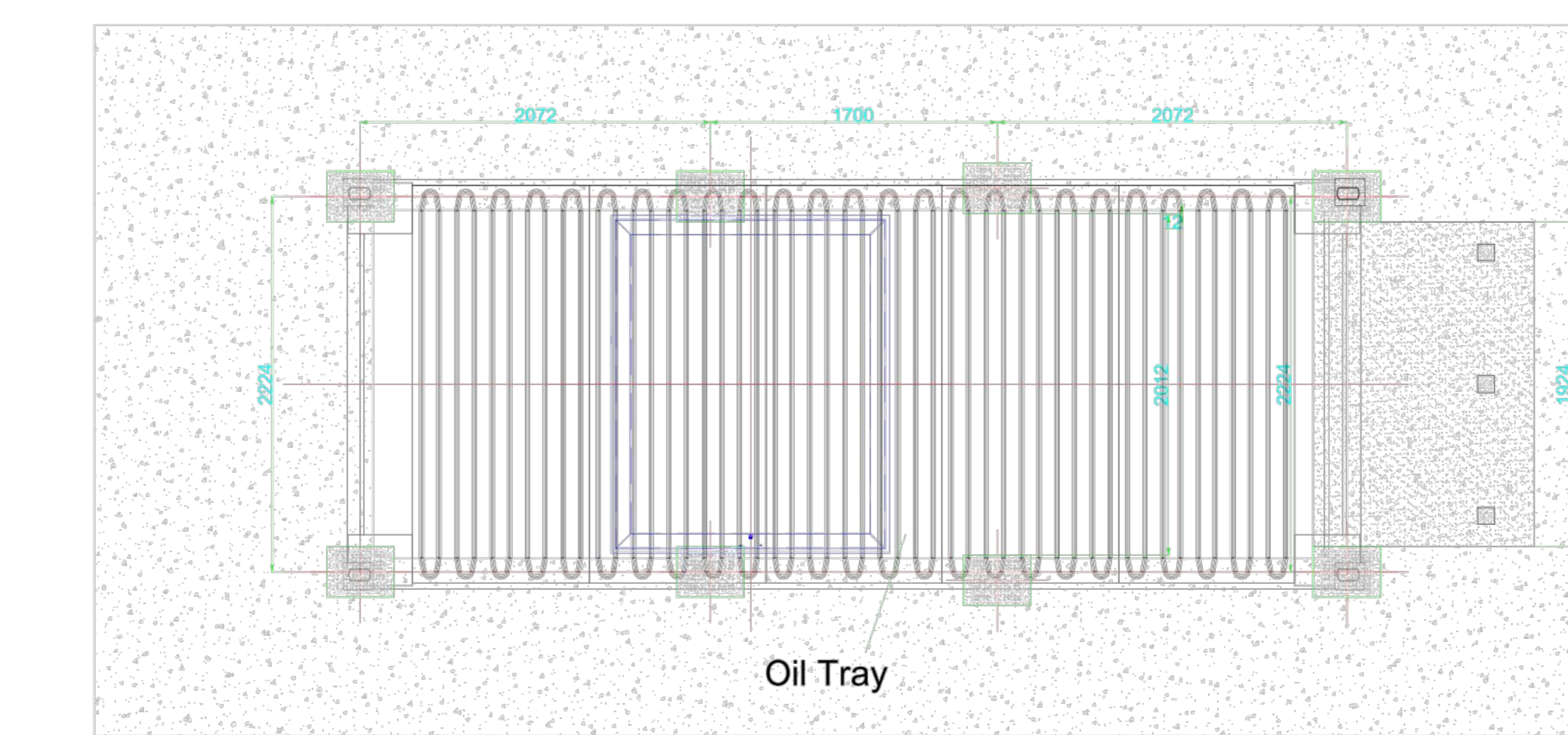

Oil Tray

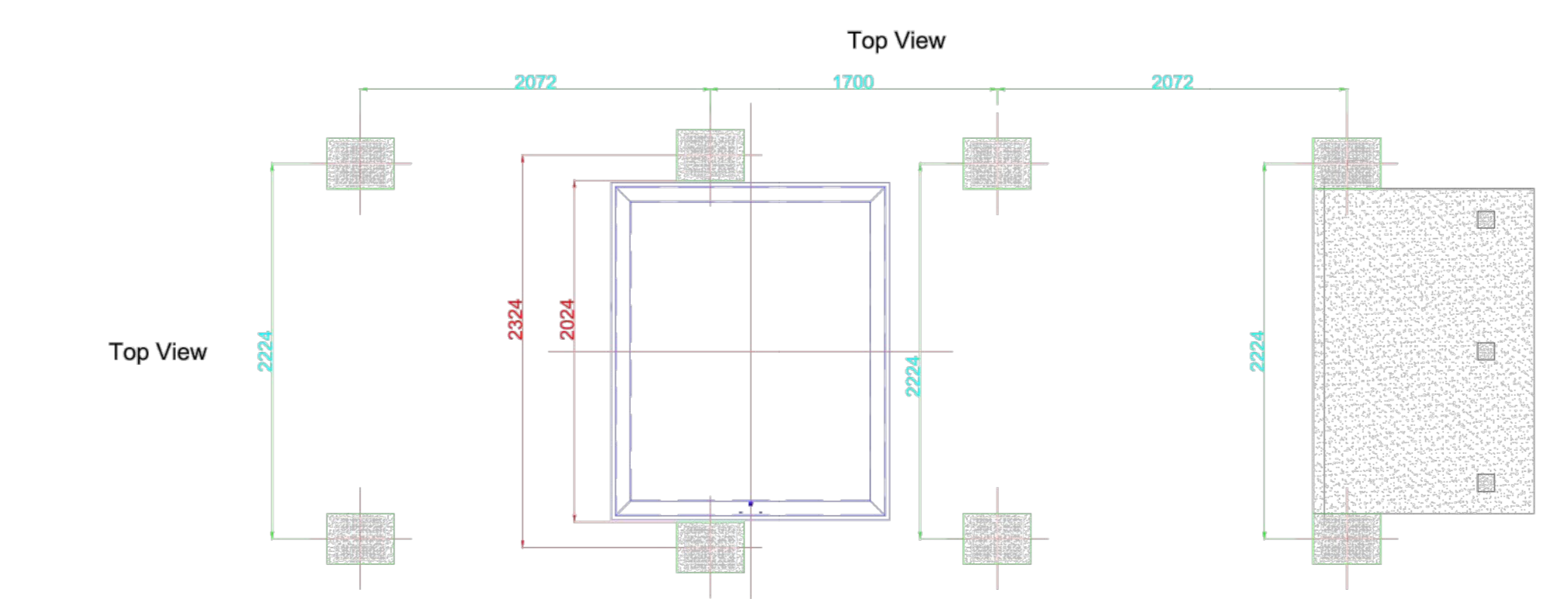

Top View

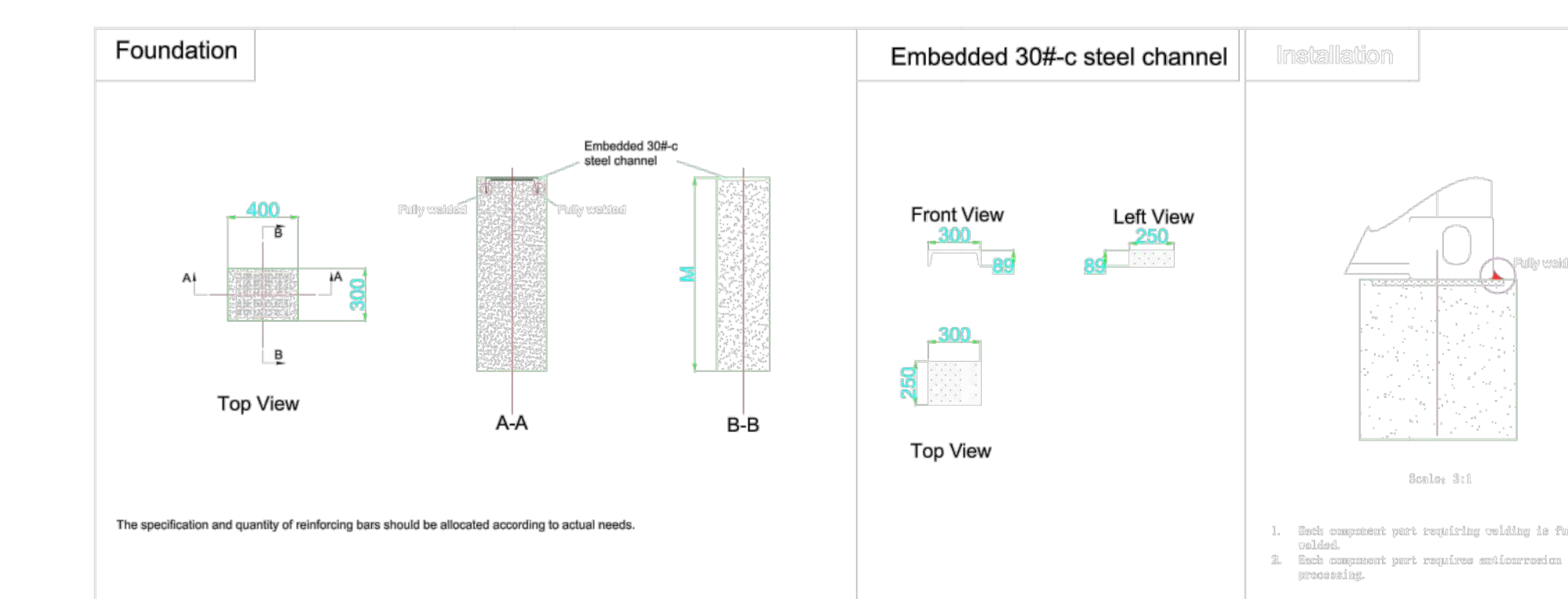

Foundation

Embedded 30M-c steel channel

Installation

Top View

Front View

Left View

Top View

enfinity energy for life

IMPIANTO FOTOVOLTAICO EG DOLOMITI SRL E OPERE CONNESSE

POTENZA IMPIANTO 58.5MWp

COMUNE DI ARGENTA (FE)

Proponente
EG DOLOMITI S.R.L.
VIA S. PIETRO 10, 41012 ARGENTA (FE) P.IVA 01789580361 P.EC: egdo-01789580361

Progettazione
META STUDIO S.R.L.
VIA S. PIETRO 10, 41012 ARGENTA (FE) P.IVA 02740480367 P.EC: meta-studio-02740480367

Collaboratori
Progettazione Generale: Ing. Corrado Pizzolotto Progettazione Elettrica: Ing. Andrea Fronteddu
Progettazione Civile e Strutturale: Ing. Paolo Lattini Progettazione Ambientale e Paesaggistica: Dott.ssa Eleonora Lananna
Coordinamento progettuale

Meta Studio S.R.L.
VIA S. PIETRO 10, 41012 ARGENTA (FE) P.IVA 02740480367 P.EC: meta-studio-02740480367

Titolo Elaborato
PROSPETTI, SEZIONI E PARTICOLARI COSTRUTTIVI IMPIANTISTICI STORAGE

LIVELLO PRODUZIONE CODICE ELABORATO FILENOME RIFERIMENTO DATA SCALA
PRODOTTO/DESVINATO TIT

Revisions

REV.	DATA	DESKINZIONE	ESEGIUTO	VERIFICATO	APPROVATO
1	27.08.2022		IN	IN	PC

COMUNE DI ARGENTA (FE) **enfinity** REGIONE EMILIA ROMAGNA