

ATTRAVERSAMENTO TUBAZIONE GAS

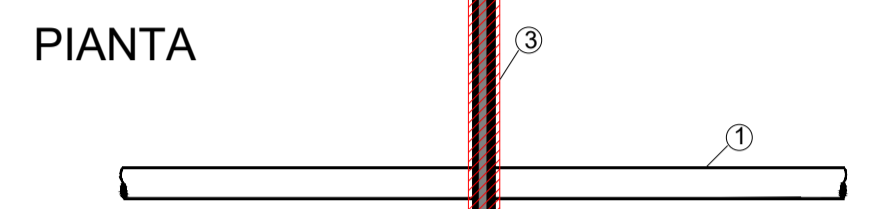

CAVO IN TUBO IN PVC
 ① TUBAZIONE GAS
 ② CAVIDOTTO AT
 ③ TUBO DI PROTEZIONE IN PVC

ATTRAVERSAMENTO TUBAZIONE ACQUA

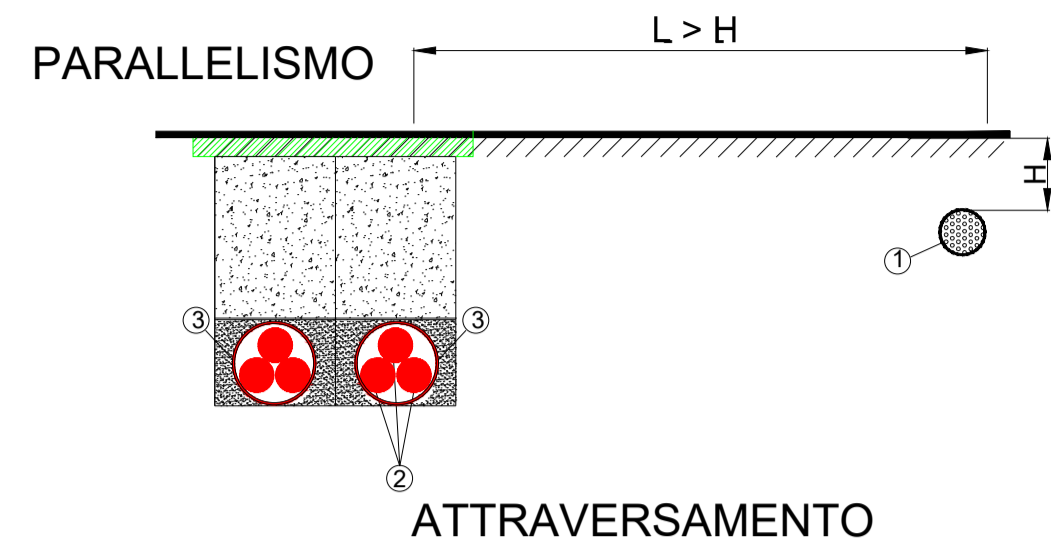
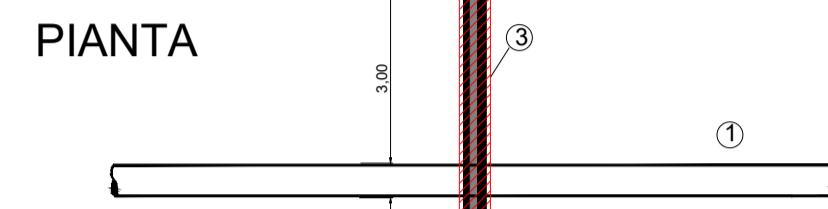
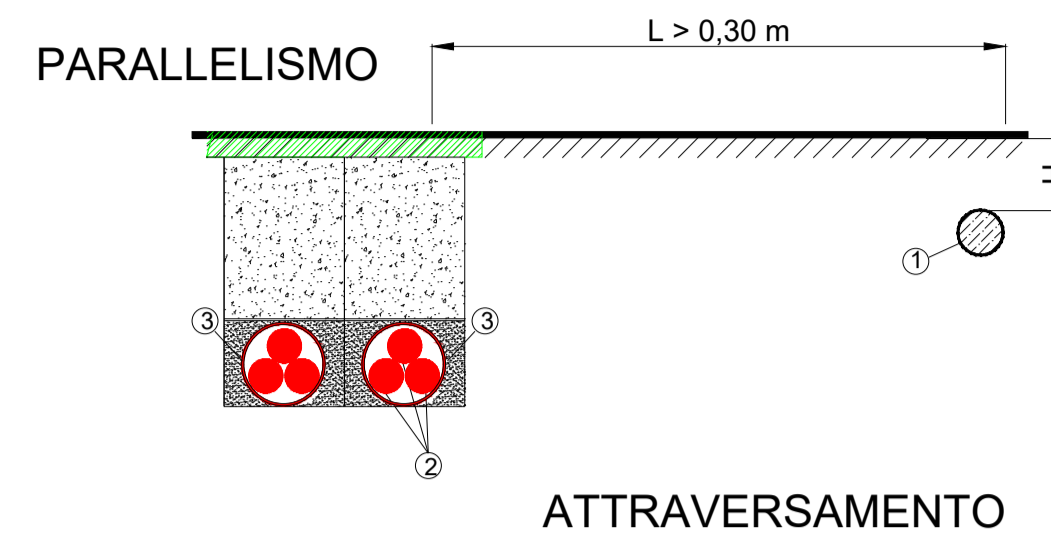

CAVO IN TUBO IN PVC
 ① TUBAZIONE ACQUA
 ② CAVIDOTTO AT
 ③ TUBO DI PROTEZIONE IN PVC

ATTRAVERSAMENTO CAVO TLC

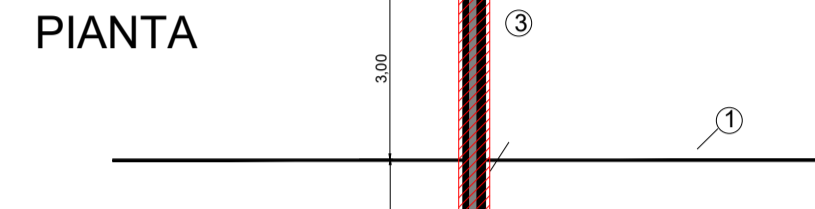
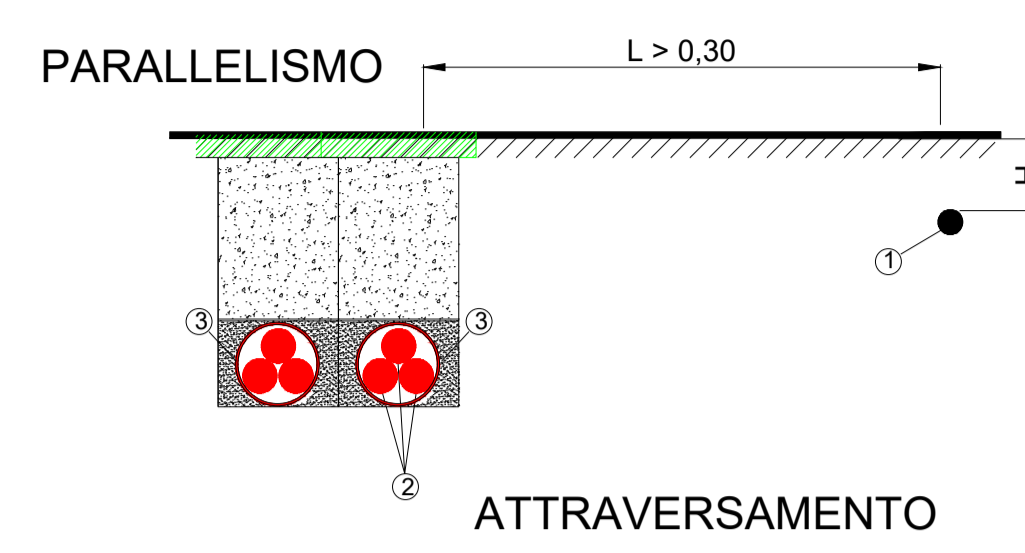

CAVO IN TUBO IN PVC
 ① CAVO TELECOMUNICAZIONE
 ② CAVIDOTTO AT
 ③ TUBO DI PROTEZIONE IN PVC

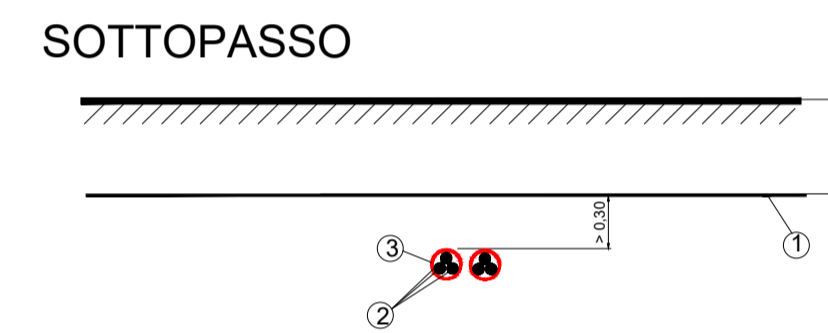
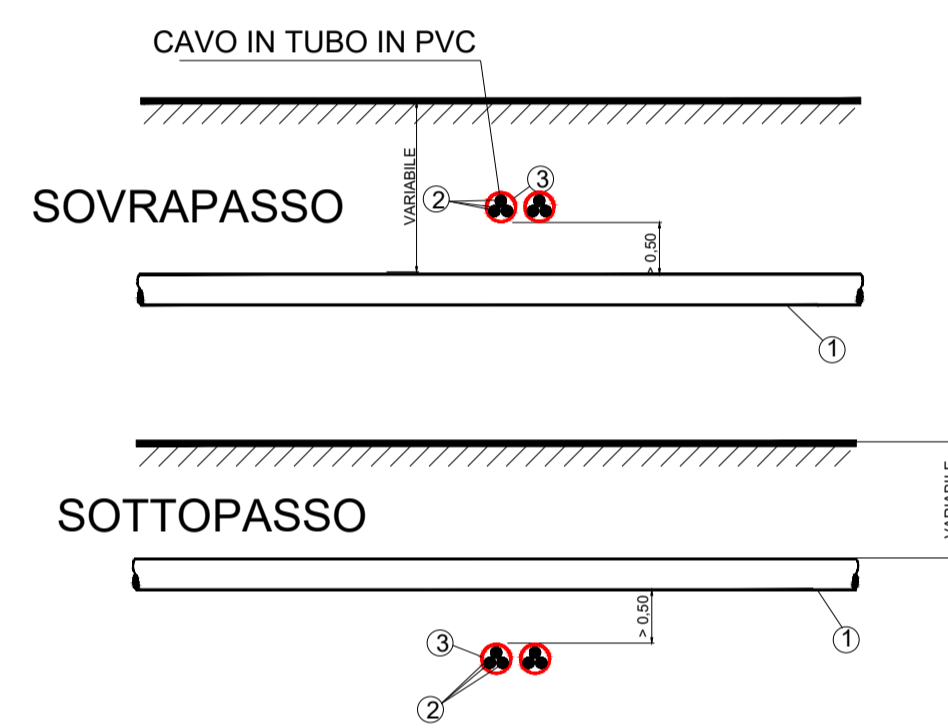
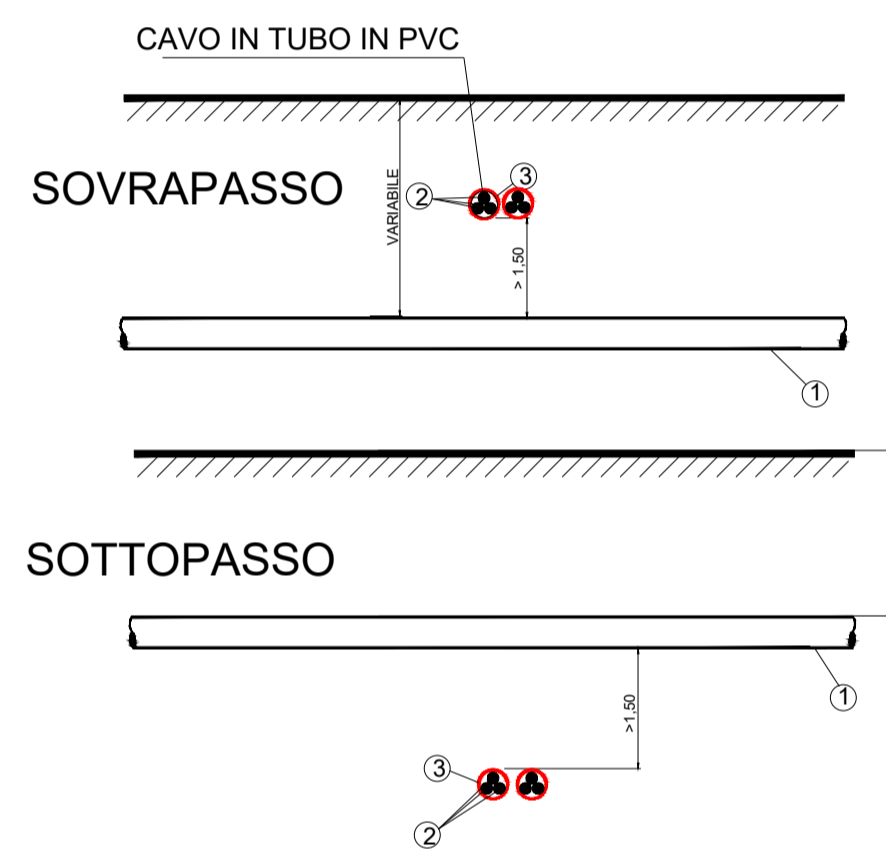

ATTRAVERSAMENTO CANALE-TRATTURO

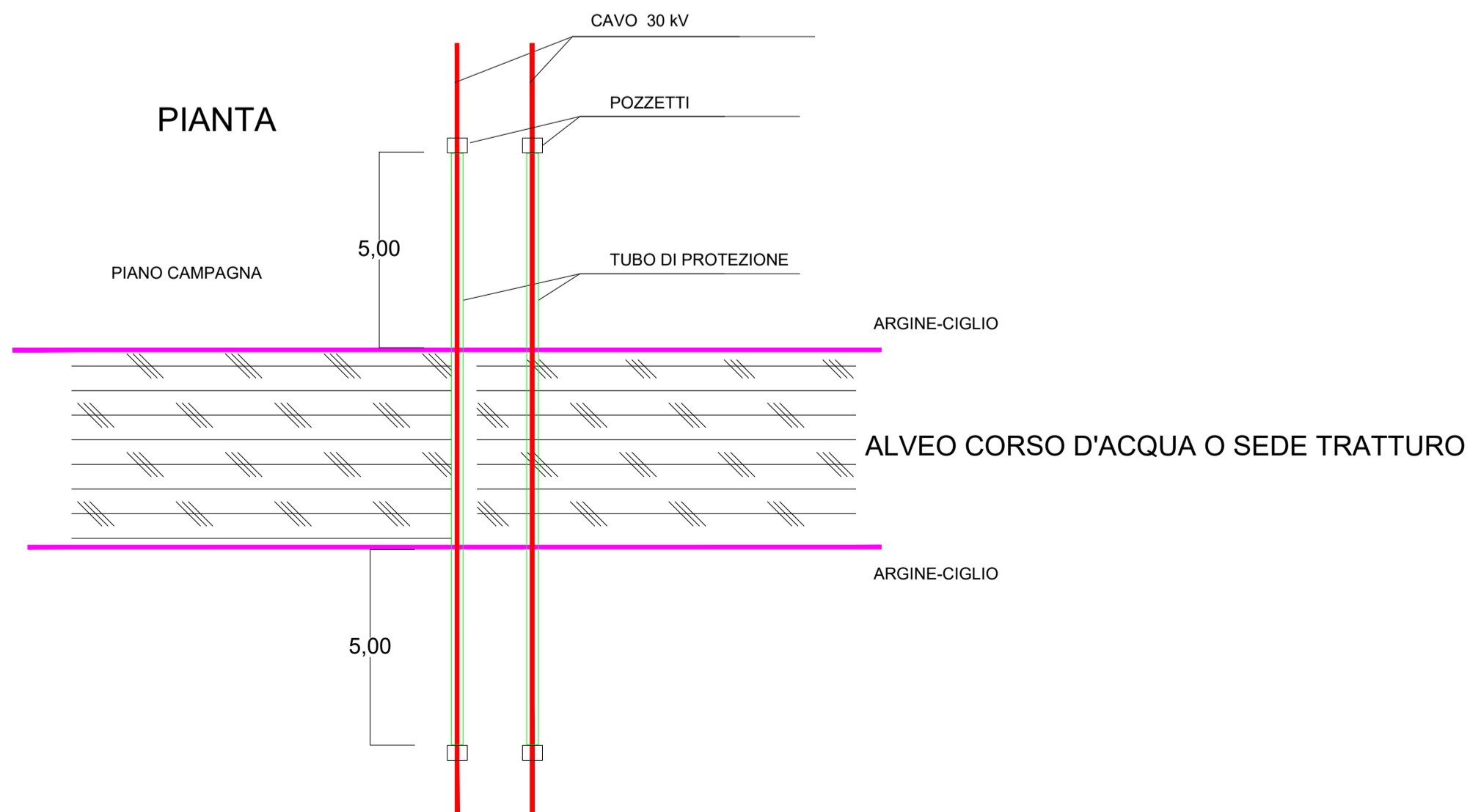
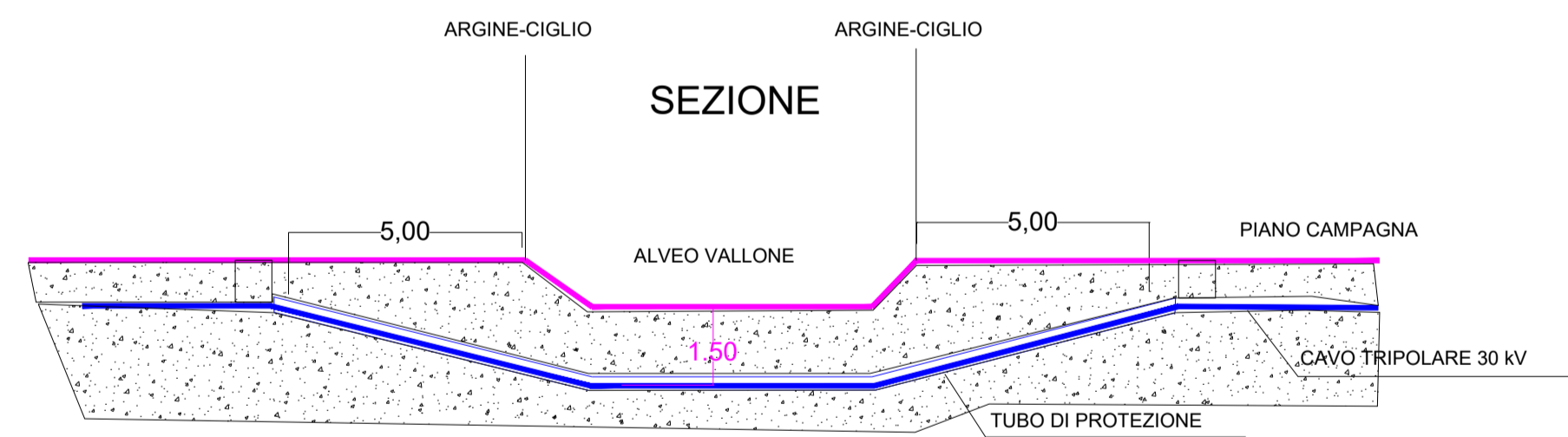

ATTRAVERSAMENTO FERROVIA

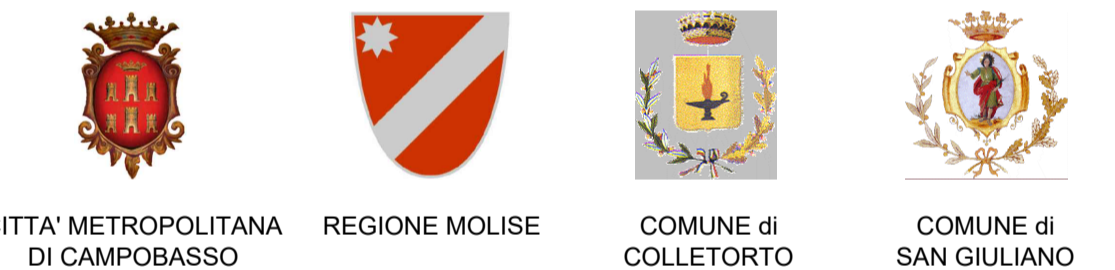
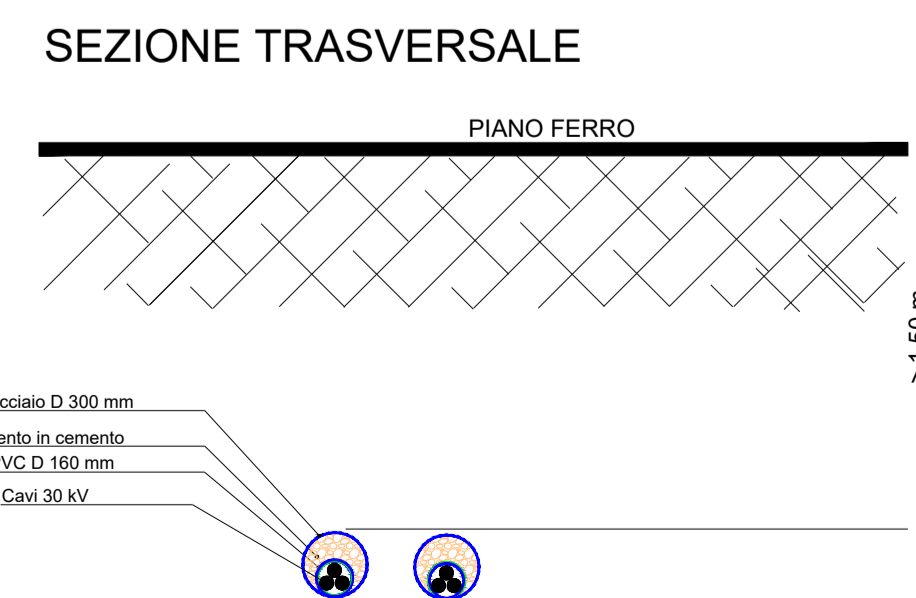
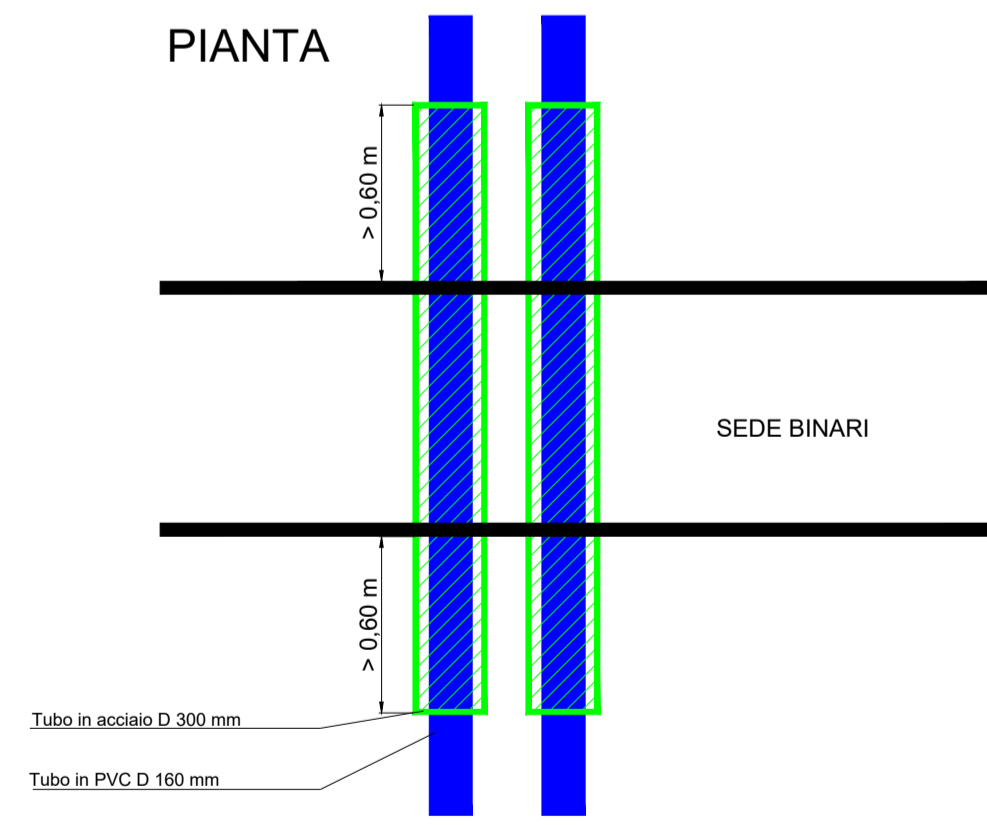

PROGETTO DEFINITIVO PER LA REALIZZAZIONE DI UN PARCO EOLICO NEI COMUNI DI COLLETORTO E SAN GIULIANO DI PUGLIA, CON OPERE DI CONNESSIONE IN SANTA CROCE DI MAGLIANO E ROTELLO

Proprietario: **GRV Wind Molise 1 S.r.l.**
 via Durini, 9 - 20122 Milano
 info@grvvalue.com

Progettazione: **INSE**
 Viale Michelangelo, 71
 80129 Napoli
 TEL. 081 579 7998
 mail: tecnica.inse@gmail.com

Autore: **INGEGNERI DELLA PROV. DI SAN GIULIANO**
 Ing. Nicola Galderisi
 Ing. Pasquale Esposito

Autore: **INGEGNERI DELLA PROV. DI SAN GIULIANO**
 Ing. V. Trunfo
 Ing. G. Diaburzio
 Arch. C. Cavallaro
 Geom. F. Malfarano
 Arch. M. Mauro

Nome Elaborato:					
TIPICI ATTRAVERSAMENTI INFRASTRUTTURE E SERVIZI					
00	15-12-2021	PRIMA EMISSIONE	INSE Srl	INSE Srl	GRV Wind Molise 1 srl
Rev.	Data	Oggetto della revisione	Elaborazione	Verifica	Approvazione
Scala:	-				
Formato:	A1	Codice Pratica	S239	Codice Elaborato	NS239-OEL06-D