

Recinzione - Scala 1:25

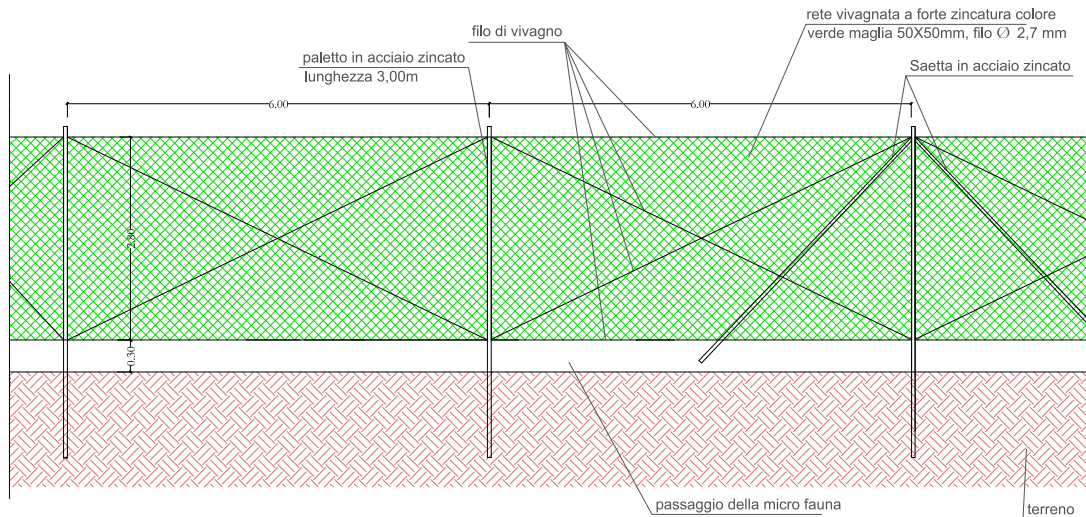

Cancello - Scala 1:25

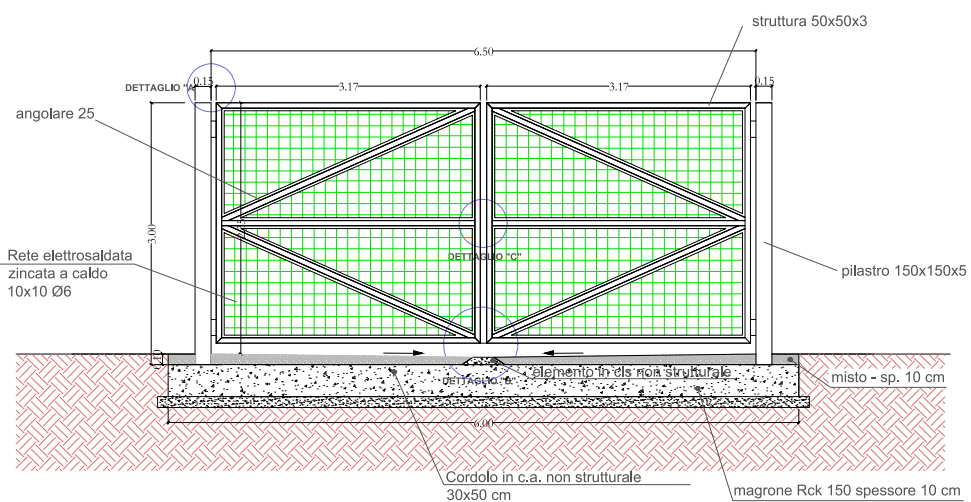

Pianta Tracker - Scala 1:100

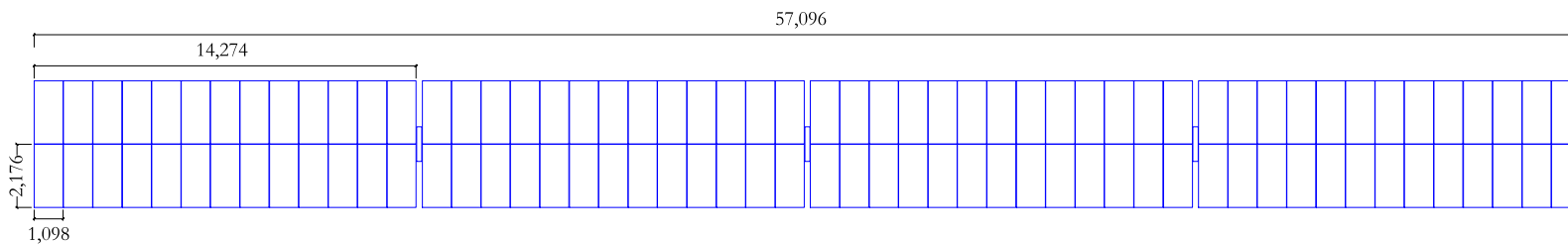

Sezione Tracker - Scala 1:100

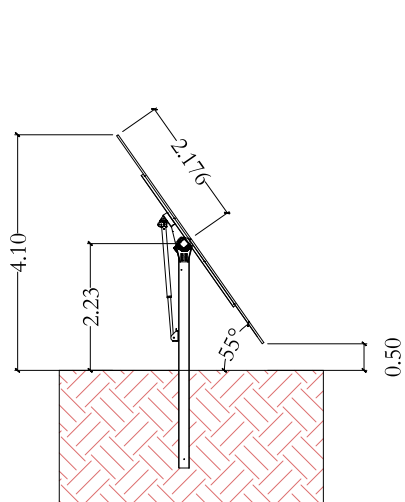

Video Sorveglianza e illuminazione

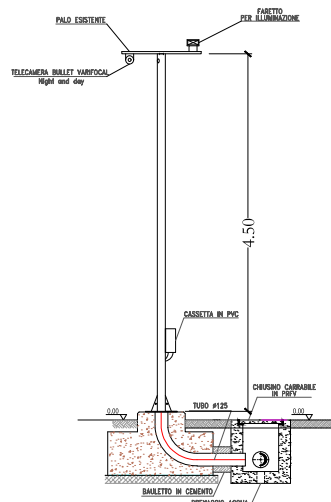

Profilo paletto in acciaio

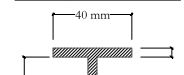

Profilo saetta

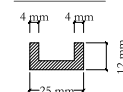

Particolare rete filo di vivagno

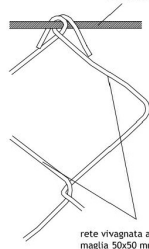

DETTAGLI CANCELLO

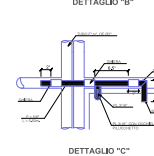
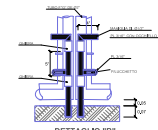
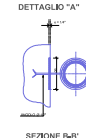
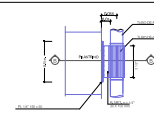

REGIONE SARDEGNA COMUNI DI PORTOSCUSO E GONNESSA

Titolo del progetto
 Progetto di costruzione ed esercizio di un impianto fotovoltaico della potenza di 13,793 MWp da realizzarsi nel comune di Portoscuso e Gonnessa (SU) con le relative opere di connessione elettriche
Denominato "Cirfini"

Proponente



Queoquery Renewables
 Unit 3.21 - 1110 Great West Road - TW8 OGP, London

ecenergy
 Powering renewables.

Ecosardina 2 S.r.l.
 Via Manzoni 30 - Milano (MI)

Titolo elaborato

Particolari costruttivi Trackers, Recinzione, Cancello

Timbro e firma progettista



Codice elaborato

PV016-ELB023

Stato del progetto

Definitivo

Ingegneria

intellienergia
 ENERGY ENGINEERING

Sede legale e operativa - Roma:
 Via Giacomo Perini n.652, 00131
 Roma tel. 06/21126934
 Sede operativa - Macerata:
 Strada Cicerone 26, 02100 - Macerata
 tel. 0733/1990394 - fax 0733/1990394
 info@intellienergia.com - www.intellienergia.com
 p.iva/c.a.: 10619391005 - REA 1244731 - cap. soc. 25.000 euro i.v.

Rev.	Descrizione	Data	Redatto	Verificato	Approvato
00	Emissione	15/04/2022	Ing. G. Cappozzi	Ing. M. Antonini	Ing. A. Zanini