



REGIONE PUGLIA
 PROVINCIA DI FOGGIA
 COMUNI DI FOGGIA E MANFREDONIA



PROGETTO IMPIANTO SOLARE AGRO-VOLTAICO DA
 REALIZZARE NEL COMUNE DI FOGGIA (FG) C.DA TITOLO, E
 RELATIVE OPERE DI CONNESSIONE NEL COMUNE DI
 MANFREDONIA, DI POTENZA PARI A **62.452,04 kWp**,
 DENOMINATO "**FOGGIA - MANFREDONIA**"

PROGETTO DEFINITIVO

PARTICOLARI ARCHITETTONICI CABINE IMPIANTO
 FOTOVOLTAICO



| livello prog. | Codice Pratica STMG | N° elaborato | DATA | SCALA |
|---------------|---------------------|---------------|------------|-------|
| PD | 201901116 | VF6FYQ3_D11.1 | 15.09.2021 | 1:100 |

REVISIONI

| REV. | DATA | DESCRIZIONE | ESEGUITO | VERIFICATO | APPROVATO |
|------|------|-------------|----------|------------|-----------|
| | | | | | |

RICHIEDENTE E PRODUTTORE
HF Solar 3 S.r.l.



ENTE

PROGETTAZIONE

HORIZONFIRM

Viale Francesco Scaduto n°2/D - 90144 Palermo (PA)

Arch. A. Calandrino
 Arch. M. Gullo
 Arch. S. Martorana
 Arch. F. G. Mazzola
 Arch. G. Vella
 Arch. Y. Kokalah

Ing. D. Siracusa
 Ing. A. Costantino
 Ing. C. Chiaruzzi
 Ing. G. Schillaci
 Ing. G. Buffa



Il Progettista

Il Progettista

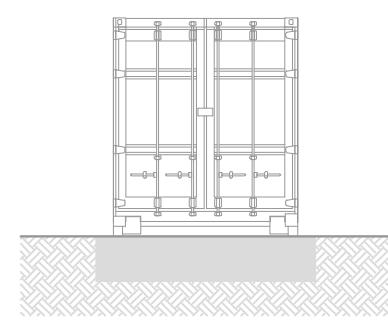
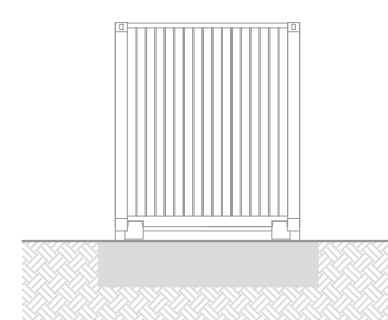
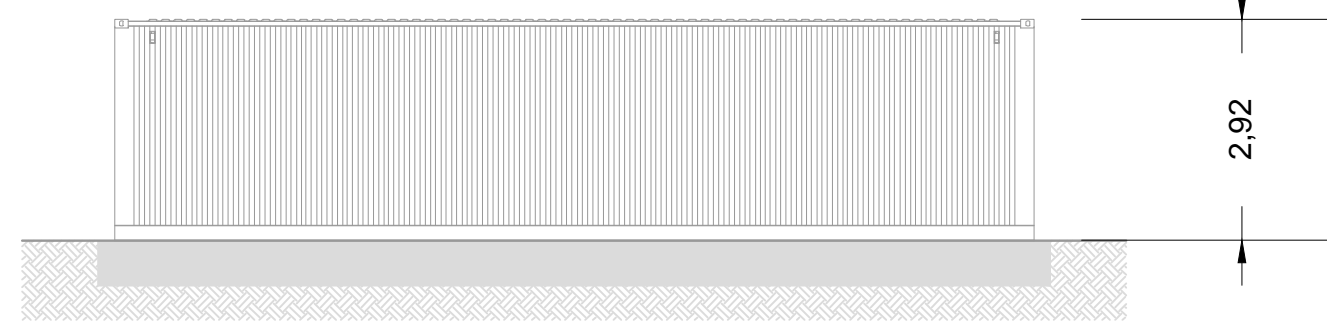
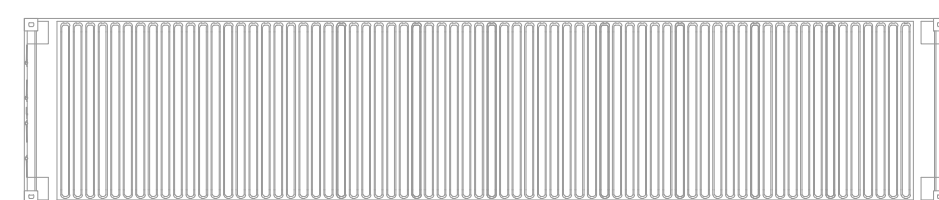
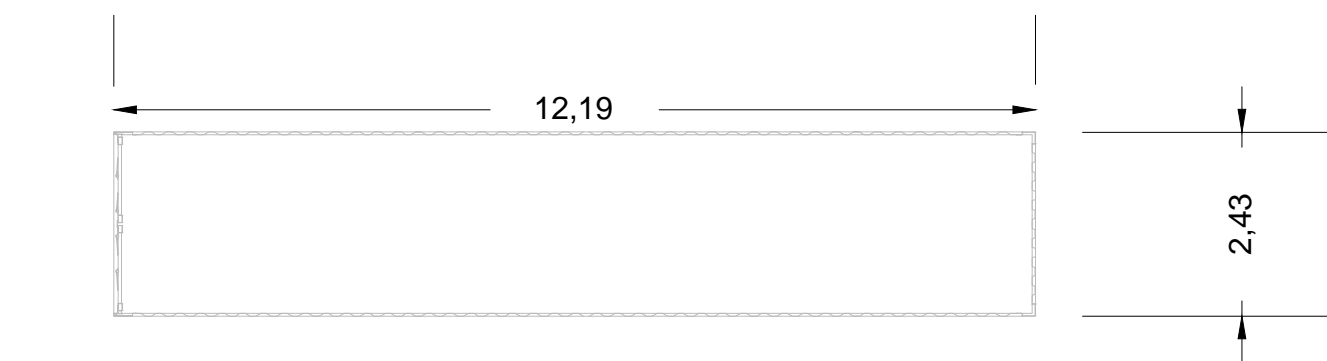

Power Station 40' High Cube

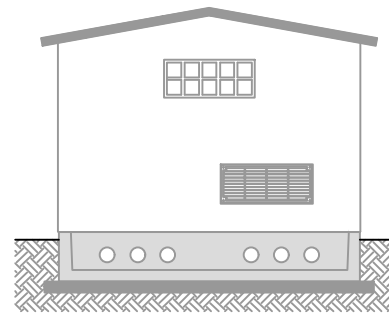
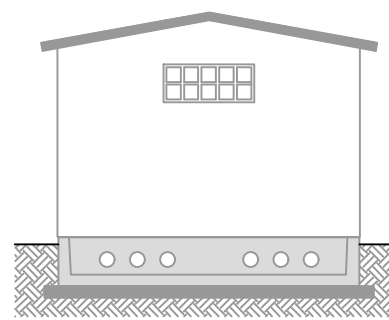
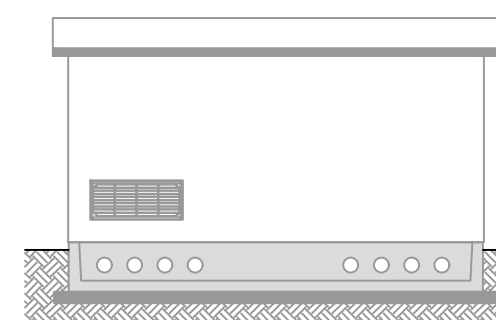
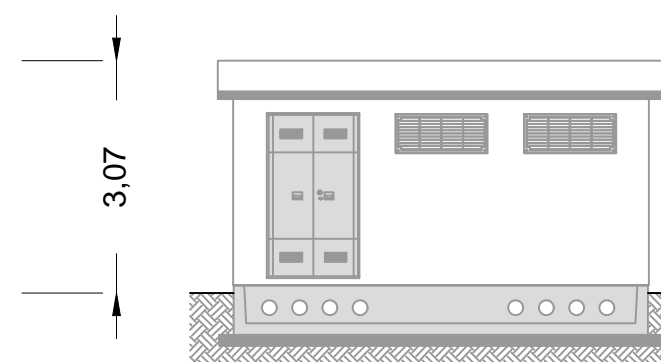
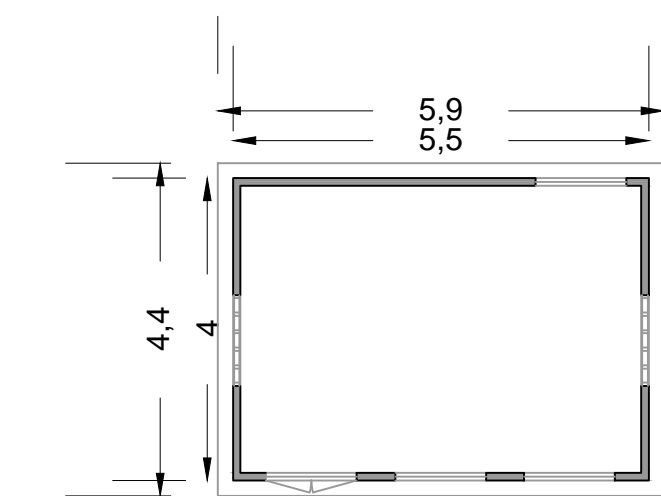

Tipico Locale tecnico in CAV

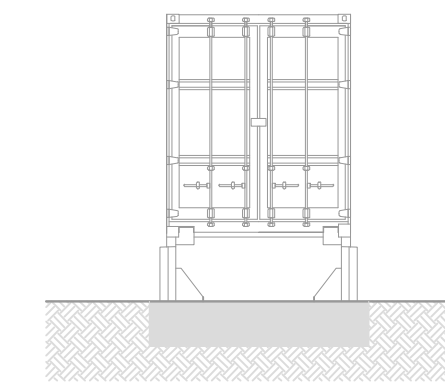
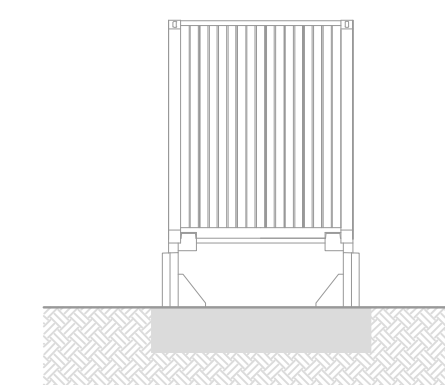
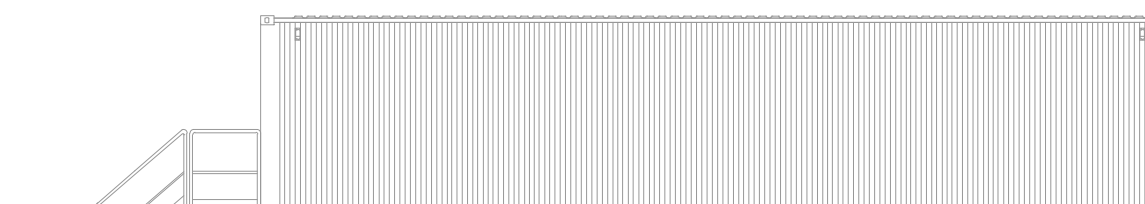
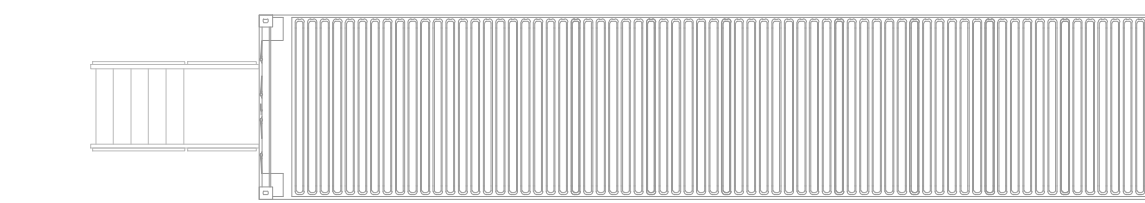

Ipotesi sopraelevazione Power station