

Profilo
Km 15+302.00 - 16+292.80
Scala : 2000:200
Q.Rif. : 150.00

NUMERO SEZIONE	DISTANZE PROGRESSIVE	QUOTE PROGETTO	QUOTE TERRENO	DIFFERENZA QUOTE	ANDAM. PLANIMETRICO	ANDAMENTO CIGLI
767	15+320.00	157.86	157.86	0.00	L=83.33m A=250.00	L=31.83 A=4.98
768	15+340.00	158.27	158.27	0.00	R=121.17m R=750.00m	L=31.83 A=4.98
769	15+360.00	158.64	158.64	0.00		L=31.83 A=4.98
770	15+380.00	158.95	158.95	0.00		L=31.83 A=4.98
771	15+400.00	159.21	159.21	0.00		L=31.83 A=4.98
772	15+420.00	159.44	159.44	0.00		L=31.83 A=4.98
773	15+440.00	159.67	159.67	0.00		L=31.83 A=4.98
774	15+460.00	159.77	159.77	0.00		L=31.83 A=4.98
775	15+480.00	159.71	159.71	0.00		L=31.83 A=4.98
776	15+500.00	159.54	159.54	0.00		L=31.83 A=4.98
777	15+520.00	159.20	159.20	0.00		L=31.83 A=4.98
778	15+540.00	158.54	158.54	0.00		L=31.83 A=4.98
779	15+560.00	157.39	157.39	0.00		L=31.83 A=4.98
780	15+580.00	155.80	155.80	0.00		L=31.83 A=4.98
781	15+600.00	154.00	154.00	0.00		L=31.83 A=4.98
782	15+620.00	152.00	152.00	0.00		L=31.83 A=4.98
783	15+640.00	150.00	150.00	0.00		L=31.83 A=4.98
784	15+660.00	148.00	148.00	0.00		L=31.83 A=4.98
785	15+680.00	146.00	146.00	0.00		L=31.83 A=4.98
786	15+700.00	144.00	144.00	0.00		L=31.83 A=4.98
787	15+720.00	142.00	142.00	0.00		L=31.83 A=4.98
788	15+740.00	140.00	140.00	0.00		L=31.83 A=4.98
789	15+760.00	138.00	138.00	0.00		L=31.83 A=4.98
790	15+780.00	136.00	136.00	0.00		L=31.83 A=4.98
791	15+800.00	134.00	134.00	0.00		L=31.83 A=4.98
792	15+820.00	132.00	132.00	0.00		L=31.83 A=4.98
793	15+840.00	130.00	130.00	0.00		L=31.83 A=4.98
794	15+860.00	128.00	128.00	0.00		L=31.83 A=4.98
795	15+880.00	126.00	126.00	0.00		L=31.83 A=4.98
796	15+900.00	124.00	124.00	0.00		L=31.83 A=4.98
797	15+920.00	122.00	122.00	0.00		L=31.83 A=4.98
798	15+940.00	120.00	120.00	0.00		L=31.83 A=4.98
799	15+960.00	118.00	118.00	0.00		L=31.83 A=4.98
800	15+980.00	116.00	116.00	0.00		L=31.83 A=4.98
801	16+000.00	114.00	114.00	0.00		L=31.83 A=4.98
802	16+020.00	112.00	112.00	0.00		L=31.83 A=4.98
803	16+040.00	110.00	110.00	0.00		L=31.83 A=4.98
804	16+060.00	108.00	108.00	0.00		L=31.83 A=4.98
805	16+080.00	106.00	106.00	0.00		L=31.83 A=4.98
806	16+100.00	104.00	104.00	0.00		L=31.83 A=4.98
807	16+120.00	102.00	102.00	0.00		L=31.83 A=4.98
808	16+140.00	100.00	100.00	0.00		L=31.83 A=4.98
809	16+160.00	98.00	98.00	0.00		L=31.83 A=4.98
810	16+180.00	96.00	96.00	0.00		L=31.83 A=4.98
811	16+200.00	94.00	94.00	0.00		L=31.83 A=4.98
812	16+220.00	92.00	92.00	0.00		L=31.83 A=4.98
813	16+240.00	90.00	90.00	0.00		L=31.83 A=4.98
814	16+260.00	88.00	88.00	0.00		L=31.83 A=4.98

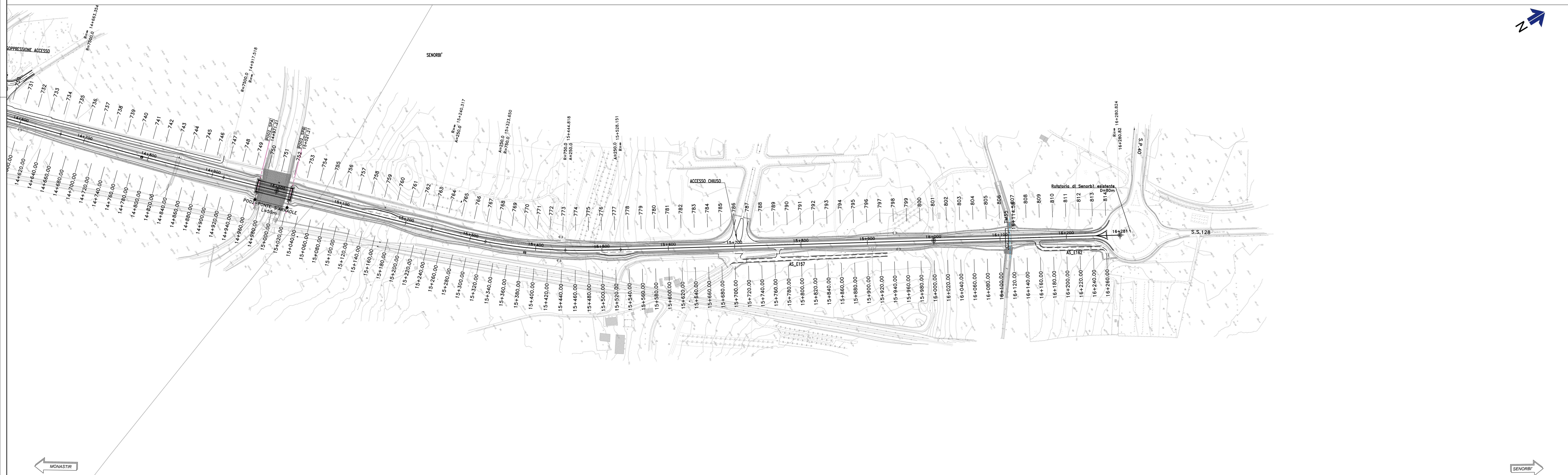
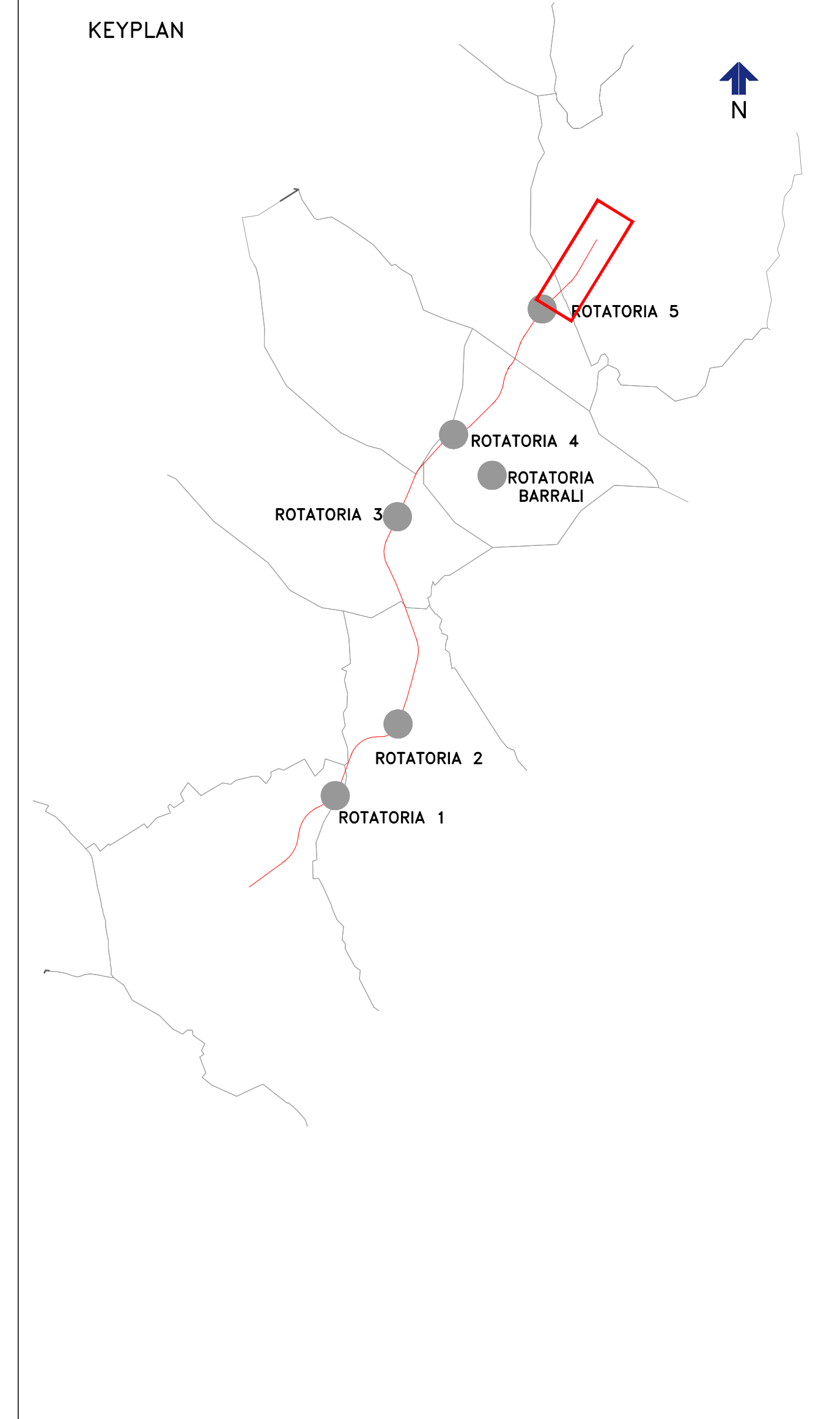

Sanas
GRUPPO FS ITALIANE
Direzione Progettazione e Realizzazione Lavori

S.S. n.128 "Centrale Sarda"
Lotto 0 bivio Monastir - bivio Senorbi
1° stralcio dal km 0+200 al km 16+700

PROGETTO DEFINITIVO
COD. CA356

PROGETTAZIONE: ANI VIA - SERING - VAP - BREGO

PROGETTISTA E RESPONSABILE DELL'INTEGRAZIONE DELLE PRESTAZIONI SPECIALISTICHE:
Gruppo di Progettazione
RESPONSABILI D'AREA:
INGEGNERIA
SERING INGEGNERIA

PROGETTO STRADALE
ASSE PRINCIPALE
PLANIMETRIA E PROFILO DI PROGETTO
Tav.08

CODICE PROGETTO	UV. PROJ. ANNO	NOME FILE	REVISIONE	SCALA:
DPCA0356	D 21	CA356_P00PSOOTRAPFD1-08_A	A	1:2000/200

REV.	DESCRIZIONE	DATA	REDATTO	VERIFICATO	APPROVATO
A	EMISSIONE	NOV 2021	G. GERRARDI	M. GERRARDI	F. MOHARRELLI