

Pianta cabine tipo

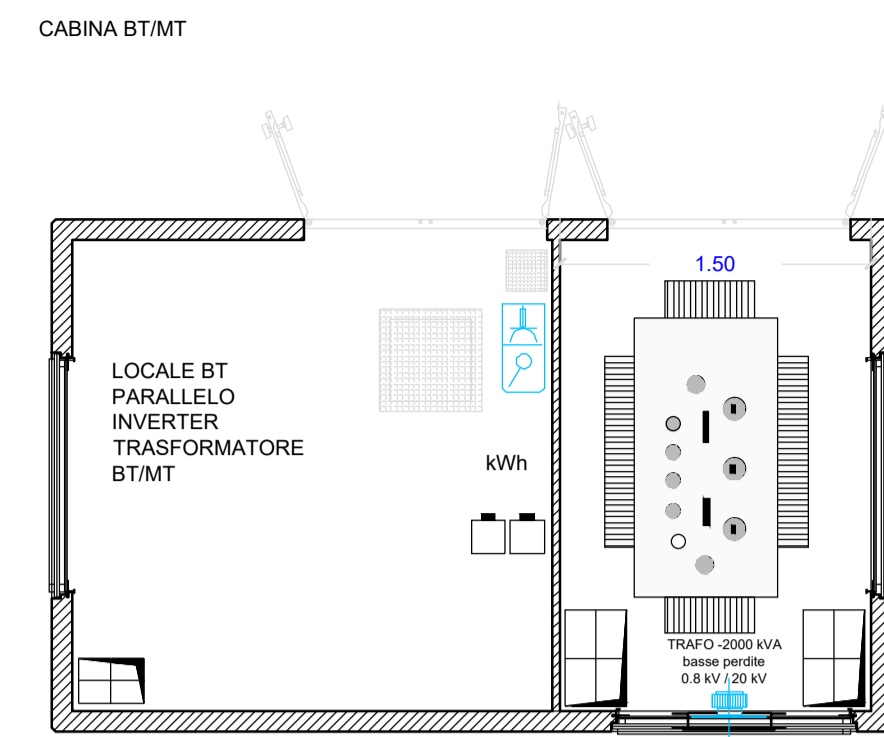

Prospetti cabine tipo

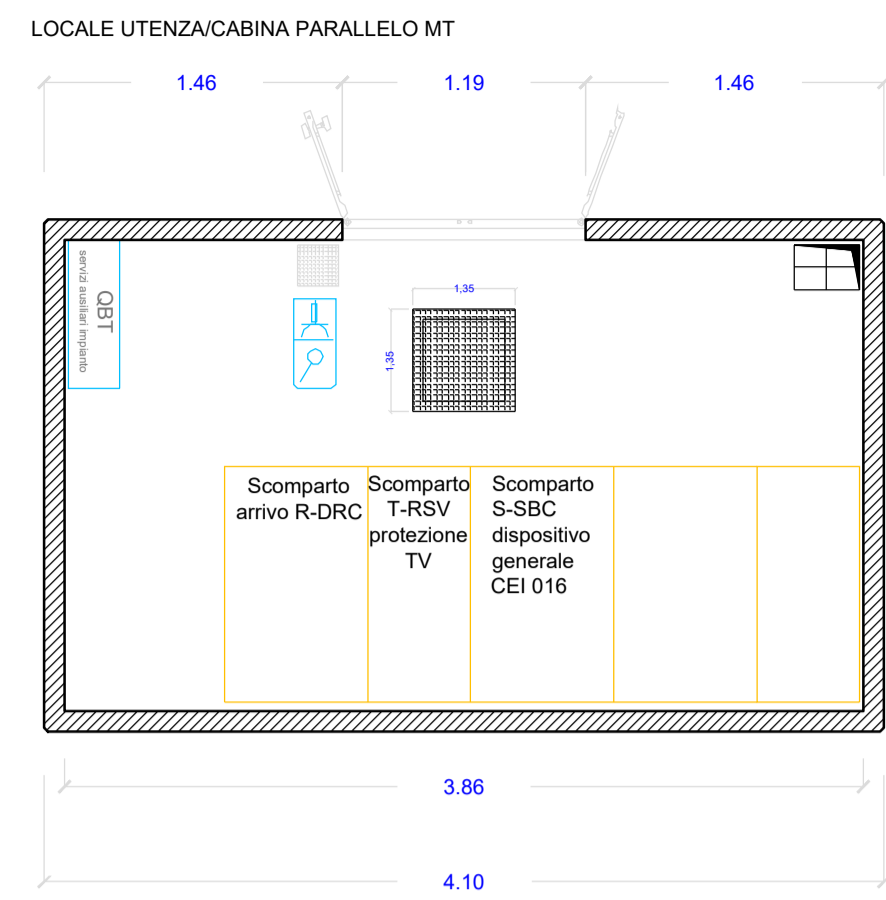
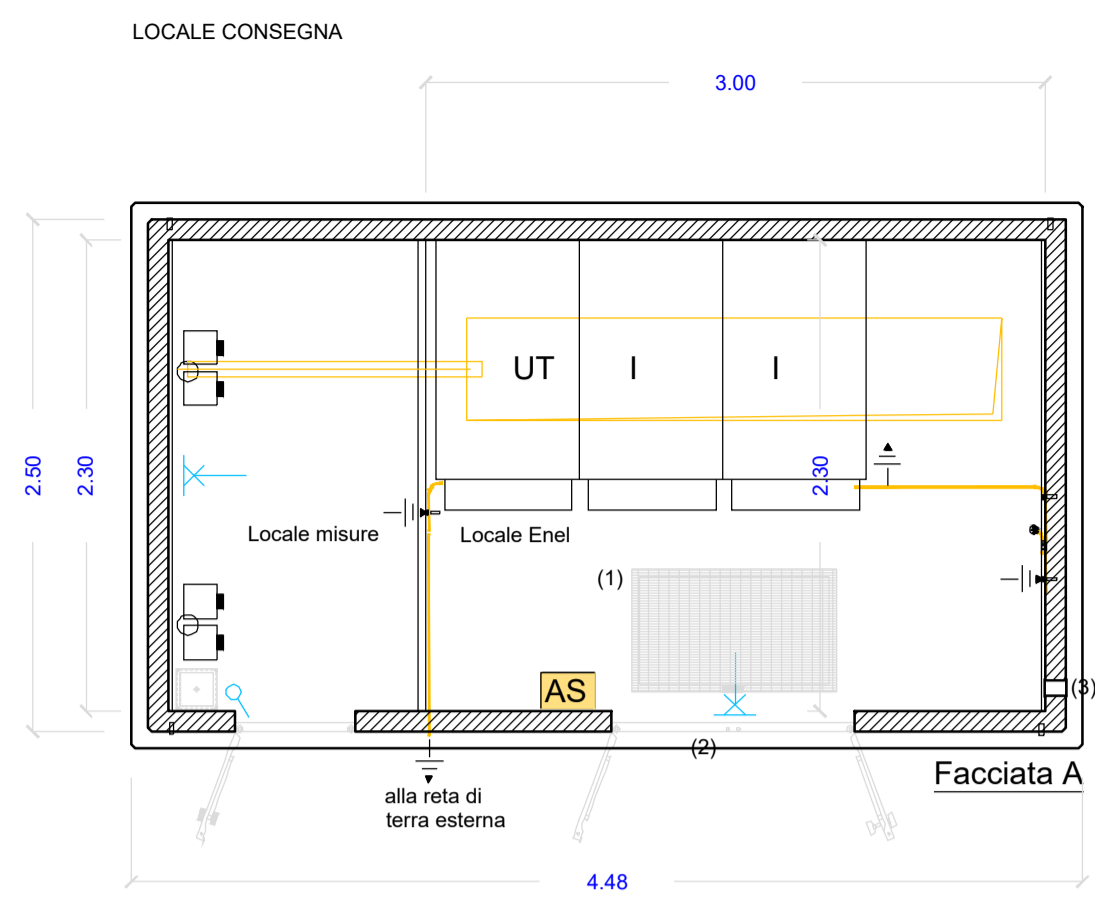
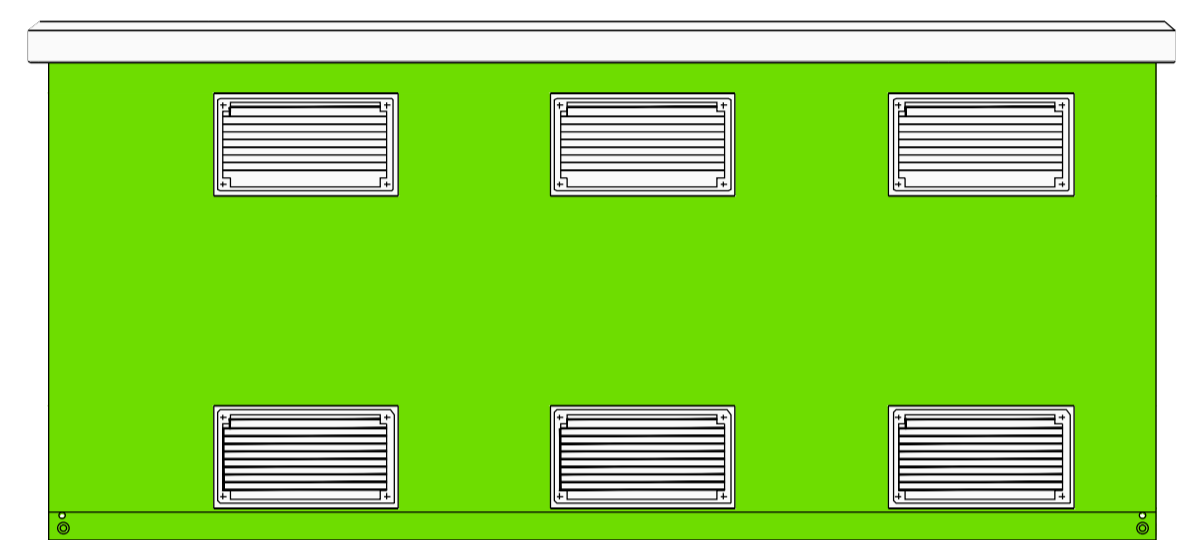
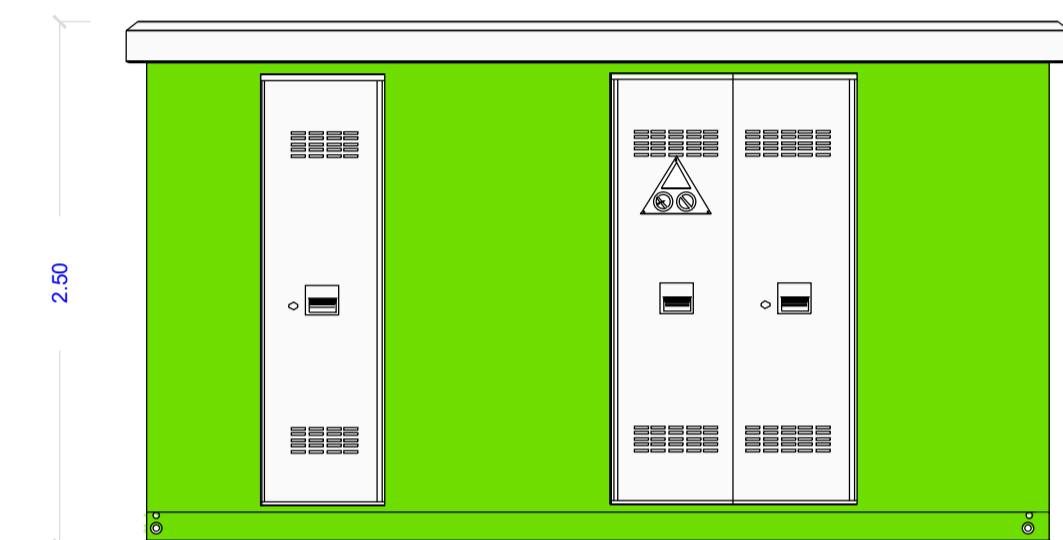

Pianta sotto-cabina tipo

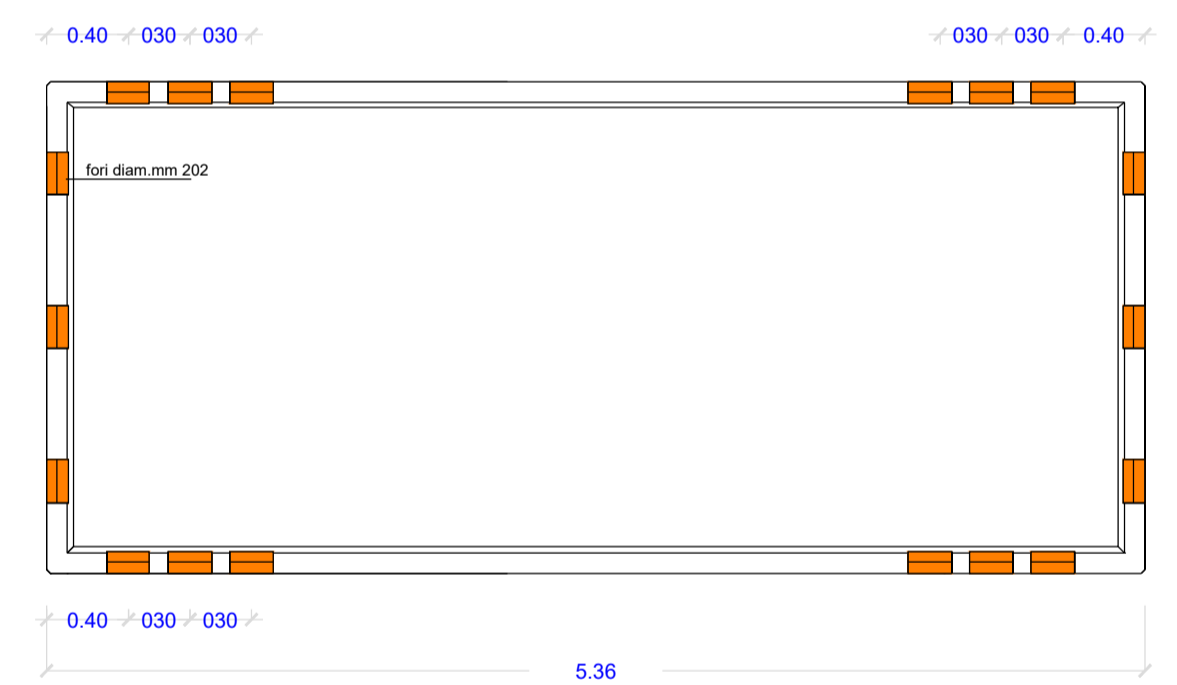
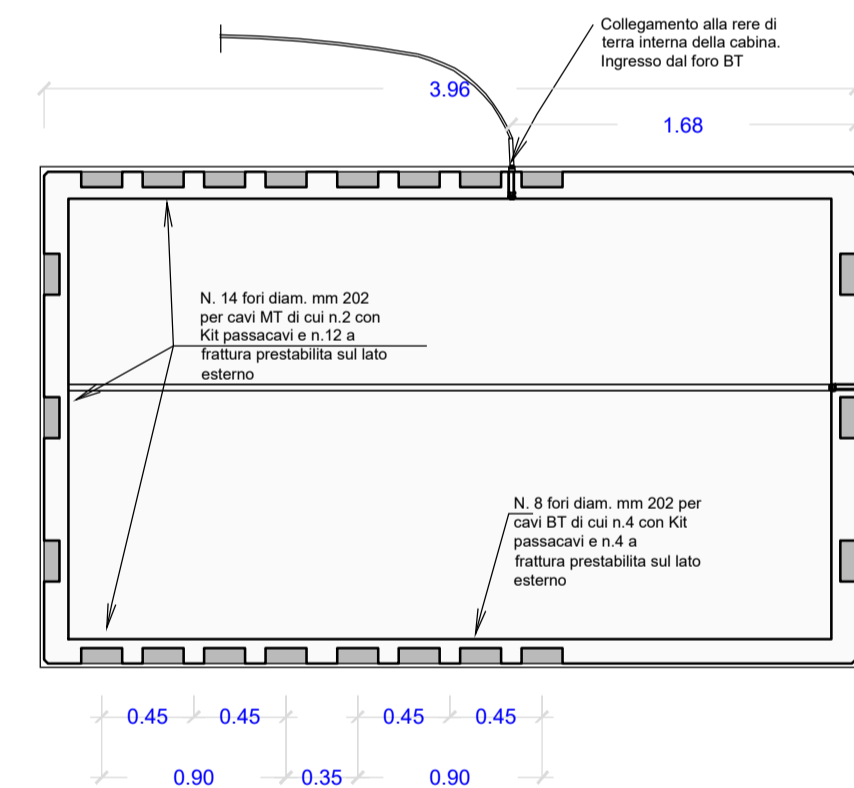
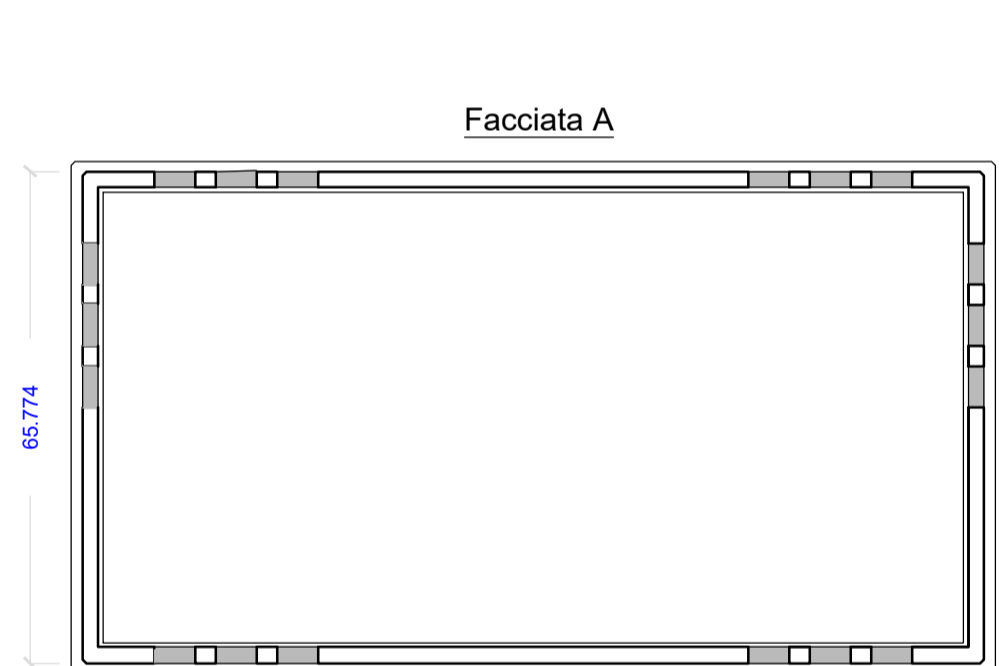

Prospetti sotto-cabina tipo

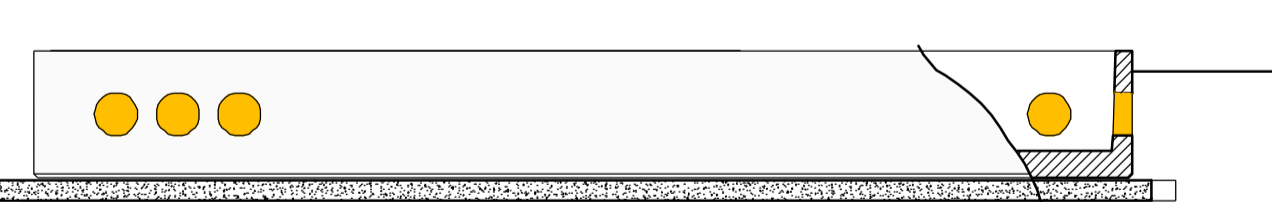
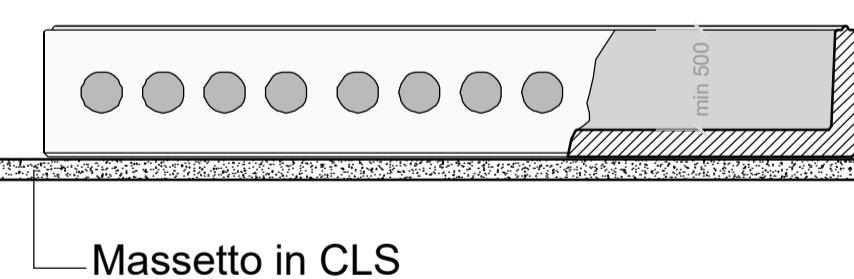
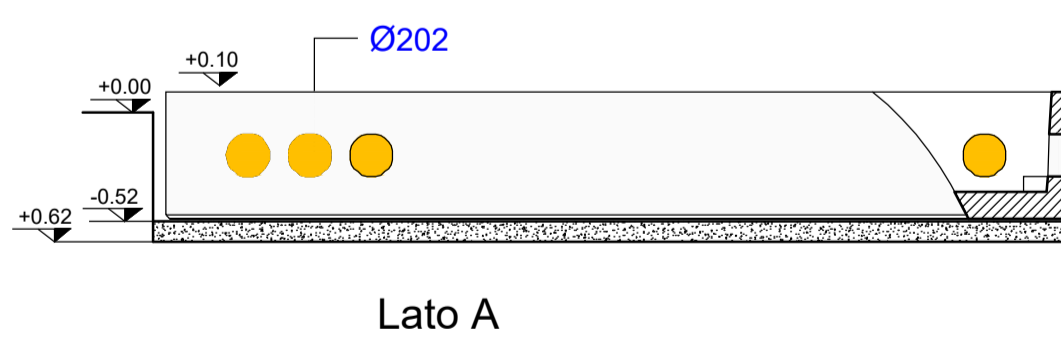

Sezione cabina tipo

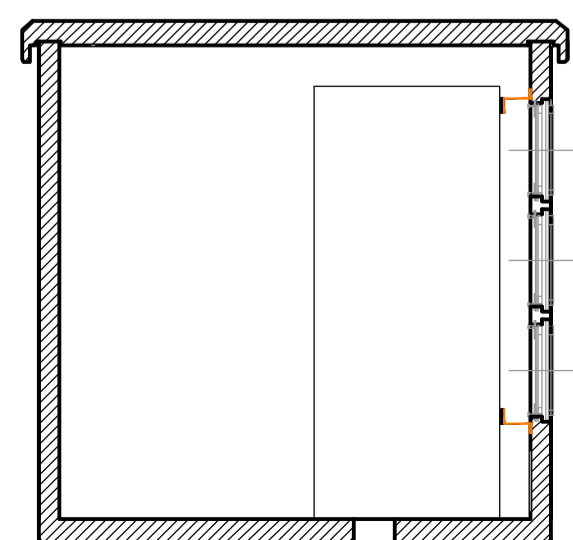

Assonometria cabina tipo

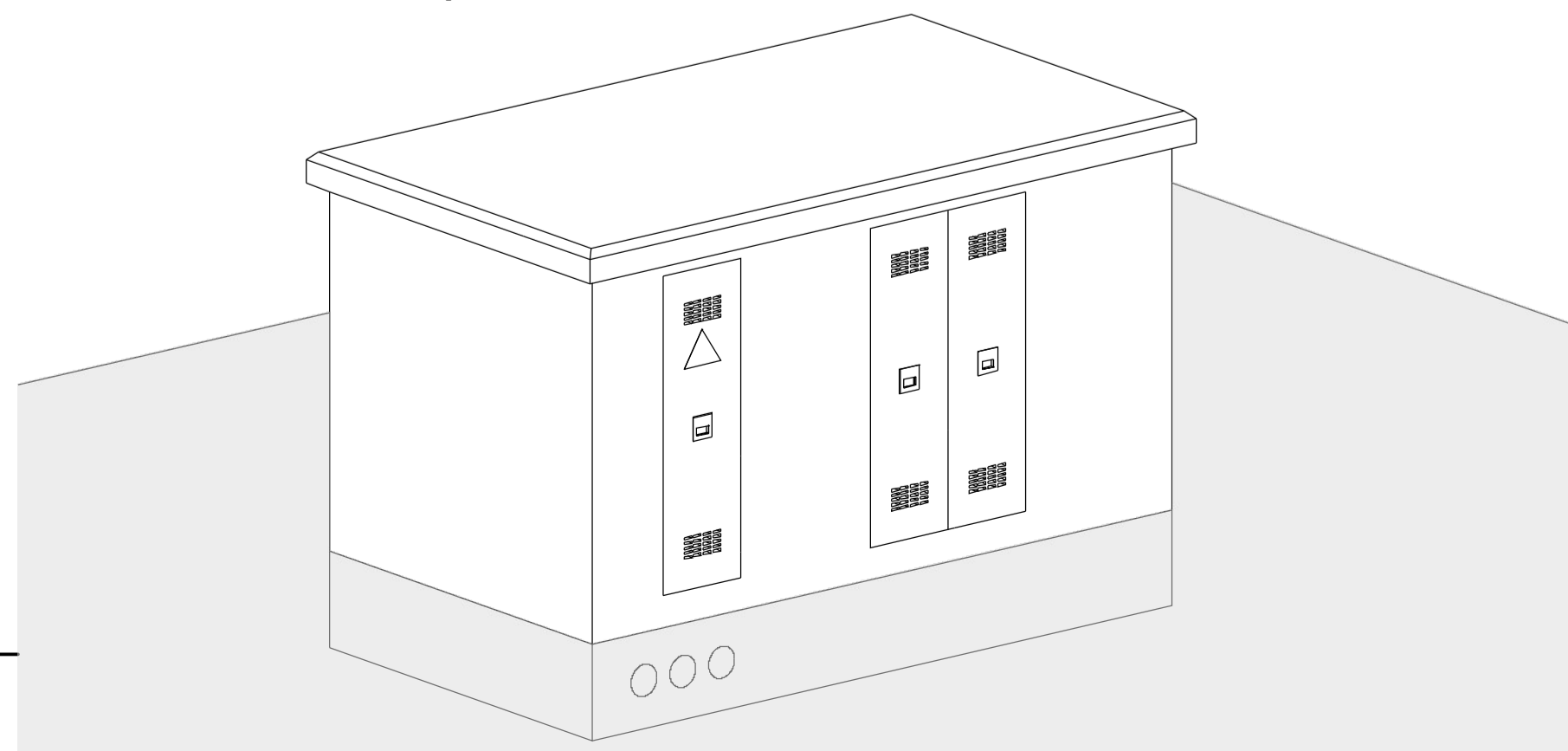

Spaccato assonometrico tipo

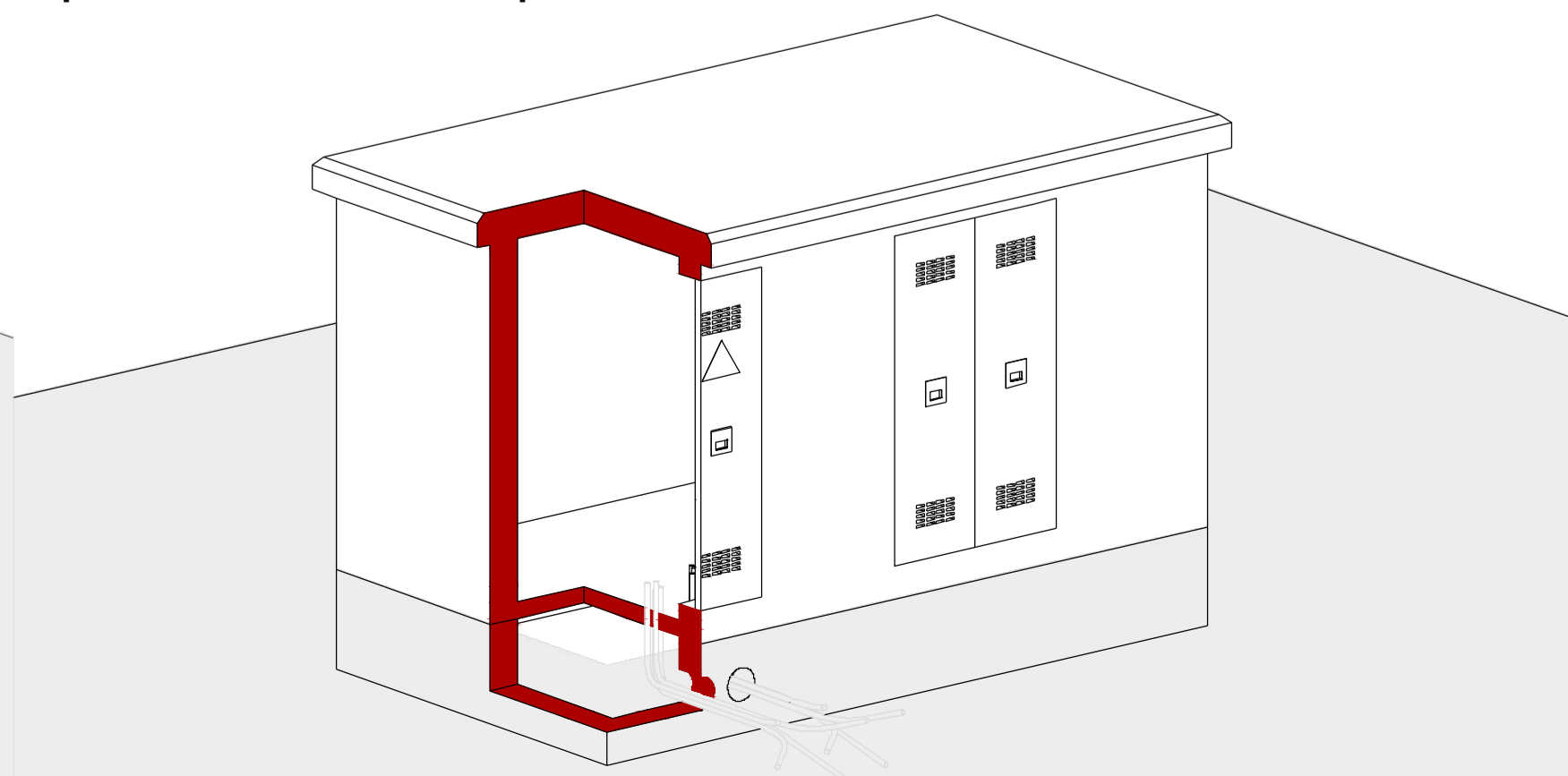

Schema di montaggio

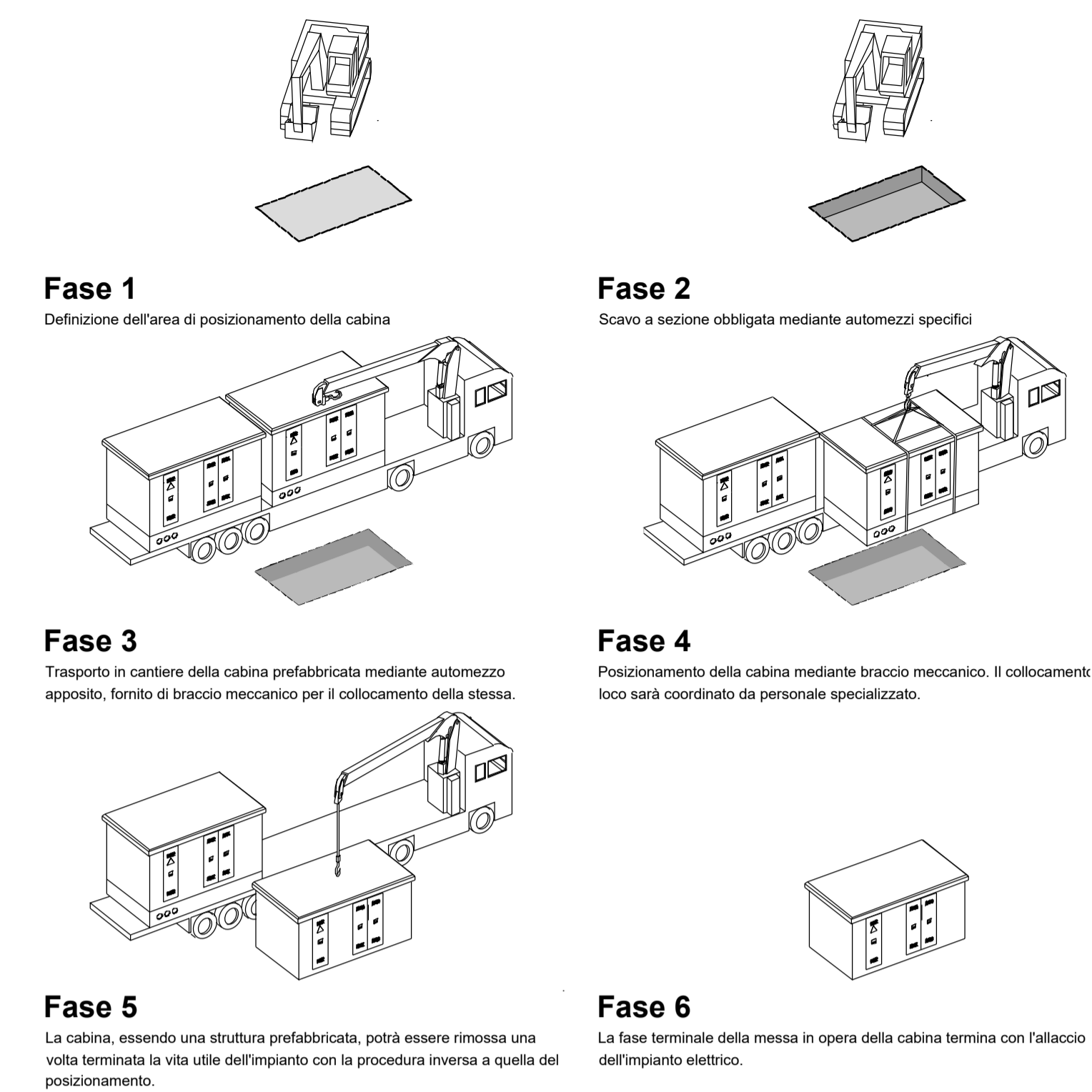

Regione Siciliana
Provincia di Agrigento
Comune di Licata

Oggetto:
Progetto di realizzazione di un impianto fotovoltaico da 28.644 kWp denominato GRAFITE LICATA

Proponente:
PACIFICO PACIFICO GRAFITE S.R.L.
Piazza Walther Von Vogelweide N°8,
39100, Bolzano, Italia,
P.IVA 03087890210

Titolo elaborato: Particolare TRACCIATO LINEA MT/AT Numero elaborato: **Tav. 29** Orientamento:

Tipo elaborato: Di dettaglio Di modifica tecnica

Codice elaborato: **SIATAVFTVBLIC29** Scala:

REV	DATA	Descrizione	Redatto	Verificato	Approvato	Autorizzato
0	16/12/2021	Prima emissione	Arch. S. Lo Bello	Ing. P. Zarbo	Ing. P. Zarbo	Pacifico Grafite srl
1						
2						
3						
4						

Logo Progettista e Denominazione commerciale: _____ Timbro progettista: _____

Visti: _____