

IMPIANTO DI RETE PER LA CONNESSIONE PER UN LOTTO DI IMPIANTI DI PRODUZIONE DI ENERGIA DA FONTE SOLARE FOTOVOLTAICA PER UNA POTENZA IN IMMISSIONE DI 46.170 kW COMUNE DI SEZZE (LT)

PROGETTO DEFINITIVO

Tipici di sostegni apparecchiature AT

IDENTIFICAZIONE ELABORATO

Livello prog.	Codice GOAL	Tipo docum.	N° elaborato	N° foglio	Tot. fogli	NOME FILE	DATA	SCALA
PD	T0737281	03	04	01	04	03.04 Tipici di sostegni apparecchiature AT.pdf	28.04.2021	varie

REVISIONI

REV.	DATA	DESCRIZIONE	ESEGUITO	VERIFICATO	APPROVATO
	28.04.21	PRIMA EMISSIONE	STC	CALCARELLA	-
			_____	_____	_____
			_____	_____	_____
			_____	_____	_____

PROGETTAZIONE: Studio Tecnico Calcarella

Via Bartolomeo Ravenna, 14 - 73100 Lecce
Tel./Fax +39 0832 1798355
studiolocalcarella@gmail.com - fablo.calcarella@gmail.com
fabio.calcarella@ingpec.it

Dott. Ing. Fabio CALCARELLA

IL TECNICO



GESTORE RETE ELETTRICA

RICHIEDENTE

MAG LAZIO S.r.l. (già ENERGIA QUARTA S.r.l.)
Via Orti, 1a - 37050 San Pietro di Morubio - Verona
Tel. +39 0874 67618
PEC energiaquartasl@pec.it
P.IVA 01618580706

FIRMA PER BENESTARE

FIRMA PER BENESTARE

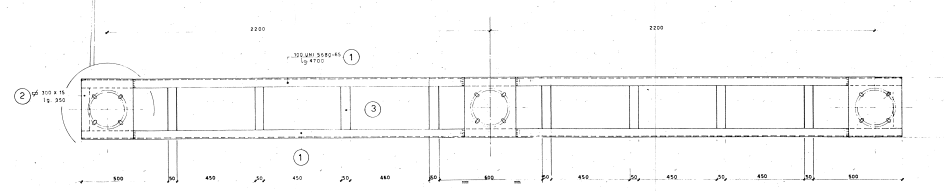
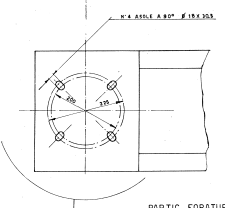
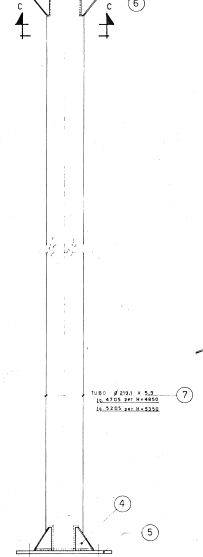
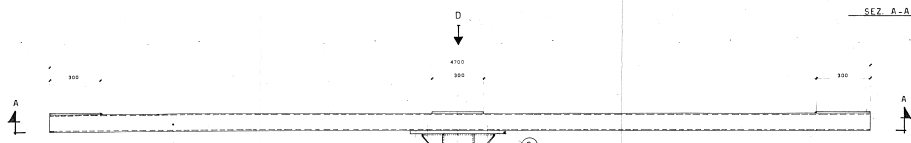
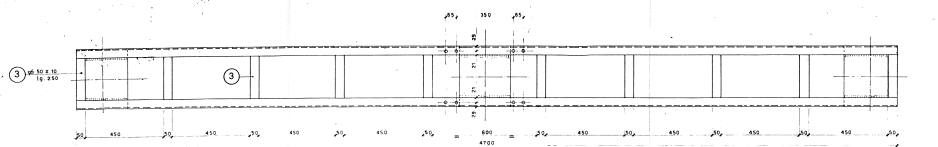

VISTA DA D

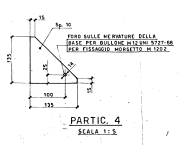
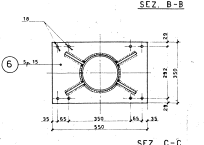
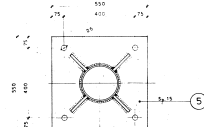
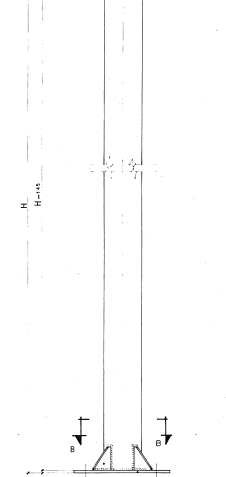
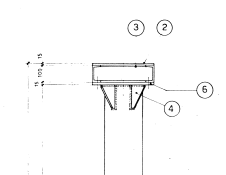

POL.	NR.	PROFILO	P.E.S.O.	
			M = 4850	H = 3350
1	2	C 400 UNI 5480	92.14	29.64
2	2	300 x 15	37.06	37.06
3	10	50 x 10	17.64	17.64
4	8	135 x 10	5.80	5.80
5	1	550 x 15	25.64	25.64
6	1	550 x 15	22.68	22.68
7	1	Ø 219,1 x 5,5	145.85	161.35

n.b. - LA CARPENTERIA DEVE ESSERE FORNITA DI TUTTA LA BULLONERIA -

4					
2					
1					

ENEL		SICILIA		DATE	NO. PRO.
COMPARTIMENTO DI AGRIGENTO		DISTRETTO PUGLIA		ESEC.	17-11-99
GENERALE SOSTEGNI					
FORNITE DA AUT.					
SOSTEGNO PER TERZA ISOLAZIONE PORTANTI					
132 - 150 KV					
N. 20668					
SISTEMA S. L. P. 592-7103					
AUTORIZZAZIONE N. 4					

Sez. A-A

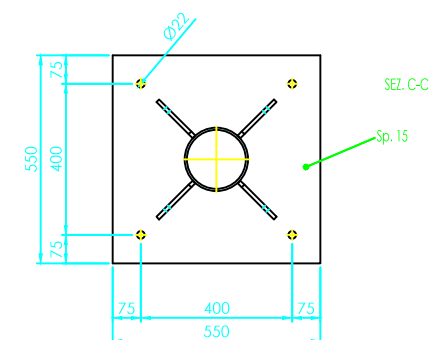
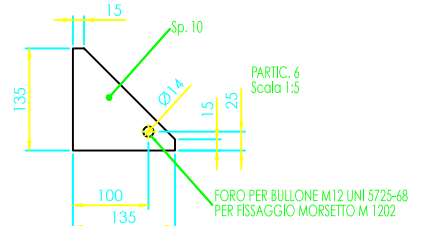
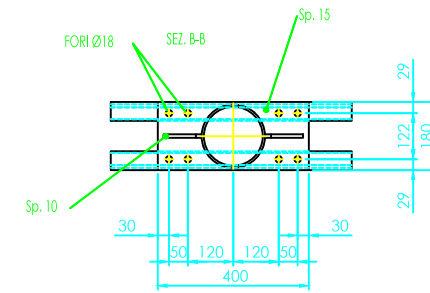
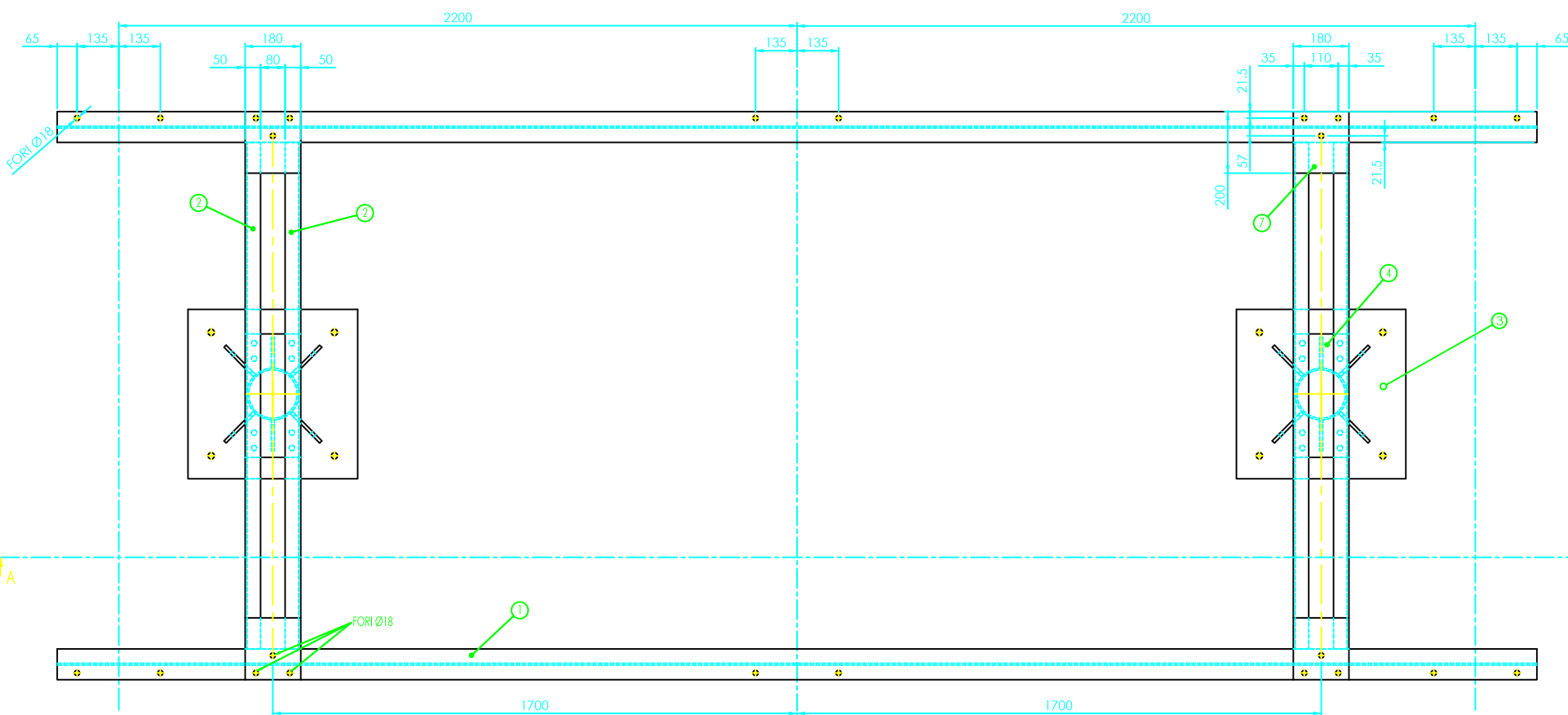
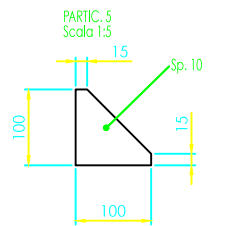
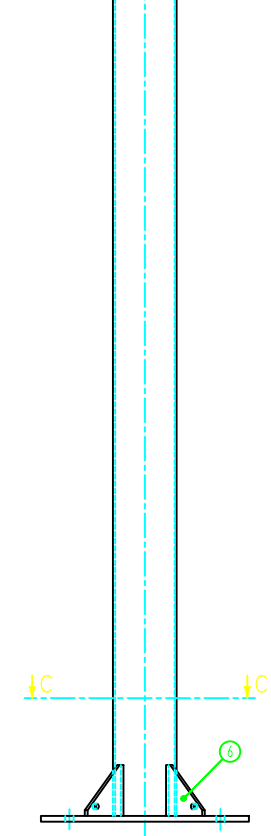
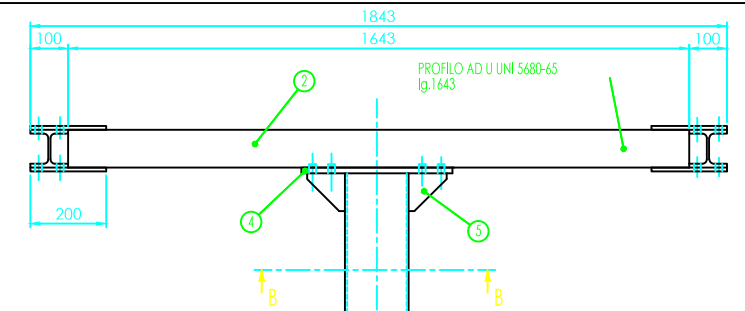
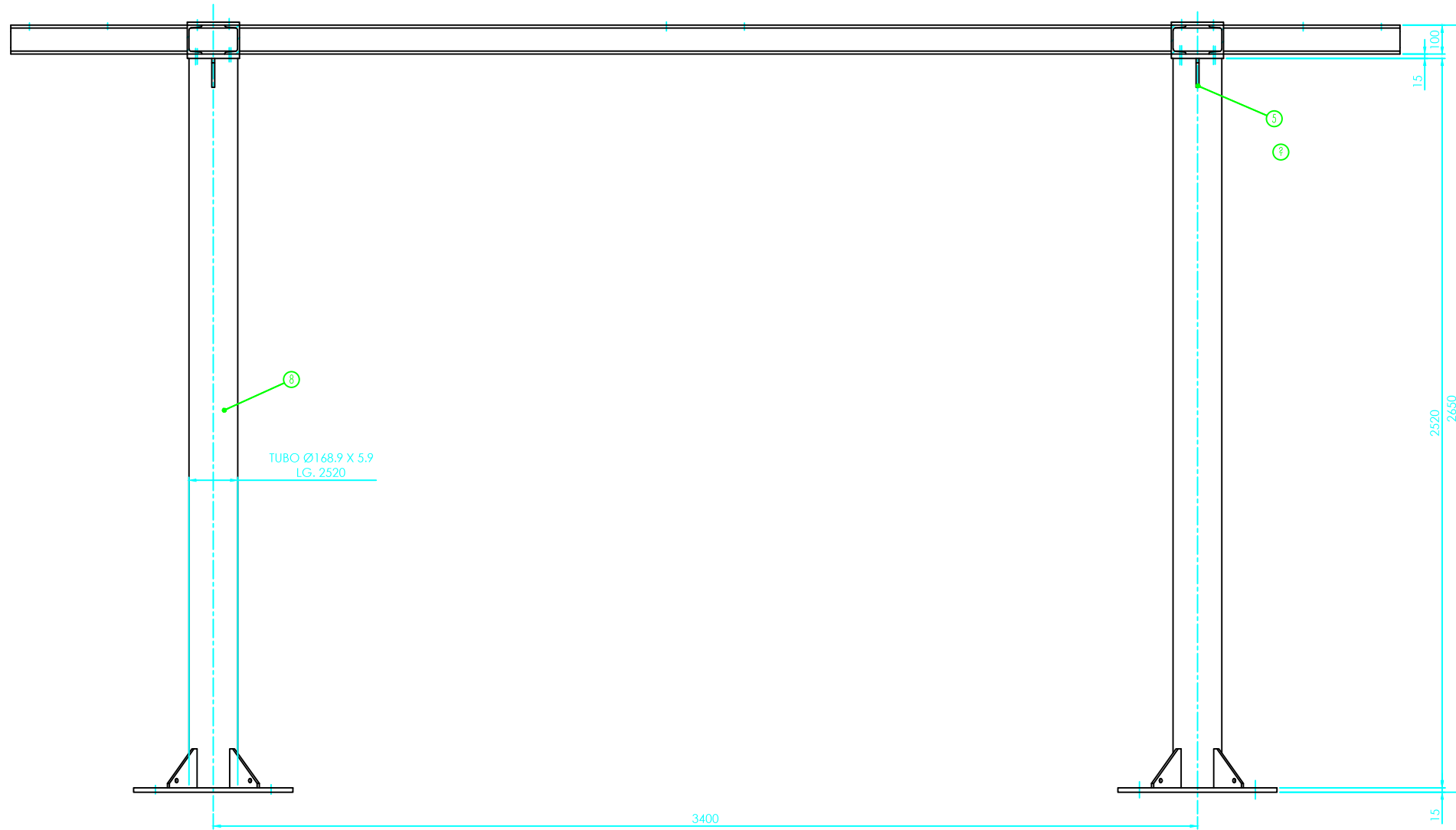

POS.	N° PEZZI	PROFILO	PESO
1	2	HE 100 B UNI 5397	195,84
2	4	Profilo ad U 100 UNI 5680	69,46
3	2	Platino 55x115	71,28
4	2	Platino 180x115	16,94
5	4	Platino 100x110	1,4
6	8	Platino 135x110	5,8
7	8	Platino 180x110	22,56
8	2	tubo Ø168,3x5,9	118,94

Nuova Rocchi S.r.l.
Costruzioni Elettromeccaniche
Via Piave 80 53048 Sinalunga - SI Tel. 0577679177

Materiali: Acciaio

502,97

denominazione: SOSTEGNO PER SEZIONATORE TRIPOLARE ROTATIVO 132-150 kV H=2650

disegno: P502/D101

scala: 1:10

data: 1/1

SOSTEGNO PER TVC TIPO DY43

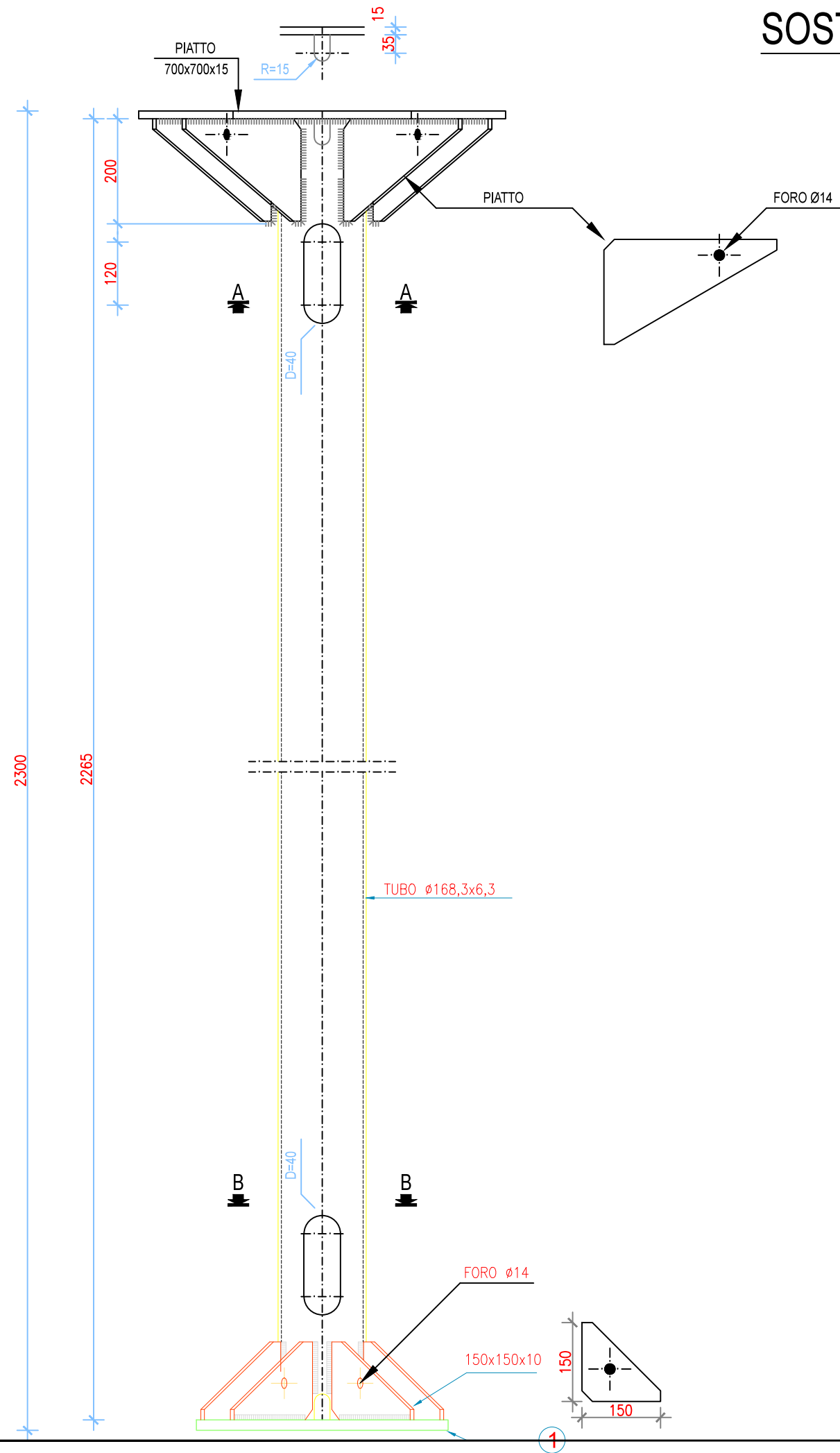

SEZIONE A-A

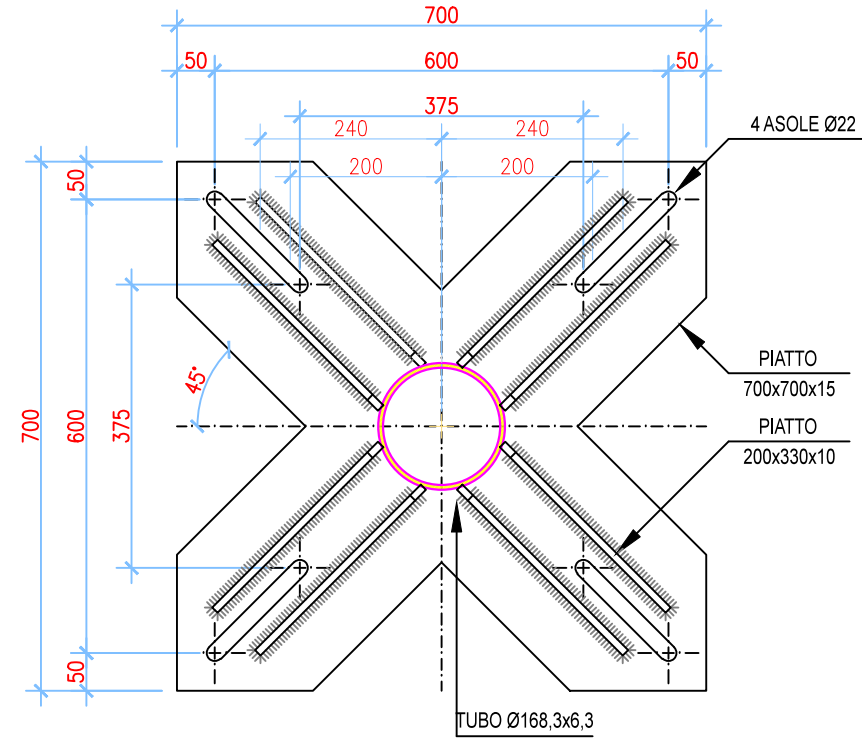

SEZIONE B-B

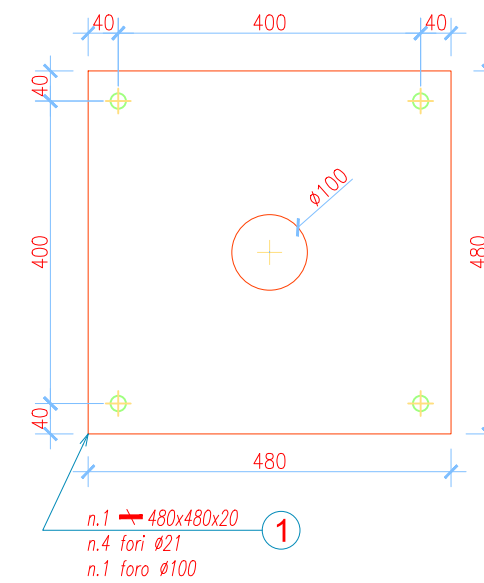
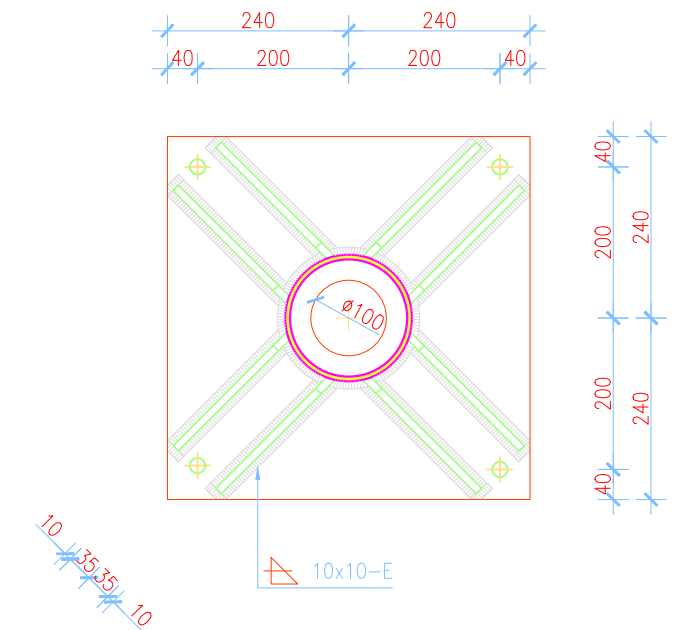

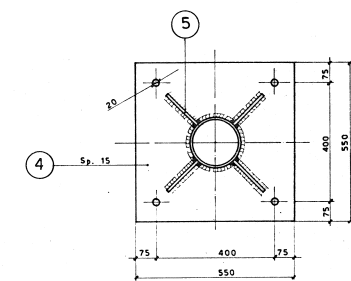
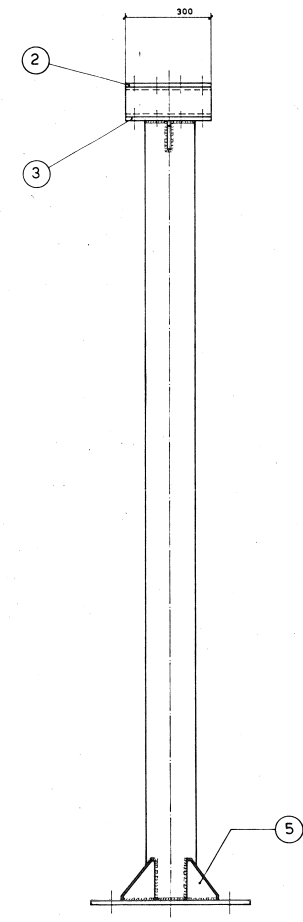
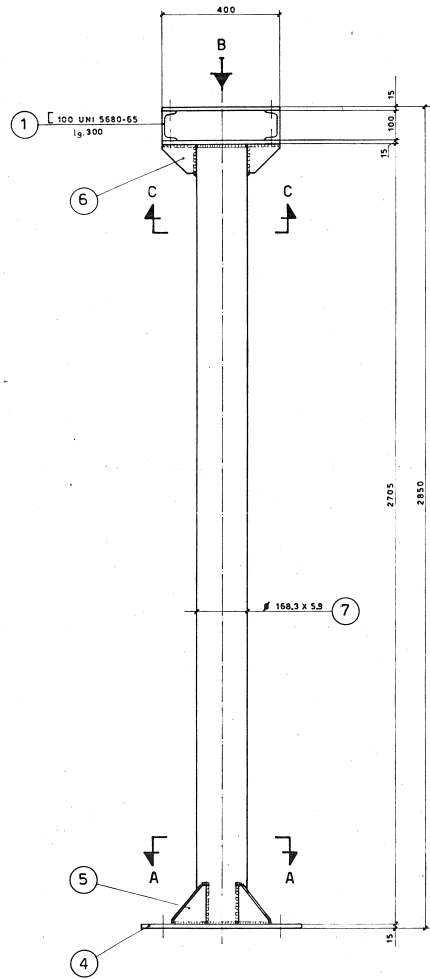

SEZ. A-A

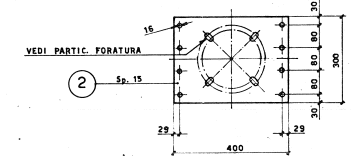

VISTA DA B

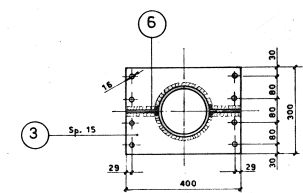

SEZ. C-C

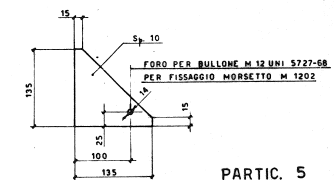

PARTIC. 5
SCALA 1:5

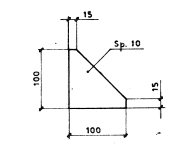

PARTIC. 6
SCALA 1:5

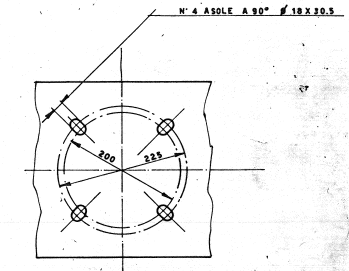

PARTIC. FORATURA

POS.	NO PEZZI	PROFILO	PESO kg.
1	2	100 UNI 5680-55	6.36
2	1	300 X 15	14.12
3	1	300 X 15	14.12
4	1	550 X 15	35.64
5	4	135 X 10	2.90
6	2	100 X 10	0.80
7	1	168.3 X 5.9	63.84

FORO PER BULLONE M 12 UNI 5277-58
PER FISSAGGIO MORSETTO M 1202

n.b. - LA CARPENTERIA DEVE ESSERE FORNITA DI TUTTA LA BULLONERIA.

MODIFICHE	4				
	3				
	2				
	1				
ENEL GRUPPO IRI COMPARTIMENTO DI NAPOLI		DISTRETTO PUGLIA		SCALA	1:20
GENERALE SOSTEGNI				DATA	11-1-85
SOSTEGNO DI APPARECCHIATURA UNIPOLARE 132 - 150 KV				CONTR.	
				VERO	
				FORMATO UNI A/4	
				N. 20669	
				SOSTITUISCE IL N. P 502-104	
				SOSTITUITO DAL N.	

20669