

SEZIONE TIPO I/1b

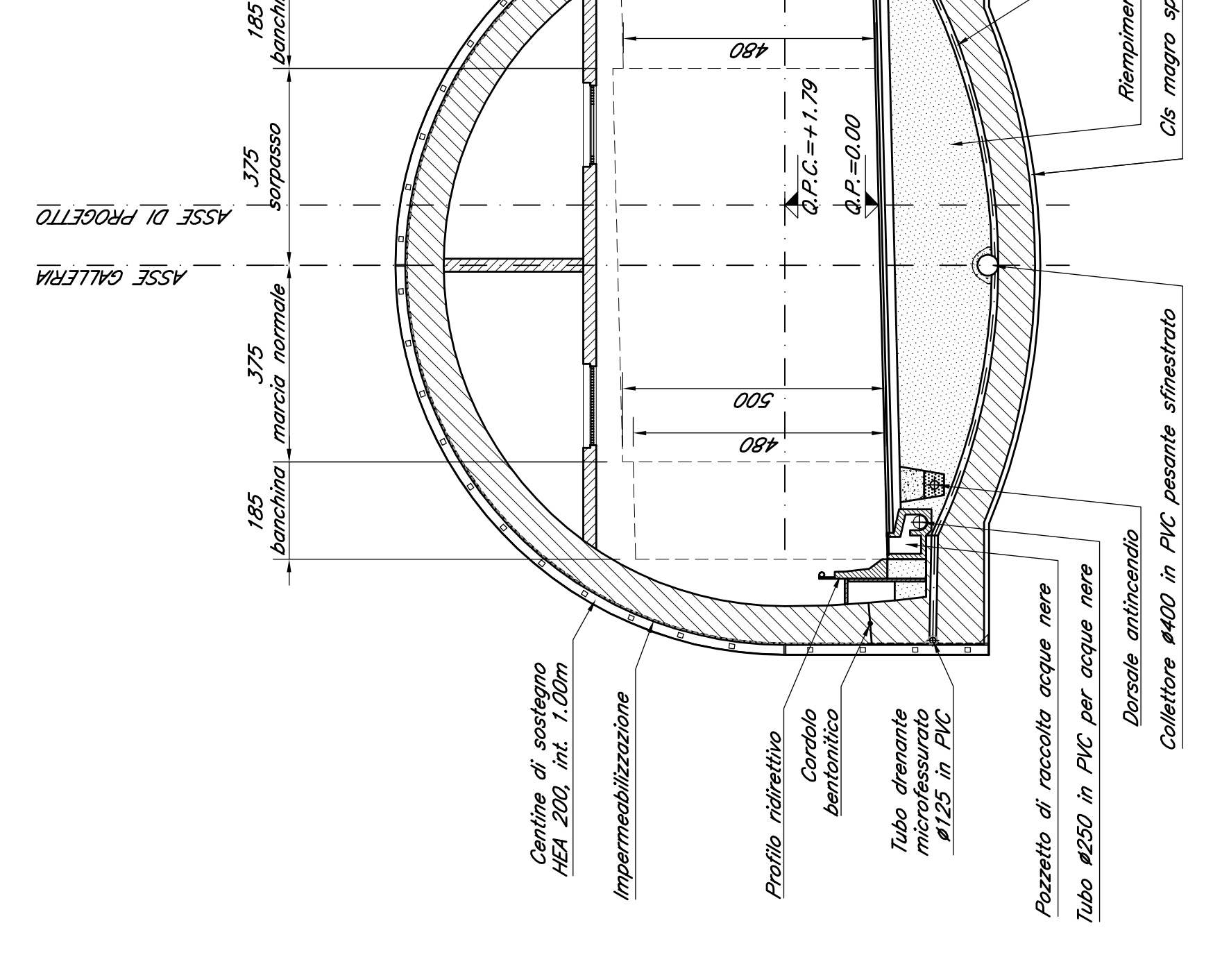

CARPENTERIA

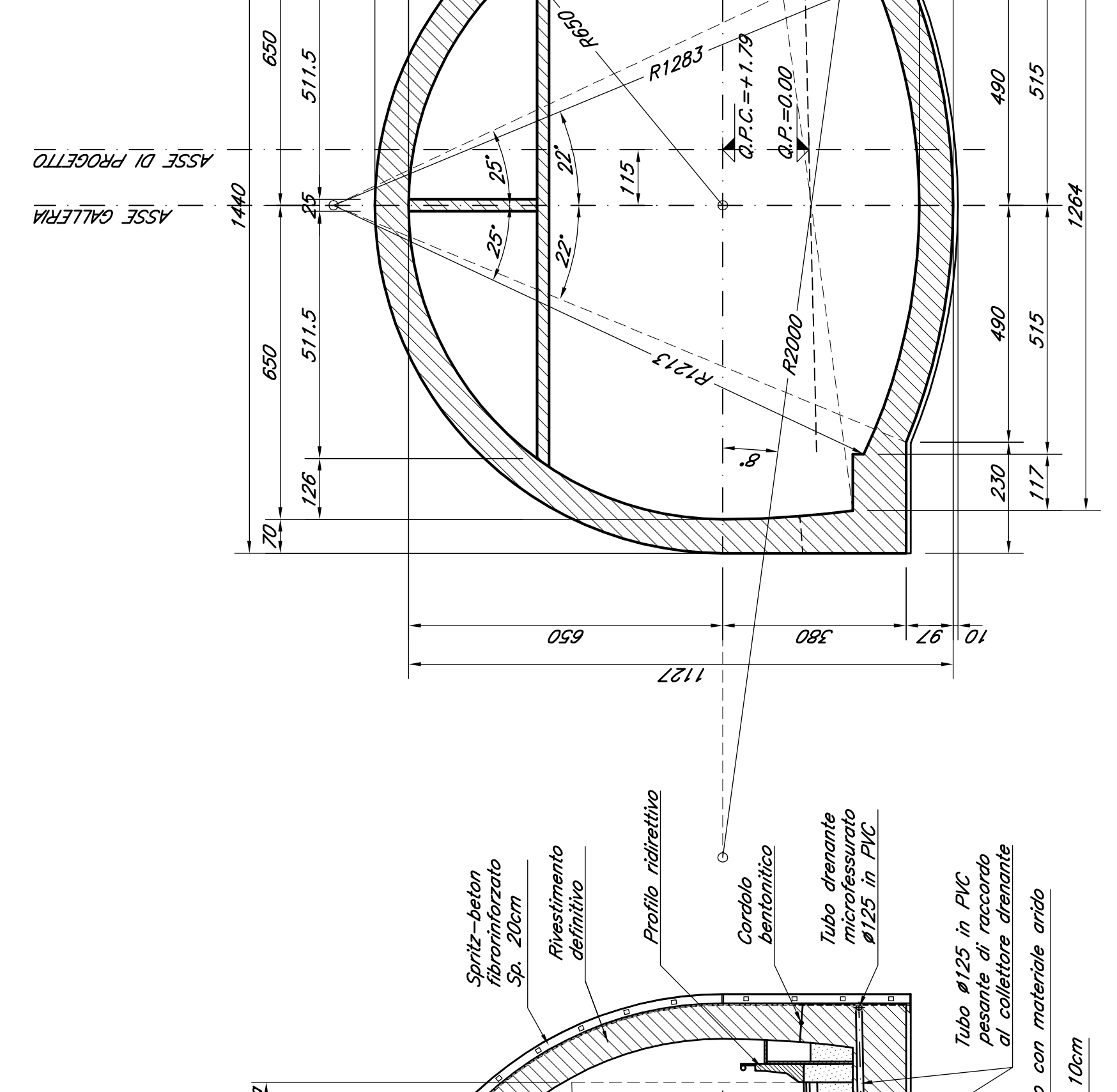

CARPENTERIA CENTINE

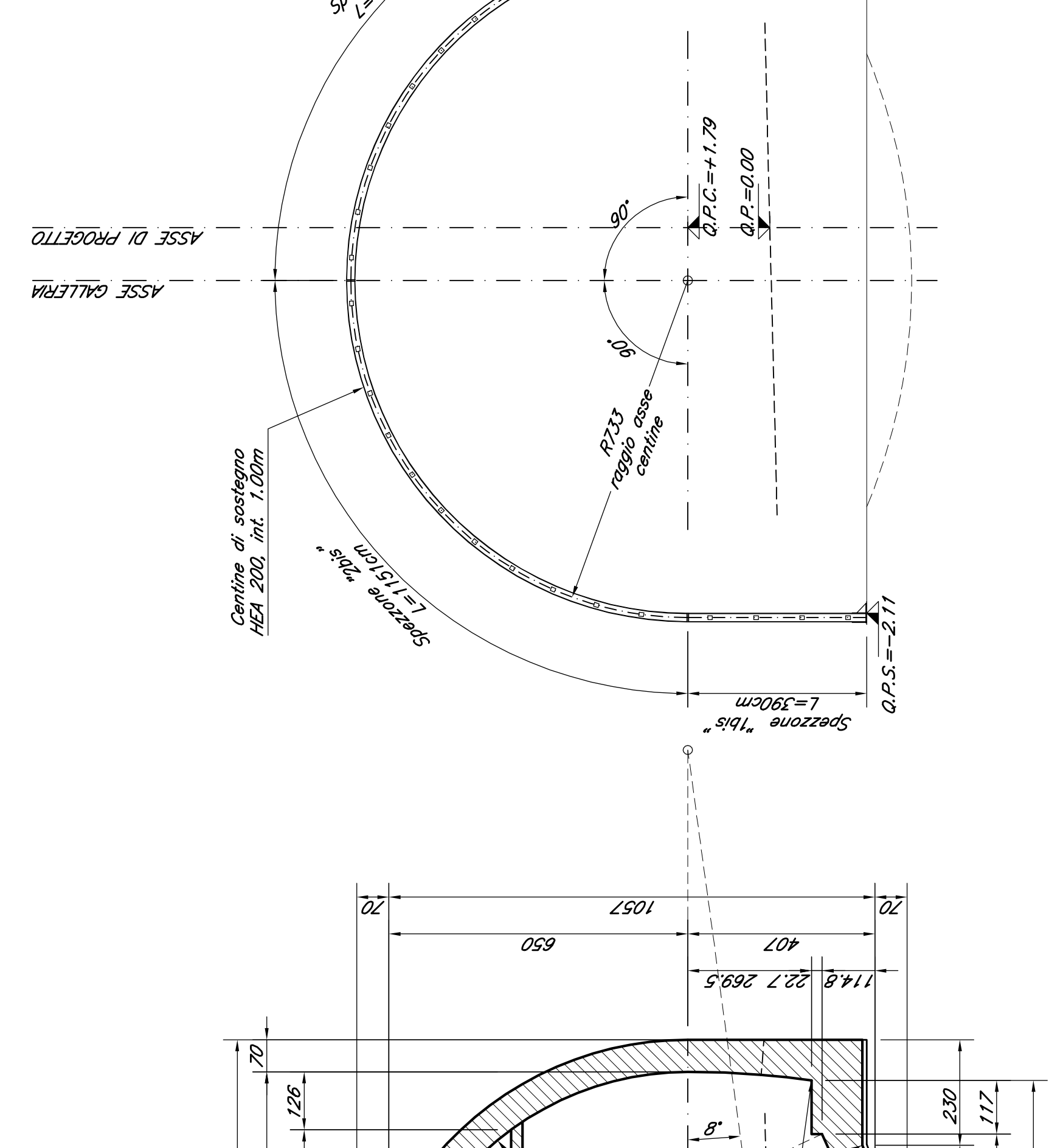

SEZIONE A-A

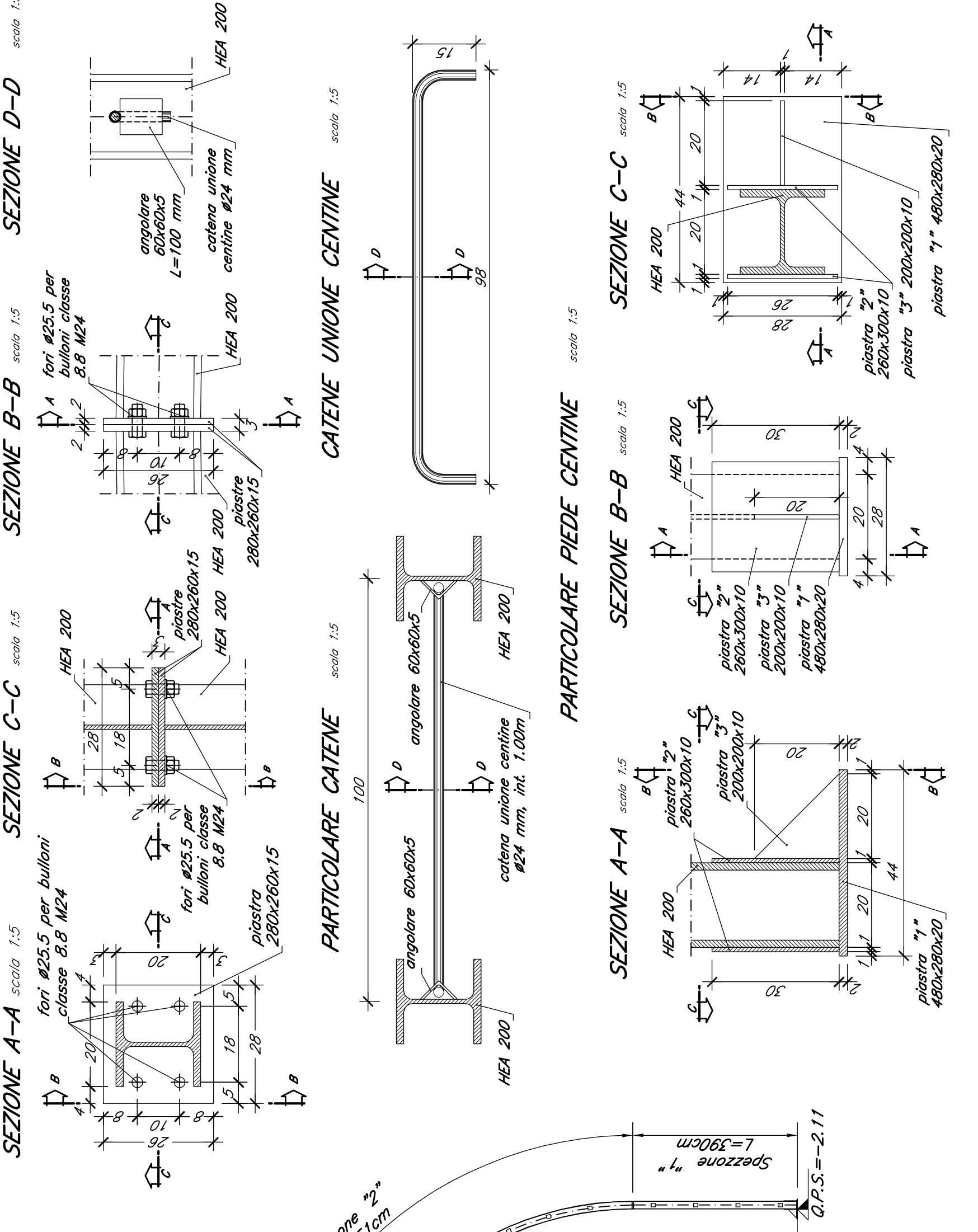

CARATTERISTICHE DEI MATERIALI

Technical specifications for materials used in the project, including concrete grades (C25/30, C30/37), steel grades (S235, S275, S355), and reinforcement details.

SEZIONE B-B

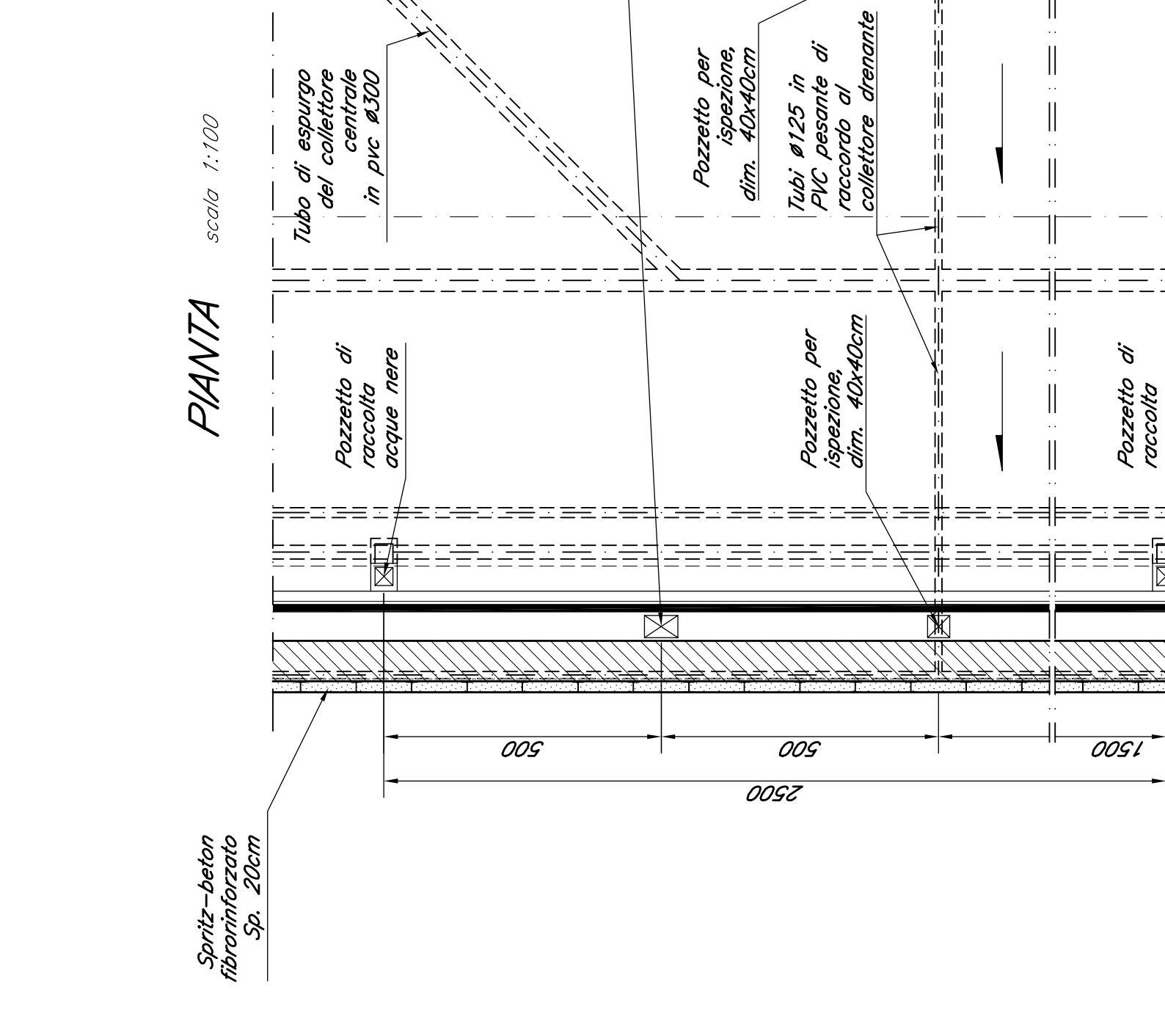

SEZIONE C-C

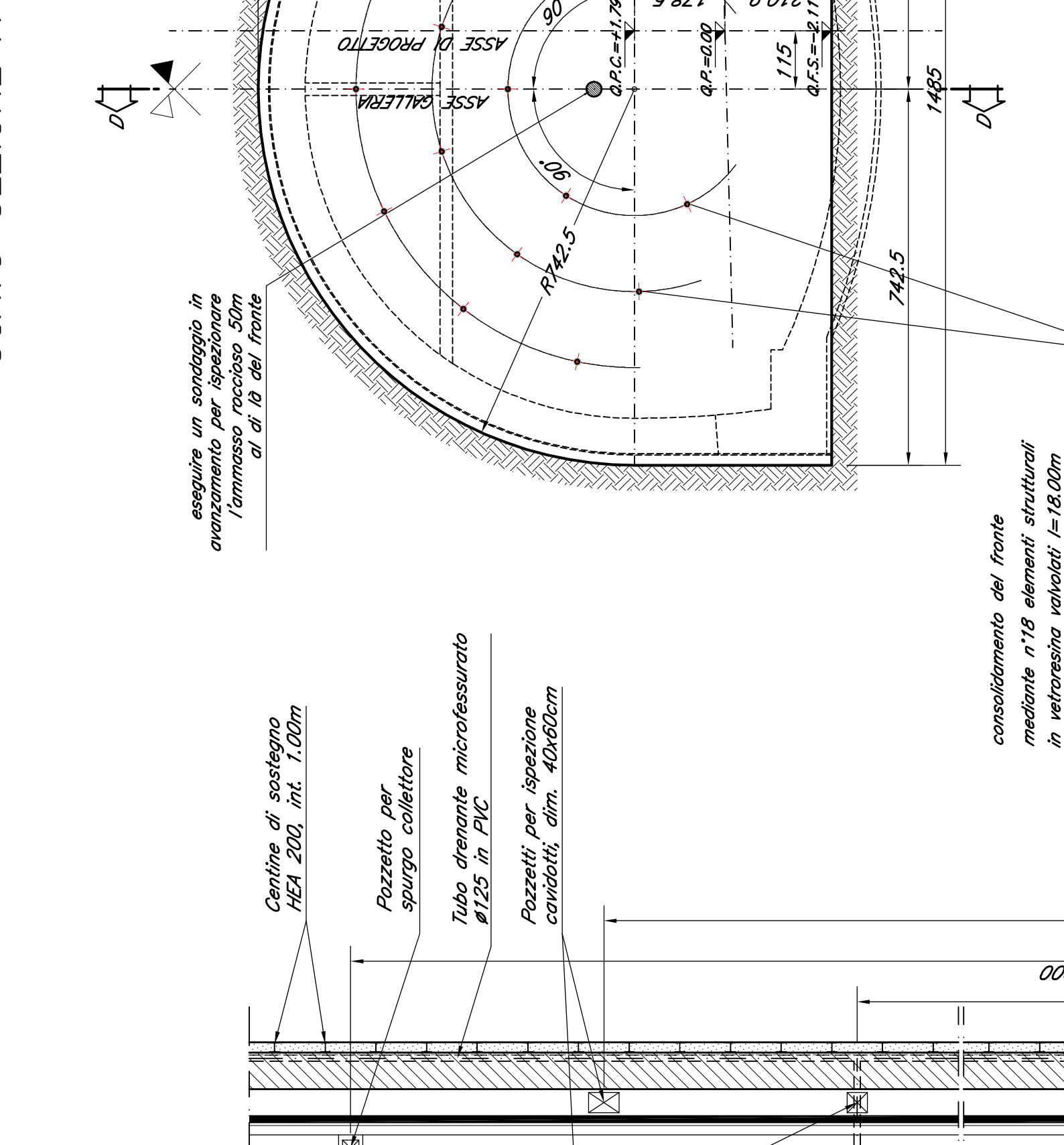

SEZIONE D-D

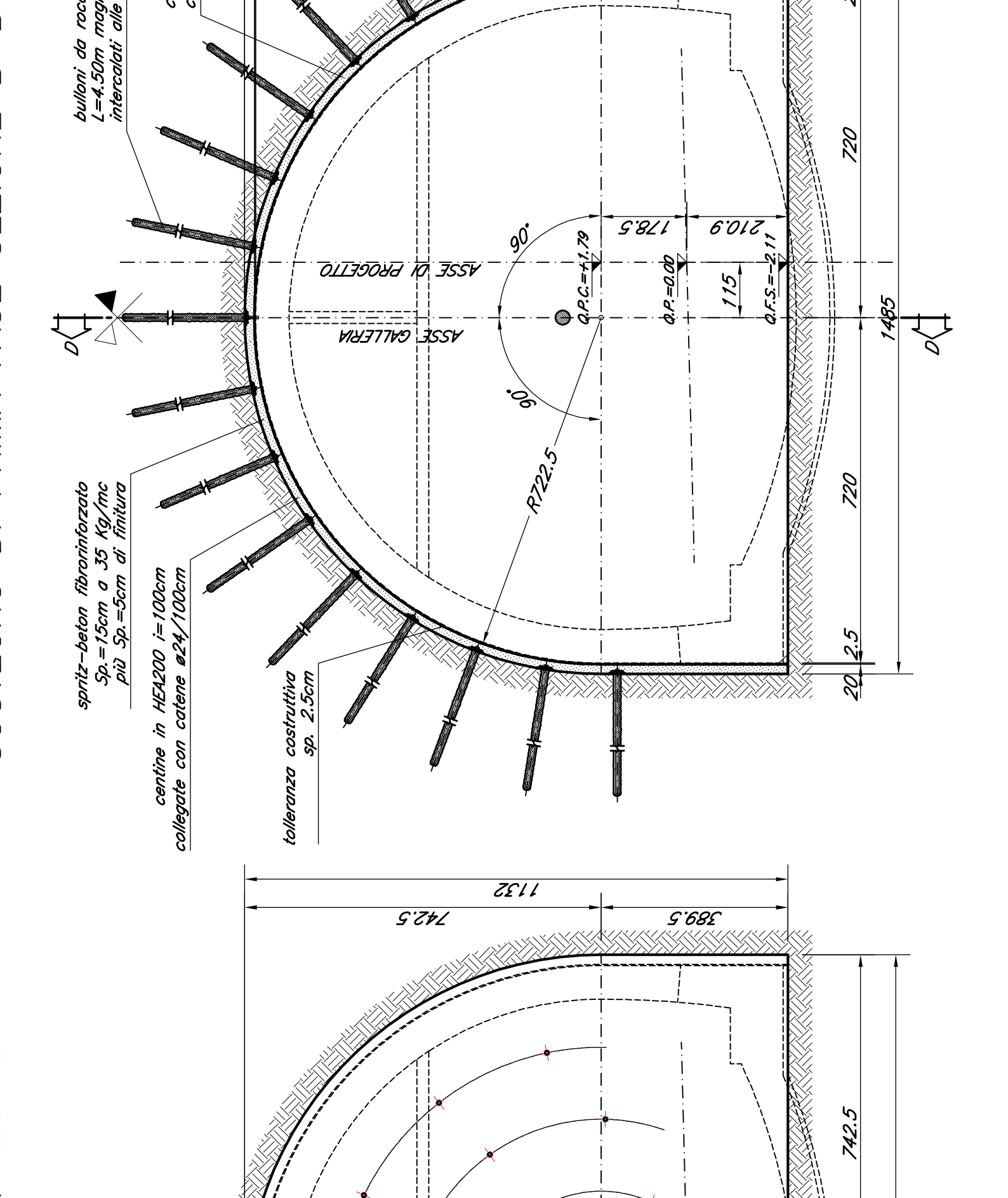

SEZIONE E-E

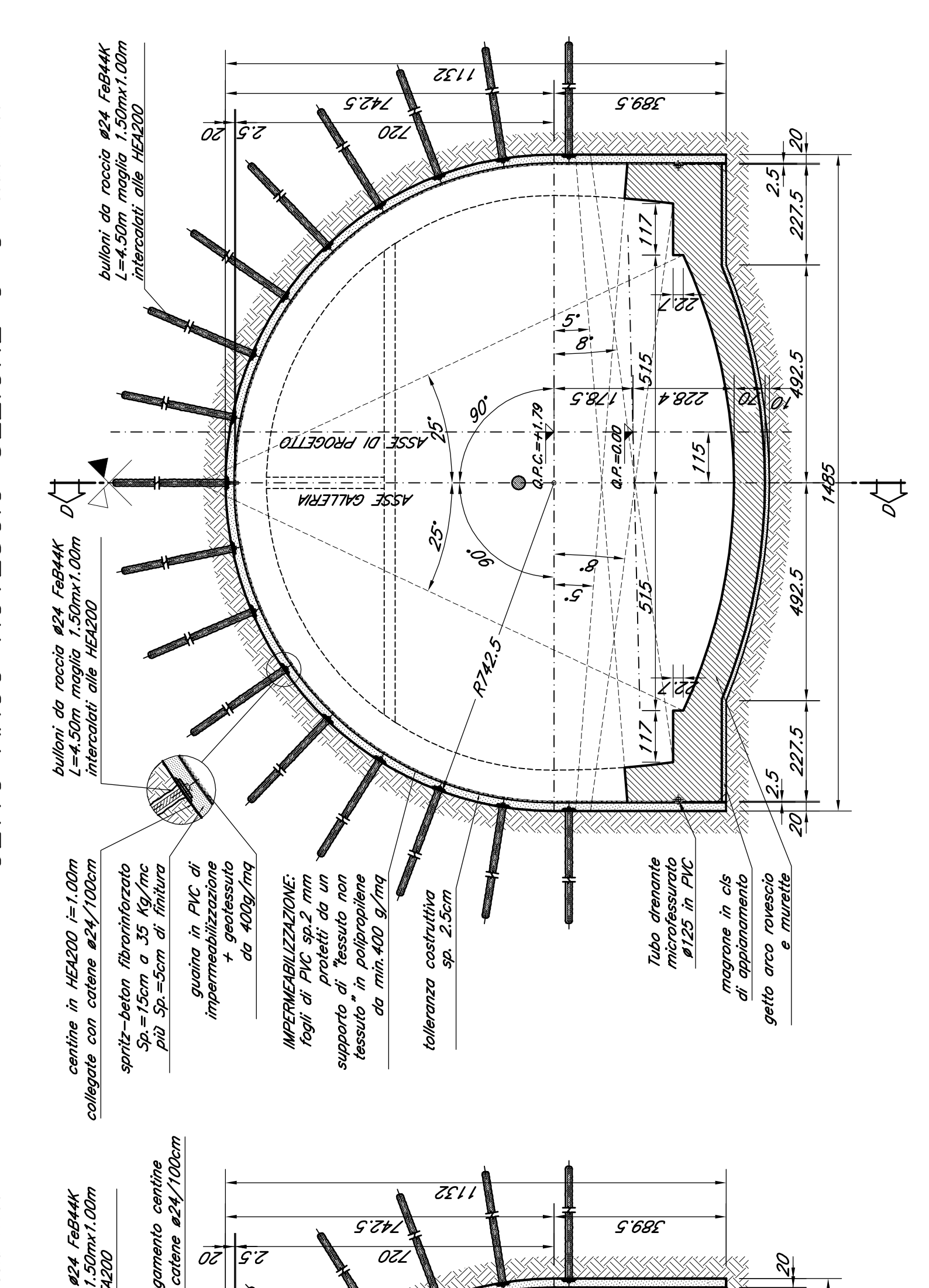

LEGENDA

Legend and specifications for the reinforcement bars and materials used in the structure.

SEZIONE A-A

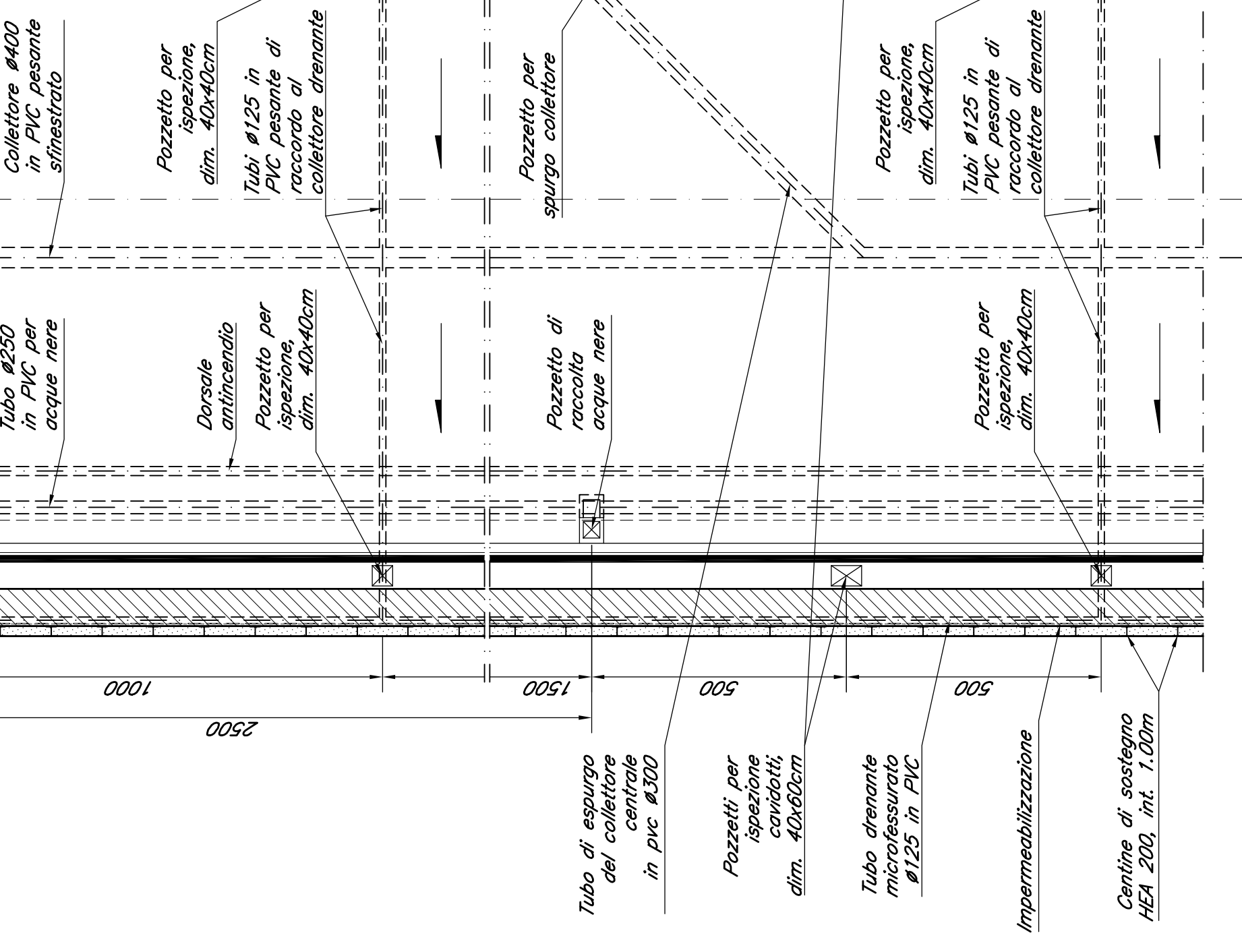

SEZIONE B-B

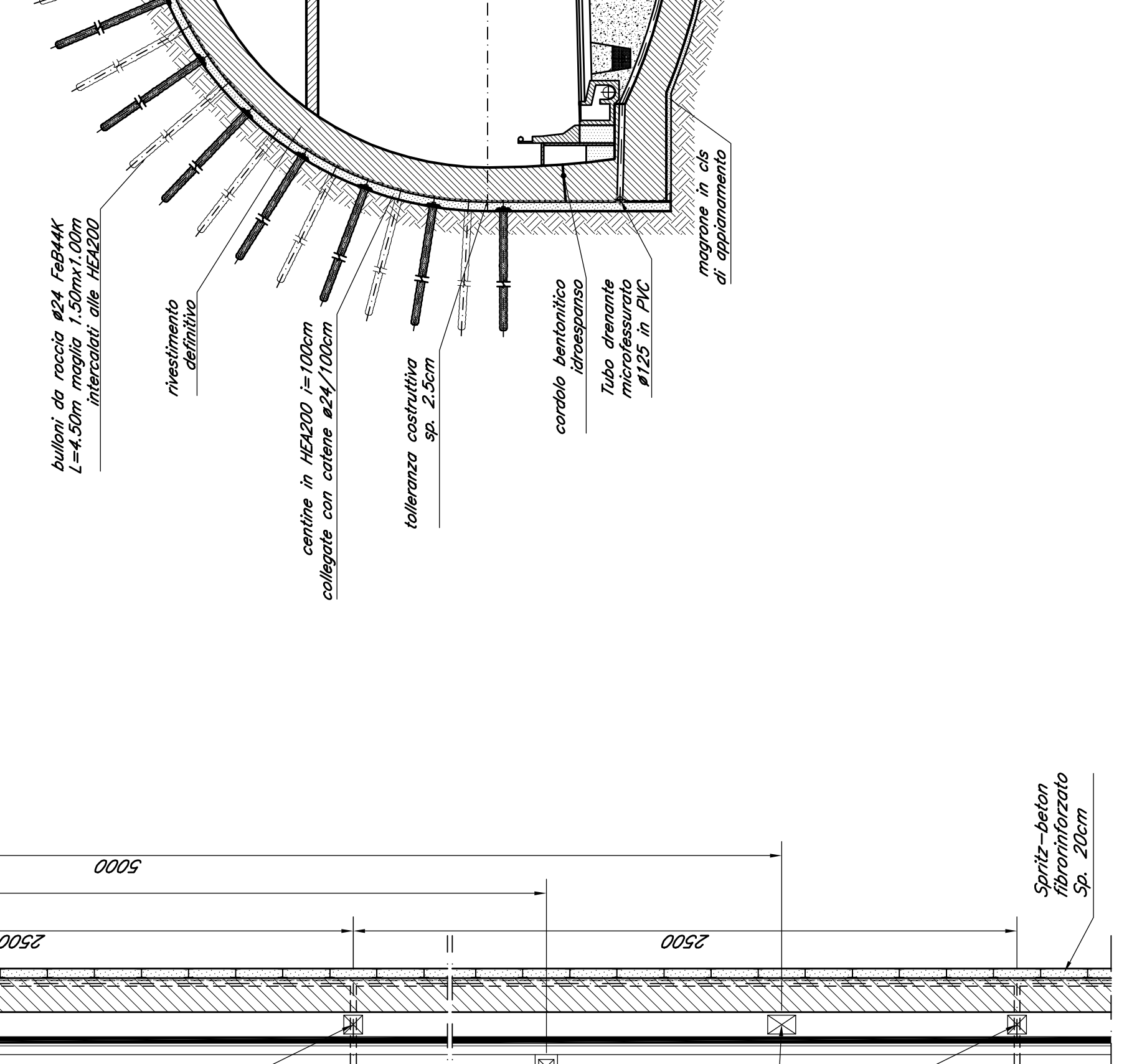

SEZIONE C-C

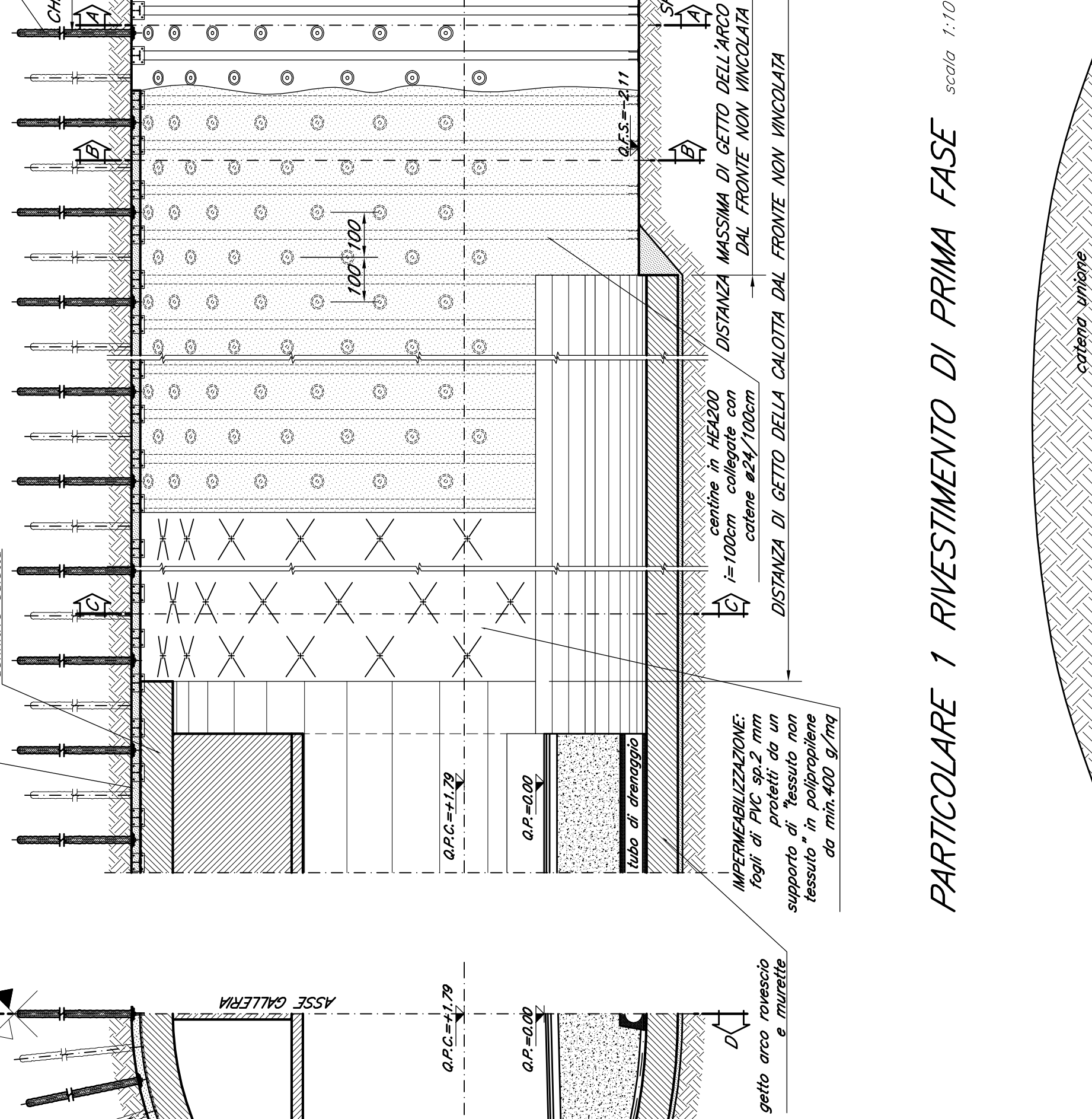

SEZIONE D-D

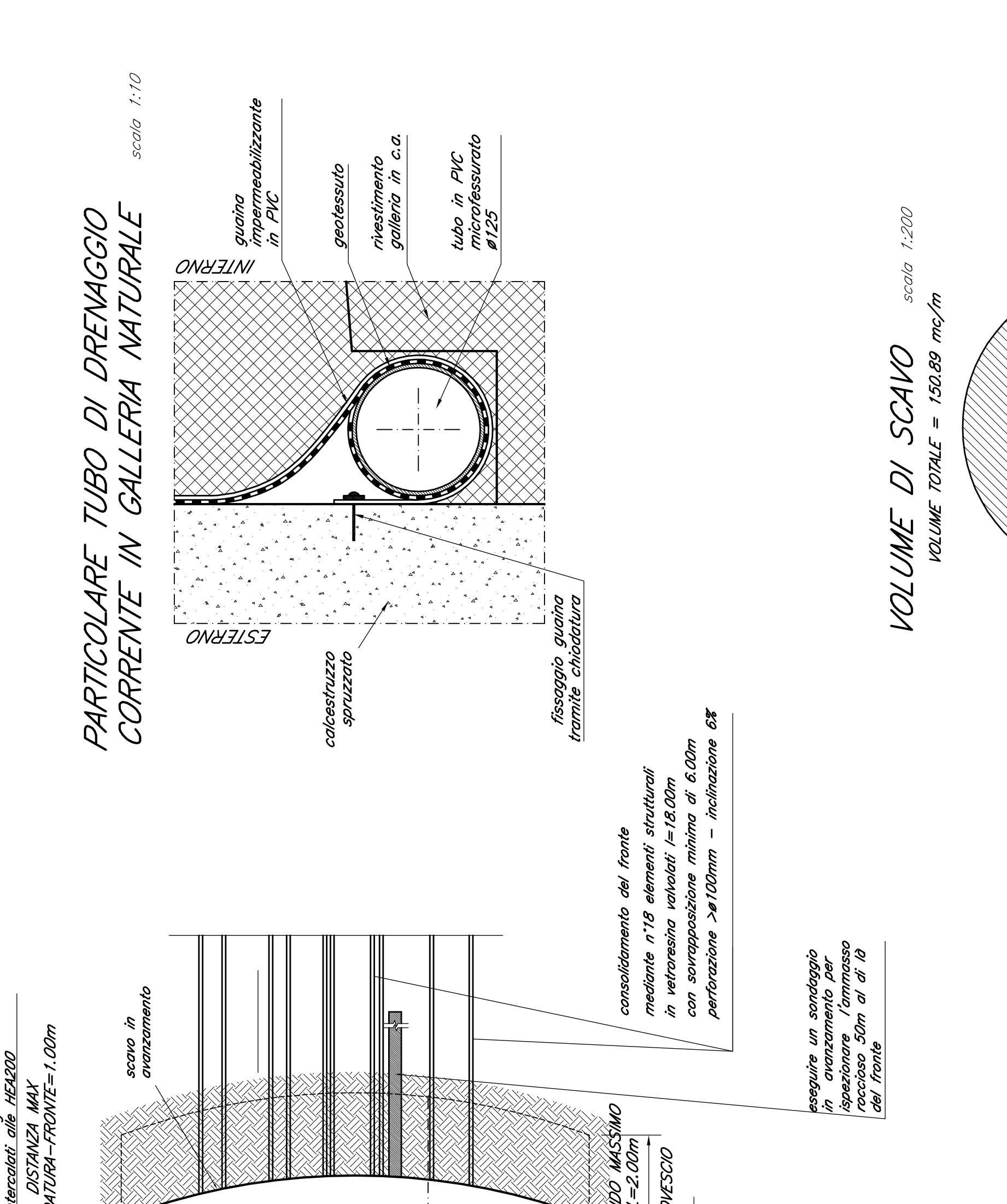

Project title and location: Regione del Veneto, Progettazione, costruzione e gestione itinerario della Valsugana Valbrenta - Bassano Superstrada a pedaggio. Includes logos for Pizzotti, C.I.S., and other project partners.

Table with project details: PROGETTO PRELIMINARE, GALLERIE GALLERIE NATURALI - TIPICI, Discenderia - sezione tipo - sezione di scavo e carpenteria classe IV b, B.03.01.GA.22, Date: Dicembre 2009, Author: Valle.

