

AUTOSTRADA (A13): BOLOGNA - PADOVA

TRATTO: BOLOGNA - FERRARA

AMPLIAMENTO ALLA TERZA CORSIA

TRATTO: BOLOGNA ARCOVEGGIO-FERRARA SUD

PROGETTO ESECUTIVO

DOCUMENTAZIONE GENERALE

GESTIONE TERRE

Allegati: Tavole planimetriche
(Parte 3)

IL PROGETTISTA SPECIALISTICO Ing. Sara Frisiani Ord. Ingg. Genova N. 9810A Responsabile Studi Ambientali	IL RESPONSABILE INTEGRAZIONE PRESTAZIONI SPECIALISTICHE Ing. Mario Brugnoli Ord. Ingg. Roma N. A24308	IL DIRETTORE TECNICO Ing. Sara Frisiani Ord. Ingg. Genova N. 9810A T.A. Ambiente
---	--	---

RIFERIMENTO PROGETTO			CODICE IDENTIFICATIVO				RIFERIMENTO ELABORATO				ORDINATORE
Codice Commessa	Lotto, Sub-Prog. Cod. Appalto	Fase	Capitolo	Paragrafo	W B S	Parte d'opera	Tip.	Disciplina	Progressivo	Rev.	
111316	0000	PE	DG	PGT	00000	00000	D	AMB	1002	-2	SCALA 1:10000

	ENGINEER COORDINATOR:	SUPPORTO SPECIALISTICO:	REVISIONE	
	Ing. Mario Brugnoli Ord. Ingg. Roma N. A24308		n.	data
			0	GIUGNO 2022
			1	NOVEMBRE 2022
REDATTO:	Dott. Francesco Cipolli	VERIFICATO:	2	DICEMBRE 2022

	VISTO DEL COMMITTENTE  IL RESPONSABILE UNICO DEL PROCEDIMENTO Ing. Maurizio Torresi	VISTO DEL CONCEDENTE  Ministero delle Infrastrutture e della mobilità sostenibili <small>DIPARTIMENTO PER LA PROGRAMMAZIONE, LE INFRASTRUTTURE DI TRASPORTO A RETE E I SISTEMI INFORMATIVI</small>
--	---	--

Quadro di unione

Legenda



SITI DI PRODUZIONE



SITI DI UTILIZZO



CANTIERI

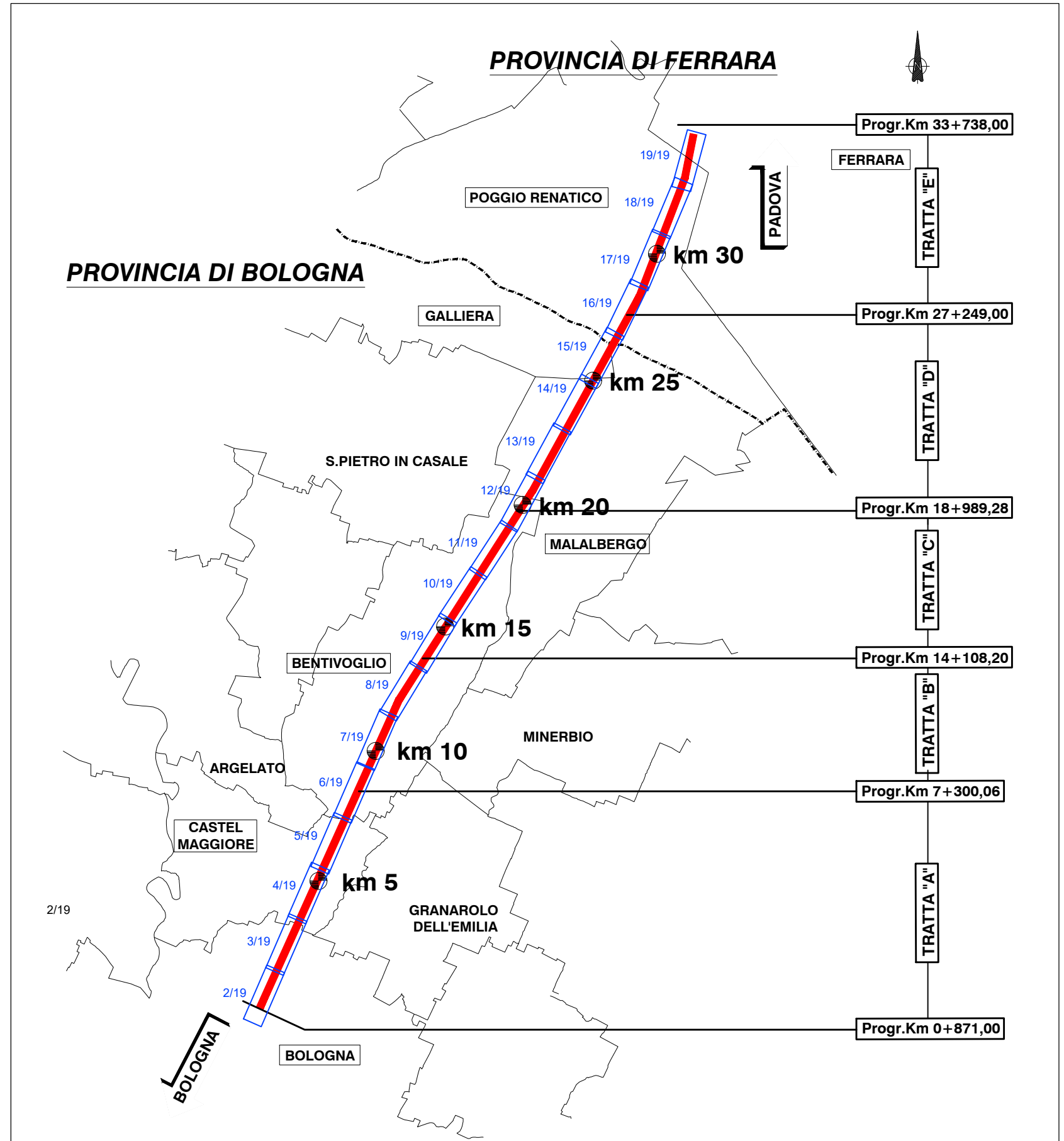

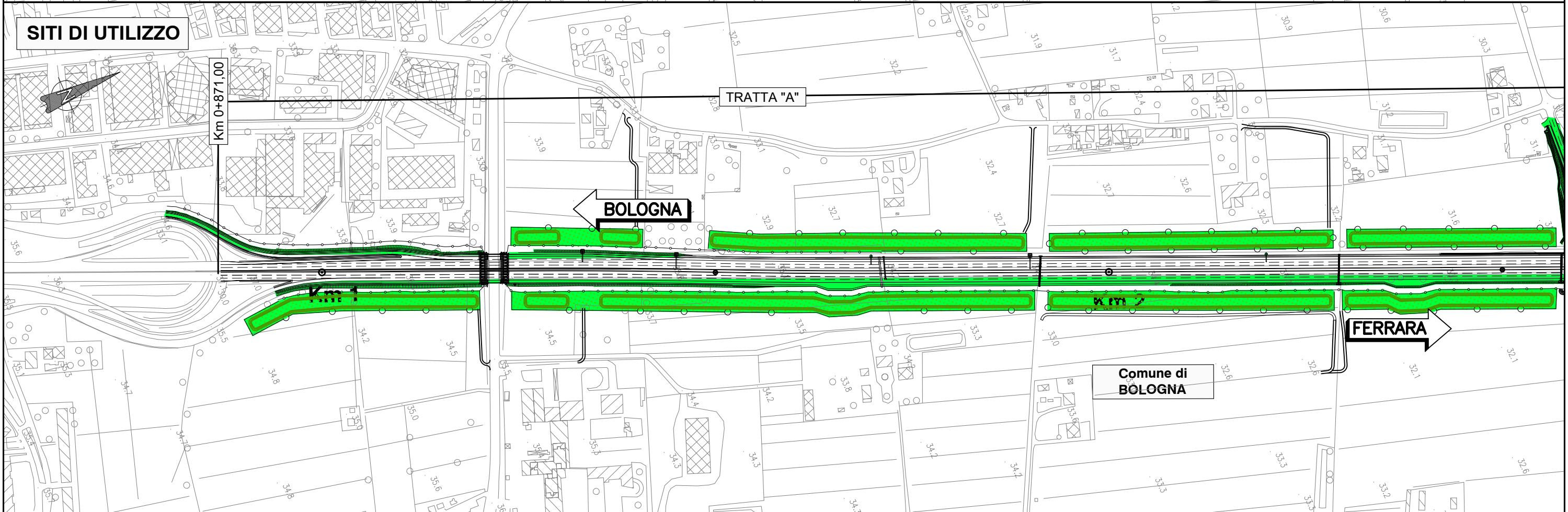
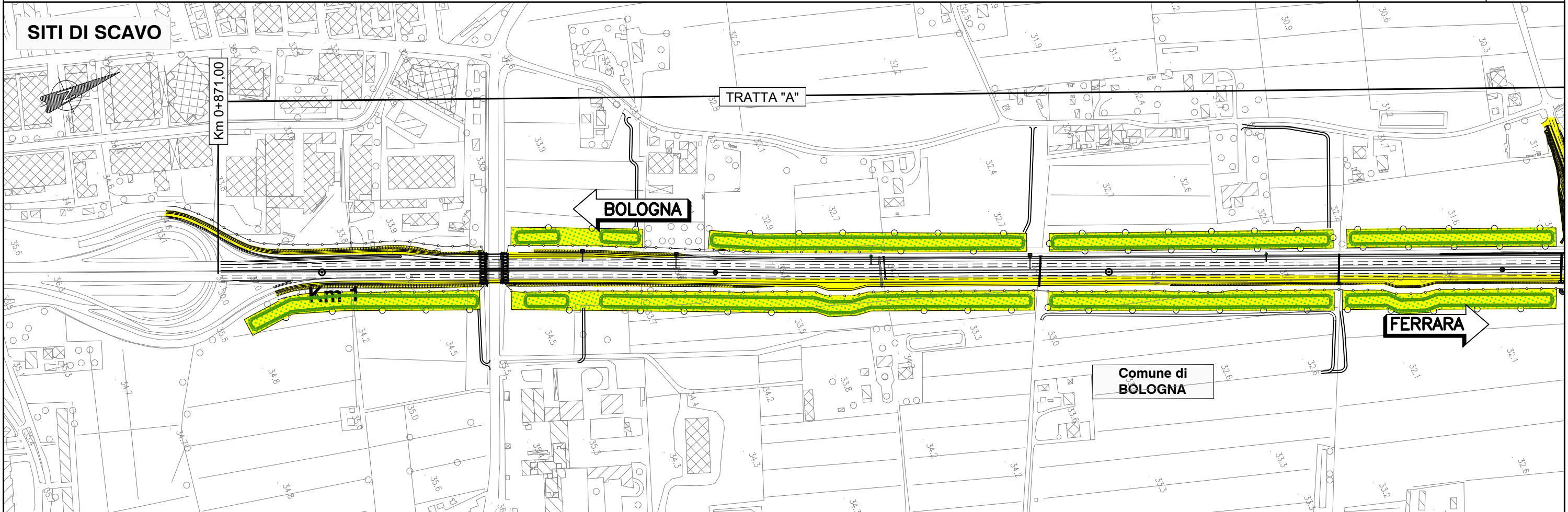

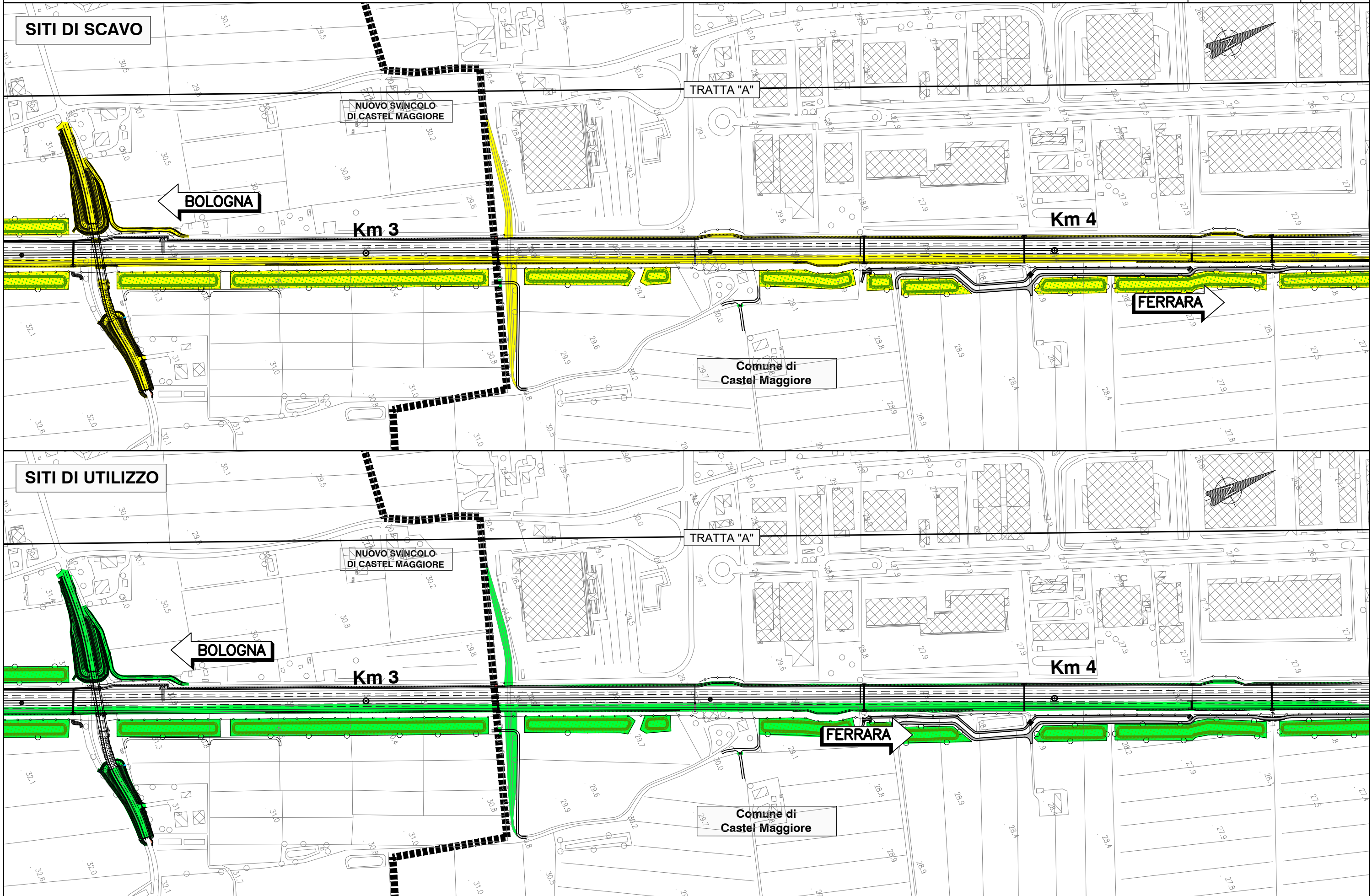

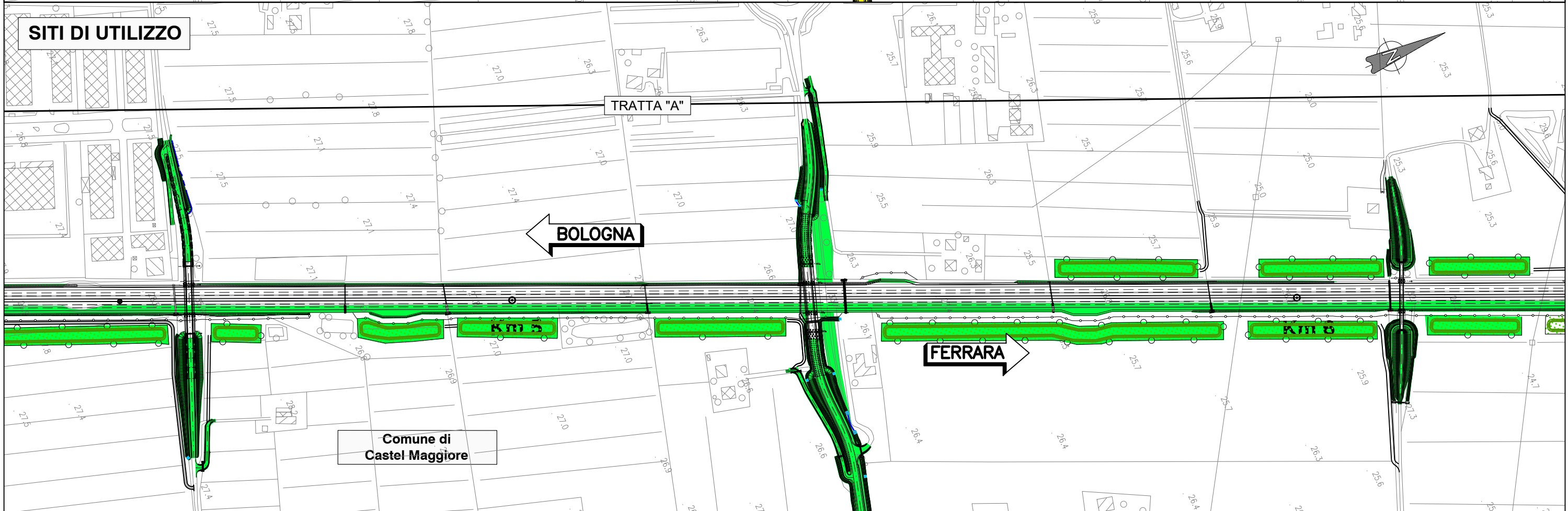
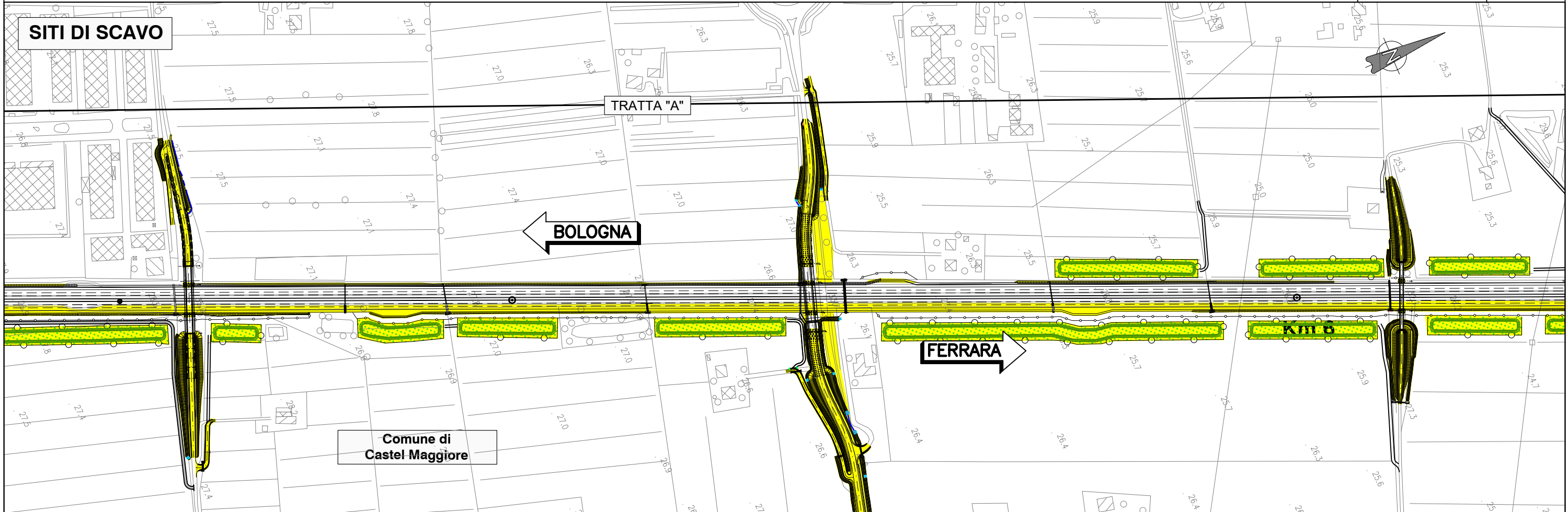



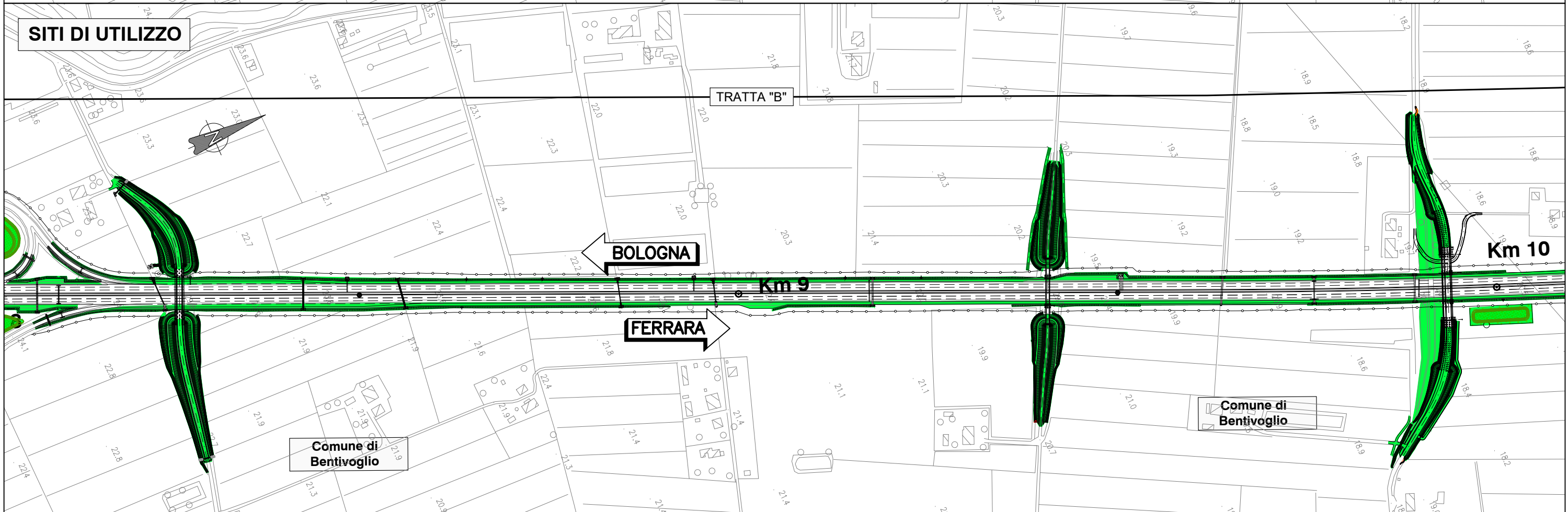
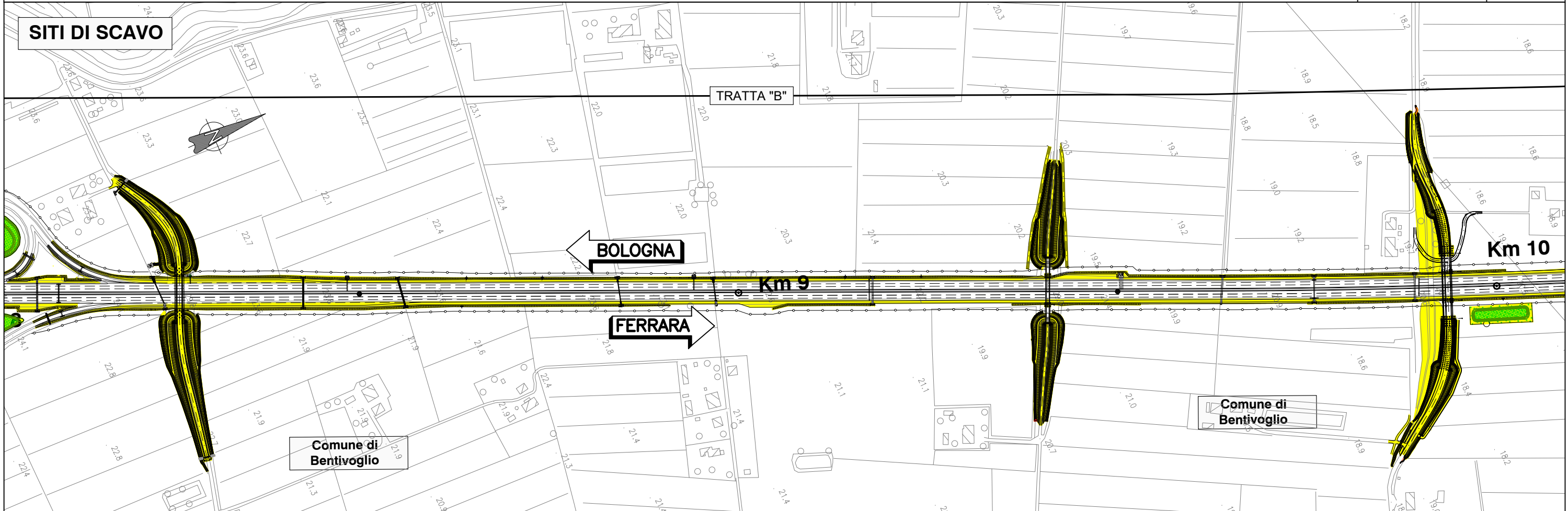

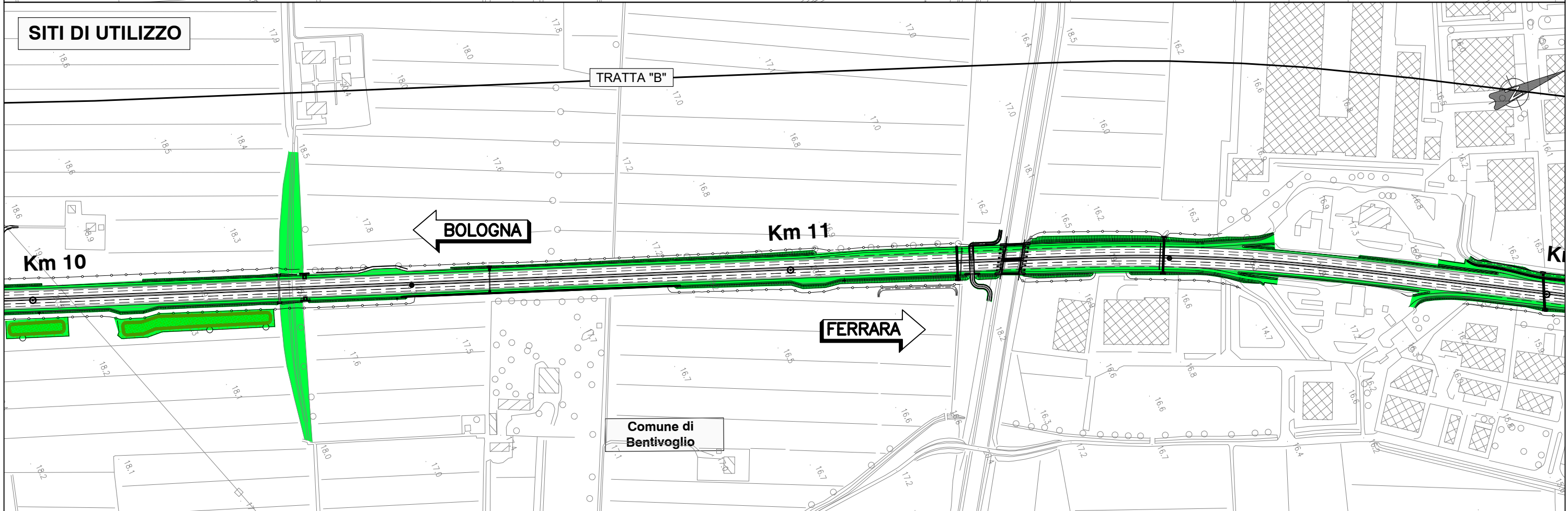
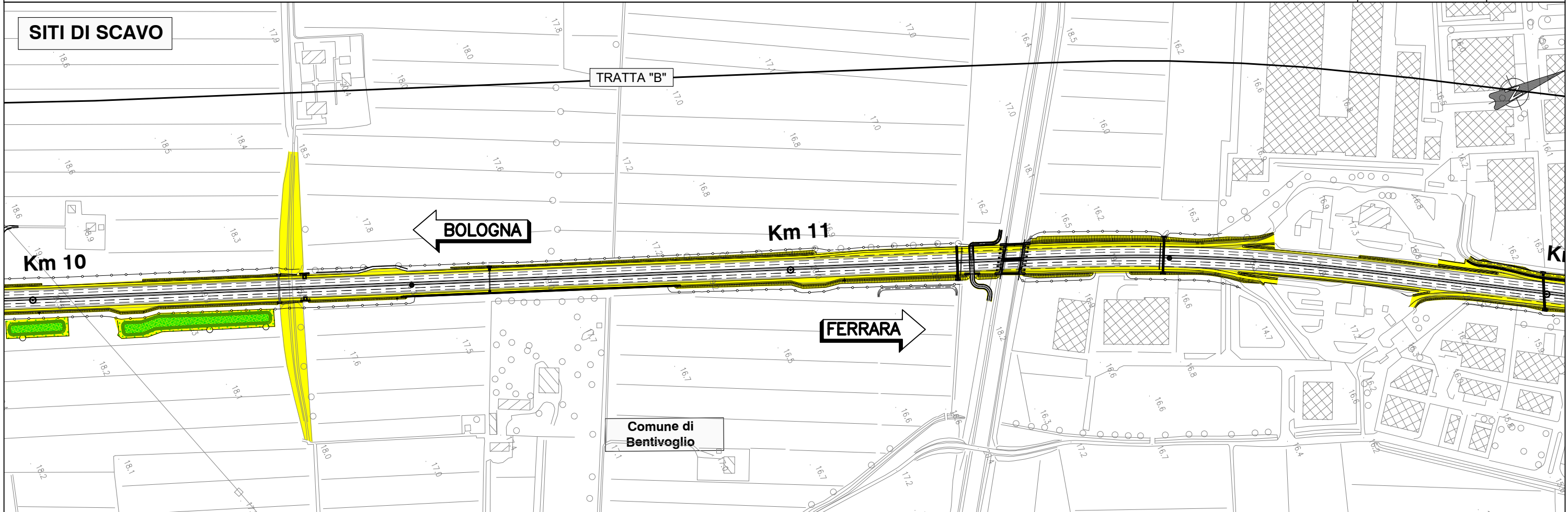

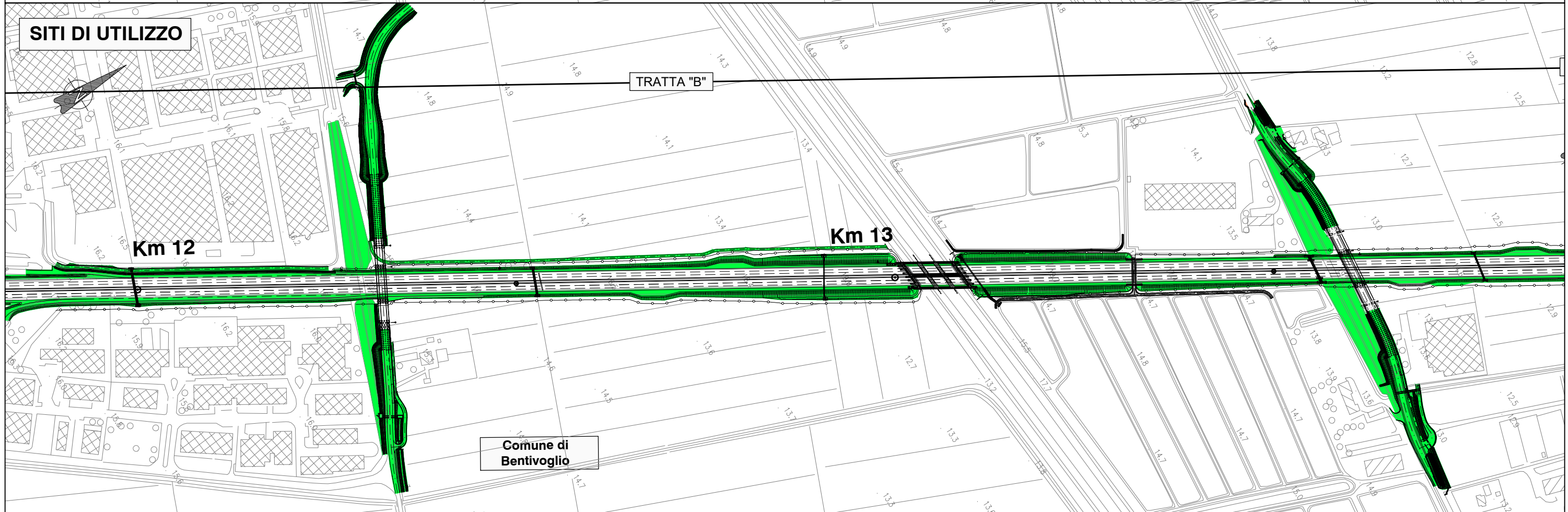
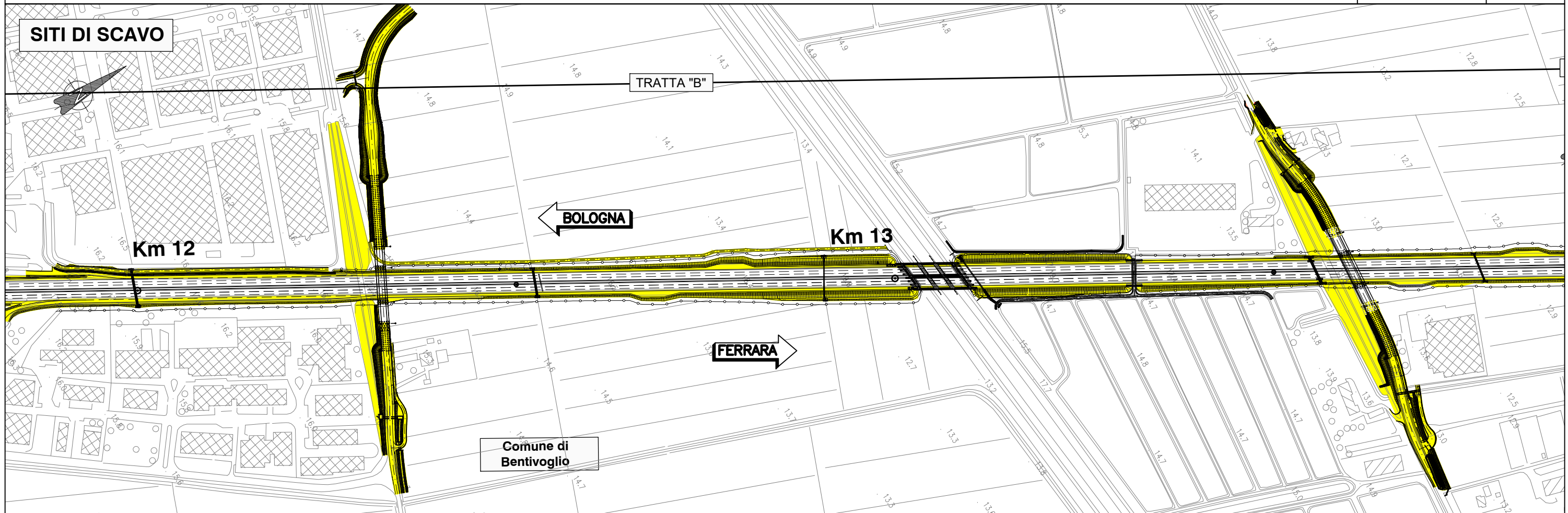

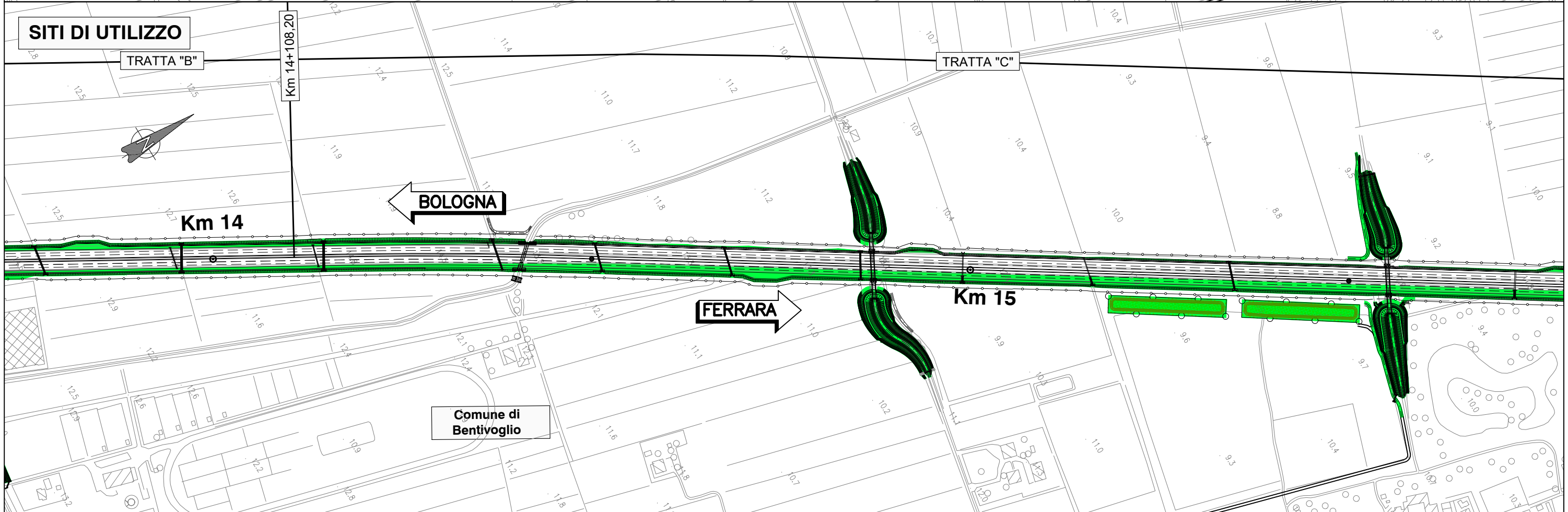
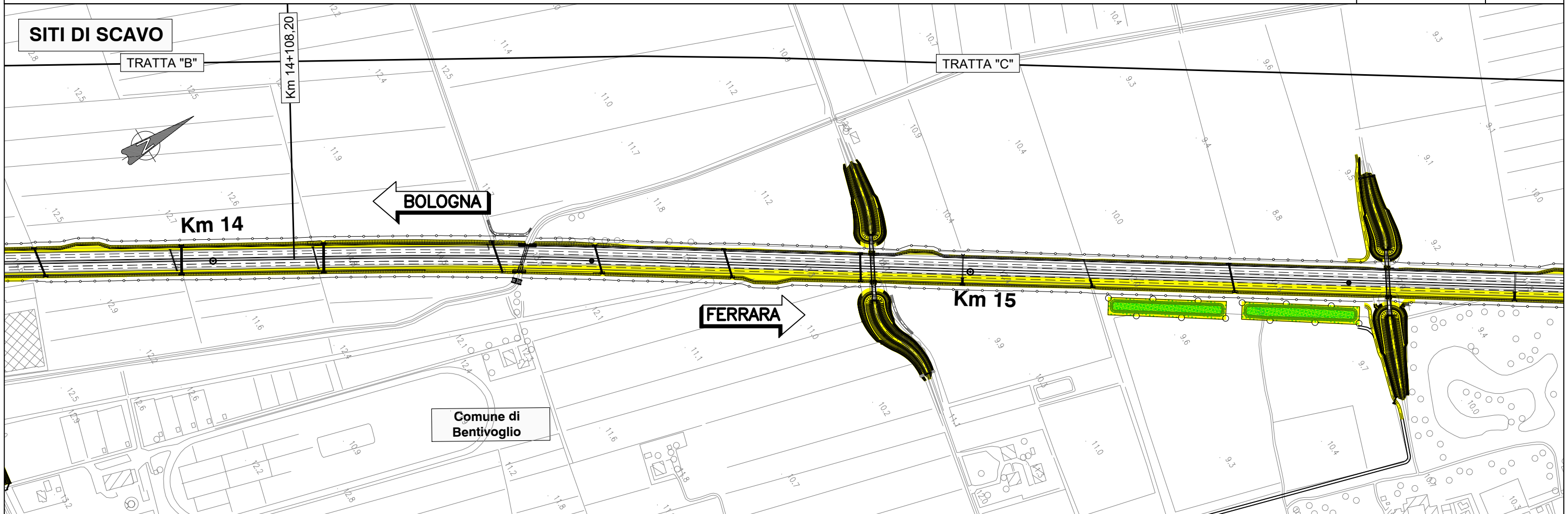

SITI DI SCAVO

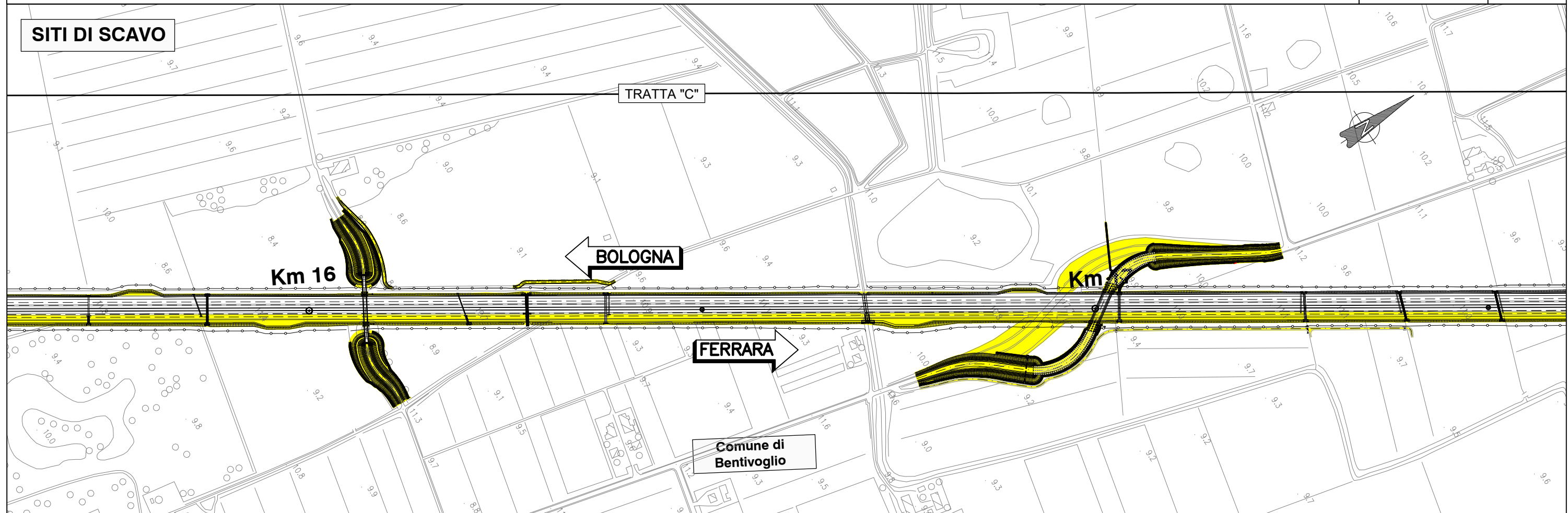

SITI DI UTILIZZO

