

Cabina Deposito Materiali - Pianta e Prospetti

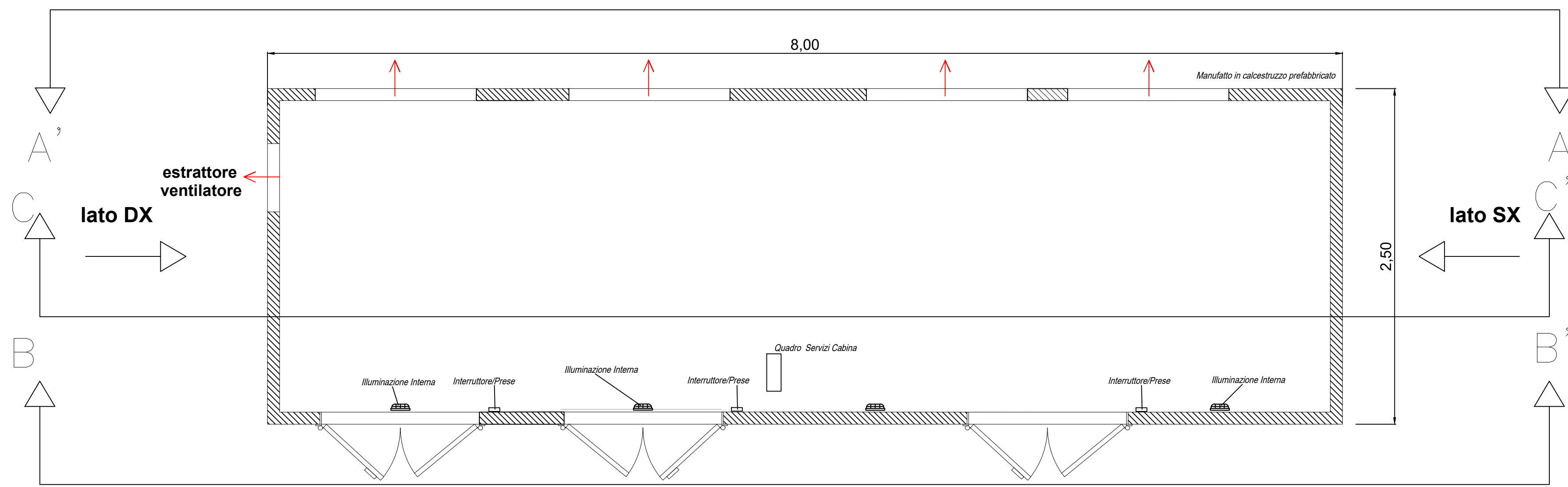

Pianta cabina di deposito

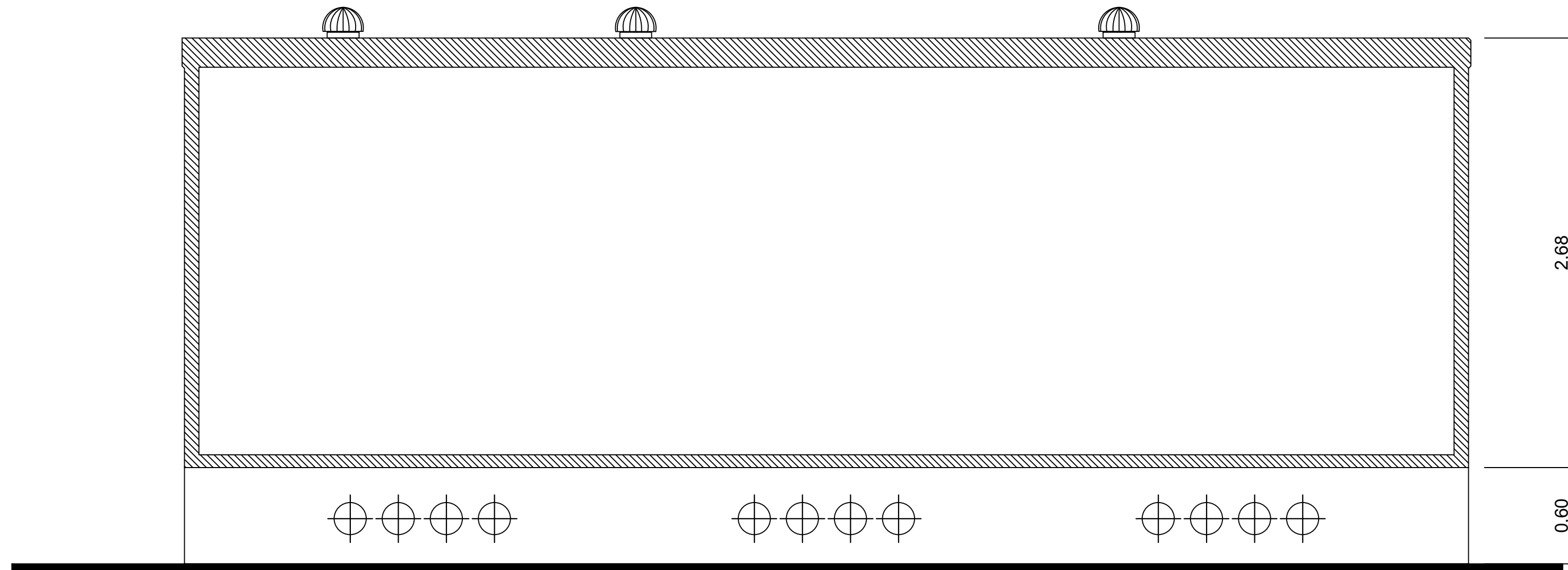

Sezione C - C' - interno

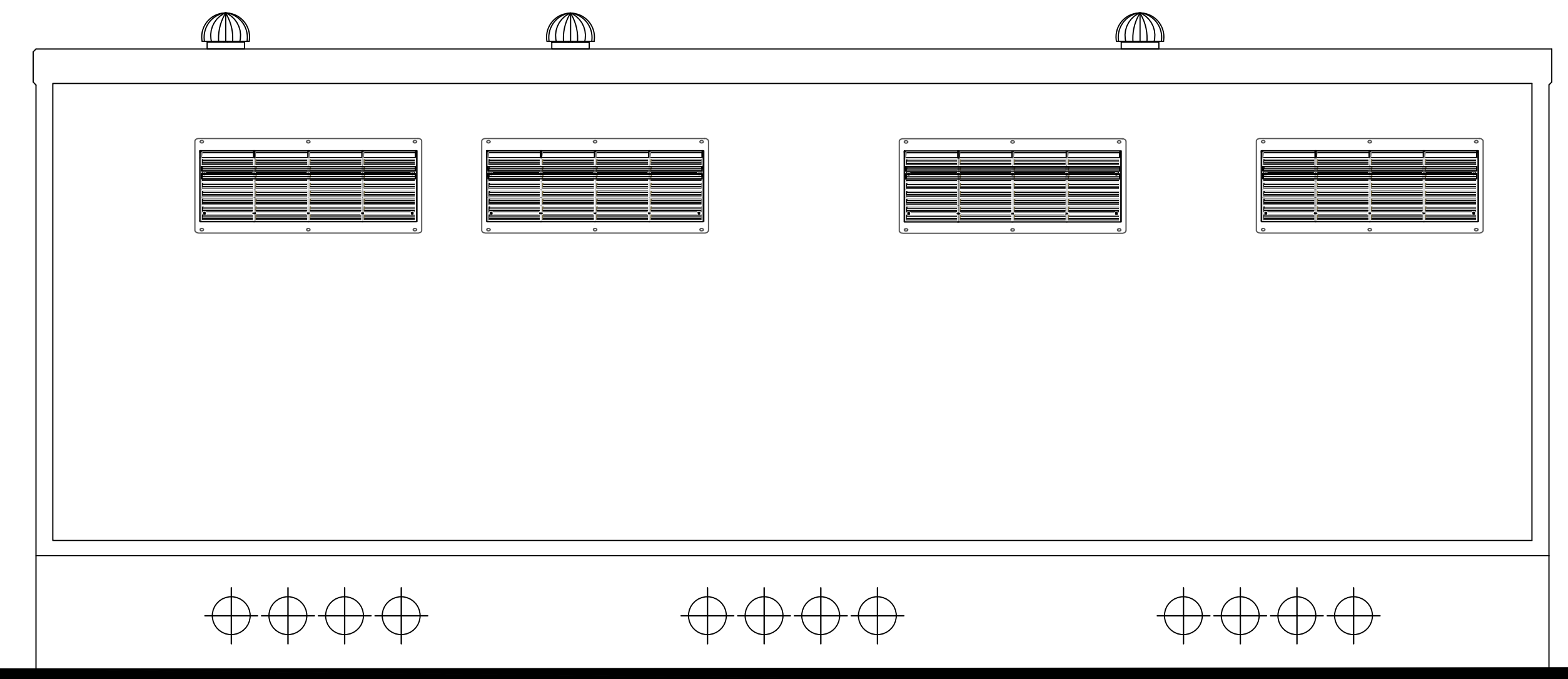

Vista A - A' - esterno

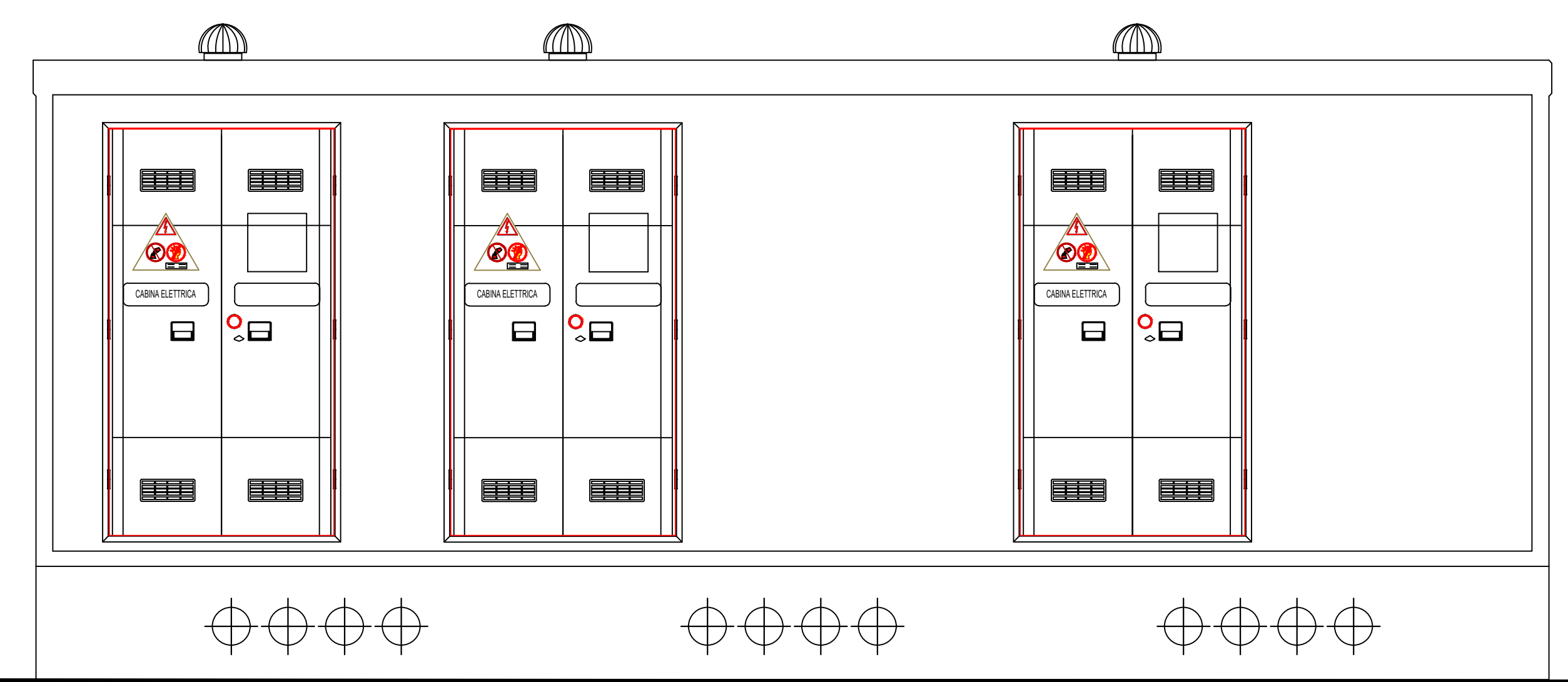

Vista B - B' - esterno

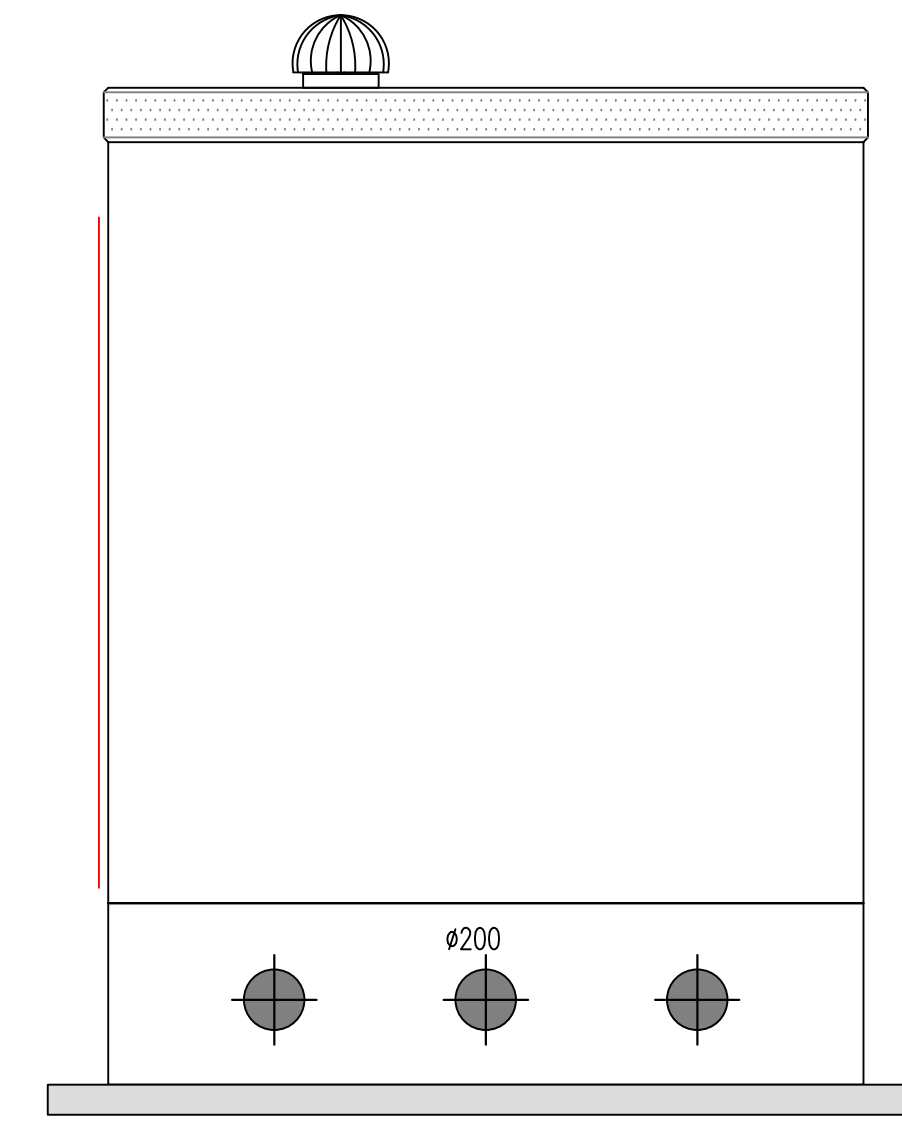

Prospetto lato SX

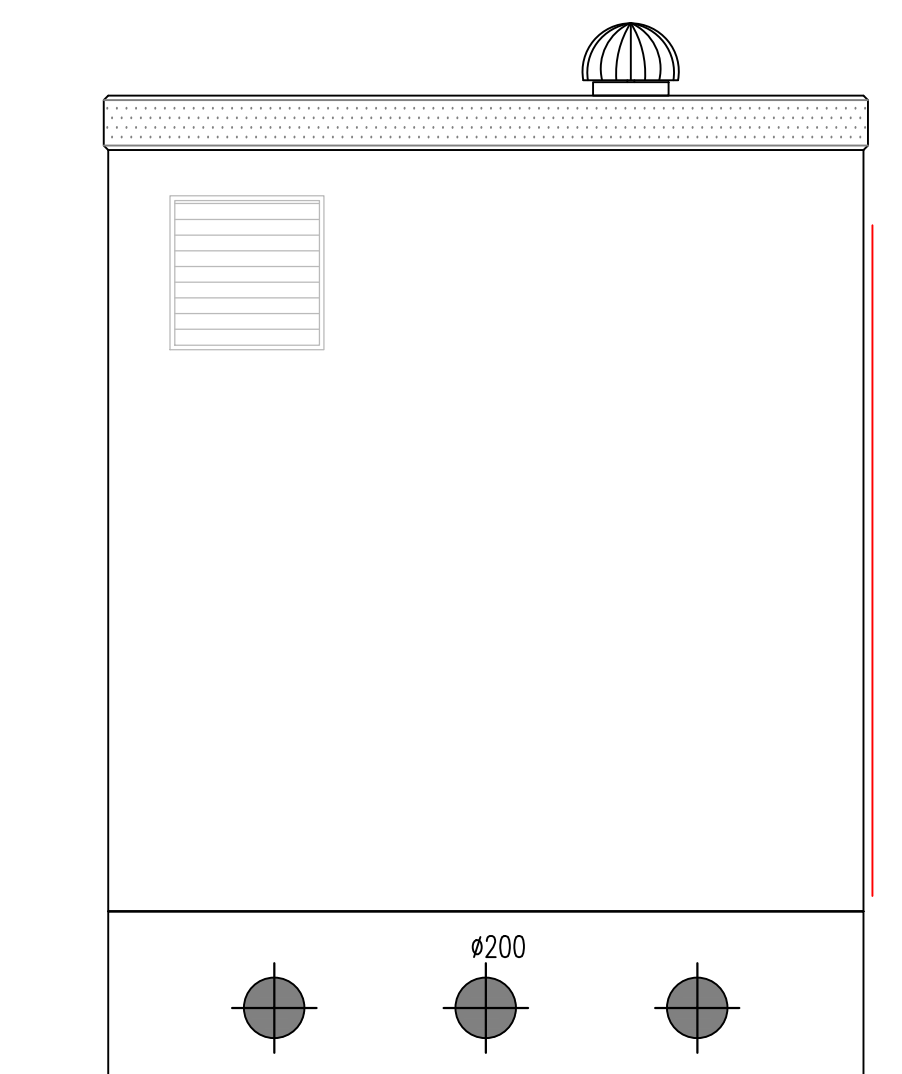

Prospetto lato DX

Scala 1:25

Control Room - Pianta e Prospetti

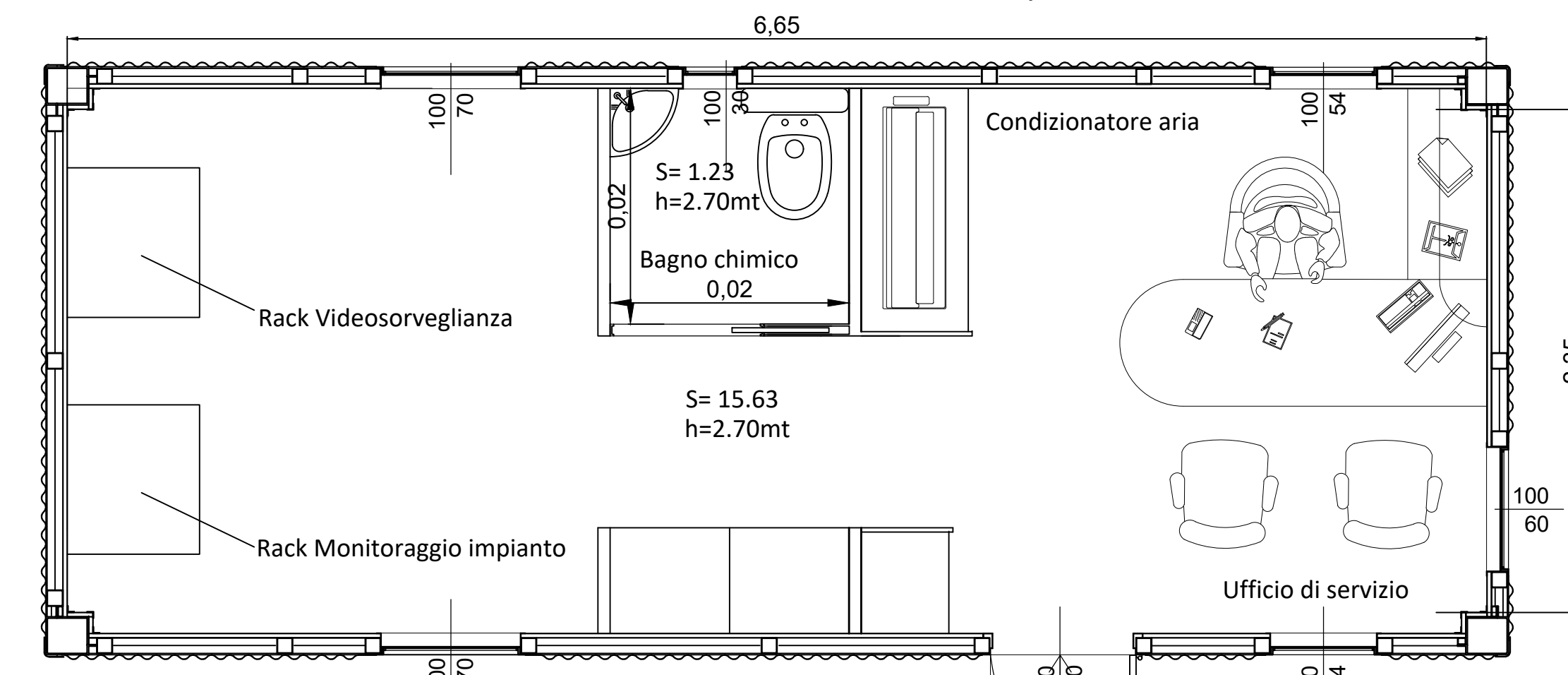

Control Room - Disposizione interna

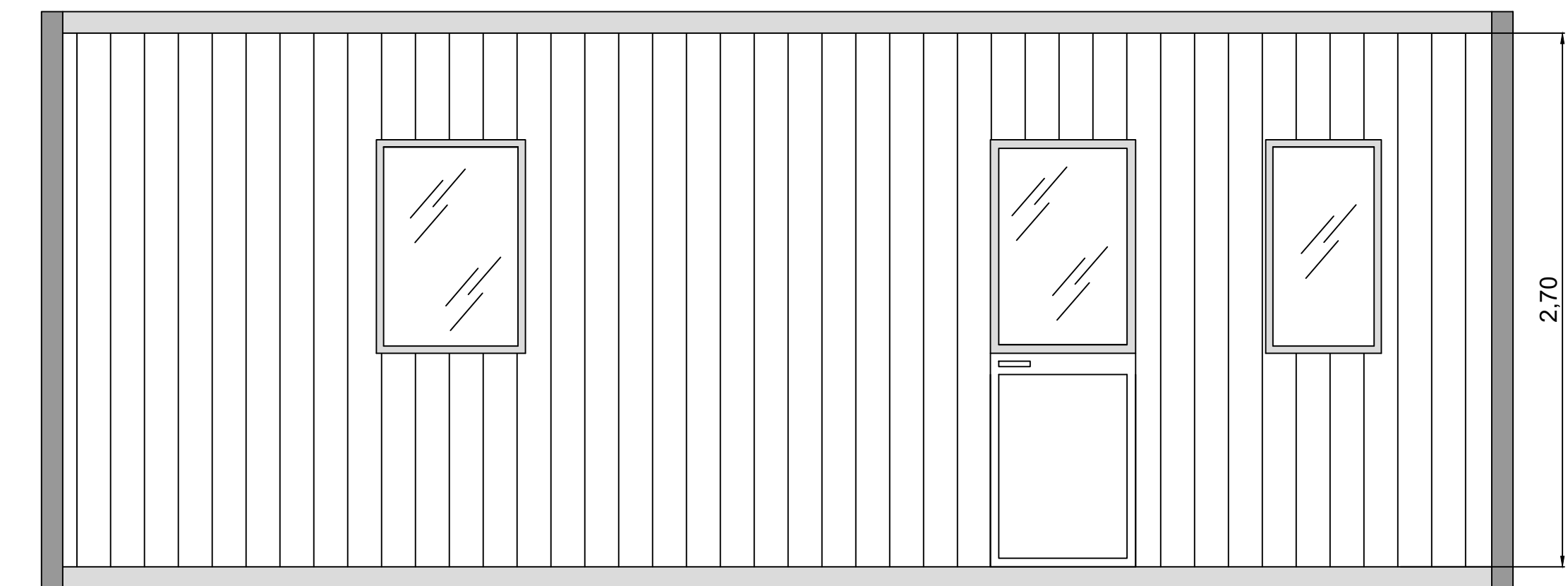

Control Room - Vista Frontale

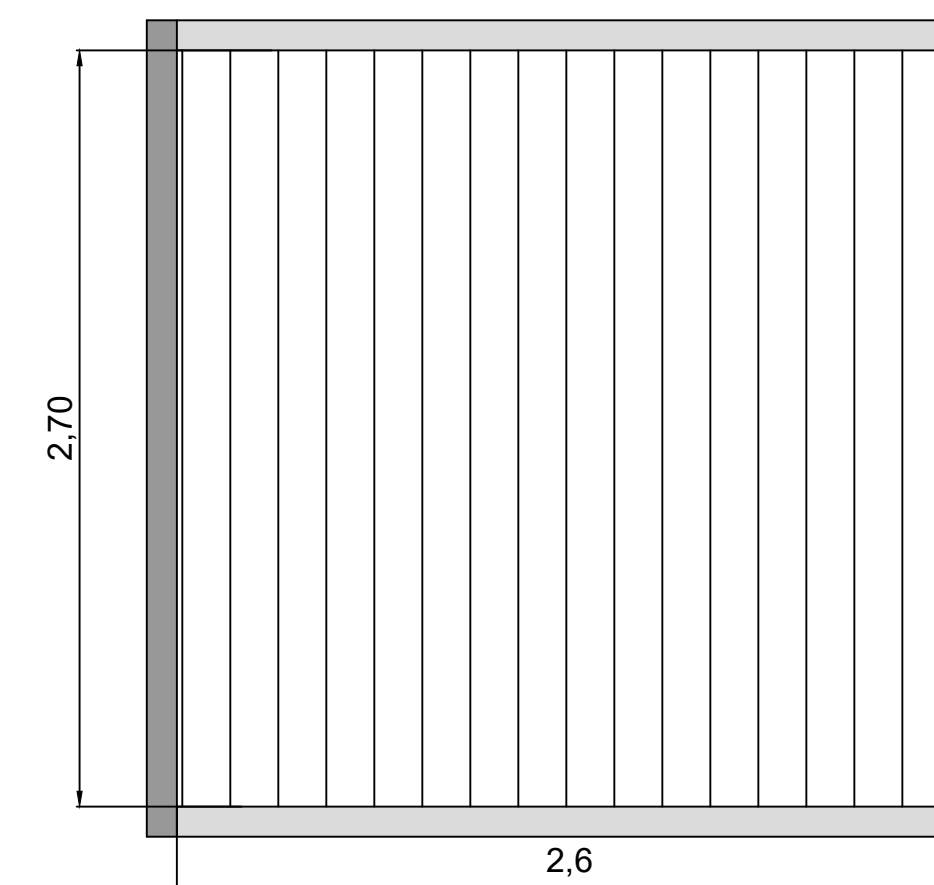

Control Room - Laterale Sinistra

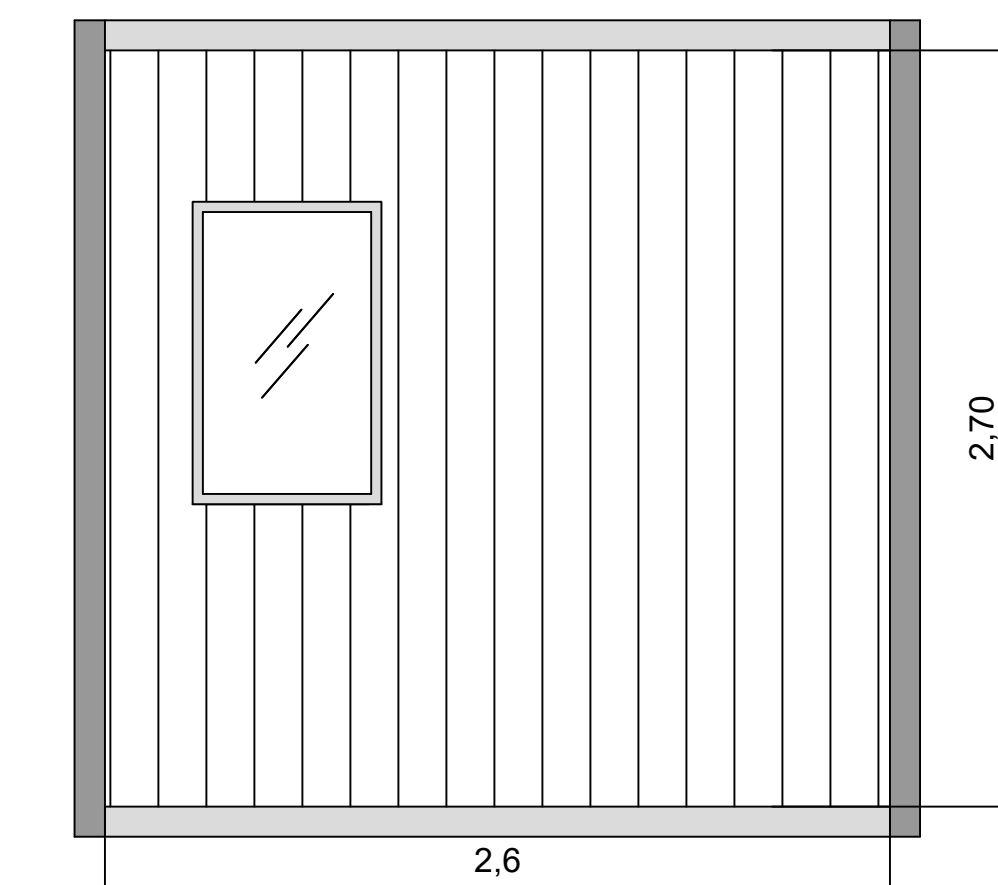

Control Room - Laterale Destra

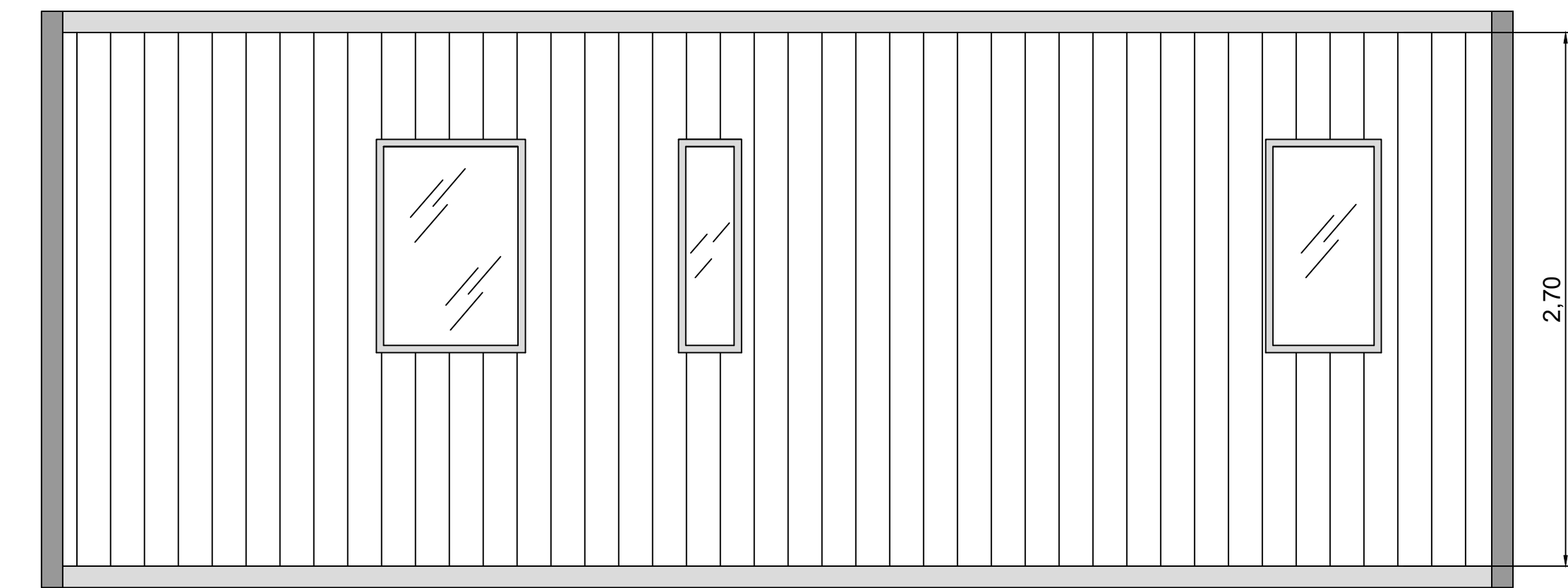

Control Room - Vista Posteriore

Rapporto Aeroilluminante Control Room

	Superficie ambiente [mq]	1/8 Superficie ambiente $S_A$ [mq]	Superficie finestrata $S_F$ [mq]	Verifica $S_A < S_F$
AREA CONTROLLO	15,63	1,95	2,48	OK
BAGNO	1,23	0,15	0,3	OK

Scala 1:25

**REGIONE SICILIA**  
**PROVINCIA DI ENNA**

**Progetto per la realizzazione di un impianto agrivoltaico da 36,7696 MW sito nel Comune di Enna (AV)**  
Località "Mulinello" denominato Enna 3

**COMITENTE**  
**Enna 3 PV s.r.l.**  
Via Alessandro Manzoni, 43 - 20121 Milano  
p.iva 16647271002

**PROGETTAZIONE**

**Horus** Green Energy Investment  
HORUS Green Energy Investment  
Viale Parioli n. 10  
00197 Roma

**FDGL** S.r.l.  
Via Ferrara n. 39  
83100 Avellino  
www.fdgl.it

Progettista:  
Ing. Fabrizio Davide

Collaboratori:  
Ing. Mario Lucadamo  
Ing. Angelo Mazza

**COMUNE DI ENNA**

**PROGETTO DEFINITIVO**

Elaborato:  
[DEF-TAV.08 - Cabina Deposito Materiali e Control Room](#)

SCALA: **1:25** DATA: **11/2022** FORMATO STAMPA: **A1**

REDAZIONE: APPROVATO: DESCRIZIONE E REVISIONE DOCUMENTO: DATA: REV: