

Planimetria - Scala 1:50

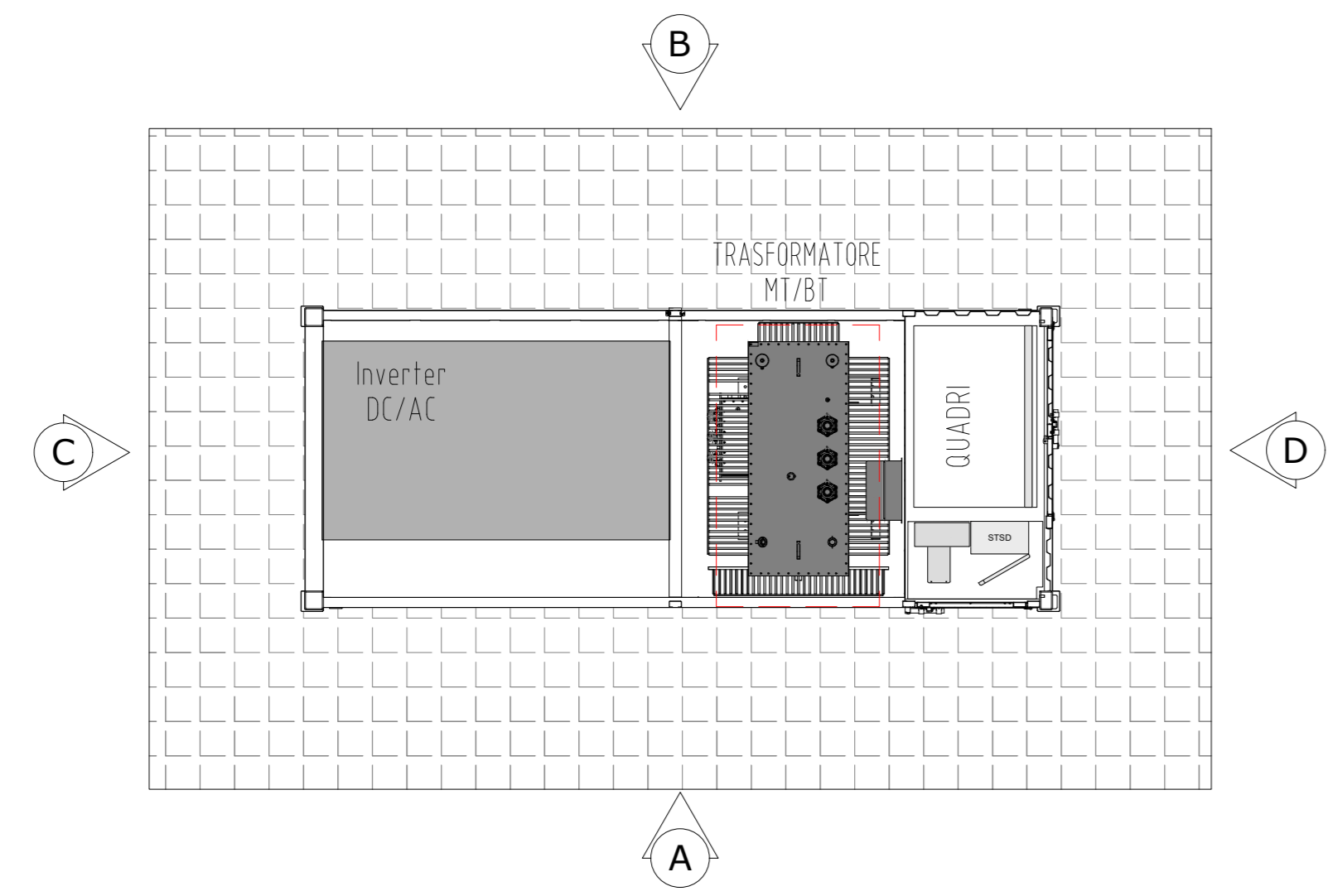

Sezione - Scala 1:50

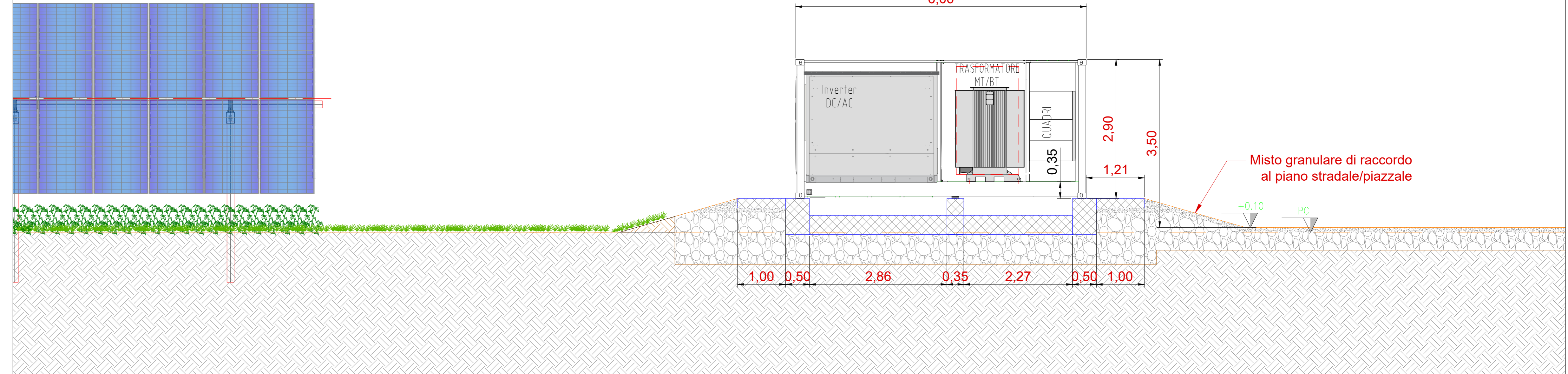

Pianta fondazioni - Scala 1:50

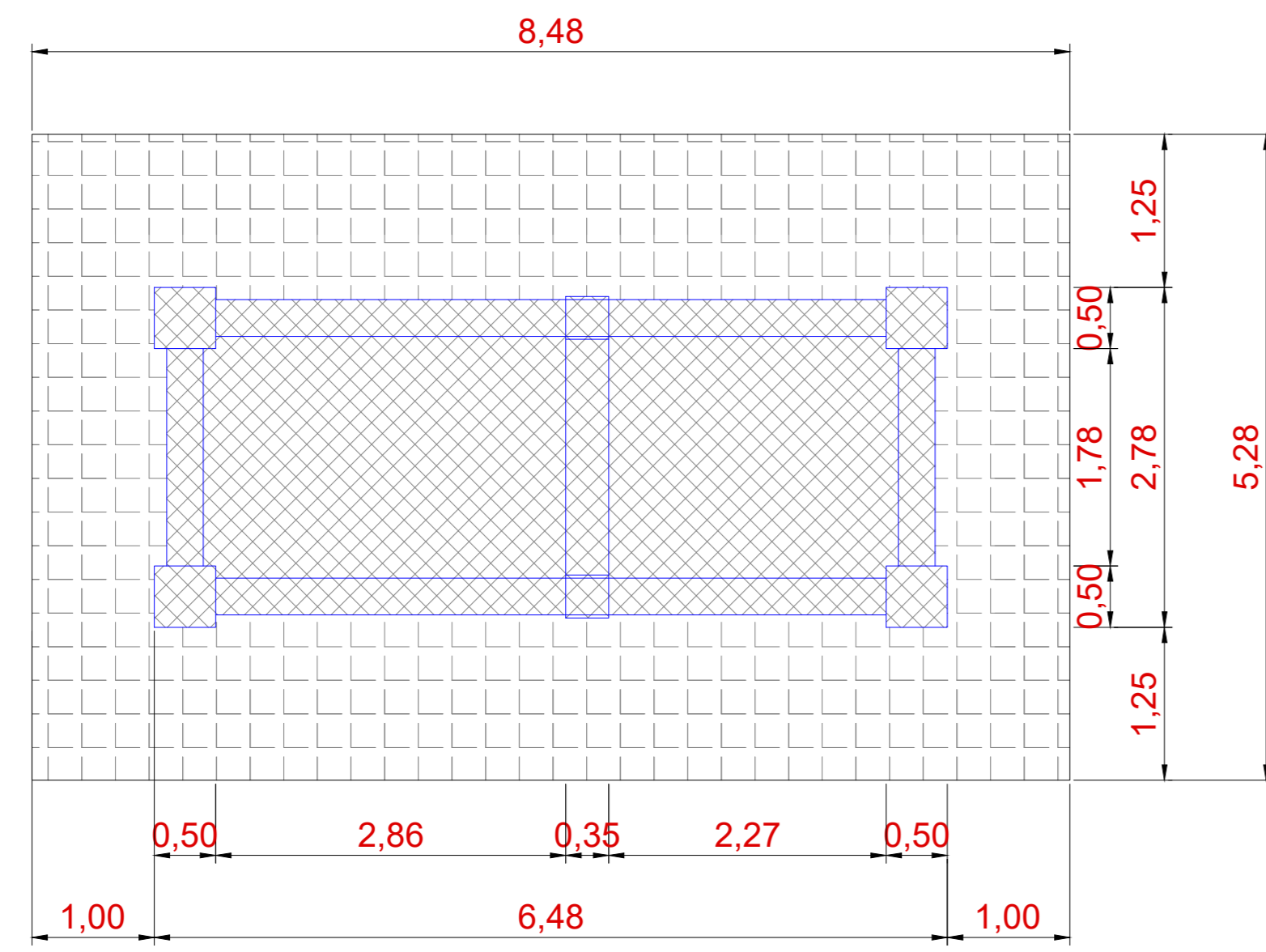

Vista A - Scala 1:50

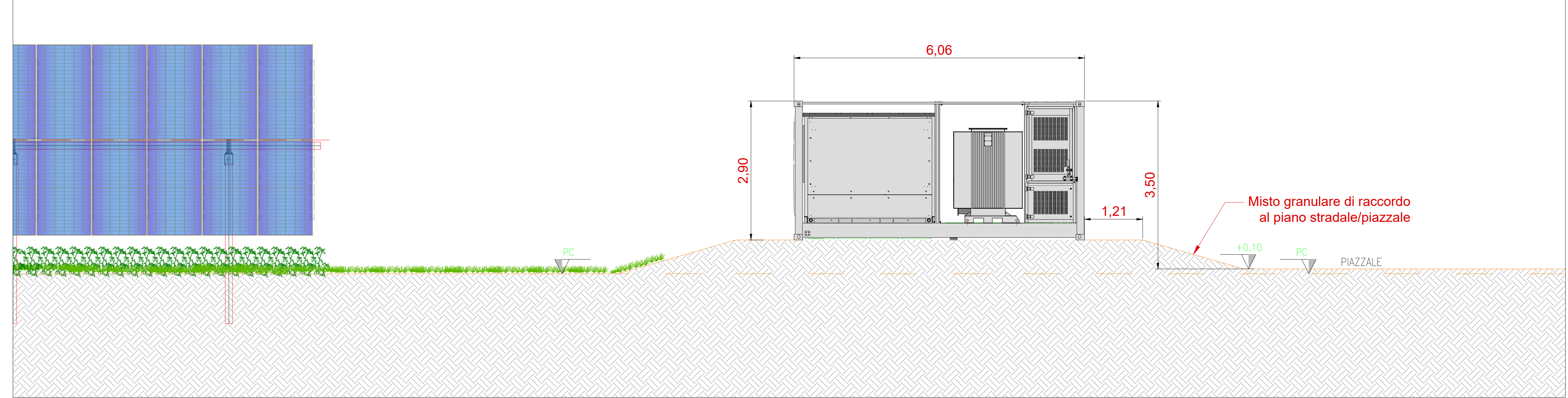

Vista dall'alto - Scala 1:50

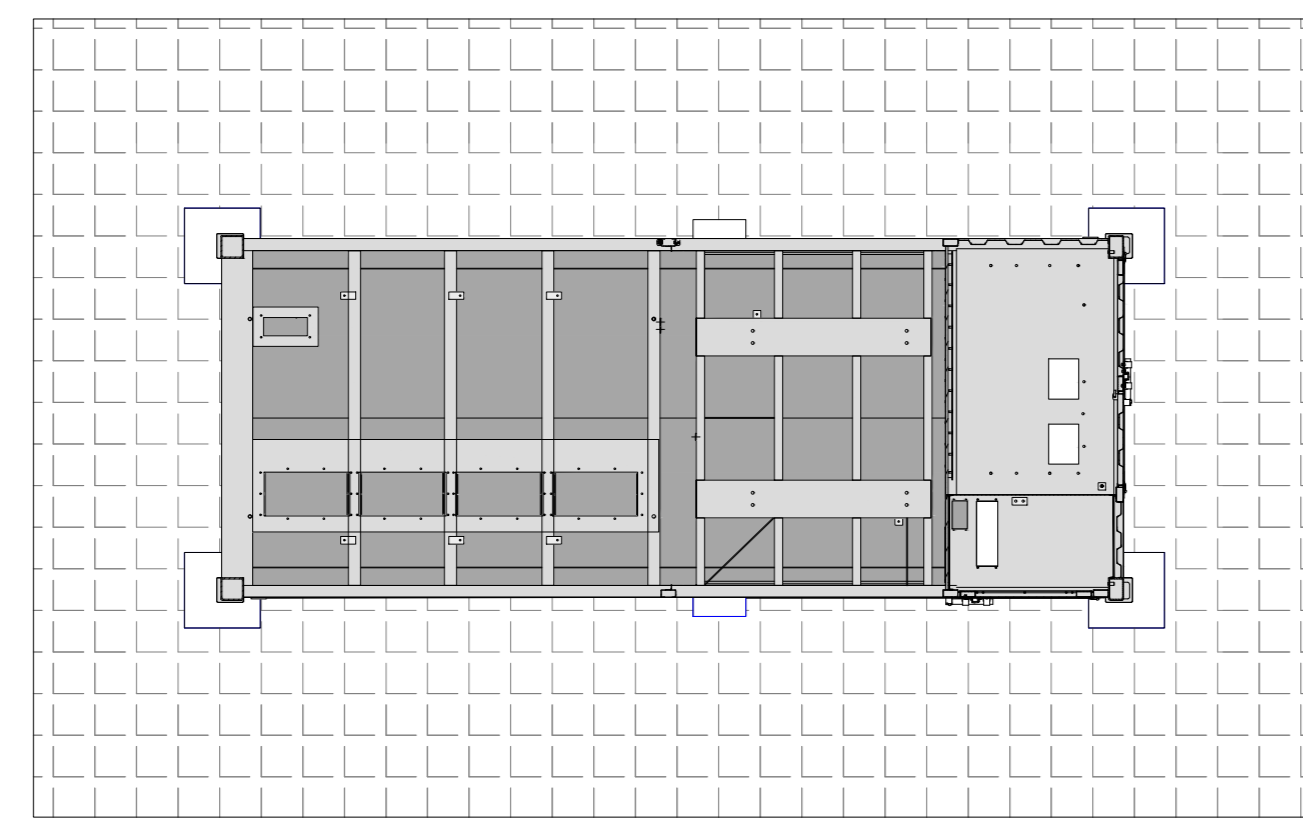

Vista B - Scala 1:50

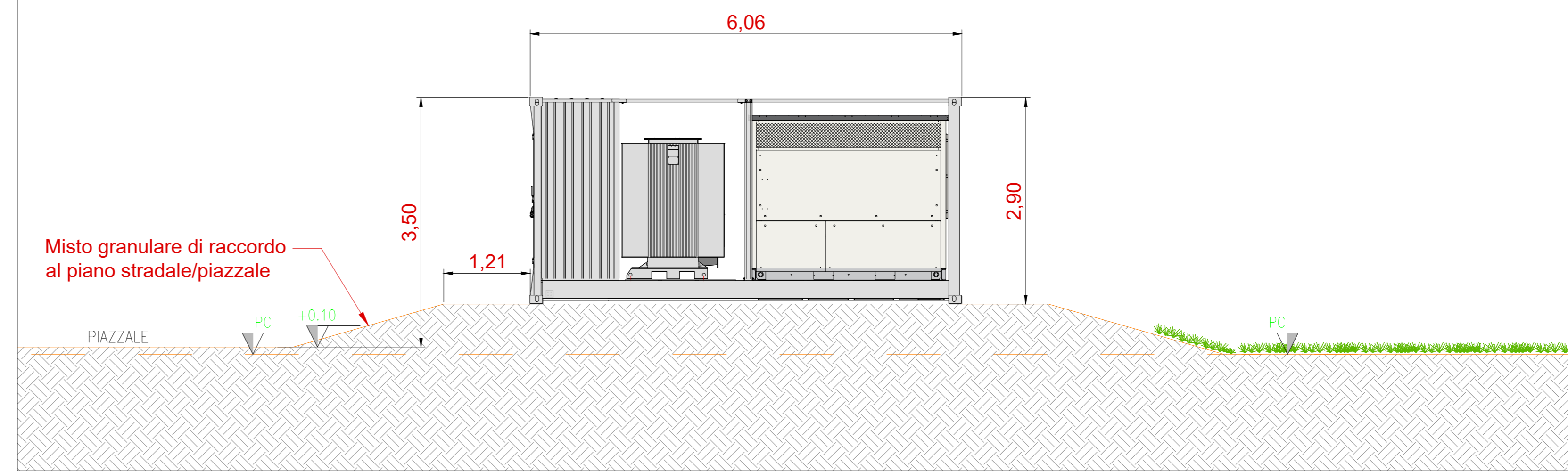

Inquadramento generale - Aree di manovra Power Station - Scala 1:200

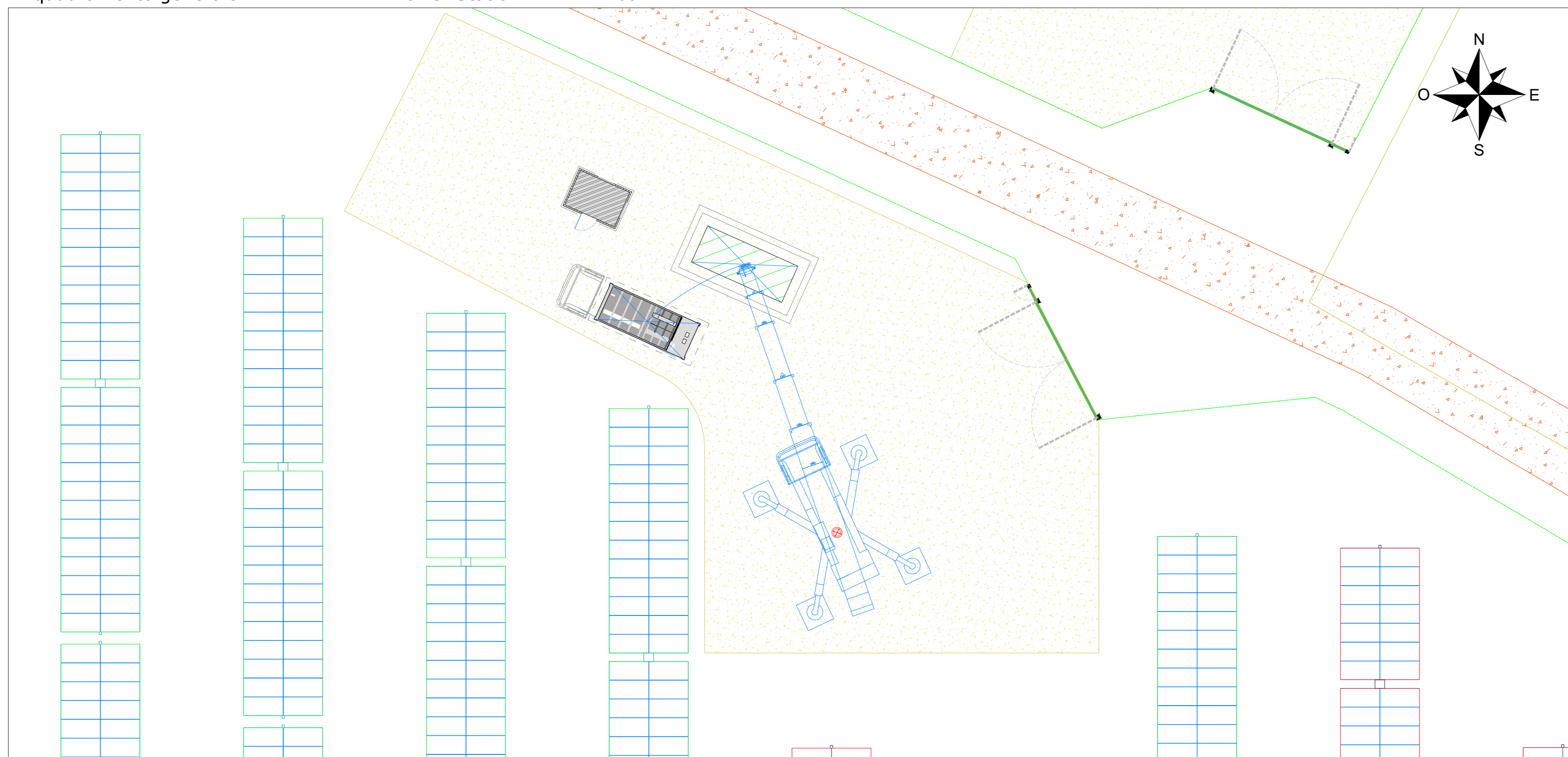

Vista D - Scala 1:50

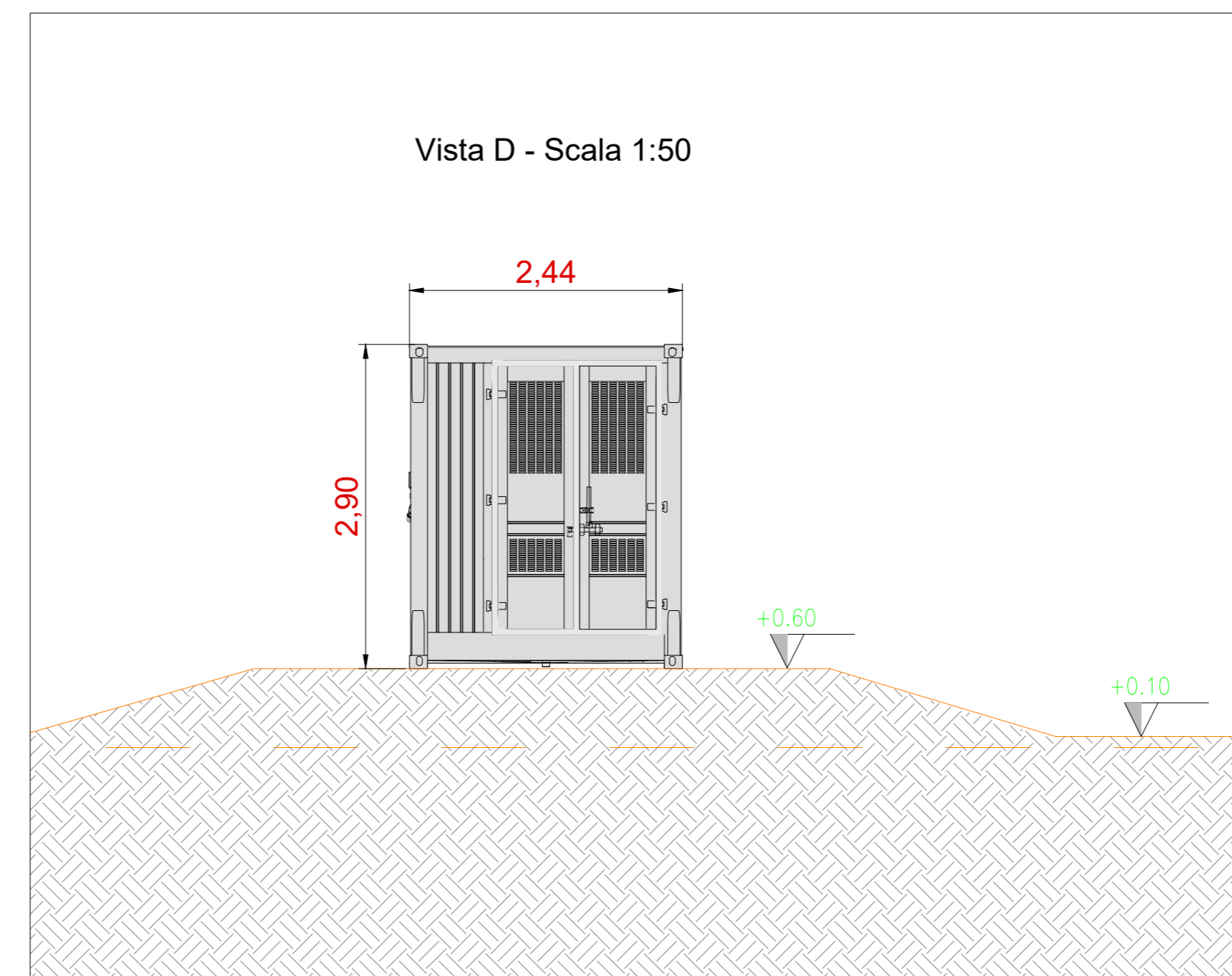

Vista C - Scala 1:50

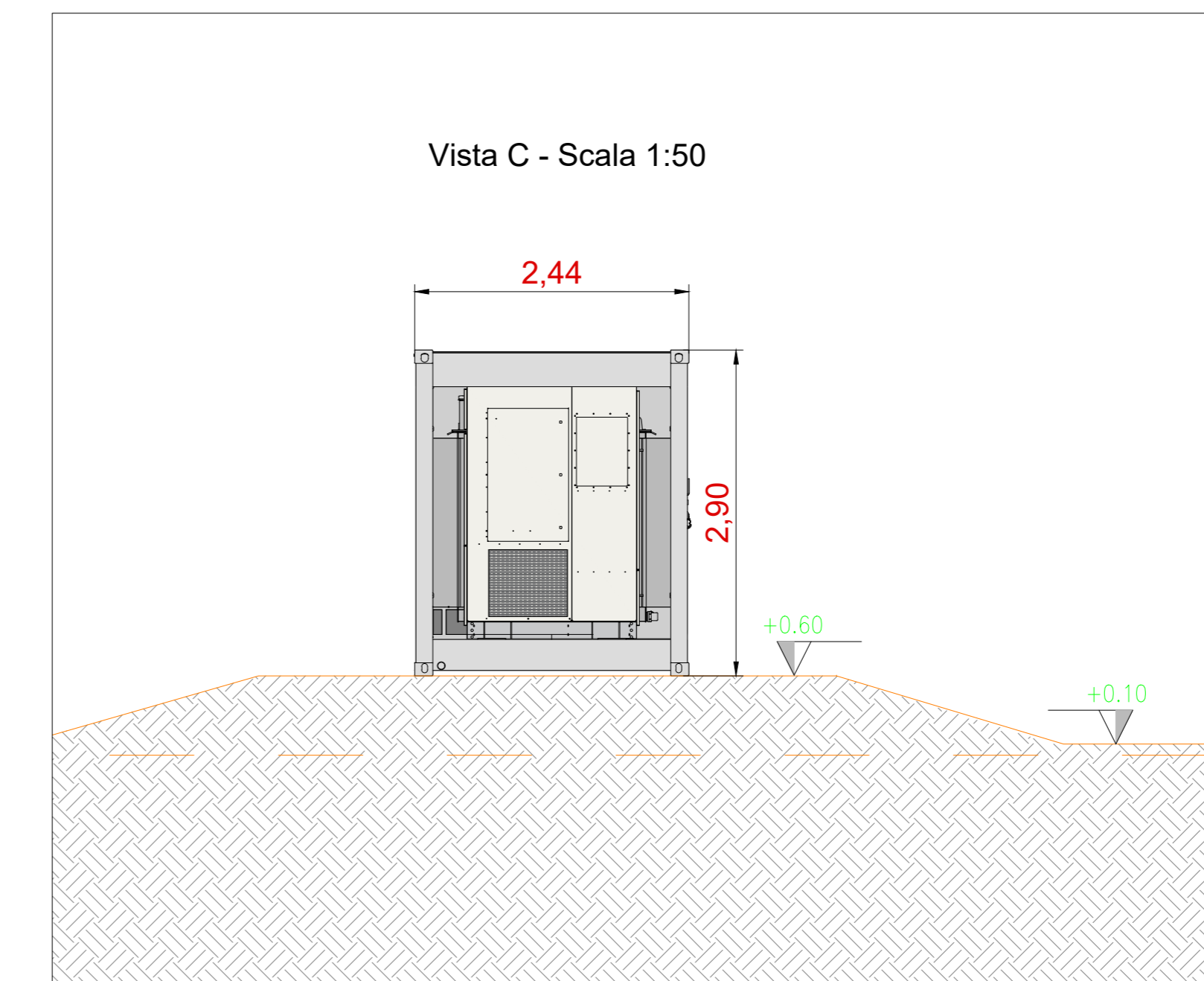

Potenze cabine

Cabina	Potenza(kVA)
C01	4400
C02, C03, C05	4200
C04	2660

REGIONE SICILIA  
COMUNE DI MONREALE (PA)

**IMPIANTO AGRIVOLTAICO DI POTENZA DI PICCO PARI A 20,08 MWp DENOMINATO "Limes 21" NEL COMUNE DI MONREALE (PA)**

**Tav.12 - Tipico power station**

PROGETTISTA	PROPONENTE	VISTI
Ing. Daniele Cavallo Studio di progettazione: SCM Ingegneria - con sede legale in: Via Carlo del Conte, 65 73022 Luchino (BR) Tel. 0871-707000 PEC: cavallo.daniele@ingepa.eu	LIMES 21 S.r.l. Sede legale e Amministrativa: 36100 Padova - Corso 22 36018 - PACHINO (PD) Tel. 049-8700000 PEC: limes21@limes.it	

Rev.	Data	Descrizione	Elaborato	Controllato	Approvato
1	15/11/2022	Prima Emissione	D.Cavallo	A.Cornadotti	R.Caroli

Scala: **Varie**

Formato Stampa: **A0**

Rev: **1**

Nome File: **Tav.12 - Tipico power station**

Foglio: **1 di 1**