

SEZIONE B-B  
SCALA 1:50

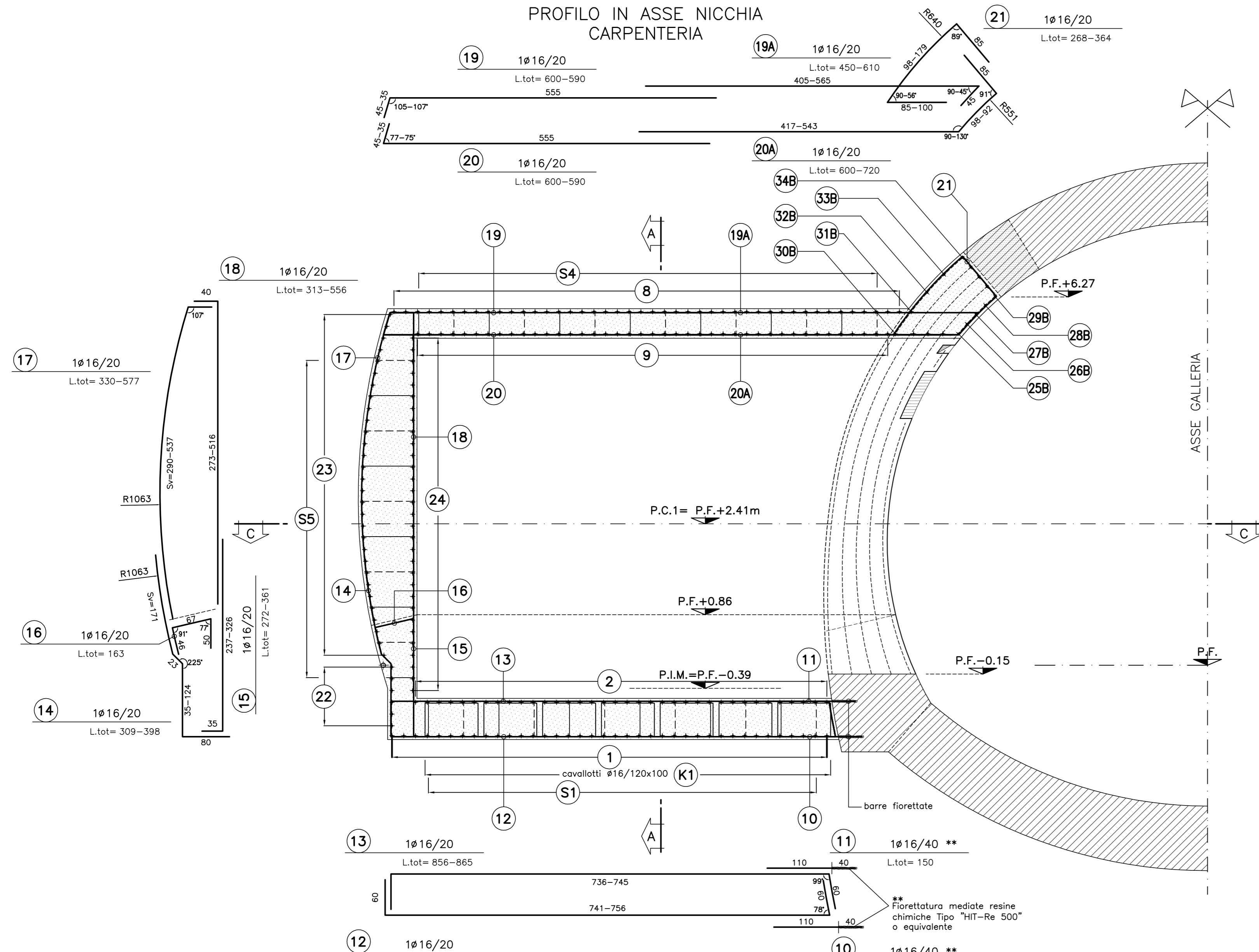

SEZIONE A-A  
SCALA 1:50

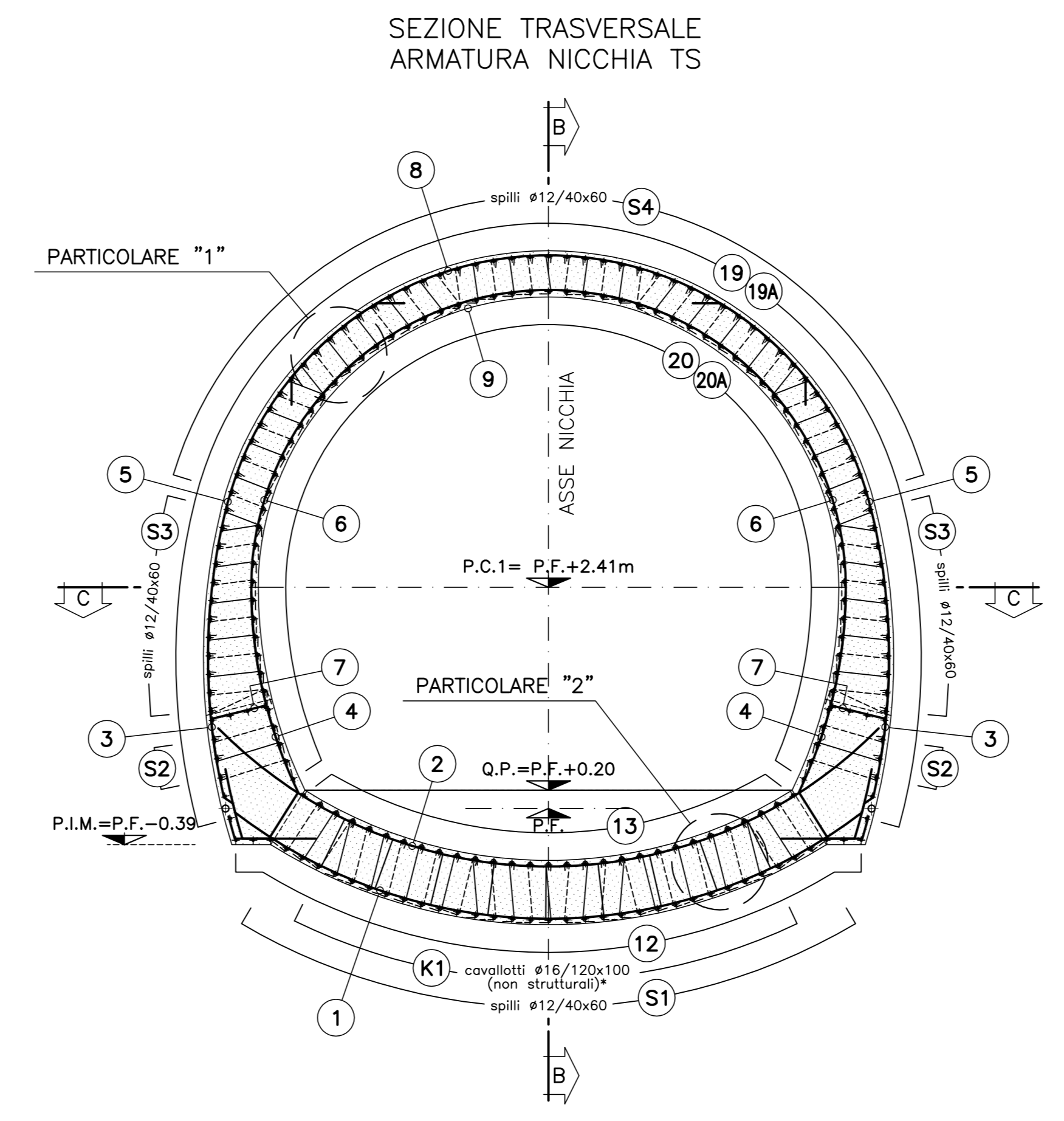

VISTA LATERALE

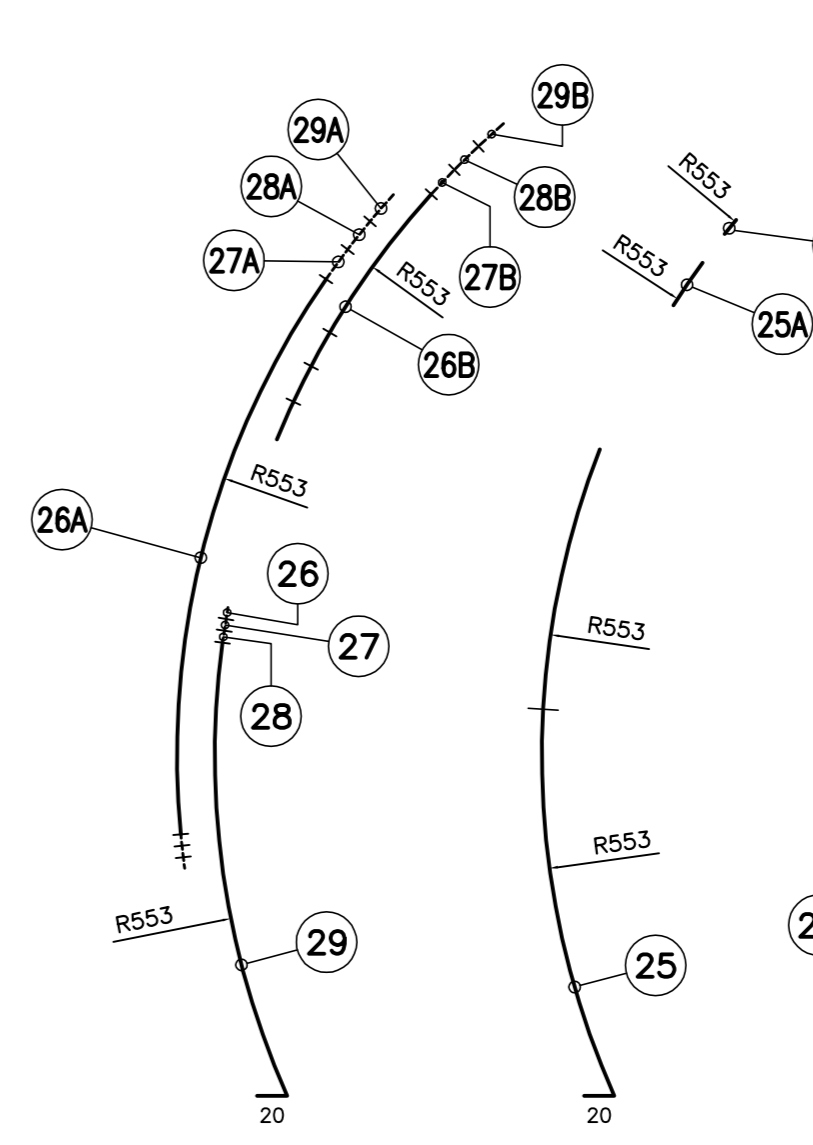

VISTA FRONTALE

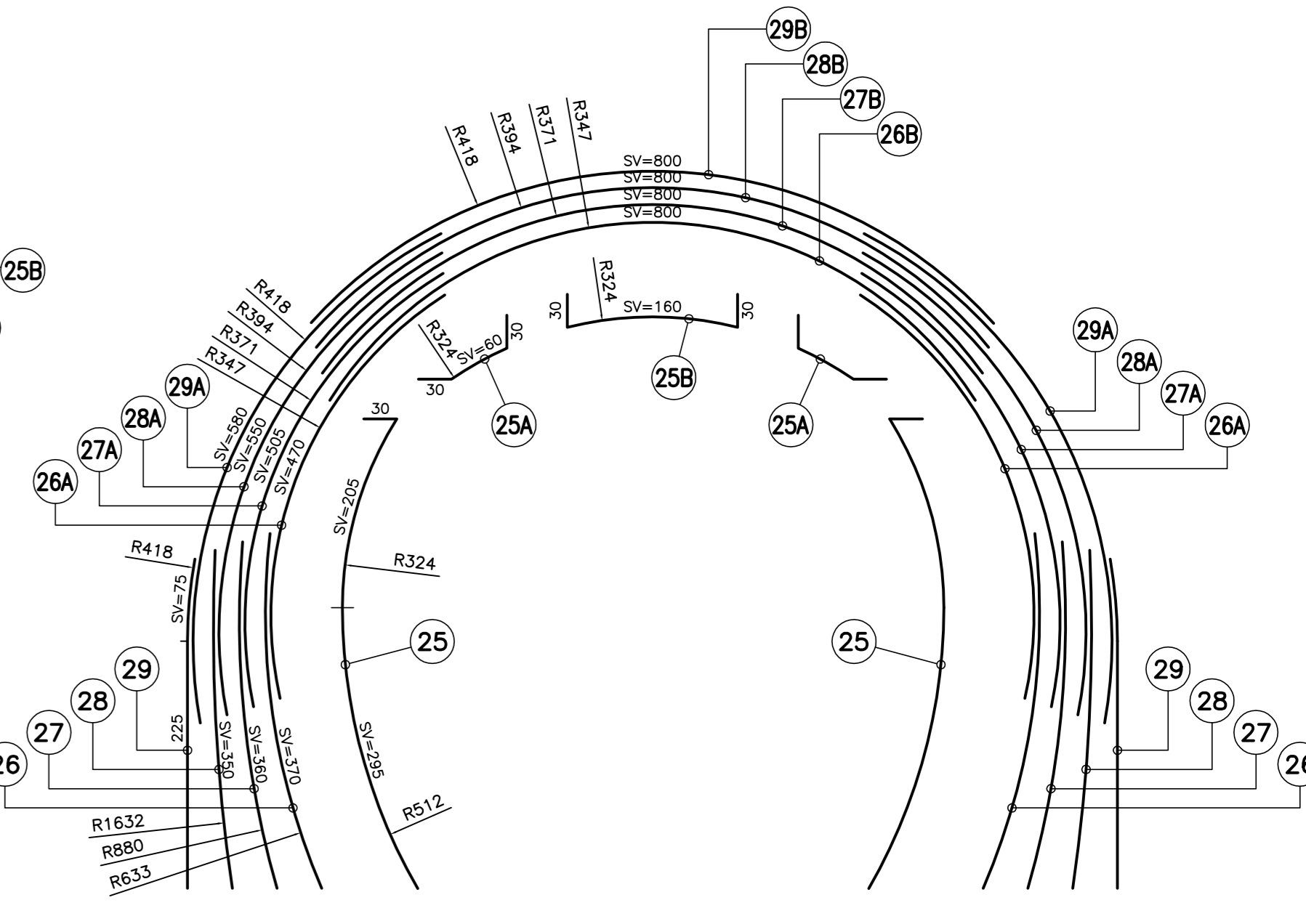

- |     |                   |     |                   |     |                   |     |                   |     |                   |
|-----|-------------------|-----|-------------------|-----|-------------------|-----|-------------------|-----|-------------------|
| 25  | 1ø20<br>Ltot= 550 | 26  | 1ø16<br>Ltot= 390 | 27  | 1ø16<br>Ltot= 380 | 28  | 1ø16<br>Ltot= 370 | 29  | 1ø20<br>Ltot= 360 |
| 25A | 1ø20<br>Ltot= 120 | 26  | 1ø16<br>Ltot= 470 | 27A | 1ø16<br>Ltot= 505 | 28A | 1ø16<br>Ltot= 550 | 29A | 1ø20<br>Ltot= 580 |
| 25B | 1ø20<br>Ltot= 220 | 26B | 1ø16<br>Ltot= 800 | 27B | 1ø16<br>Ltot= 800 | 28B | 1ø16<br>Ltot= 800 | 29B | 1ø20<br>Ltot= 800 |

SEZIONE C-C  
SCALA 1:50

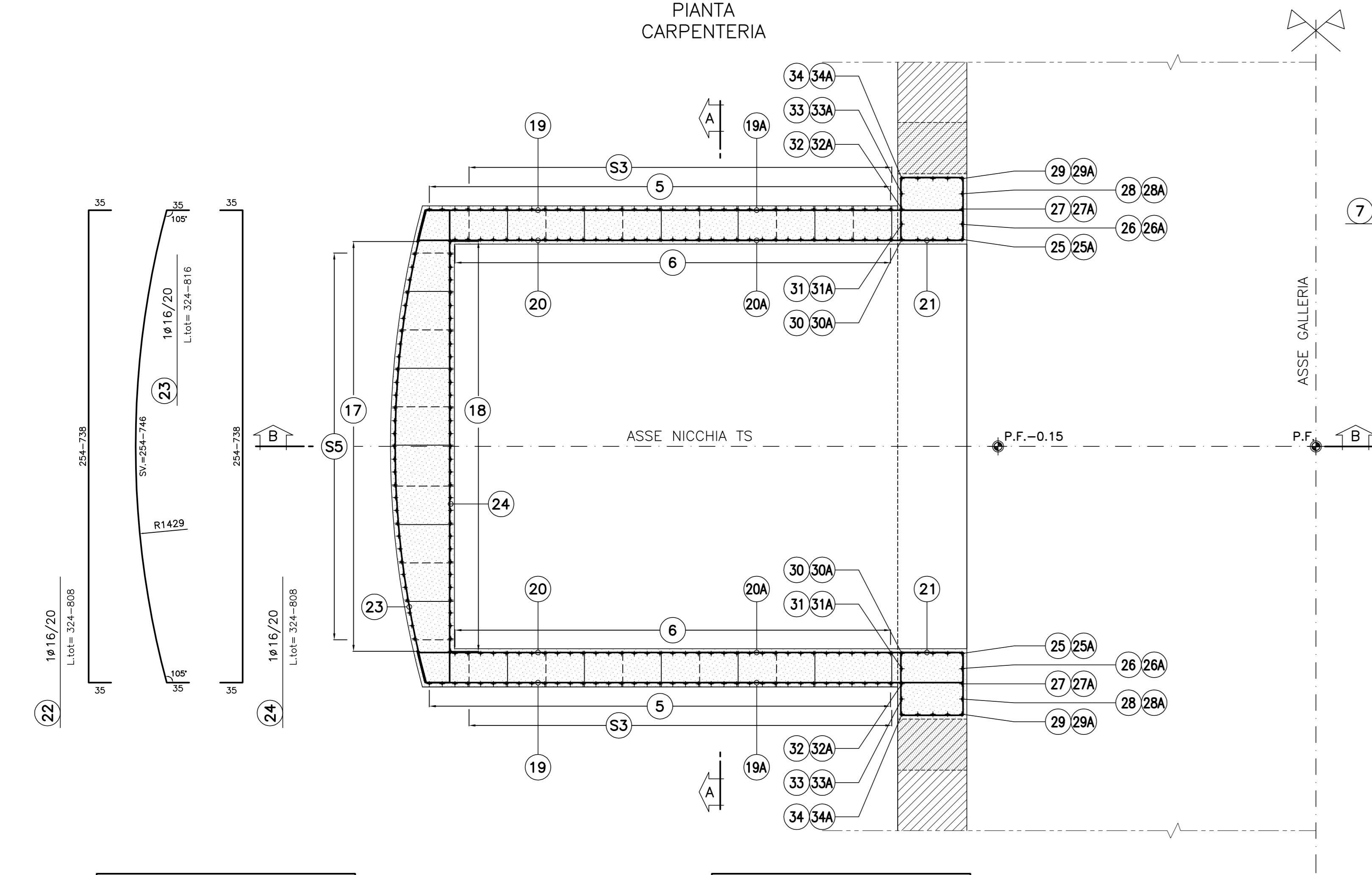

ESPLOSO

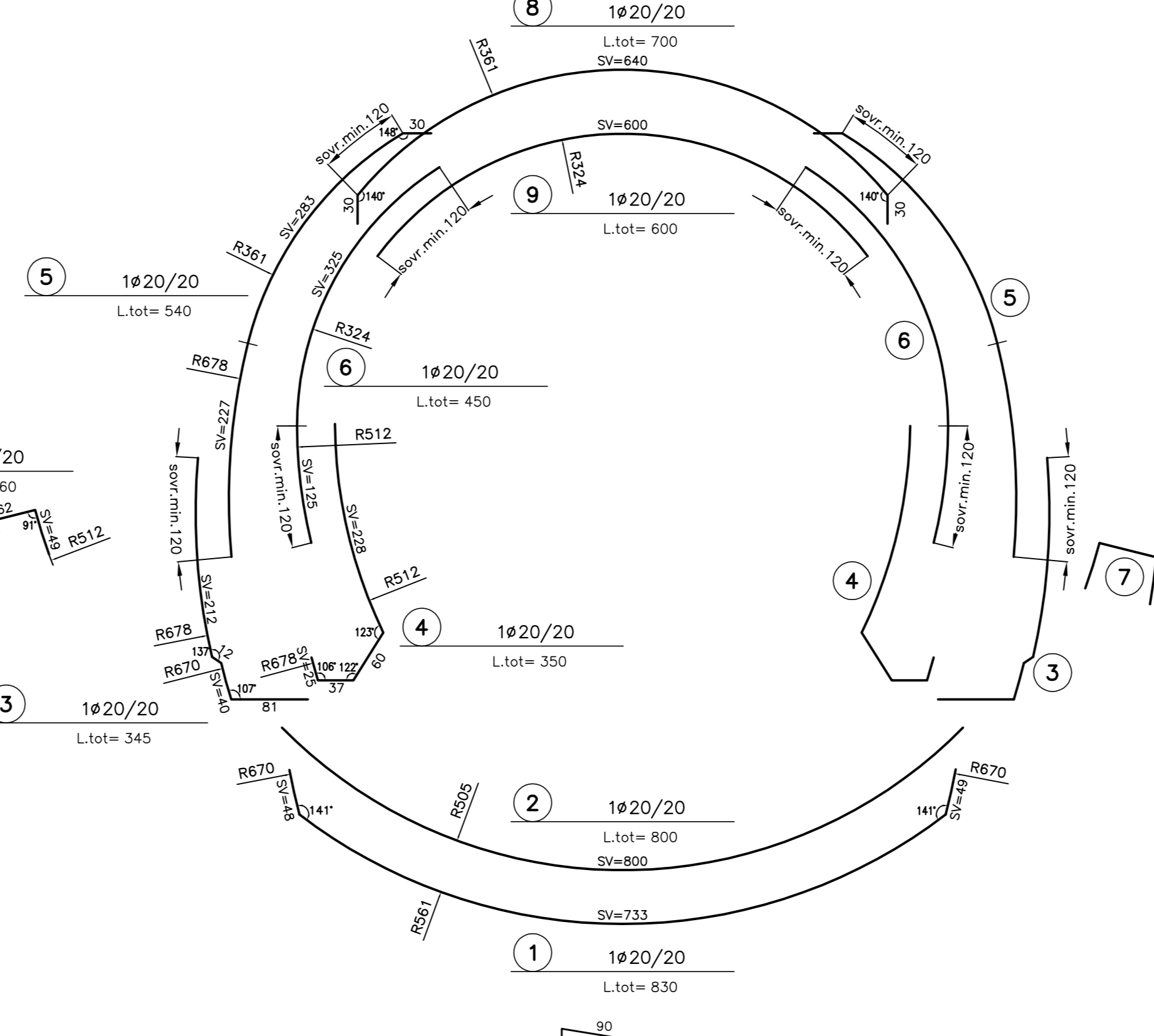

VISTA LATERALE

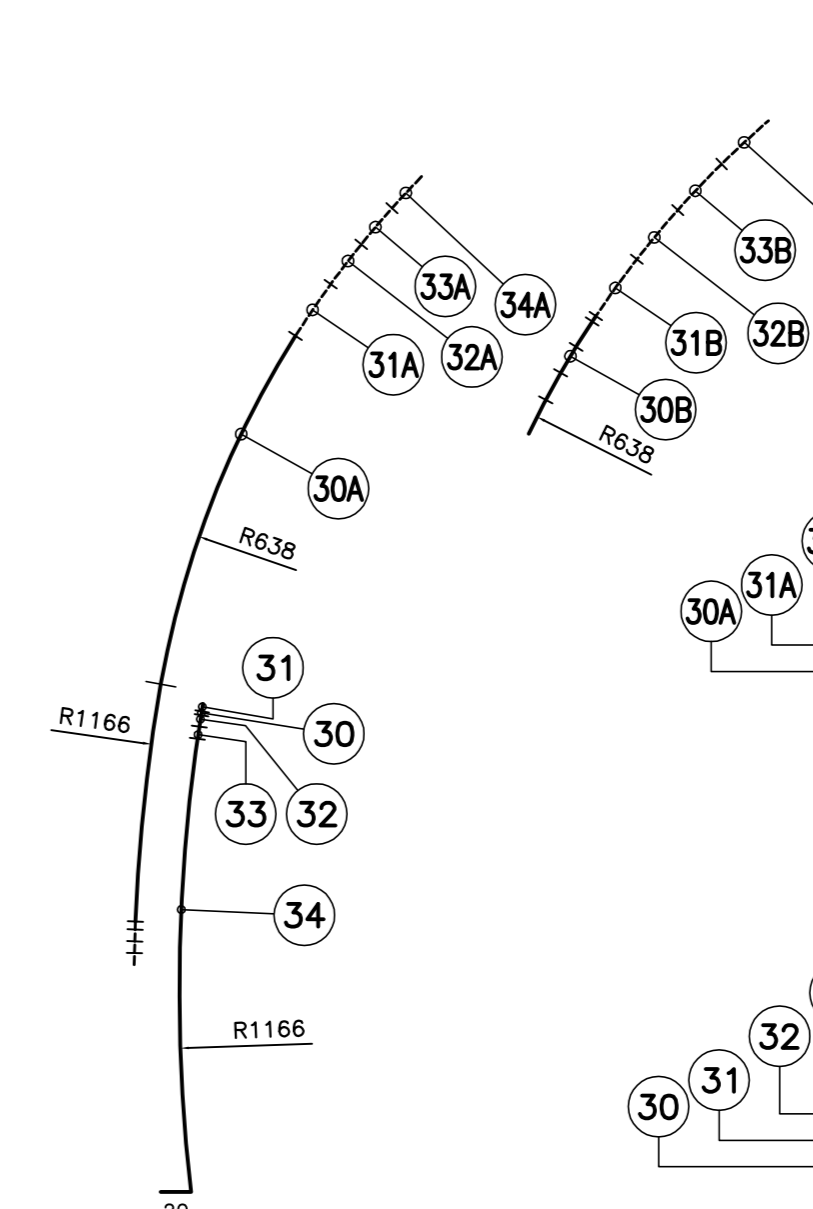

VISTA FRONTALE

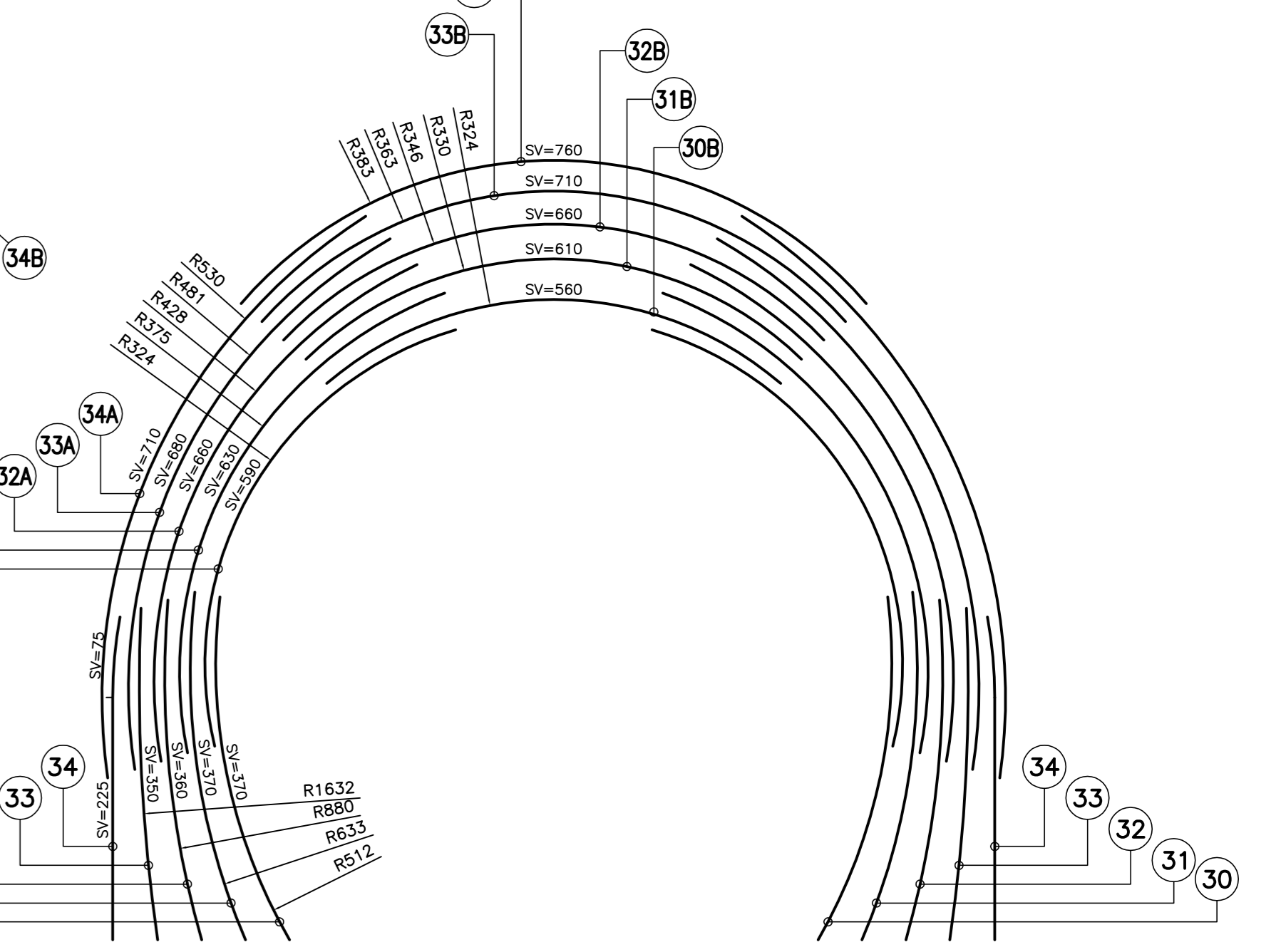

- |     |                   |     |                   |     |                   |     |                   |     |                   |
|-----|-------------------|-----|-------------------|-----|-------------------|-----|-------------------|-----|-------------------|
| 30  | 1ø20<br>Ltot= 390 | 31  | 1ø16<br>Ltot= 390 | 32  | 1ø16<br>Ltot= 380 | 33  | 1ø16<br>Ltot= 370 | 34  | 1ø20<br>Ltot= 360 |
| 30A | 1ø20<br>Ltot= 390 | 31A | 1ø16<br>Ltot= 630 | 32A | 1ø16<br>Ltot= 660 | 33A | 1ø16<br>Ltot= 680 | 34A | 1ø20<br>Ltot= 710 |
| 30B | 1ø20<br>Ltot= 360 | 31B | 1ø16<br>Ltot= 610 | 32B | 1ø16<br>Ltot= 660 | 33B | 1ø16<br>Ltot= 710 | 34B | 1ø20<br>Ltot= 760 |

PARTICOLARE "1"  
SCALA 1:10

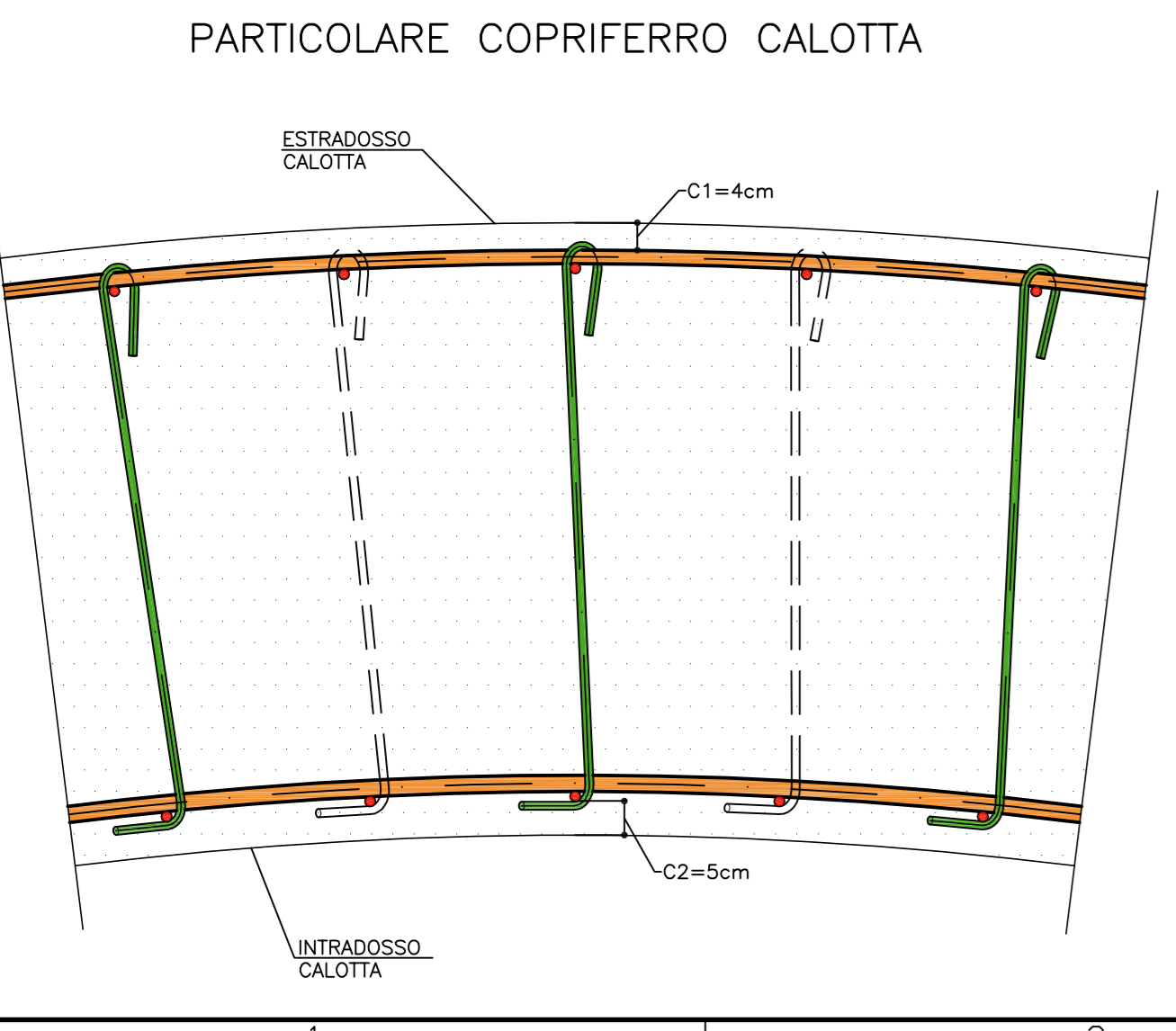

PARTICOLARE "2"  
SCALA 1:10

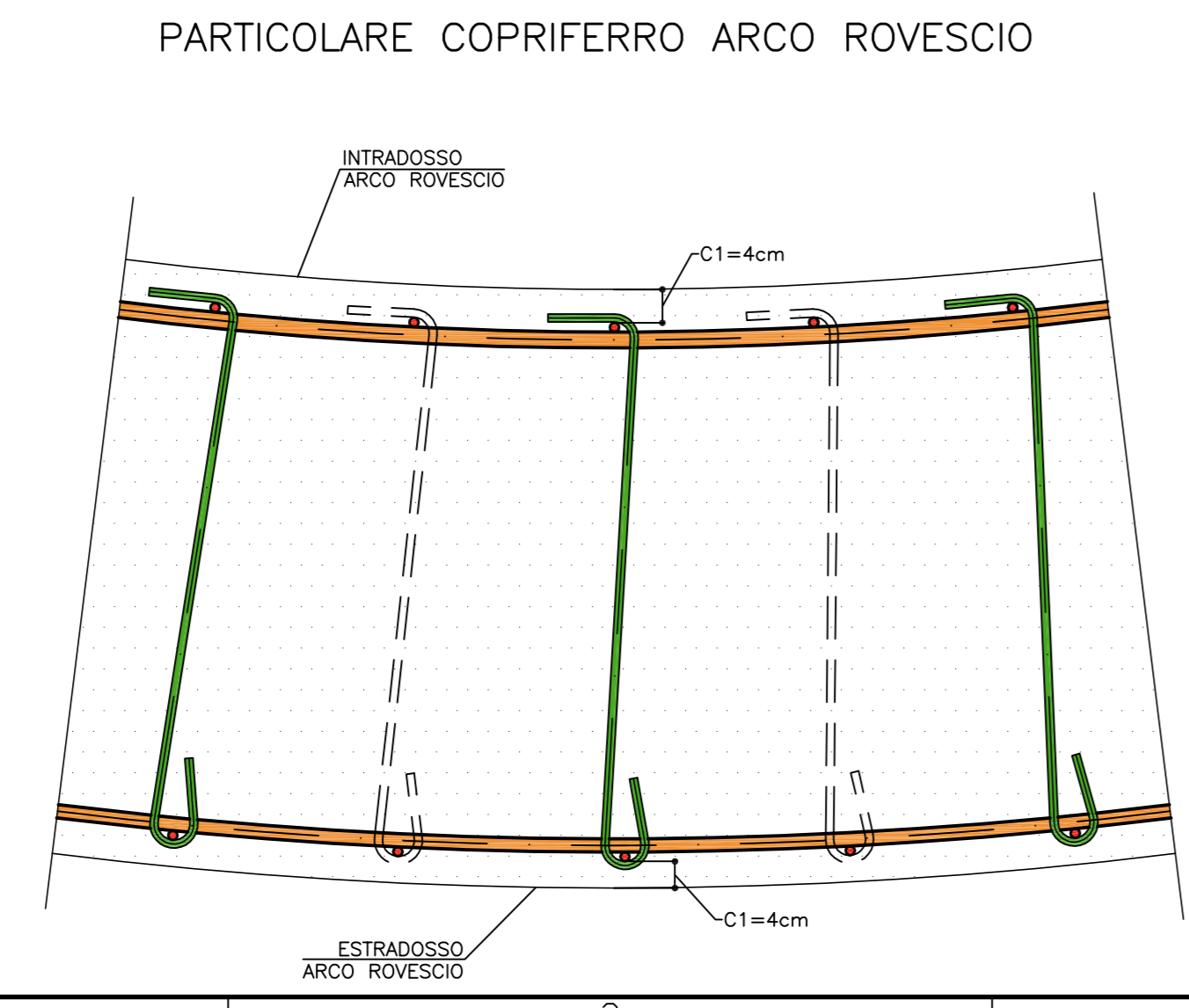

SCHEMA COPRIFERRO



TABELLA MATERIALI

ACCIAIO ARMATURE	B450C
COPRIFERRO	(vedi schema)

LEGENDA

- P.C.	PIANO DEI CENTRI
- P.F.	PIANO FERRO
- P.I.M.	PIANO IMPOSTA MURETTE

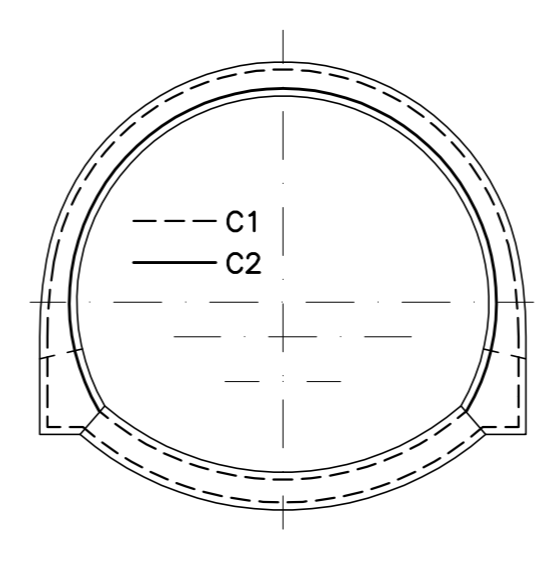
NOTA

I CAVALLOTTI NON SONO DA CONSIDERARSI STRUTTURALI E POSSONO ESSERE EVENTUALMENTE SOSTITUITI CON ELEMENTI ALTERNATIVI

COMMITTENTE:

ALTA SORVEGLIANZA:

GENERAL CONTRACTOR:

INFRASTRUTTURE FERROVIARIE STRATEGICHE DEFINITE DALLA LEGGE OBIETTIVO N.443/01

TRATTA A.V./A.C. TERZO VALICO DEI GIOVI  
PROGETTO ESECUTIVO

GALLERIA NATURALE CAMPASSO  
Nicchia TS - Sezione Tipo C2  
Armatura

GENERAL CONTRACTOR	DIRETTORE LAVORI	SCALA:
Comitato <b>Cociv</b> Ing. G. Gagliardi		1:50

COMMESSA

IG51	01	E	CV	BB	GN1110X	011	A
------	----	---	----	----	---------	-----	---

PROGETTAZIONE

Rev.	Descrizione erratore	Redatto	Data	Verificato	Data	Progettista	Data	IL PROGETTISTA
001	Prima emissione	Ing. F. Colli	17/09/2012	Ing. F. Colli	18/09/2012	Ing. E. Ghislandi	21/09/2012	

Nome File: I25101-CC-05-05-10-01-1-001  
CUP: F51H03000000000