

REGIONE MOLISE

Comune di Sant'Elia a Pianisi (CB)

PROGETTO DEFINITIVO

PROGETTO DEFINITIVO PER LA REALIZZAZIONE
DI UN IMPIANTO EOLICO DELLA POTENZA DI 41.4 MW
sito nel comune di Sant'Elia a Pianisi (CB) e delle relative opere di connessione
da realizzare nei comuni di Monacilioni, Ripabottoni e Morrone del Sannio

TITOLO

Sezioni stradali dei tronchi di viabilità di nuova realizzazione - Strada T08

PROGETTAZIONE	PROPONENTE	SUPPORTO TECNICO
 SR International S.r.l. C.so Vittorio Emanuele II, 282-284 - 00186 Roma Tel. 06 8079555 - Fax 06 80693106 C.F e P.IVA 13457211004 	 Sorgenia Renewables Srl Codice Fiscale e Partita Iva: 10300050969 Indirizzo PEC: sorgenia.renewables@legalmail.it Sede legale: via Alessandro Algardi 4, 20148 Milano	 STUDIO TECNICO ING. MAFFIA LEONARDO ACCA POWER Srl C.so Benedetto Cairoli 25 - 71121 Foggia Ing. Leonardo Maffia Via Molfetta 15 - 71121 Foggia Tel. 3315284623 

Revisione	Data	Elaborato	Verificato	Approvato	Descrizione
00	18/11/2022	Maffia	Imperato	Sorgenia Renewables	---

N° DOCUMENTO	SCALA	FORMATO
SRG-SLP-OC.29	1:200	A4

Strada accesso T08 Planimetria

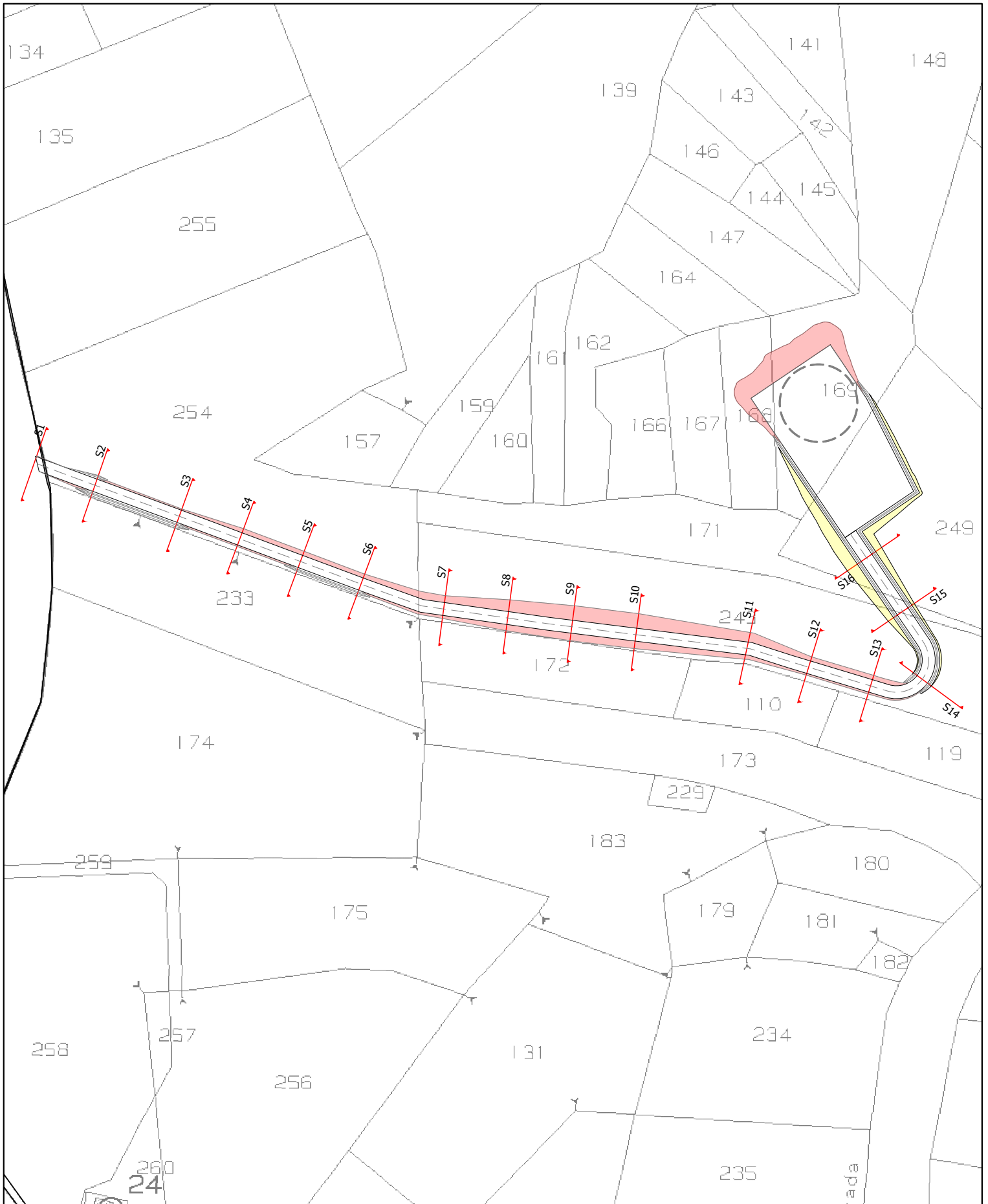

Strada accesso T08 S1

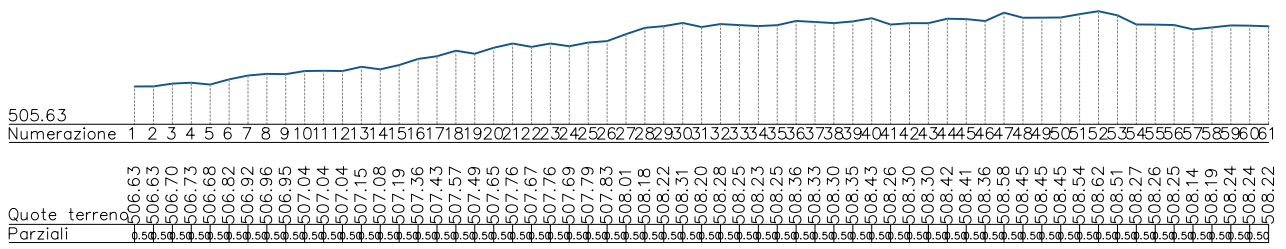

Strada accesso T08 S2

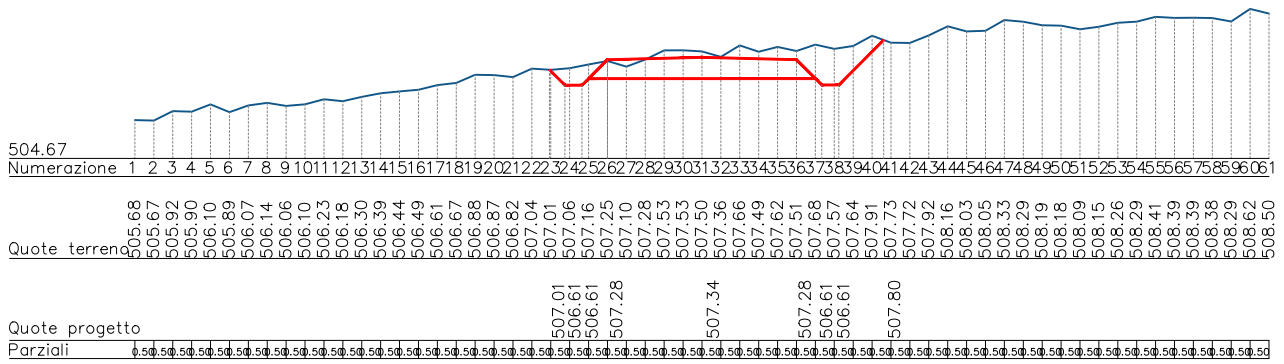

Strada accesso T08 S3

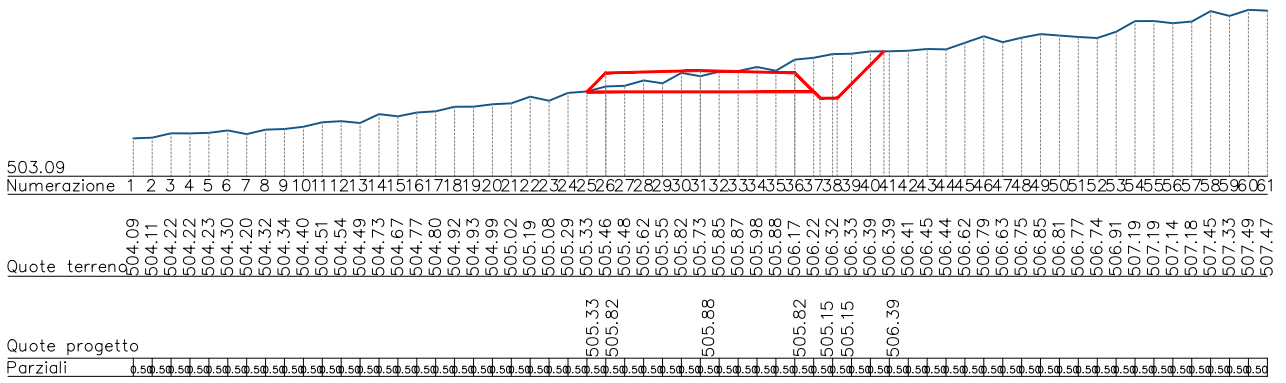

Strada accesso T08 S4

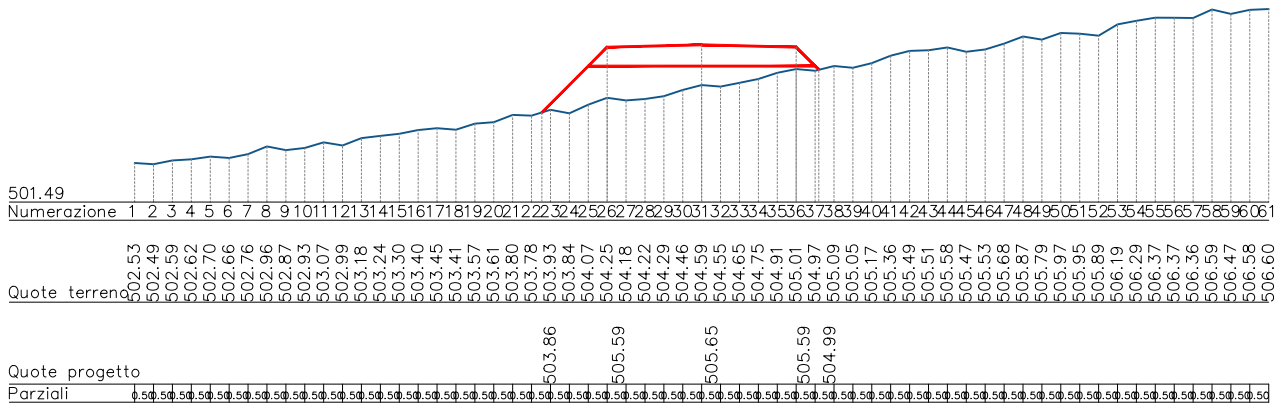

Strada accesso T08 S5

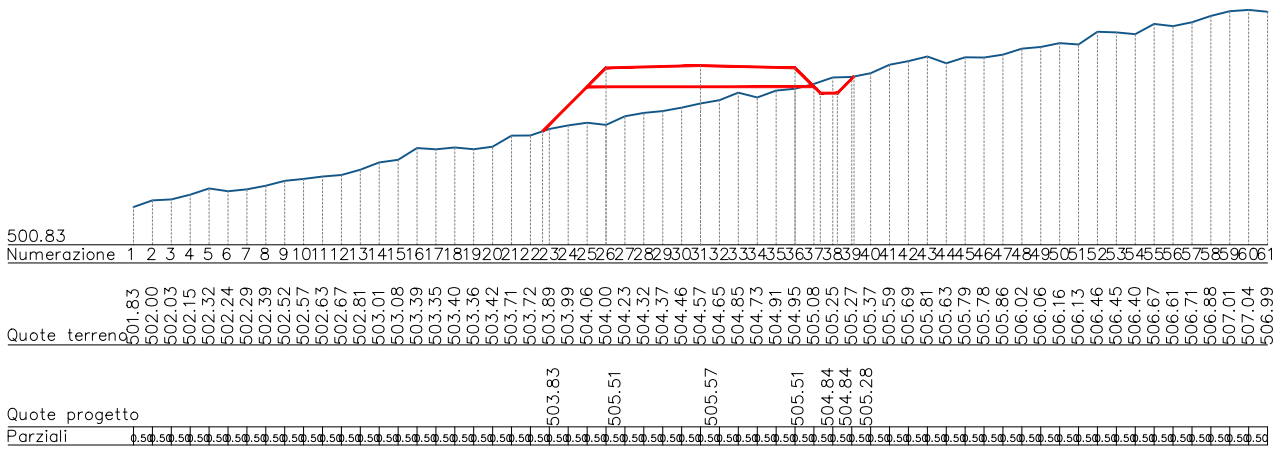

Strada accesso T08 S6

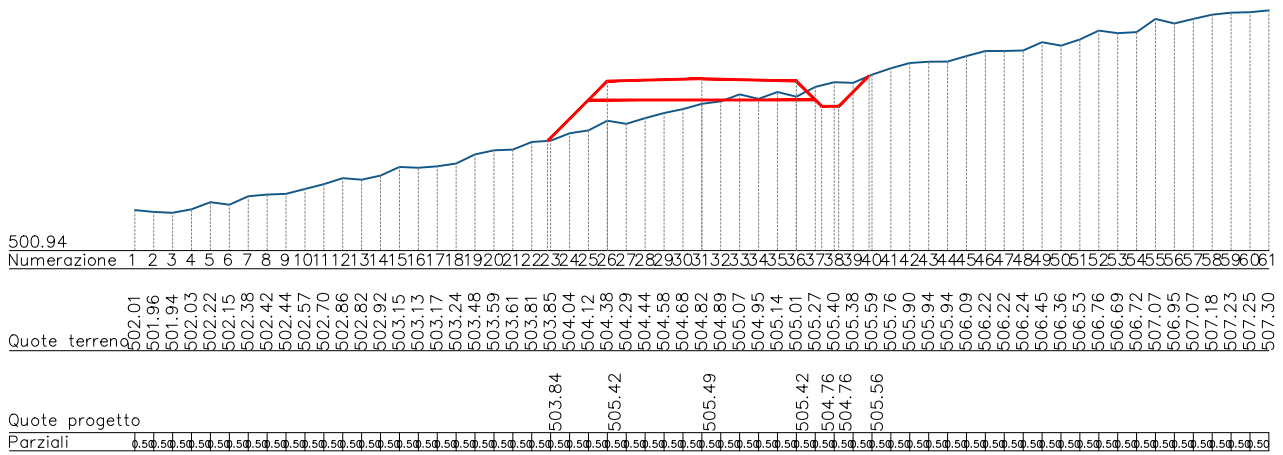

Strada accesso T08 S7

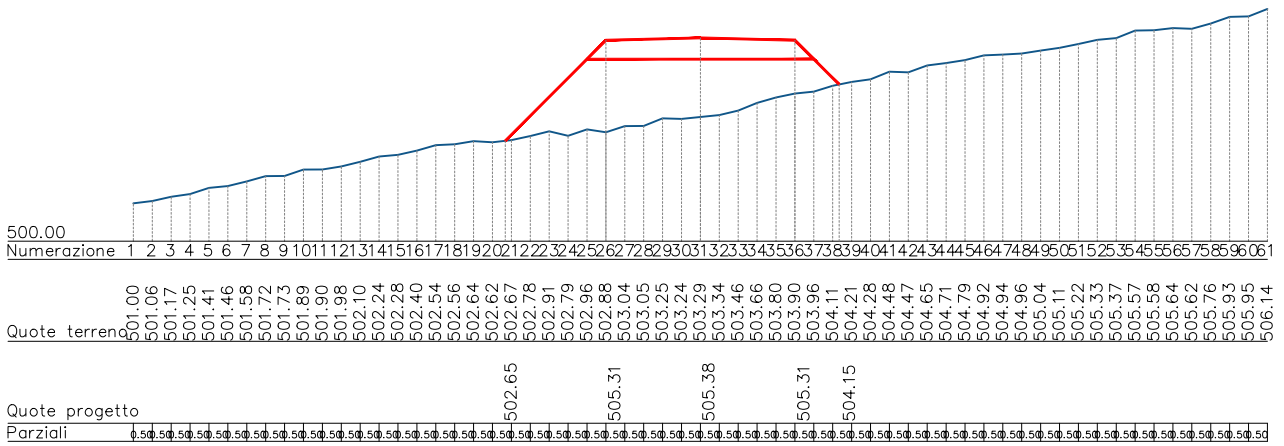

Strada accesso T08 S8

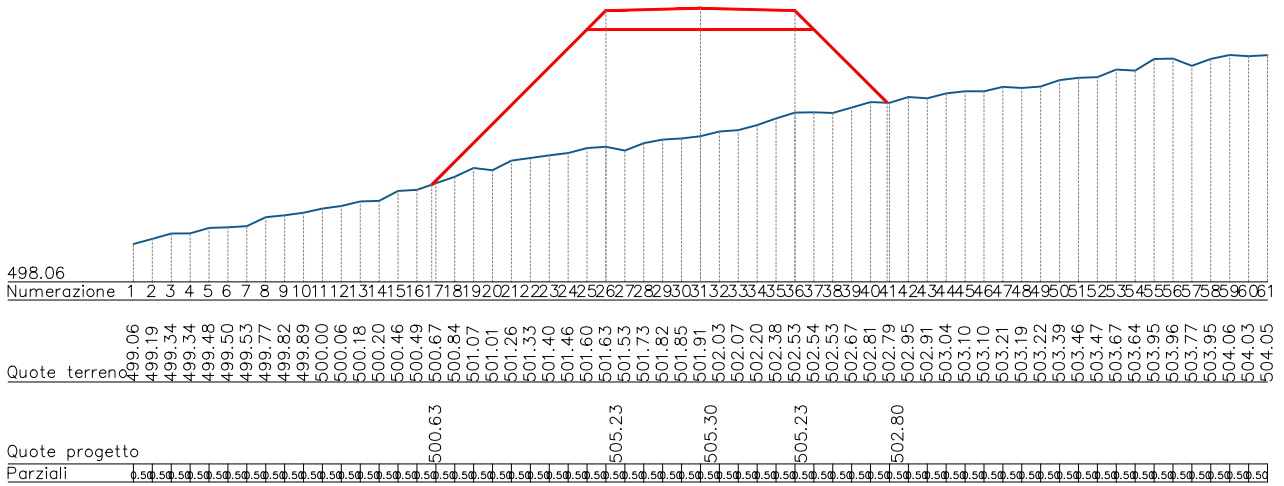

Strada accesso T08 S10

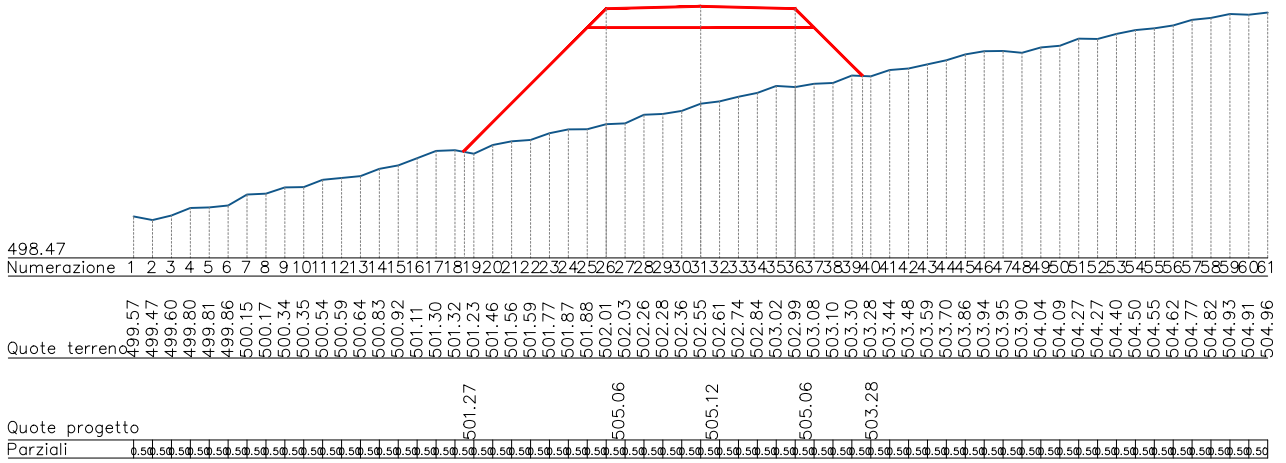

Strada accesso T08 S11

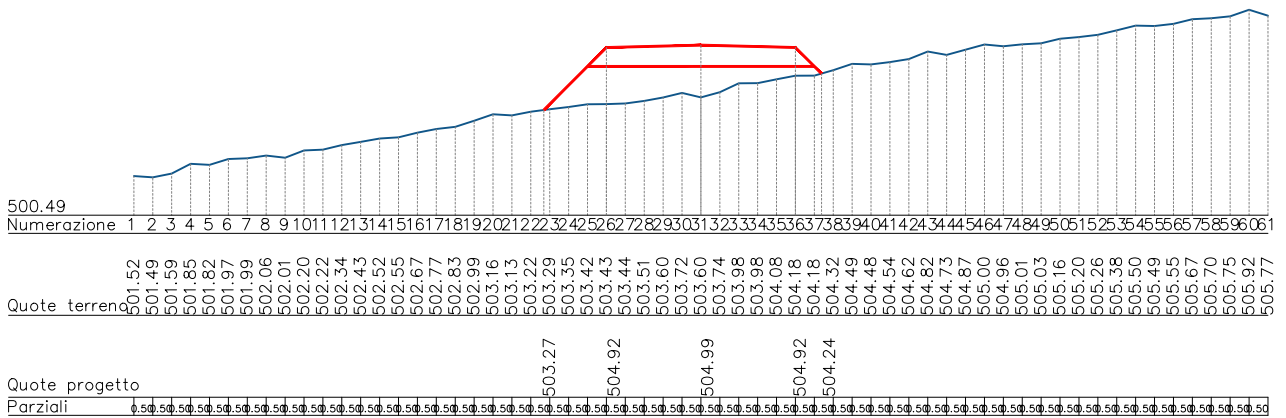

Strada accesso T08 S12

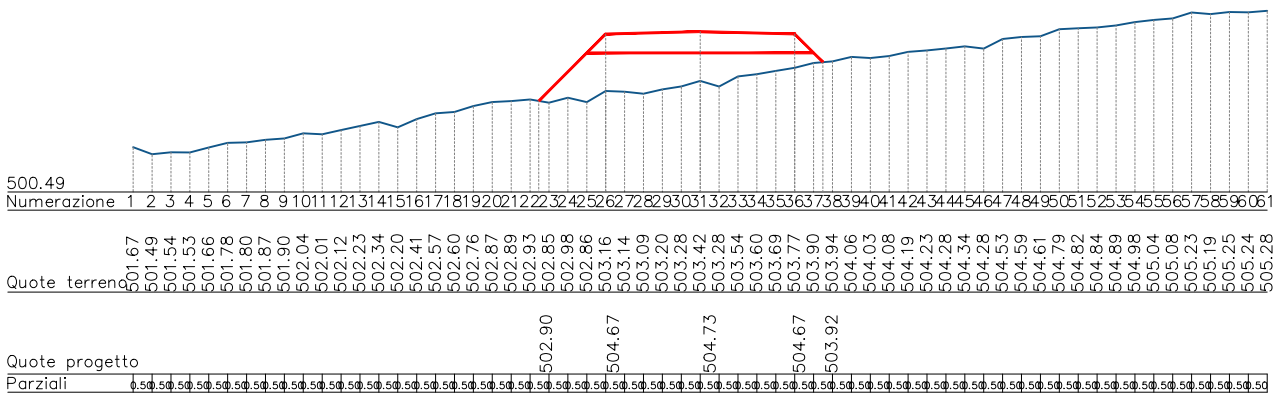

Strada accesso T08 S13

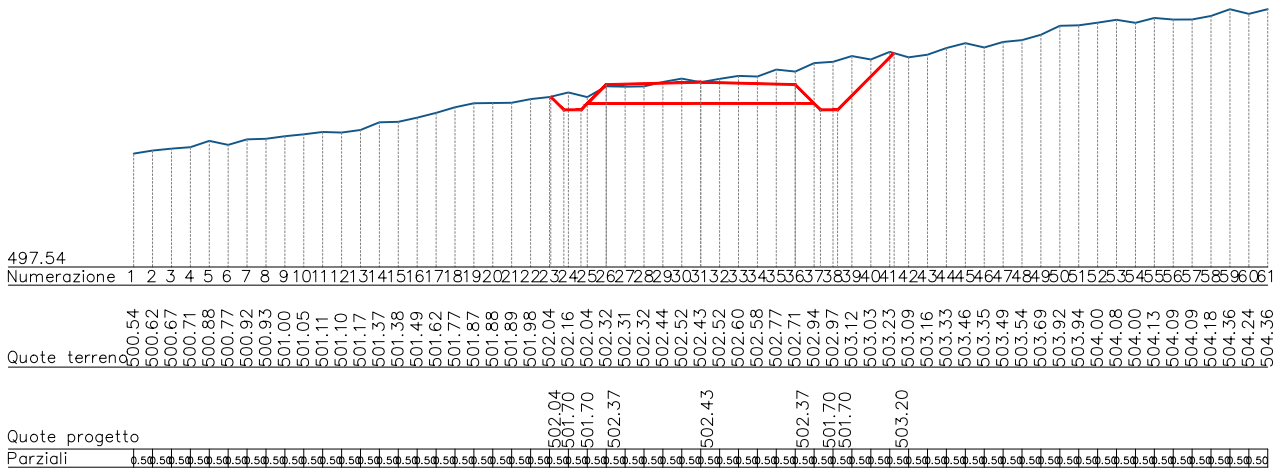

Strada accesso T08 S15

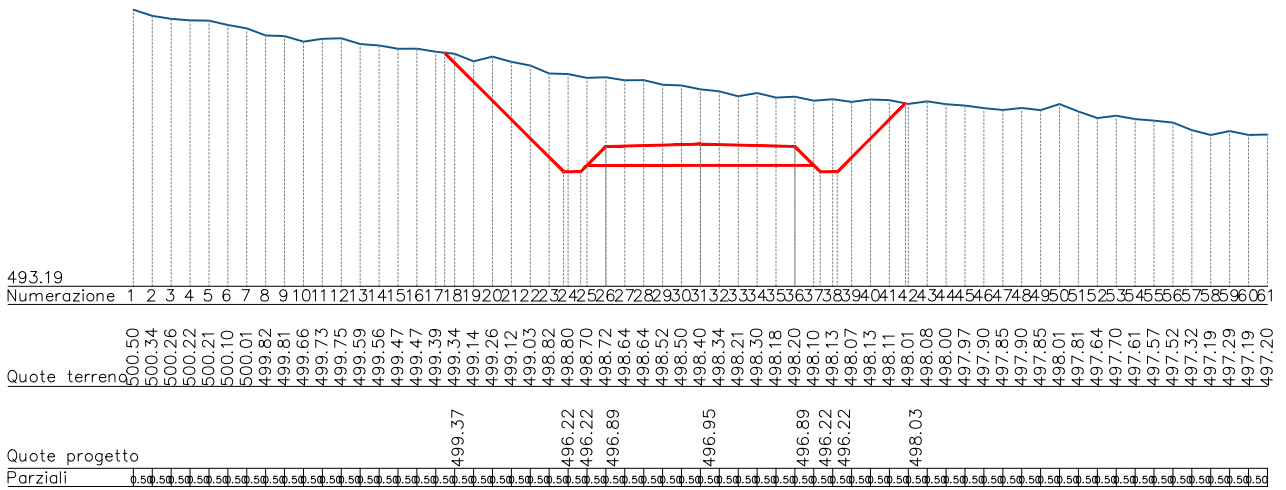

Strada accesso T08 S16

