



REGIONE SICILIA
 PROVINCIA RAGUSA
 COMUNE DI ACATE



**PROGETTO PER LA REALIZZAZIONE DI UN IMPIANTO AGROVOLTAICO SITO IN C/DA PAVAVONE NEL COMUNE DI ACATE, COMPRESO LE OPERE PER LA CONNESSIONE ALLA RETE ELETTRICA IN AT NEL COMUNE DI CHIARAMONTE GULFI (RG)
 POT. IMMISSIONE 38,60 MW - POT. IMPIANTO 38,8332 MWp**

PROGETTO DEFINITIVO

**PARTICOLARI COSTRUTTIVI
 STRUTTURE DI SOSTEGNO**

Titolo elaborato

Committente



Sviluppo



Progettazione



Firme



Struttura tipo - Stringhe da 28 moduli

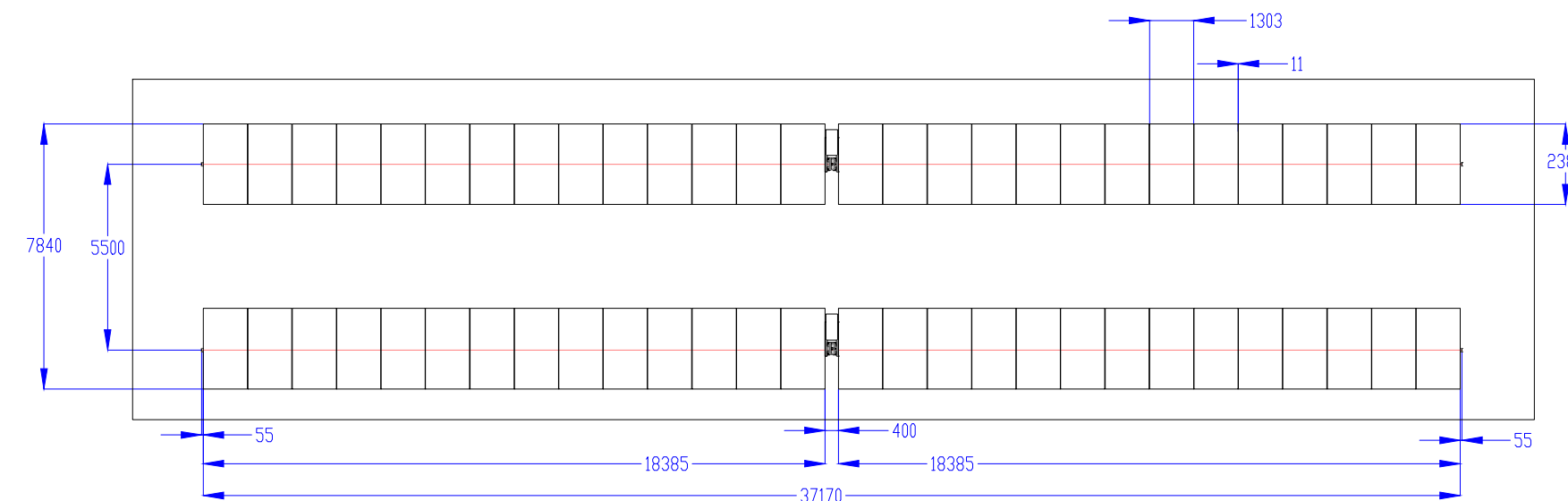
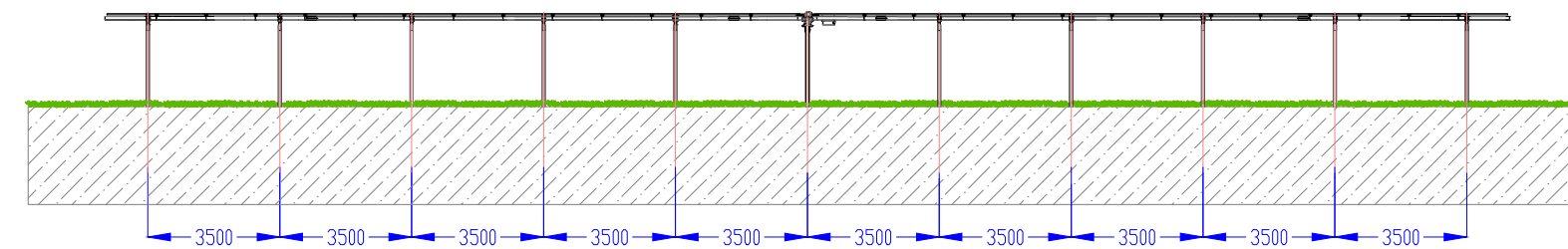

Particolare struttura - Vista 3D

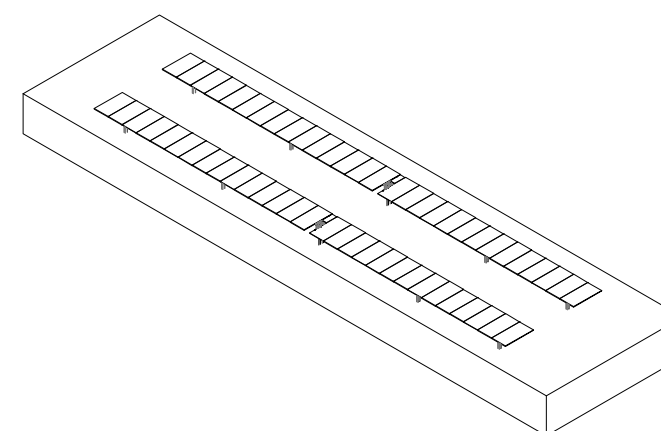

Sections

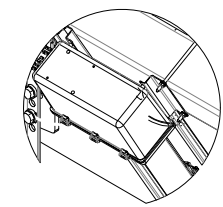
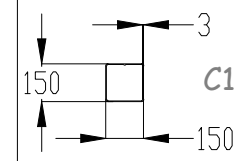

Detail D
Scale 1:20

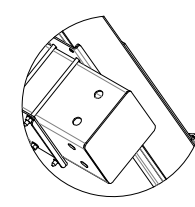

Detail C
Scale 1:15

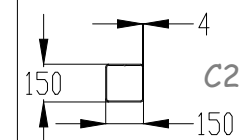

Middle Clamp

End Clamp

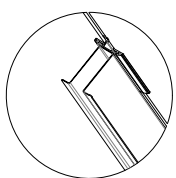
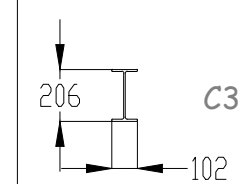

Detail F
Scale 1:15

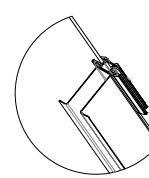

Detail E
Scale 1:15

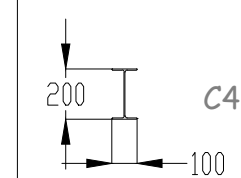

Simple Support

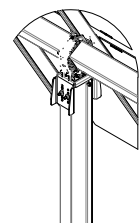

Motor Support

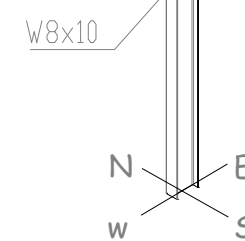
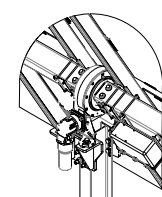

Detail B
Scale 1:50

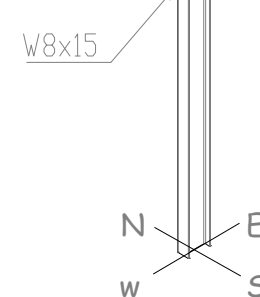

Detail A
Scale 1:50

| | | | | | |
|----------|----------------|-------------------------------------|---------|------------|-----------|
| P01/22 | PVI1EPD0034A0 | P01/Acate/EPD/Part. strut. sostegno | - | A2- | 001/001 |
| Commissa | Cod. elaborato | Nome file | Scala | Formato | Foglio |
| 00 | 20.05.2022 | Emissione | RS | FB | AN |
| Rev. | Data | Oggetto revisione | Redatto | Verificato | Approvato |