

LONGI Hi-MO 5m LR5-72HPH 535~555M

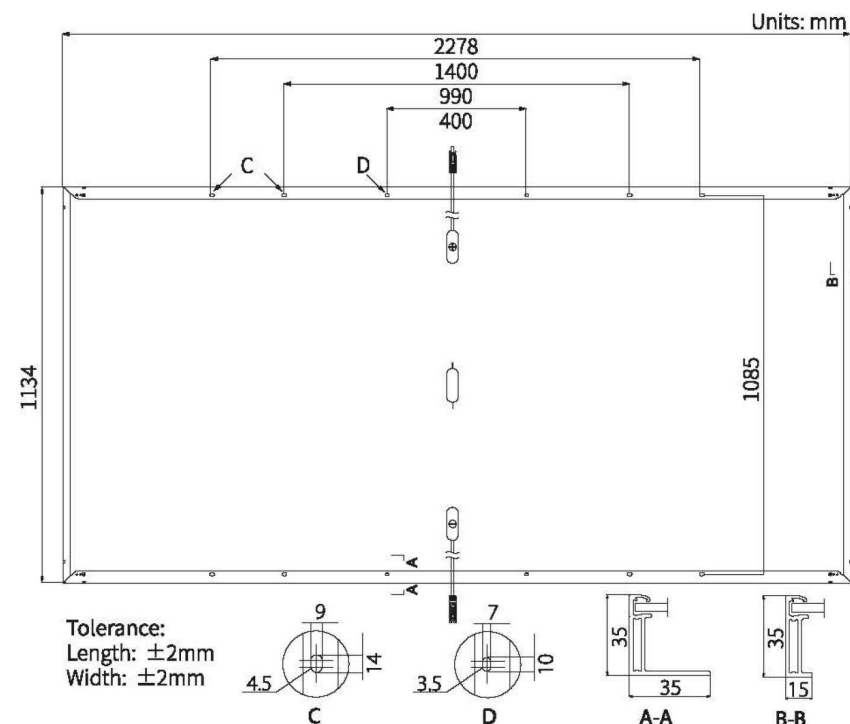
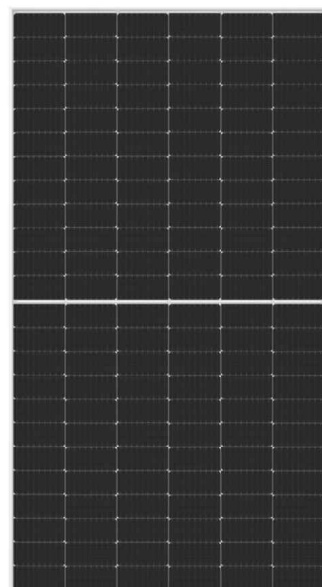

Operating Parameters

Operational Temperature	-40°C ~ +85°C
Power Output Tolerance	0 ~ +5 W
Voc and Isc Tolerance	±3%
Maximum System Voltage	DC1500V (IEC/UL)
Maximum Series Fuse Rating	25A
Nominal Operating Cell Temperature	45±2°C
Protection Class	Class II
Fire Rating	UL type 1 or 2

Temperature Ratings (STC)

Temperature Coefficient of Isc	+0.048%/°C
Temperature Coefficient of Voc	-0.270%/°C
Temperature Coefficient of Pmax	-0.350%/°C

Mechanical Parameters

Cell Orientation	144 (6×24)
Junction Box	IP68, three diodes
Output Cable	4mm ² , +400, -200mm/±1400mm length can be customized
Glass	Single glass, 3.2mm coated tempered glass
Frame	Anodized aluminum alloy frame
Weight	27.5kg
Dimension	2278×1134×35mm
Packaging	31pcs per pallet / 155pcs per 20' GP / 620pcs per 40' HC

Electrical Characteristics

STC: AM1.5 1000W/m² 25°C NOCT: AM1.5 800W/m² 20°C 1m/s Test uncertainty for Pmax: ±3%

Module Type	LR5-72HPH-535M		LR5-72HPH-540M		LR5-72HPH-545M		LR5-72HPH-550M		LR5-72HPH-555M	
	STC	NOCT	STC	NOCT	STC	NOCT	STC	NOCT	STC	NOCT
Maximum Power (Pmax/W)	535	399.9	540	403.6	545	407.4	550	411.1	555	414.8
Open Circuit Voltage (Voc/V)	49.35	46.40	49.50	46.54	49.65	46.68	49.80	46.82	49.95	46.97
Short Circuit Current (Isc/A)	13.78	11.14	13.85	11.20	13.92	11.25	13.98	11.31	14.04	11.35
Voltage at Maximum Power (Vmp/V)	41.50	38.55	41.65	38.69	41.80	38.83	41.95	38.97	42.10	39.11
Current at Maximum Power (Imp/A)	12.90	10.38	12.97	10.43	13.04	10.49	13.12	10.56	13.19	10.61
Module Efficiency(%)	20.7		20.9		21.1		21.3		21.5	

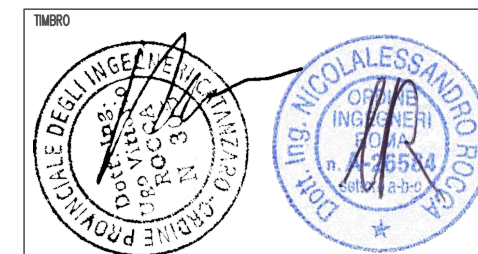

2	REVISIONE						TIPO DI ELABORATO:	<input type="checkbox"/> PROGETTO PRELIMINARE <input checked="" type="checkbox"/> PROGETTO DEFINITIVO <input type="checkbox"/> PROGETTO ESECUTIVO <input type="checkbox"/> PROGETTO DI VARIANTE <input type="checkbox"/> A.S. BUILT	COMMITTENTE	PROGETTISTA	LOCALITA'	NOME PROGETTO	POTENZA	
1	REVISIONE									RESIT S.R.L. Lungotevere Flaminio, 74 00196 Roma	Comune di Castrovillari	CASTROVILLARI	21,6 MW	
0	12.07.22	EMISSIONE	MELIS	ROCCA		ROCCA	ROCCA							
Rev	Data	Descrizione	Disegnato	Verifica	Approvazione	Autorizzazione	IL PRESENTE DOCUMENTO NON POTRA' ESSERE COPIATO, RIPRODOTTO O ALTAMENTE PUBBLICATO, IN TUTTO O IN PARTE, SENZA IL CONSENSO SCRITTO DELLA RESIT S.R.L.; OGNI UTILIZZO NON AUTORIZZATO SARA' PERSEGUITO A NORMA DI LEGGE. THIS DOCUMENT MAY NOT BE COPIED, REPRODUCED OR PUBLISHED, EITHER IN PART OR IN ITS ENTIRETY, WITHOUT THE WRITTEN PERMISSION OF RESIT S.R.L. UNAUTHORIZED USE WILL BE PROSECUTE BY LAW.			FORMATO	SCALA	TITOLO DOCUMENTO	FOGLIO	SEGUE
										A3	--	EG09 - Caratteristiche modulo fotovoltaico	01	--