

SEZIONE G-G

Scala 1:50

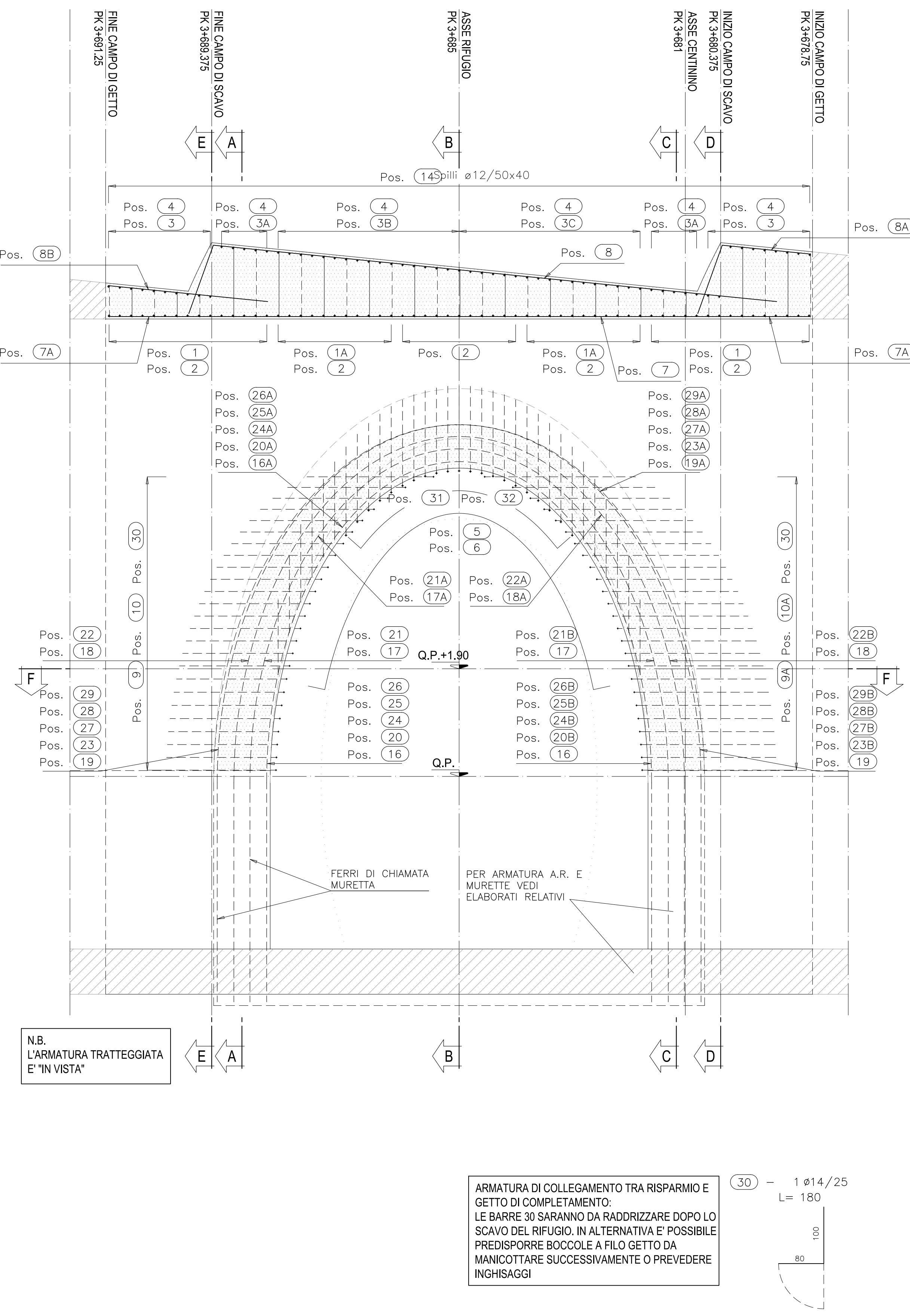

ARMATURA DI COLLEGAMENTO TRA RISPARMIO E GETTO DI COMPLETAMENTO. LE BARRE 30 SARANNO DA RADRIZZARE DOPO LO SCAVO DEL RIFUGIO. IN ALTERNATIVA E' POSSIBILE PREDISPORRE BOCCOLE A FILO GETTO DA MANICOTTARE SUCCESSIVAMENTE O PREVEDERE INGHISAGGI

N.B. L'ARMATURA TRATTEGGIATA E' 'IN VISTA'

VISTA FRONTALE VISTA LATERALE LATO SX E DX

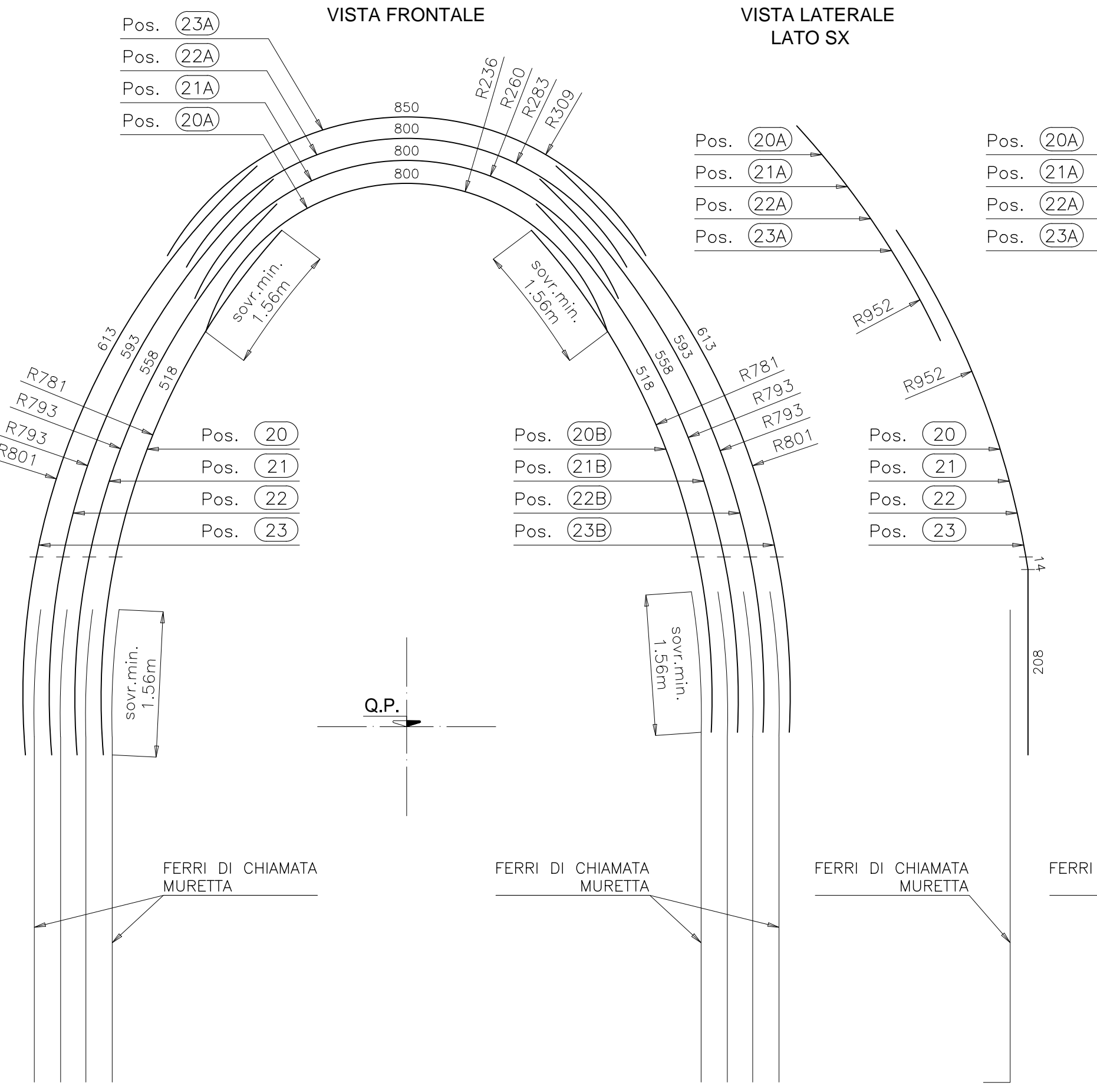
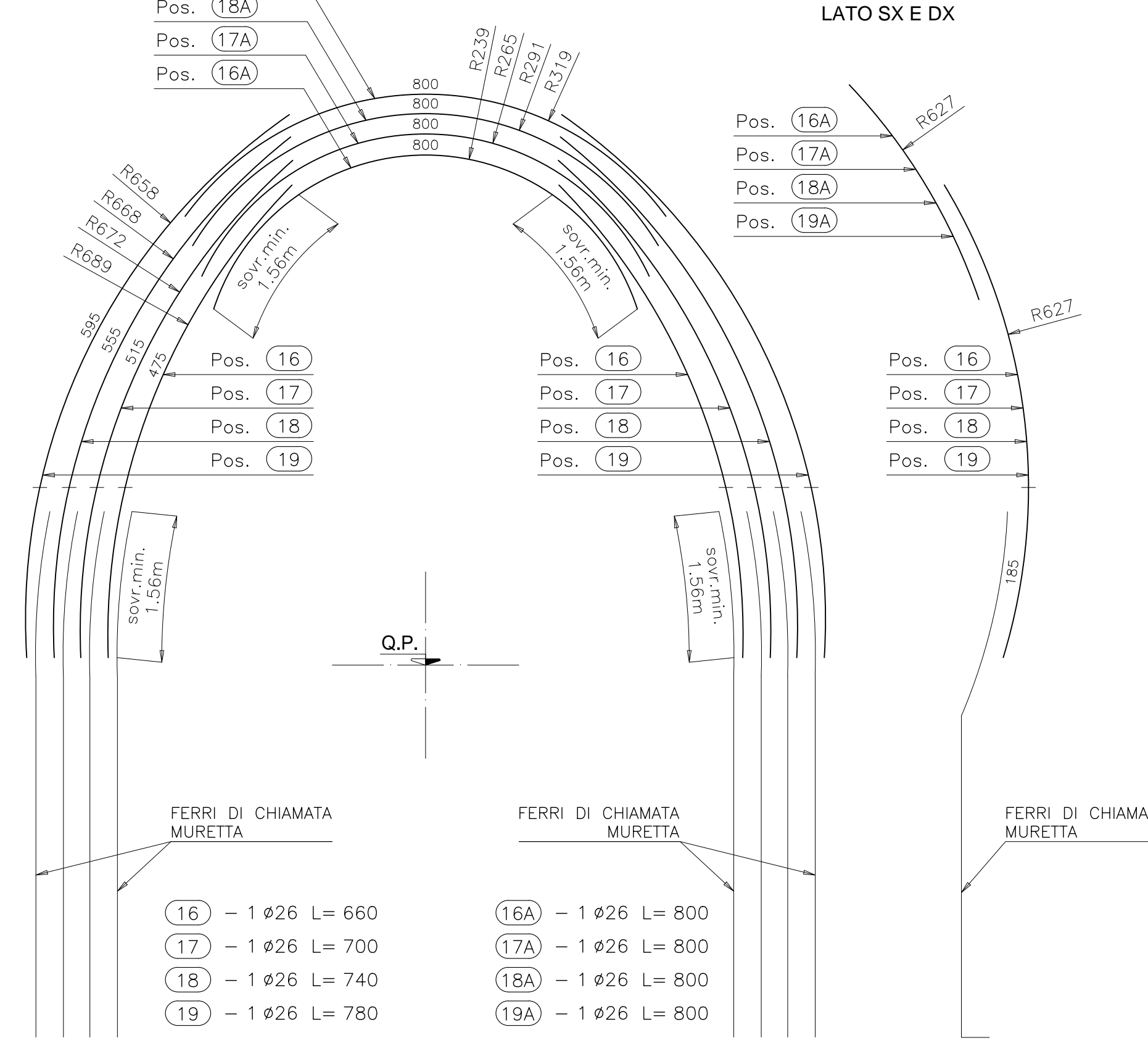

VISTA FRONTALE VISTA LATERALE LATO SX

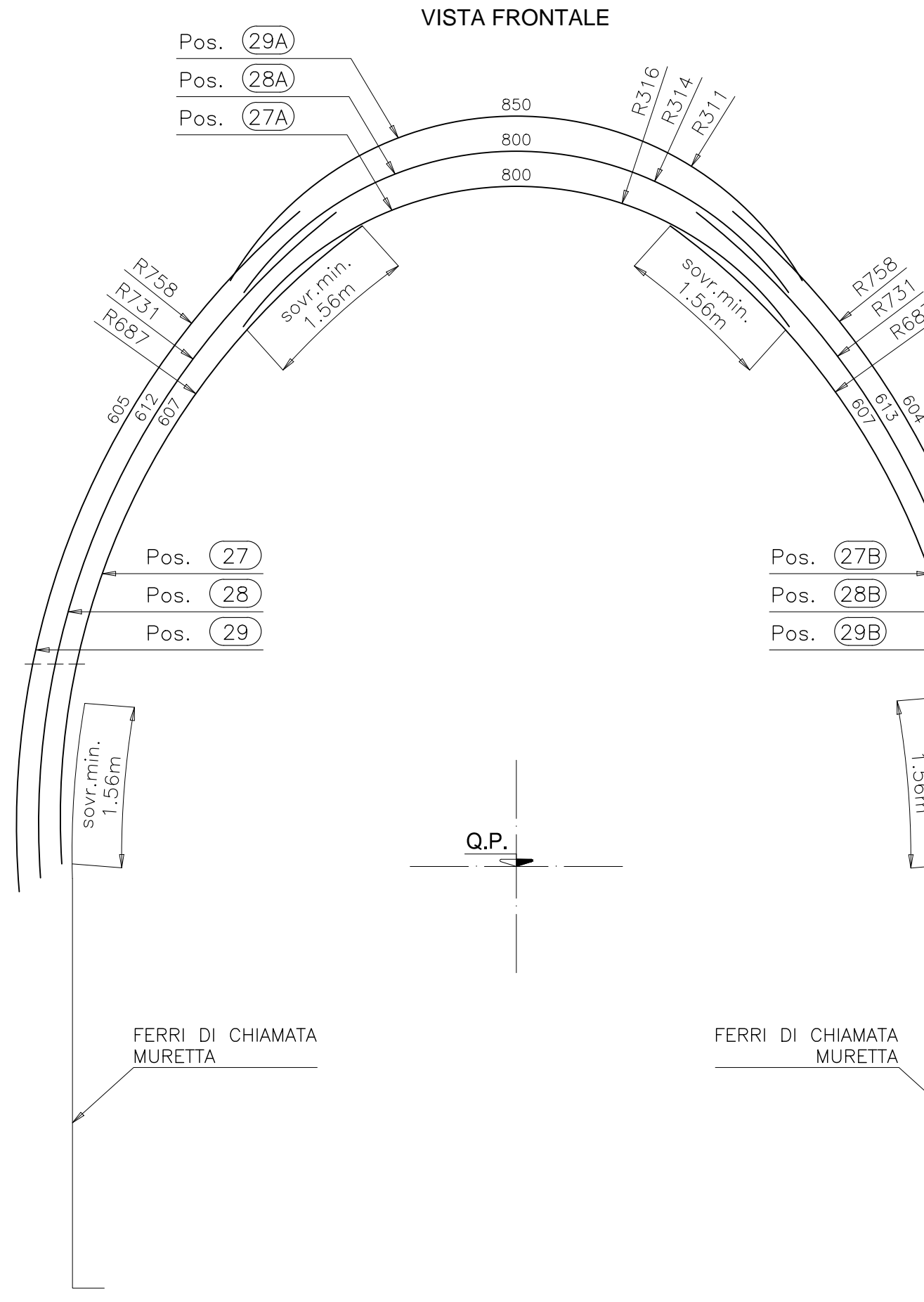
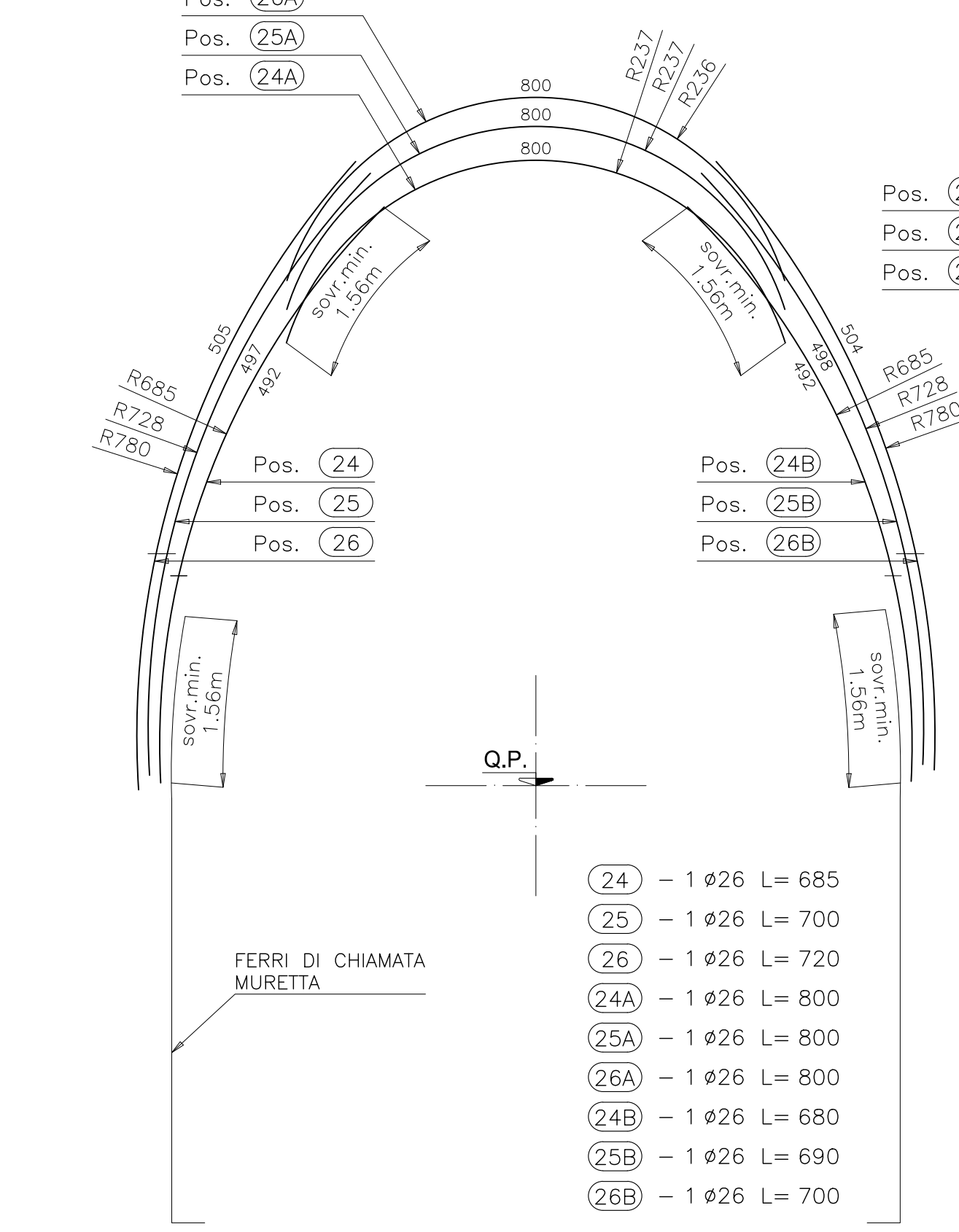

VISTA LATERALE LATO DX

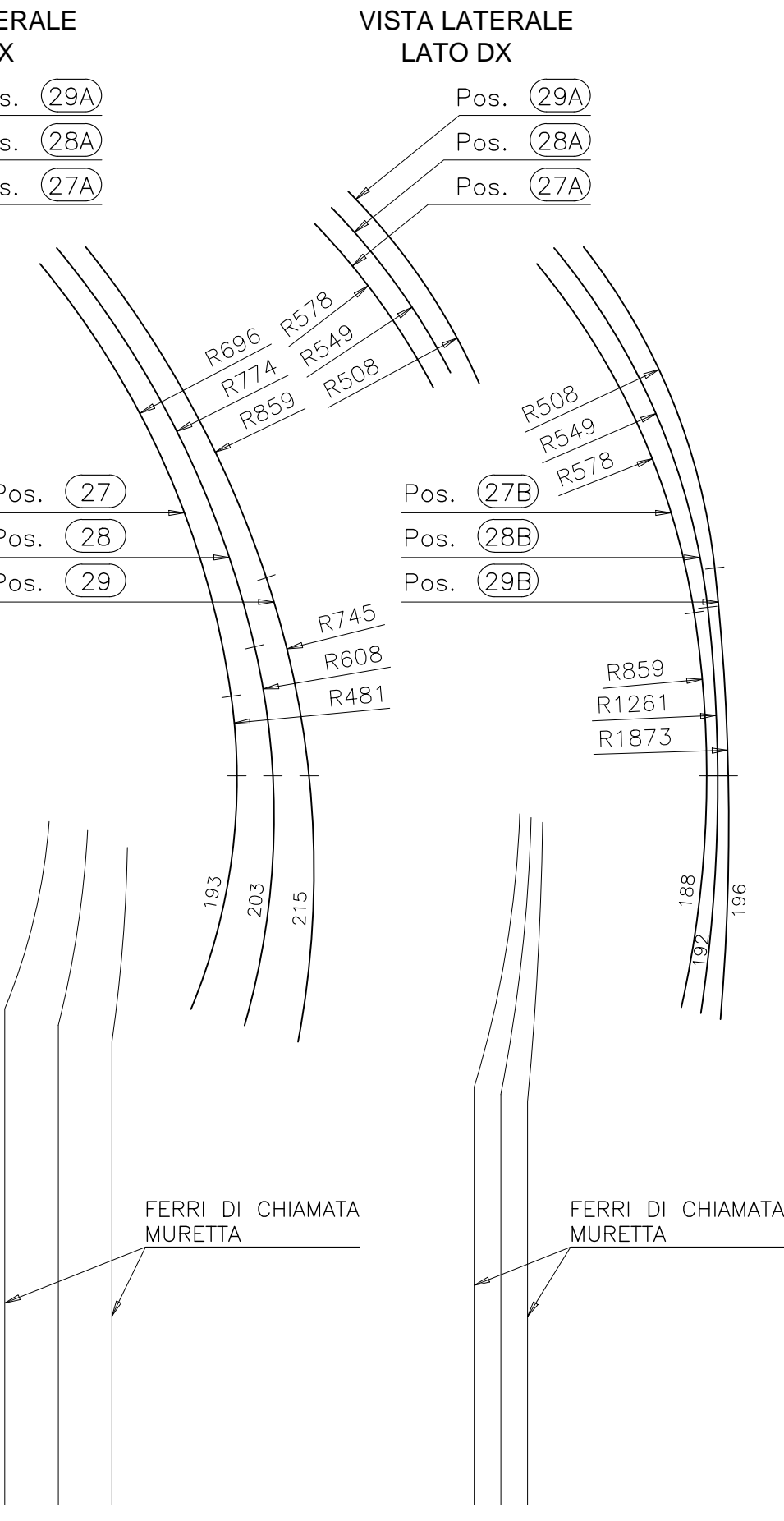
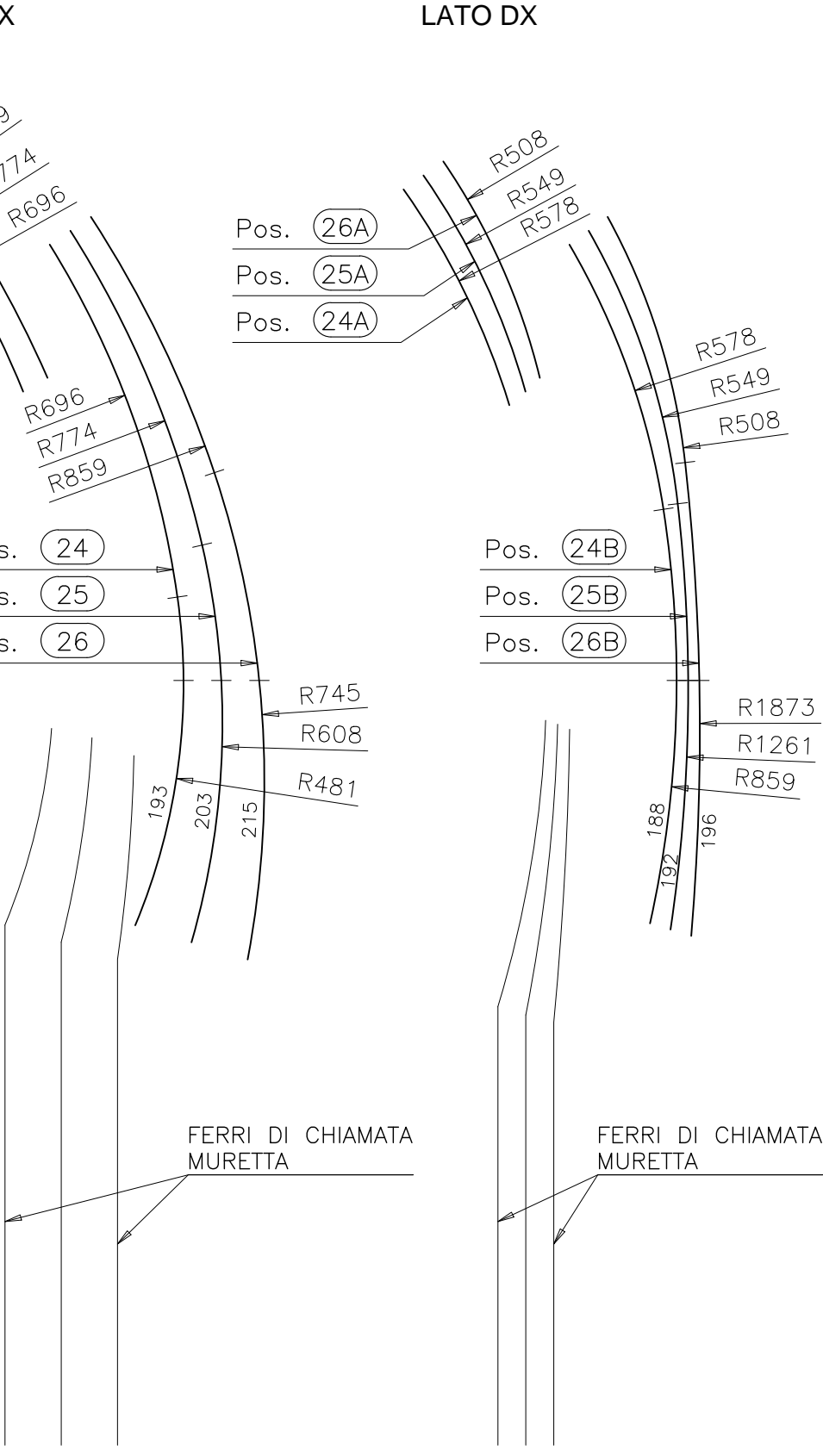

Table with 2 columns: Material characteristics (CARATTERISTICHE DEI MATERIALI) and technical specifications.

Table with 6 columns: Position (Posizione), Diameter (Diametro), Quantity (Quantità), Length (Lunghezza), Total Weight (Peso Totale), and Unit Weight (Peso Unitario). Includes a 'TABELLA FERRI' section.

NOTA BENE: LE ARMATURE DELLA CALOTTA E DEL RISPARMIO SONO STATE RAPPRESENTATE CONSIDERANDO UN CONCIO DI GETTO DA 12.50m IN ASSE AL RIFUGIO.

SEZIONE F-F

Scala 1:50

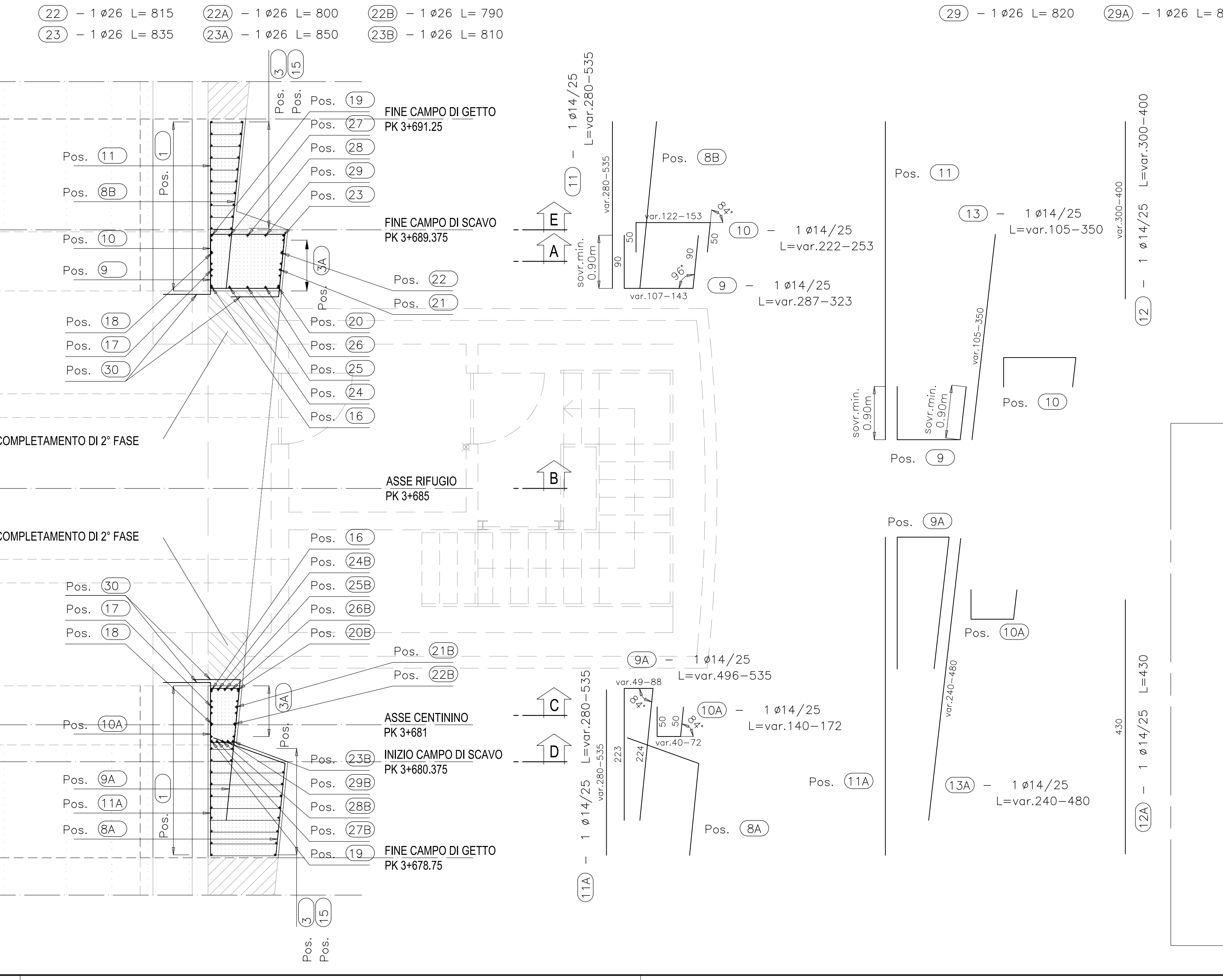
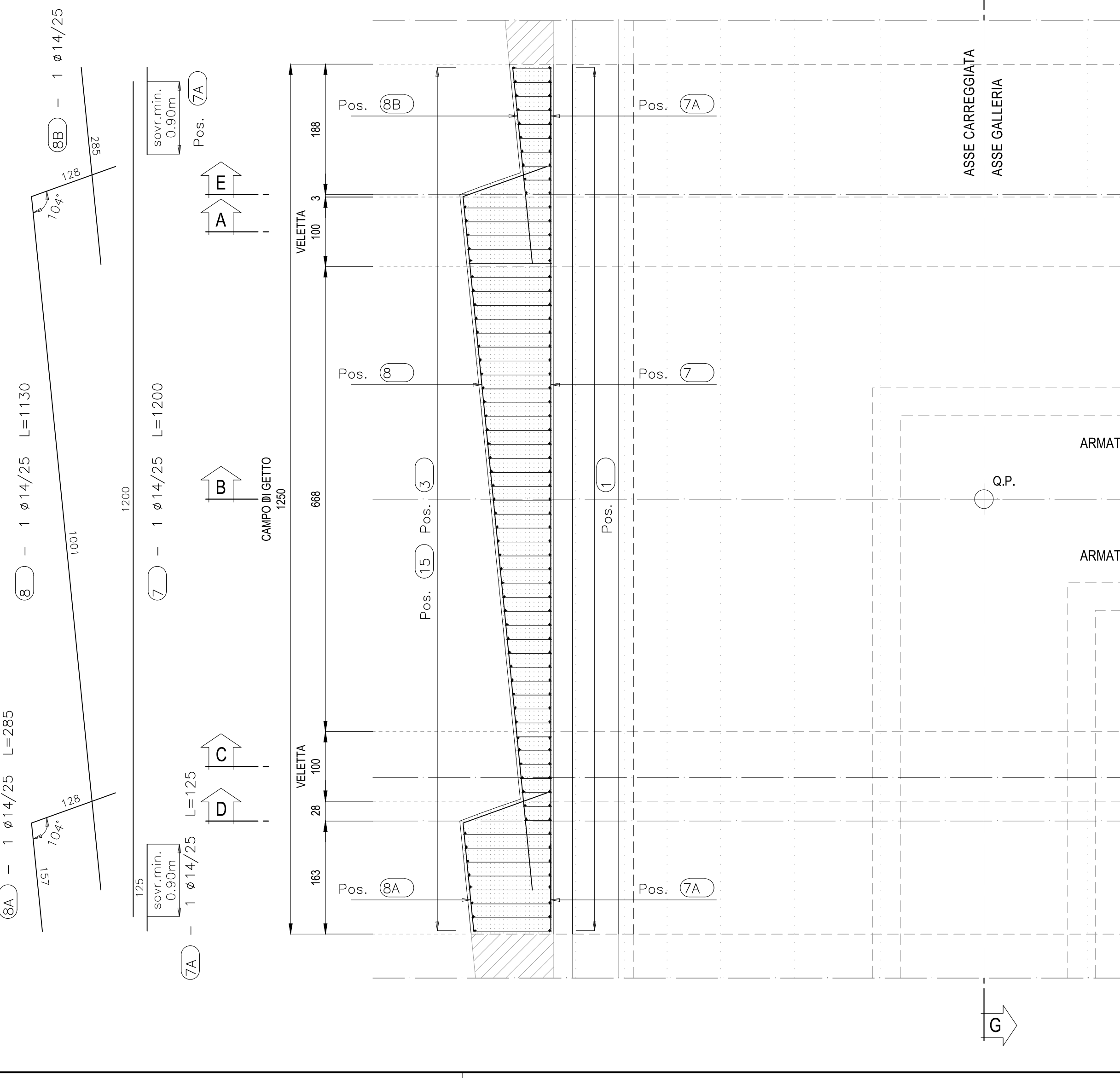

MAGLIA SPILLI 50X40 (SFALSATI) scala 1:50

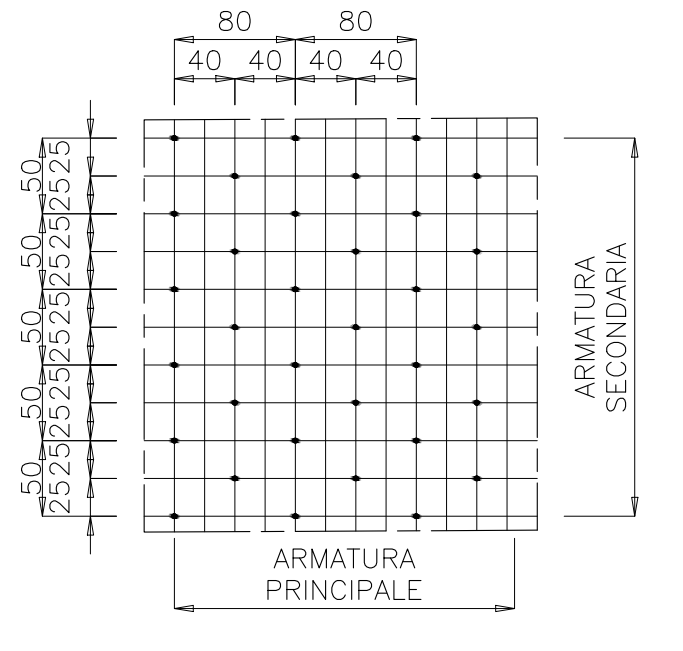

MAGLIA SPILLI 25X20 scala 1:50

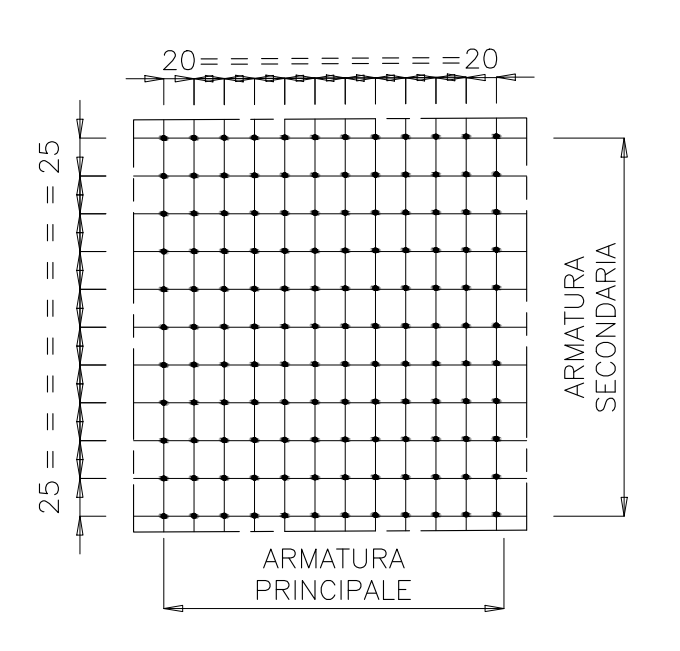

PARTICOLARE '1' PARTICOLARE COPRIFERRO CALOTTA

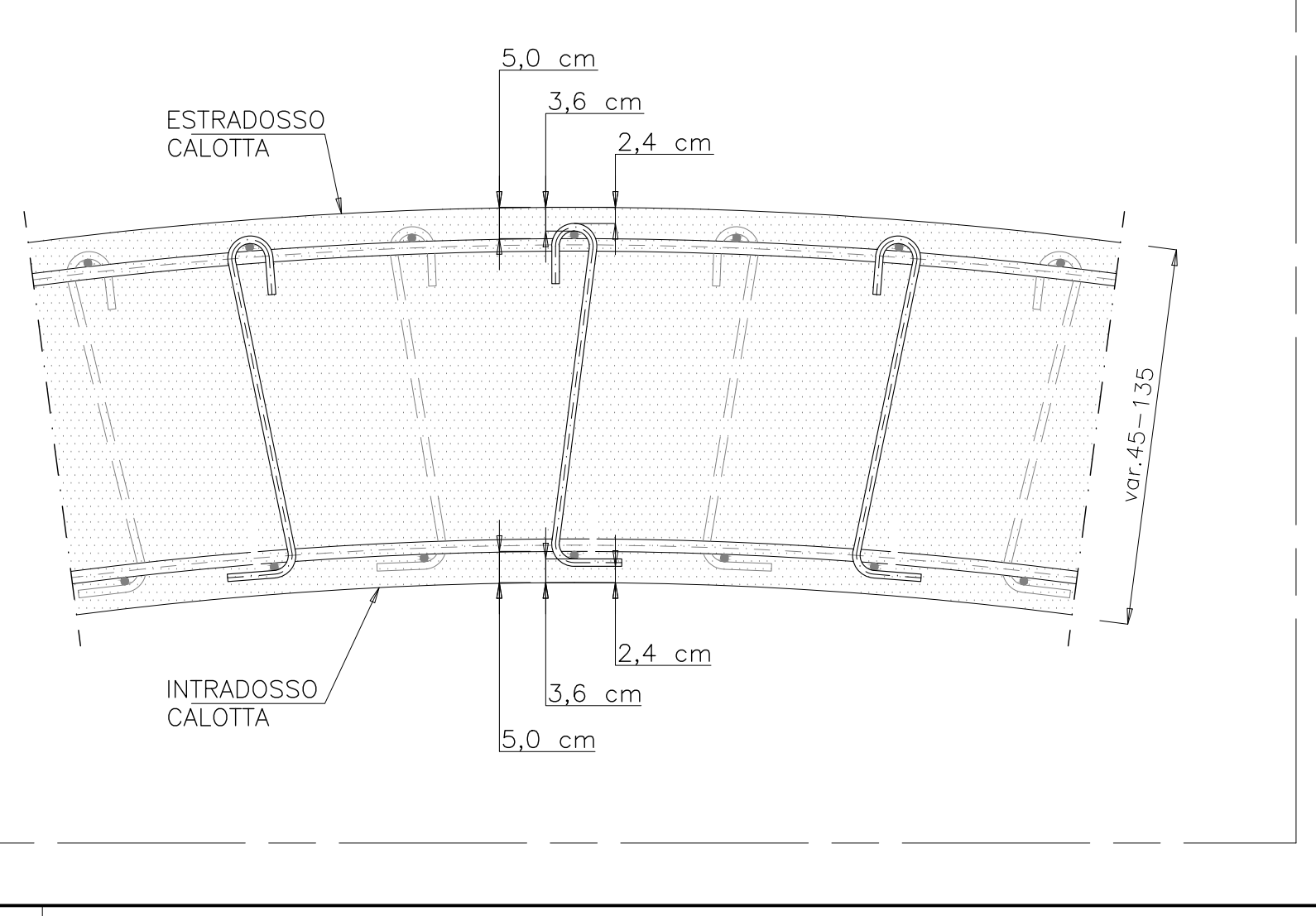

Project information block including ANAS S.p.A. logo, project name (OPERE MAGGIORI GALERIE NATURALI), scale (1:10/1:50), and revision table.