

DETTAGLIO ARMATURA PALI
Scala 1:100

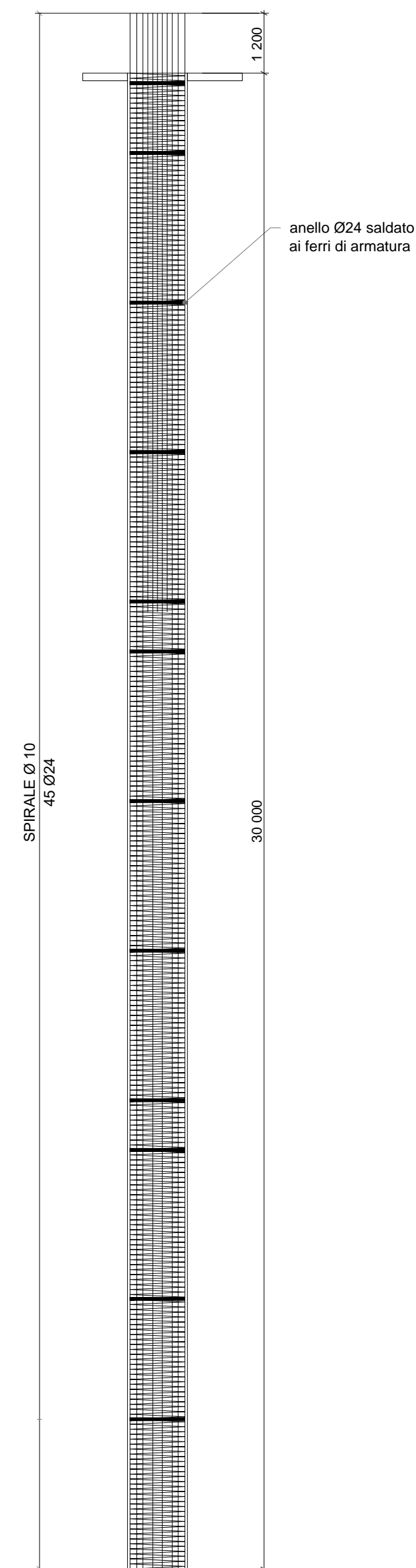

PARTICOLARE DIMA DI ANCORAGGIO Scala 1:50

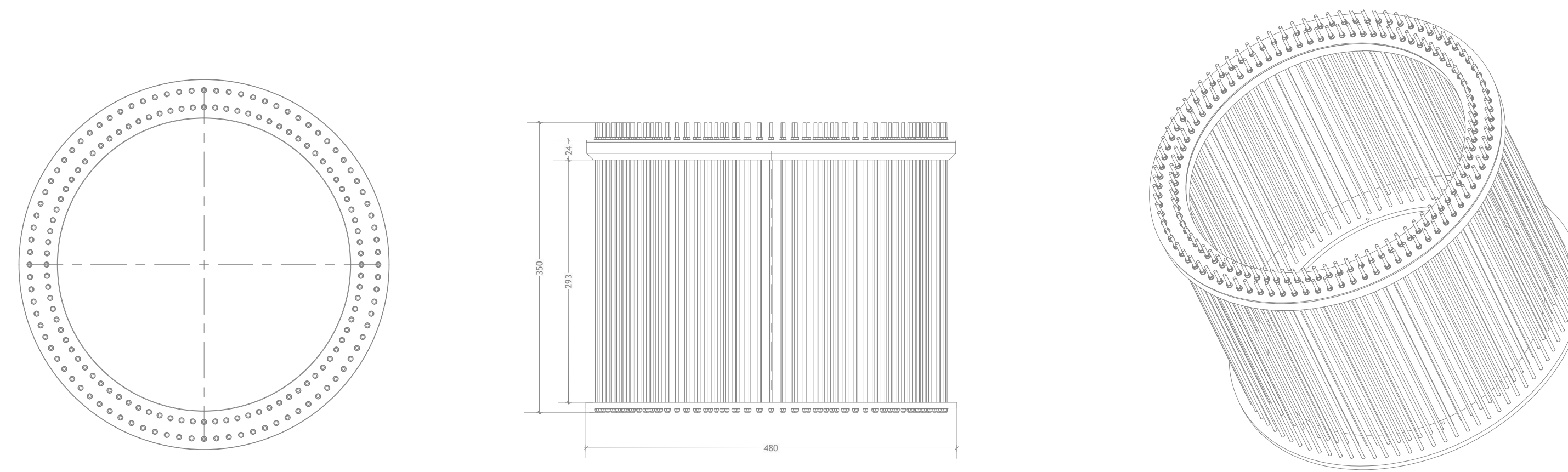

PARTICOLARE FONDAZIONE SU PALI Scala 1:100

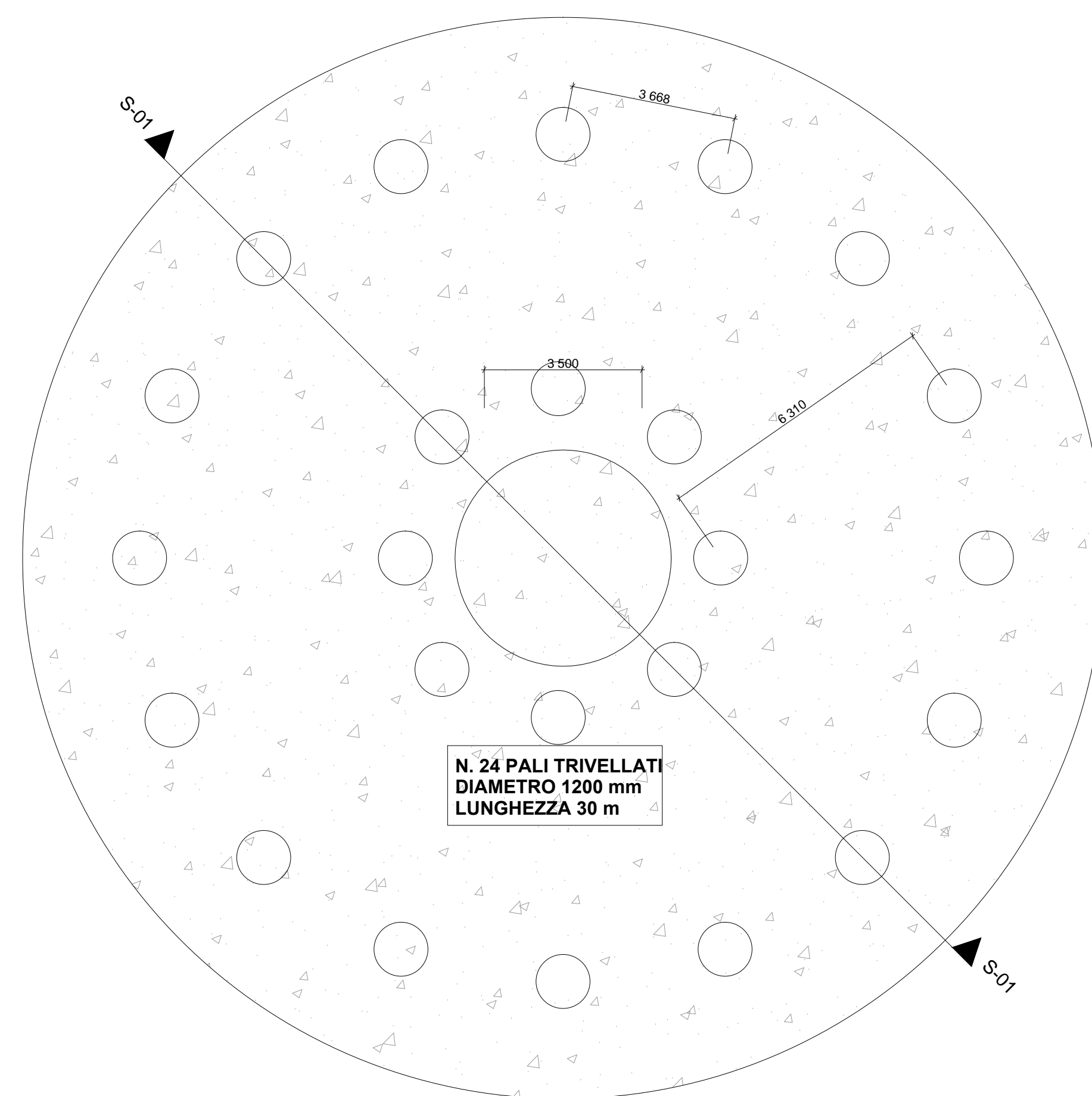

SEZIONE S-01 PARTICOLARE FONDAZIONE SU PALI Scala 1:100

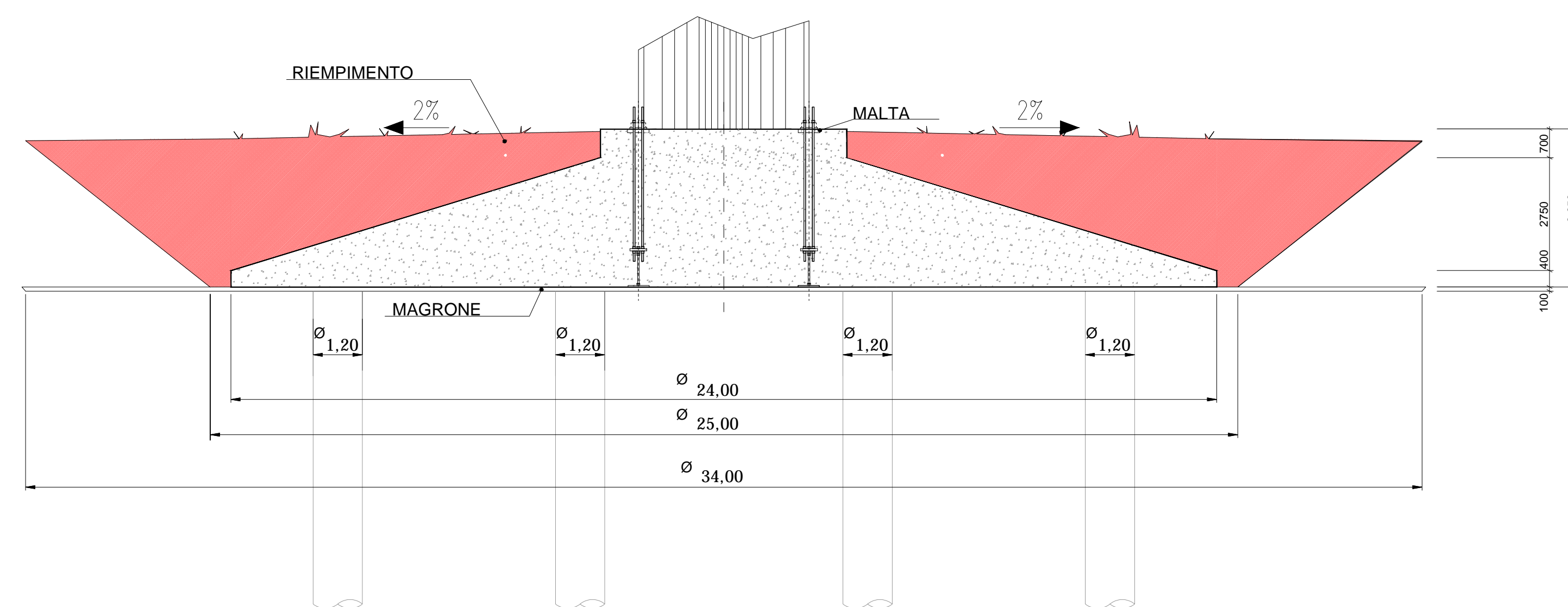

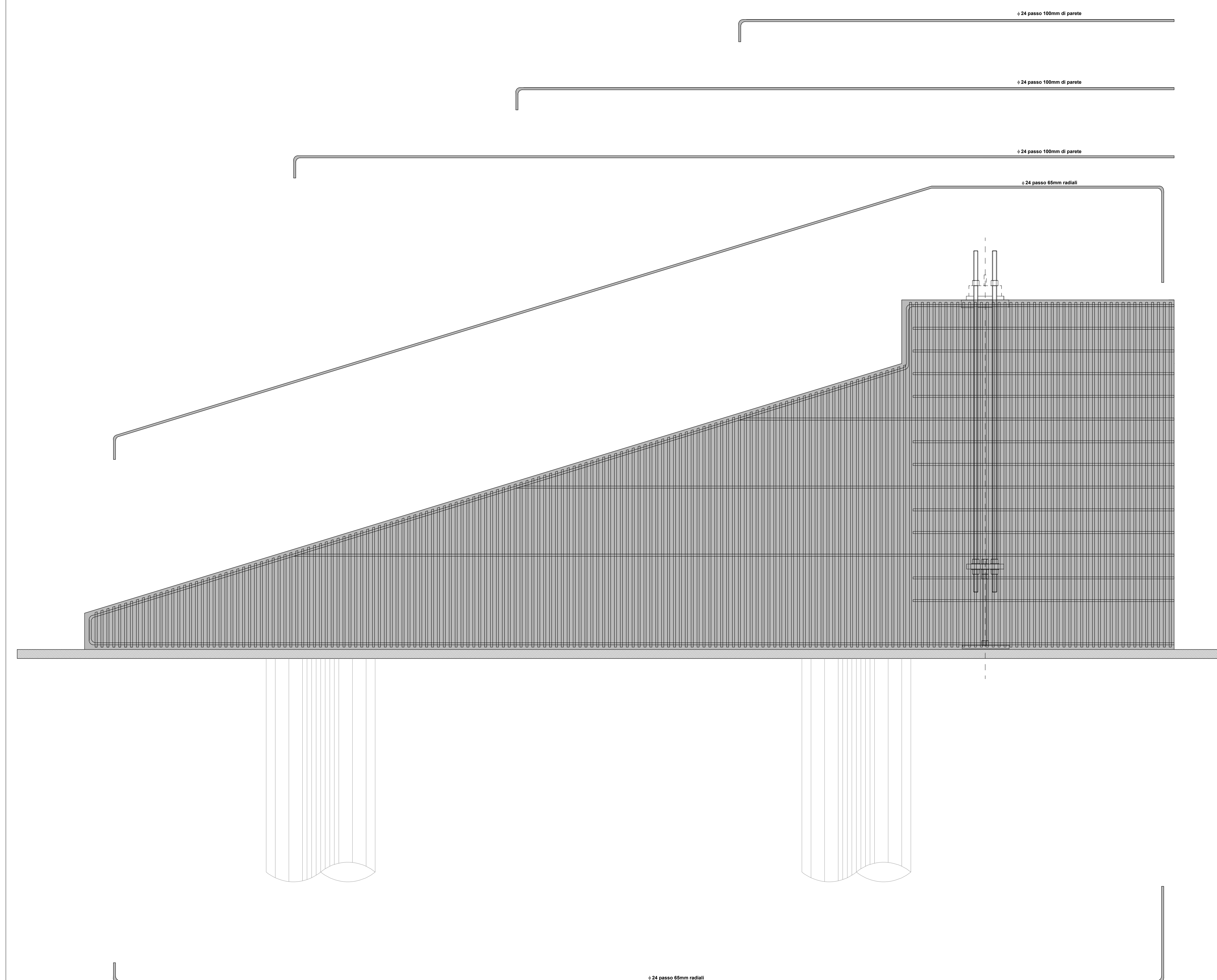

DISPOSIZIONE ARMATURE PLINTO IN C.A. Scala 1:25
CALCESTRUZZO C45/55 ARMATURE B450C



COMUNI DI ISOLA DI CAPO RIZZUTO E CUTRO
PROVINCIA DI CROTONE

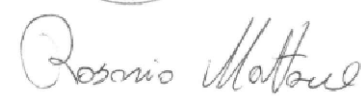

PROGETTO DEFINITIVO PARCO EOLICO "FAUCI"

TAVOLA: FA_CIV_T12	PARTICOLARE COSTRUTTIVO FONDAZIONE
SCALA: 1:25;1:50;1:100	
FORMATO: A0	
COMMITTENTE : ENERGIA LEVANTE s.r.l. Via Iacopanton 10/11 - Reggio Emilia - Cap 41013 SORANA P.IVA 10540591007 - REA RM1219825 - energialevante@sigpa.it SOCIETA' DEL GRUPPO	IL PROFESSIONISTA: Ing. Rosario Mattace  
 For a better world of energy www.sse renewables.com Tel. +39 063482107	

N. REVISIONE	DATA REVISIONE	ELABORATO	CONTROLLATO	APPROVATO	NOTE

E' vietata la copia anche parziale del presente elaborato