

Planimetria - Scala 1:50

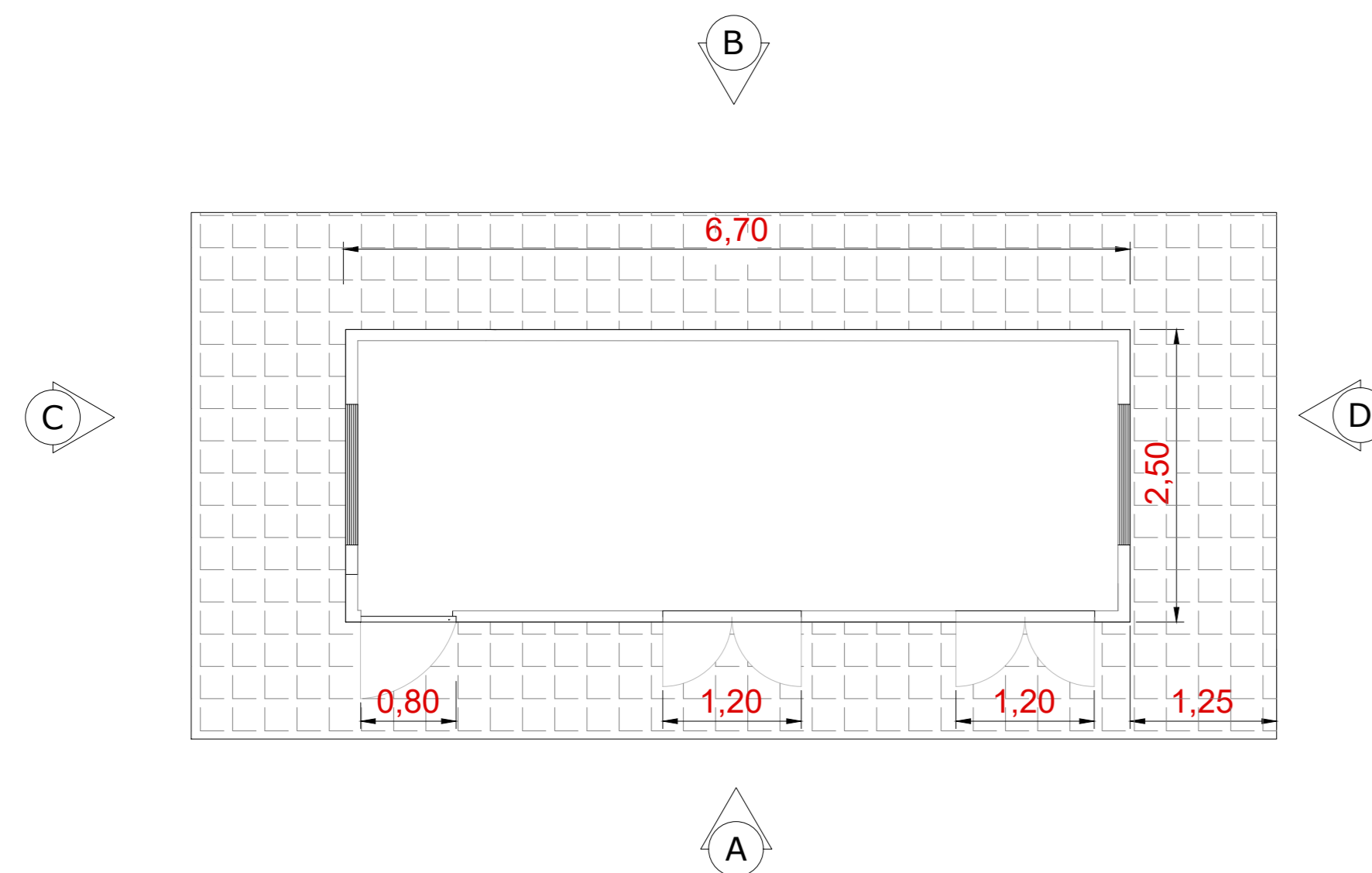

Sezione - Scala 1:50

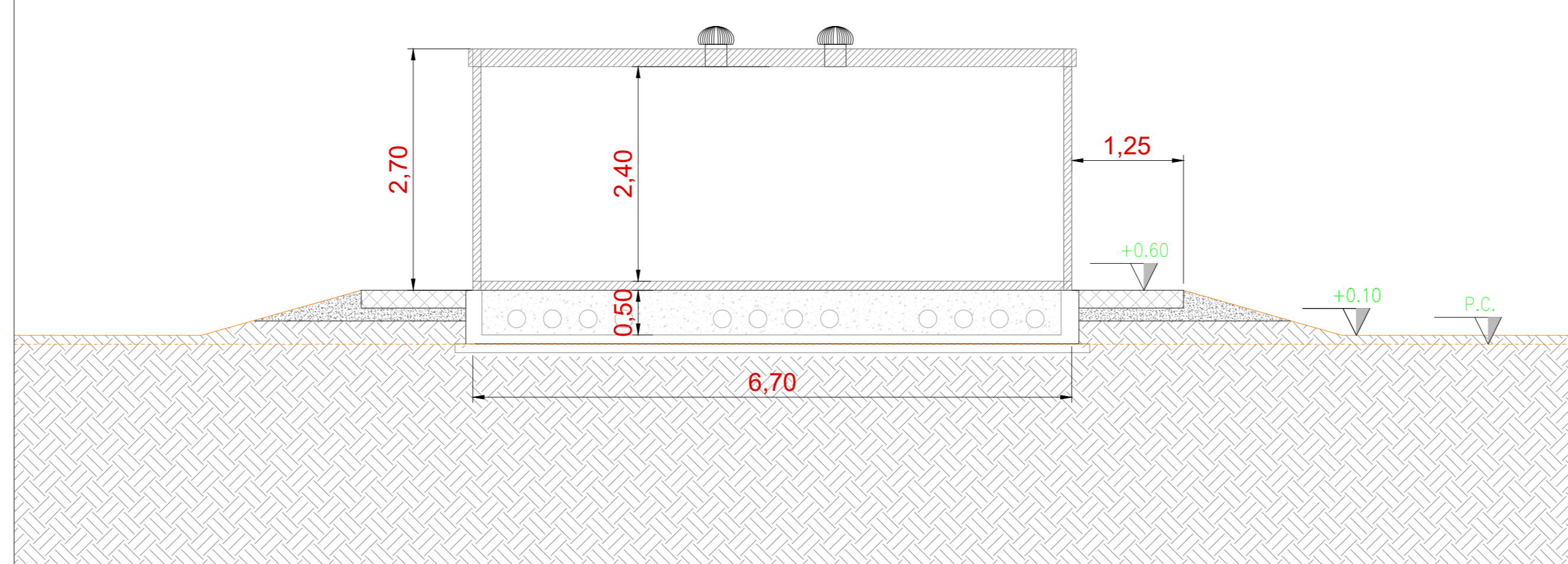

Vista A - Scala 1:50

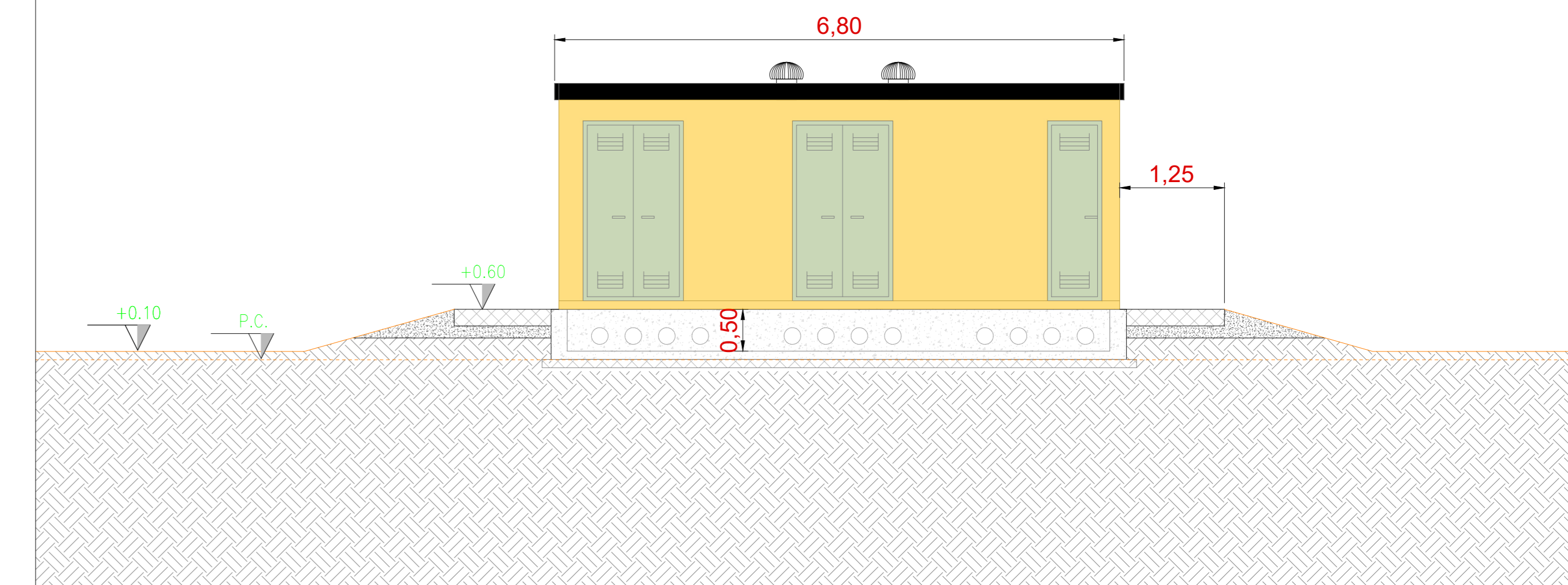

Pianta fondazioni - Scala 1:50

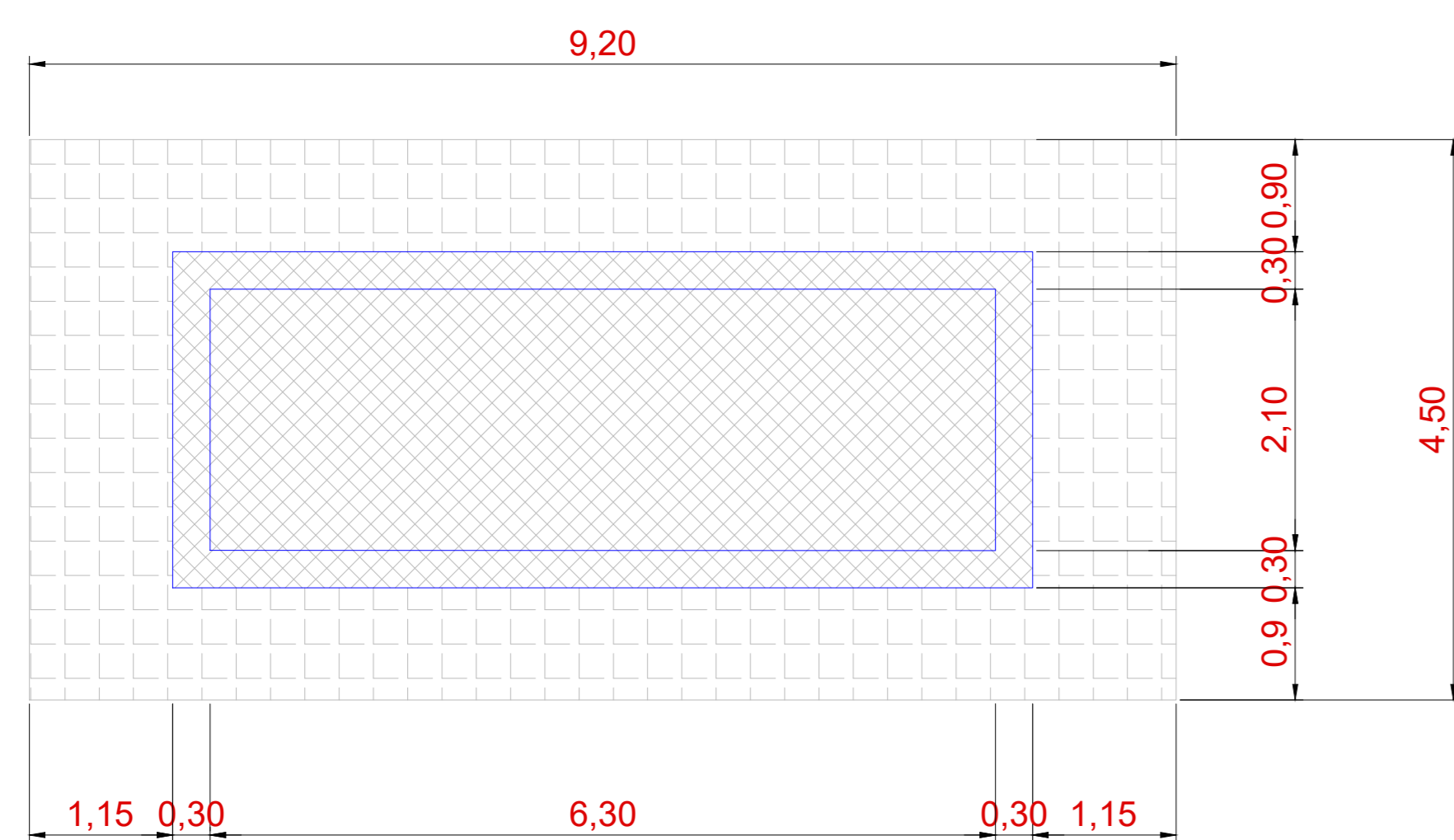

Vista B - Scala 1:50

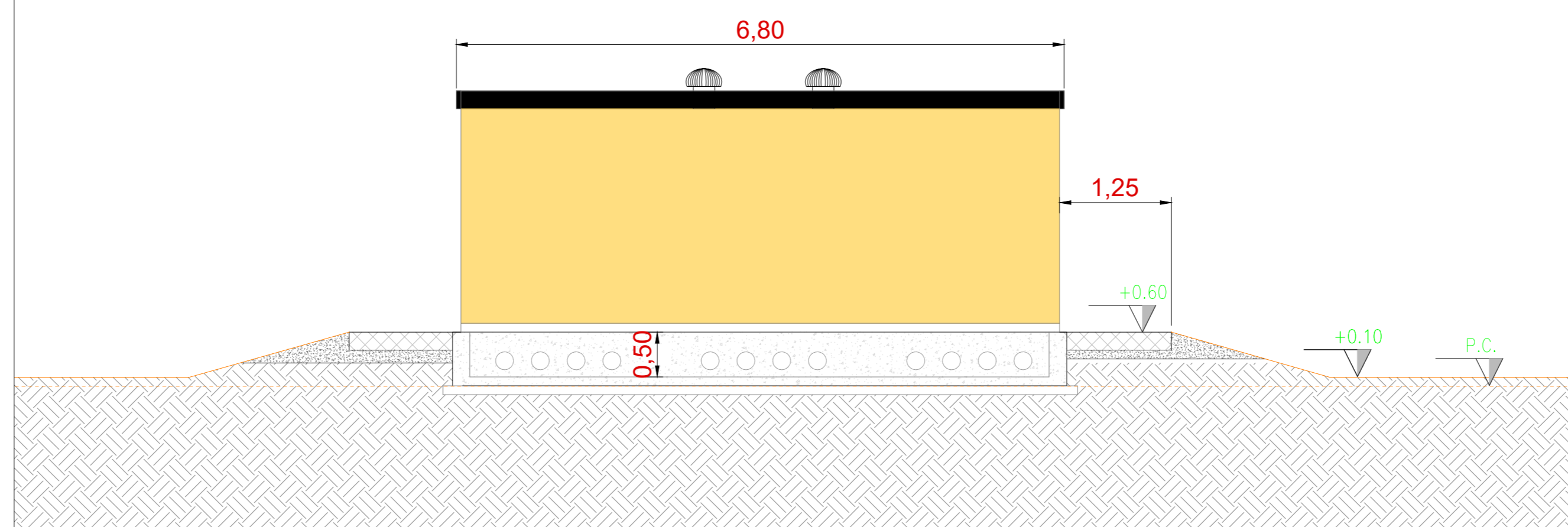

Vista C - Scala 1:50

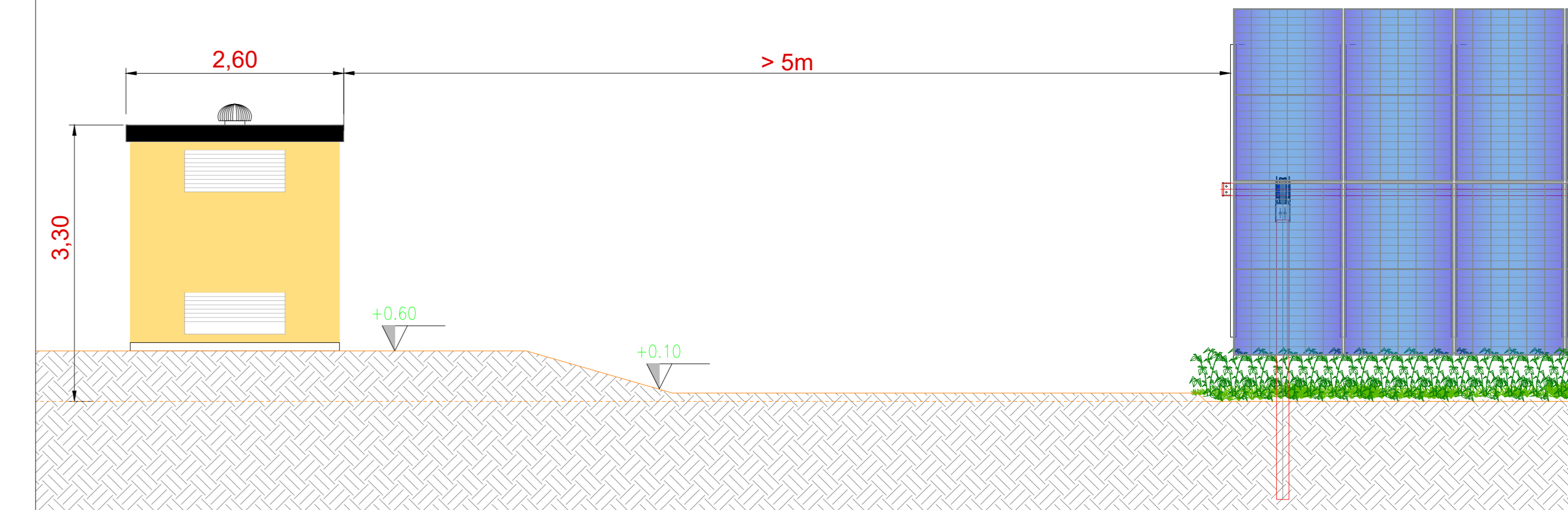

Vista dall'alto - Scala 1:50

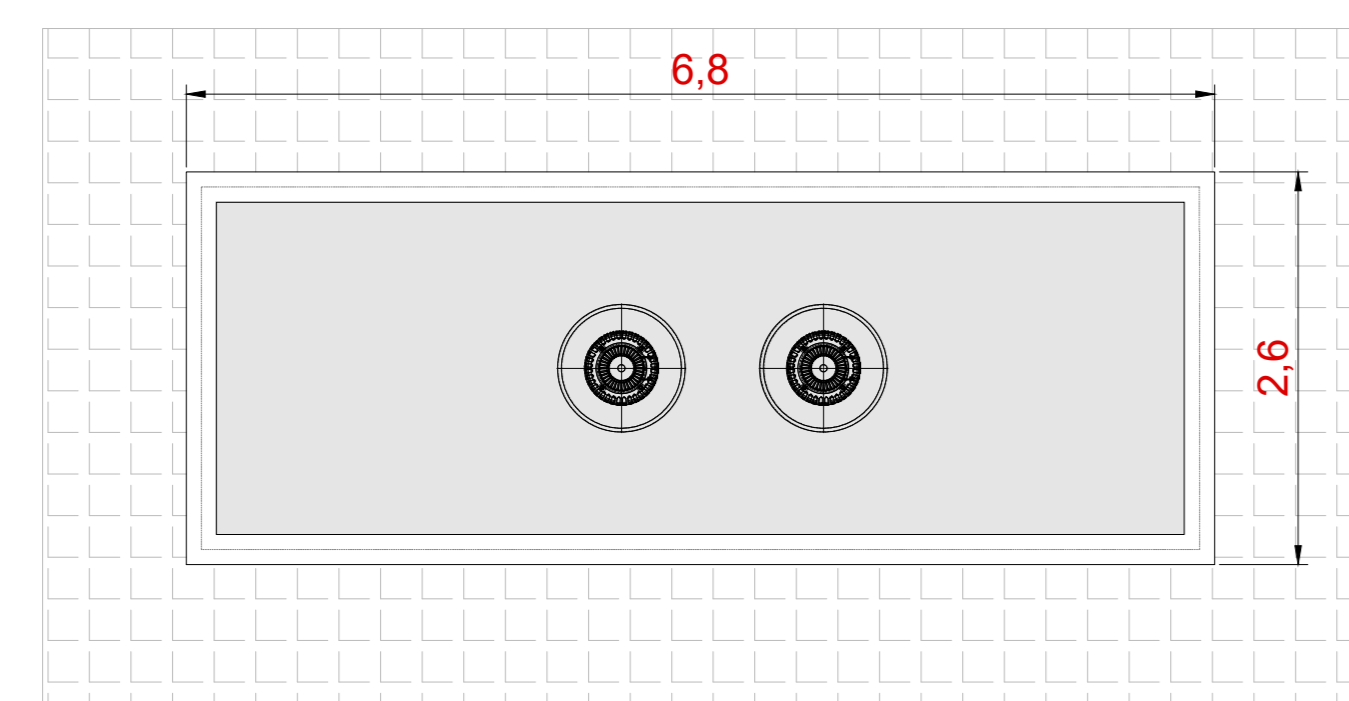

Vista D - Scala 1:50

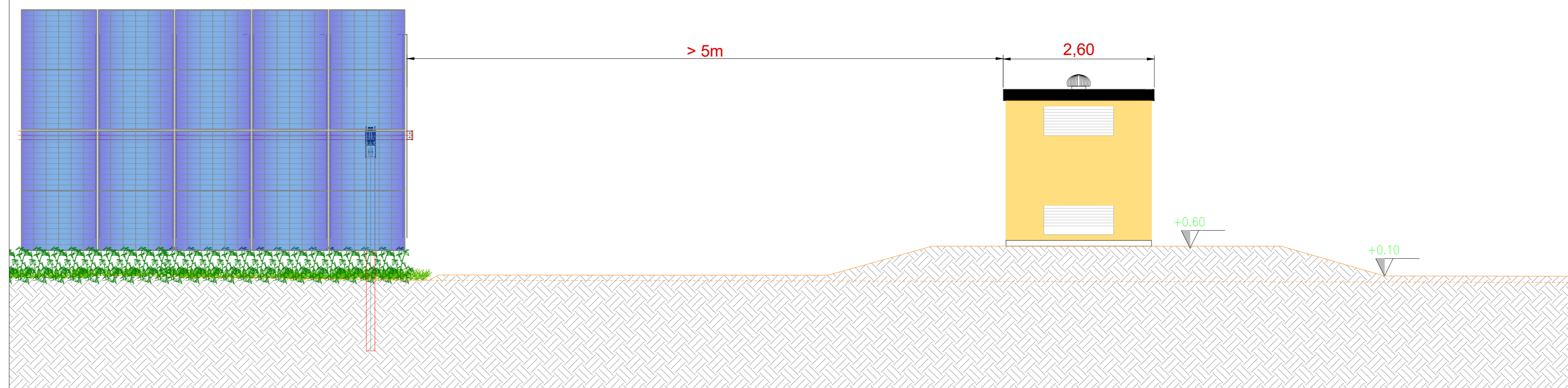

Inquadramento generale - Aree di manovra cabina raccolta cavi 36 kV - Scala 1:200

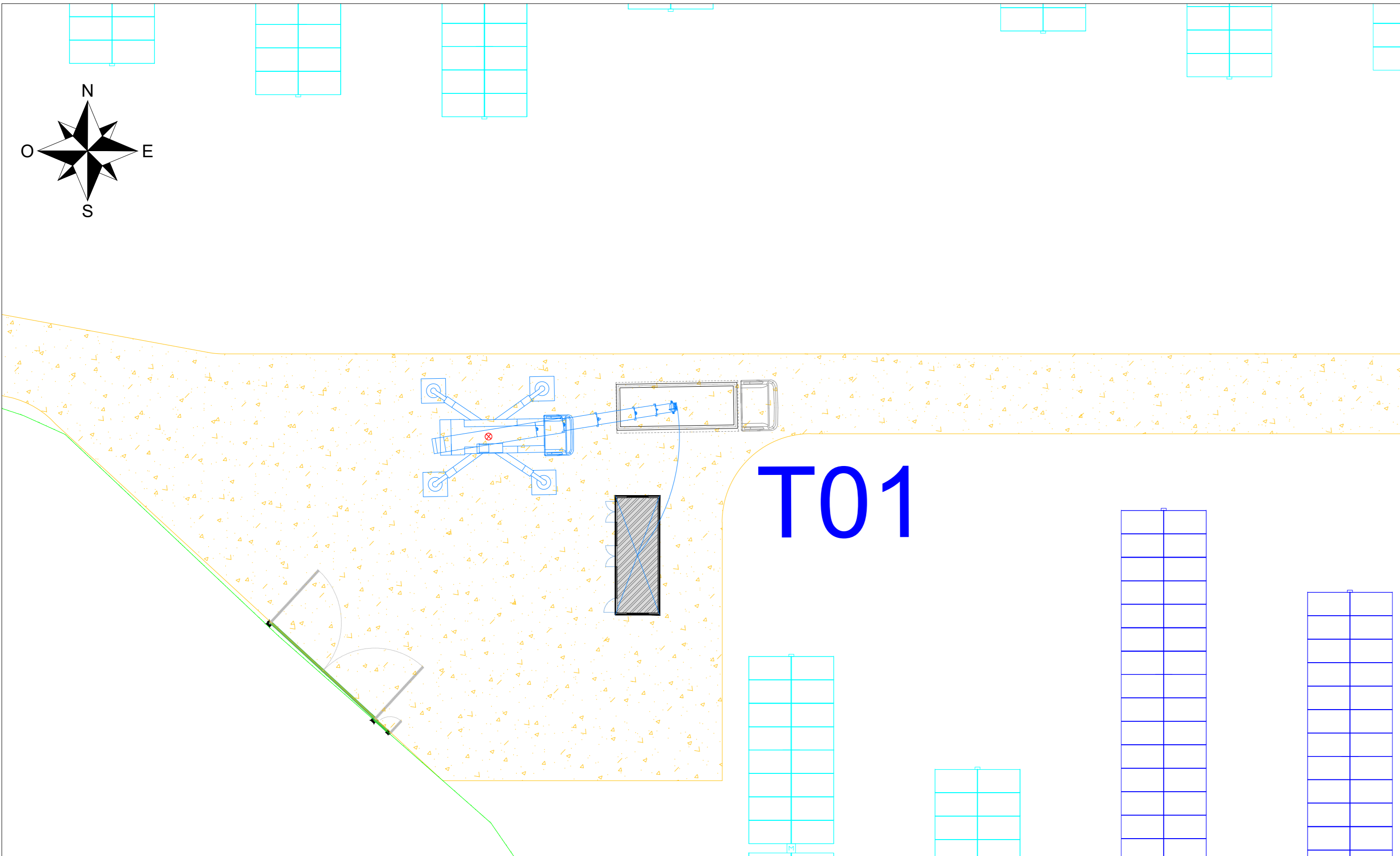

Tipico 3D Cabina raccolta MT

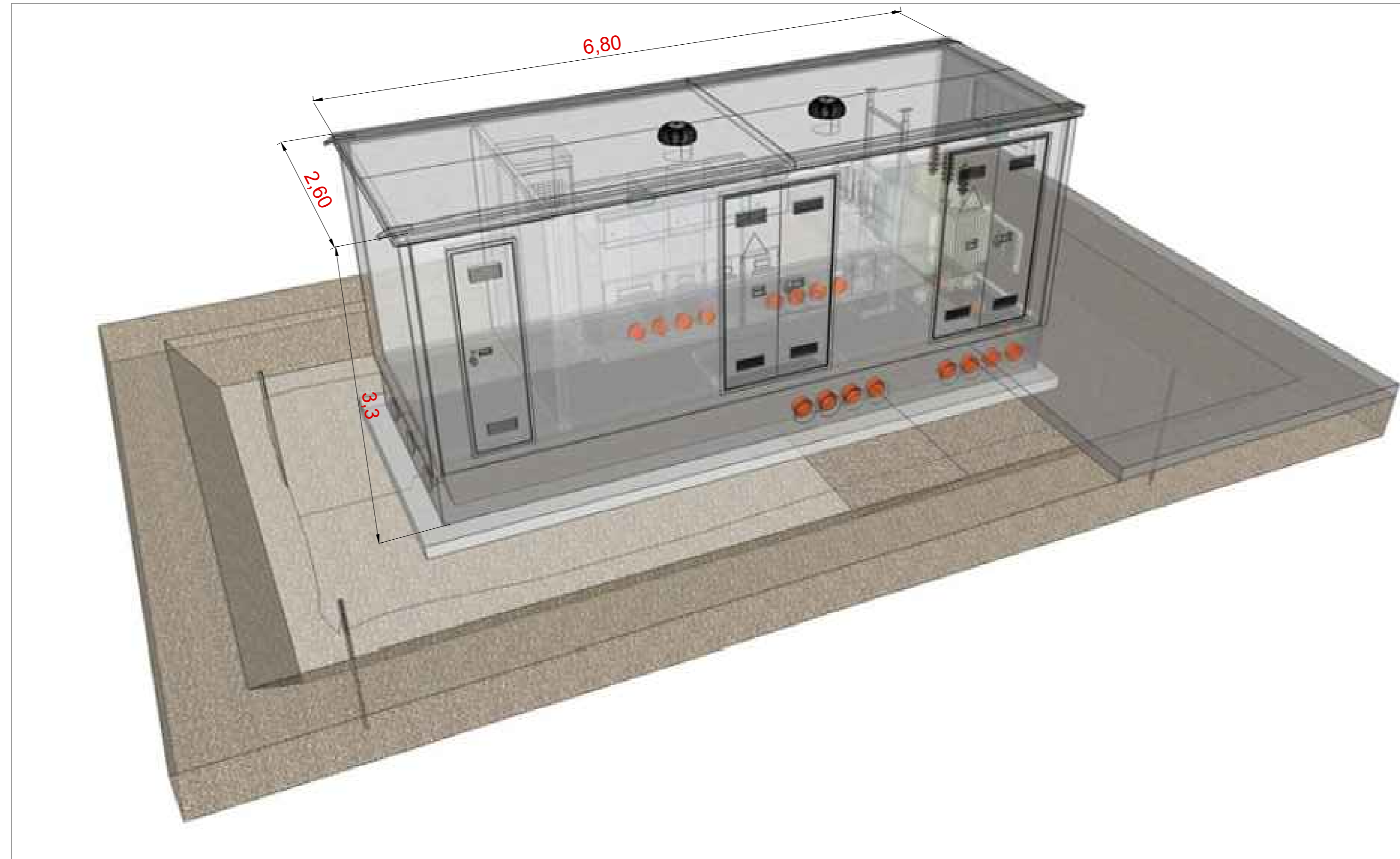

		REGIONE SICILIA COMUNE DI RACALMUTO (AG)			
PROGETTO IMPIANTO AGRIVOLTAICO DI POTENZA PARI A 38745 kWp (29785 kWp IN IMMISSIONE) DENOMINATO "Tolalp - Racalmuto" ED OPERE CONNESSE INDISPENSABILI DA REALIZZARSI NEL COMUNE DI RACALMUTO (AG)					
TITOLO Tav.16 - Tipico cabina di raccolta MT					
PROGETTISTI SCM Ingegneria S.r.l. Via Carlo Farini, 55 20145 MILANO (MI) Tel. +39 02 7738955 T0221 (Numero 800) Mail: info@scmengineering.com		PROPONENTE TOLALP ENERGY S.R.L. Sede legale e Amministrativa: Via Michelangelo Buonarroti, 39 20145 MILANO (MI) PEC: tolalpenenergy@legalmail.it			
VISTI SICILWIND S.r.l. Viale Cilea Roma, 26 Tel. +39 091 9763003 90134 Palermo (PA) PEC: sicilwind@pec.it					
PROGETTAZIONE 					
Scala	Formato Stamp	Cod. Elaboro	Nome File	Foglio	
VARE	A0	FVRCMD-L_Tav.16	00	1 di 1	
Rev.	Data	Descrizione	Elaborato	Controllato	Approvato
00	Mag-23	Prima Emersione	R. Cavallaro	D. Cavallaro	L. Neriello