

PROGETTO PER LA REALIZZAZIONE DI UN IMPIANTO PER LA
PRODUZIONE DI ENERGIA MEDIANTE LO SFRUTTAMENTO DEL VENTO
NEL MARE ADRIATICO MERIDIONALE - BARIUM BAY
74 WTG – 1.110 MW

PROGETTO DEFINITIVO - SIA

Progettazione e SIA



Indagini ambientali e studi specialistici



Studio misure di mitigazione e compensazione



supervisione scientifica





4. STAZIONE DI TRASFORMAZIONE OFFSHORE

T.4.2 Sottostazione Offshore - elaborati grafici apparecchiature elettromeccaniche

REV.	DATA	DESCRIZIONE



		BARIUM BAY OFFSHORE SUBSTATIONS ELECTRICAL EQUIPMENT LIST				Document 12085-ELE-001 Pagina 1 di 3 Page of									
		PROGETTO: Barium Bay Offshore Project				Security Index <table border="1"> <tr> <td>A</td> <td>B</td> <td>C</td> <td>D</td> </tr> <tr> <td></td> <td></td> <td></td> <td></td> </tr> </table>		A	B	C	D				
A	B	C	D												
TITLE Electrical Equipment List Sub-Title						R.00									
CLIENTE Client															
JOB no: 12085		Doc. no. ELE-001													
INOLTRO AL CLIENTE Submittal to the client		Per Approvazione For approval		Per Informazione For Information		Non richiesto Not Requested									
SISTEMA System		TIPO ELABORATO Document type		DISCIPLINA Discipline		NOME FILE File name									
REV.	DESCRIZIONE DELLE REVISIONI / REVISION DESCRIPTION														
00	First Issue														
00	30/06/2023	First Issue	/	SD	/	/	/	/	/	MT	MT				
REV	DATA Date	FASE Phase	SCOPO Scope	PREPARATO DA Prepared by		COLLABORAZIONI Co-operations			CONTROLLATO DA Checked by		APPROVATO DA Approved by				

BARIUM BAY OFFSHORE SUBSTATIONS

ELECTRICAL EQUIPMENT APPARECCHIATURE ELETTTRICHE

SUBSTATION 1 (130m sea depth)

ITEM	DESCRIPTION	TECHNICAL DATA INFORMATION	QUANTITIES	TOTAL WEIGHT (kg)	VOLUME (m ³) [LxWxH]	NOTE
ITEMIZED EQUIPMENT						
1	SWITCHYARD					
	AIR INSULATED SUBSTATION (AIS)	n.a				
	380kV - GAS INSULATED SUBSTATION (GIS)	N°2 trafo bay N°3 line bay N°1 coupler	1	66.000	1.167	
	66kV - GAS INSULATED SUBSTATION (GIS)	N°12 bays N°1 coupler N°2 TV on busbars	1	61.100	476	
	HV OUTDOOR LOOSE EQUIPMENT	n.a				
2	GENERATOR & AUXILIARY EQUIPMENT					
	G.T. GENERATOR & AUXILIARY EQUIPMENT	n.a				
	S.T. GENERATOR & AUXILIARY EQUIPMENT	n.a				
3	BUS DUCTS					
	G.T. ISOLATED PHASE BUS DUCT	n.a				
	S.T. ISOLATED PHASE BUS DUCT	n.a				
	DURESCA BUS DUCT	2x2000A Bus Duct at GIS 66kV terminals Tee-off (from 2x2000A to 1x4000A) 1X4000A Bus Duct to TRAF0	2	8.760	4	between GIS 66kV incomers to main transformers
4	GENERATOR NEUTRAL EARTHING CUBICLE					
	G.T. GENERATOR NEUTRAL EARTHING CUBICLE	n.a				
	S.T. GENERATOR NEUTRAL EARTHING CUBICLE	n.a				
5	GENERATOR CIRCUIT BREAKER					
	GT GENERATOR CIRCUIT BREAKER	n.a				
	ST GENERATOR CIRCUIT BREAKER	n.a				
	NEUTRAL EARTHING RESISTOR CUBICLE	n.a				
6	TRANSFORMER					
	MAIN TRANSFORMER <i>(including cooling bank)</i>	N° 2 x 330 MVA (ONAN) 380/66kV	2	660.000	1.383	
	EARTHING TRANSFORMER	N° 2 x 2MVA (tbd) dry type (tbd) 66/0,42-0,23 kV	2	10.000	16	
	AUXILIARY TRANSFORMER	N° 2 x 2MVA (tbd) dry type 66/0,42-0,23 kV	2	10.000	16	
	SMALL POWER TRANSFORMER	tbd				
	VARIABLE SHUNT REACTOR <i>(including cooling bank)</i>	N° 2 x 300 MVar (ONAN) 380kV	2	620.000	1.126	
	CURRENT LIMITING REACTOR	n.a				
	MV SWITCHGEARS	n.a				
	AUTOMATIC FAST TRANSFER PANELS	n.a				
	BUS DUCT	n.a				
	LV SWITCHBOARDS	N° 1 x LVSG-AUX n°4 incomer n° 2 coupler n°24 feeder	1	12.600	25	assumed 14 cabinets
7	DC SYSTEM & UPS SYSTEM					
		N°2 x AC/DC + DC/AC converters (100kVA, tbd) N° 2 x AC Distribution Panel (with Bypass transformer) N°1 x DC Distribution Panel N°2 x Battery Set	1	17.100	30	assumed 5 cabinets + battery packs
8	DIESEL GENERATOR SET <i>(including container and diesel tank)</i>	N° 2 x 500kVA (tbd)	2	40.000	140	
9	ELECTRICAL MOTORS					
	M.V. (INDUCTION & SYNCHRONOUS) MOTORS	tbd				
	L.V. MOTORS	tbd				
	VARIABLE SPEED DRIVE SYSTEM	tbd				
	ELECTRICAL MODULES	tbd				
	PROTECTION PANEL	tbd				
	UTF METERING SYSTEM	tbd				
	INTERFACE PANELS	tbd				
	CABLES	tbd				
10	H.V. CABLES & ACCESSORIES (JOINT & TERMINATION)	tbd				
BULK MATERIAL						
11	MV POWER CABLES & ACCESSORIES	tbd				
12	LV POWER CABLES & ACCESSORIES	tbd				
13	CONTROL CABLES & ACCESSORIES	tbd				
14	OPTICAL FIBER CABLES & ACCESSORIES	tbd				
15	CATHODIC PROTECTION SYSTEM	tbd				
16	MOTOR CONTROL STATIONS	tbd				
17	CONDUITS	tbd				
18	CABLE TRAYS/LADDER	tbd				
19	EARTHING & LIGHTNING PROTECTION SYSTEM	tbd				
20	LIGHTING and SMALL POWER SYSTEM	tbd				
21	HEAT TRACING SYSTEM	tbd				
22	COMMUNICATION and CLOCK SYSTEM	tbd				
23	ACCESS CONTROL SYSTEM	tbd				
24	ANTI-INTRUSION & SECURITY SYSTEM	tbd				
25	MISCELLANEOUS BULK MATERIAL	tbd				
TOTAL				1.505.560	4.382	

BARIUM BAY OFFSHORE SUBSTATIONS

ELECTRICAL EQUIPMENT APPARECCHIATURE ELETTTRICHE

SUBSTATION 2 (150m sea depth)

ITEM	DESCRIPTION	TECHNICAL DATA INFORMATION	QUANTITIES	TOTAL WEIGHT (kg)	VOLUME (m ³) [LxWxH]	NOTE
ITEMIZED EQUIPMENT						
1	SWITCHYARD					
	AIR INSULATED SUBSTATION (AIS)	n.a				
	380kV - GAS INSULATED SUBSTATION (GIS)	N°2 trafo bay N°1 line bay	1	33.000	584	
	66kV - GAS INSULATED SUBSTATION (GIS)	N°12 bays N°1 coupler N°2 TV on busbars	1	61.100	476	
	HV OUTDOOR LOOSE EQUIPMENT	n.a				
2	GENERATOR & AUXILIARY EQUIPMENT					
	G.T. GENERATOR & AUXILIARY EQUIPMENT	n.a				
	S.T. GENERATOR & AUXILIARY EQUIPMENT	n.a				
3	BUS DUCTS					
	G.T. ISOLATED PHASE BUS DUCT	n.a				
	S.T. ISOLATED PHASE BUS DUCT	n.a				
	DURESCA BUS DUCT	2x2000A Bus Duct at GIS 66kV terminals Tee-off (from 2x2000A to 1x4000A) 1X4000A Bus Duct to TRAF0	2	8.760	4	between GIS 66kV incomers to main transformers
4	GENERATOR NEUTRAL EARTHING CUBICLE					
	G.T. GENERATOR NEUTRAL EARTHING CUBICLE	n.a				
	S.T. GENERATOR NEUTRAL EARTHING CUBICLE	n.a				
5	GENERATOR CIRCUIT BREAKER					
	GT GENERATOR CIRCUIT BREAKER	n.a				
	ST GENERATOR CIRCUIT BREAKER	n.a				
	NEUTRAL EARTHING RESISTOR CUBICLE	n.a				
6	TRANSFORMER					
	MAIN TRANSFORMER <i>(including cooling bank)</i>	N° 2 x 330 MVA (ONAN) 380/66kV	2	660.000	1.383	
	EARTHING TRANSFORMER	N° 2 x 2MVA (tbd) dry type (tbd) 66/0.42-0.23 kV	2	10.000	16	
	AUXILIARY TRANSFORMER	N° 2 x 2MVA (tbd) dry type 66/0.42-0.23 kV	2	10.000	16	
	SMALL POWER TRANSFORMER	tbd				
	VARIABLE SHUNT REACTOR <i>(including cooling bank)</i>	N° 2 x 350 MVar (ONAN) 380kV	2	700.000	1.126	
	CURRENT LIMITING REACTOR	n.a				
	MV SWITCHGEARS	n.a				
	AUTOMATIC FAST TRANSFER PANELS	n.a				
	BUS DUCT	n.a				
	LV SWITCHBOARDS	N° 1 x LVSG-AUX n°4 incomer n° 2 coupler n°24 feeder	1	12.600	25	assumed 14 cabinets
7	DC SYSTEM & UPS SYSTEM					
		N°2 x AC/DC + DC/AC converters (100kVA, tbd) N° 2 x AC Distribution Panel (with Bypass transformer) N°1 x DC Distribution Panel N°2 x Battery Set	1	17.100	30	assumed 5 cabinets + battery packs
8	DIESEL GENERATOR SET <i>(including container and diesel tank)</i>	N° 2 x 500kVA (tbd)	2	40.000	140	
9	ELECTRICAL MOTORS					
	M.V. (INDUCTION & SYNCHRONOUS) MOTORS	tbd				
	L.V. MOTORS	tbd				
	VARIABLE SPEED DRIVE SYSTEM	tbd				
	ELECTRICAL MODULES	tbd				
	PROTECTION PANEL	tbd				
	UTF METERING SYSTEM	tbd				
	INTERFACE PANELS	tbd				
	CABLES	tbd				
10	H.V. CABLES & ACCESSORIES (JOINT & TERMINATION)	tbd				
BULK MATERIAL						
11	MV POWER CABLES & ACCESSORIES	tbd				
12	LV POWER CABLES & ACCESSORIES	tbd				
13	CONTROL CABLES & ACCESSORIES	tbd				
14	OPTICAL FIBER CABLES & ACCESSORIES	tbd				
15	CATHODIC PROTECTION SYSTEM	tbd				
16	MOTOR CONTROL STATIONS	tbd				
17	CONDUITS	tbd				
18	CABLE TRAYS/LADDER	tbd				
19	EARTHING & LIGHTNING PROTECTION SYSTEM	tbd				
20	LIGHTING and SMALL POWER SYSTEM	tbd				
21	HEAT TRACING SYSTEM	tbd				
22	COMMUNICATION and CLOCK SYSTEM	tbd				
23	ACCESS CONTROL SYSTEM	tbd				
24	ANTI-INTRUSION & SECURITY SYSTEM	tbd				
25	MISCELLANEOUS BULK MATERIAL	tbd				
TOTAL				1.552.560	3.798	

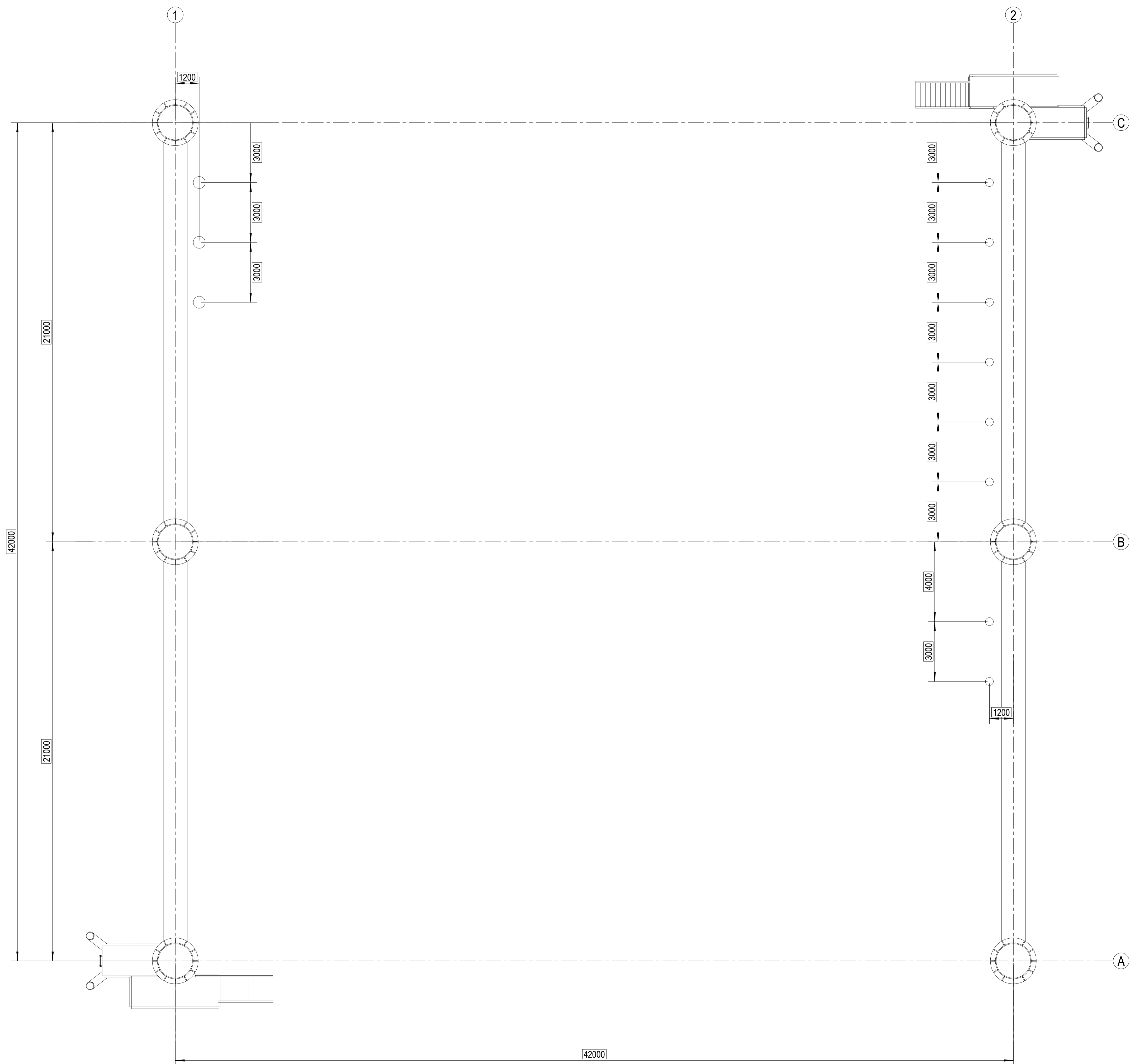

File name: 12085-LDL-001-00_Layout Substation 1.dwg

Rev.	Date	Created by	Checked by	Approved by	Description
00	30/06/2023	MC	MT	MT	First issue
Customer		Project		Customer Document ID	
Barium Bay Srl		Barium Bay Offshore Substations		-	
Project ID		Replacing		Based on	
12085		-		-	
Responsible Department		Created by		Checked by	
-		Matteo Corbetta		Mauro Tavola	
Title		Document ID		Page	
Layout Substation 1		12085-LDL-001		1/6	
KKS-NO.: -		Rev.		Rel. Date	
		00		30/06/2023	



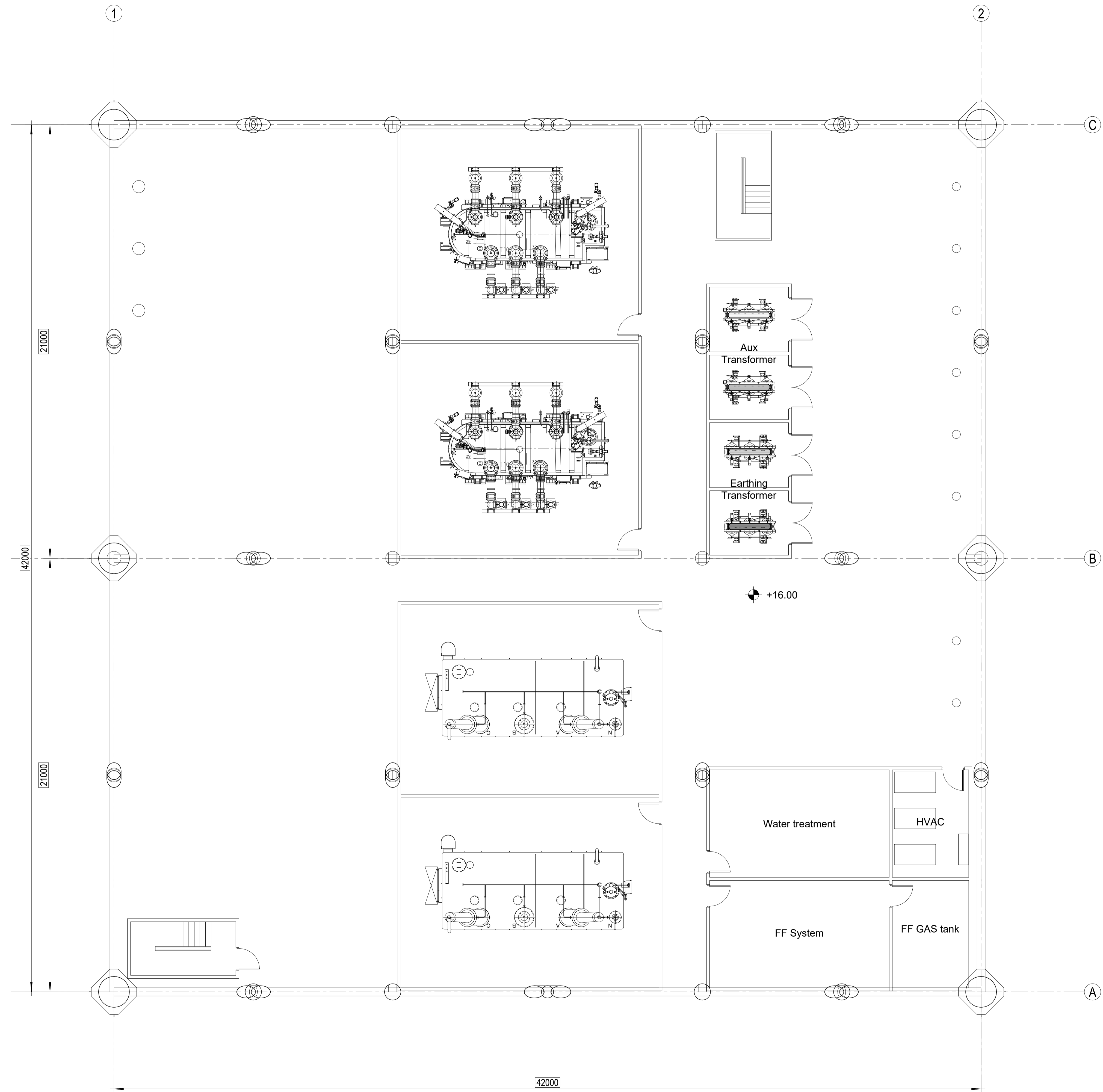

PLAN AT EL. +16.00

File name: 12085-LDL-001-00_Layout Substation 1.dwg

Rev.	Date	Created by	Checked by	Approved by	Description
00	30/06/2023	MC	MT	MT	First issue
Customer		Project		Customer Document ID	
Barium Bay SRL		Barium Bay Offshore Substations		-	
Project ID		Replacing		Based on	
12085		-		-	
Responsible Department		Created by		Checked by	
-		Matteo Corbetta		Mauro Tavola	
Title		Document ID		Page	
Layout substation 1		12085-LDL-001		2/6	
KKS-NO: -		Rev.		Rel. Date	
		00		30/06/2023	



Mod. UNI-A1/0

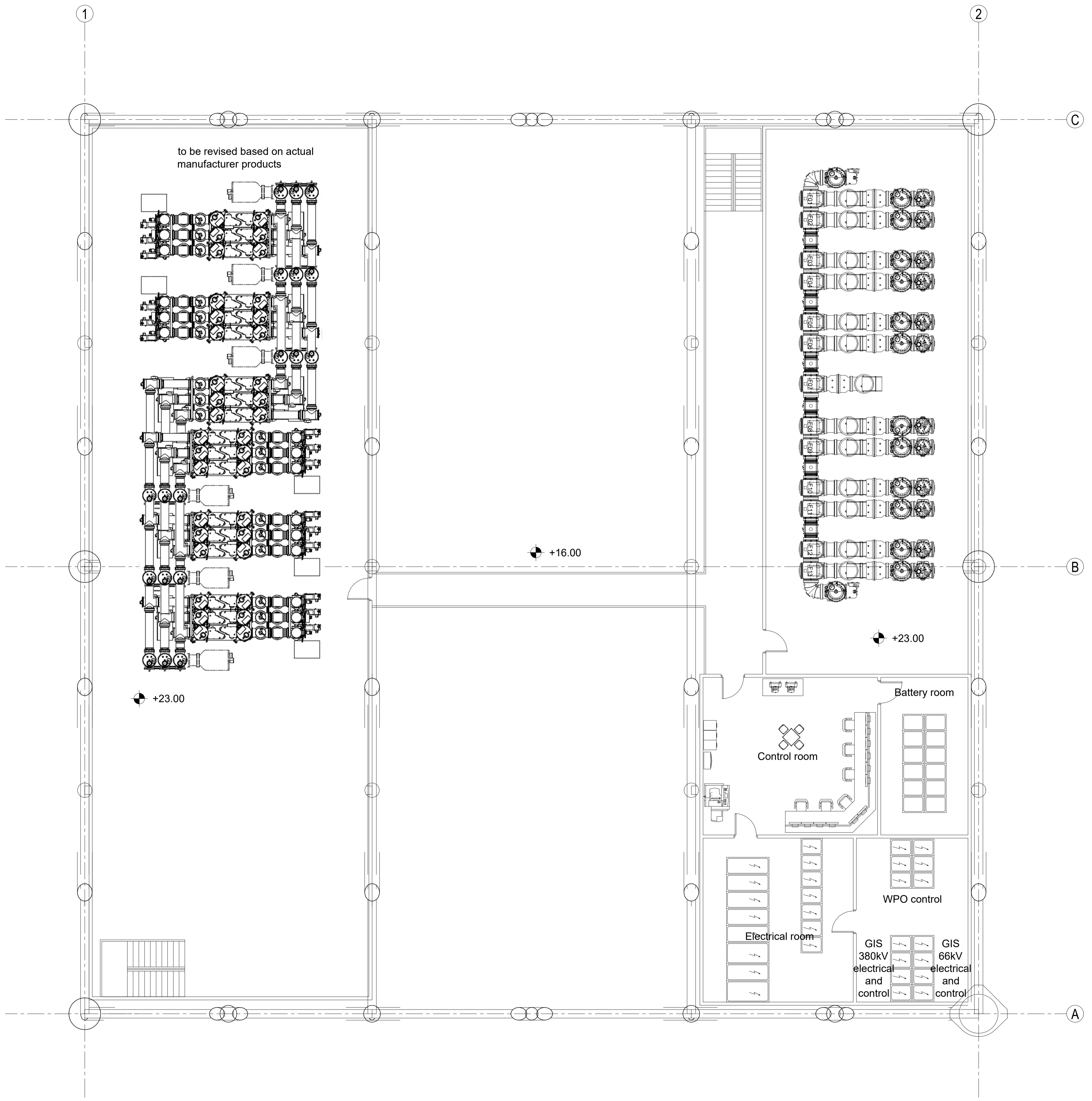

PLAN AT EL. +23.00

File name: 12085-LDL-001-00_Layout Substation 1.dwg

00	30/06/2023	MC	MT	MT	First issue
Rev.	Date	Created by	Checked by	Approved by	Description
Customer		Project		Customer Document ID	
Barium Bay Srl		Barium Bay Offshore Substations		-	
Project ID		Replacing		Based on	
12085		-		-	
Responsible Department		Created by		Checked by	
-		Matteo Corbetta		Mauro Tavola	
Title		Document ID		Page	
Layout Substation 1		12085-LDL-001		3/6	
KKS-NO.: -		Rev.		Rel. Date	
		00		30/06/2023	

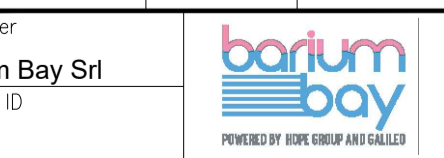

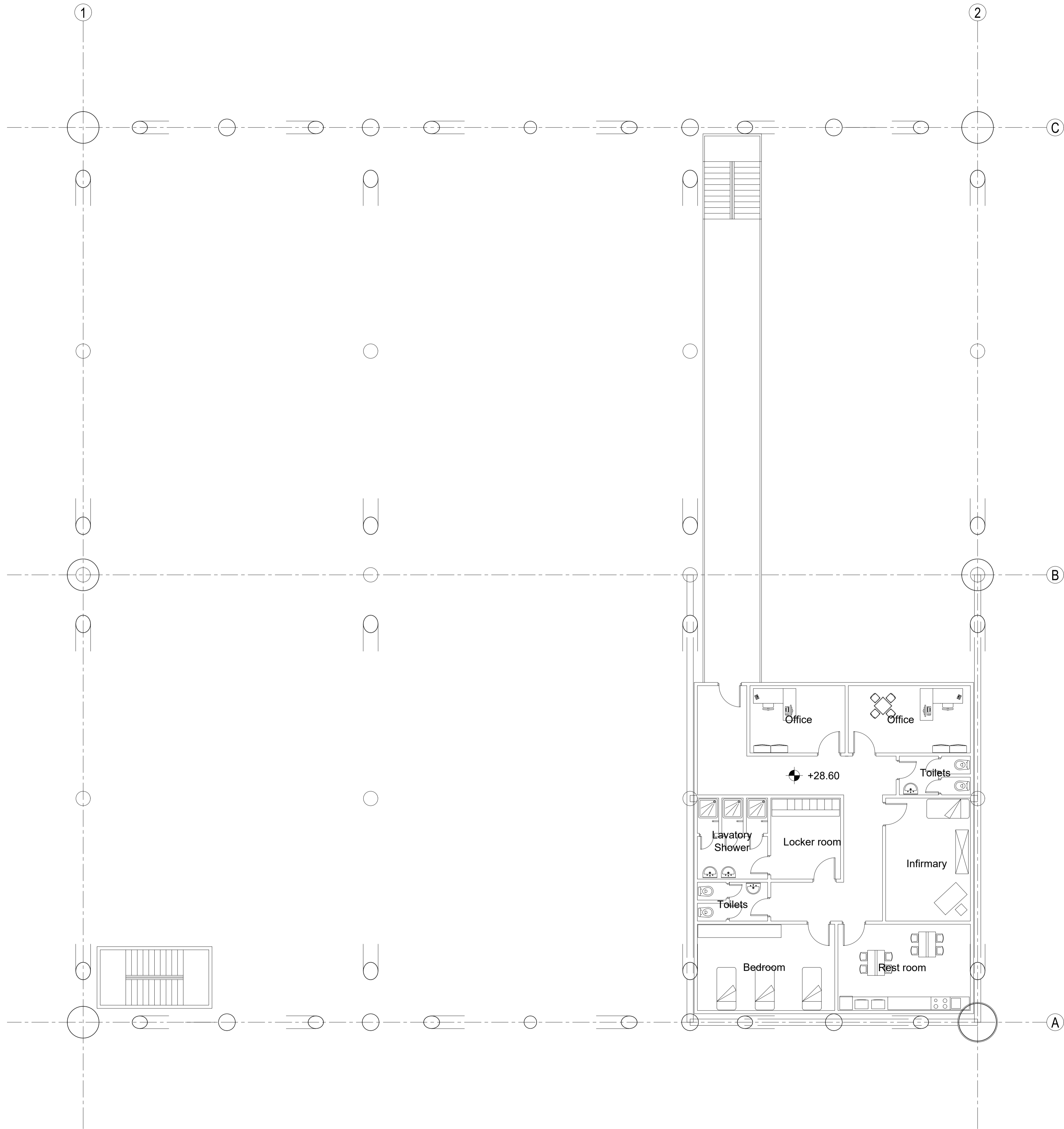

PLAN AT EL. +28.60

File name: 12085-LDL-001-00_Layout Substation 1.dwg

00	30/06/2023	MC	MT	MT	First issue
Rev.	Date	Created by	Checked by	Approved by	Description
Customer		Project		Customer Document ID	
Barium Bay Srl		Barium Bay Offshore Substations		-	
Project ID		Replacing		Based on	
12085		-		-	
Responsible Department		Created by		Checked by	
-		Matteo Corbetta		Mauro Tavola	
Title		Document ID		Page	
Layout Substation 1		12085-LDL-001		4/6	
KKS-NO.: -		Rev.		Rel. Date	
		00		30/06/2023	

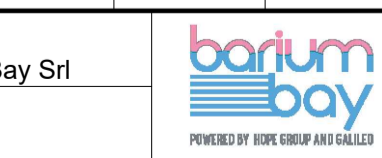

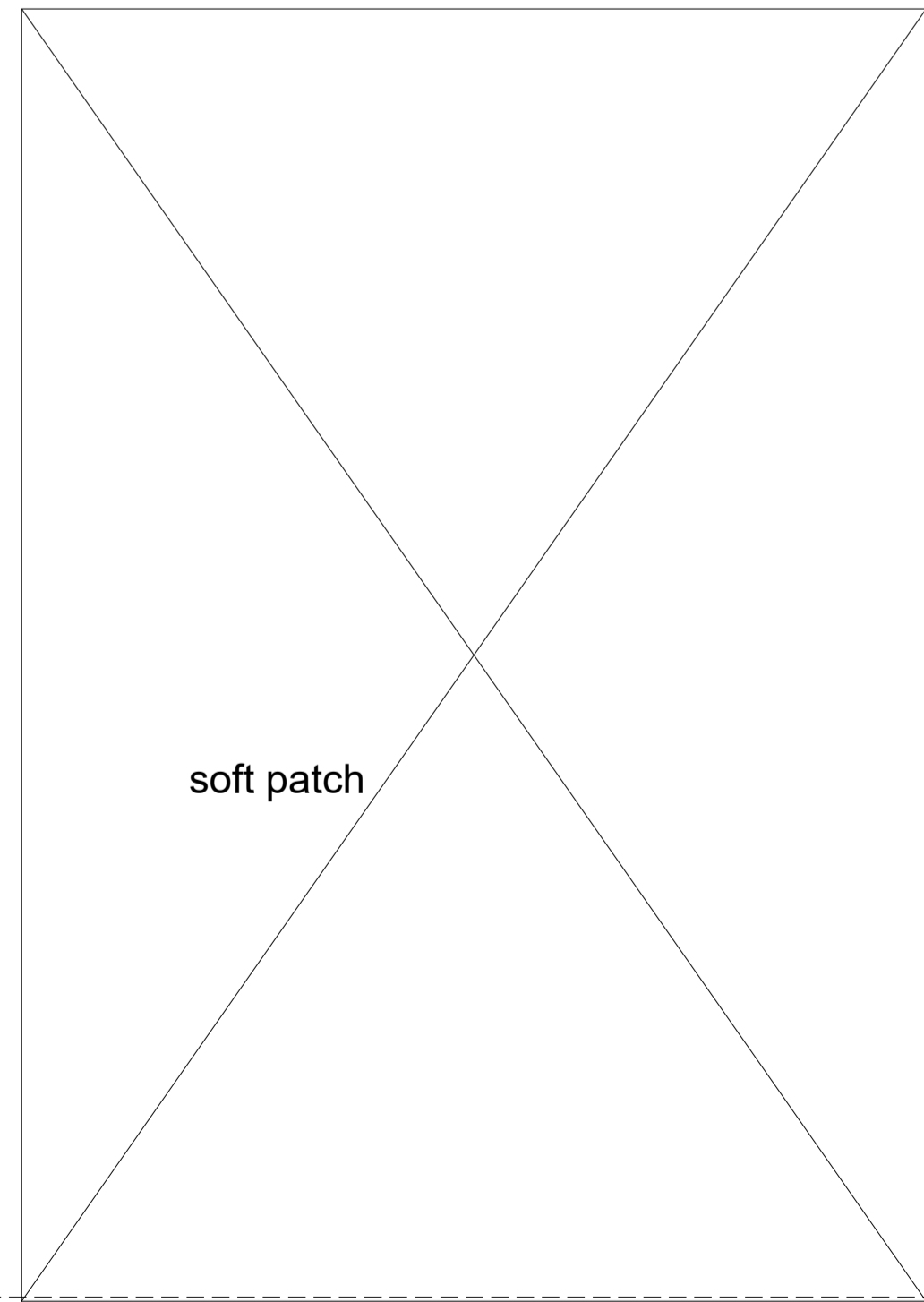
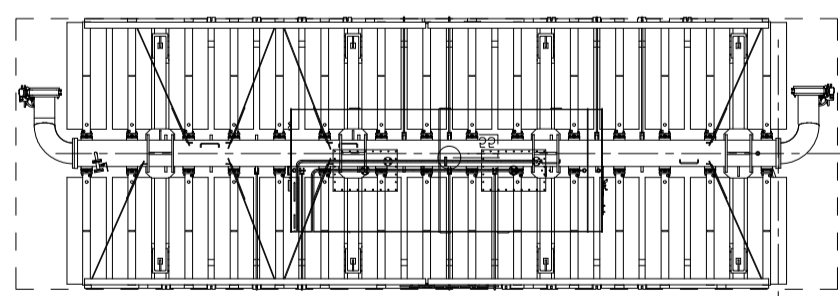
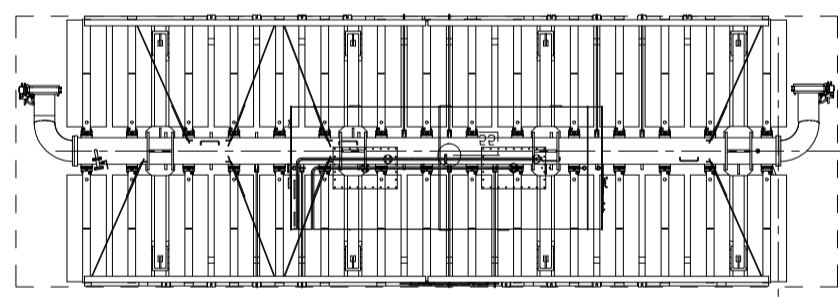
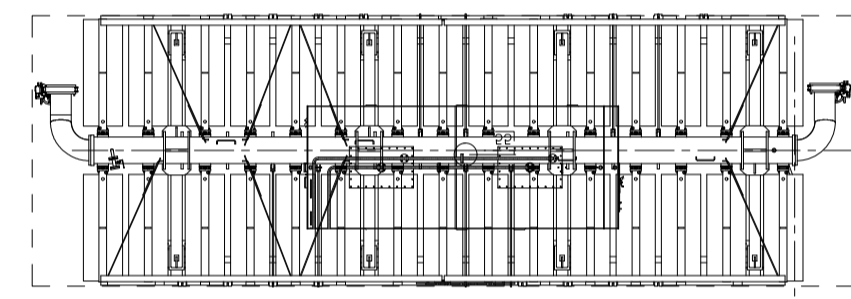
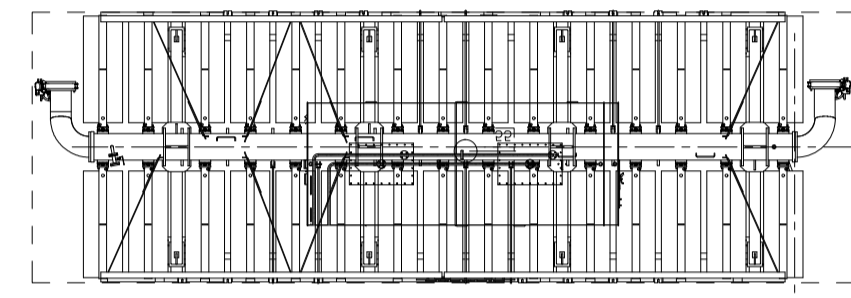
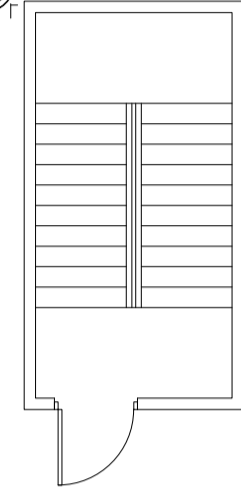
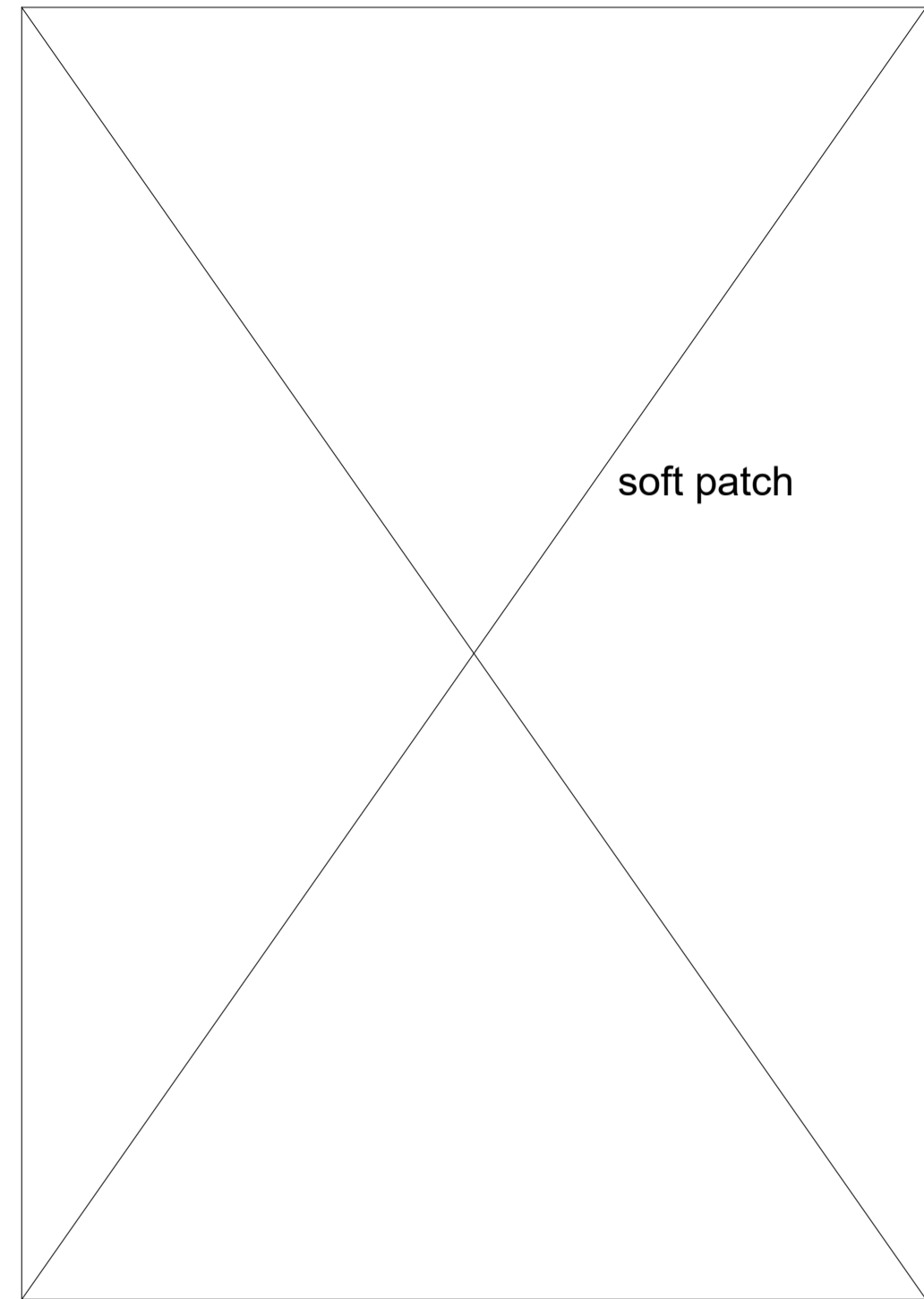
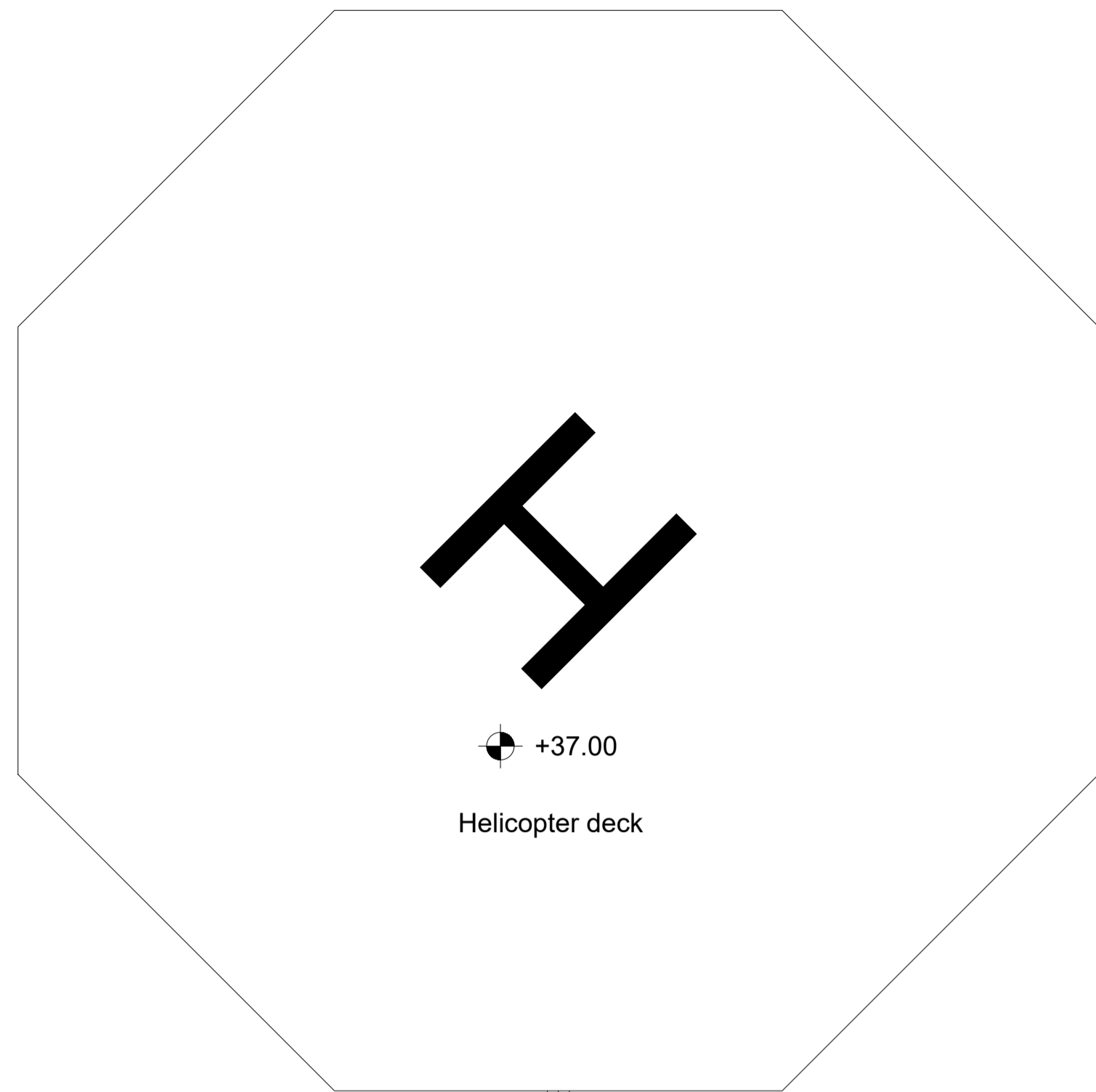

+34.00

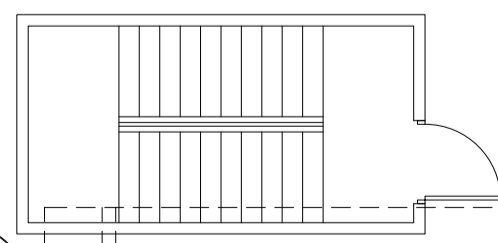
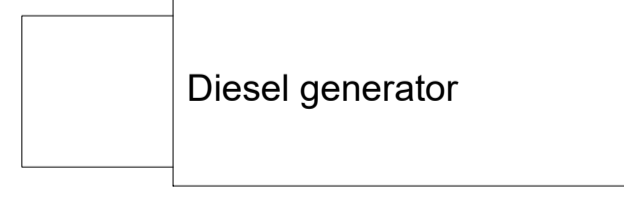
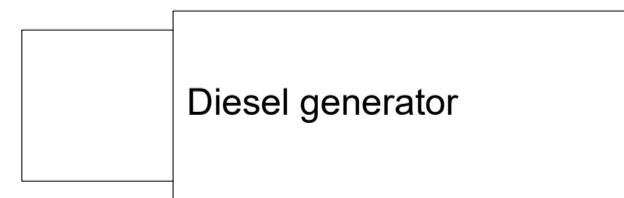

Crane

PLAN AT EL. +34.00

File name: 12085-LDL-001-00_Layout Substation 1.dwg

Rev.	Date	Created by	Checked by	Approved by	Description
00	30/06/2023	MC	MT	MT	First issue

Customer Barium Bay Srl	Project Barium Bay Offshore Substations	Customer Document ID -
Project ID 12085	Replacing -	Based on -
Responsible Department -	Created by Matteo Corbetta	Checked by Mauro Tavola
	Approved by Mauro Tavola	
Title Layout Substation 1		Document ID 12085-LDL-001
KKS-NO.: -		Rev. Rel. Date Page 00 30/06/2023 5/6



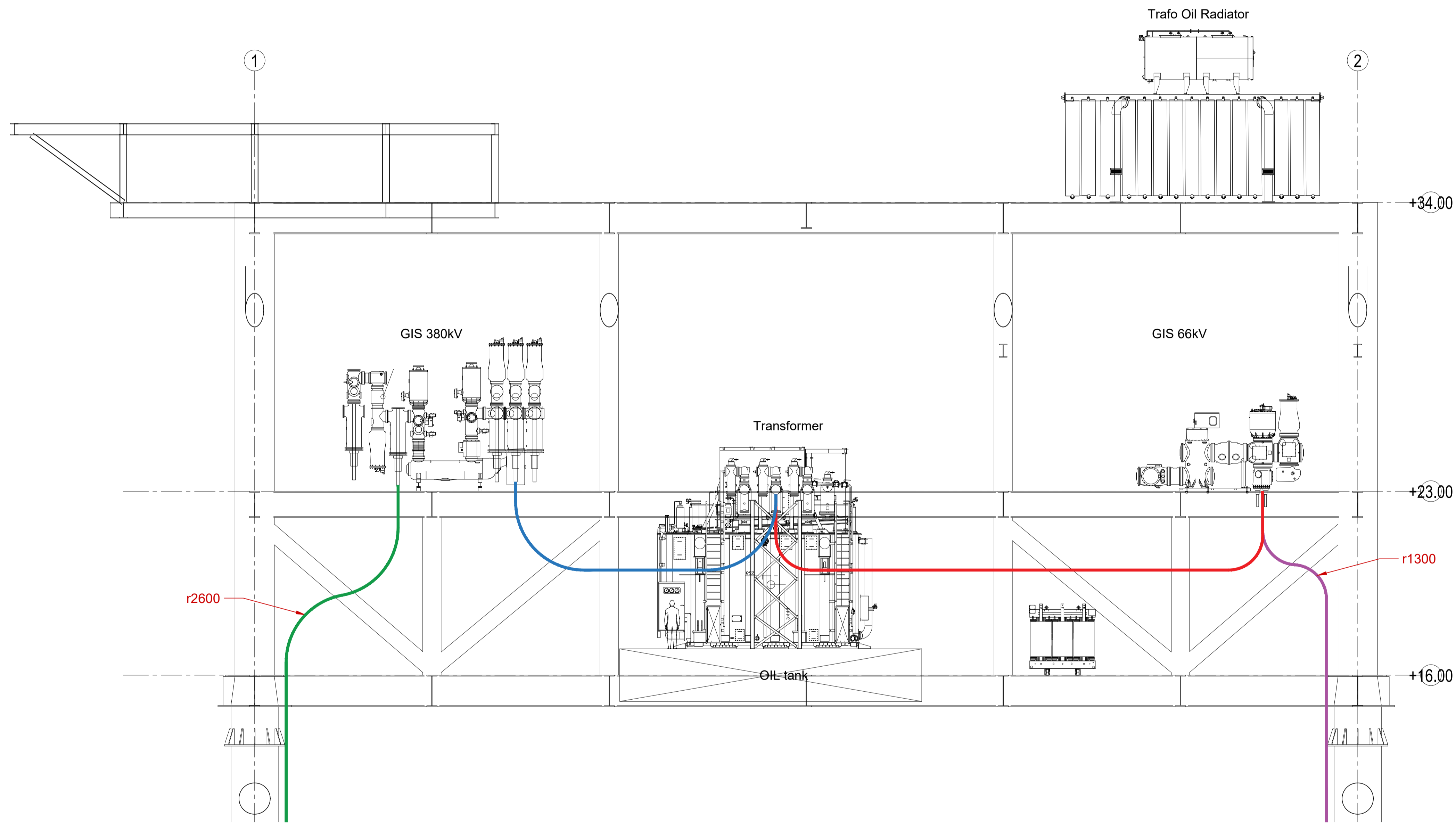

SECTION

File name: 12085-LDL-001-00_Layout Substation 1.dwg

00	30/06/2023	MC	MT	MT	First issue
Rev.	Date	Created by	Checked by	Approved by	Description
Customer Barium Bay Srl		Project Barium Bay Offshore Substations		Customer Document ID -	
Project ID 12085		Replacing -		Based on -	Scale 1:XX
Responsible Department -		Created by Matteo Corbetta	Checked by Mauro Tavola	Approved by Mauro Tavola	
Title Layout Substation 1		Document ID 12085-LDL-001		Rev. 00	Page 6/6
KKS-NO.: -		Rel. Date 30/06/2023		Page 6/6	

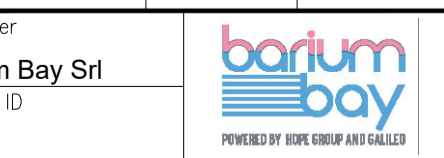

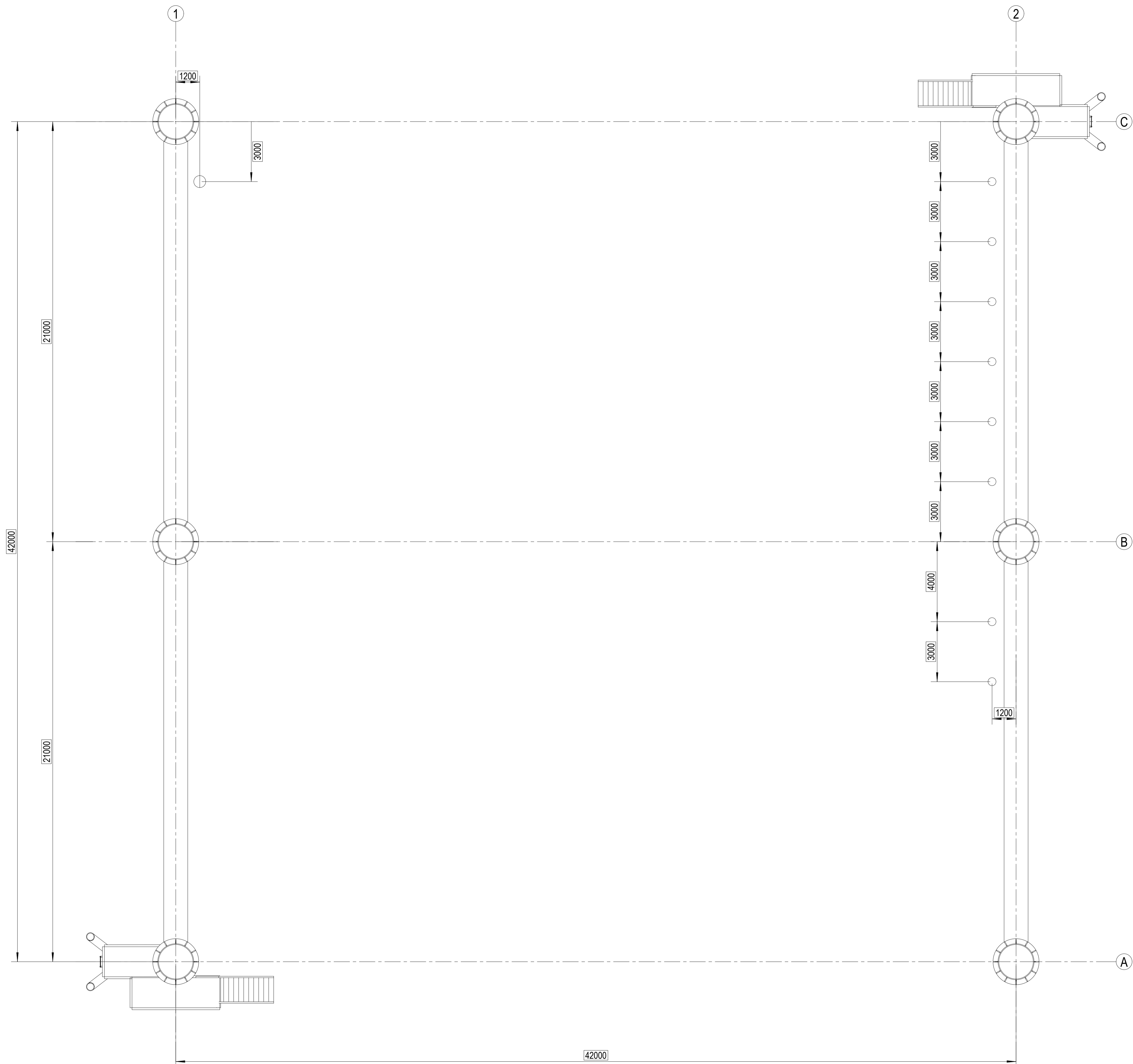

File name: 12085-LDL-002-00_Layout Substation 2.dwg

Rev.	Date	Created by	Checked by	Approved by	Description
00	30/06/2023	MC	MT	MT	First issue
Customer		Project			Customer Document ID
Barium Bay Srl		Barium Bay Offshore Substations			-
Project ID		Replacing		Based on	Scale
12085		-		-	1:XX
Responsible Department		Created by		Checked by	Approved by
-		Matteo Corbetta		Mauro Tavola	Mauro Tavola
Title		Document ID			
Layout Substation 2		12085-LDL-002			
KKS-NO.: -		Rev.	Rel. Date	Page	
		00	30/06/2023	1/6	



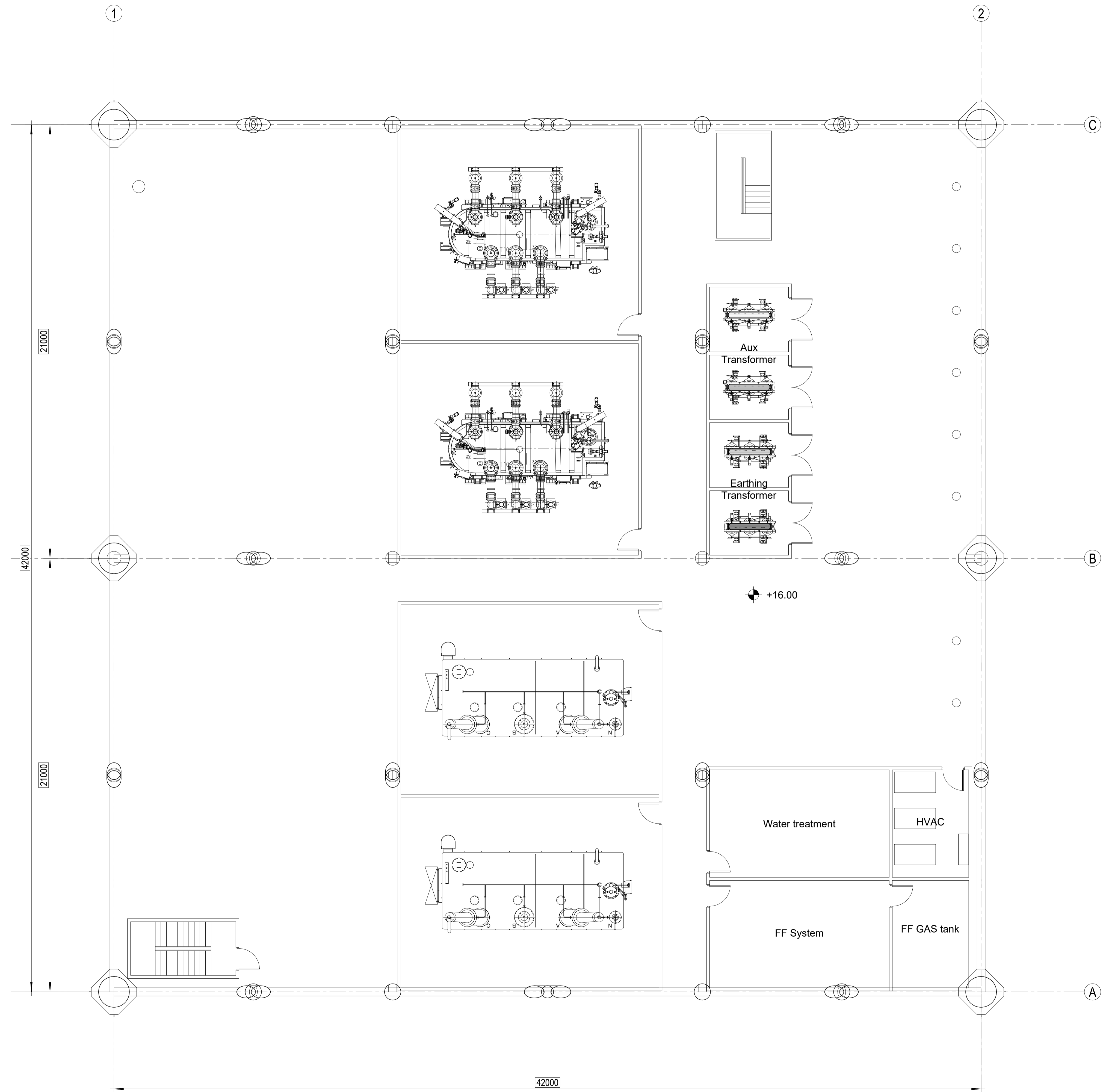

PLAN AT EL. +16.00

File name: 12085-LDL-002-00_Layout Substation 2.dwg

Rev.	Date	Created by	Checked by	Approved by	Description
00	30/06/2023	MC	MT	MT	First issue
Customer		Project		Customer Document ID	
Barium Bay Srl		Barium Bay Offshore Substations		-	
Project ID		Replacing		Based on	
12085		-		-	
Responsible Department		Created by		Checked by	
-		Matteo Corbetta		Mauro Tavola	
Title		Document ID		Page	
Layout Substation 2		12085-LDL-002		2/6	
KKS-NO.: -		Rev.		Rel. Date	
		00		30/06/2023	



Mod. UNI-A1/0

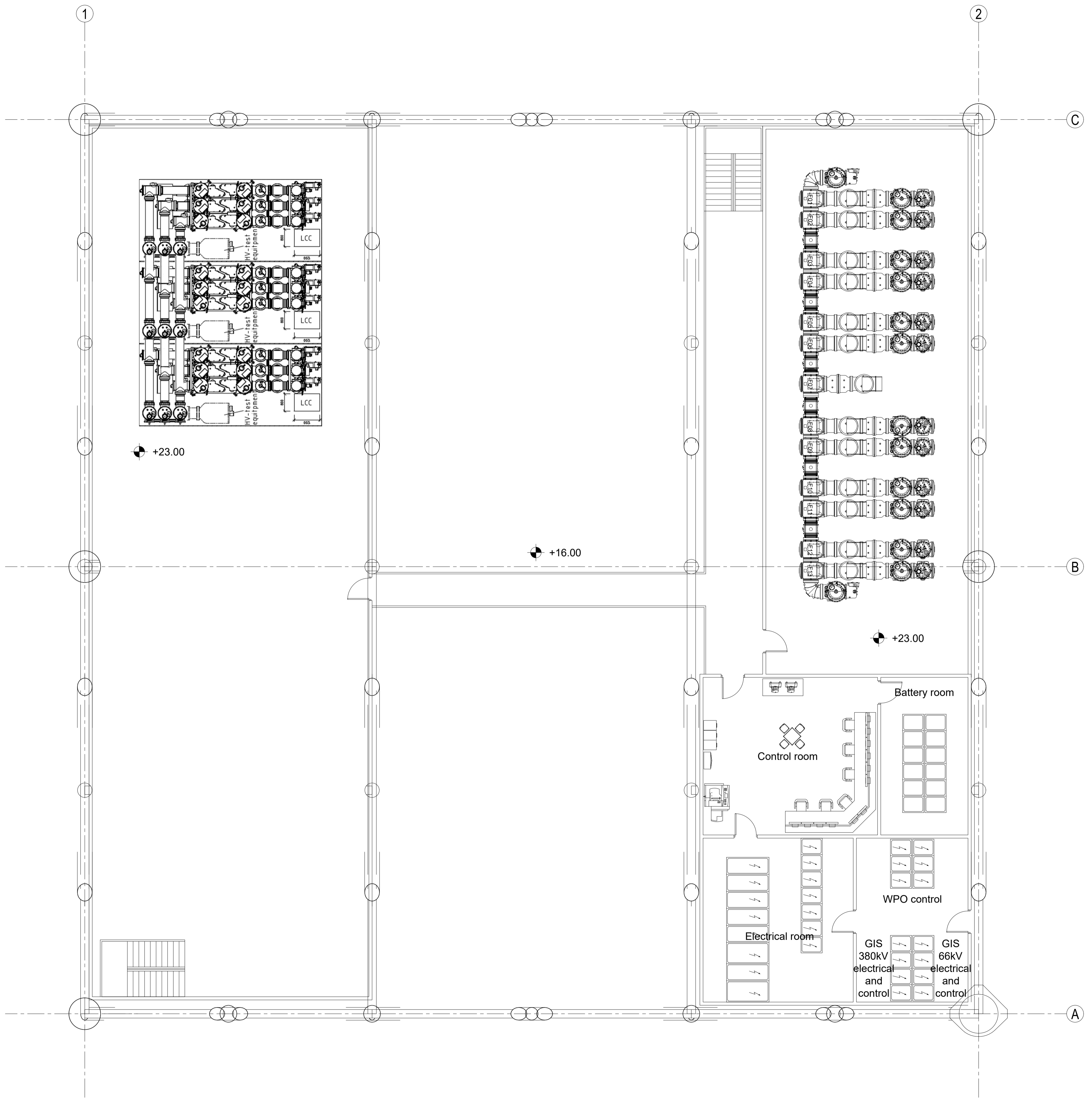

PLAN AT EL. +23.00

File name: 12085-LDL-002-00_Layout Substation 2.dwg

Rev.	Date	Created by	Checked by	Approved by	Description
00	30/06/2023	MC	MT	MT	First issue
Customer		Project		Customer Document ID	
Barium Bay Srl		Barium Bay Offshore Substations		-	
Project ID		Replacing		Based on	
12085		-		-	
Responsible Department		Created by		Checked by	
-		Matteo Corbetta		Mauro Tavola	
Title		Document ID		Page	
Layout Substation 2		12085-LDL-002		3/6	
KKS-NO: -		Rev.		Rel. Date	
-		00		30/06/2023	

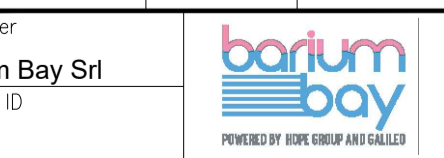

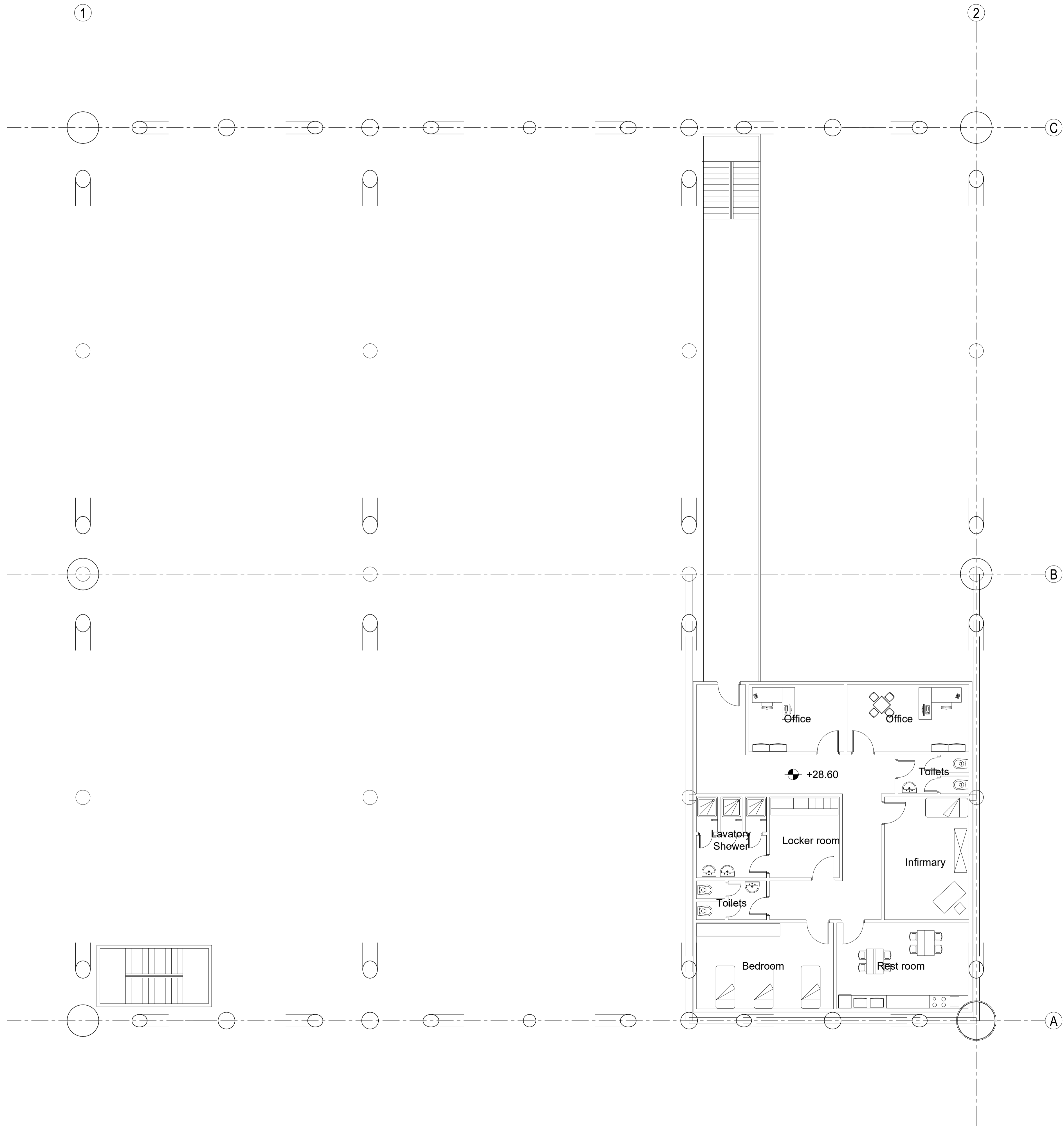

PLAN AT EL. +28.60

File name: 12085-LDL-002-00_Layout Substation 2.dwg

Rev.	Date	Created by	Checked by	Approved by	Description
00	30/06/2023	MC	MT	MT	First issue
Customer		Project			Customer Document ID
Barium Bay Srl		Barium Bay Offshore Substations			-
Project ID		Replacing	Based on	Scale	Format
12085		-	-	1:XX	A1
Responsible Department		Created by	Checked by	Approved by	
-		Matteo Corbetta	Mauro Tavola	Mauro Tavola	
Title		Document ID			
Layout Substation 2		12085-LDL-002			
KKS-NO.: -		Rev.	Rel. Date	Page	
		00	30/06/2023	4/6	



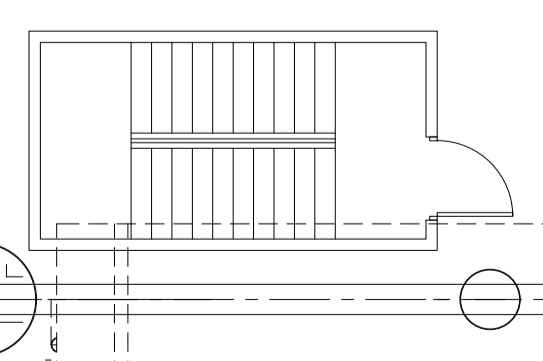
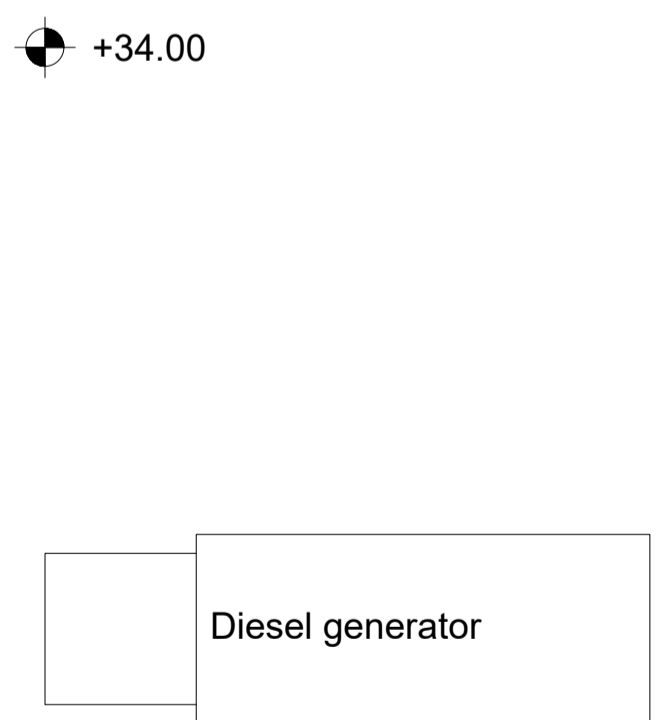
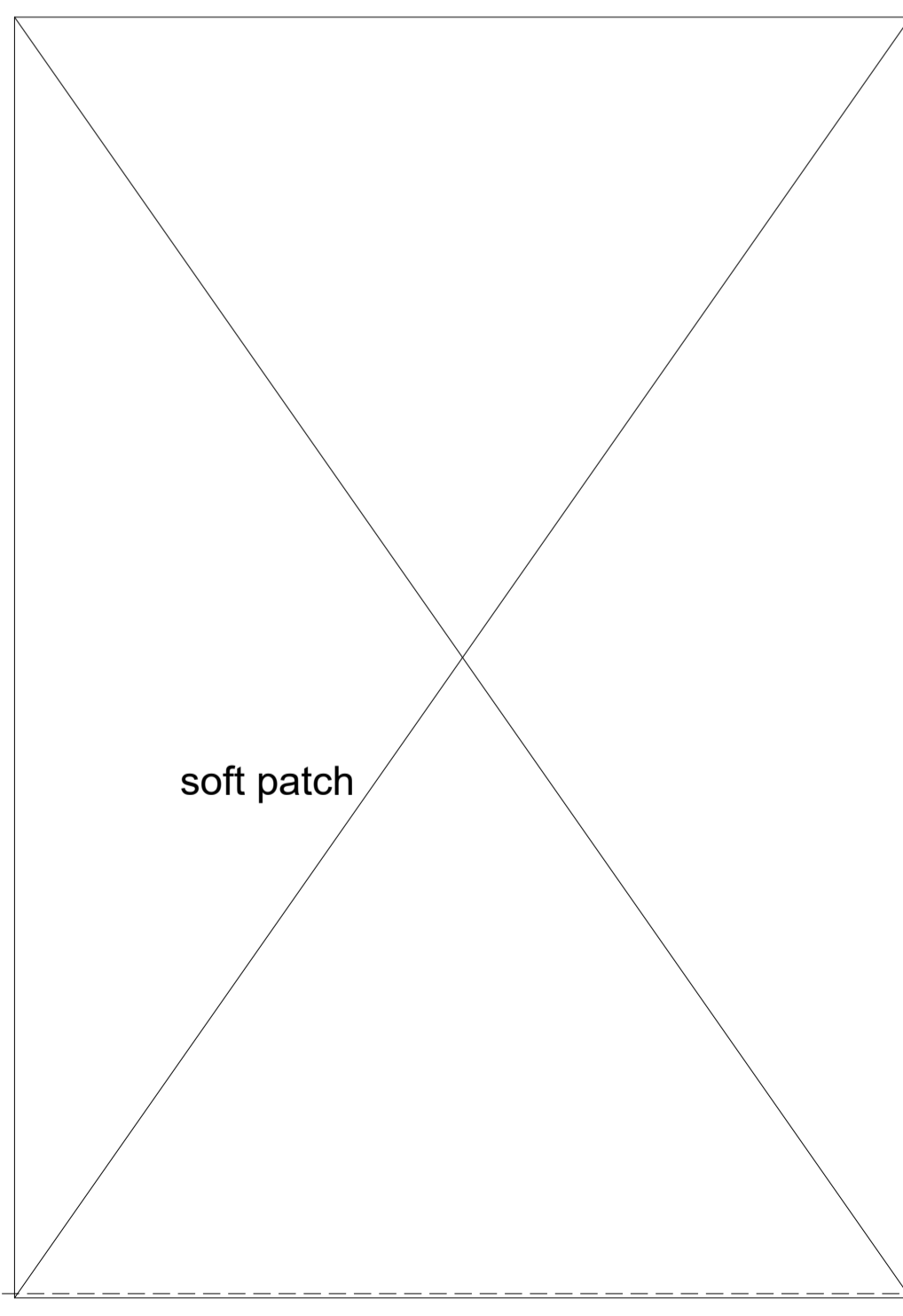
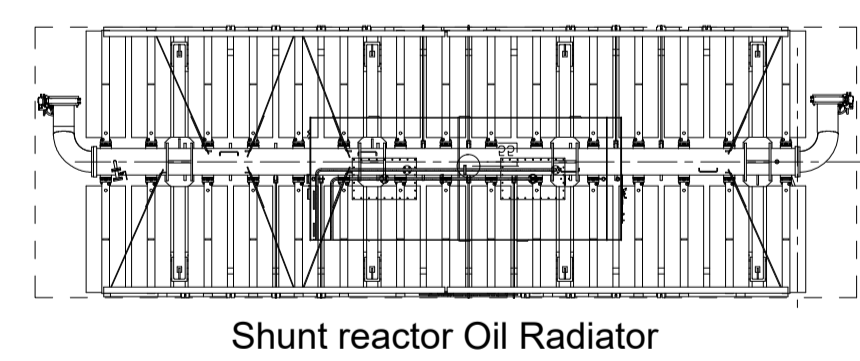
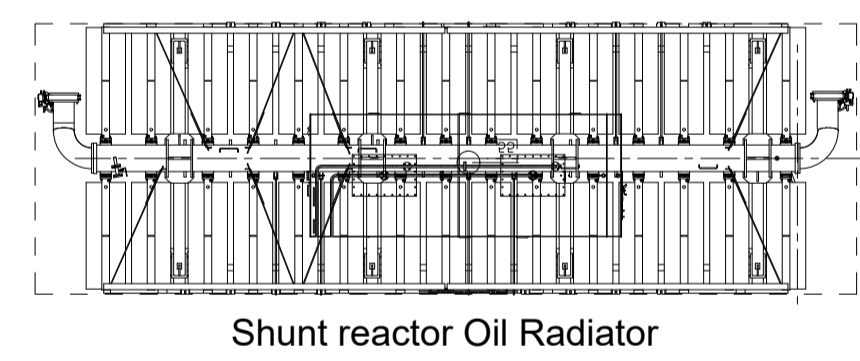
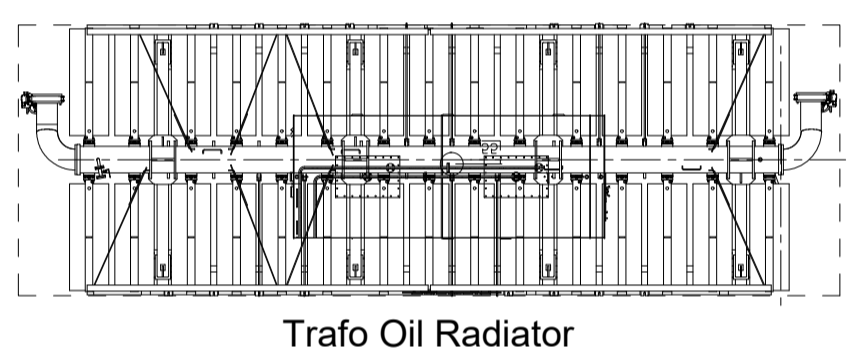
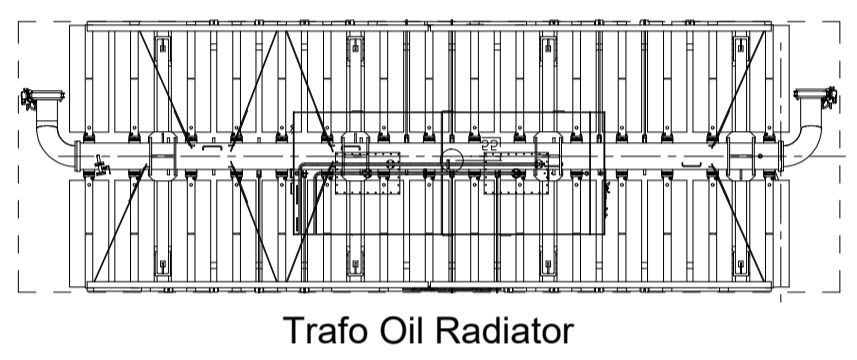
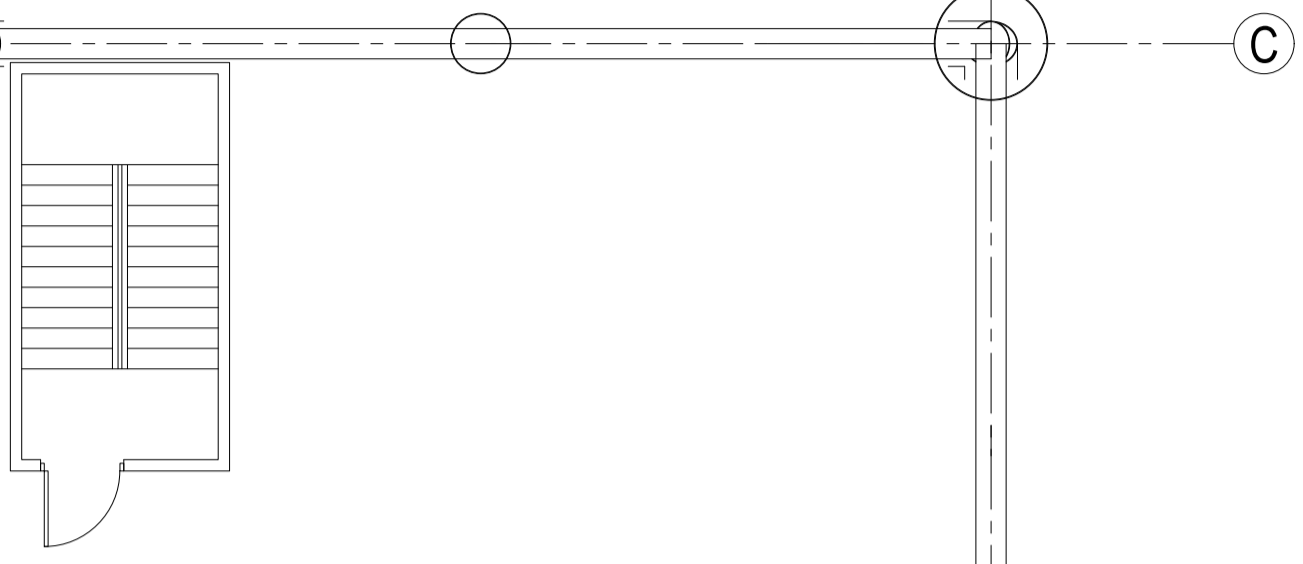
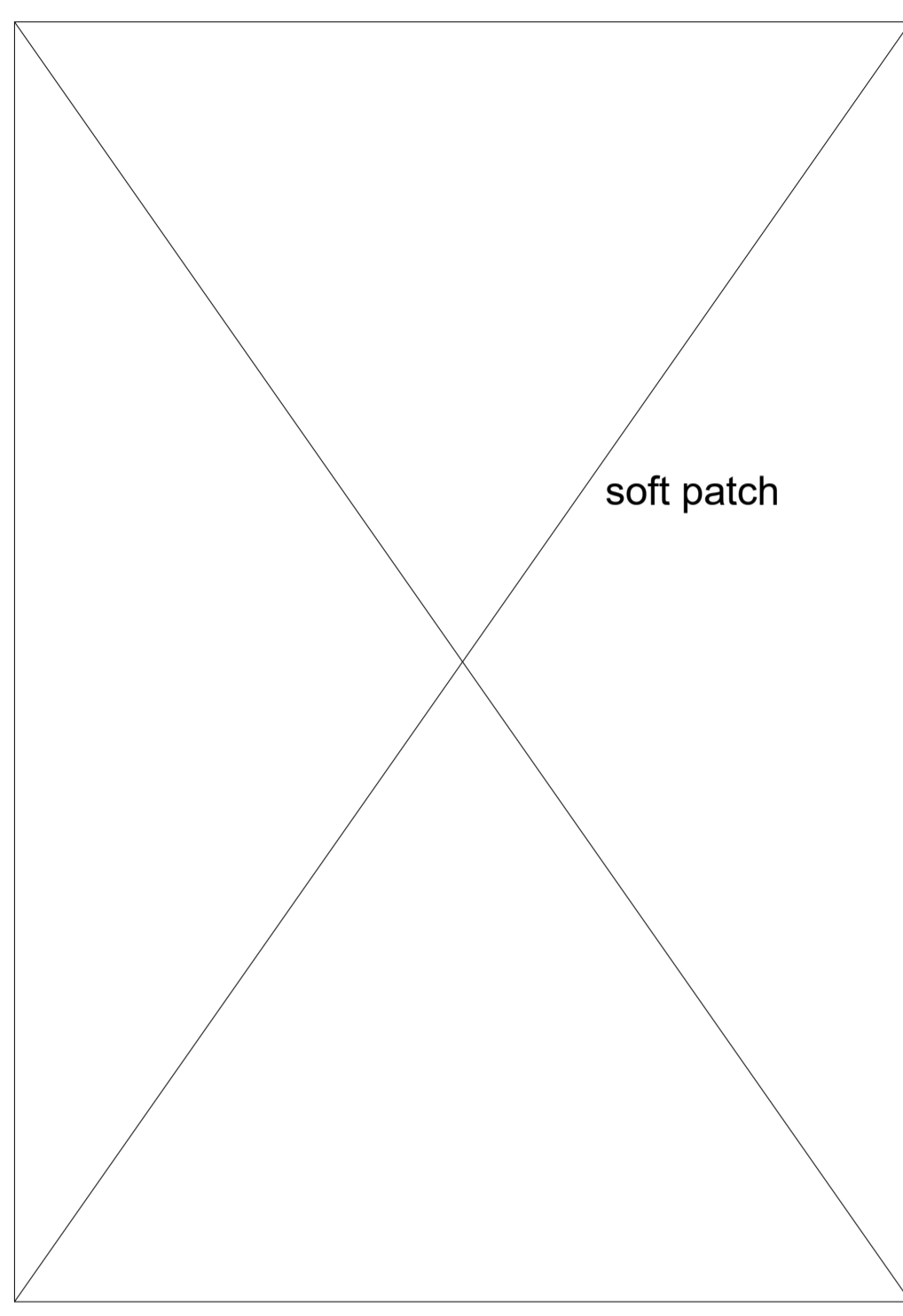
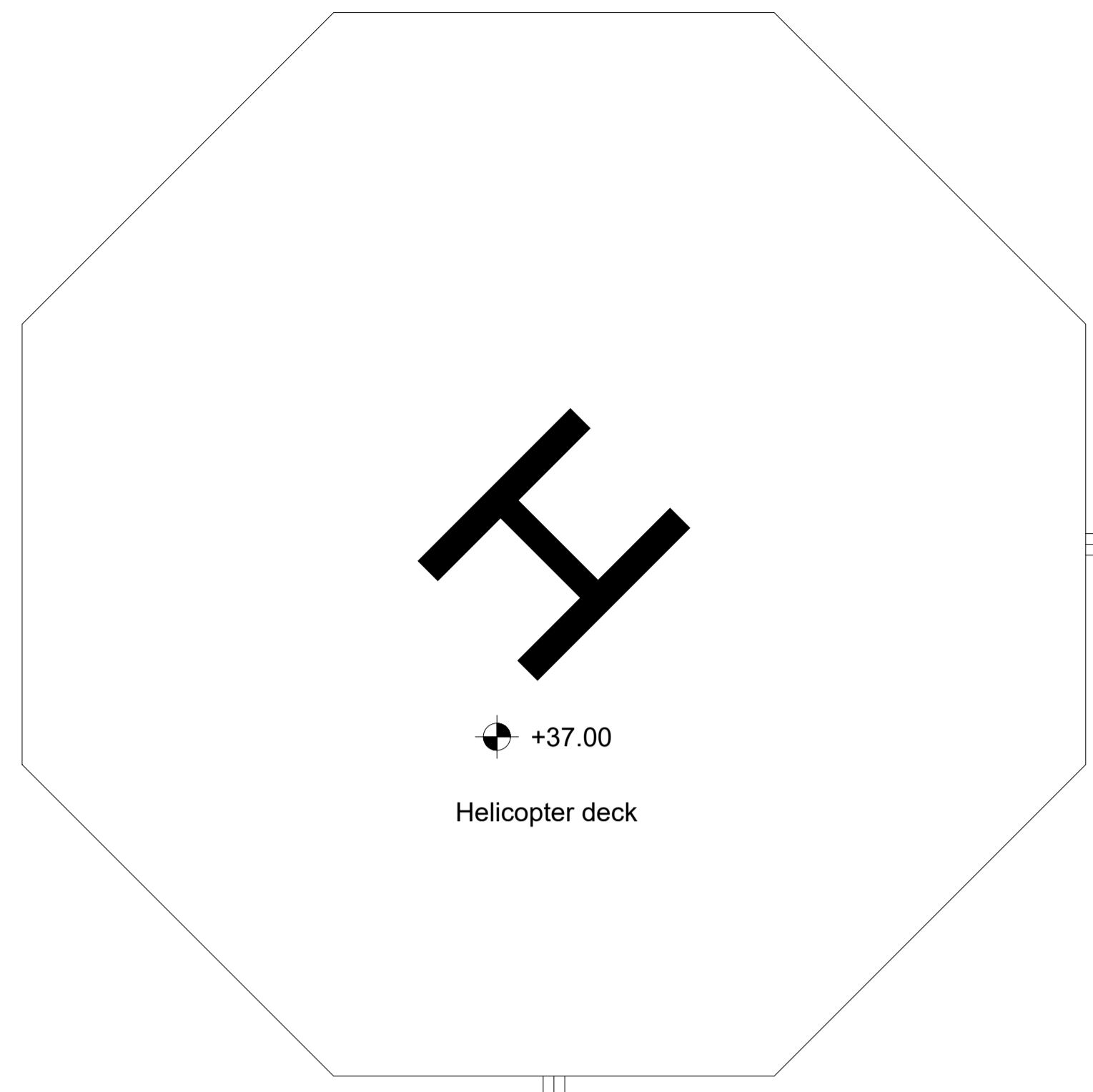

PLAN AT EL. +34.00

File name: 12085-LDL-002-00_Layout Substation 2.dwg

Rev.	Date	Created by	Checked by	Approved by	Description
00	30/06/2023	MC	MT	MT	First issue
Customer		Project		Customer Document ID	
Barium Bay Srl		Barium Bay Offshore Substations		-	
Project ID		Replacing		Based on	
12085		-		-	
Responsible Department		Created by		Checked by	
-		Matteo Corbetta		Mauro Tavola	
Title		Document ID		Approved by	
Layout Substation 2		12085-LDL-002		Mauro Tavola	
KKS-NO: -		Rev.		Page	
-		00		30/06/2023	
-		-		5/6	



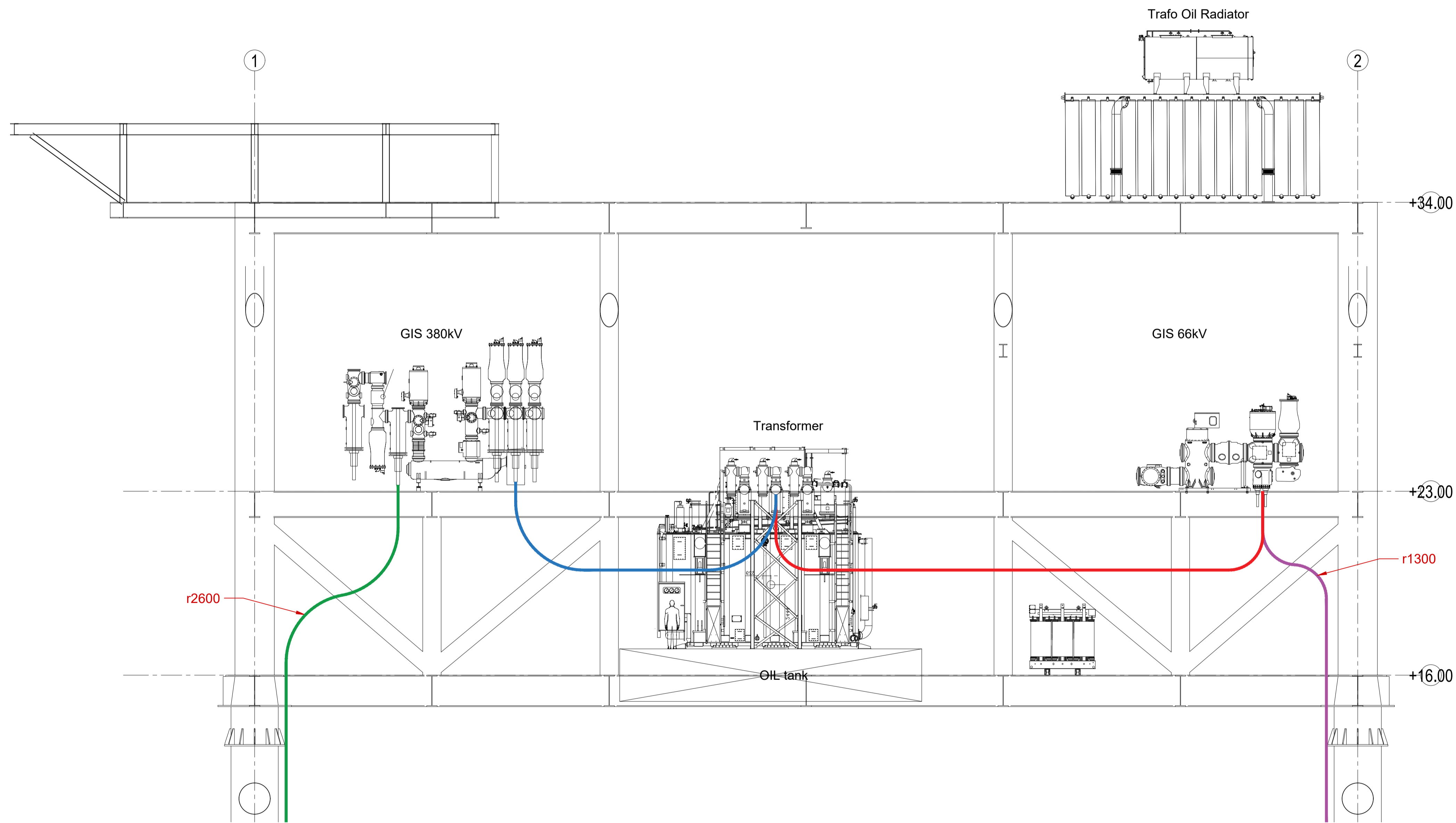

SECTION

File name: 12085-LDL-002-00_Layout Substation 2.dwg

00	30/06/2023	MC	MT	MT	First issue
Rev.	Date	Created by	Checked by	Approved by	Description
Customer		Project			Customer Document ID
Barium Bay Srl		Barium Bay Offshore Substations			-
Project ID		Replacing		Based on	Scale
12085		-		-	1:XX
Responsible Department		Created by		Checked by	Approved by
-		Matteo Corbetta		Mauro Tavola	Mauro Tavola
Title		Document ID		Document ID	
Layout Substation 2		12085-LDL-002		12085-LDL-002	
KKS-NO: -		Rev.	Rel. Date	Page	
-		00	30/06/2023	6/6	

