



LEGENDA PIANTA CHIAVE
 PIAZZOLA CON ROTORE EDICOLA
 PISTA DI ACCESSO ALLA PIAZZOLA
 VIABILITA' ESISTENTE DA ADEGUARE

NOTE:
- PER LE UBICAZIONI E LE DIMENSIONI RELATIVE ALLE OPERE IDRAULICHE SI VEDANO LE TAVOLE SPECIFICHE.

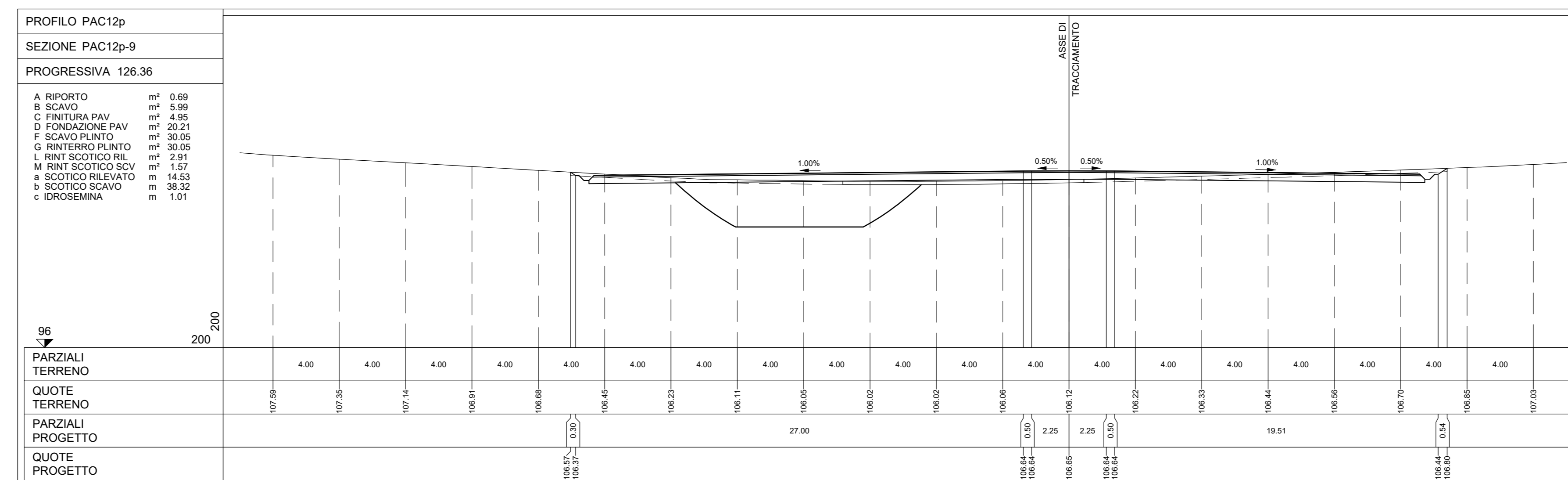
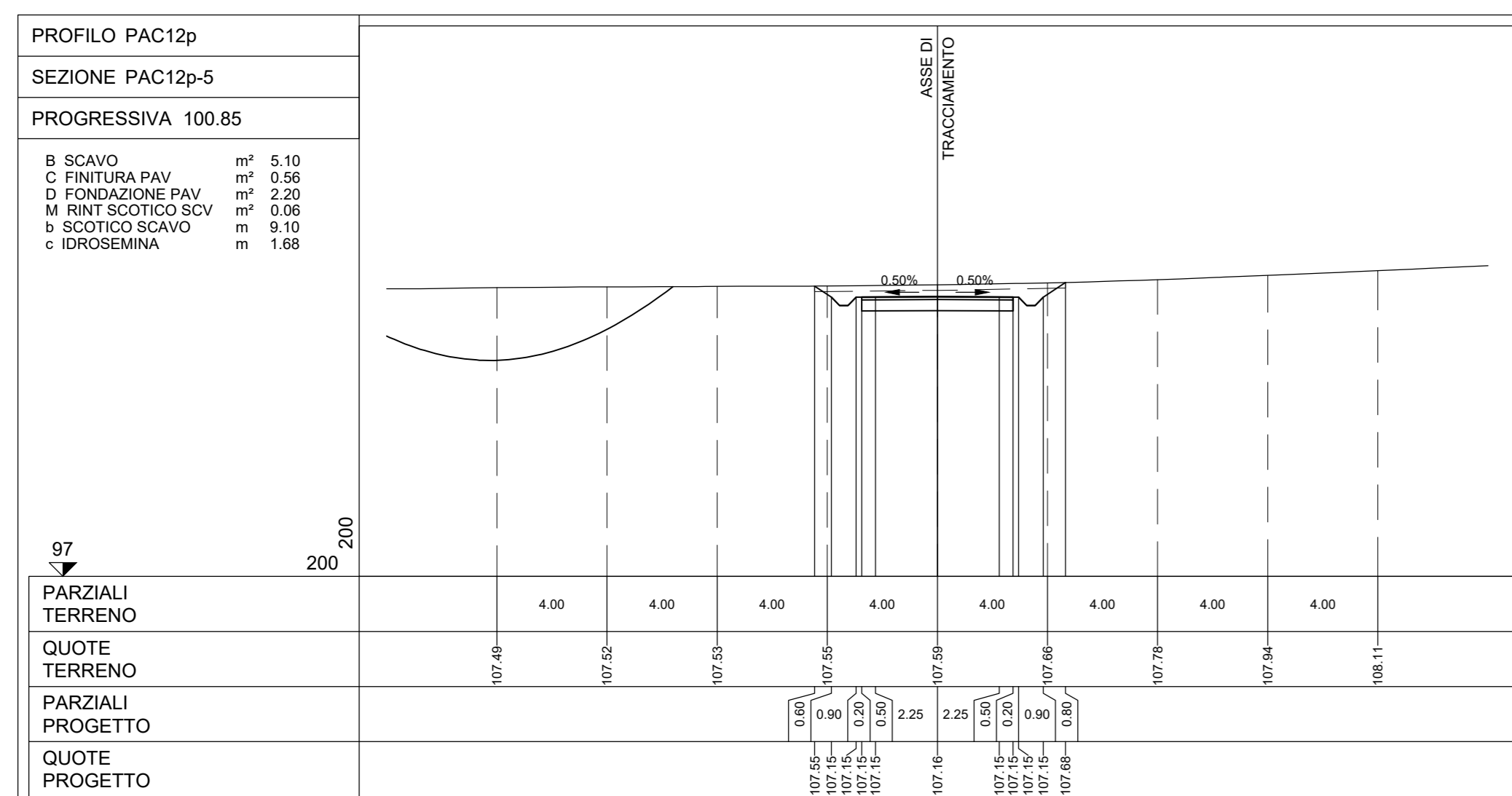
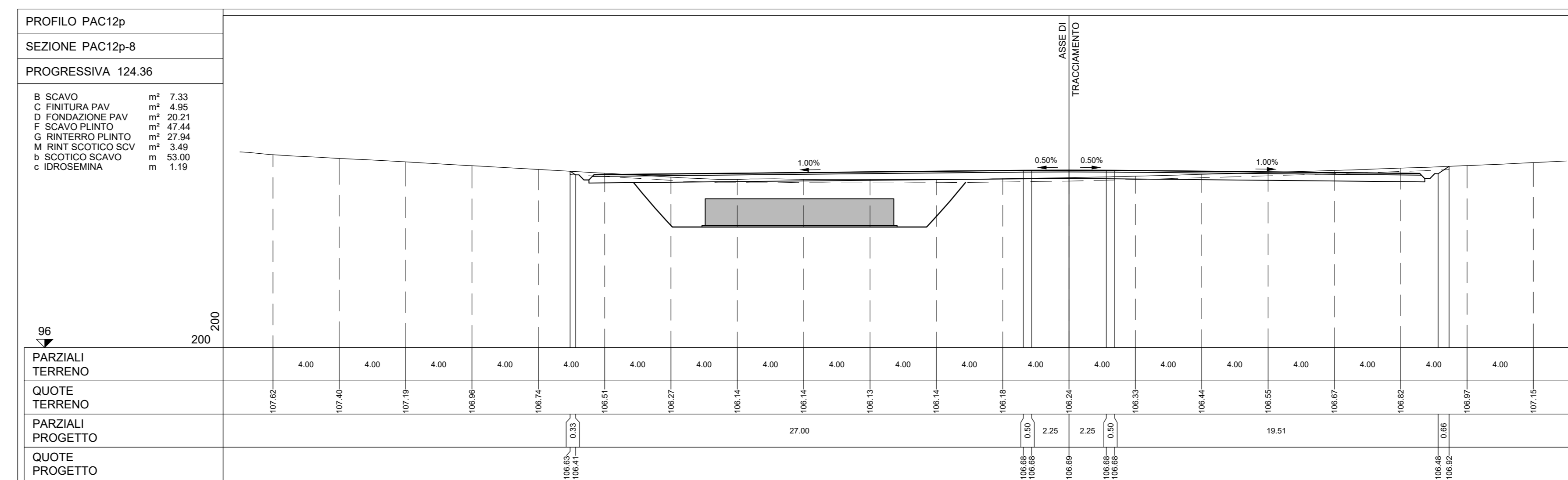
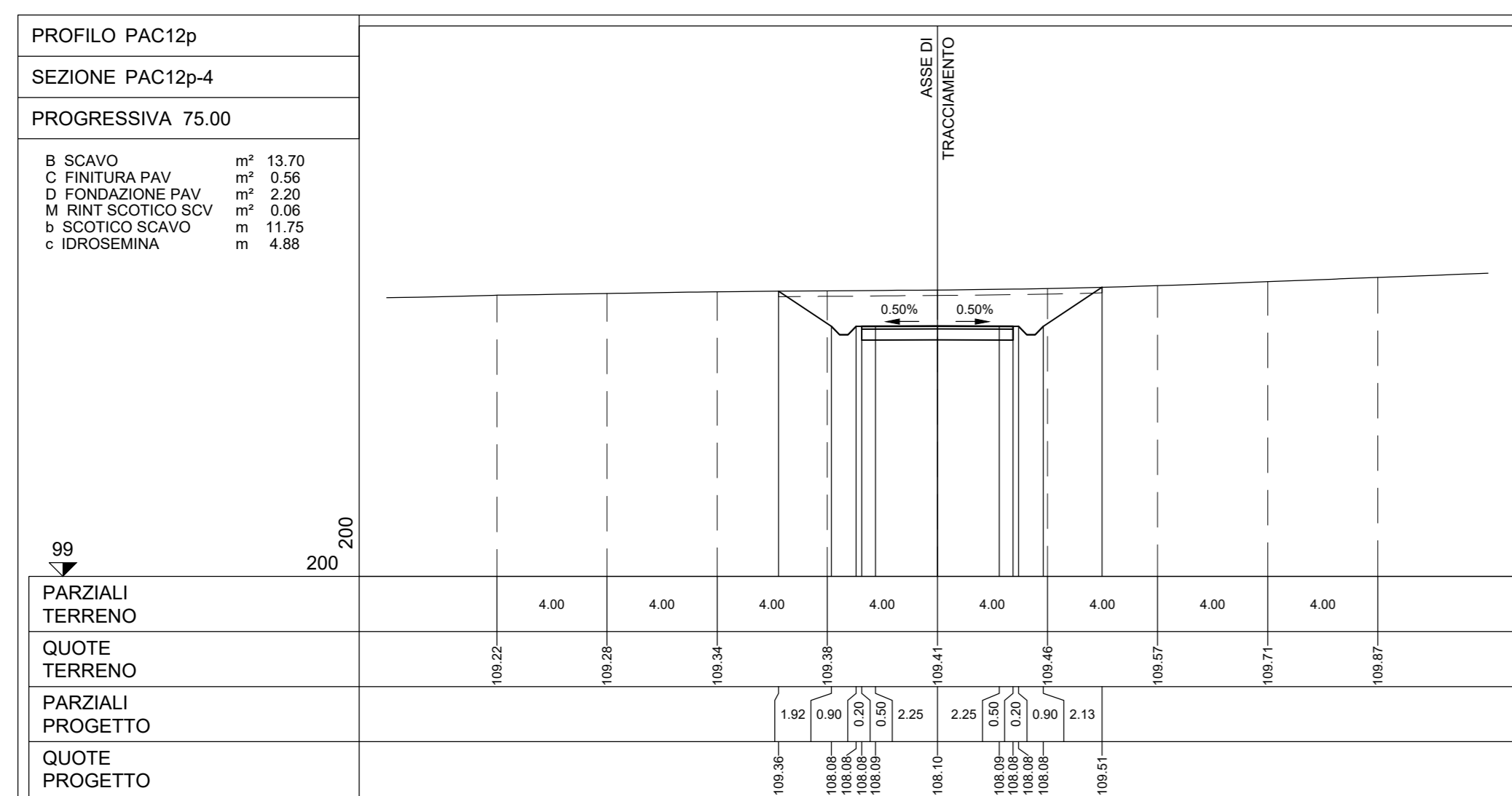
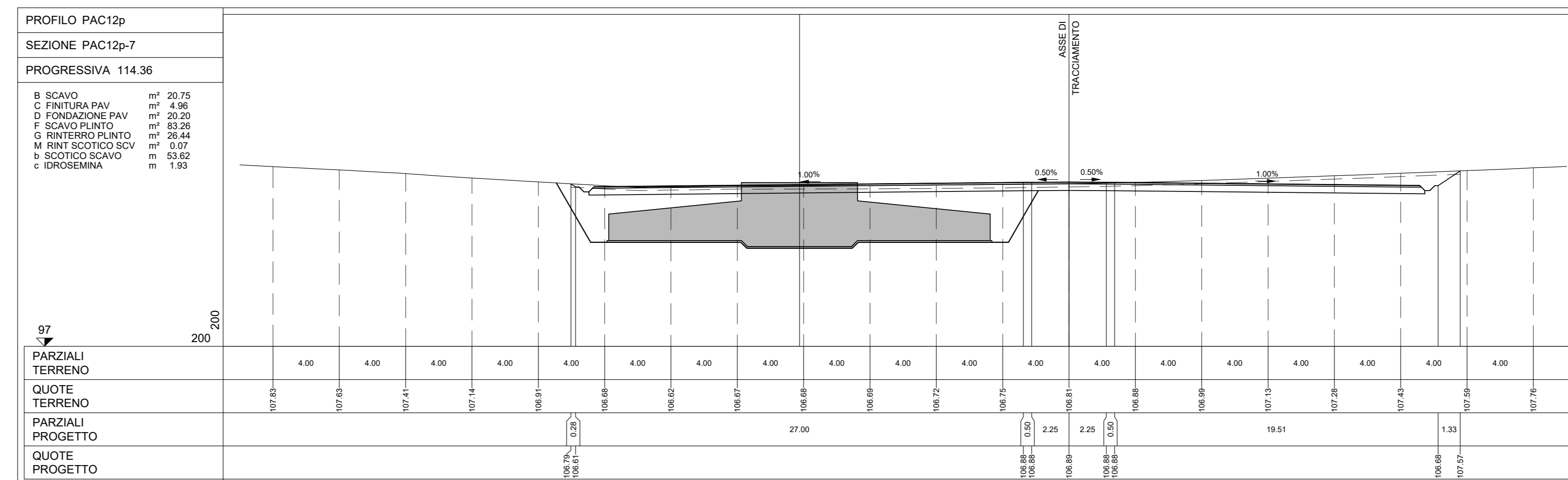
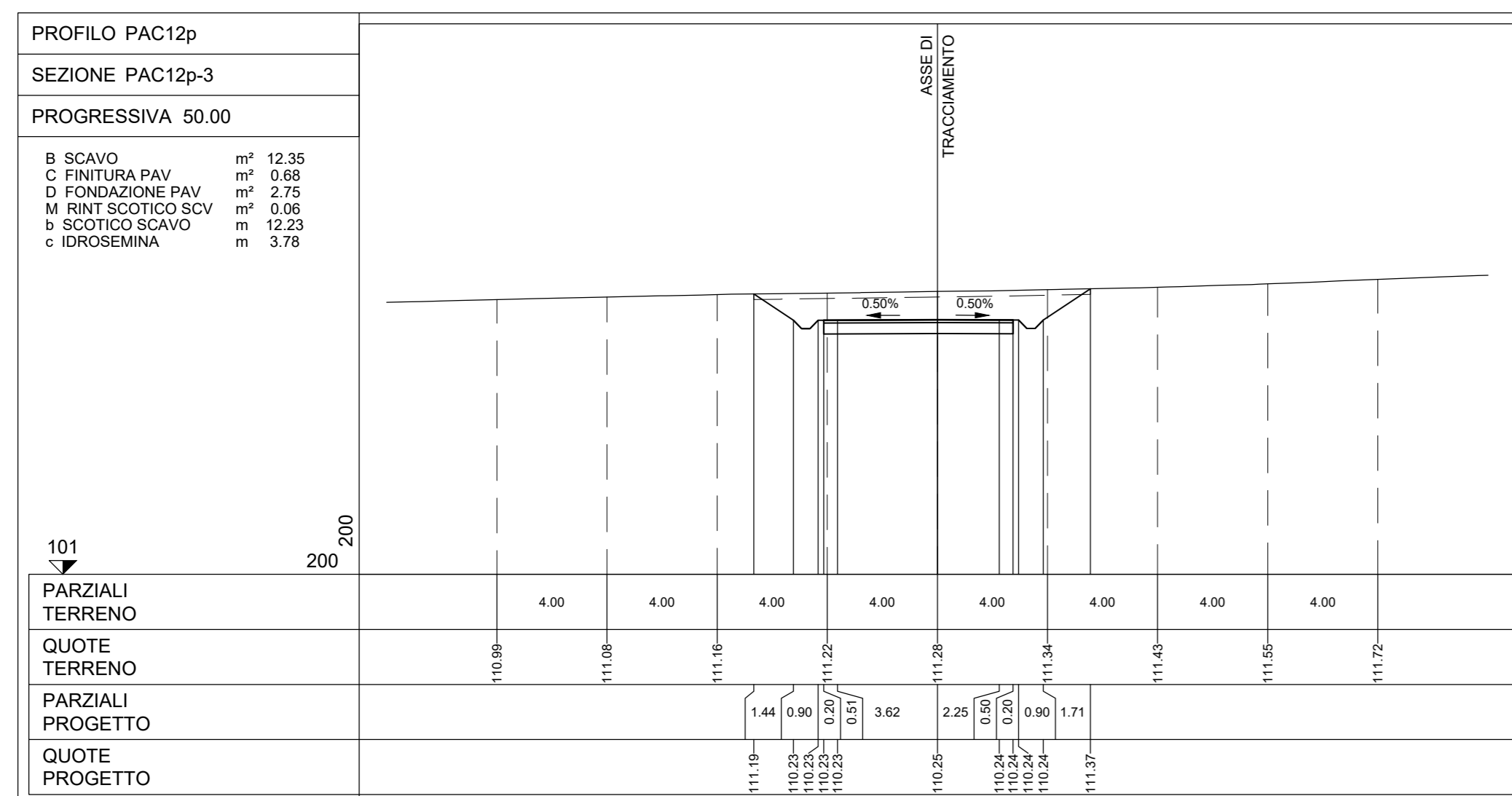
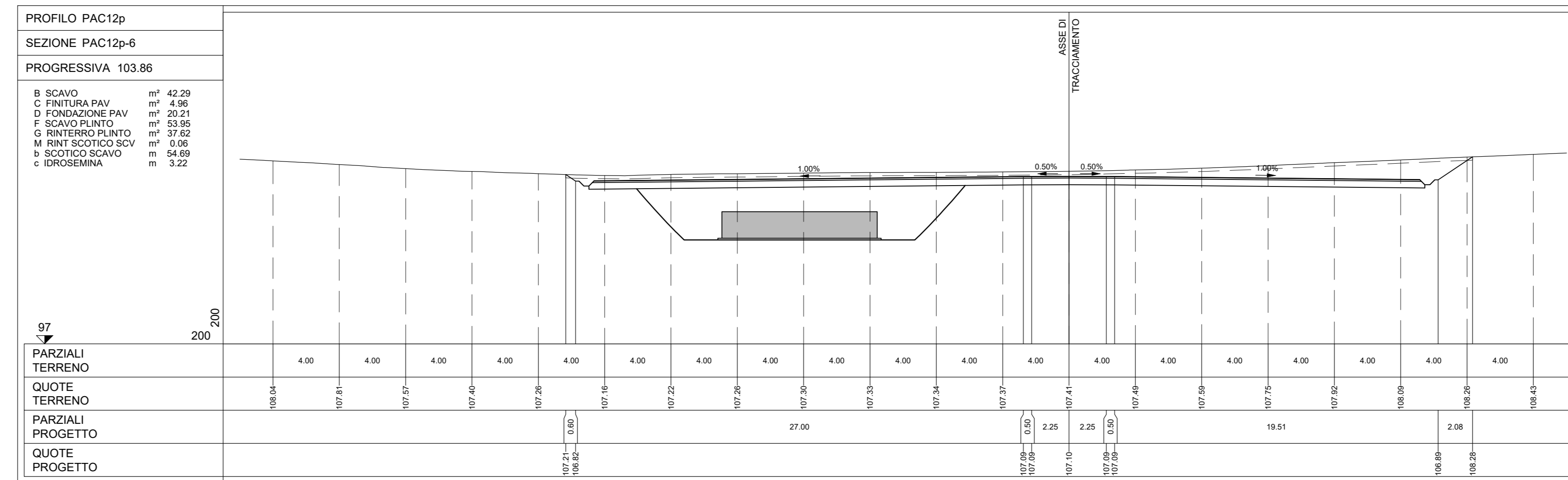
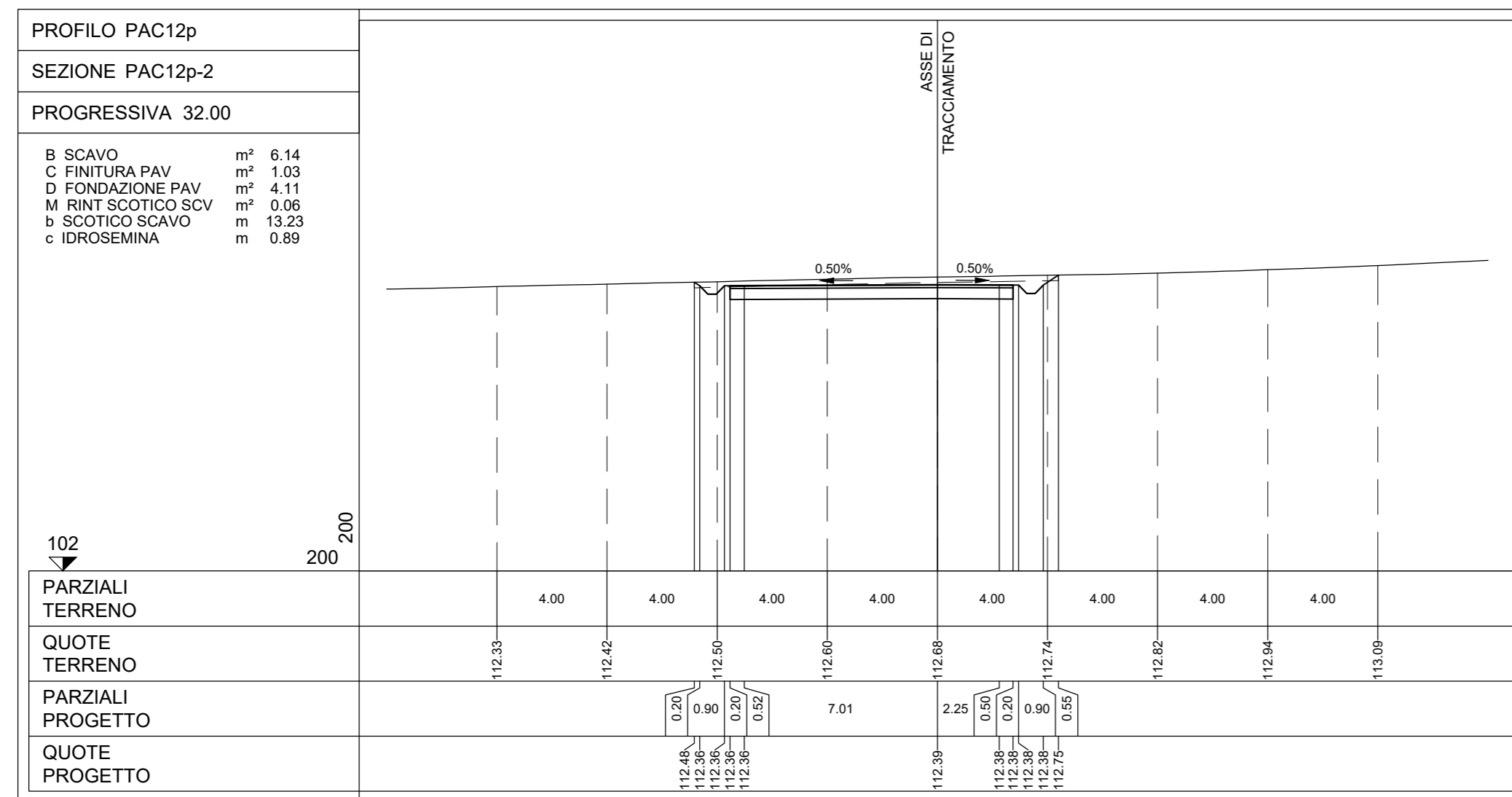
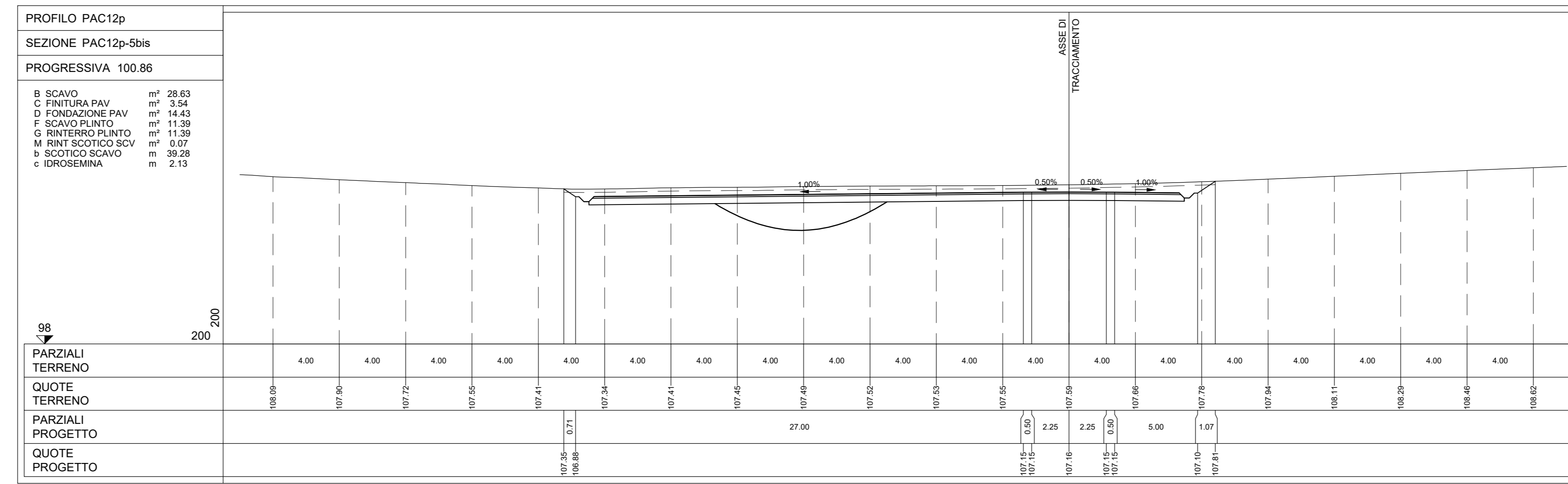
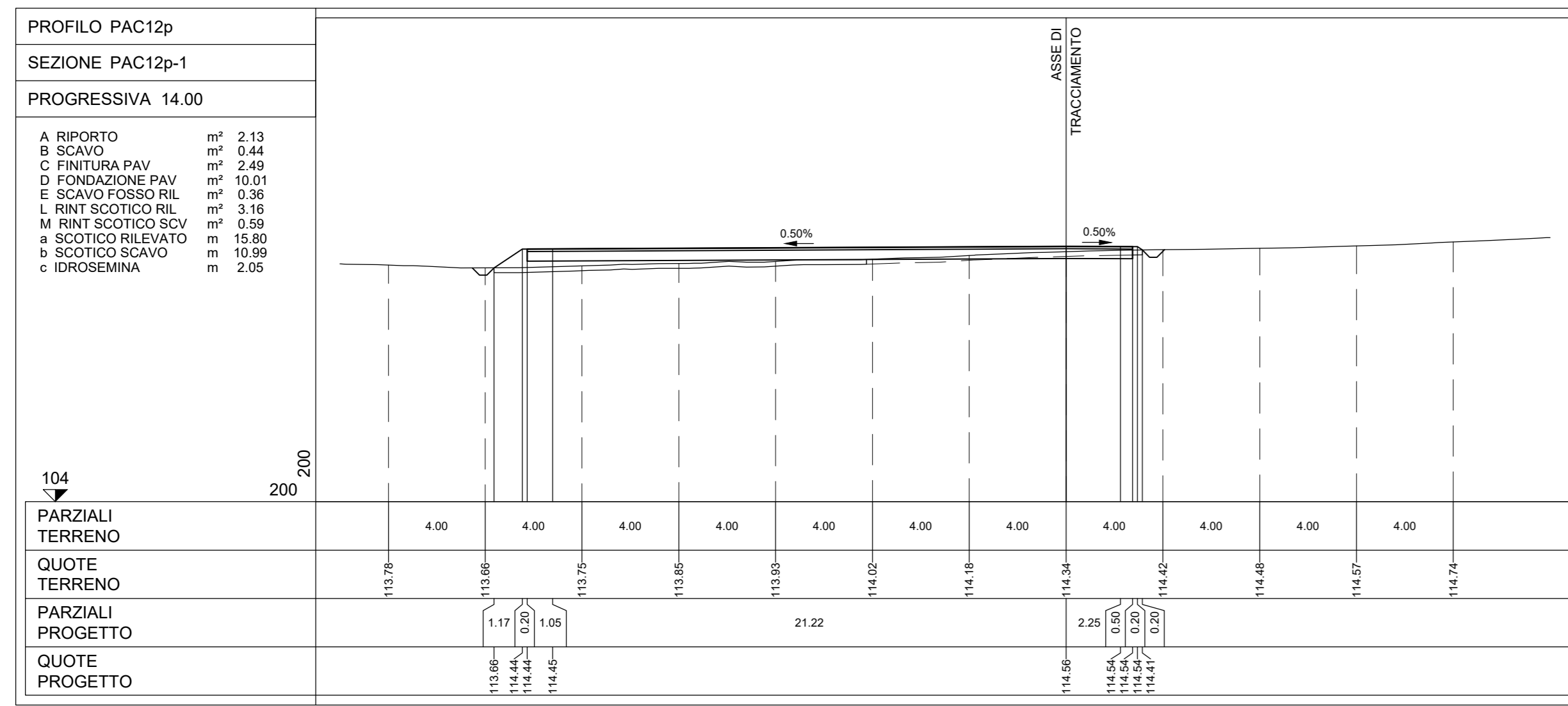

Rev.	Descrizione	%	Cl.	Cl.	07/2023
REV. 01	SECONDA				

Montana
Paceco S.R.L.
Via Angelo Fumagalli 6, 20143 MILANO

Progetto: ING. LAURA CONTI
scritta all'Ordine degli Ingegneri della Provincia di Pavia n. 1728

Oggetto: IMPIANTO EDICO DA 105 MW
COMUNE DI PACECO (TP), MISUSCUMI (TP) e TRAPANI (TP)

Tavola: PAC12 - SEZIONI TRASVERSALI PIAZZOLA
n. Tav. T12.12a

N. in. 2995_5531_PAC_PTE_T12.12_REV.01_PAC12-SEZIONI TRASVERSALI PIAZZOLA
E' VIETATA LA RIPRODUZIONE DI QUESTO DOCUMENTO SENZA PREVENUTA AUTORIZZAZIONE SCRITTA DELLA MONTANA SPA

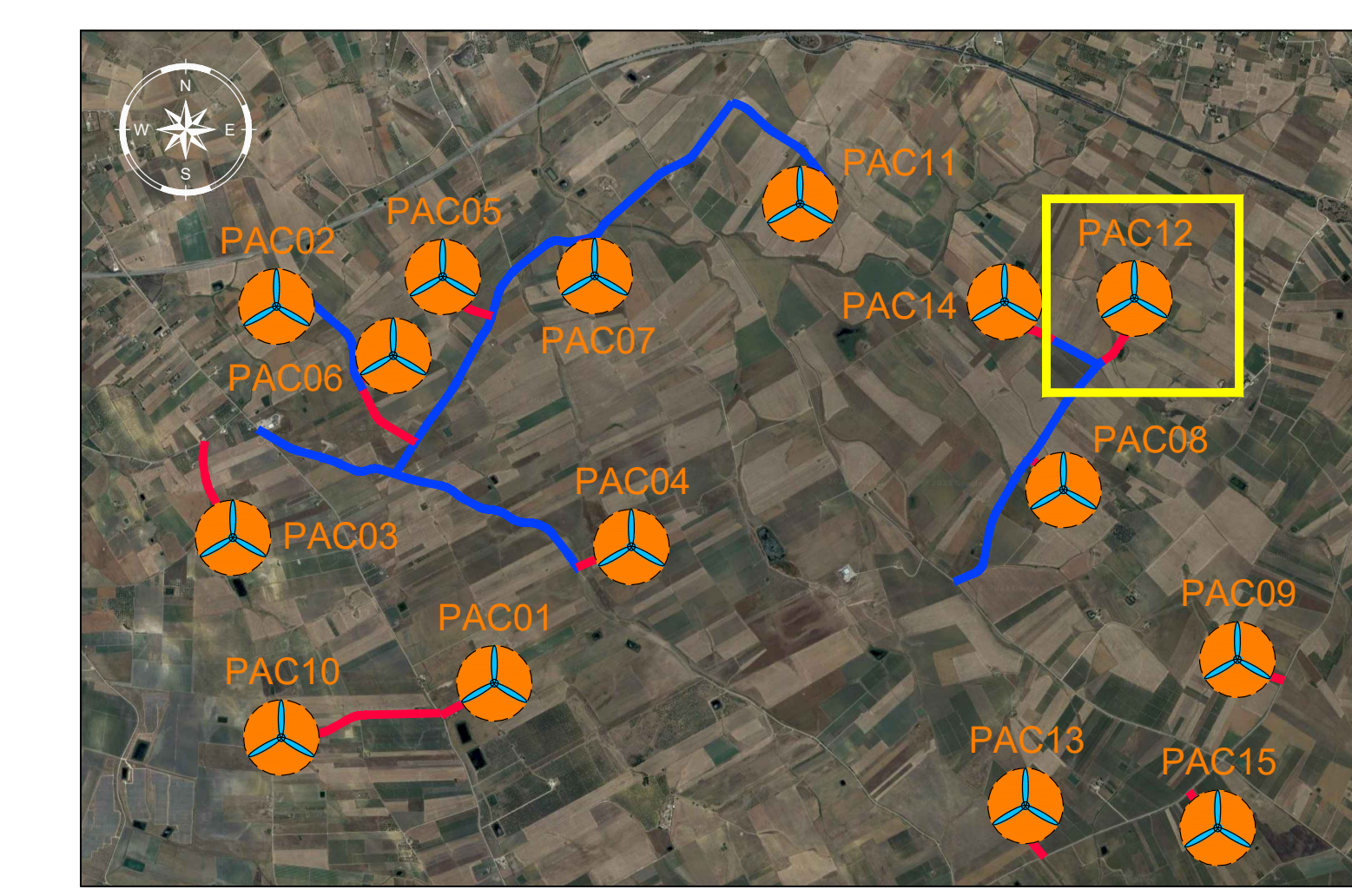
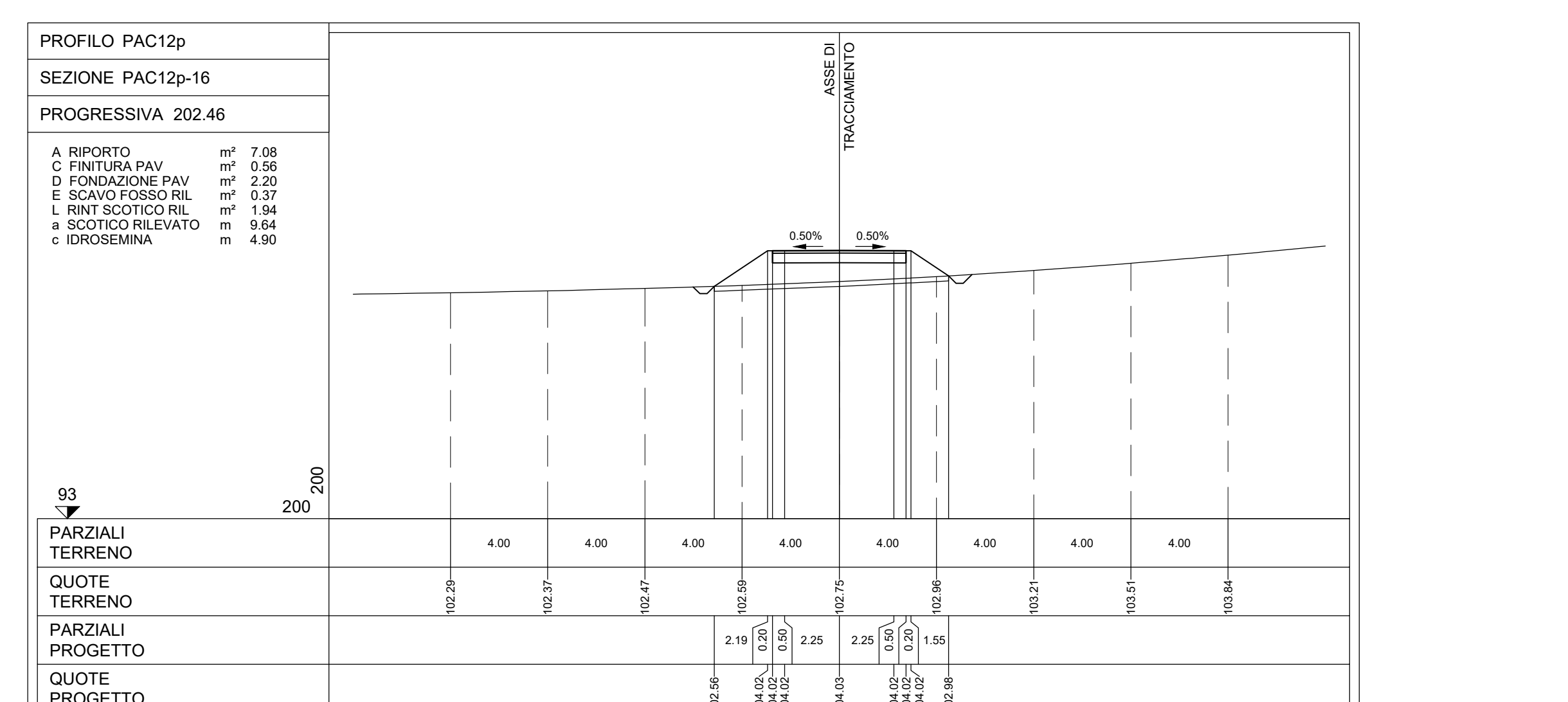
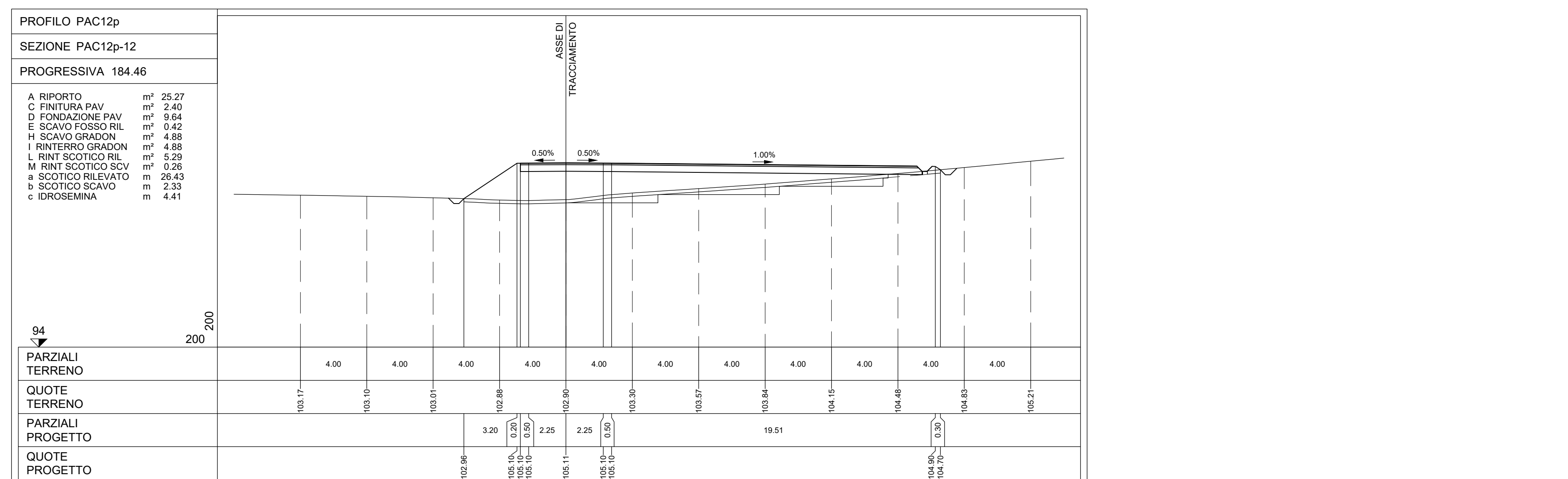
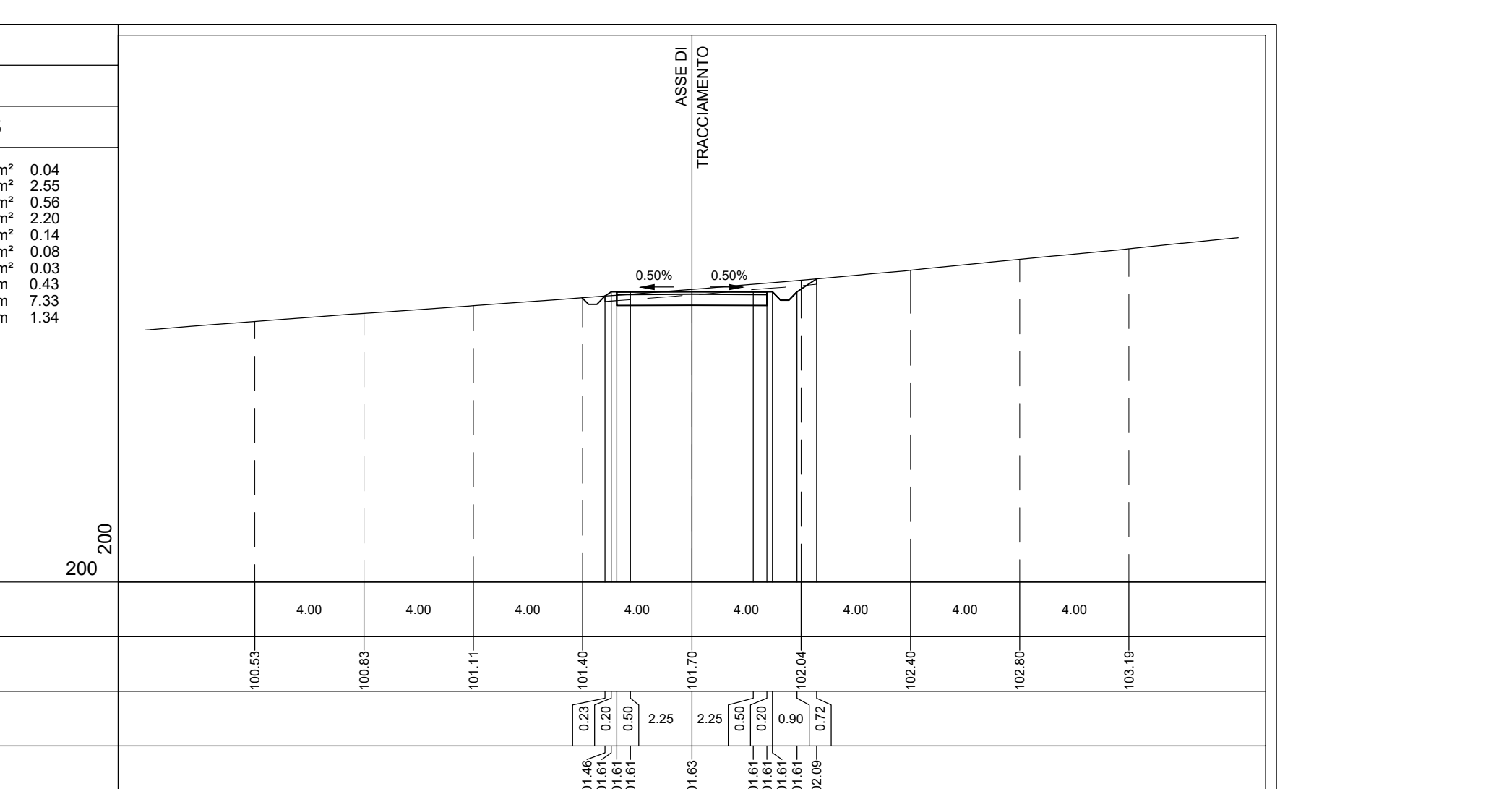
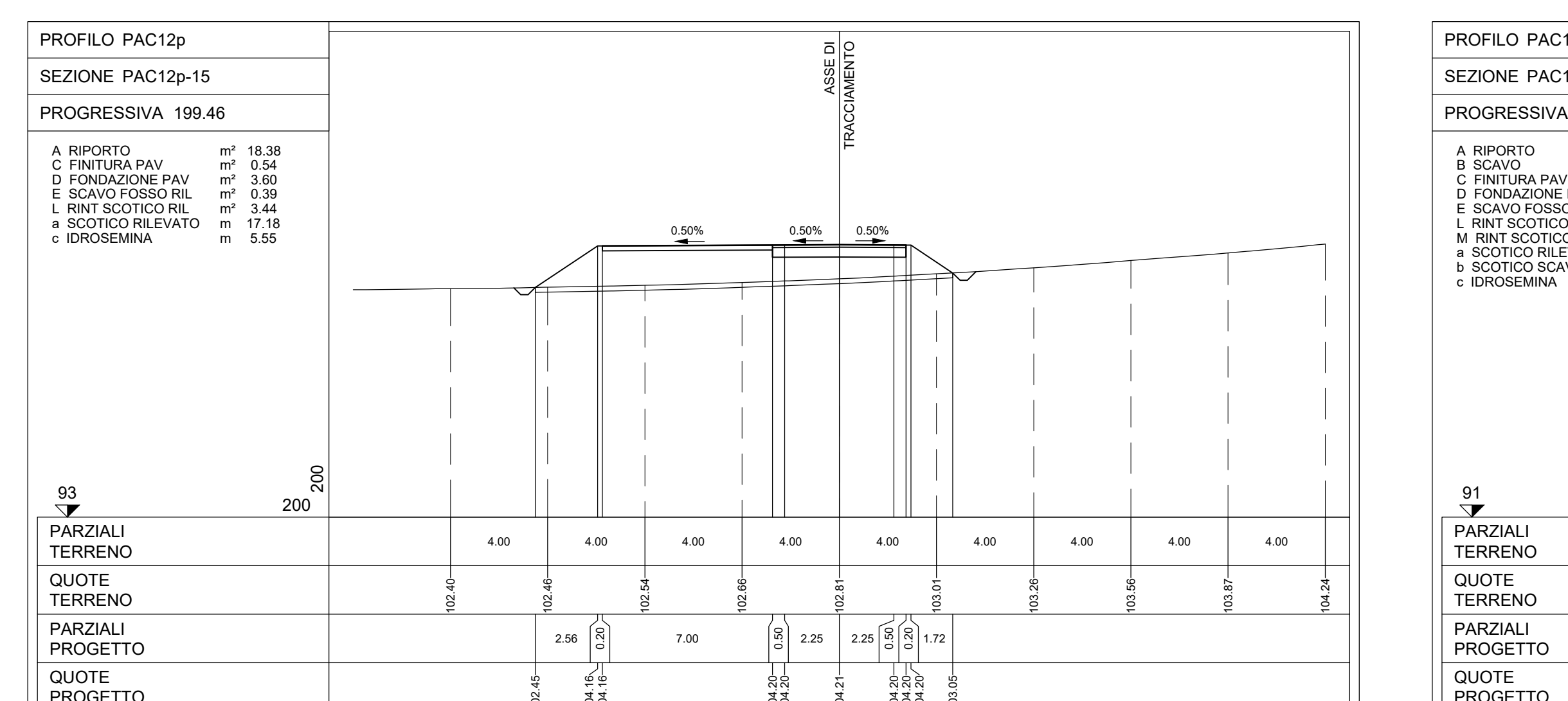
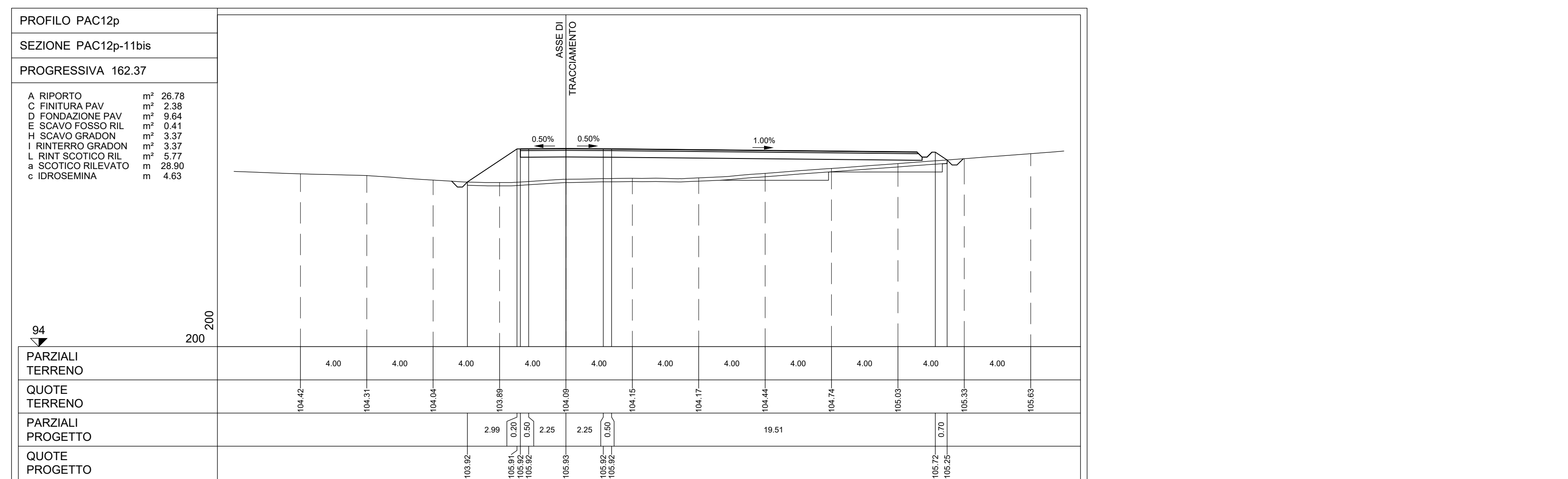
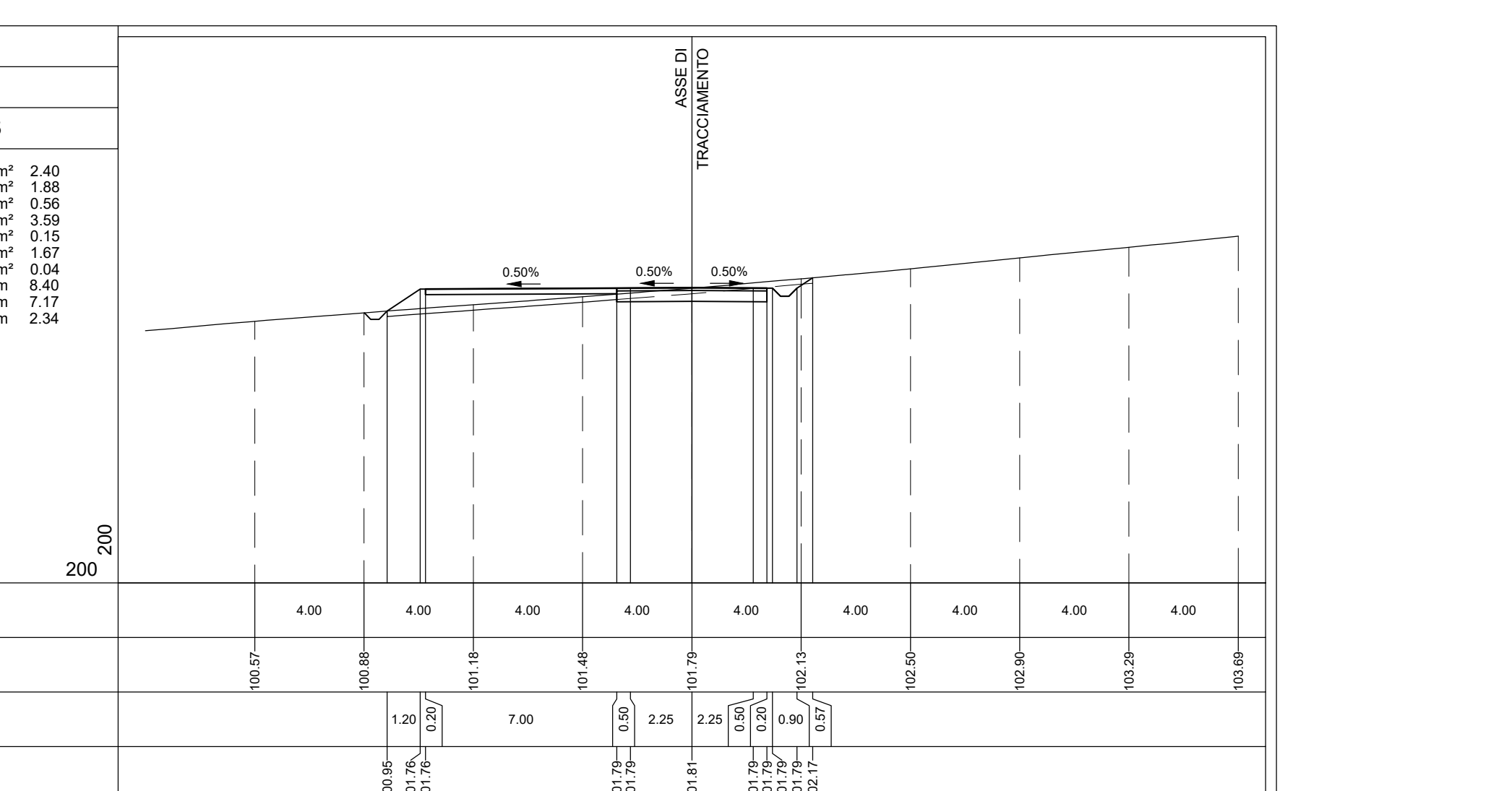
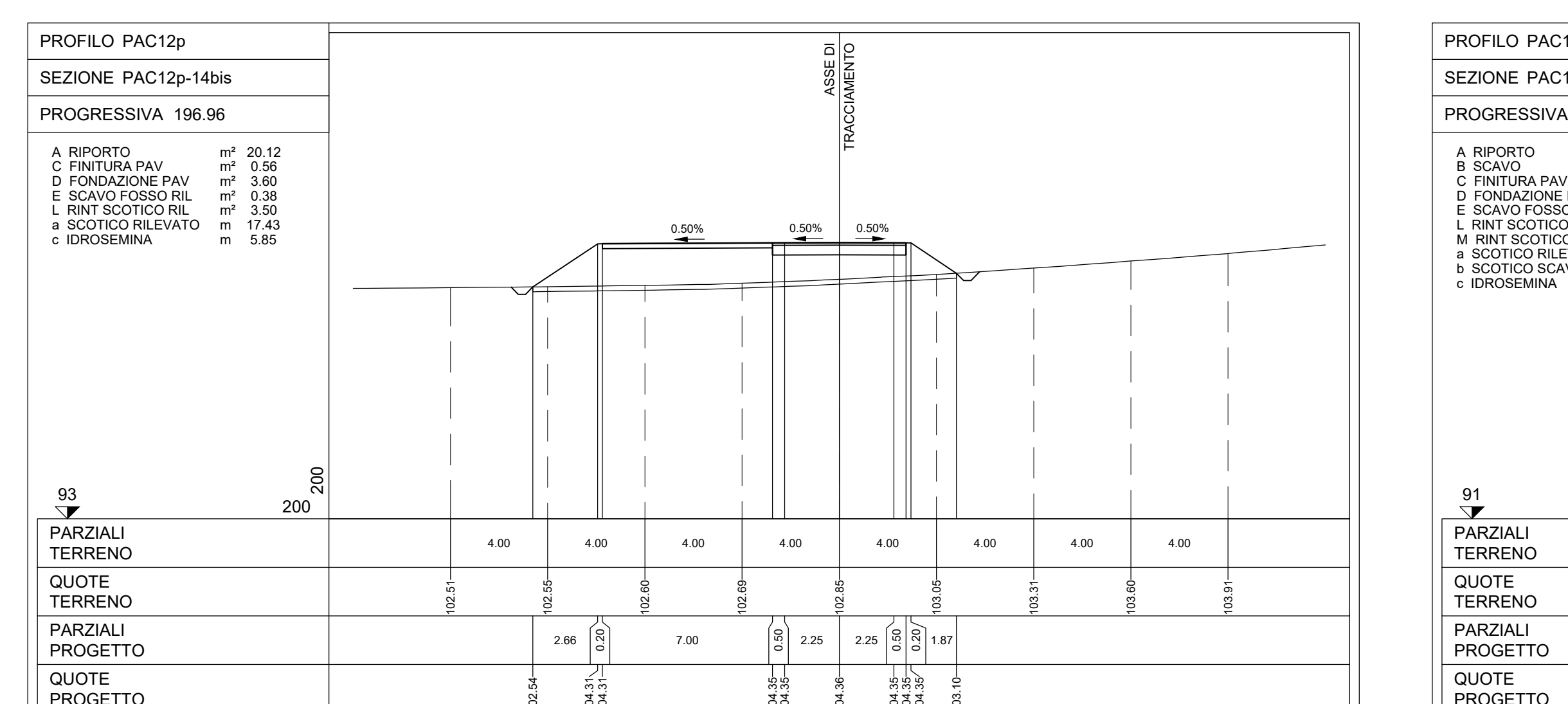
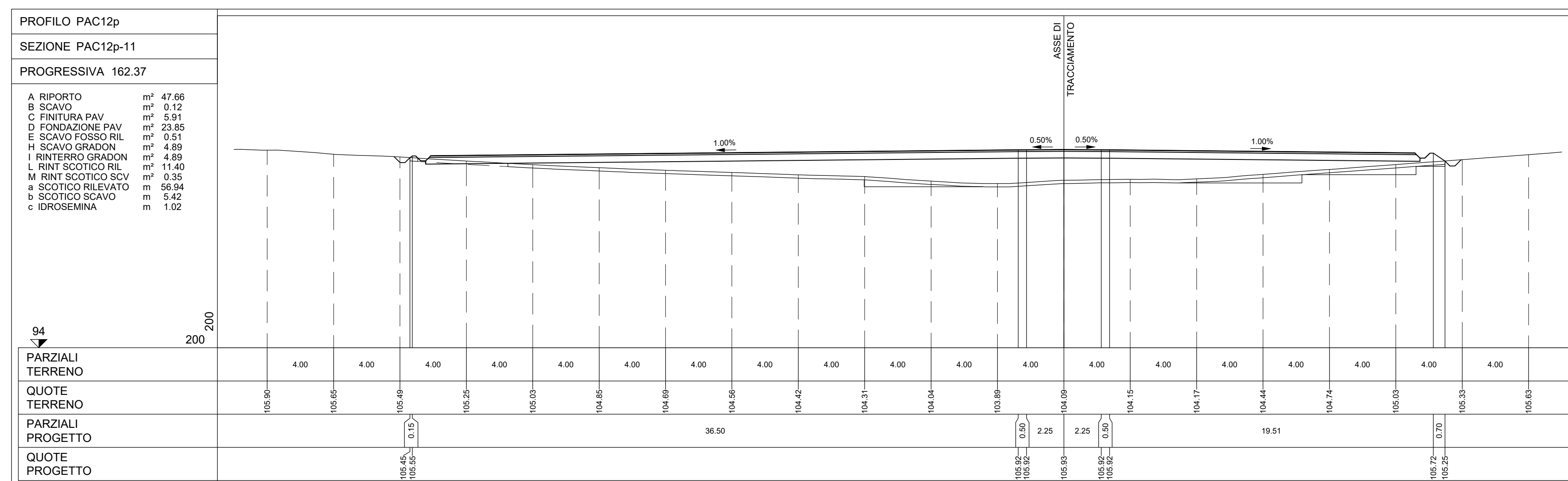
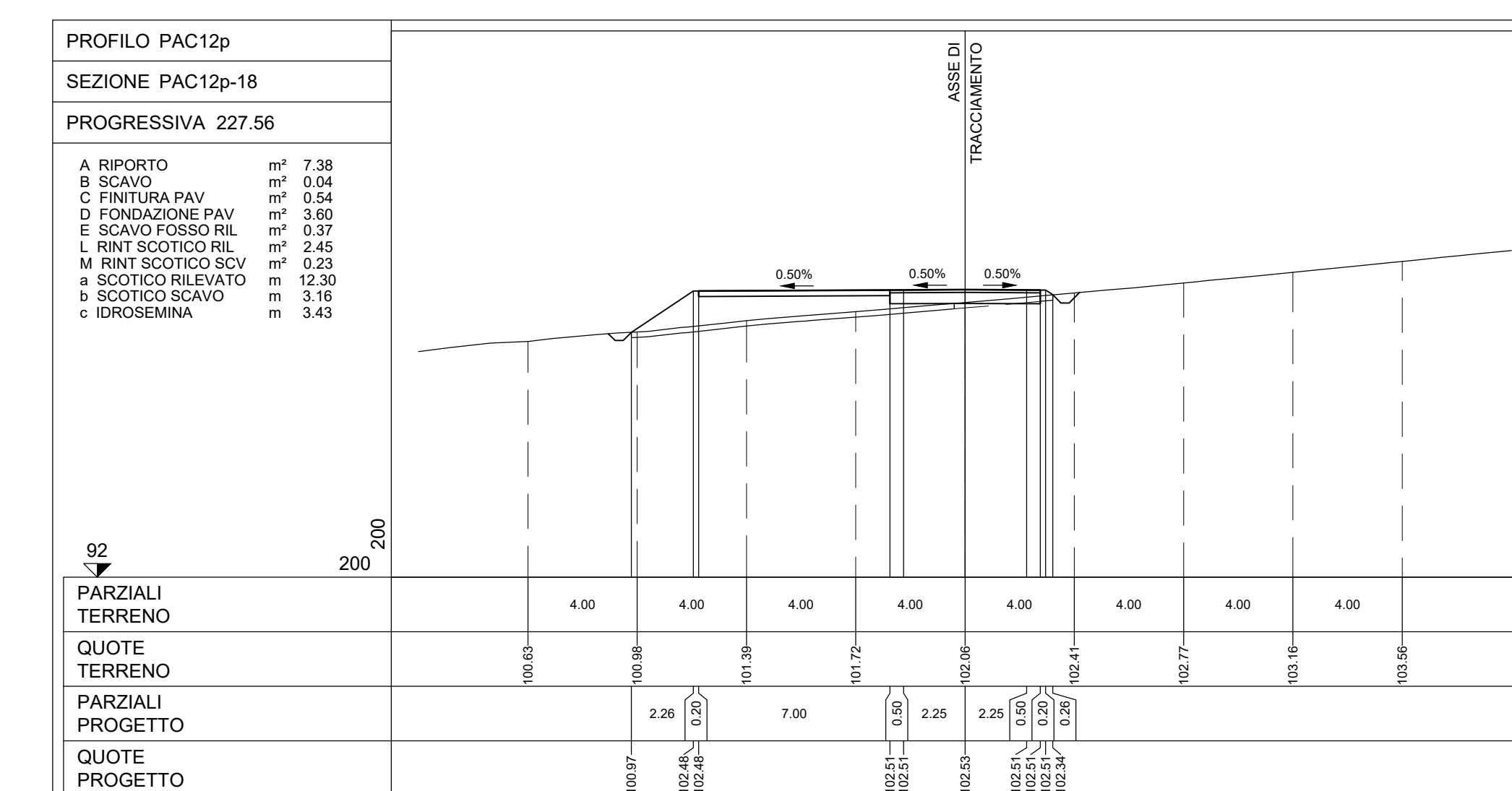
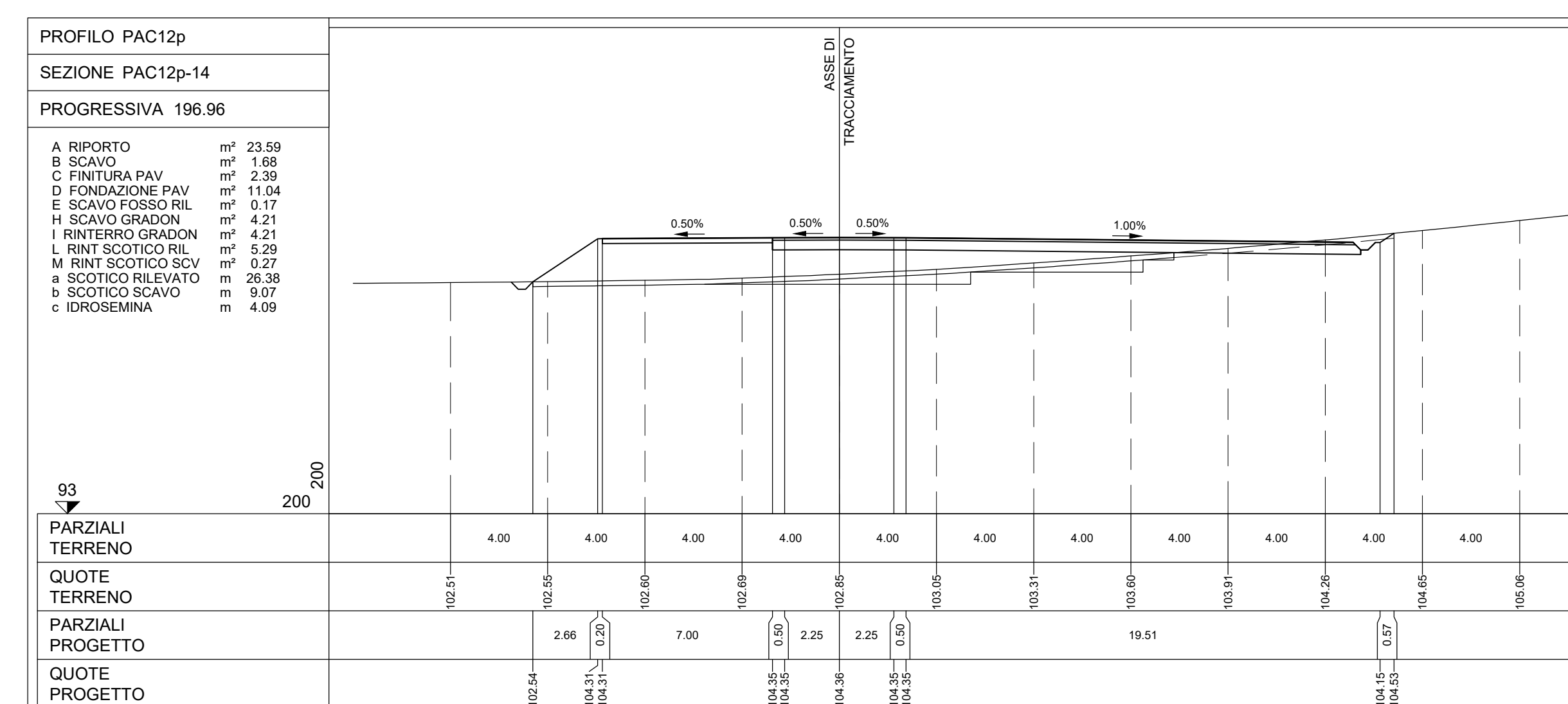
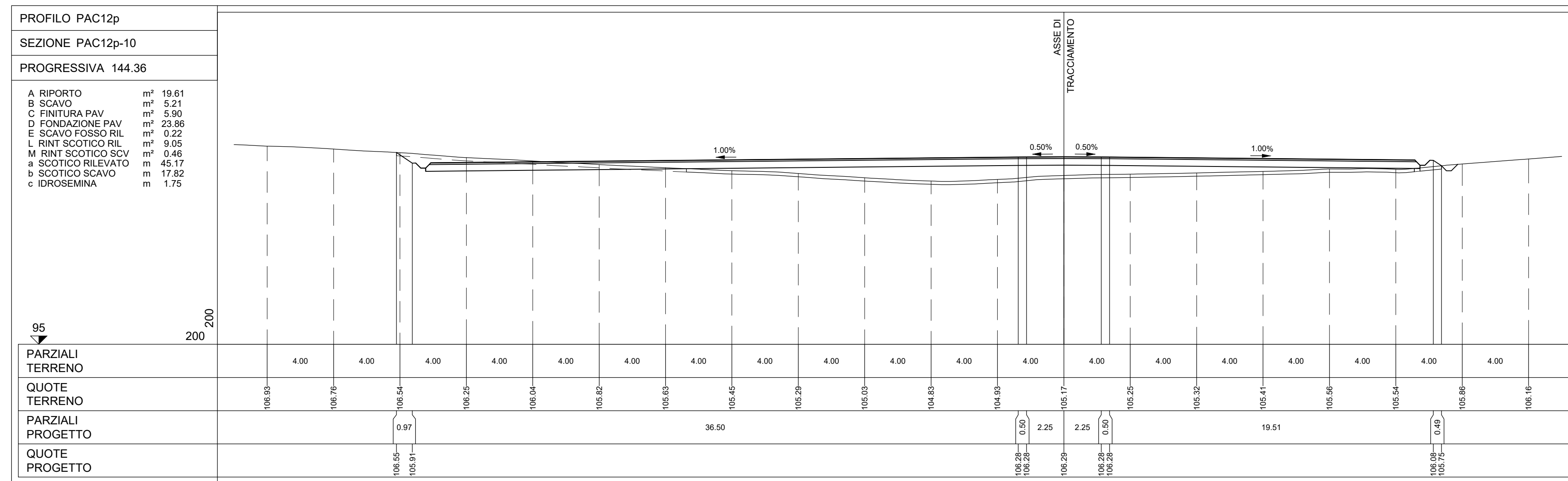
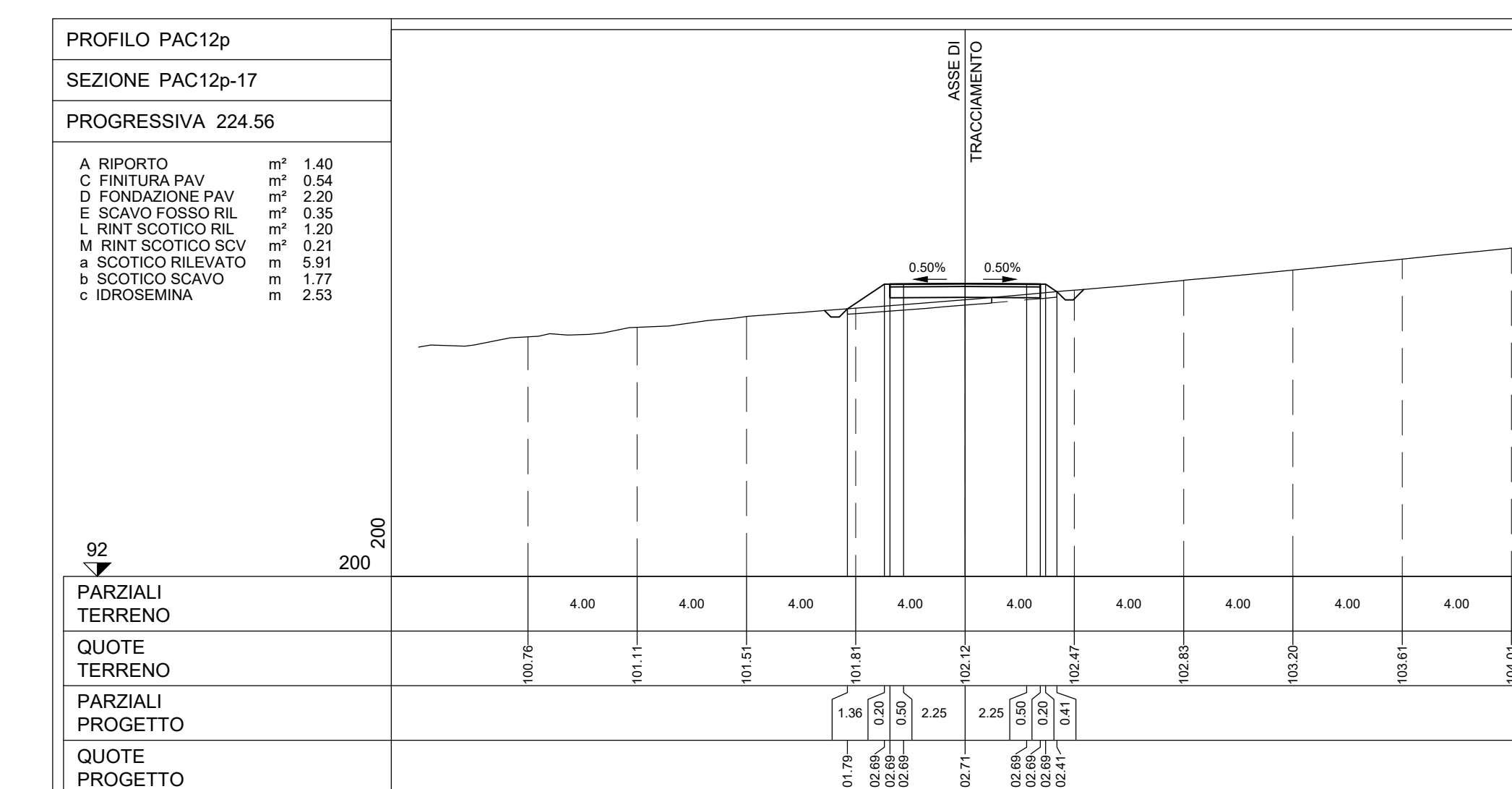
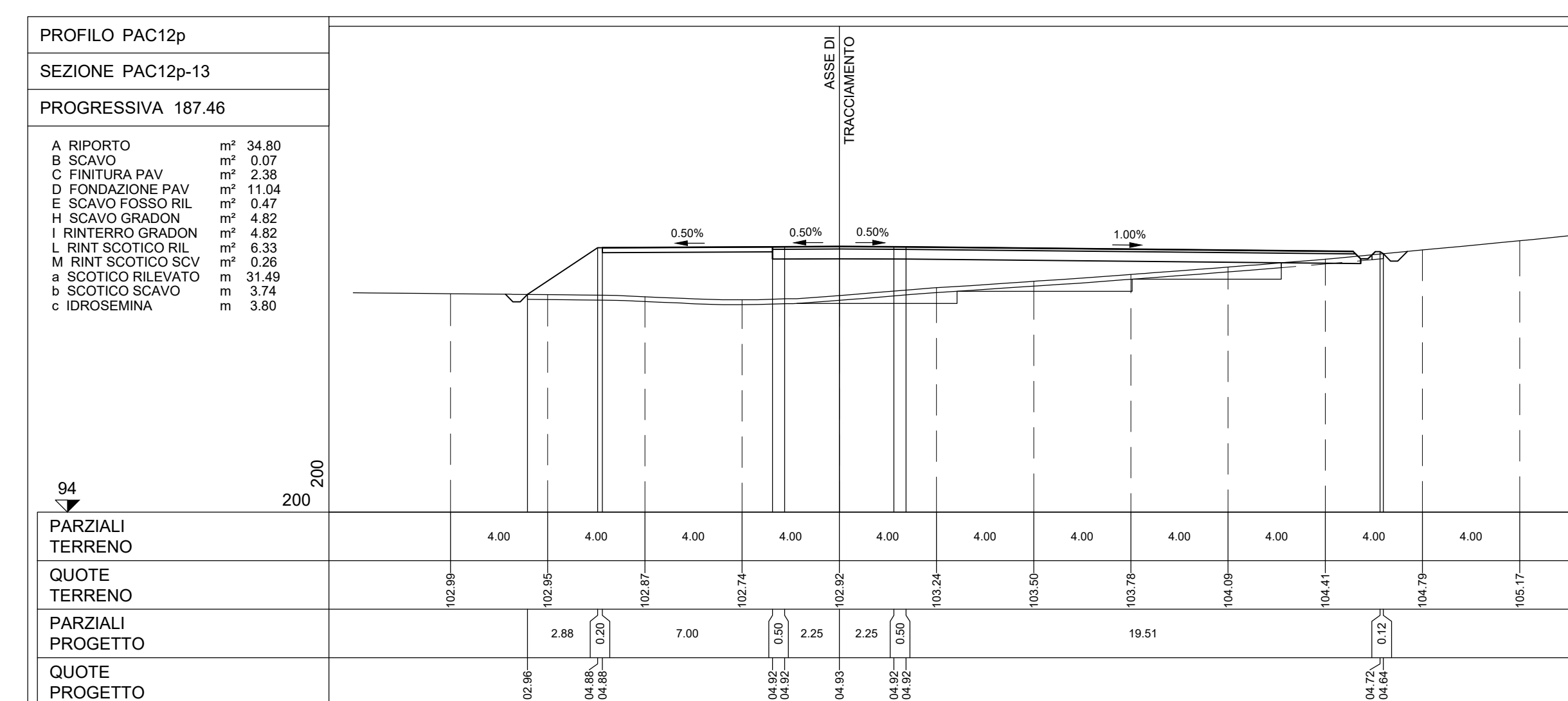
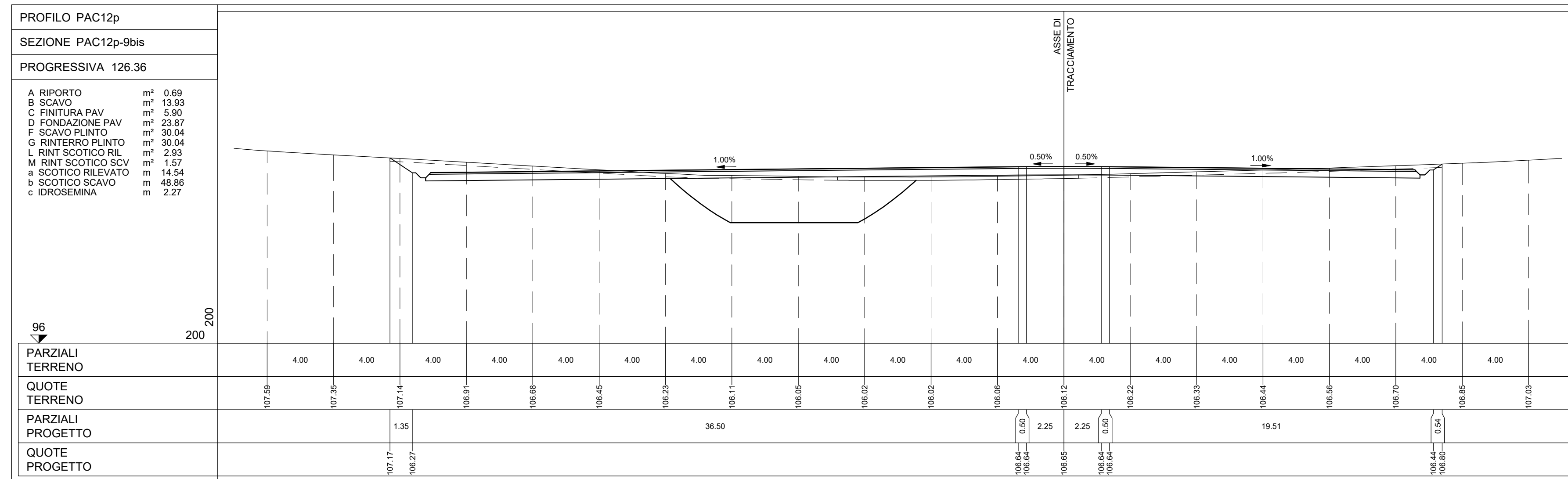

NOTE:
- PER LE UBICAZIONI E LE DIMENSIONI RELATIVE ALLE OPERE IDRAULICHE SI VEDANO LE TAVOLE SPECIFICHE

Rev.	Descrizione	Aut.	Coll.	Data
REV.	MODIFICAZIONE	GGM	CONTR.	07/2023

Montana

PACECO S.R.L. - VIA ANGELO FUMAGALLI 6, 20143 MILANO

IMPANTO EGILO DA 108 MW
COMUNE DI PACECO (TP), MISUSCEMI (TP) e TRAPANI (TP)

PAC12 - SEZIONI TRASVERSALI PAZZOLA

Rev. 2023