

**LEGENDA PIANTA CHIAVE**

- PAZZOLA CON ROTORE EOLICO
- PISTA DI ACCESSO ALLA PAZZOLA
- VIABILITA' ESISTENTE DA ADEGUARE

**NOTE:**  
- PER LE UBICAZIONI E LE DIMENSIONI RELATIVE ALLE OPERE IDRAULICHE SI VEDANO LE TAVOLE SPECIFICHE.

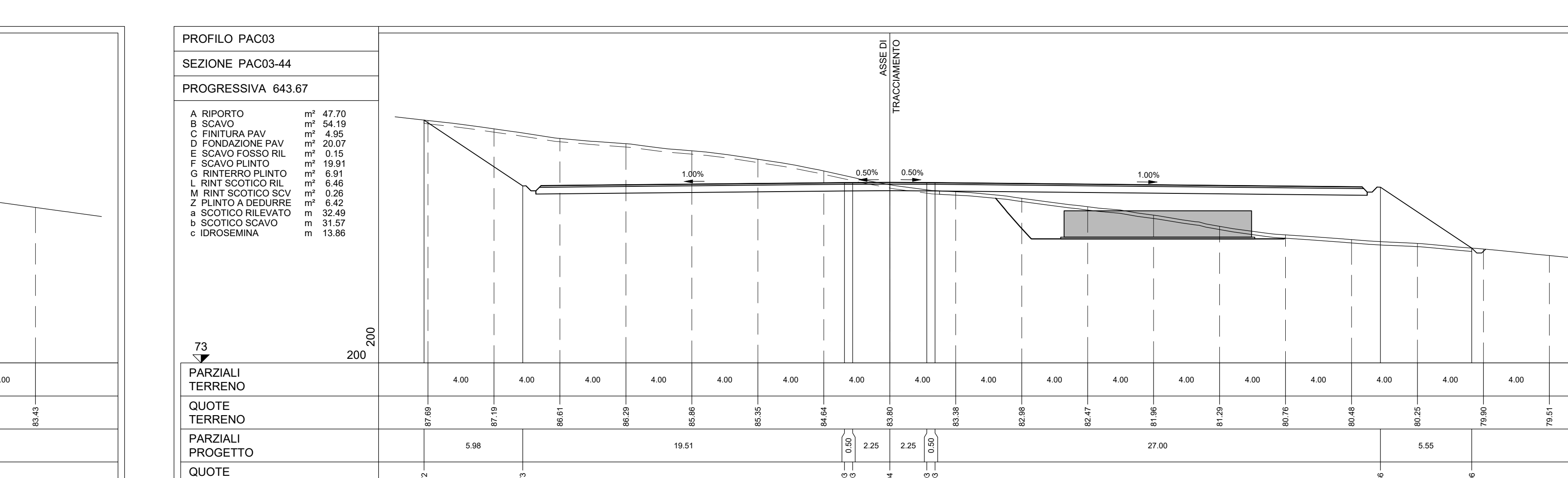
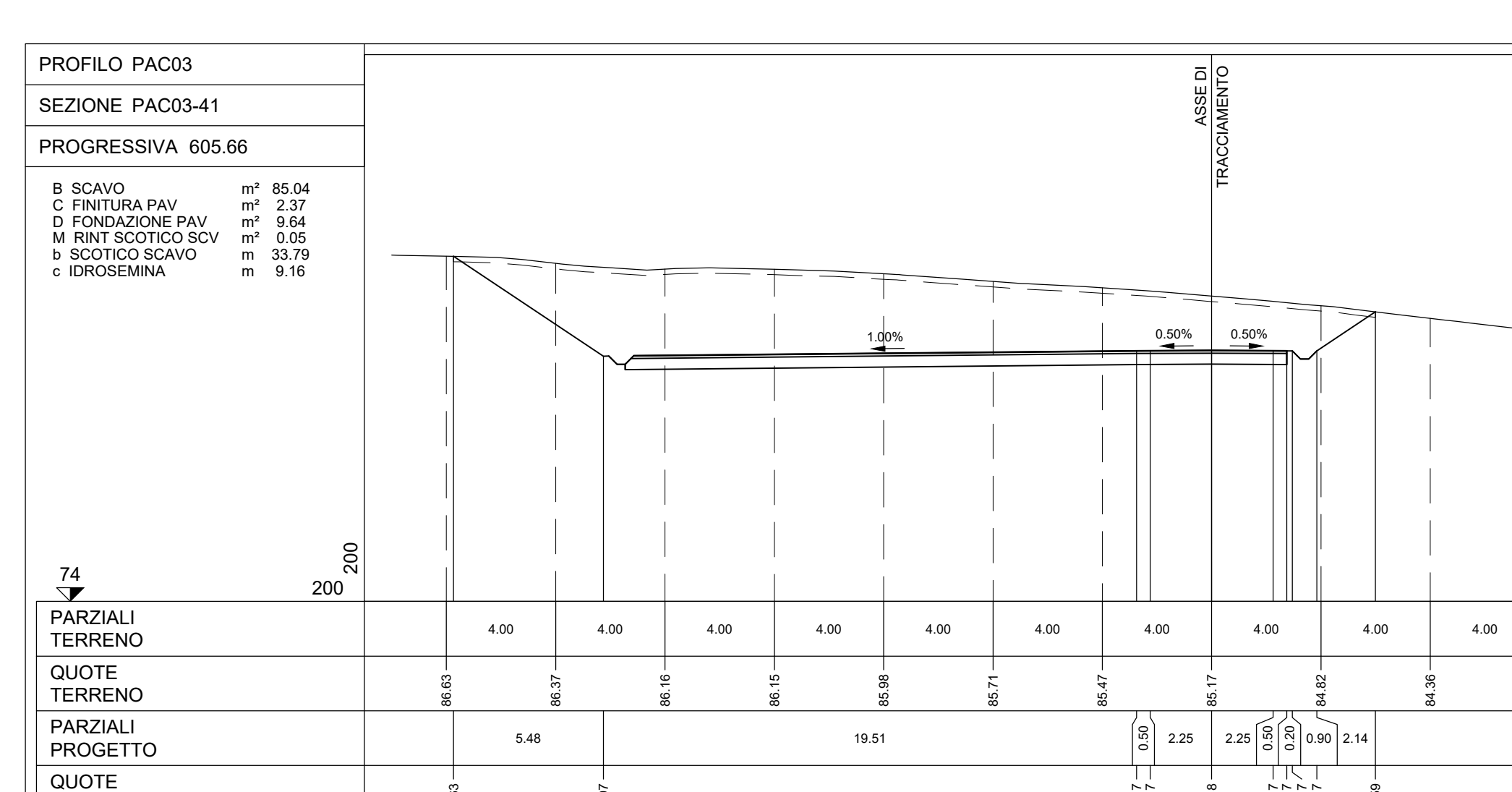
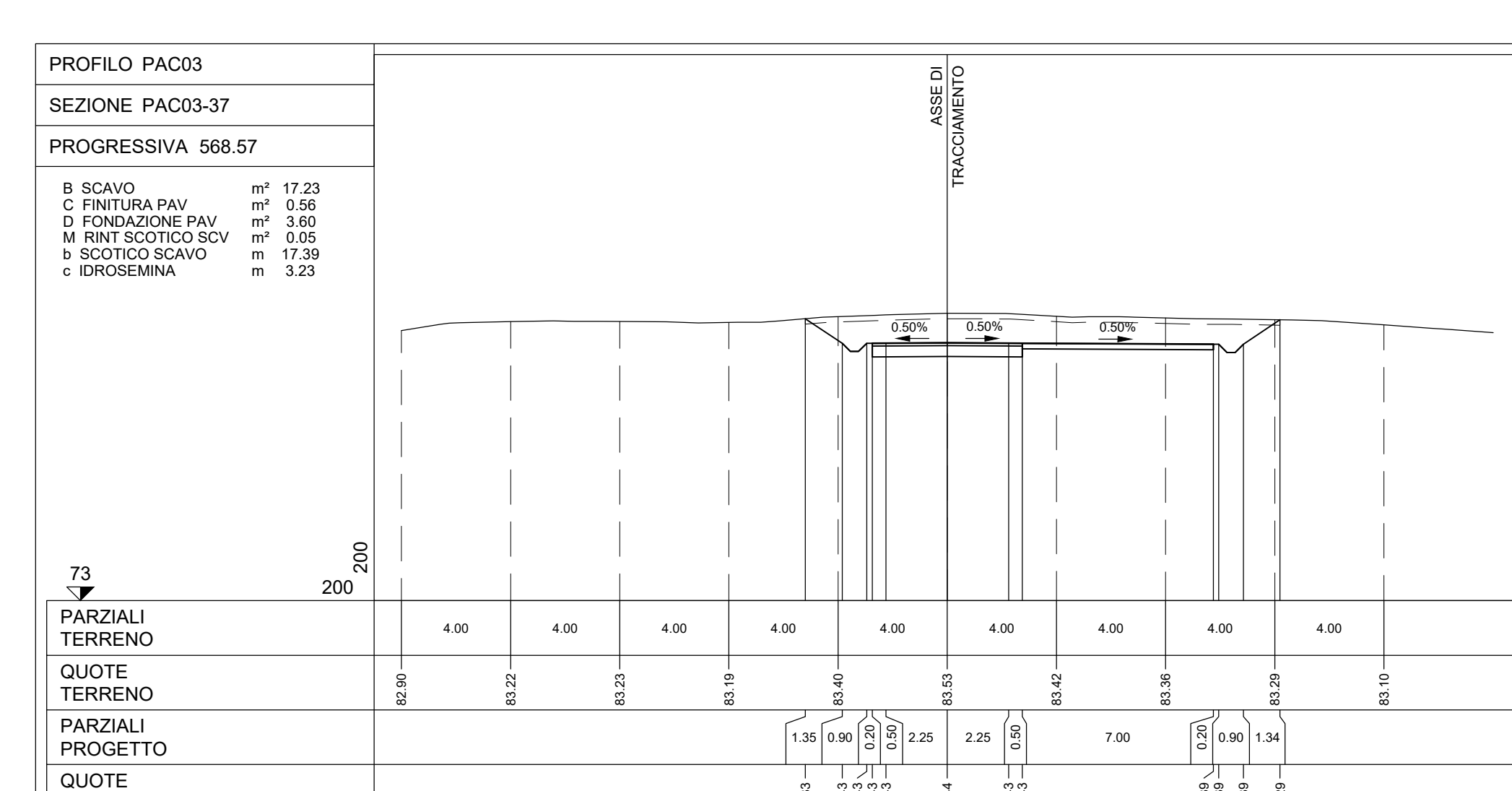
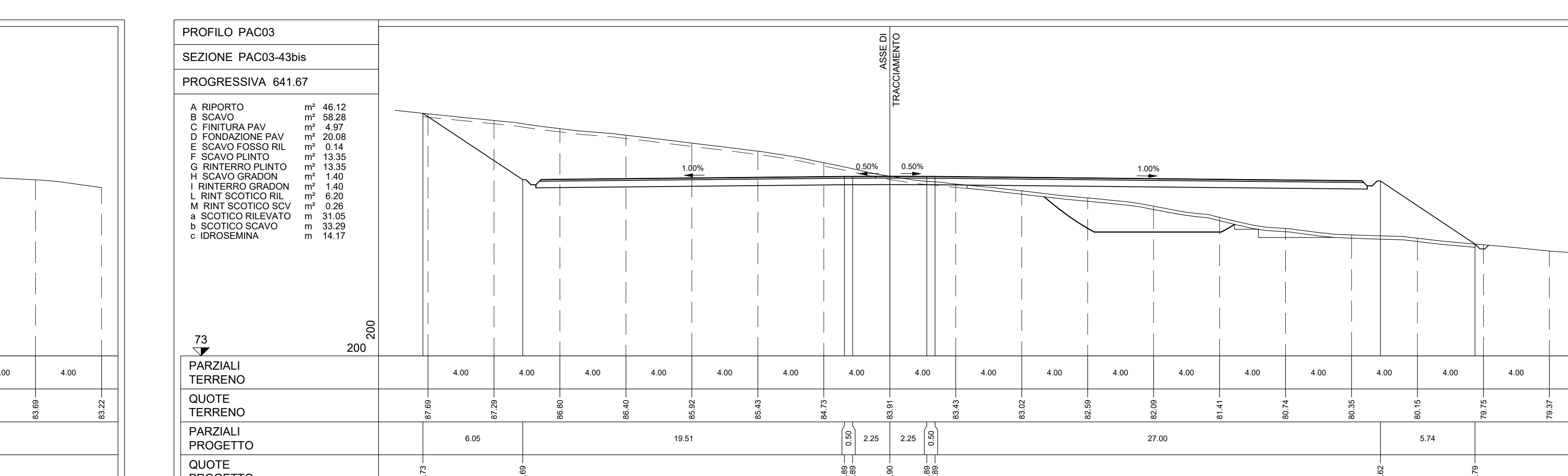
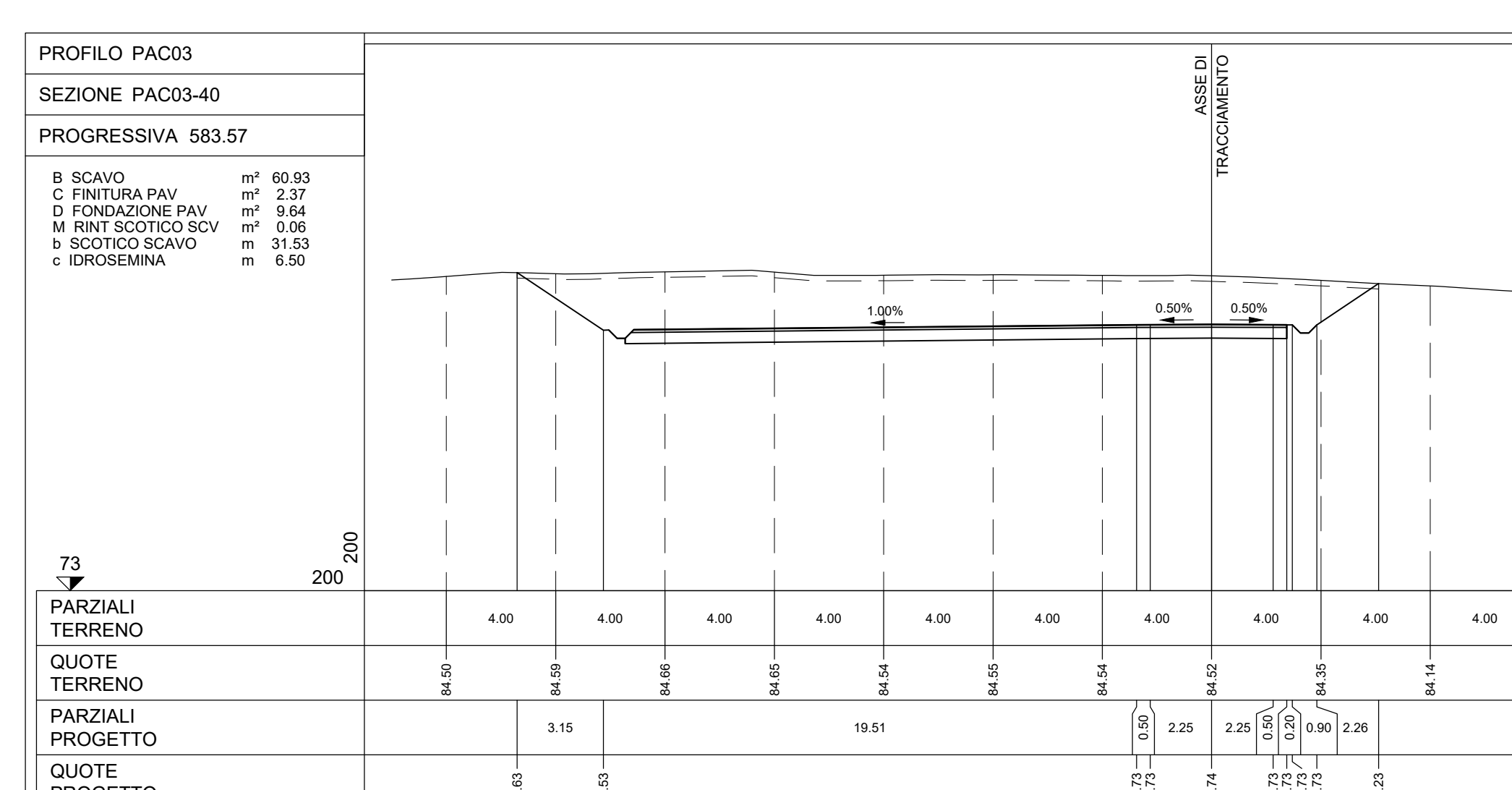
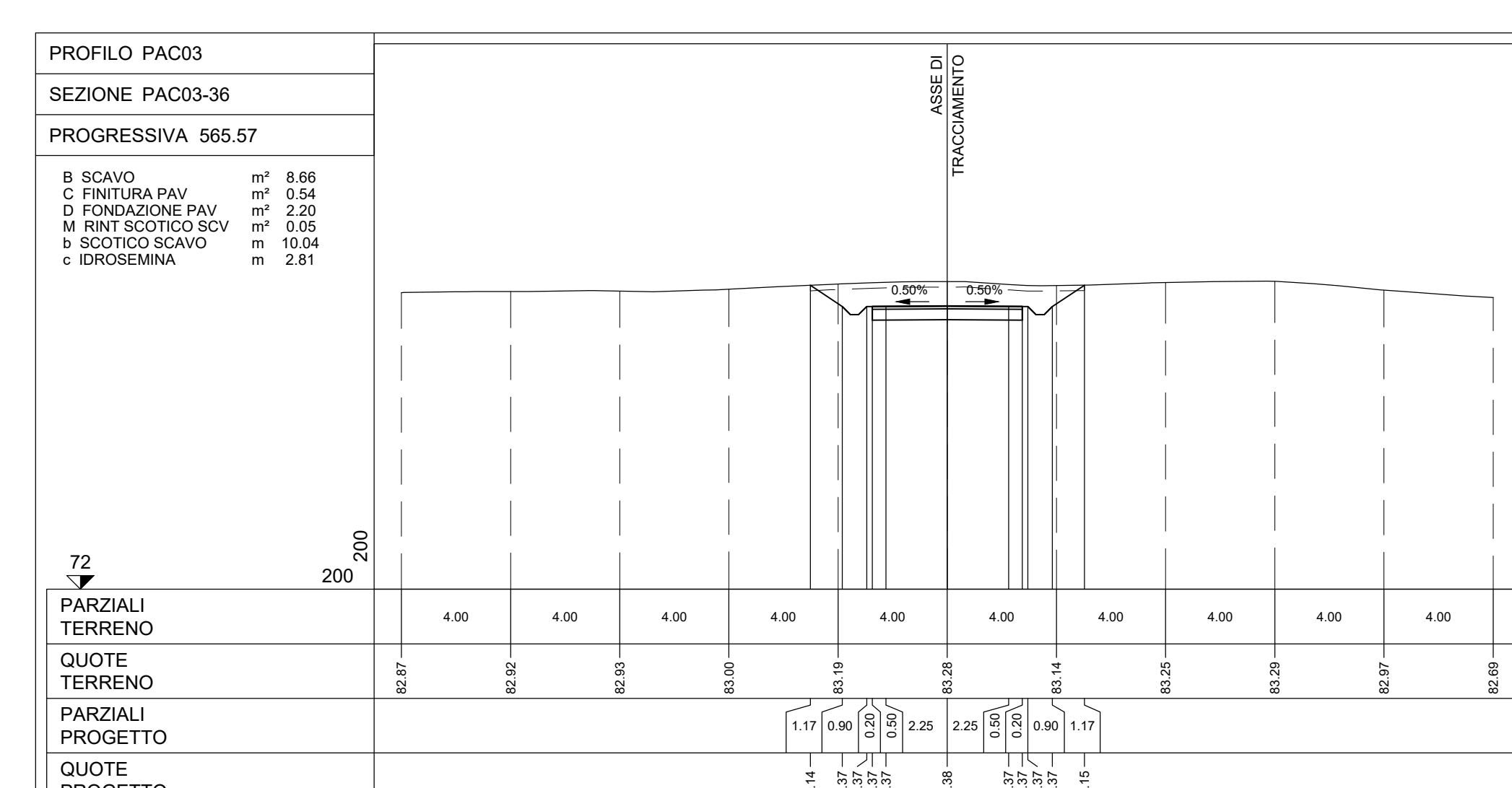
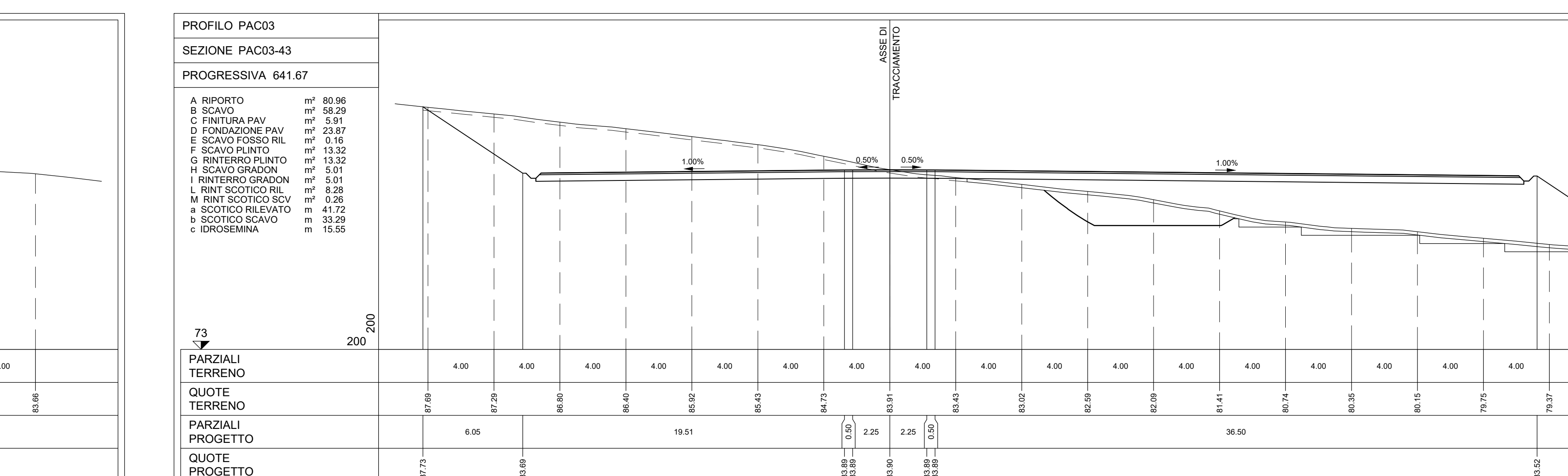
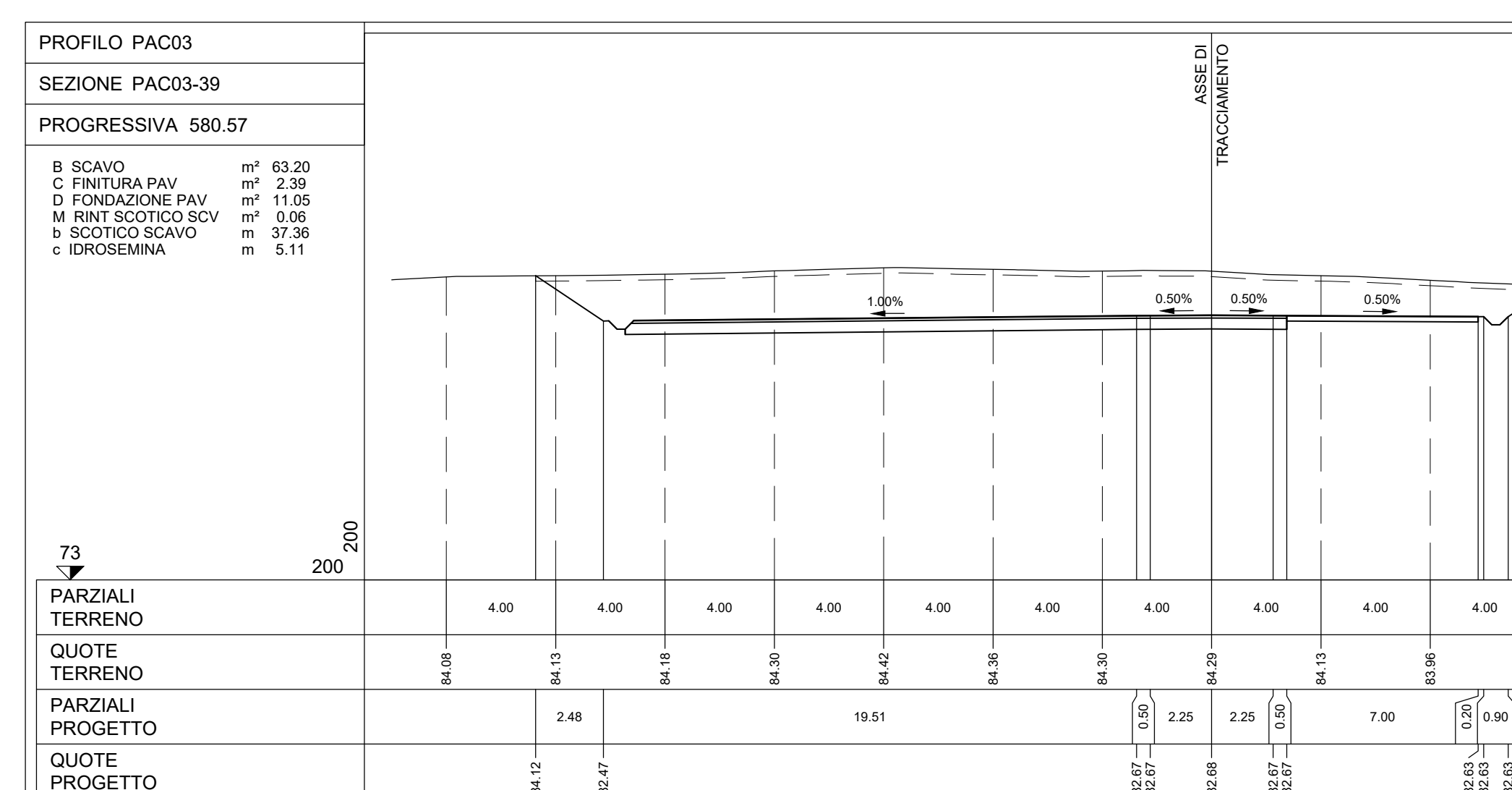
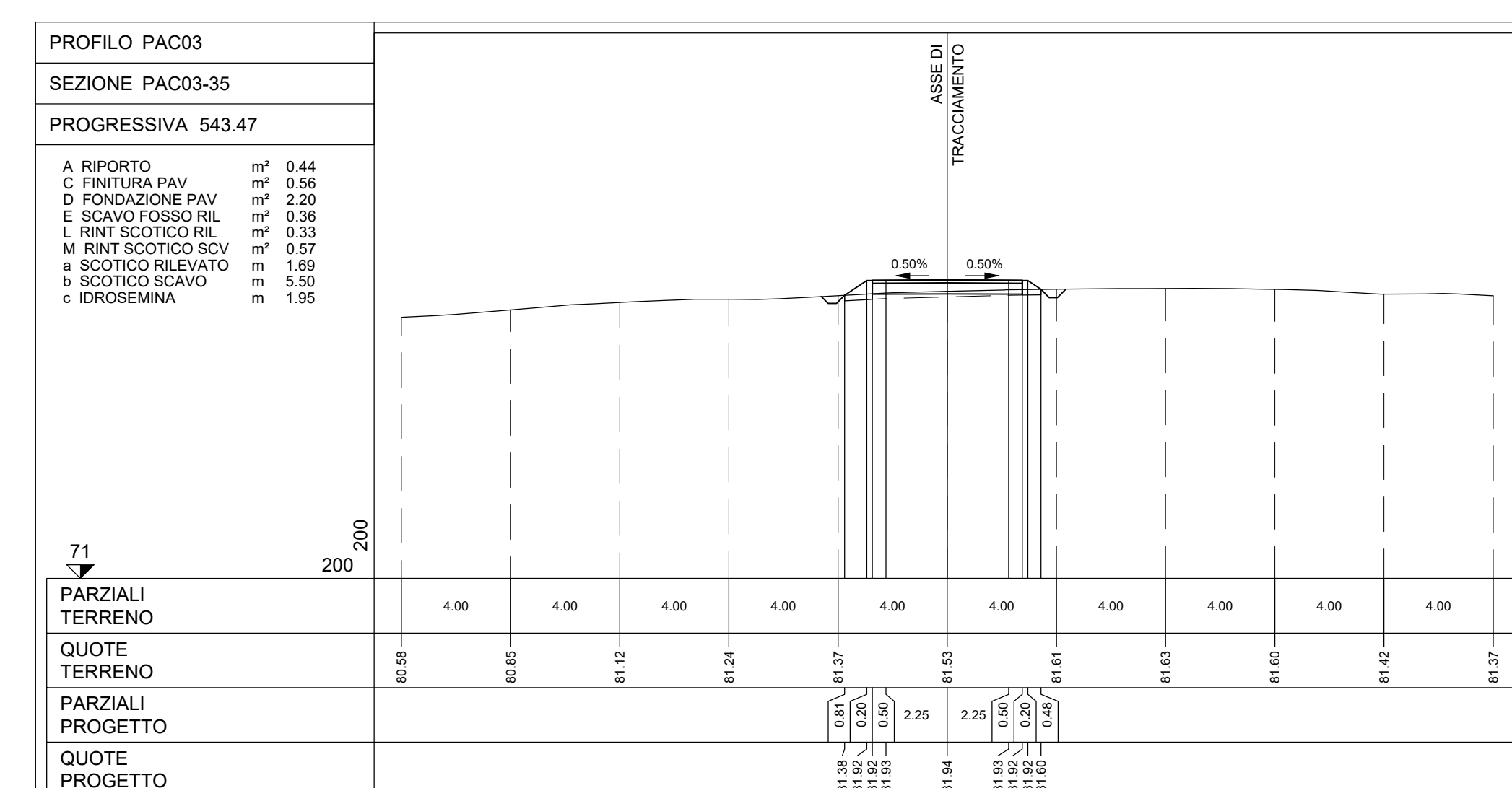
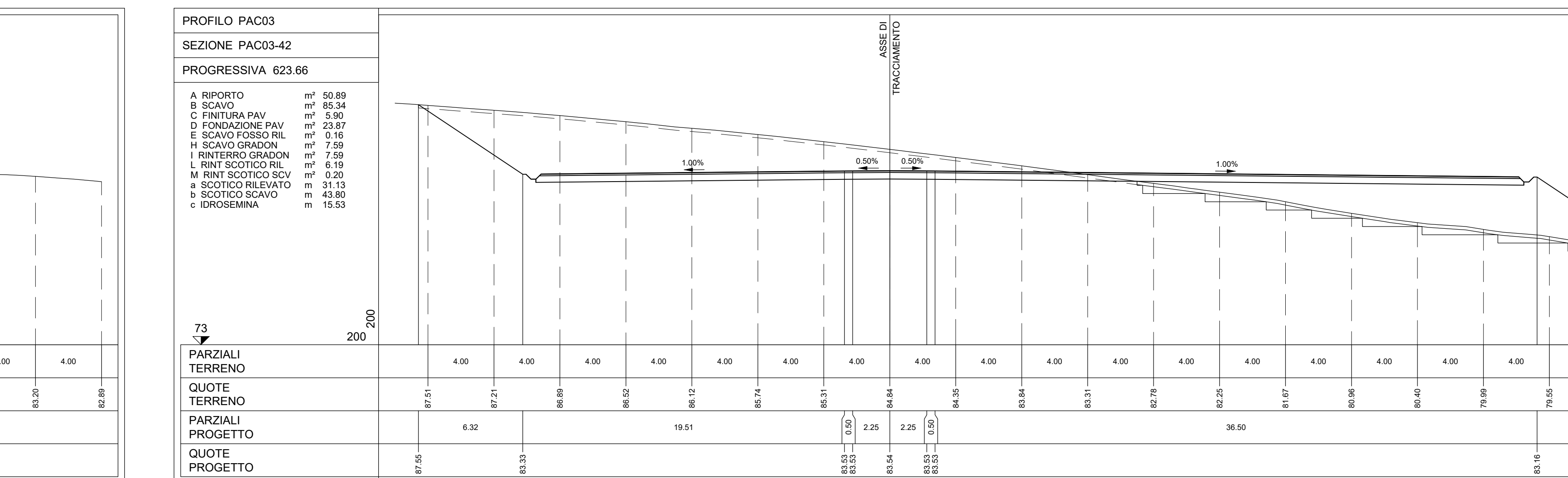
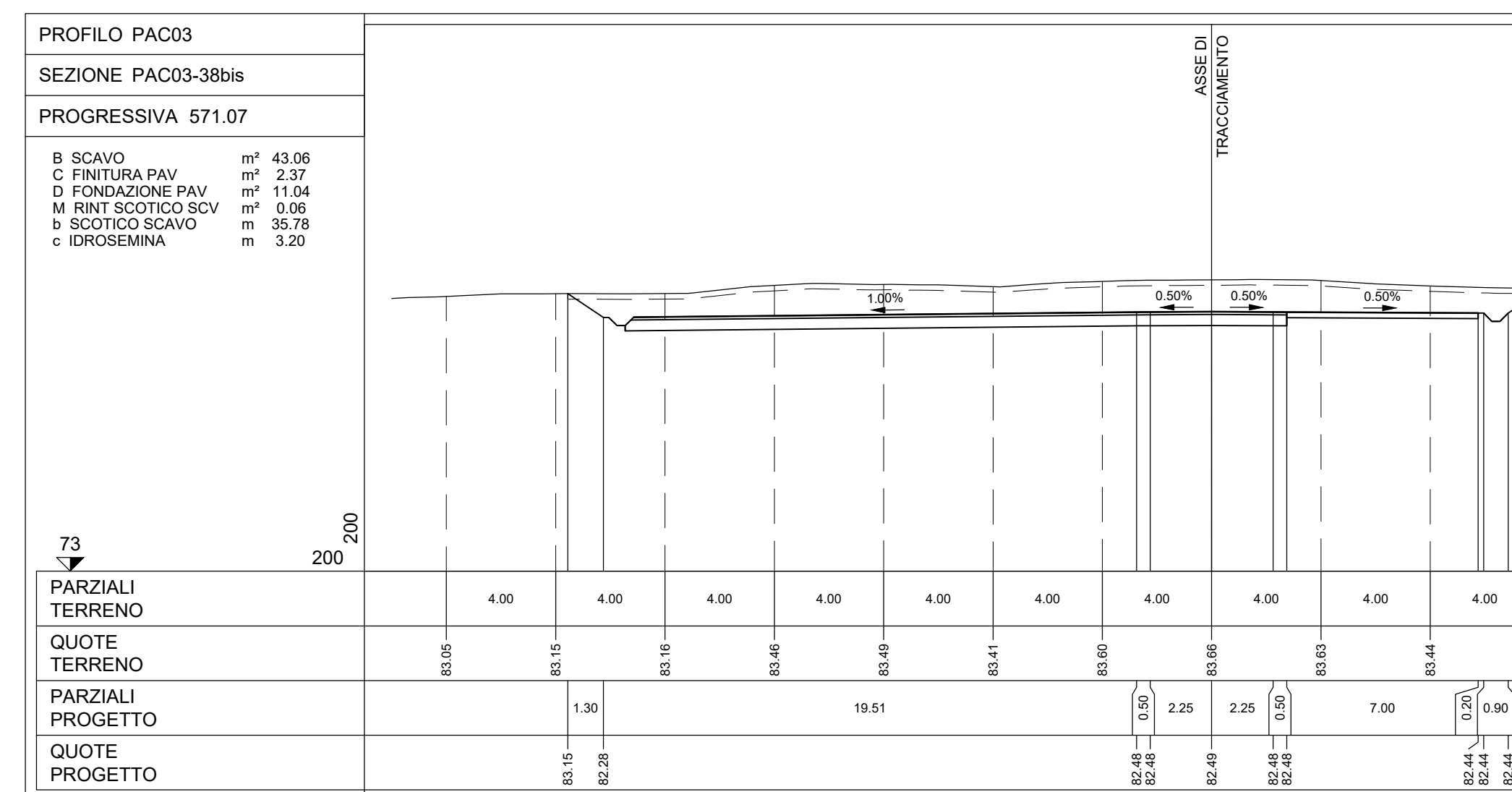
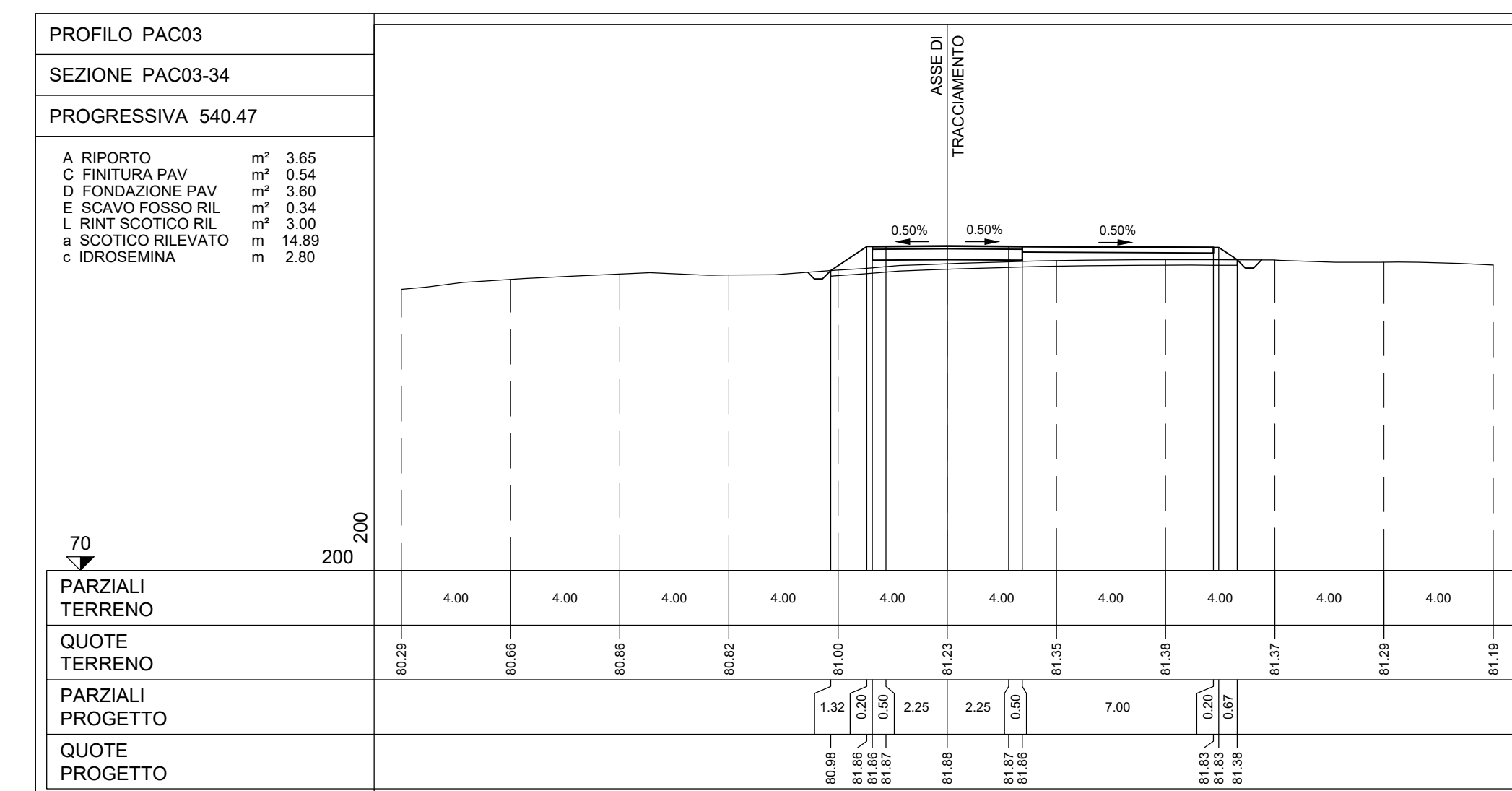
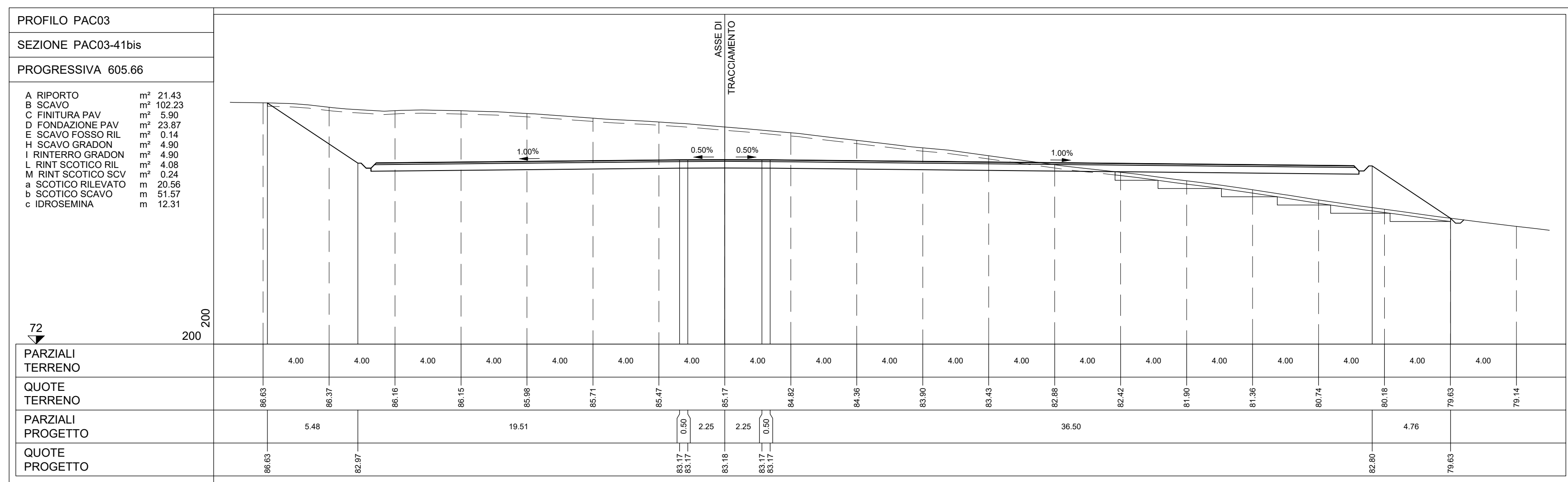
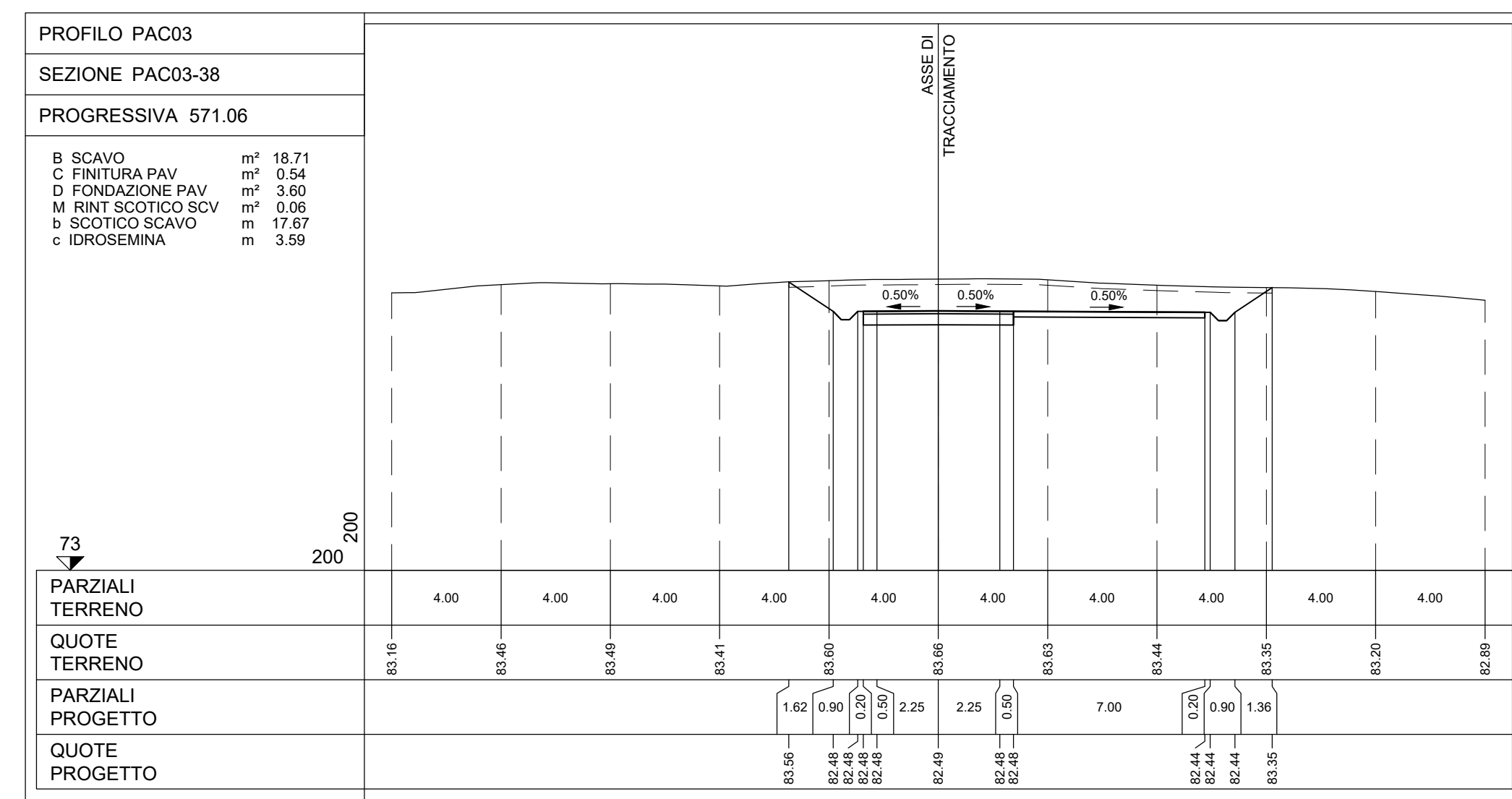
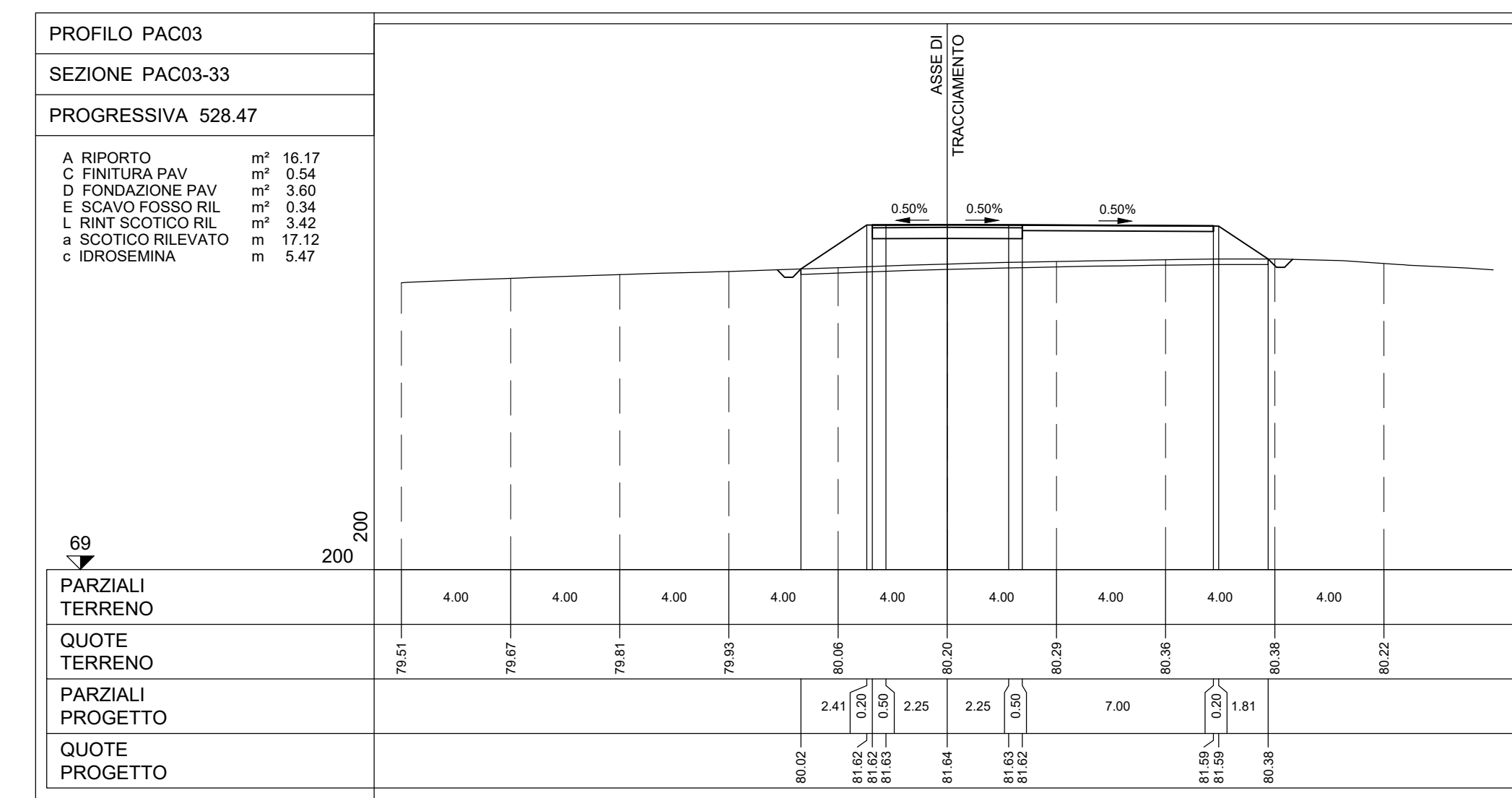

Rev.	Descrizione	El.	Di.	07/2023
REV.	MODIFICAZIONE	0004	0004	0004

**Montana** INGEGNERIA E ARCHITETTURA

**Paceco S.R.L.** VA ANGELO FUMAGALLI 6, 20143 MILANO

Progetto: **IMPIANTO EOLICO DA 108 MW**  
COMUNE DI PACECO (TP), MISLISECIMI (TP) e TRAPANI (TP)

Tavola: **PAC03 - SEZIONI TRASVERSALI PAZZOLA** T12.3a

Rev. 01 - 28/05/2023 - PAC\_PTE\_T12.3 - REV\_PAC03 - SEZIONI TRASVERSALI PAZZOLA

PACECO  
PIANTA CHIAVE

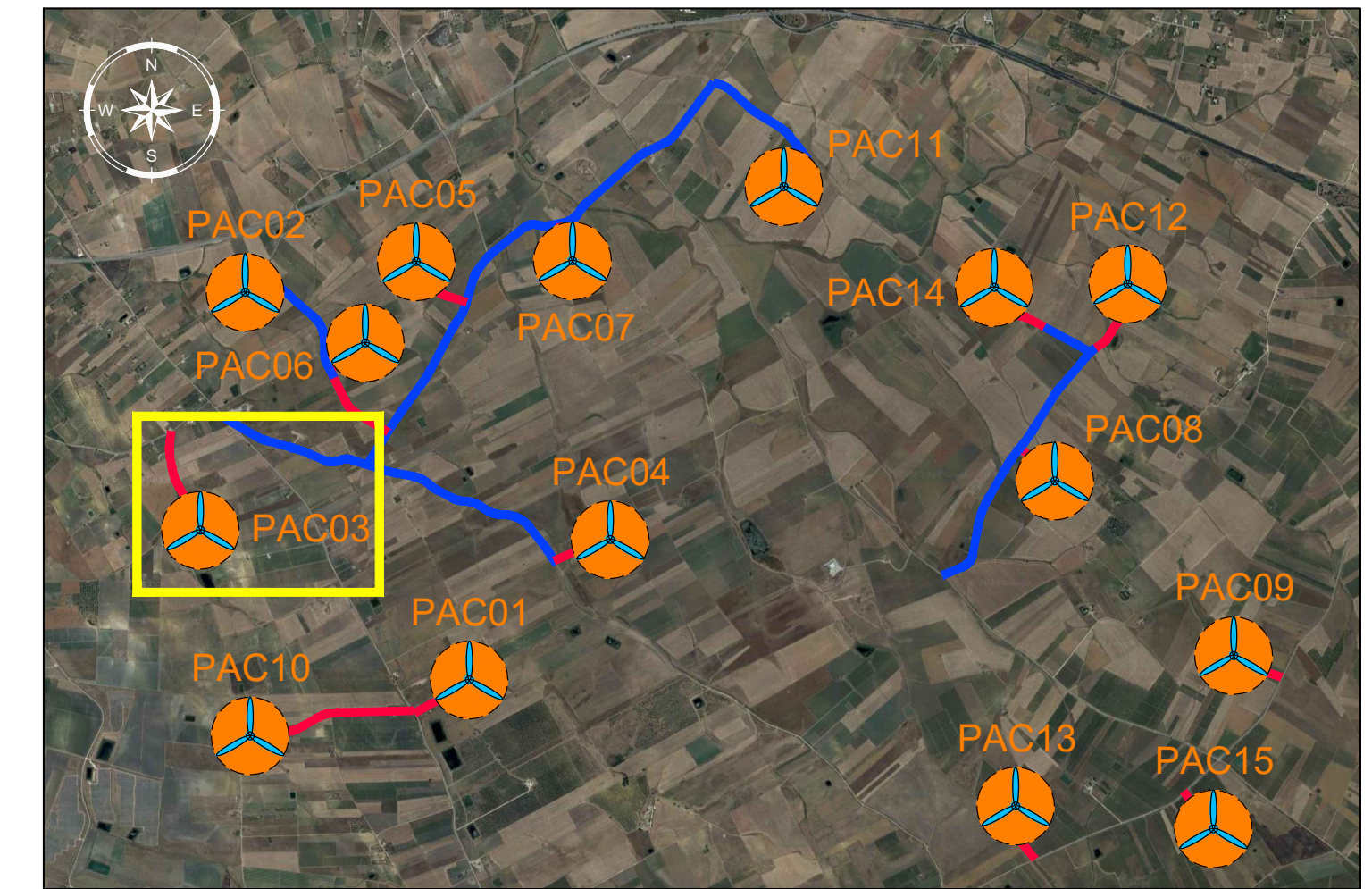

**LEGENDA PIANTA CHIAVE**

- PIAZZOLA CON ROTORE EOLICO
- PISTA DI ACCESSO ALLA PIAZZOLA
- VIABILITA' ESISTENTE DA ADEGUARE

**NOTE:**  
- PER LE UBICAZIONI E LE DIMENSIONI RELATIVE ALLE OPERE IDRAULICHE SI VEDANO LE TAVOLE SPECIFICHE.

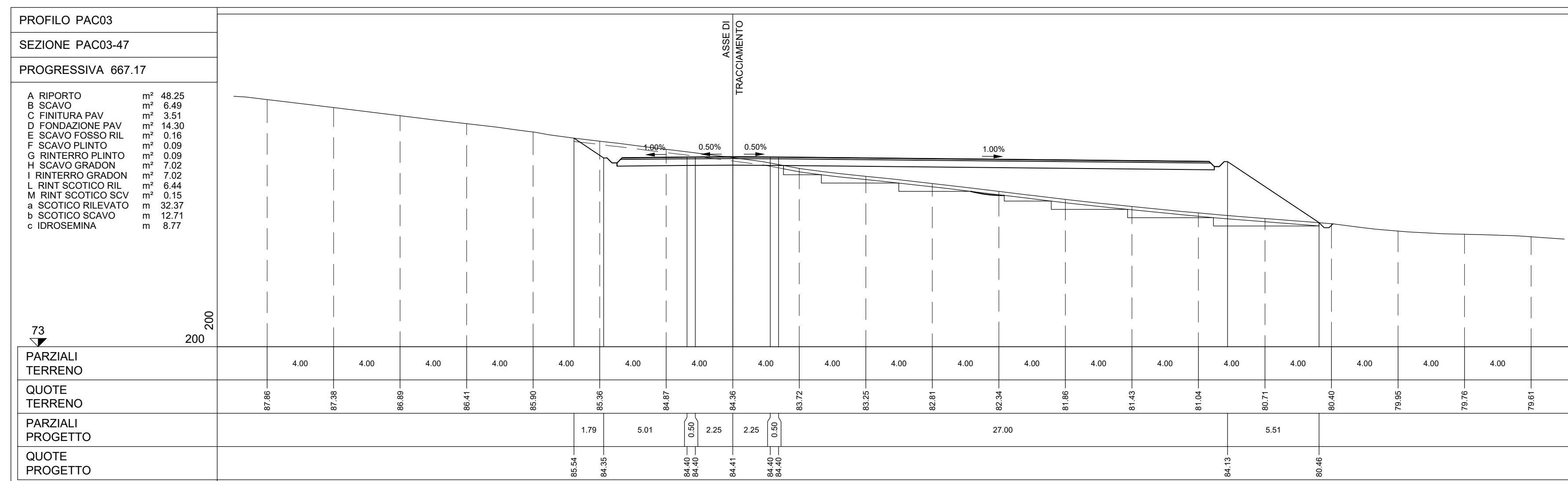
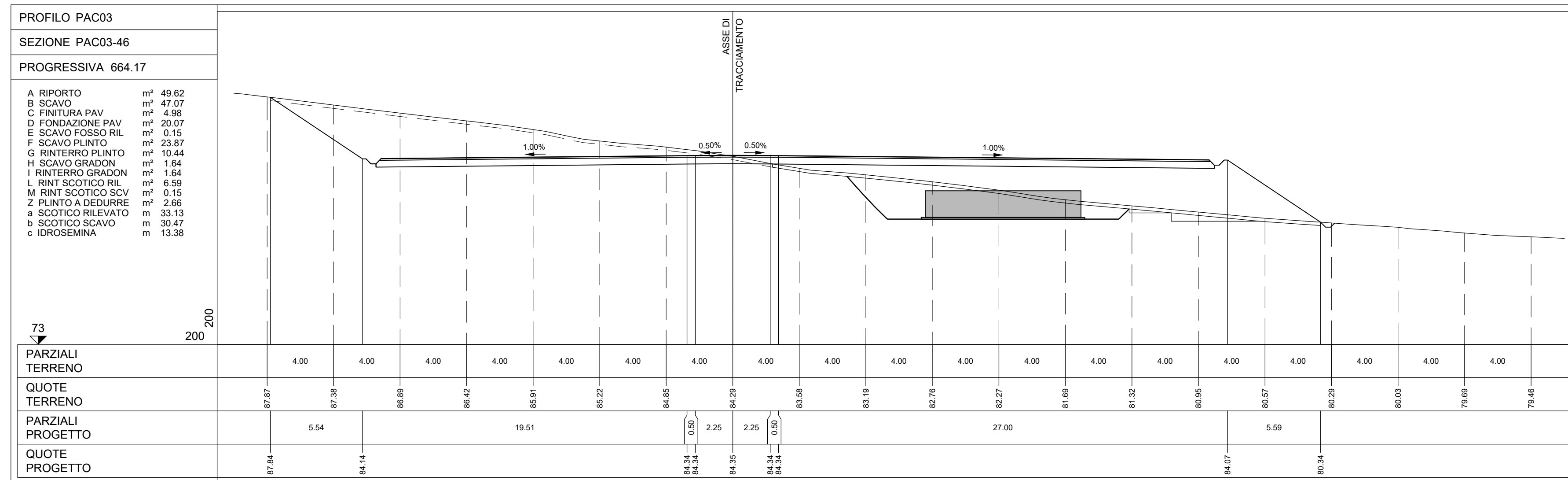
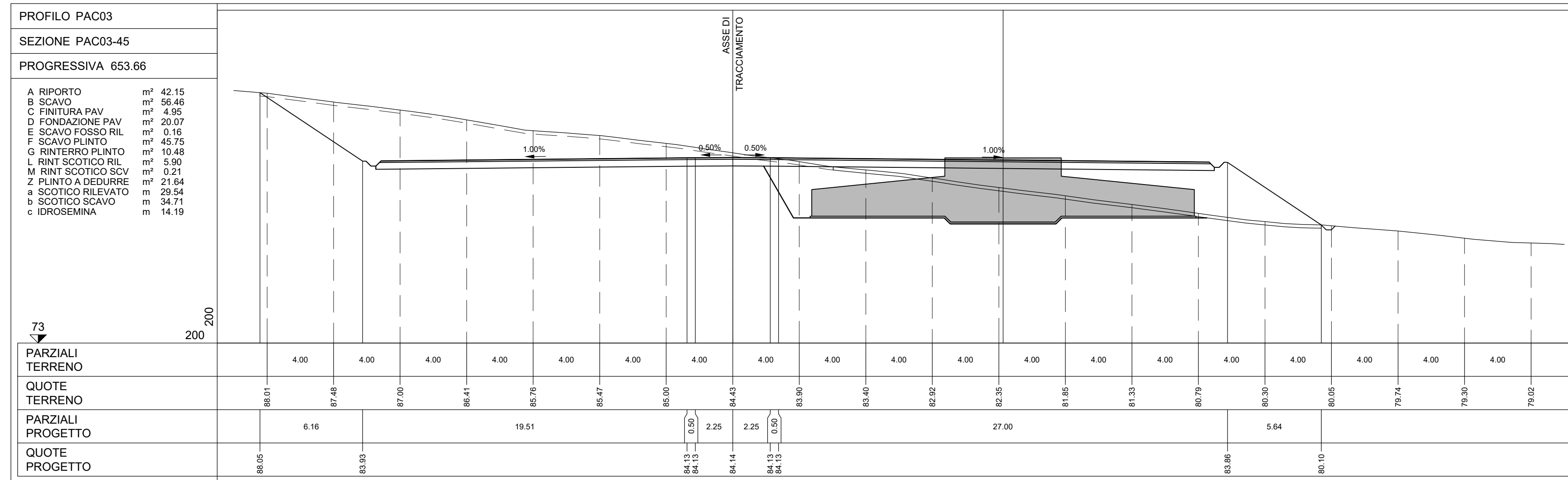

Rev0	Emissione	TR	EL	LC	07/2023
REV.	DESCRIZIONE	DESIGN	CONTROL	APPROV.	DATA

**Montana**  
Via Galvani 10, 20143 Milano  
Tel: +39 02 5418179 Fax: +39 02 5418180  
www.montanaitalia.com Cap.Soc. 003000000

Milano | Padova | Brescia | Palermo | Cagliari | Roma | Siracusa

**Committente**  
PACECO S.R.L.  
PACECO S.R.L.  
Via ANGELO FUMAGALLI 6, 20143 MILANO

**Progettisti**  
ING. LAURA CONTI  
Iscritta all'Ordine degli Ingegneri della Provincia di Pavia al n. 1726

**Oggetto**  
IMPIANTO EOLICO DA 108 MW  
COMUNE DI PACECO (TP), MISILISCEMI (TP) e TRAPANI (TP)

**Tavola**  
PAC03 - SEZIONI TRASVERSALI PIAZZOLA

**N. Tav.**  
T12.3b

**N. di**  
2995\_5531\_PAC\_PFFE\_T12.3\_REV0\_PAC03-SEZIONI TRASVERSALI PIAZZOLA

**Scala**  
1:200

E' VIETATA LA RIPRODUZIONE DI QUESTO DOCUMENTO SENZA PREVENTIVA AUTORIZZAZIONE SCRITTA DELLA MONTANA SPA