

LEGENDA PIANTA CHIAVE

- PIAZZOLA CON ROTORE EOLICO
- PISTA DI ACCESSO ALLA PIAZZOLA
- VIABILITA' ESISTENTE DA ADEGUARE

NOTE:
- PER LE UBICAZIONI E LE DIMENSIONI RELATIVE ALLE OPERE IDRAULICHE SI VEDANO LE TAVOLE SPECIFICHE.

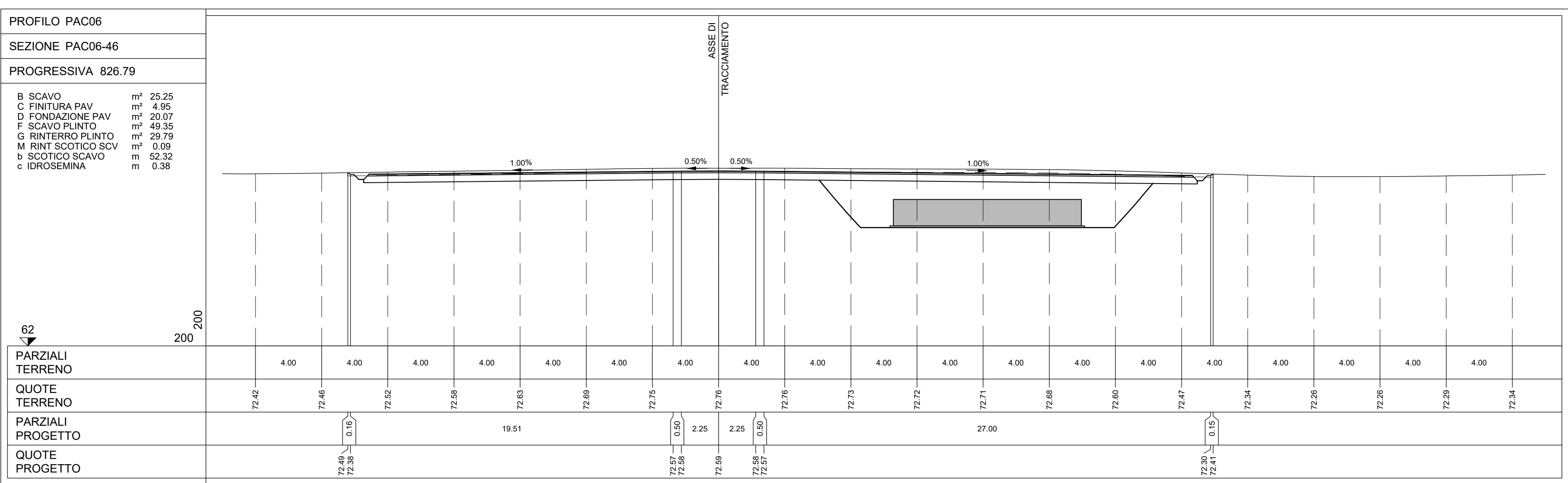
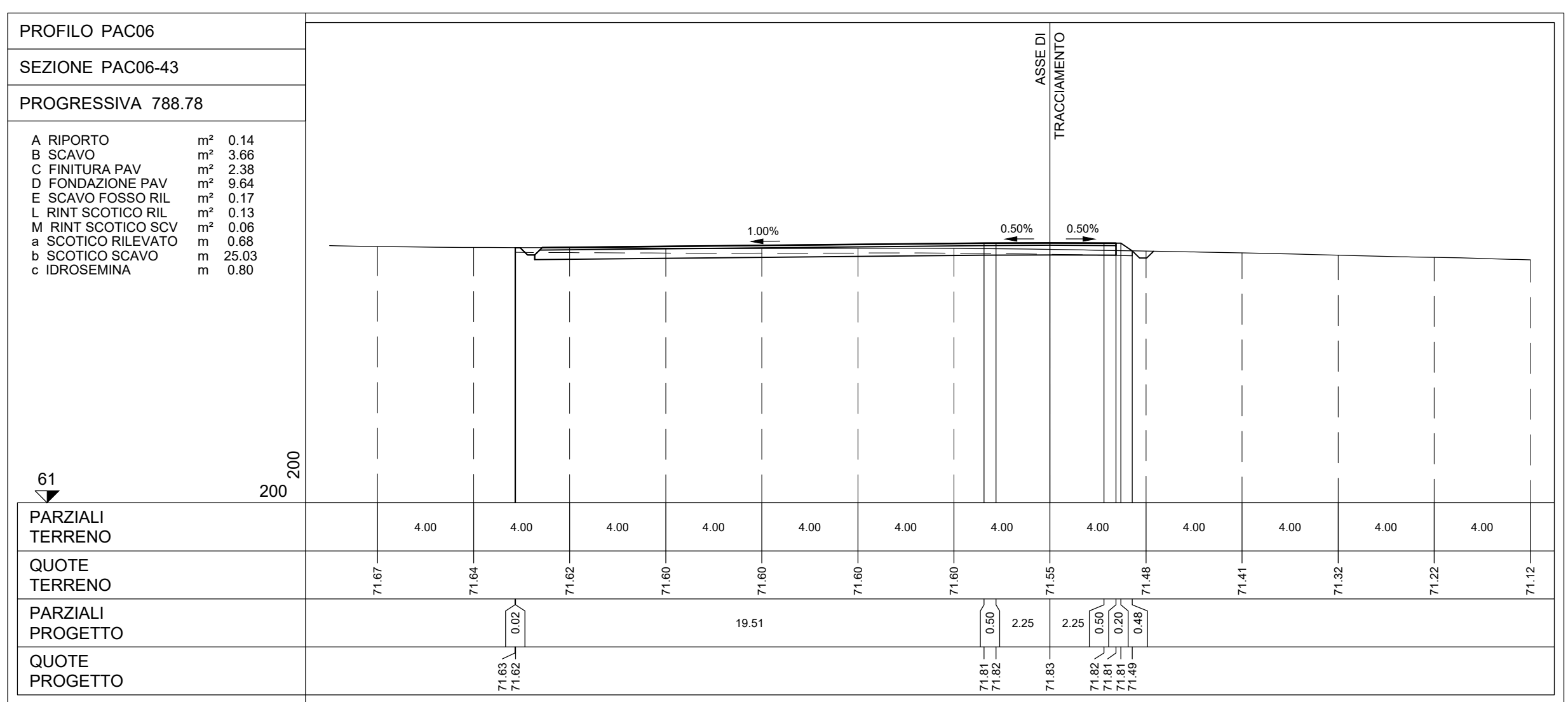
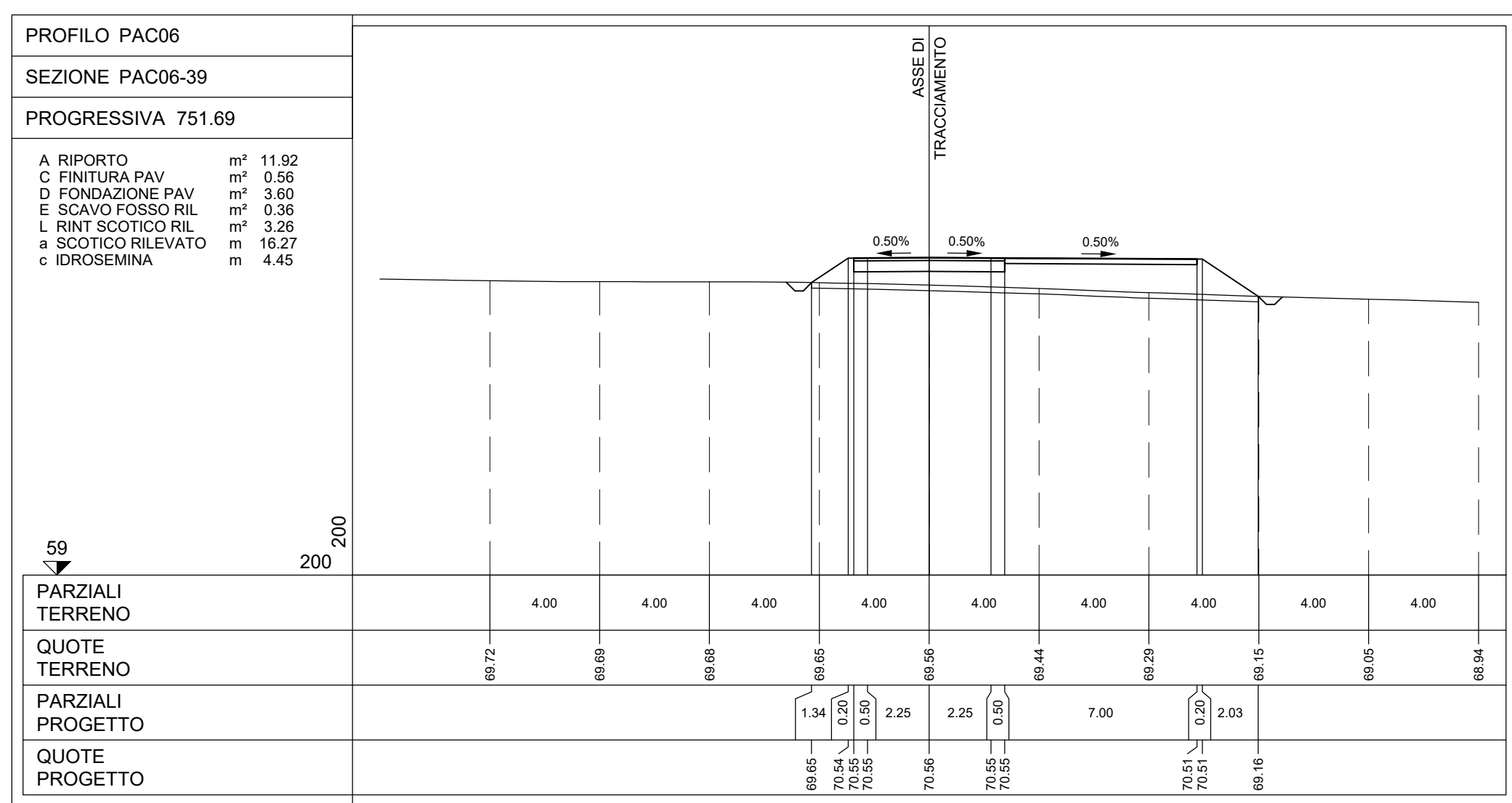
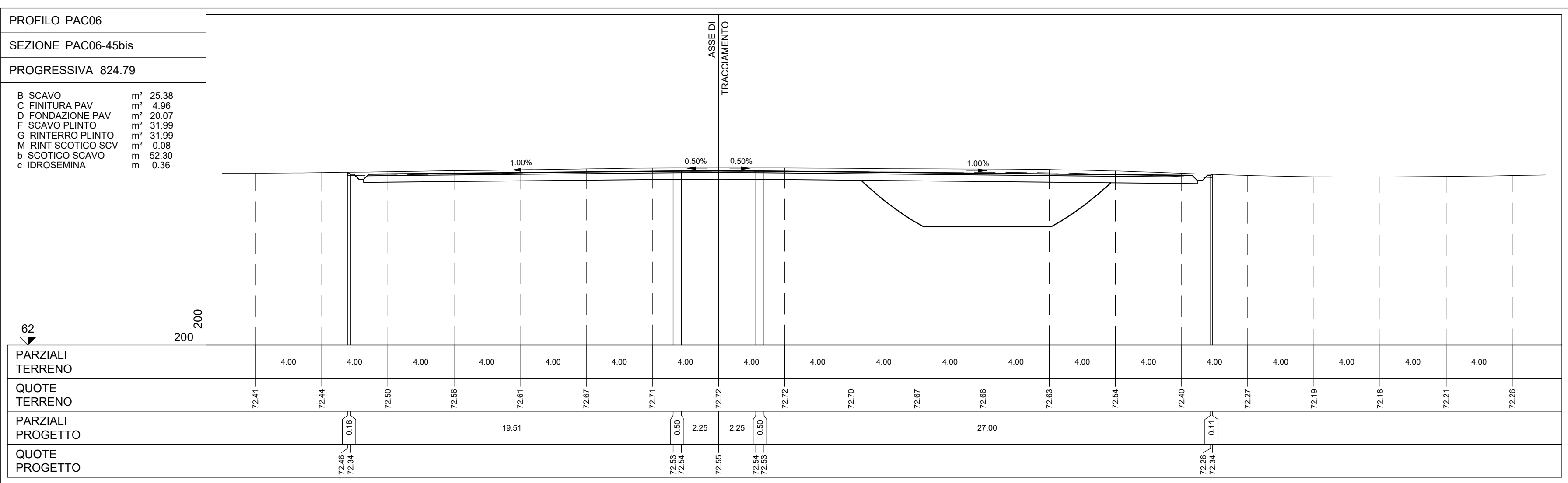
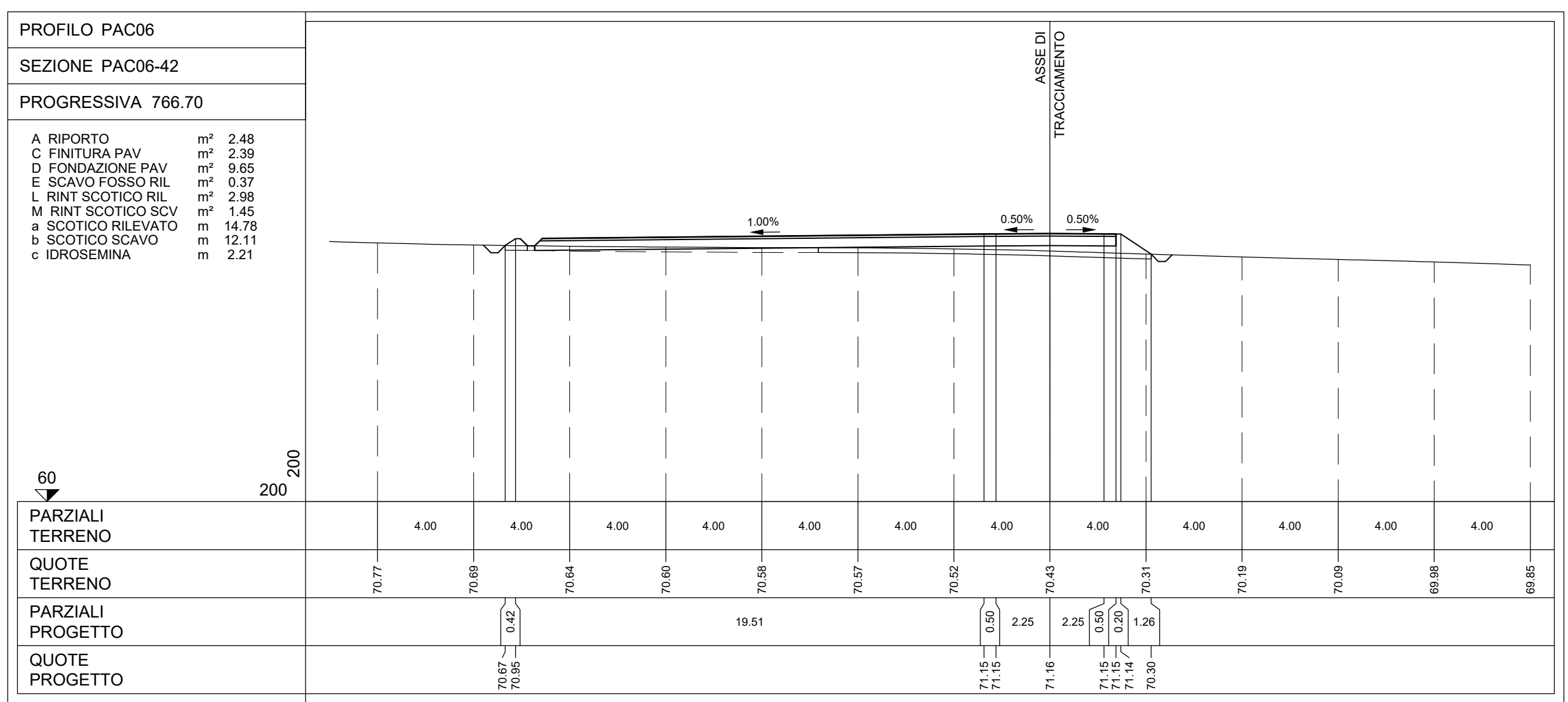
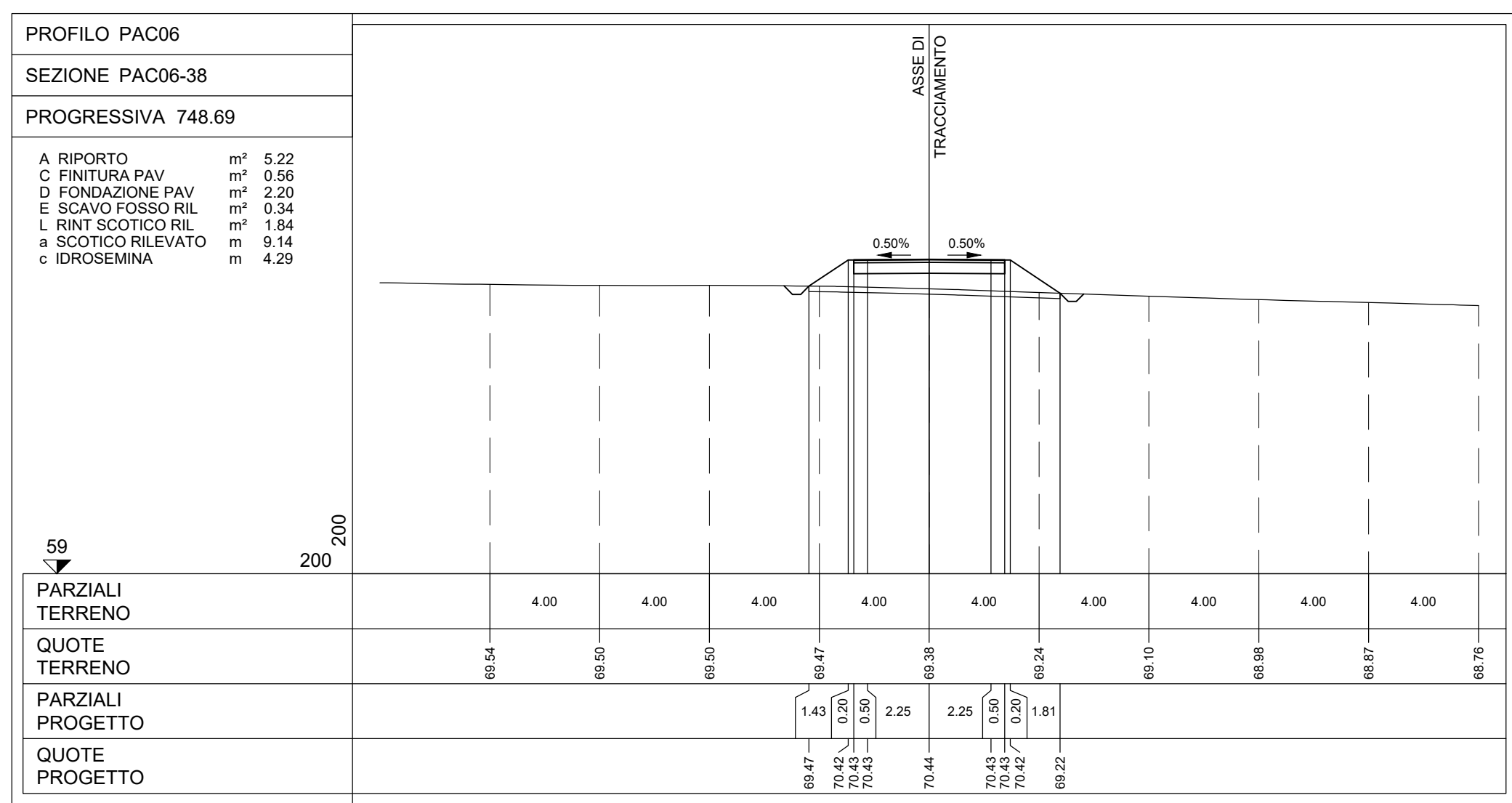
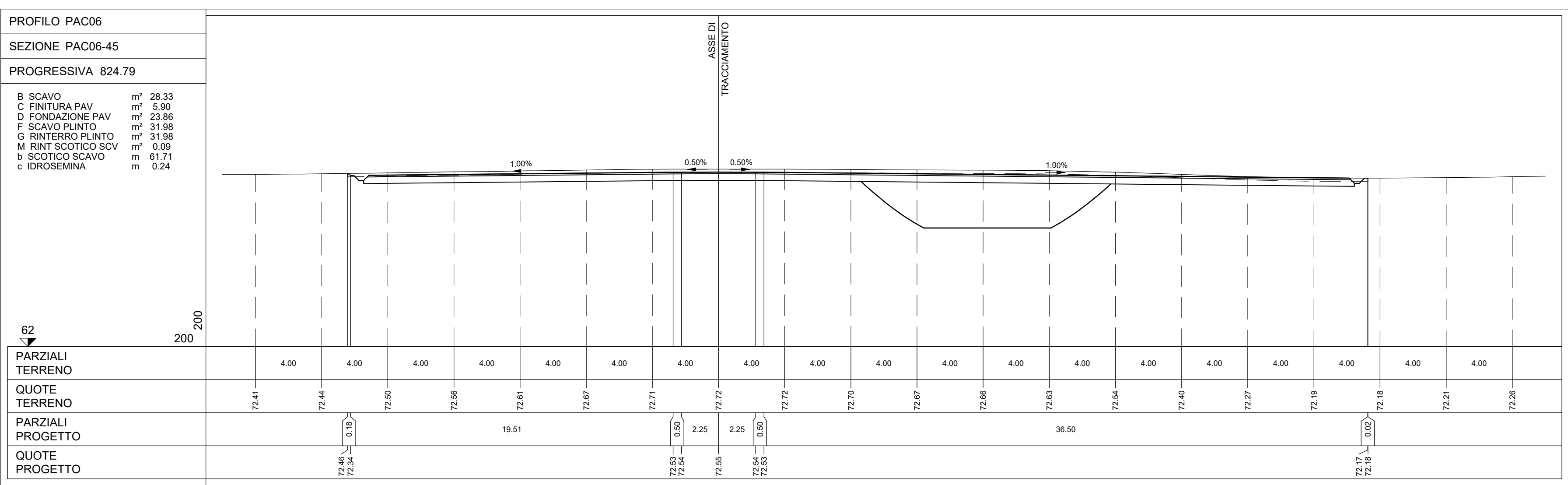
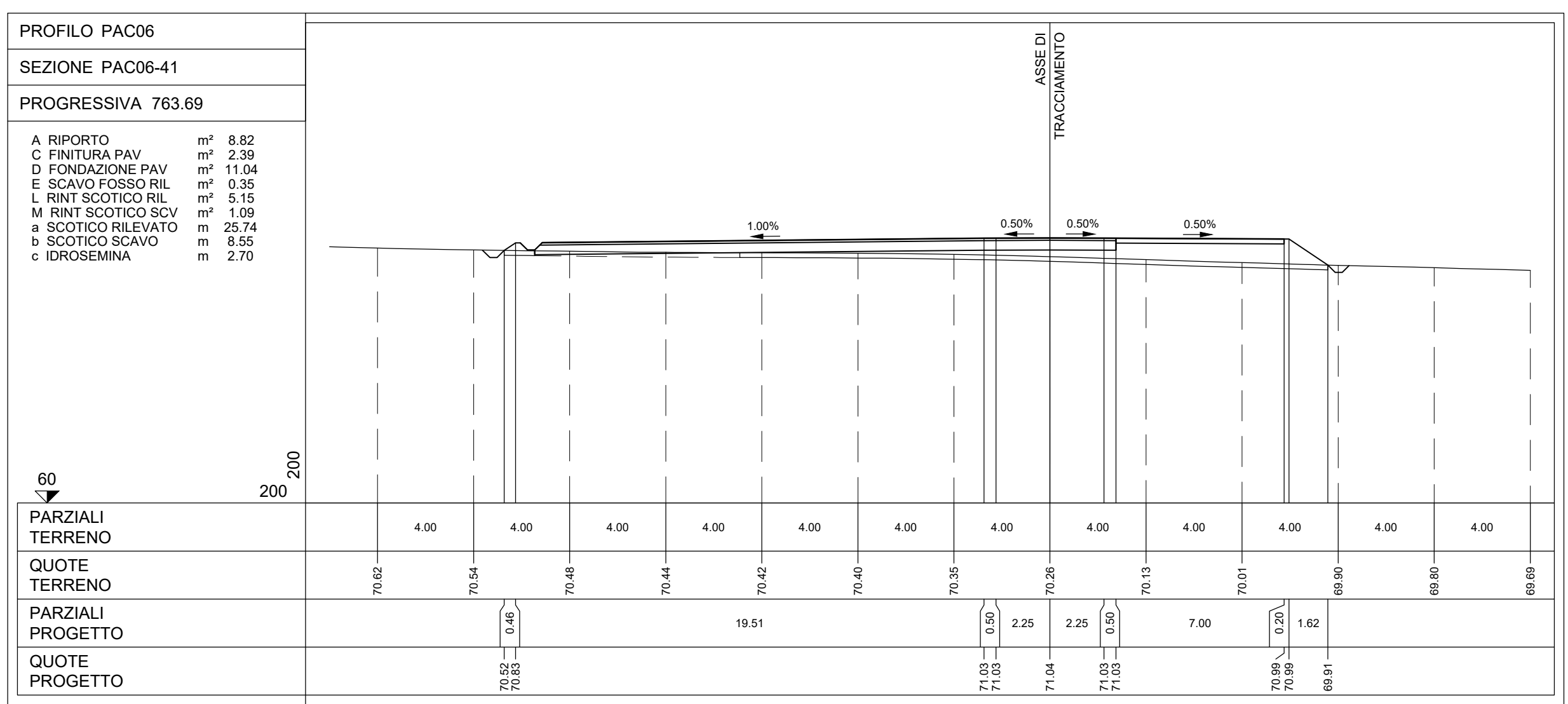
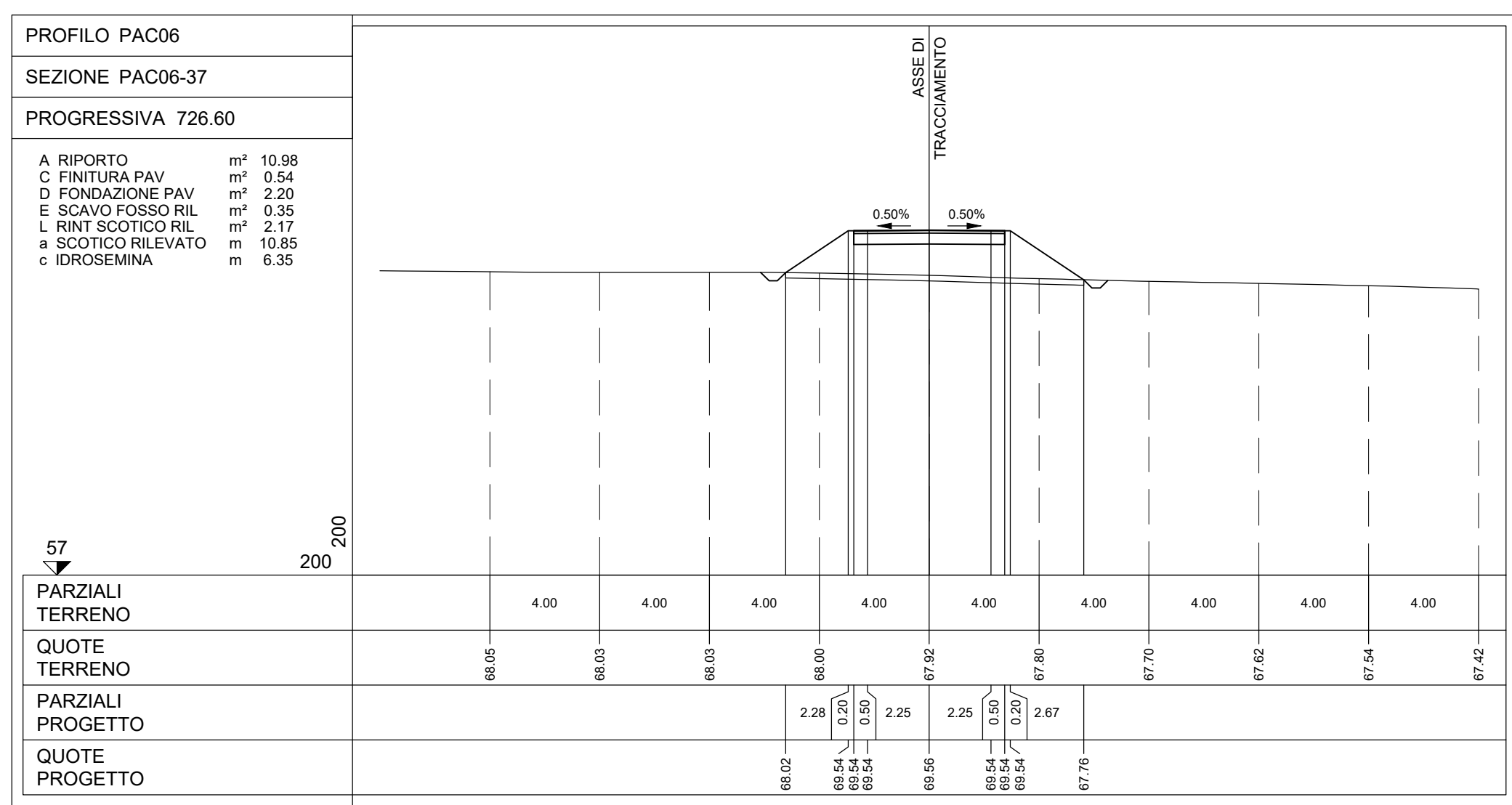
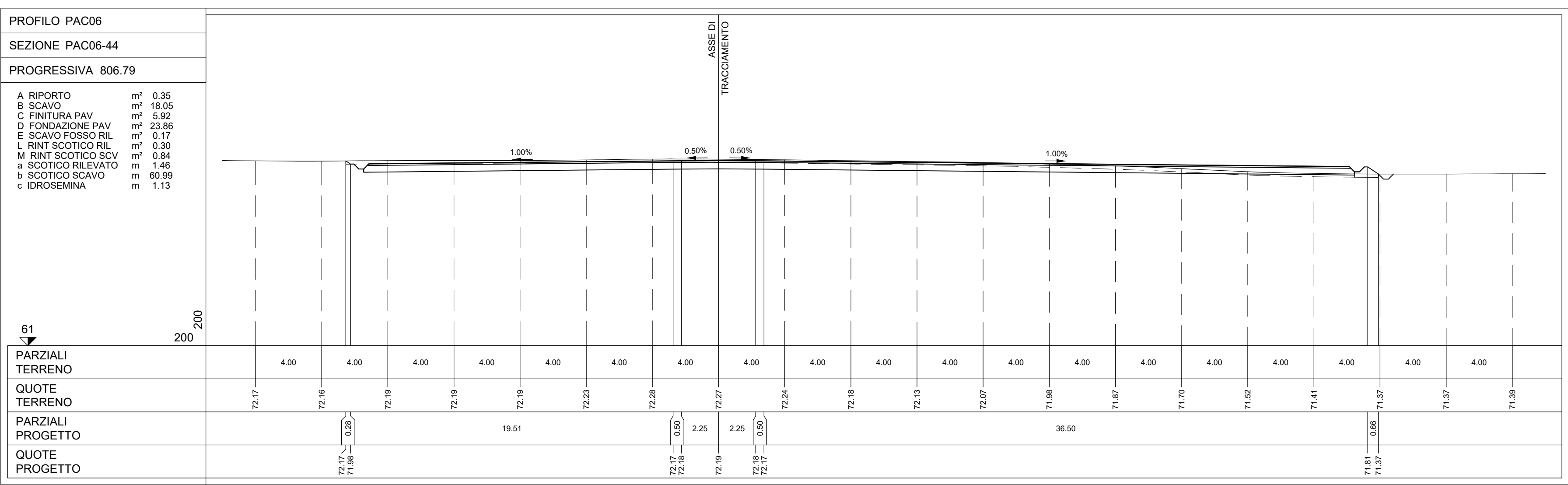
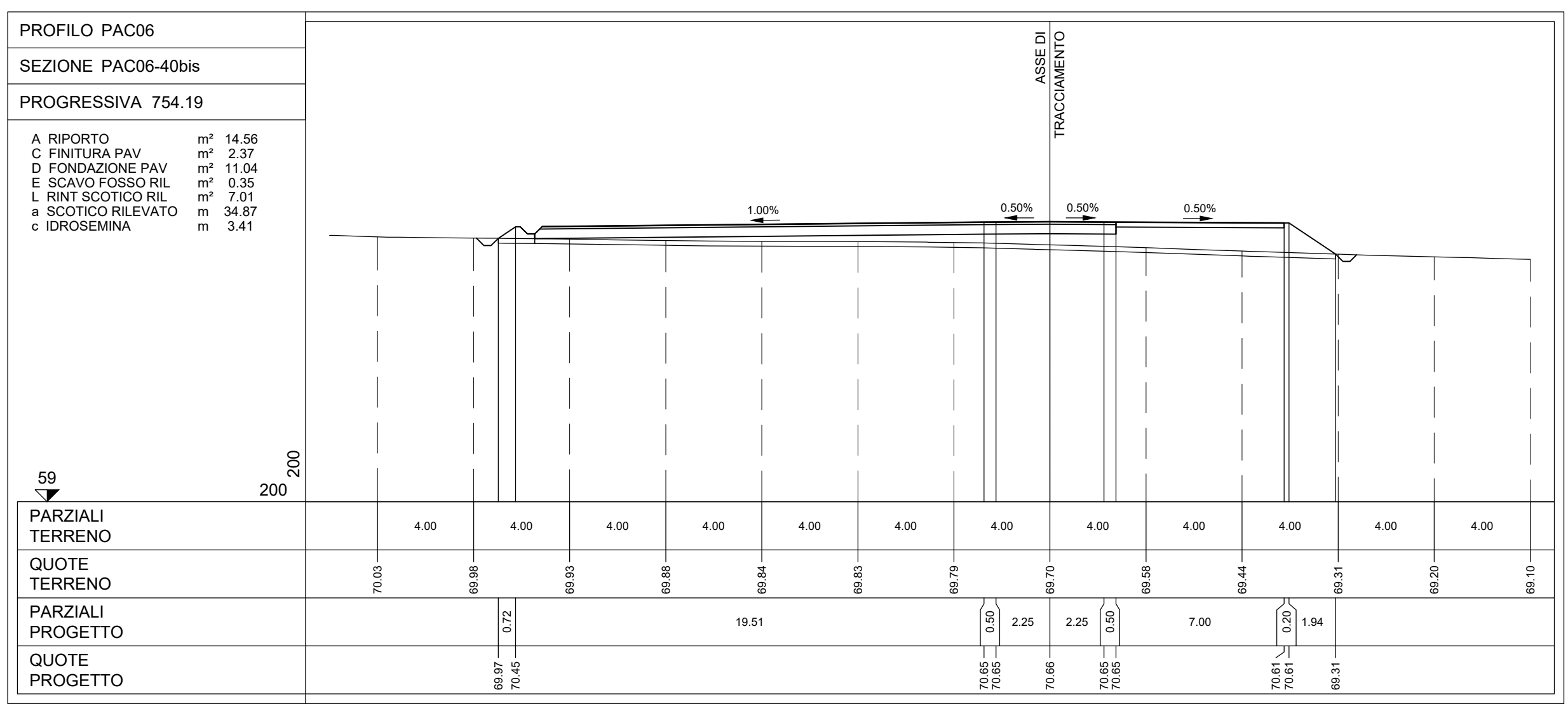
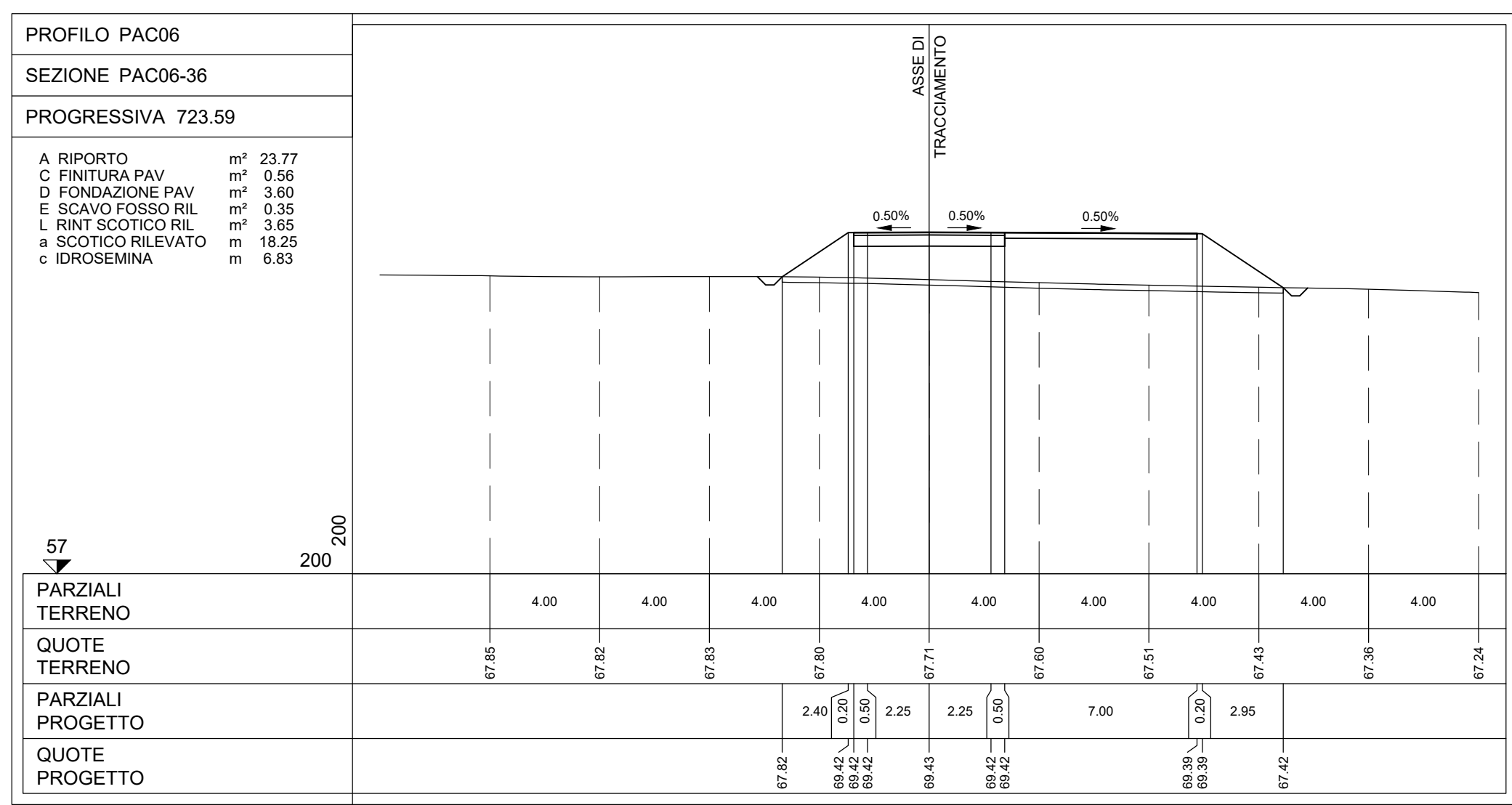
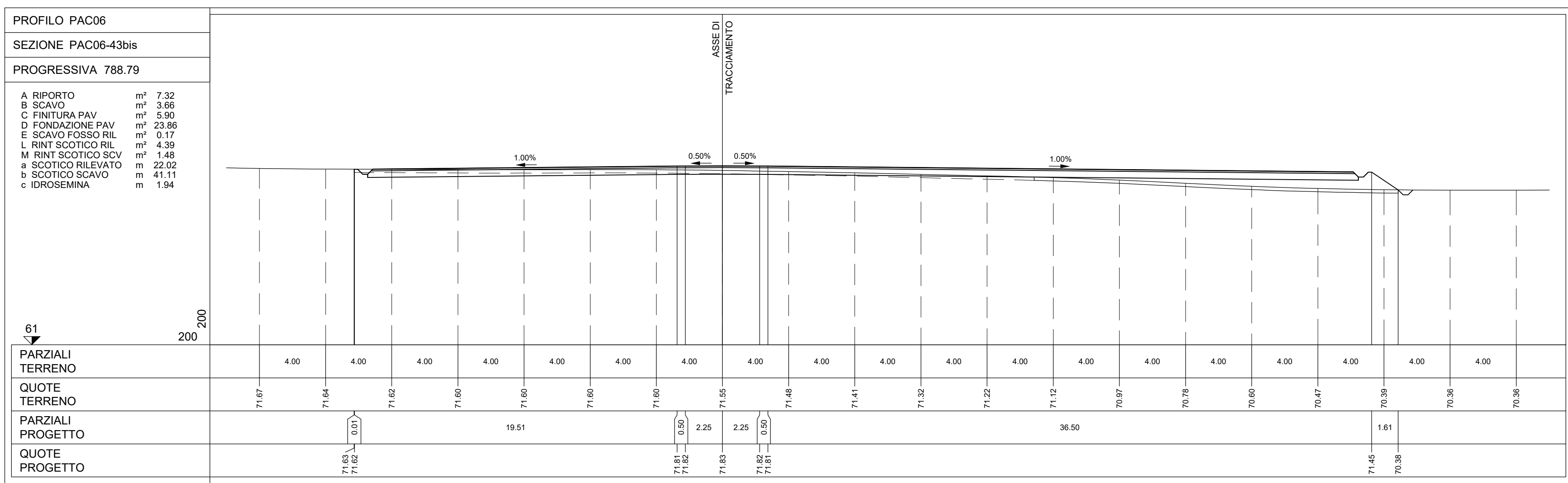
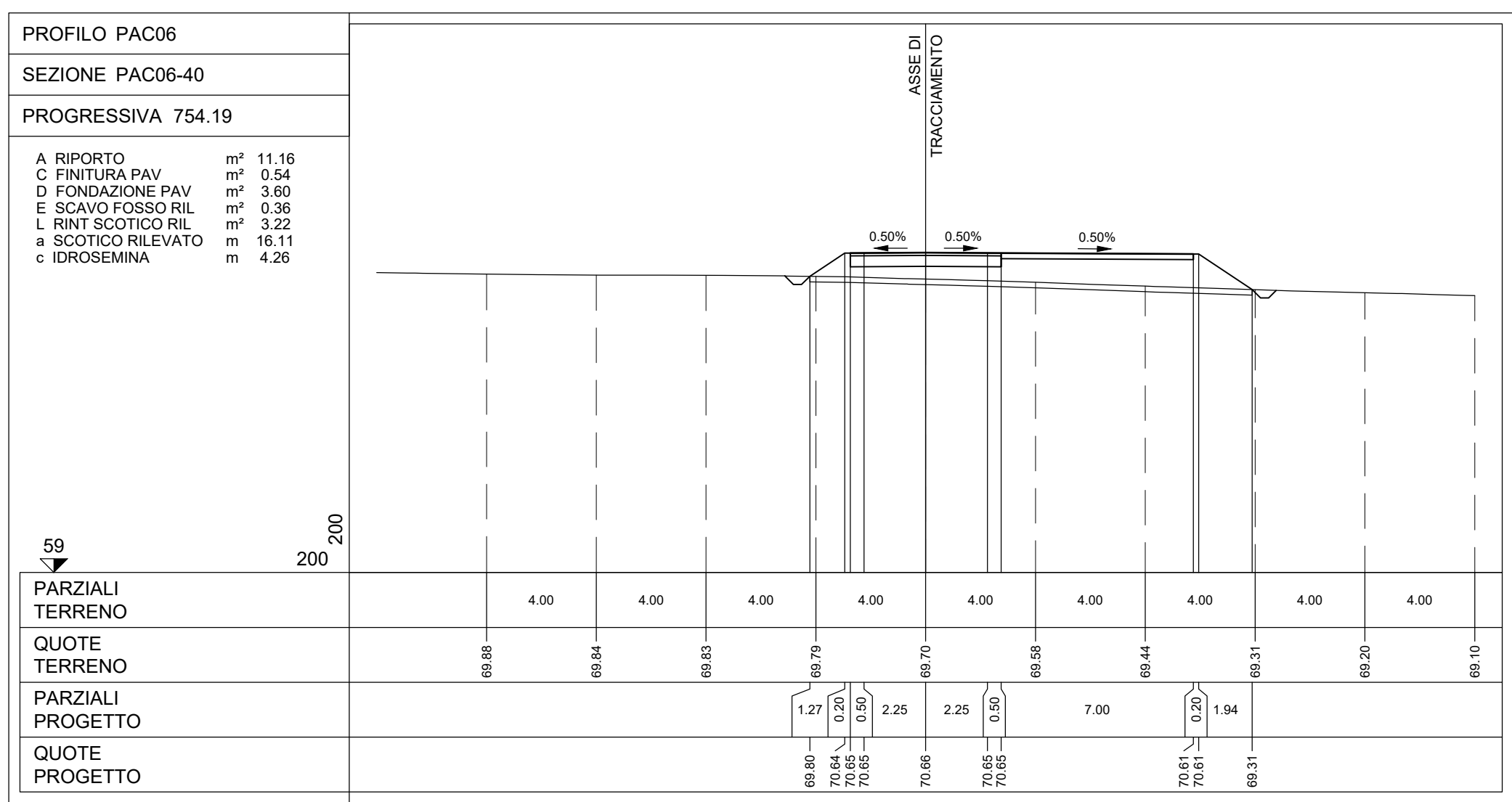
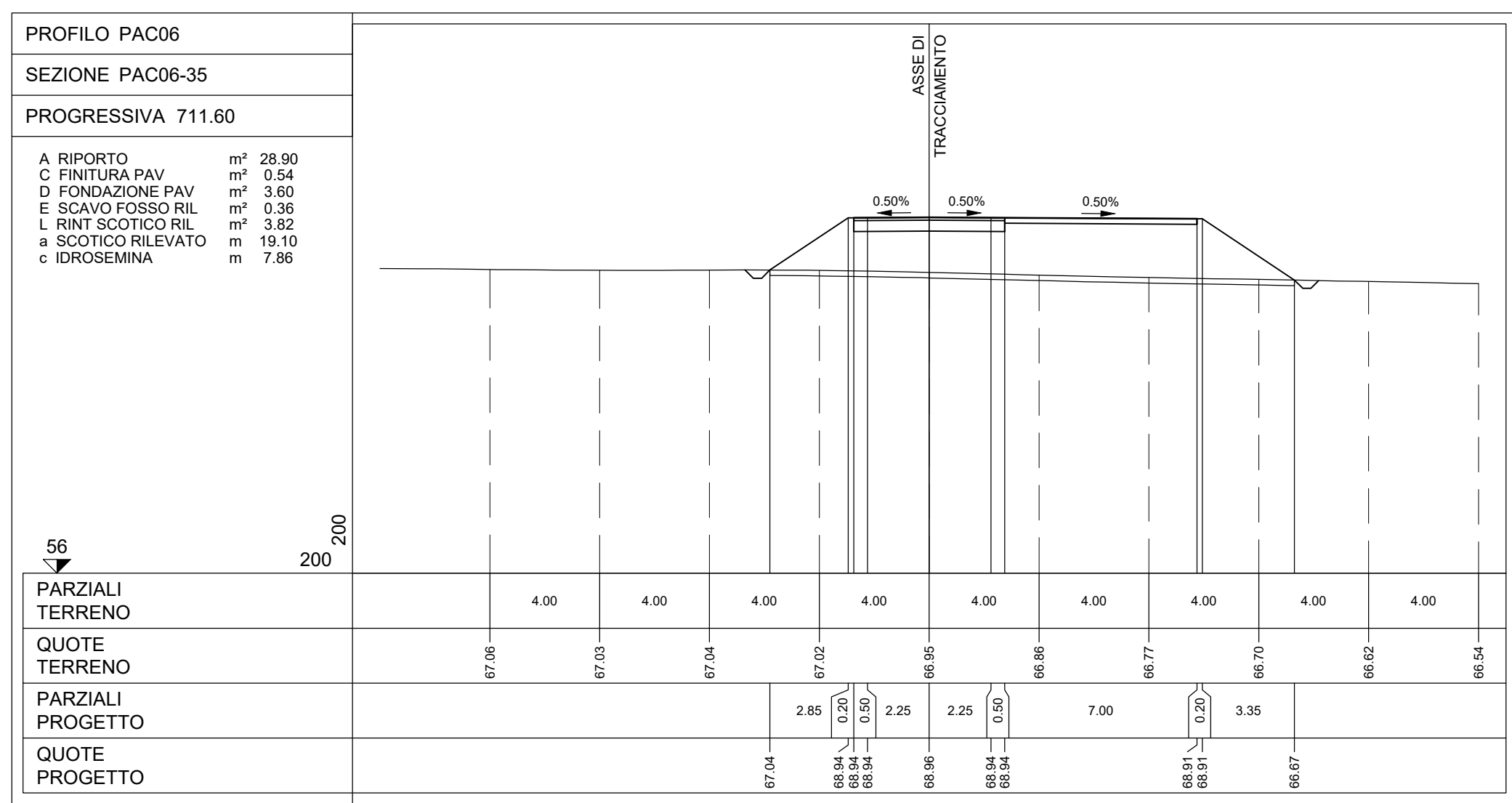

Rev.	Descrizione	EL.	NO.	CD.	07/2023
REV.	MODIFICAZIONE				

Montana
INGEGNERIA
PACECO S.R.L.
Via Angelo Fogagnoli 6, 20143 MILANO

Progetto: IMPIANTO EOLICO DA 108 MW
COMUNE DI PACECO (TP), MISUGLIEMI (TP) e TRAPANI (TP)

Tavola: PAC06 - SEZIONI TRASVERSALI PIAZZOLA
N. Tav. T12.60

Scale: 1:200

VERBA LA RIPRODUZIONE DI QUESTO DOCUMENTO SENZA PRECEDUTA AUTORIZZAZIONE SCRITTA DELLA MONTANA SPA È VIETATA.

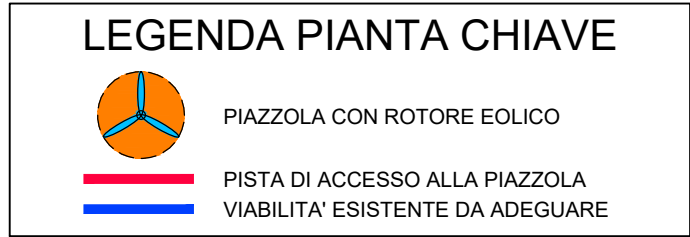
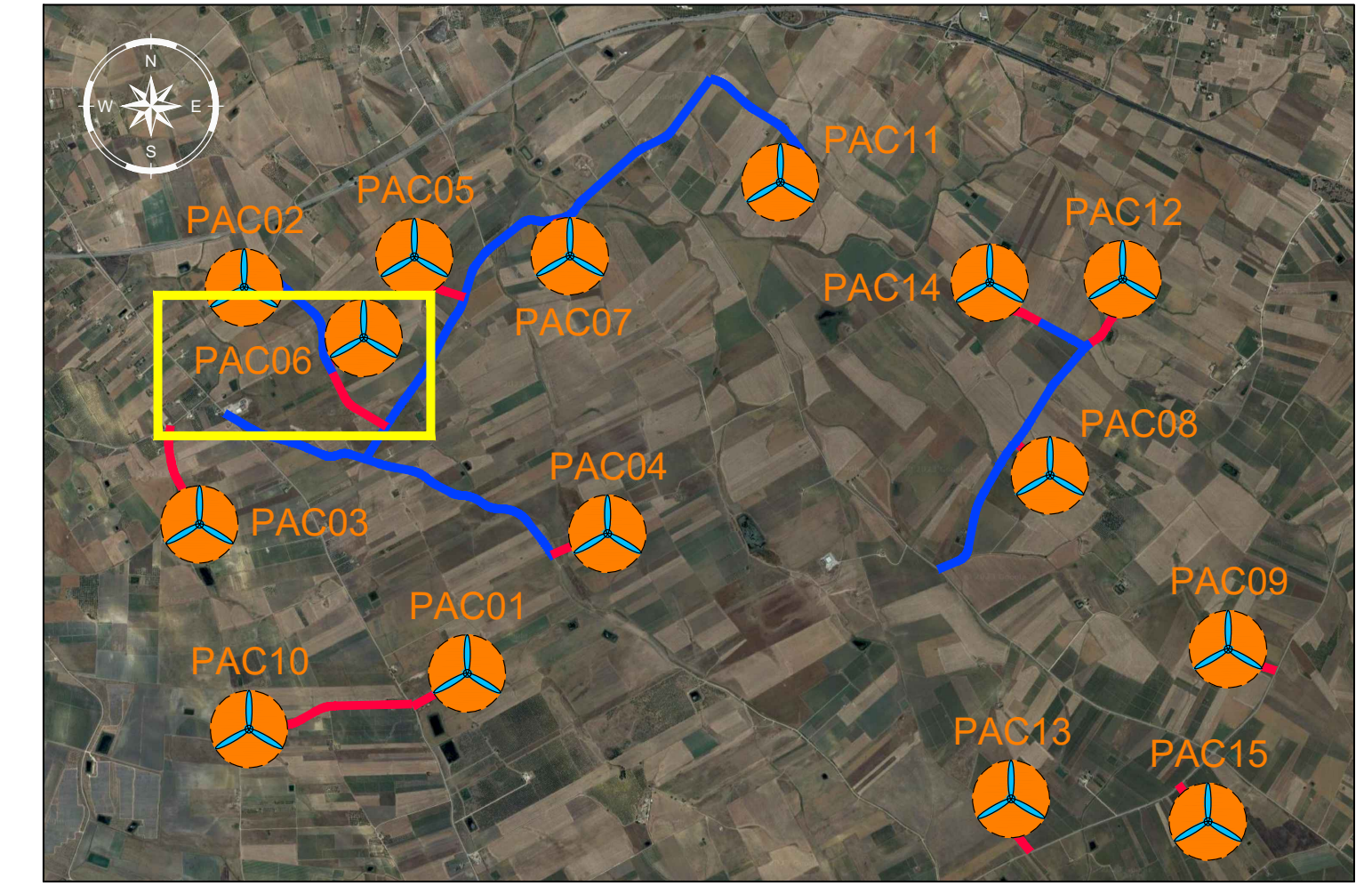
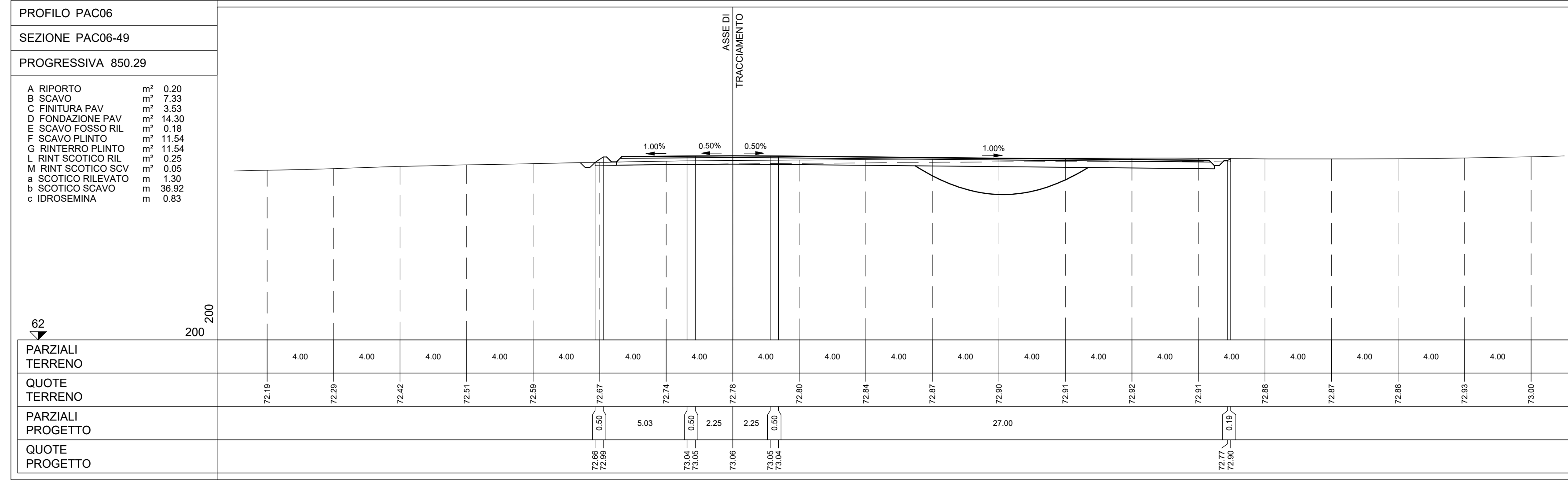
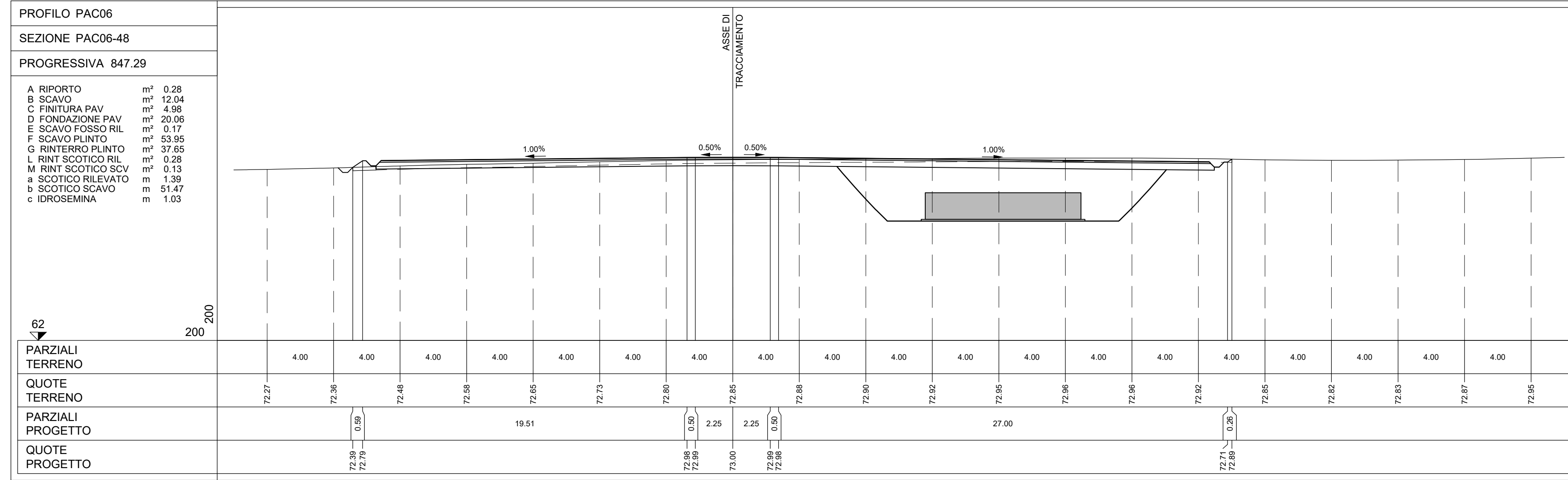
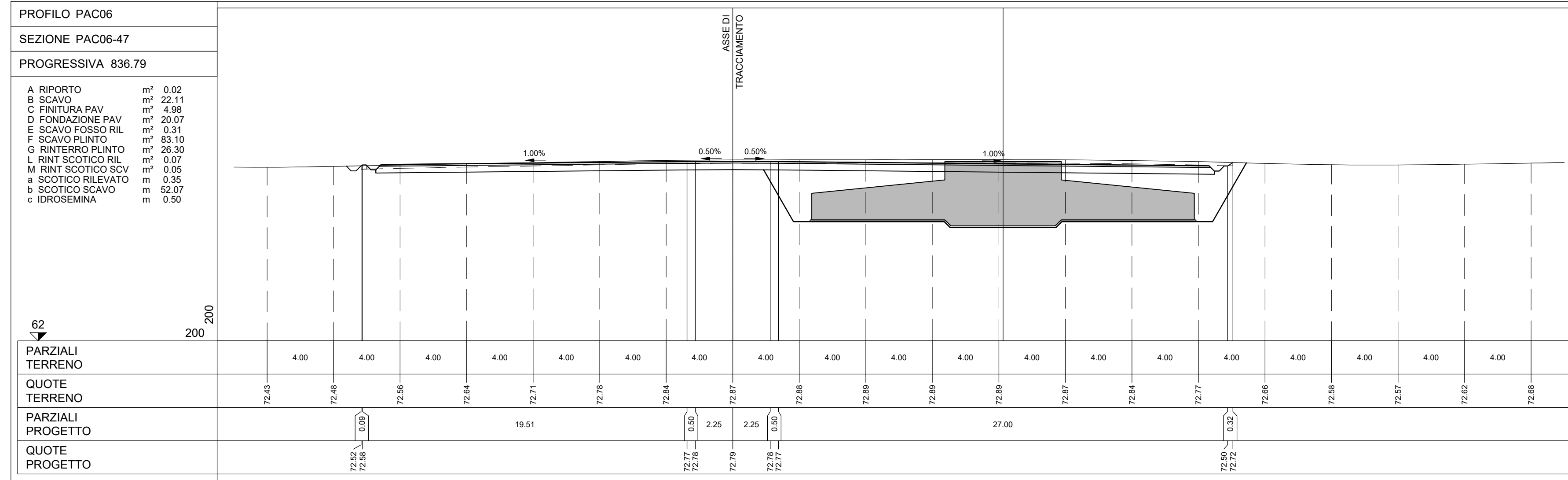

NOTE:
- PER LE UBICAZIONI E LE DIMENSIONI RELATIVE ALLE OPERE IDRAULICHE SI VEDANO LE TAVOLE SPECIFICHE.

Rev0	Emissione	TR	EL	LC	07/2023
REV.	DESCRIZIONE	DESIGN	CONTROL	APPROV.	DATA

		MontanaSpA Via Galvani 4/A - 20141 Milano www.montanaspa.com	Tel. +39 02 5418177 Fax +39 02 5418195 www.montanaspa.com	PIAZZOLE EOLICHE Cap.Soc. 600000000
Committente: PACECO S.R.L. PACECO S.R.L. VIA ANGELO FUMAGALLI 6, 20143 MILANO				
Progettisti: ING. LAURA CONTI iscritta all'Ordine degli Ingegneri della Provincia di Pavia al n. 1726				
Oggetto: IMPIANTO EOLICO DA 108 MW COMUNE DI PACECO (TP), MISILISCEMI (TP) e TRAPANI (TP)				
Titolo: PAC06 - SEZIONI TRASVERSALI PIAZZOLA 2di2				N. Tav. T12.6b
Nr. int. 2995_5531_PAC_PFFE_T12.6_REV0_PAC06-SEZIONI TRASVERSALI PIAZZOLA				Scala 1:200
E' VIETATA LA RIPRODUZIONE DI QUESTO DOCUMENTO SENZA PREVENTIVA AUTORIZZAZIONE SCRITTA DELLA MONTANA SPA				