

LEGENDA PIANTE CHIAVE

- PAZZOLA CON ROTORE EOLICO
- PISTA DI ACCESSO ALLA PAZZOLA
- VIABILITA' ESISTENTE DA ADEGUARE

NOTE:
- PER LE UBICAZIONI E LE DIMENSIONI RELATIVE ALLE OPERE IDRAULICHE SI VEDANO LE TAVOLE SPECIFICHE

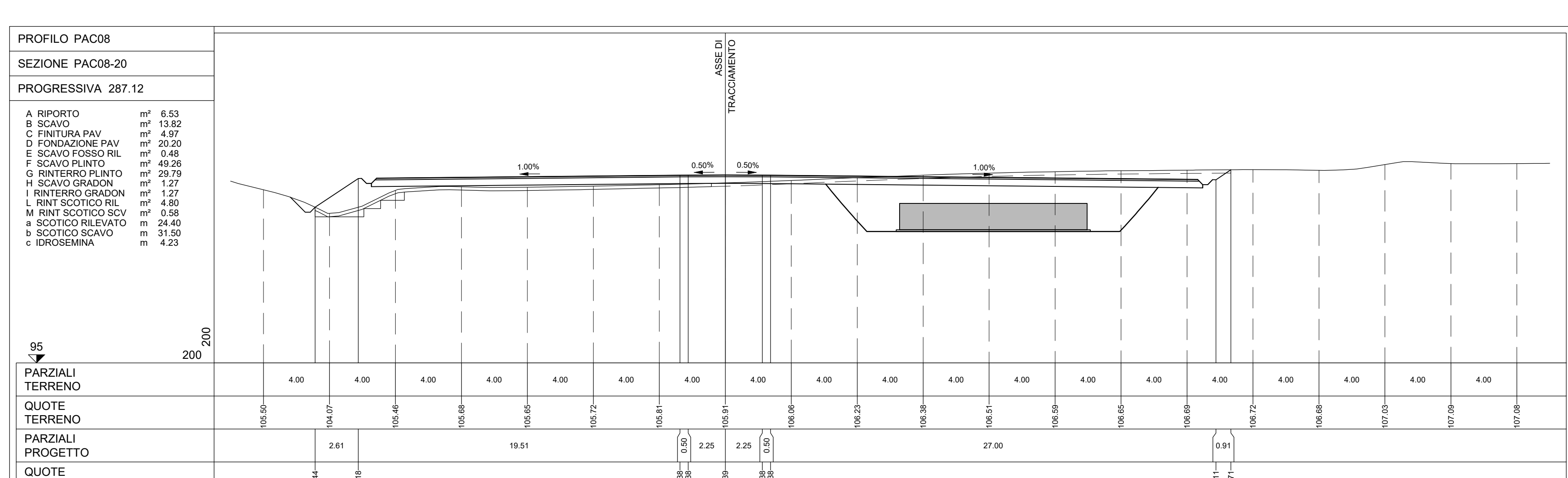
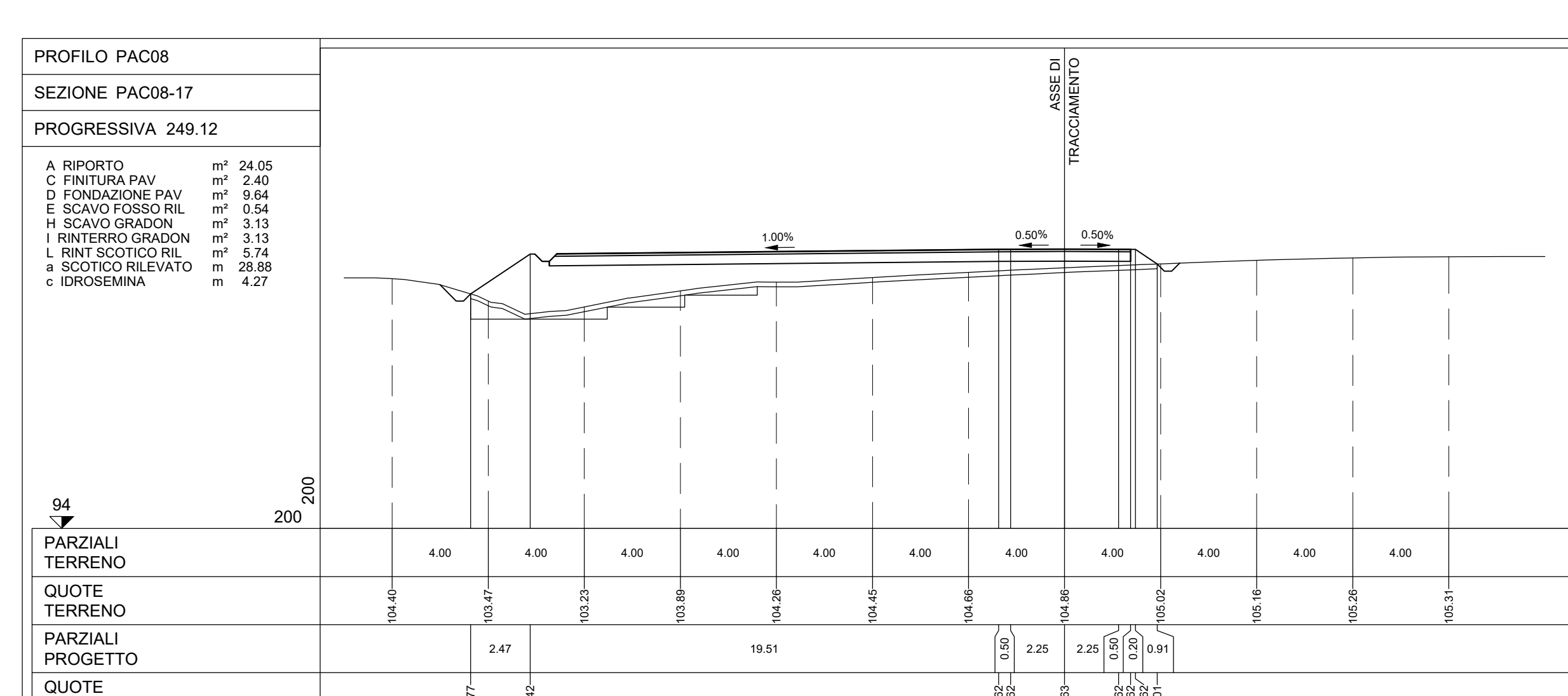
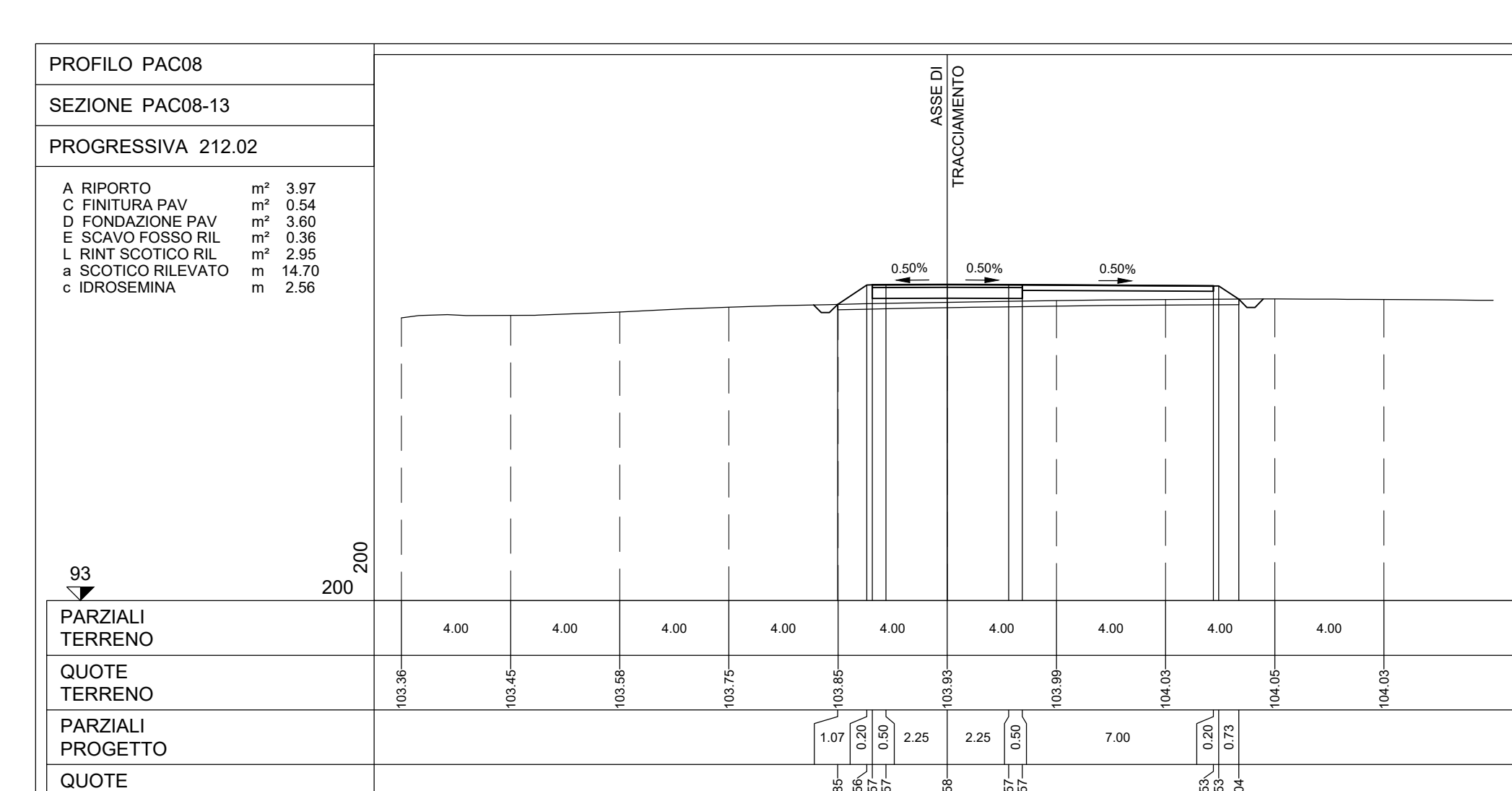
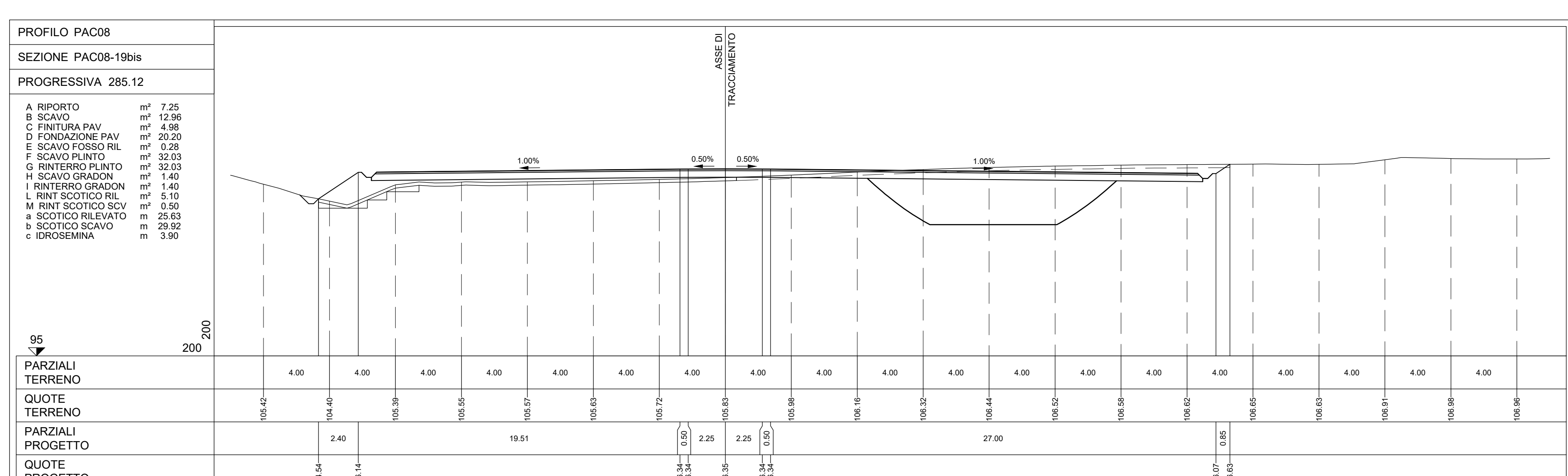
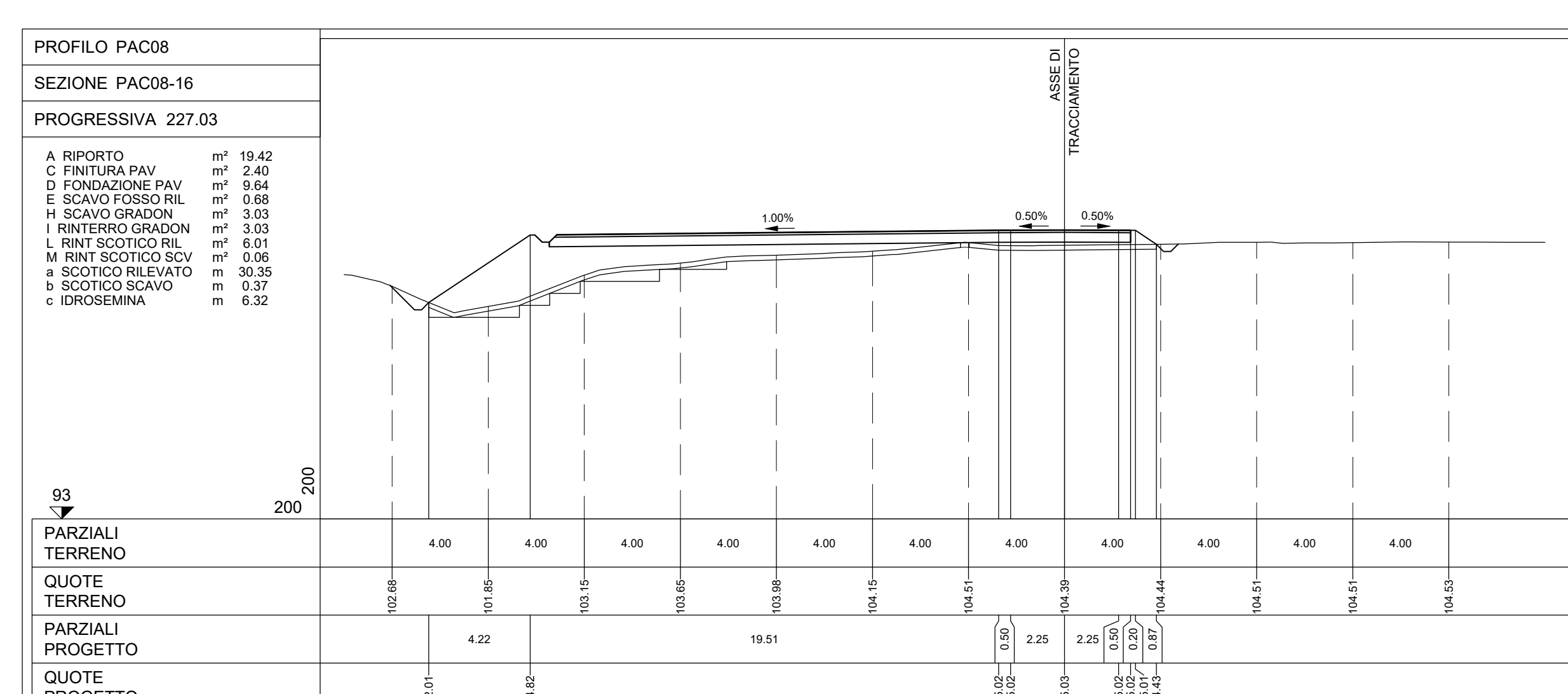
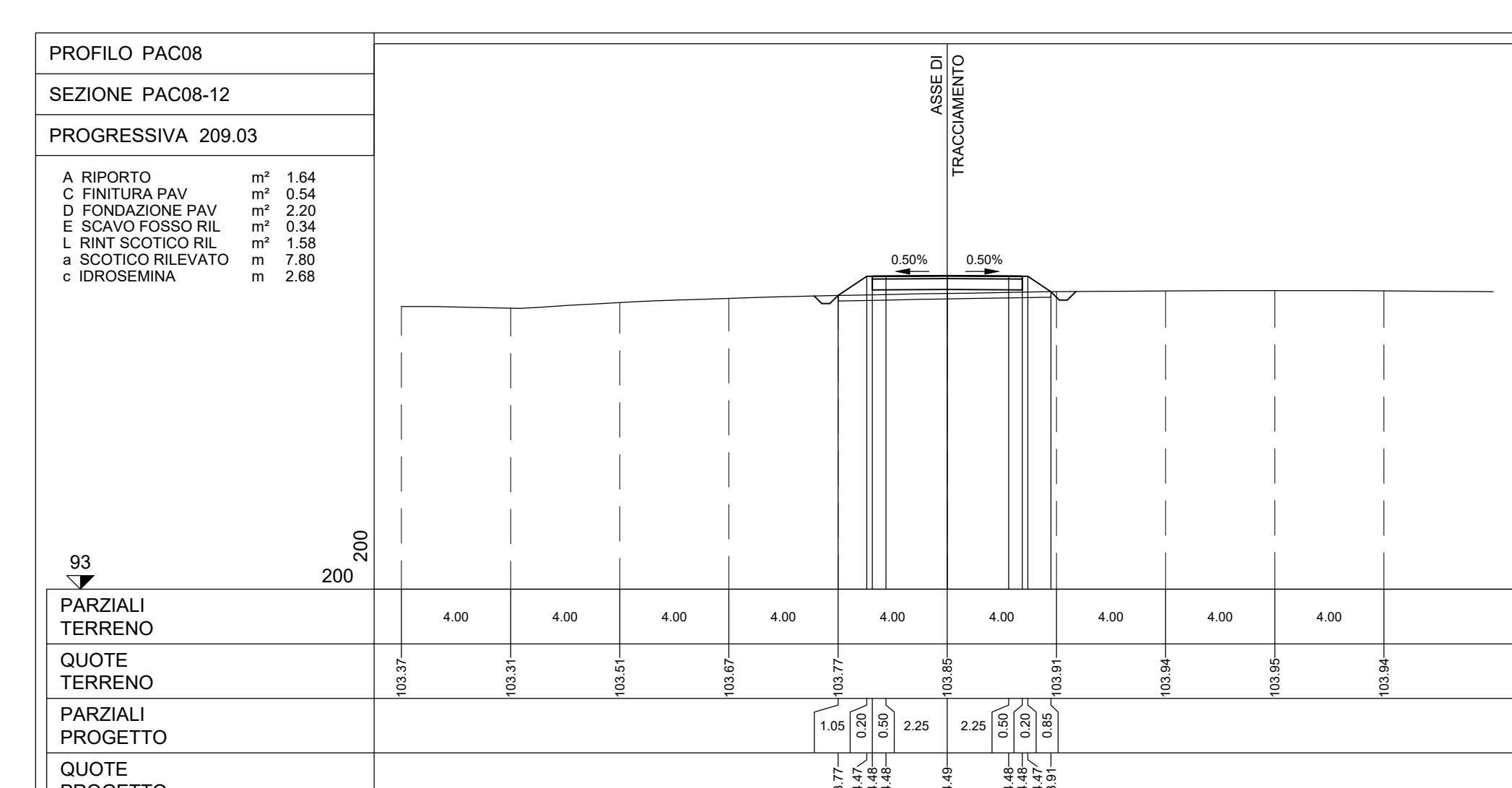
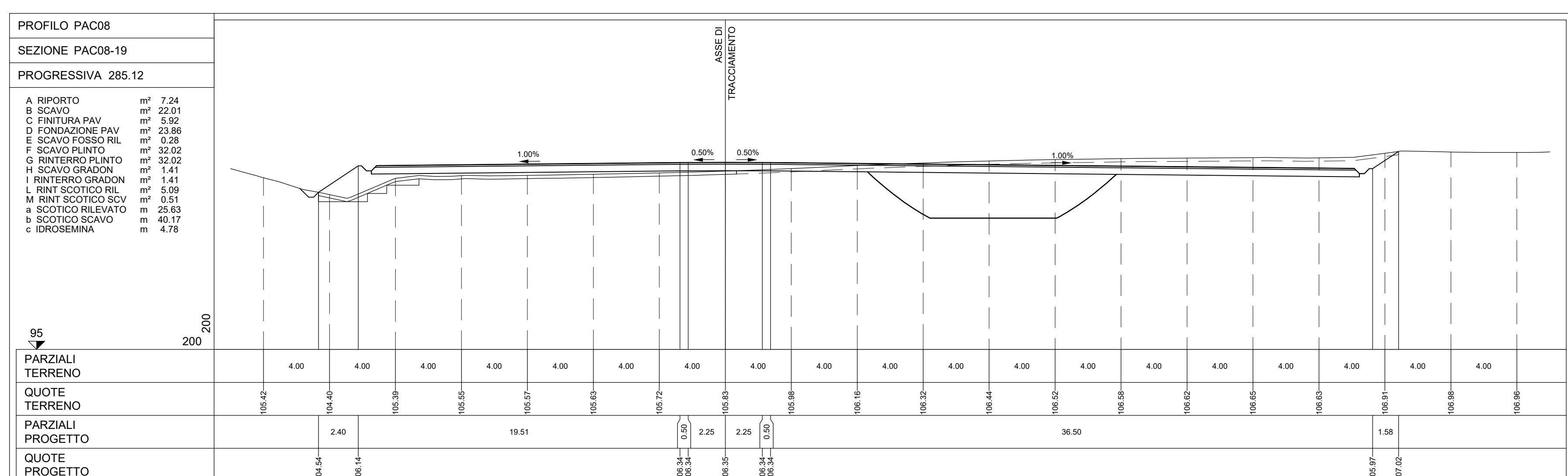
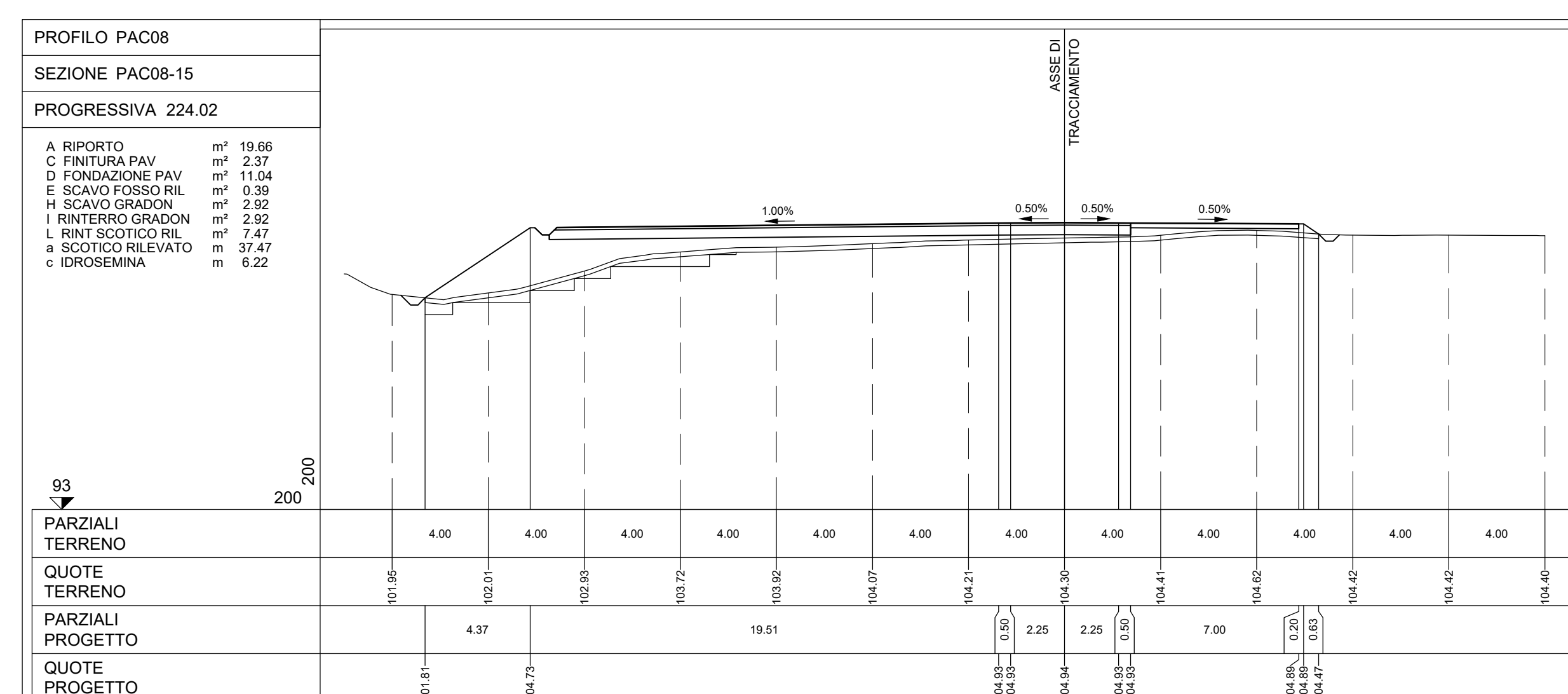
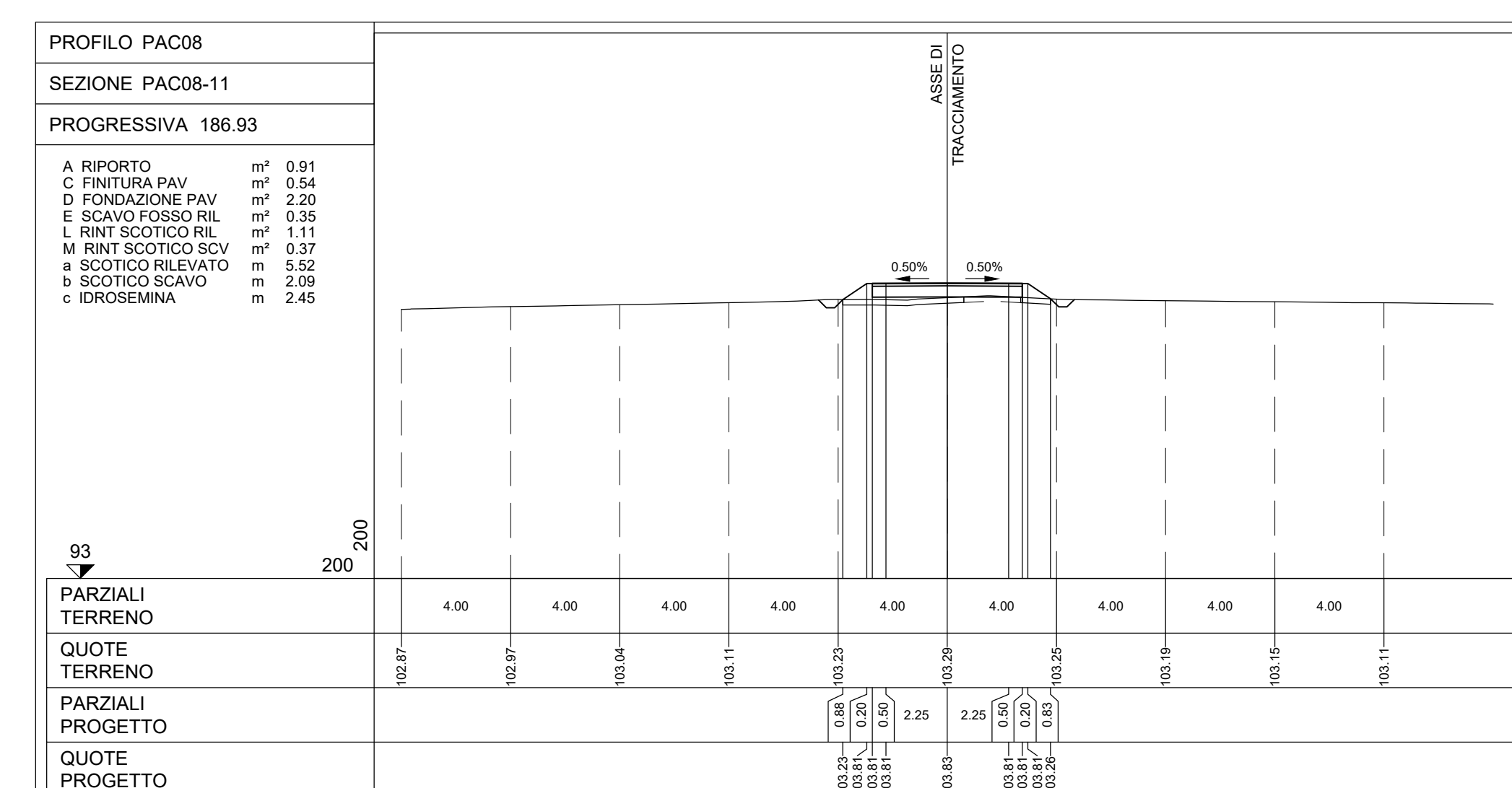
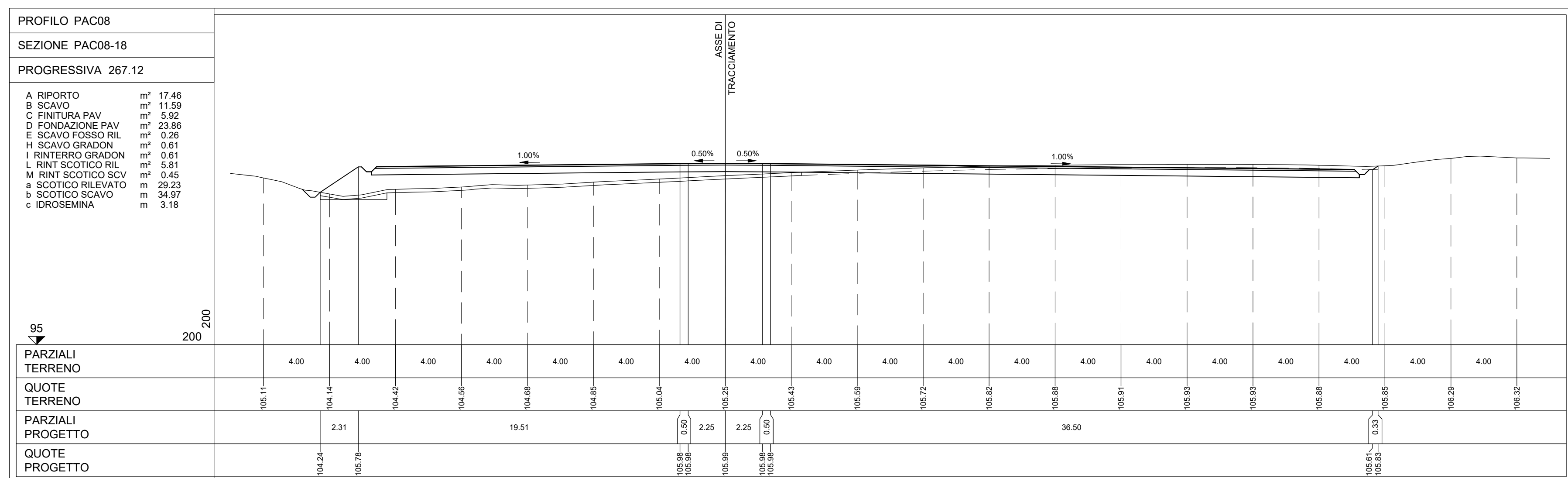
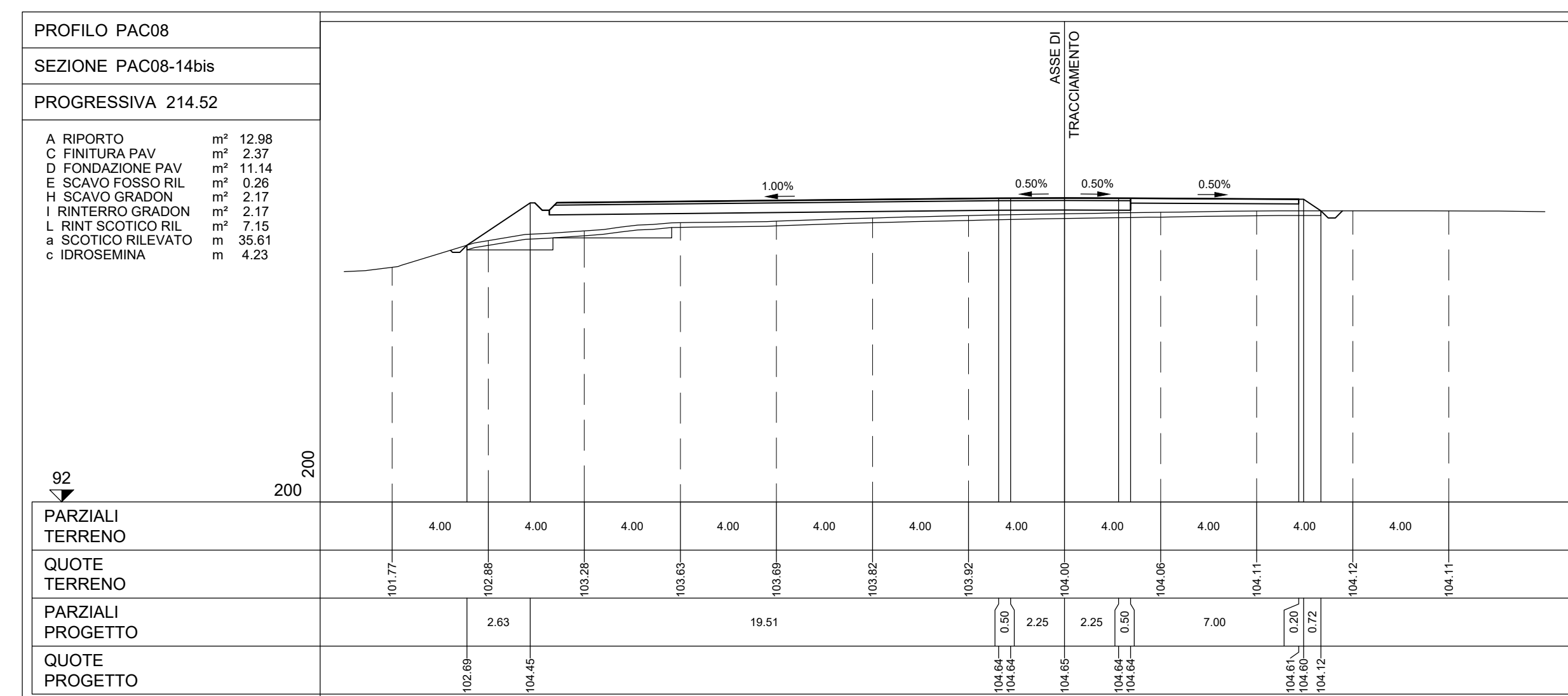
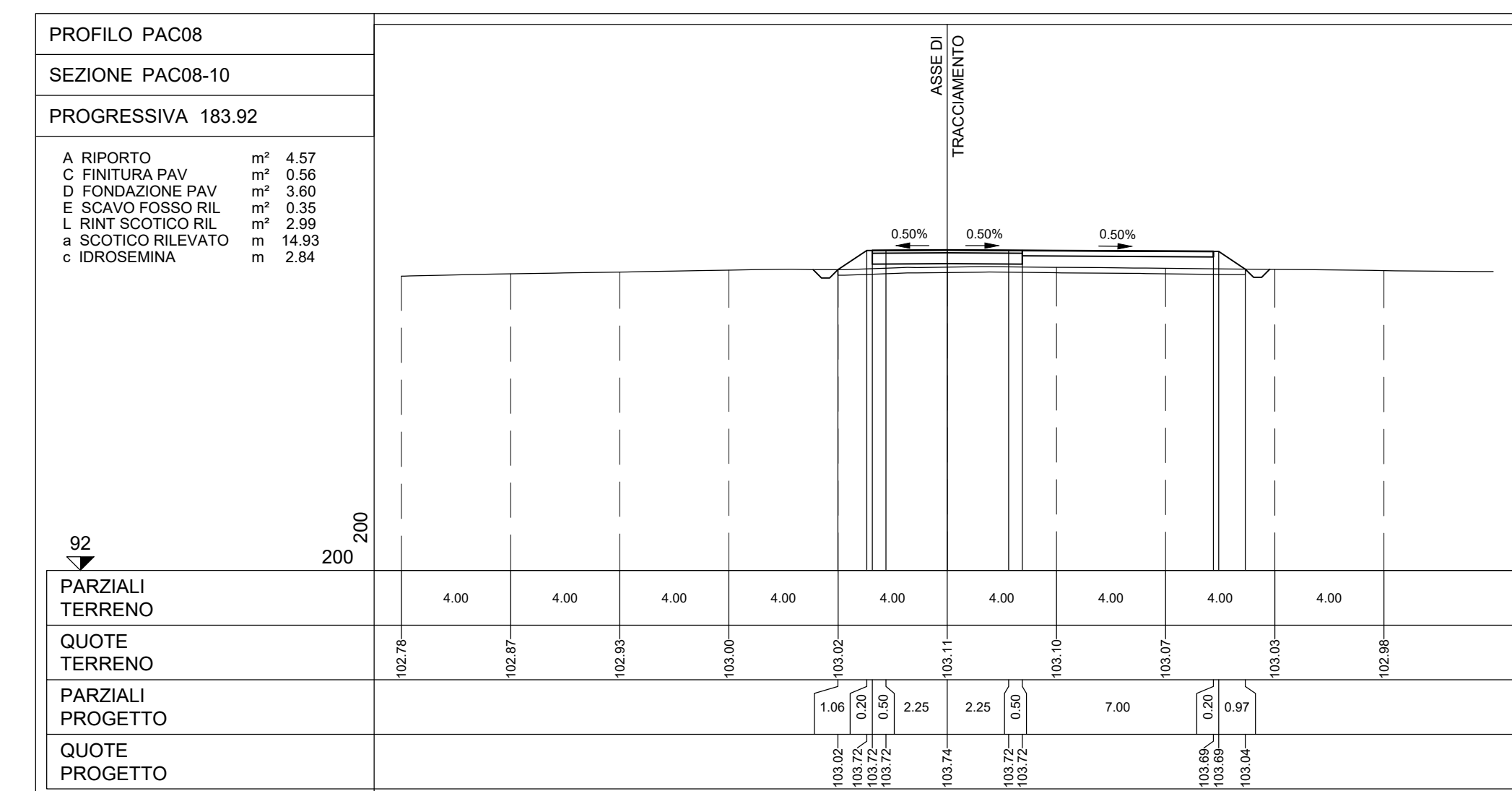
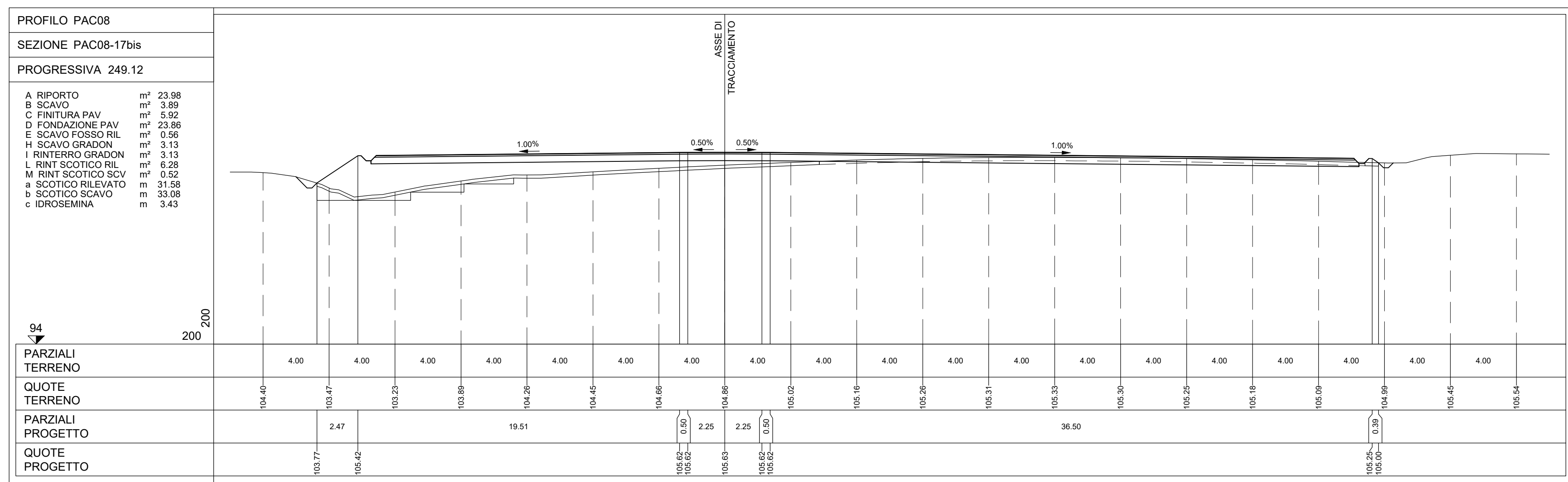
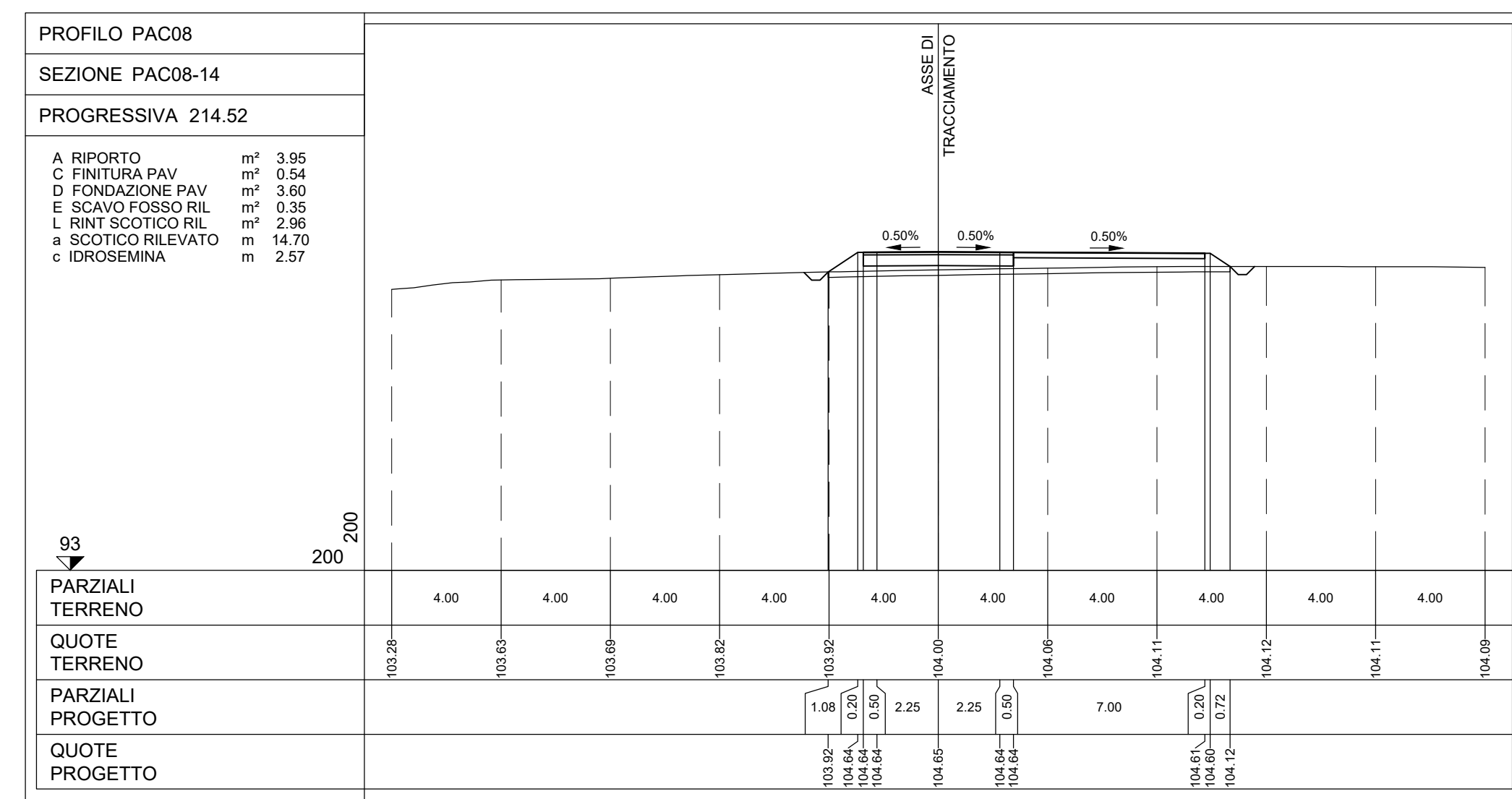
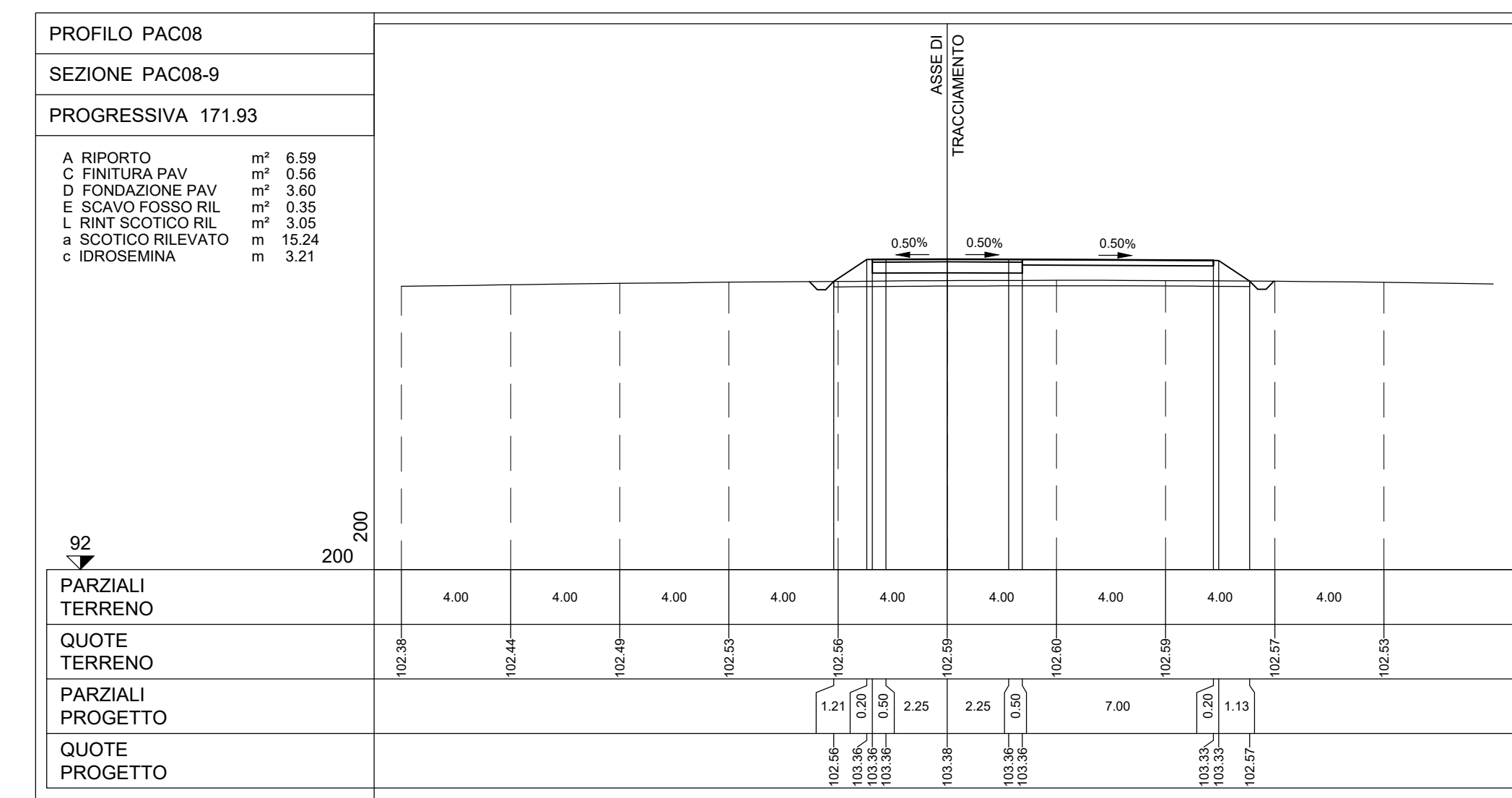

Rev.	Descrizione	El.	Di.	07/2023
REV.	MODIFICAZIONE	0001	0001	0001

Montana INGEGNERIA E ARCHITETTURA

PACCO S.R.L. VA ANGELO FUMAGALLI 6, 20143 MILANO

OGGETTO: IMPIANTO EOLICO DA 108 MW
COMUNE DI PACCO (TP), MISUGLIEMI (TP) e TRAPANI (TP)

TAVOLA: PAC08 - SEZIONI TRASVERSALI PAZZOLA T12.8a

NUM. AUT. 3393_5531_PAC_PTE_T12.8_REV.08-2023-SEZIONI TRASVERSALI PAZZOLA
E' VIETATA LA RIPRODUZIONE DI QUESTO DOCUMENTO SENZA PREVIATA AUTORIZZAZIONE SCRITTA DELLA MONTANA SPA

**PACECO
PIANTA CHIAVE**

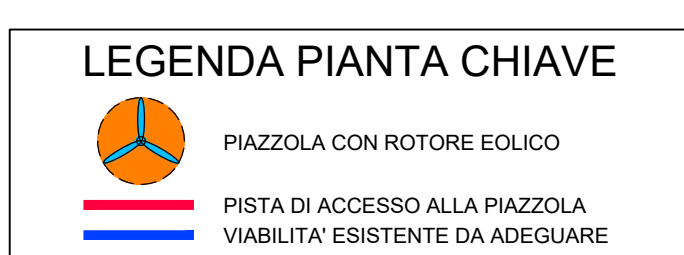
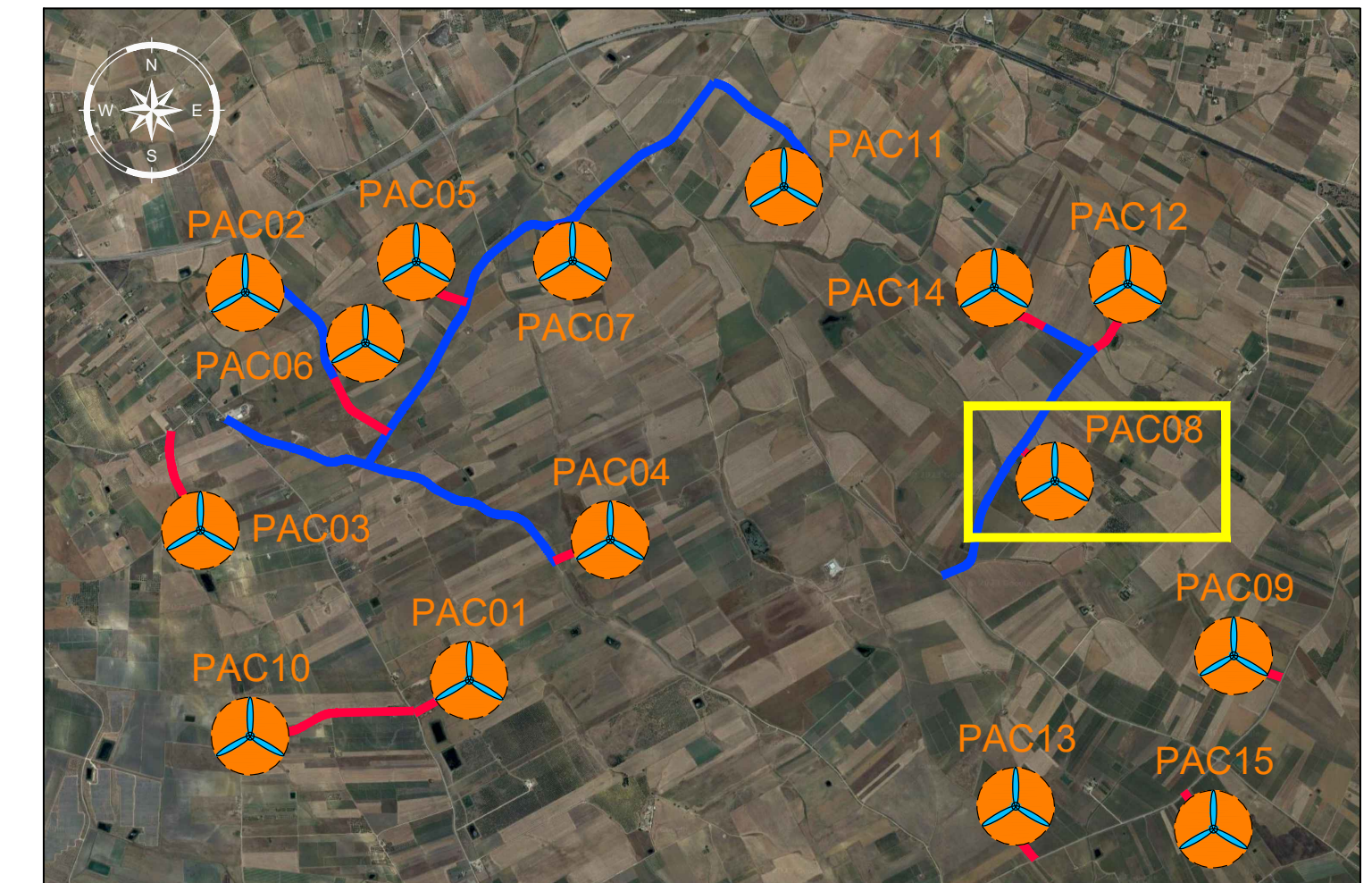

NOTE:
- PER LE UBICAZIONI E LE DIMENSIONI RELATIVE ALLE OPERE IDRAULICHE SI VEDANO LE TAVOLE SPECIFICHE.

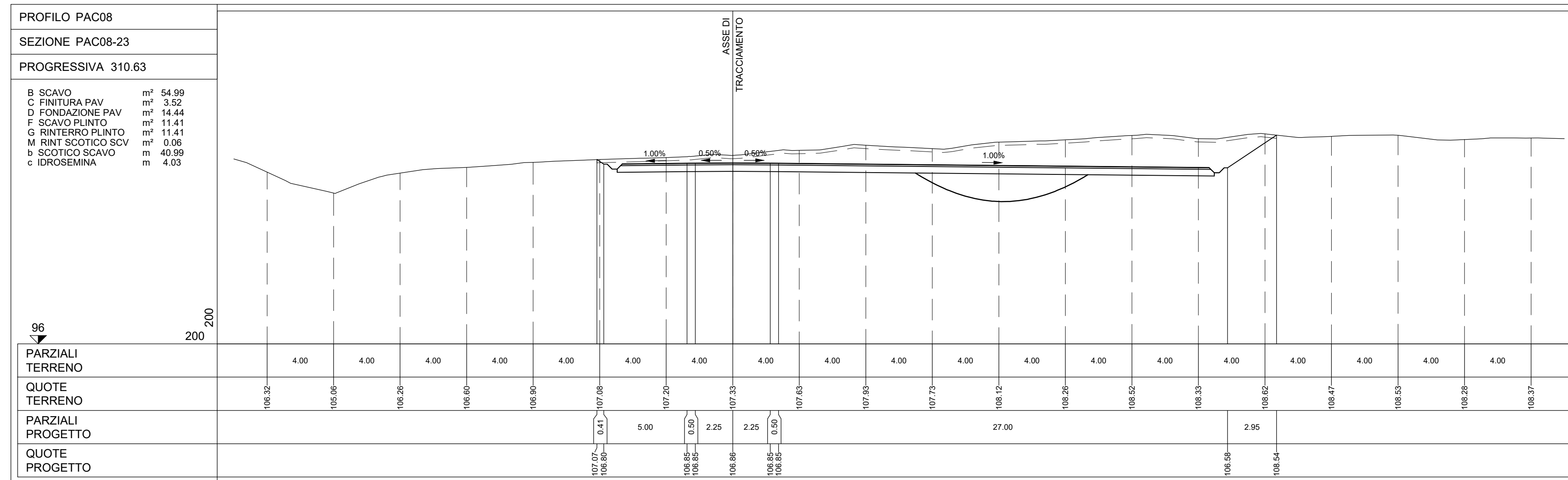
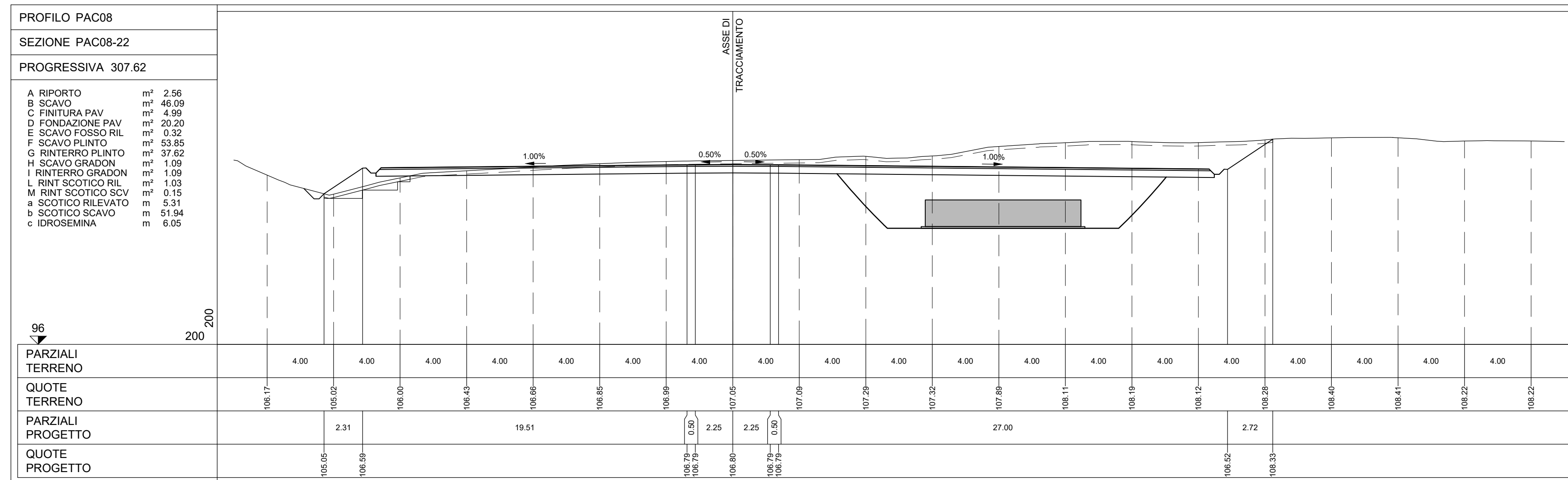
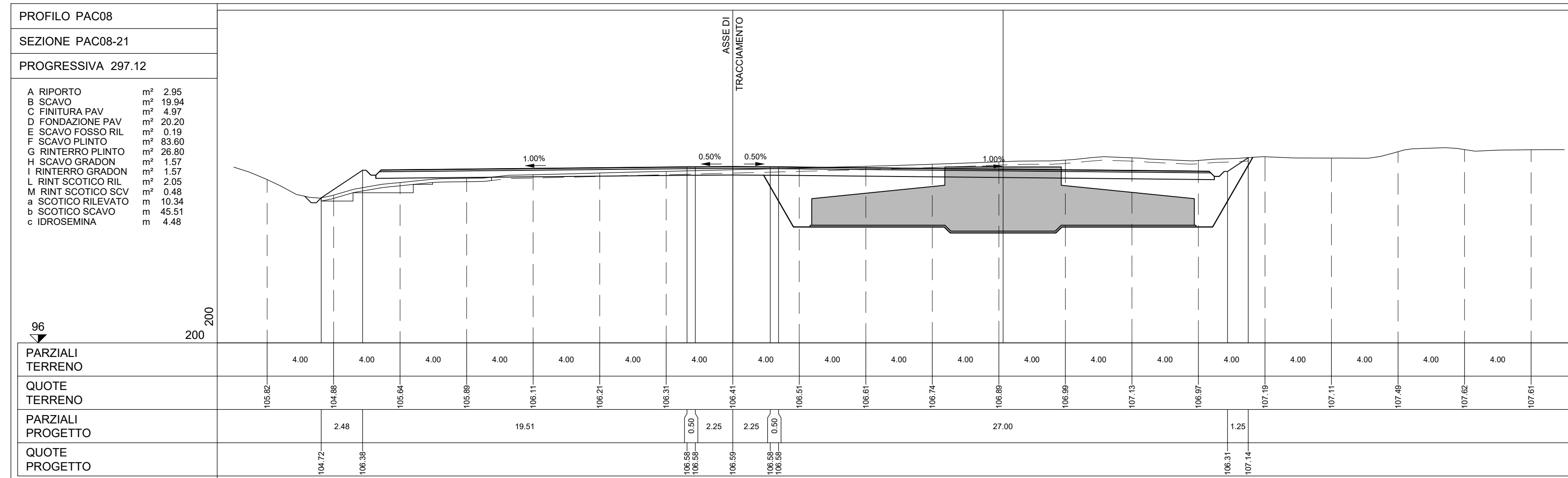

Rev0	Emissione	TR	EL	LC	07/2023
REV.	DESCRIZIONE	DESIGN	CONTROL	APPROV	DATA

		Montana SpA Via Galvani 4, 20151 Milano Milano (tel) 02 54118177 Fax 02 54118195 www.montanabiosystem.com		PIAZZOLA 001056 Cap.Soc. 000000000	
		Milano Padova Bologna Roma Venezia			
Committente PACECO S.R.L. PACECO S.R.L. VIA ANGELO FUMAGALLI 6, 20143 MILANO					
Progettisti ING. LAURA CONTI iscritta all'Ordine degli Ingegneri della Provincia di Pavia al n. 1726					
Oggetto IMPIANTO EOLICO DA 108 MW COMUNE DI PACECO (TP), MISILISCEMI (TP) e TRAPANI (TP)					
Titolo PAC08 - SEZIONI TRASVERSALI PIAZZOLA					N. Tav. T12.8b
No. int. 2995_5531_PAC_PFFE_T12.8_REV0_PAC08-SEZIONI TRASVERSALI PIAZZOLA					Scala 1:200
E' VIETATA LA RIPRODUZIONE DI QUESTO DOCUMENTO SENZA PREVENTIVA AUTORIZZAZIONE SCRITTA DELLA MONTANA SPA					