

NOTE:  
- PER LE UBICAZIONI E LE DIMENSIONI RELATIVE ALLE OPERE IDRAULICHE SI VEDANO LE TAVOLE SPECIFICHE.

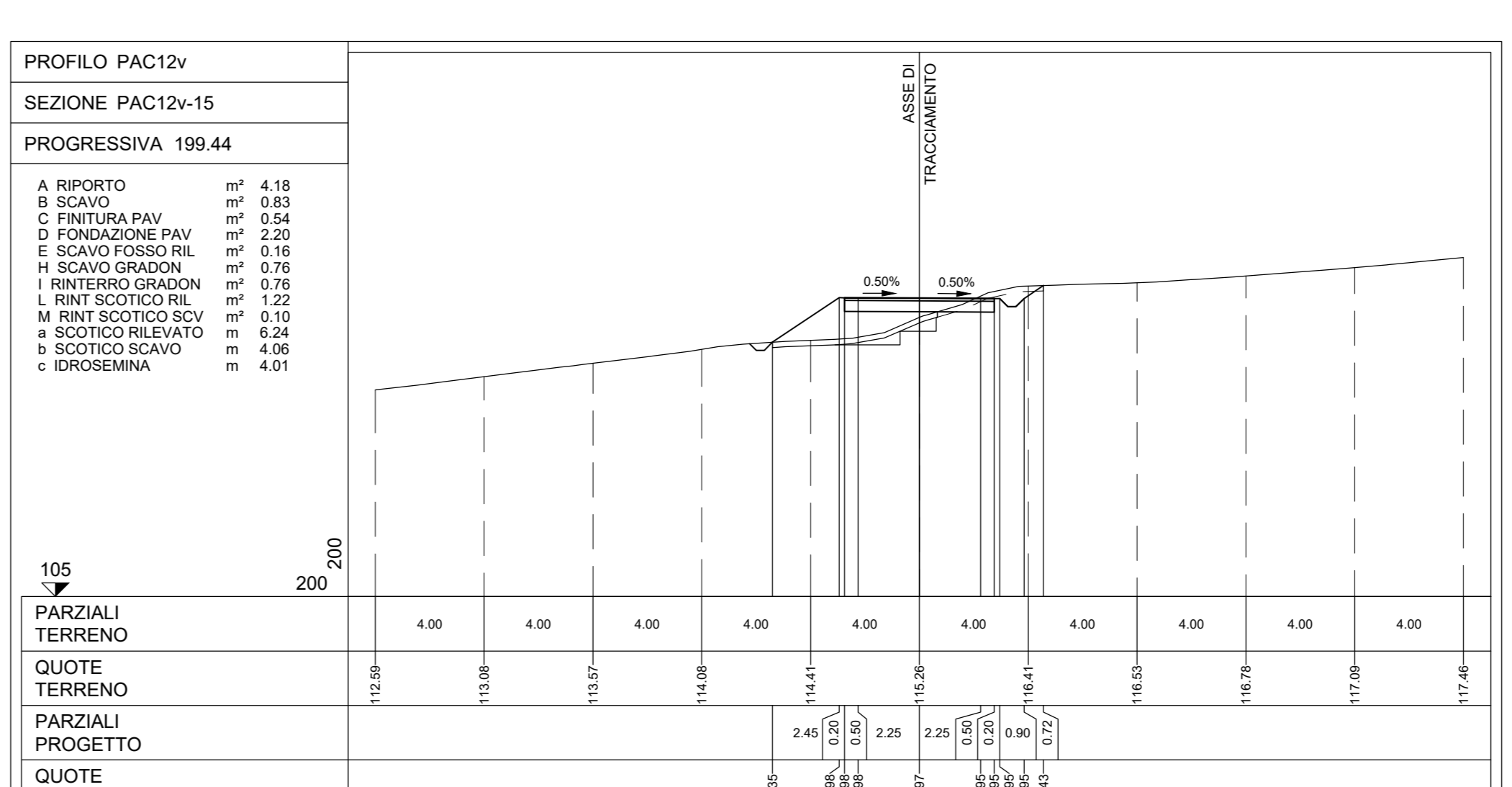
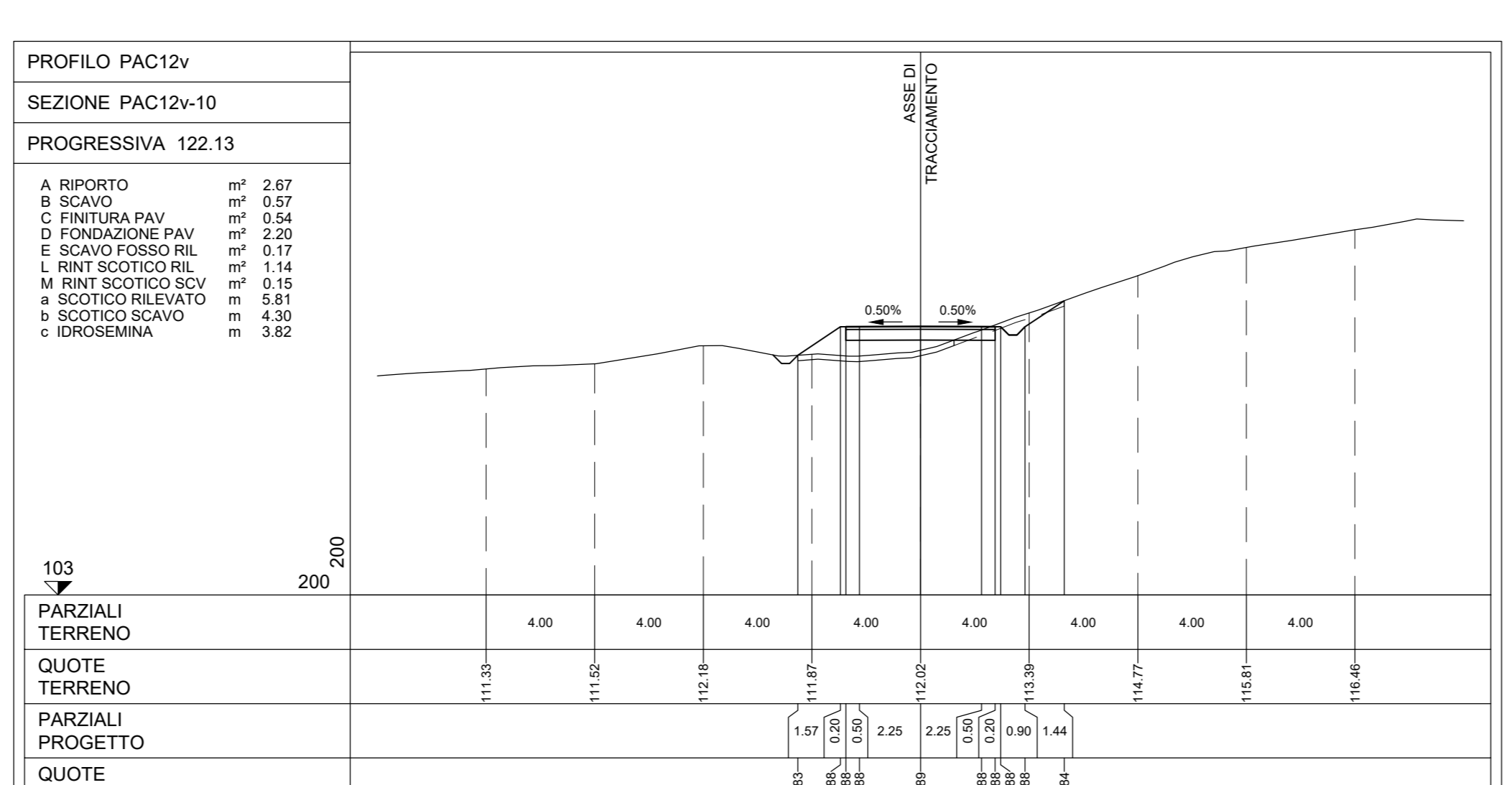
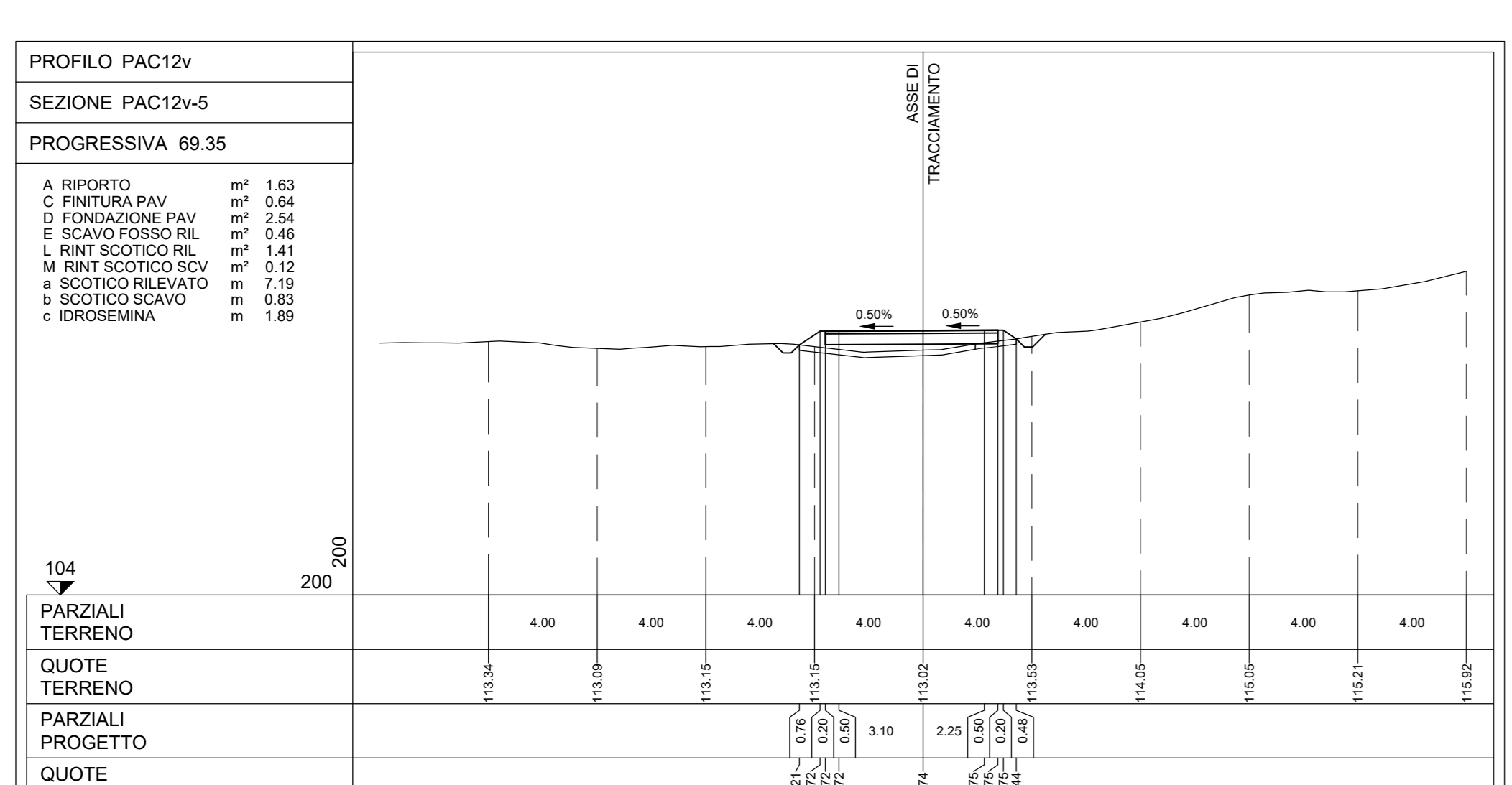
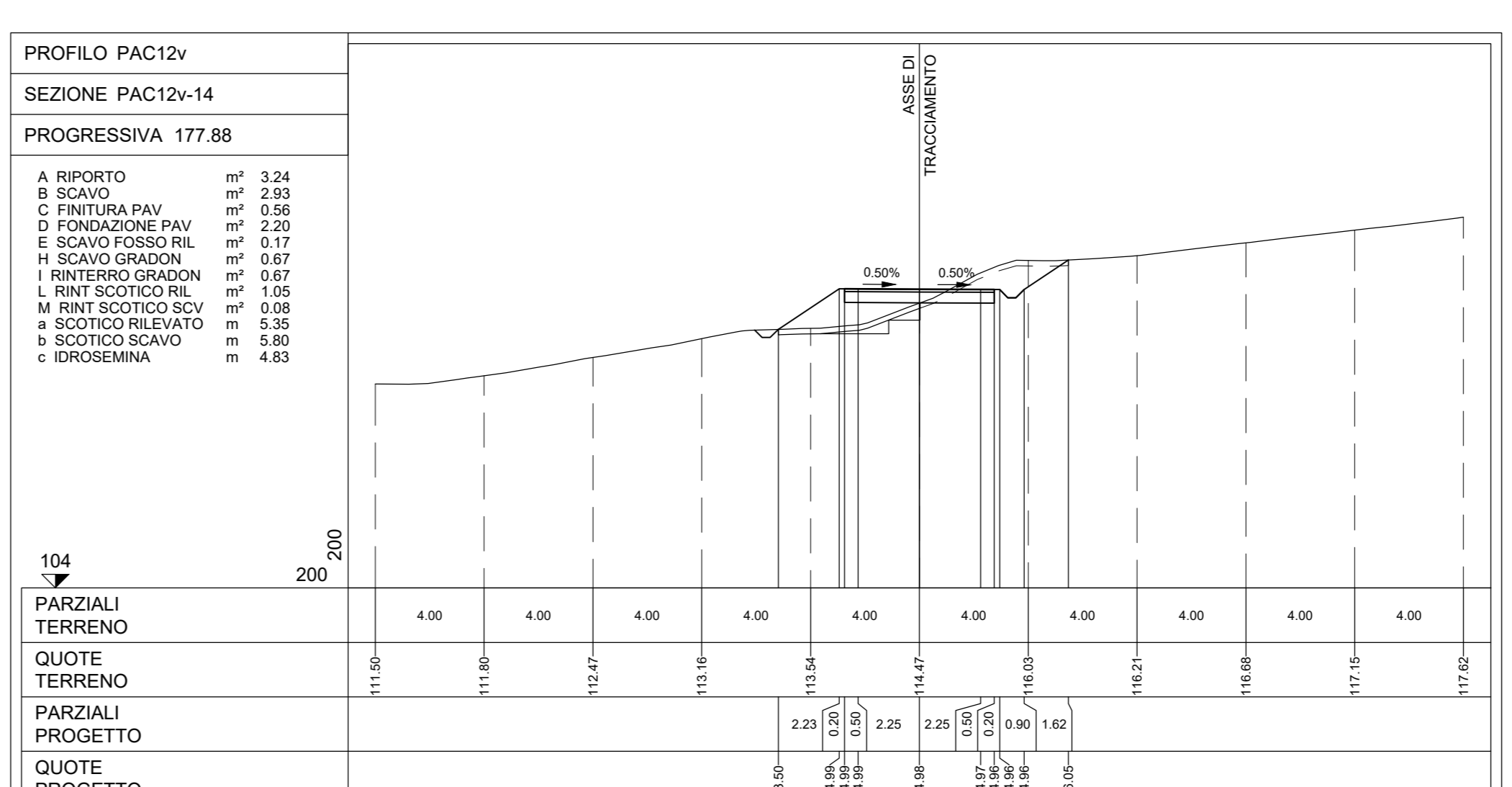
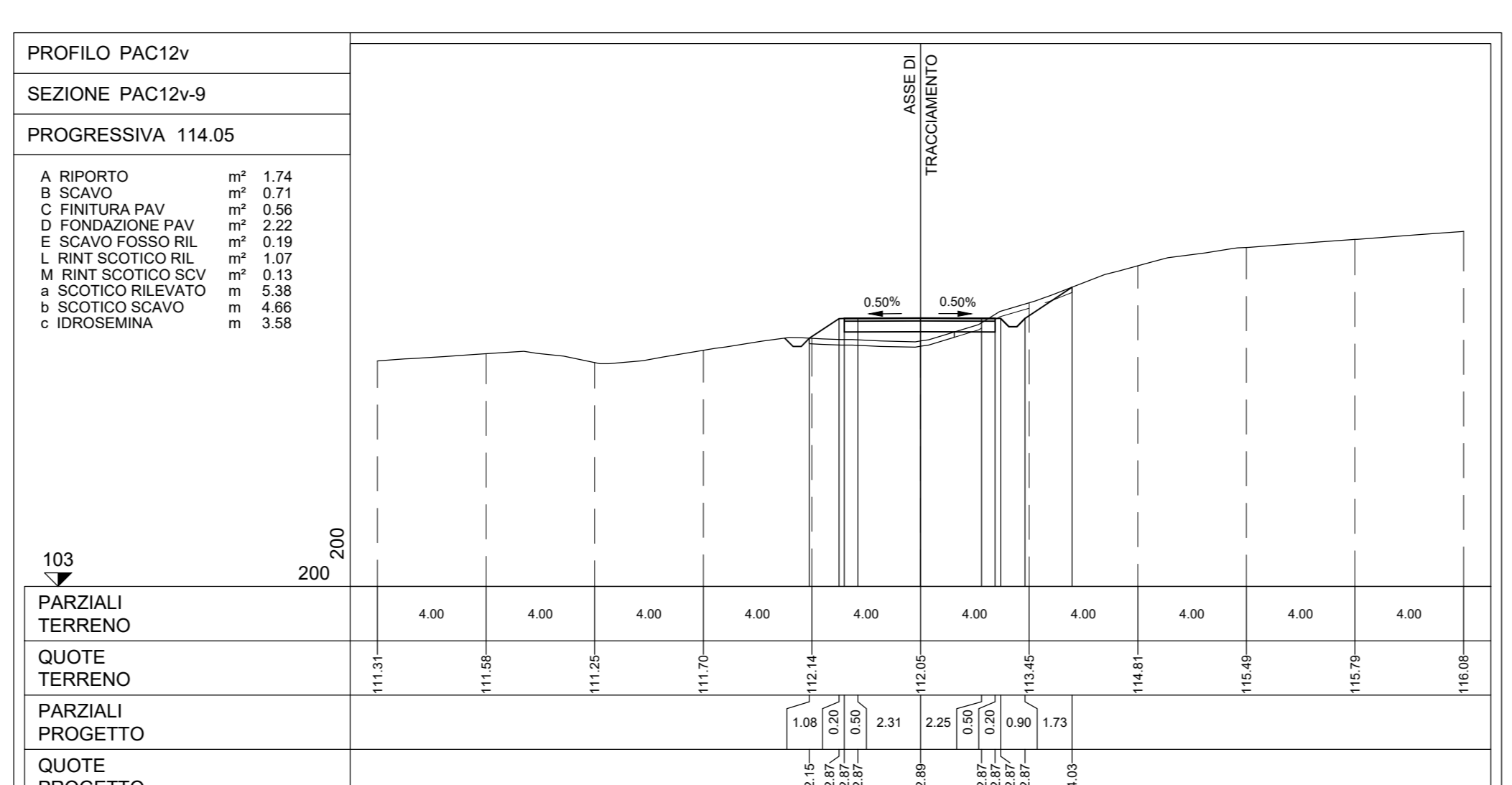
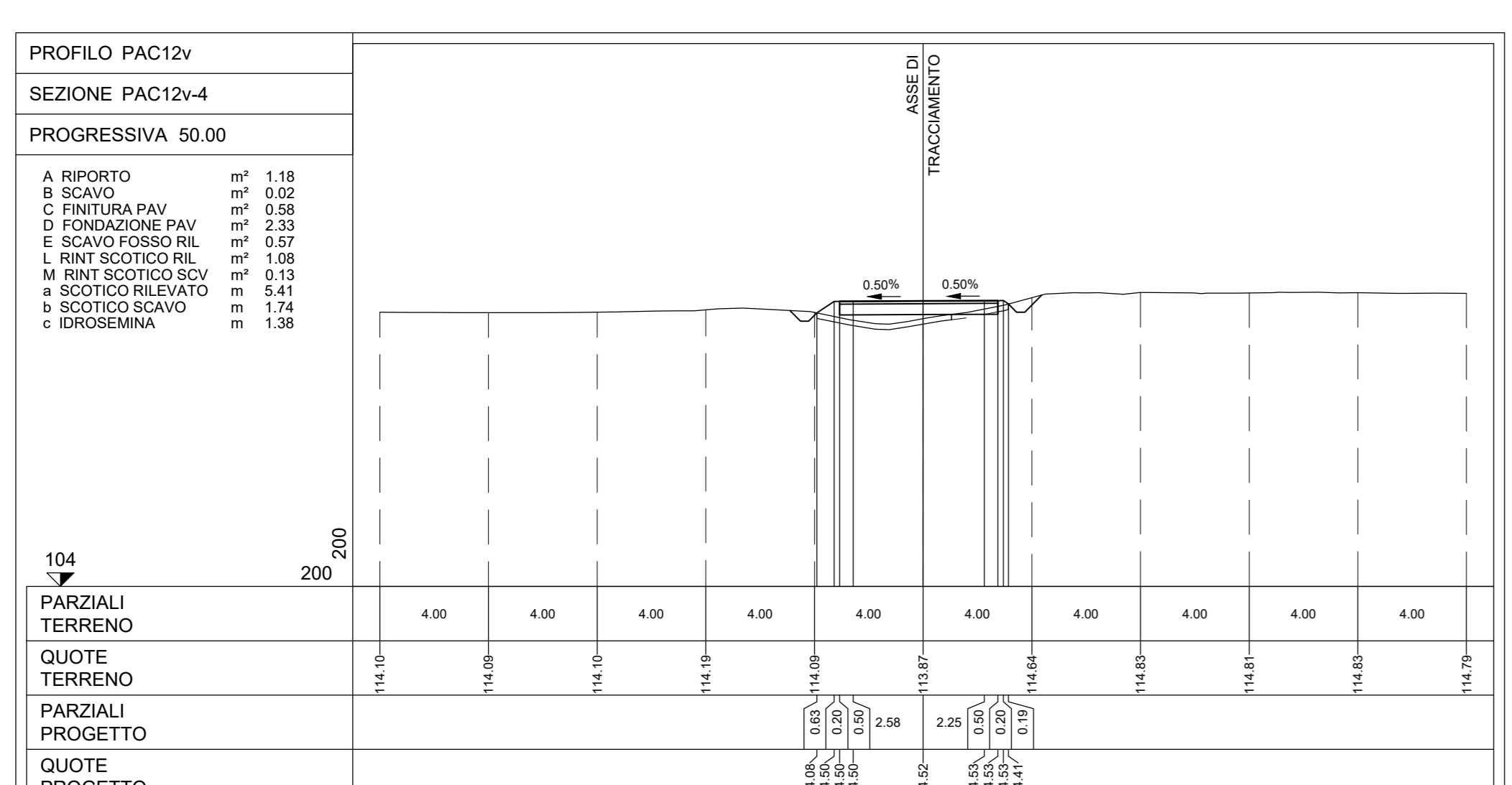
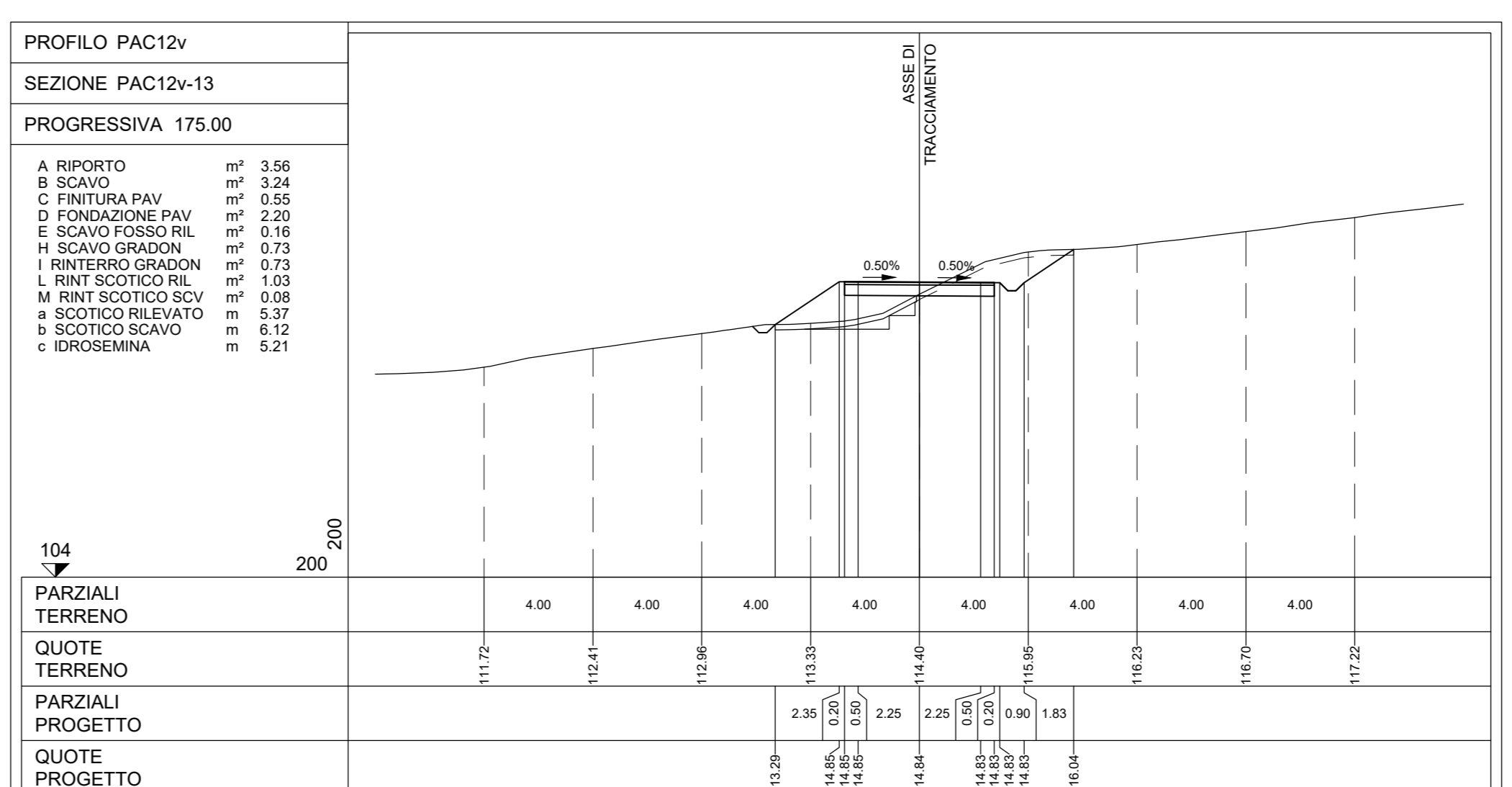
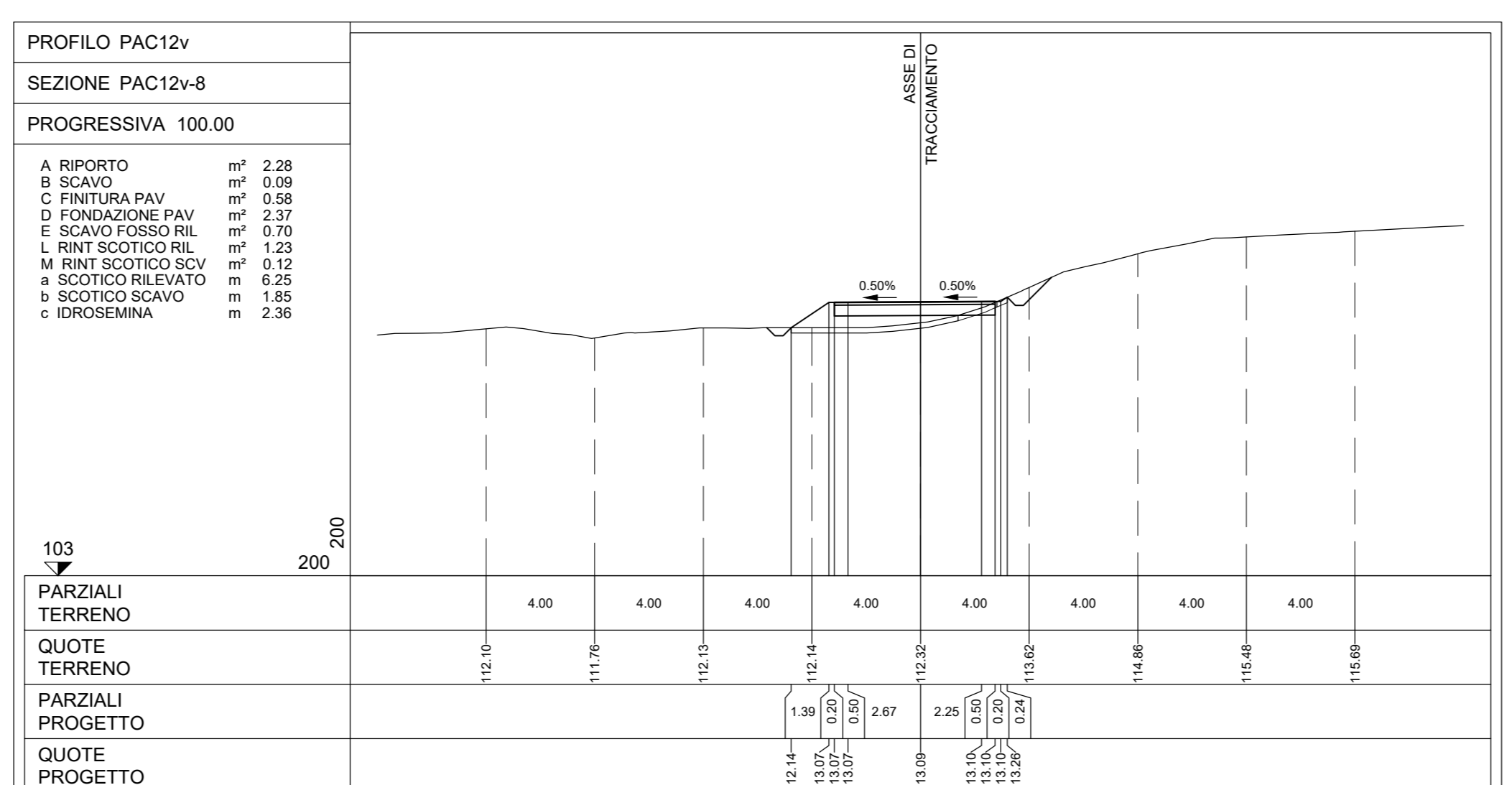
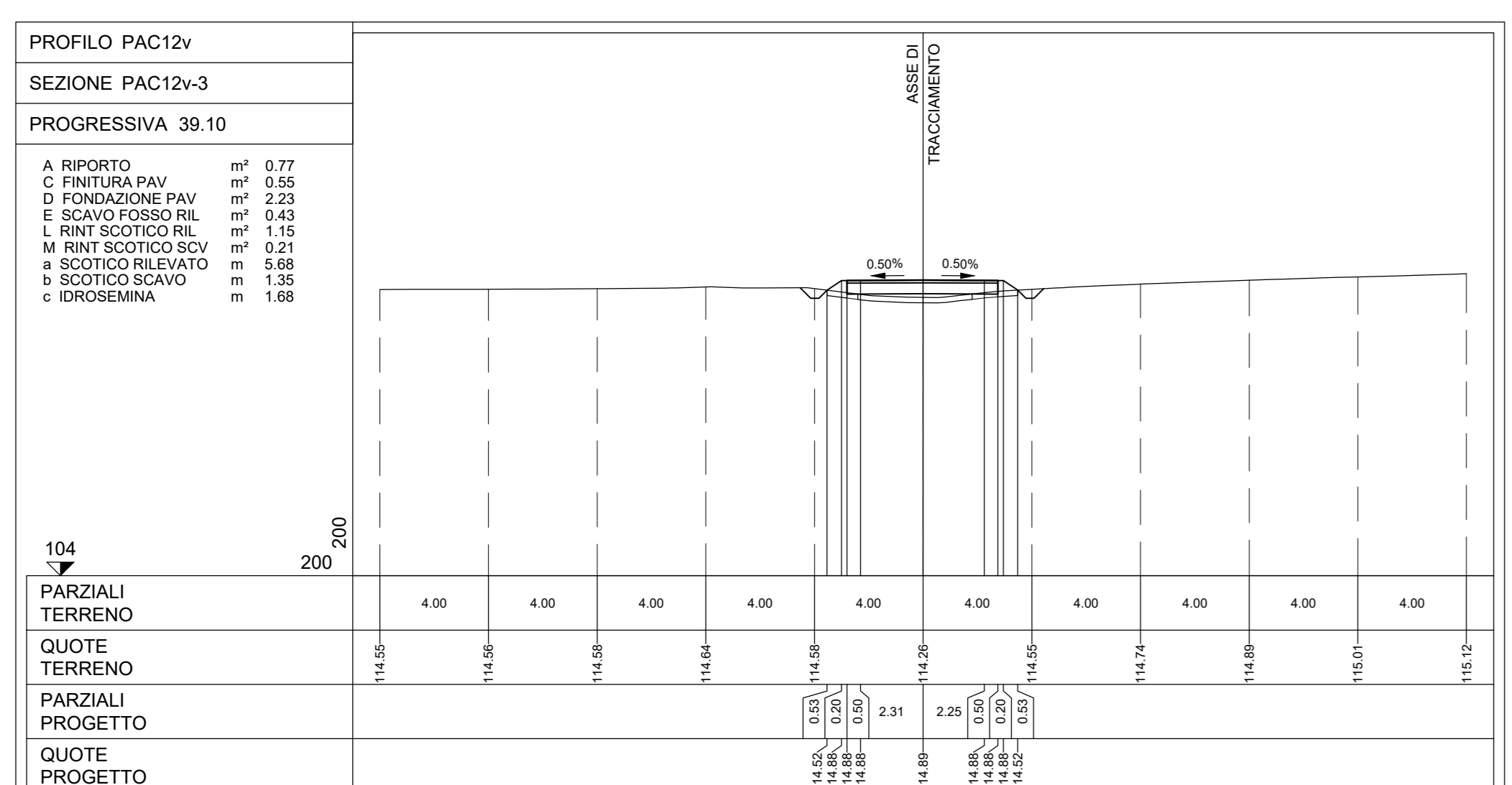
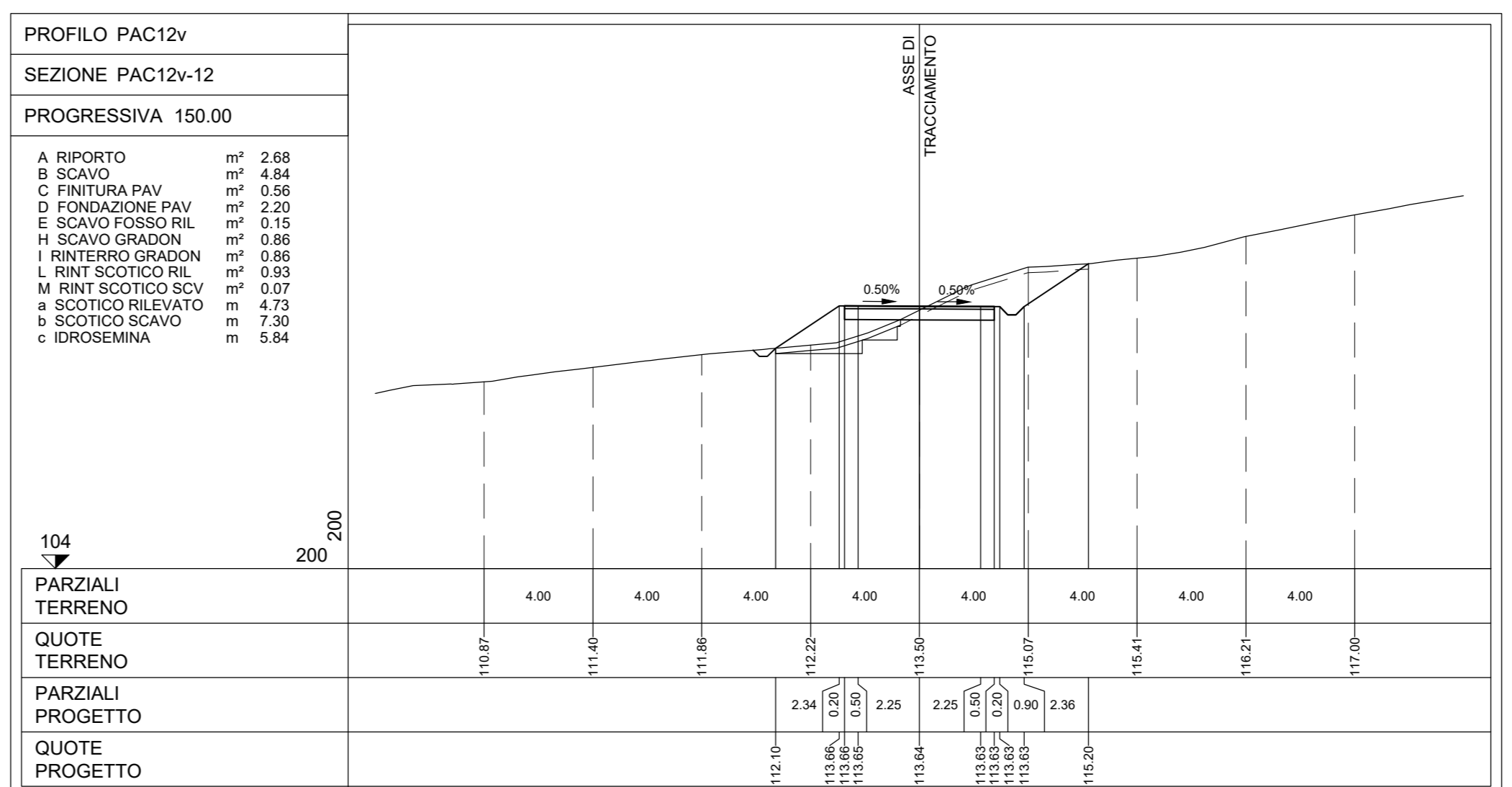
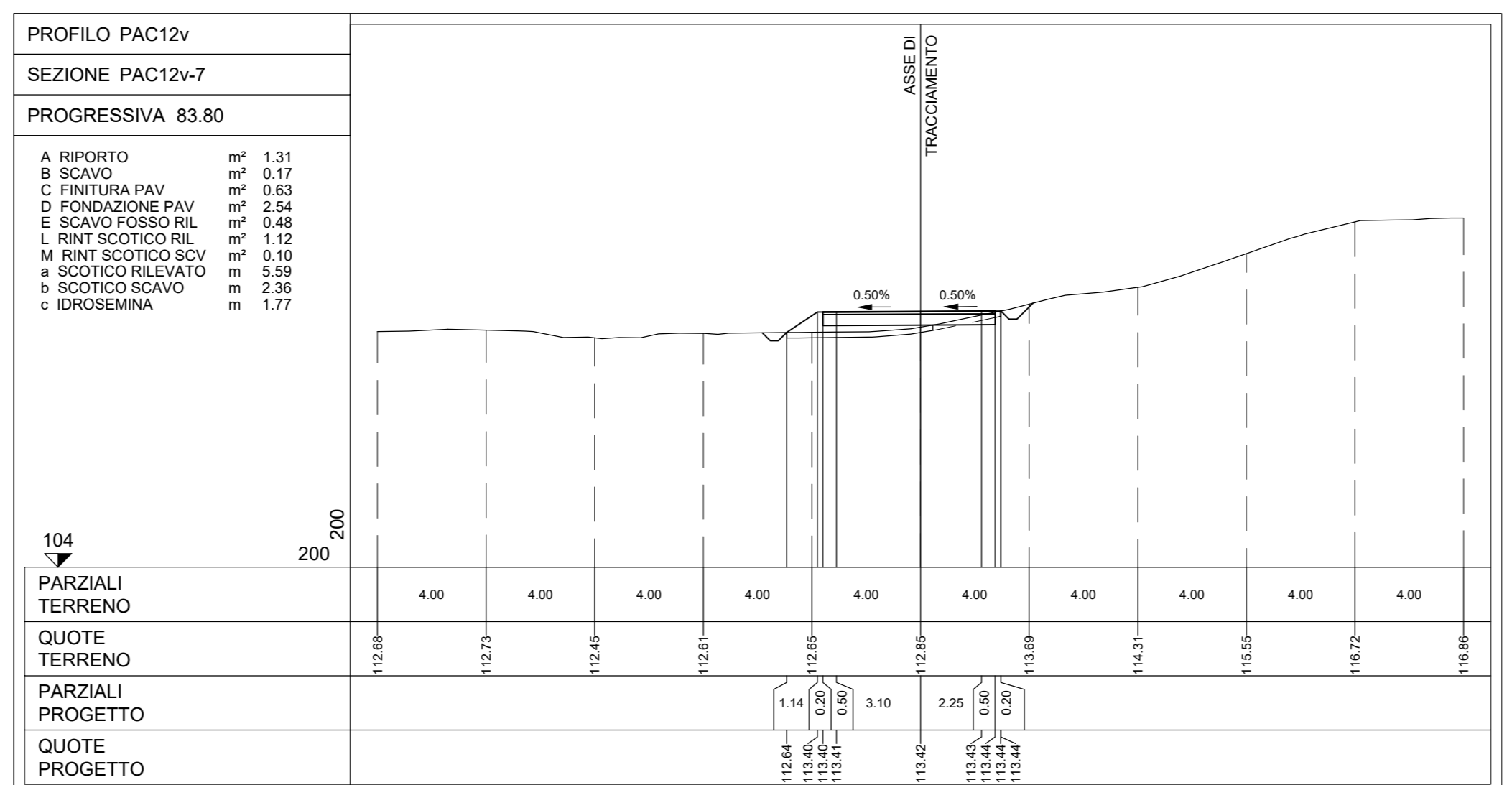
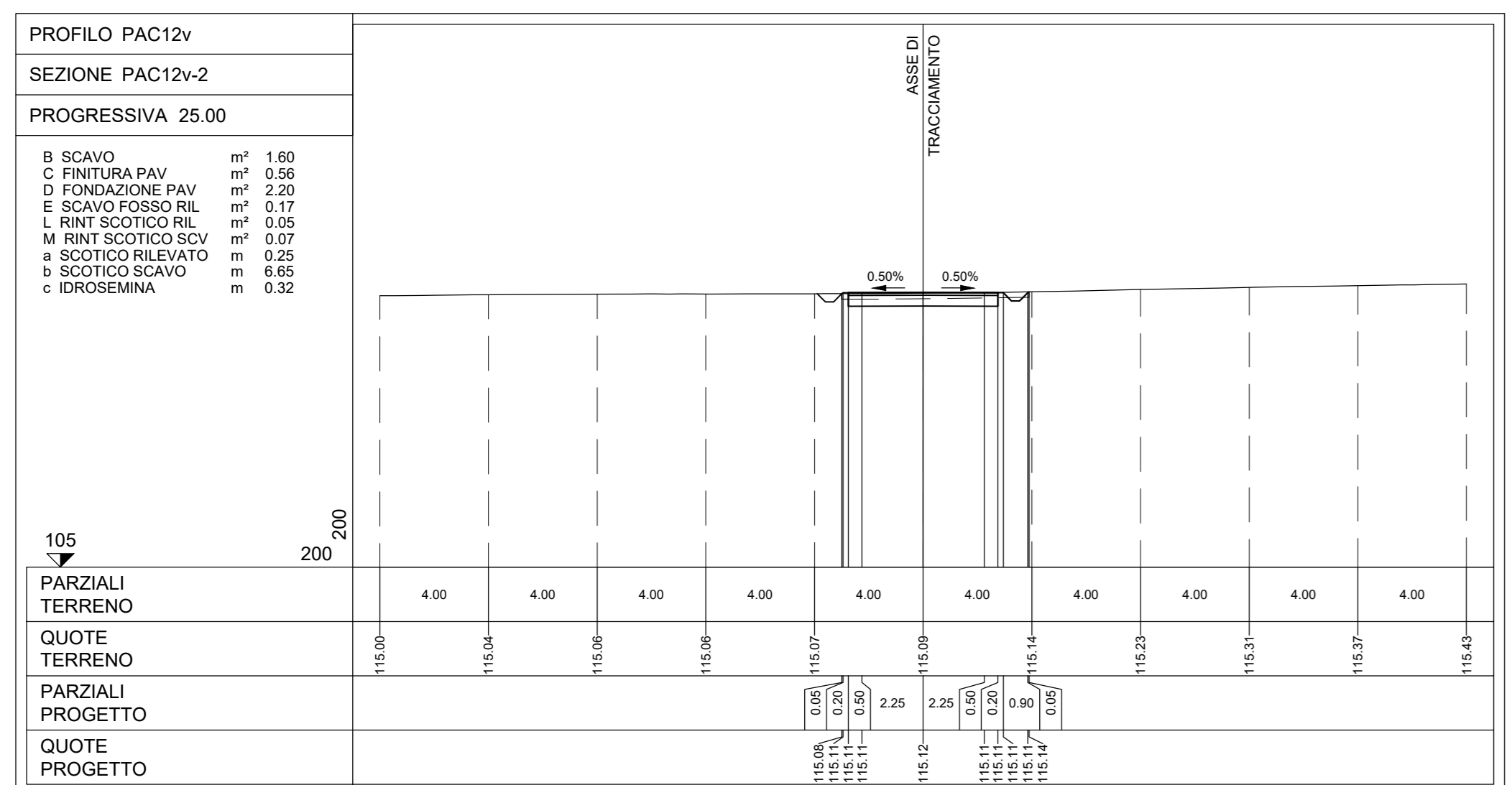
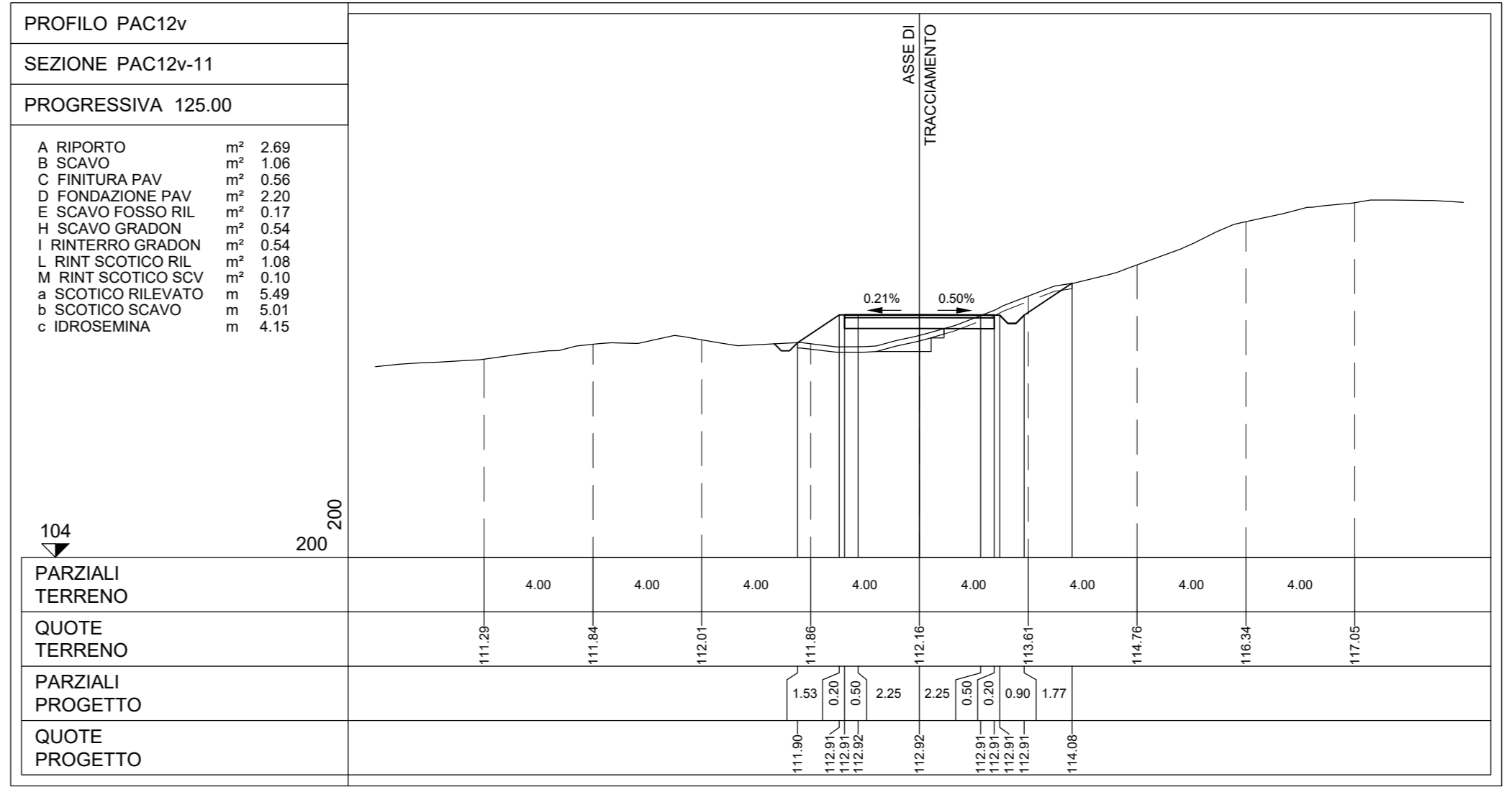
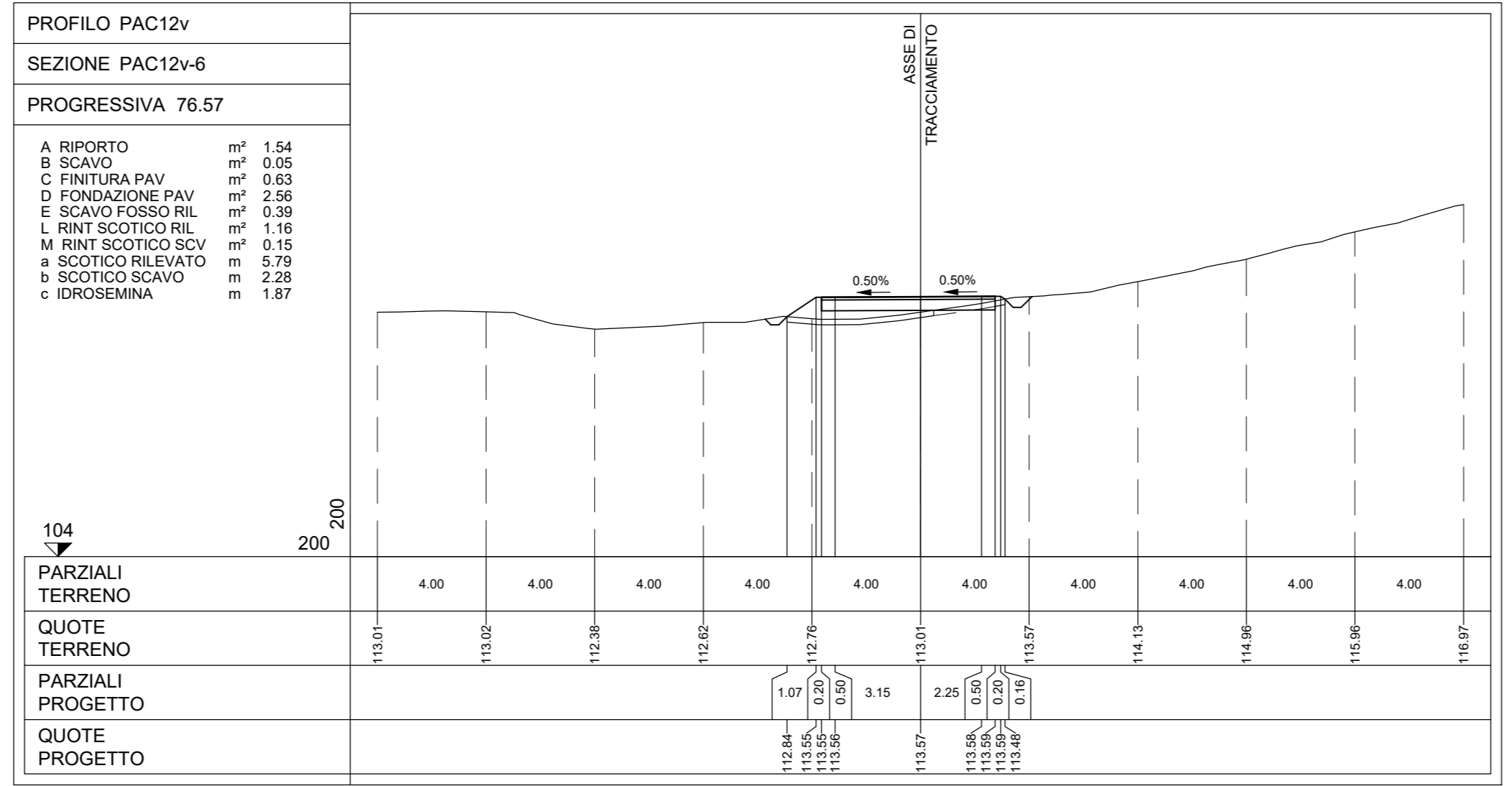
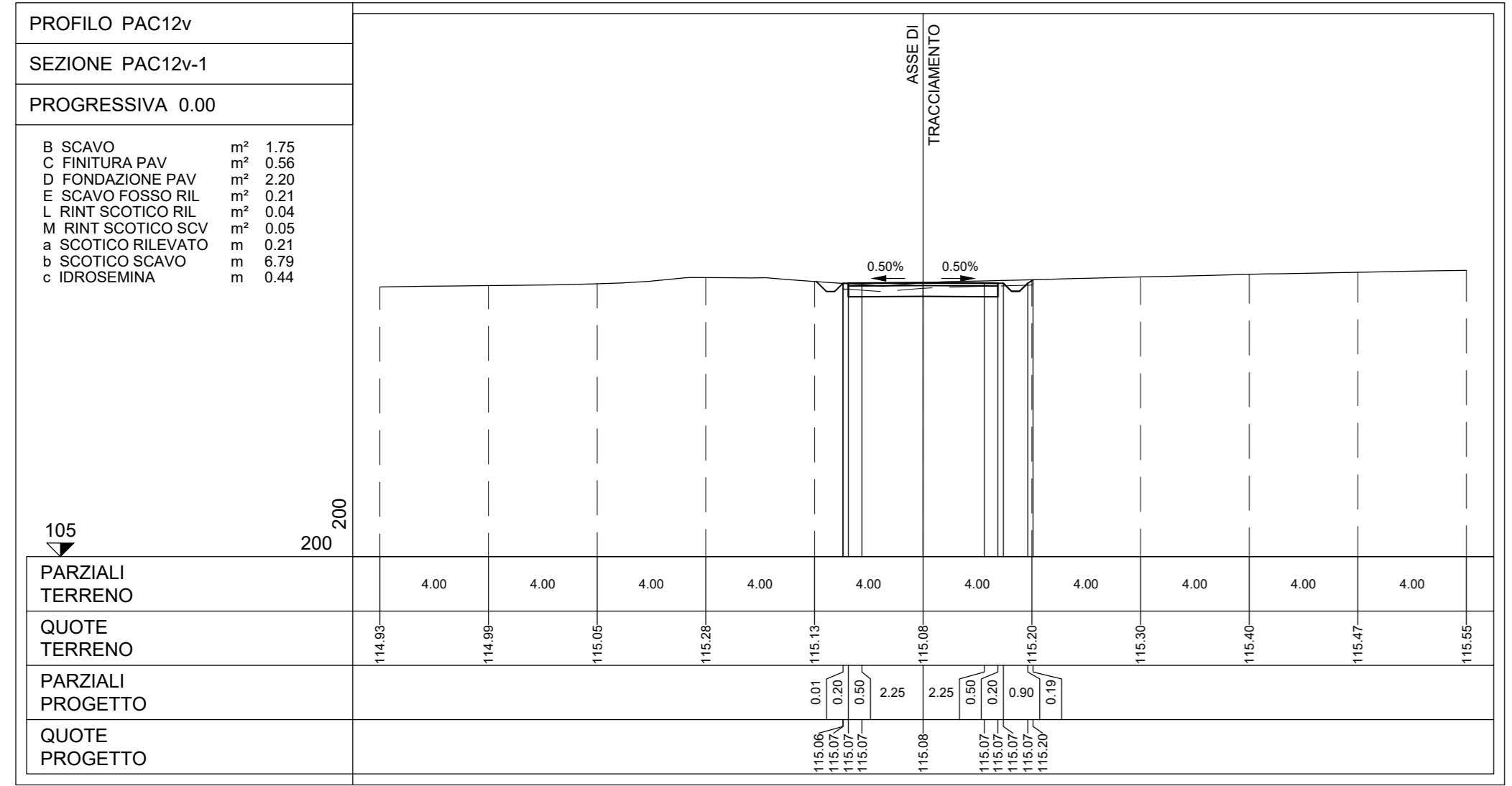

Rev.	Descrizione	%	ES	CC	07/2013
001	ESBORNE				

Montana  
Paceco S.R.L.  
Via Angelo Fumagalli 6, 20143 MILANO

ING. LAURA CONTI  
scritta all'Ordine degli Ingegneri della Provincia di Pavia n. 1728

OGGETTO: IMPIANTO EOLICO DA 108 MW  
COMUNE DI PACECO (TP), MISUSCUMI (TP) e TRAPANI (TP)

TITOLO: PAC12 - SEZIONI TRASVERSALI VIABILITA'

N. W. 2395\_5531\_PAC\_PFE\_T13.12\_REV1\_PAC12-SEZIONI TRASVERSALI VIABILITA'

E' VIETATA LA RIPRODUZIONE DI QUESTO DOCUMENTO SENZA PREVENUTA AUTORIZZAZIONE SCRITTA DELLA MONTANA SPA

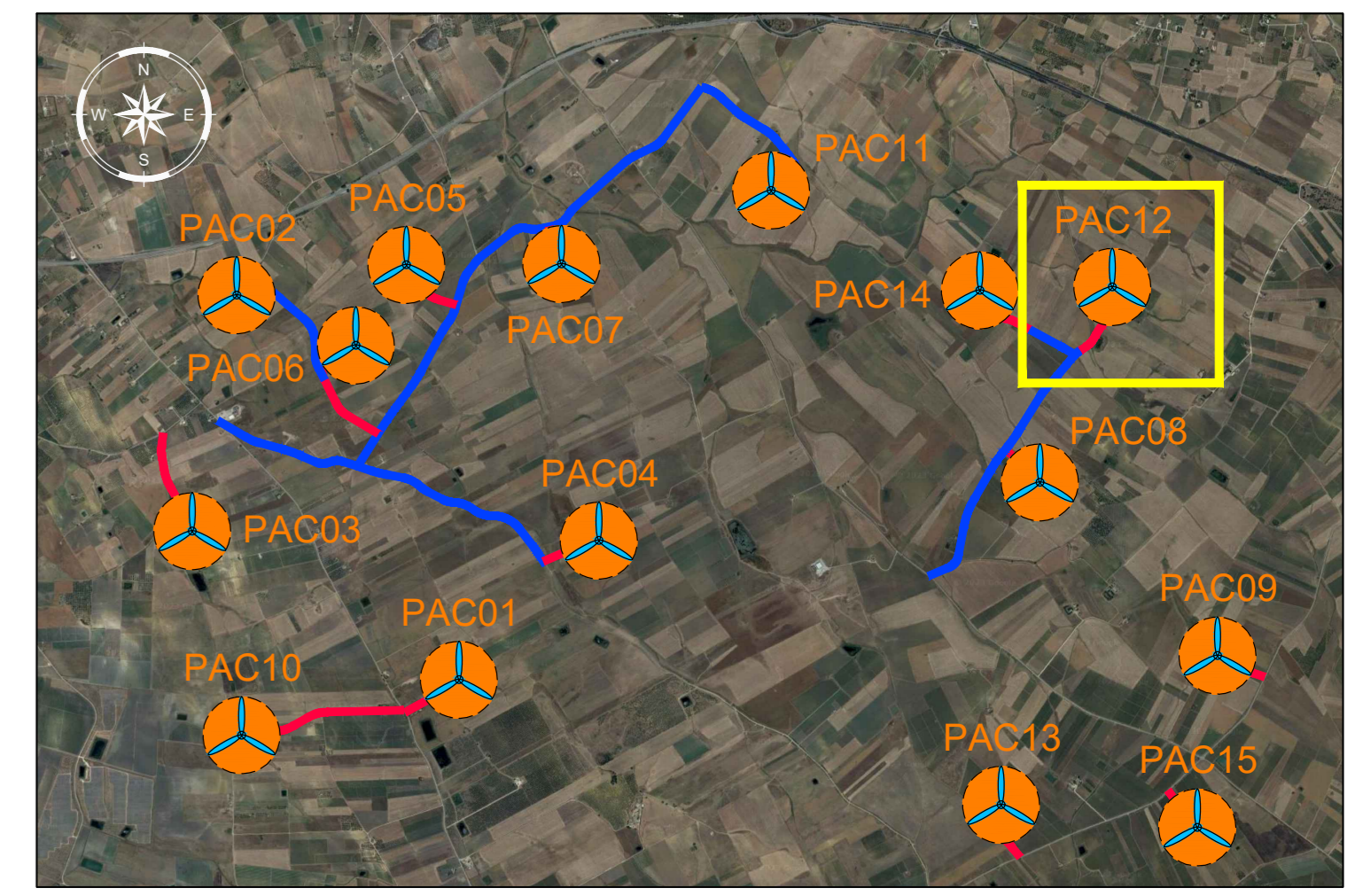

**LEGENDA PIANTA CHIAVE**

- PIAZZOLA CON ROTORE EOLICO
- PISTA DI ACCESSO ALLA PIAZZOLA
- VIABILITA' ESISTENTE DA ADEGUARE

NOTE:  
- PER LE UBICAZIONI E LE DIMENSIONI RELATIVE ALLE OPERE IDRAULICHE SI VEDANO LE TAVOLE SPECIFICHE.

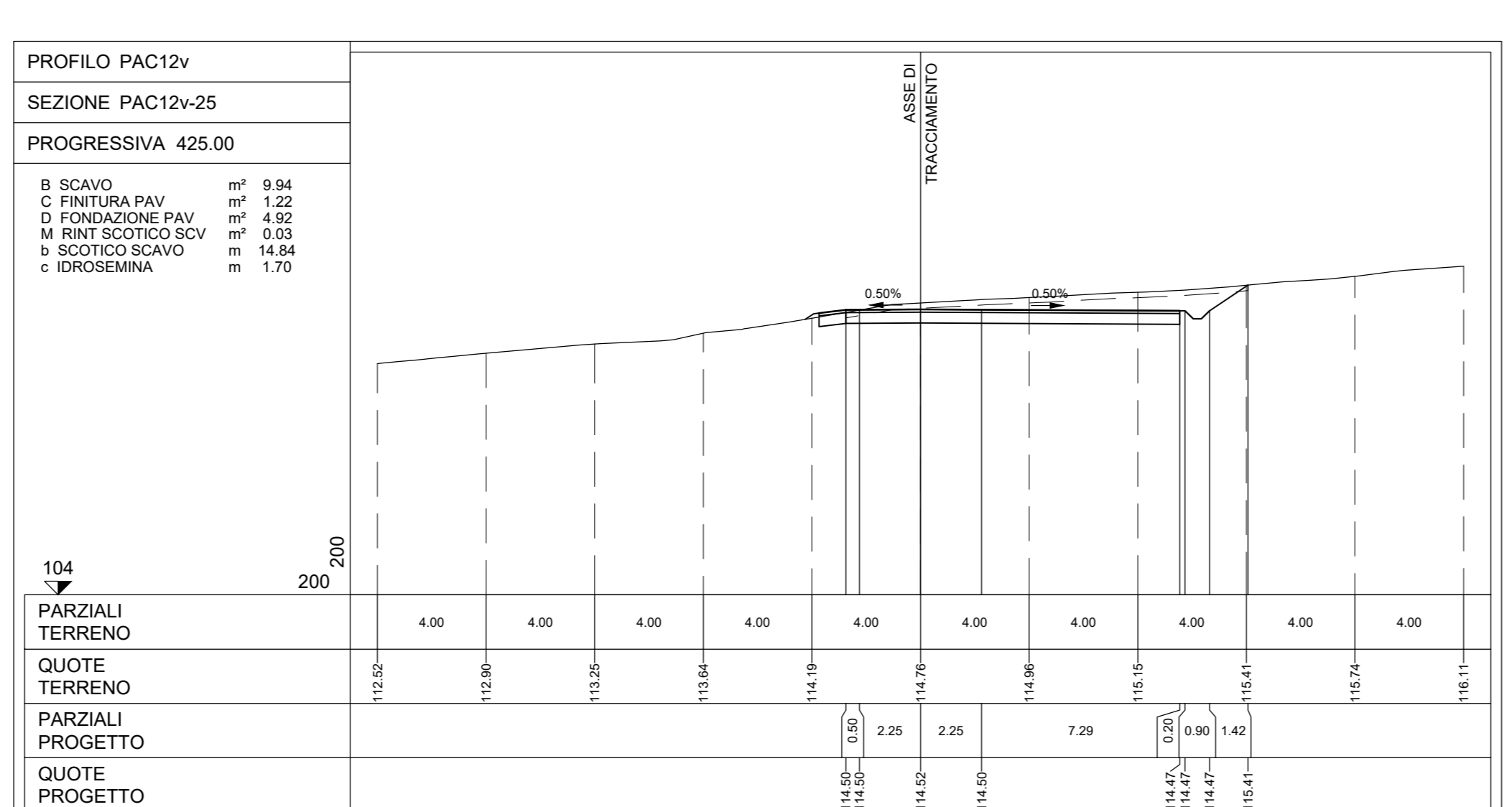
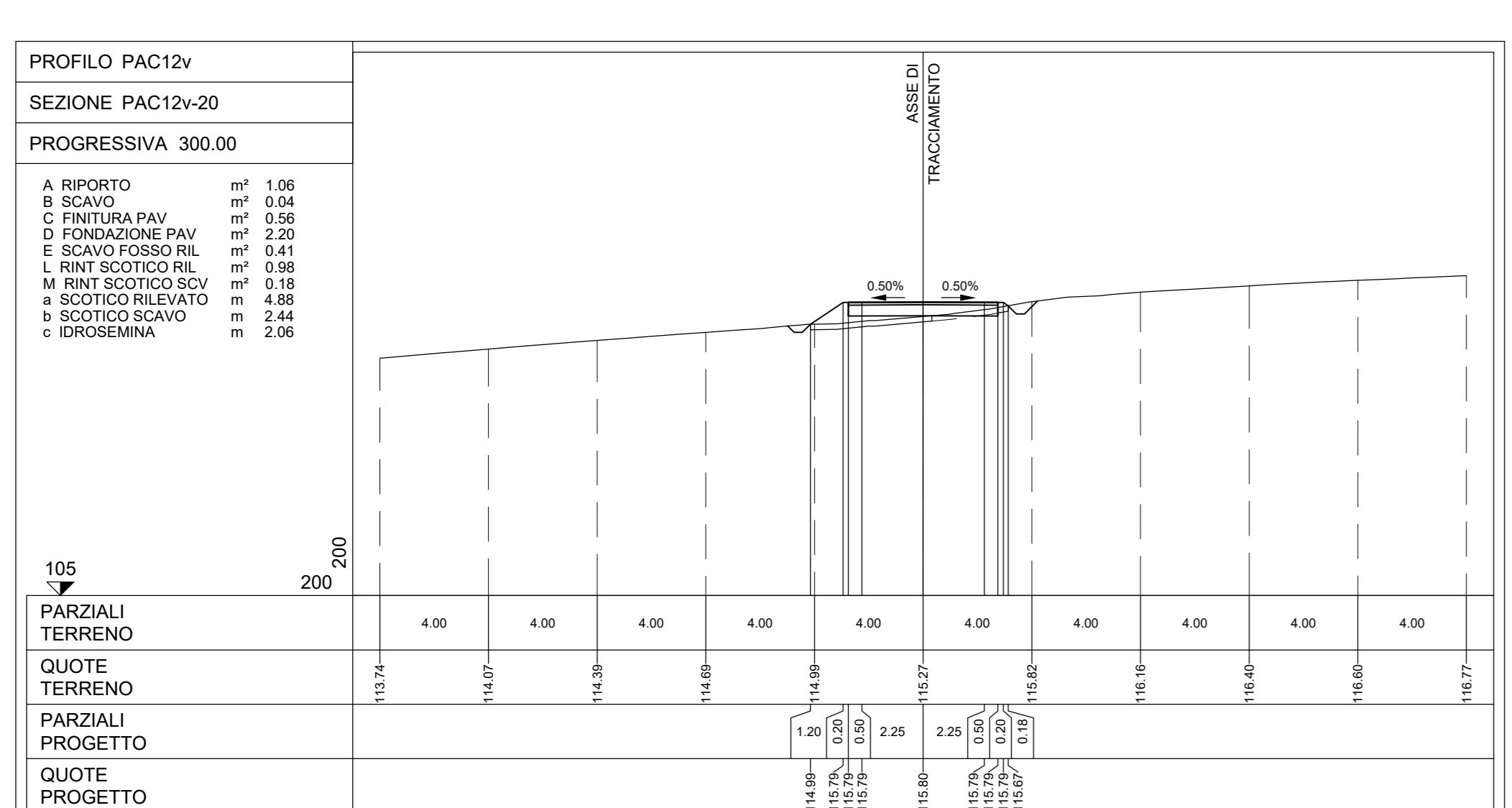
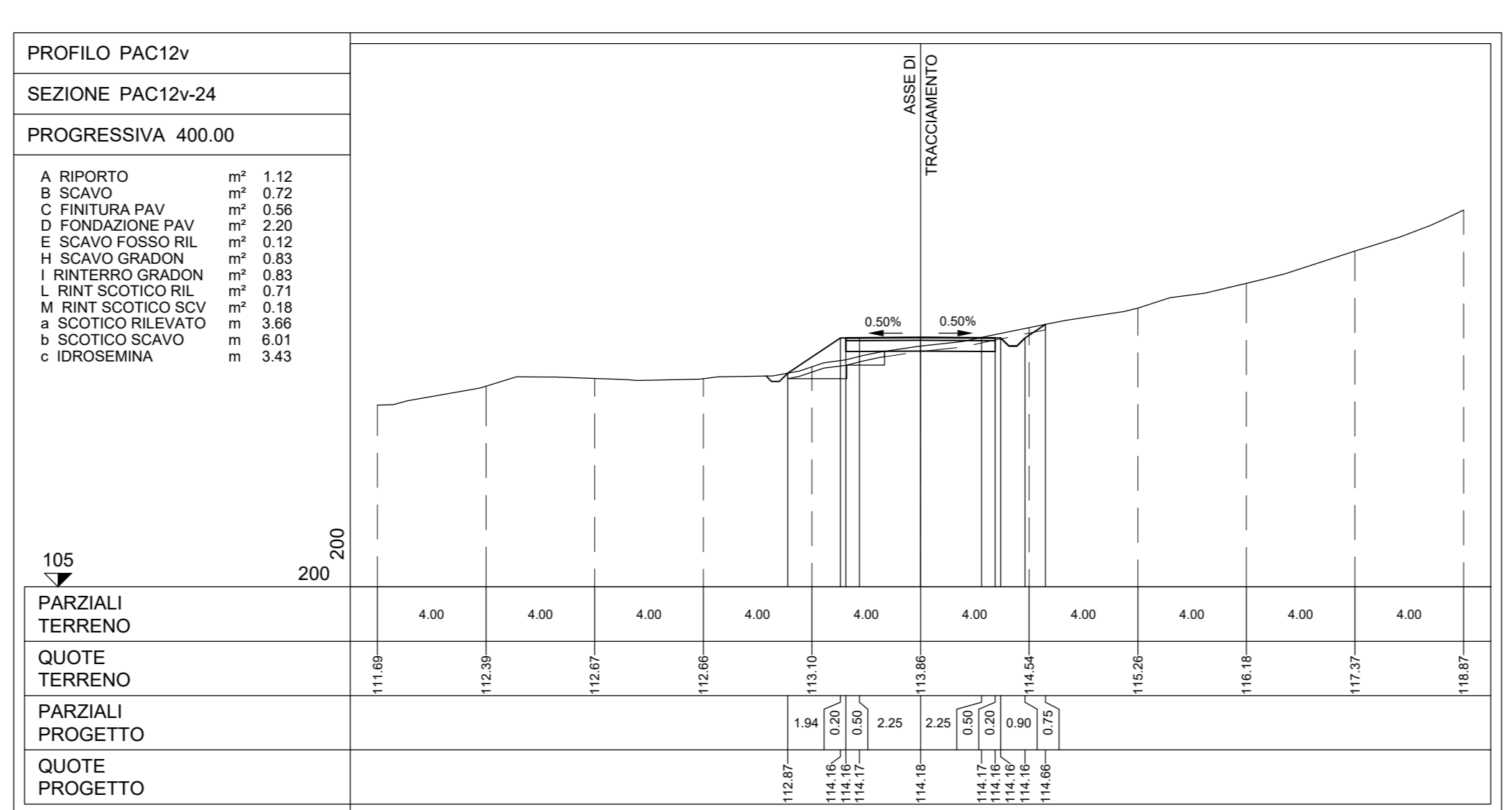
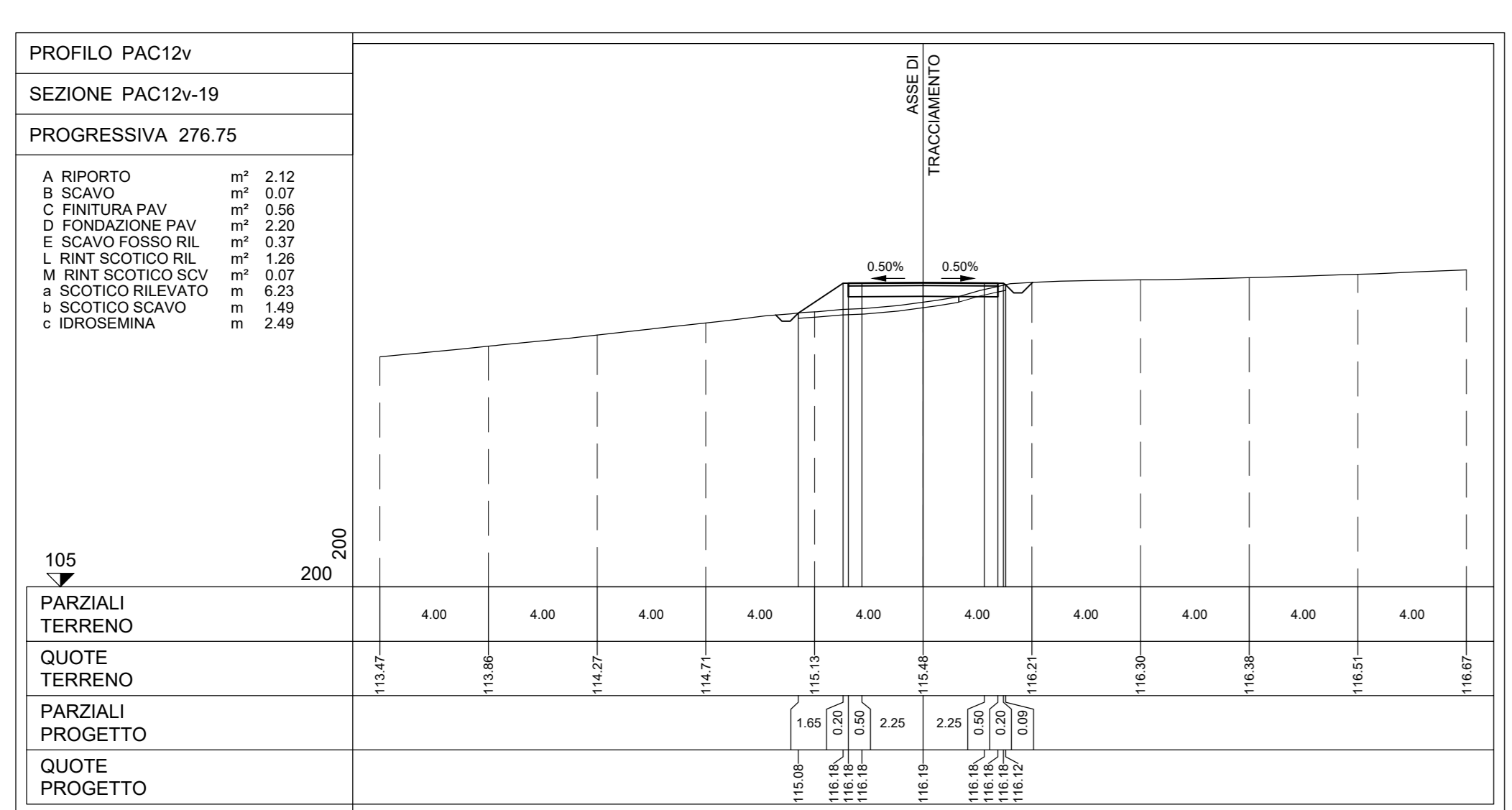
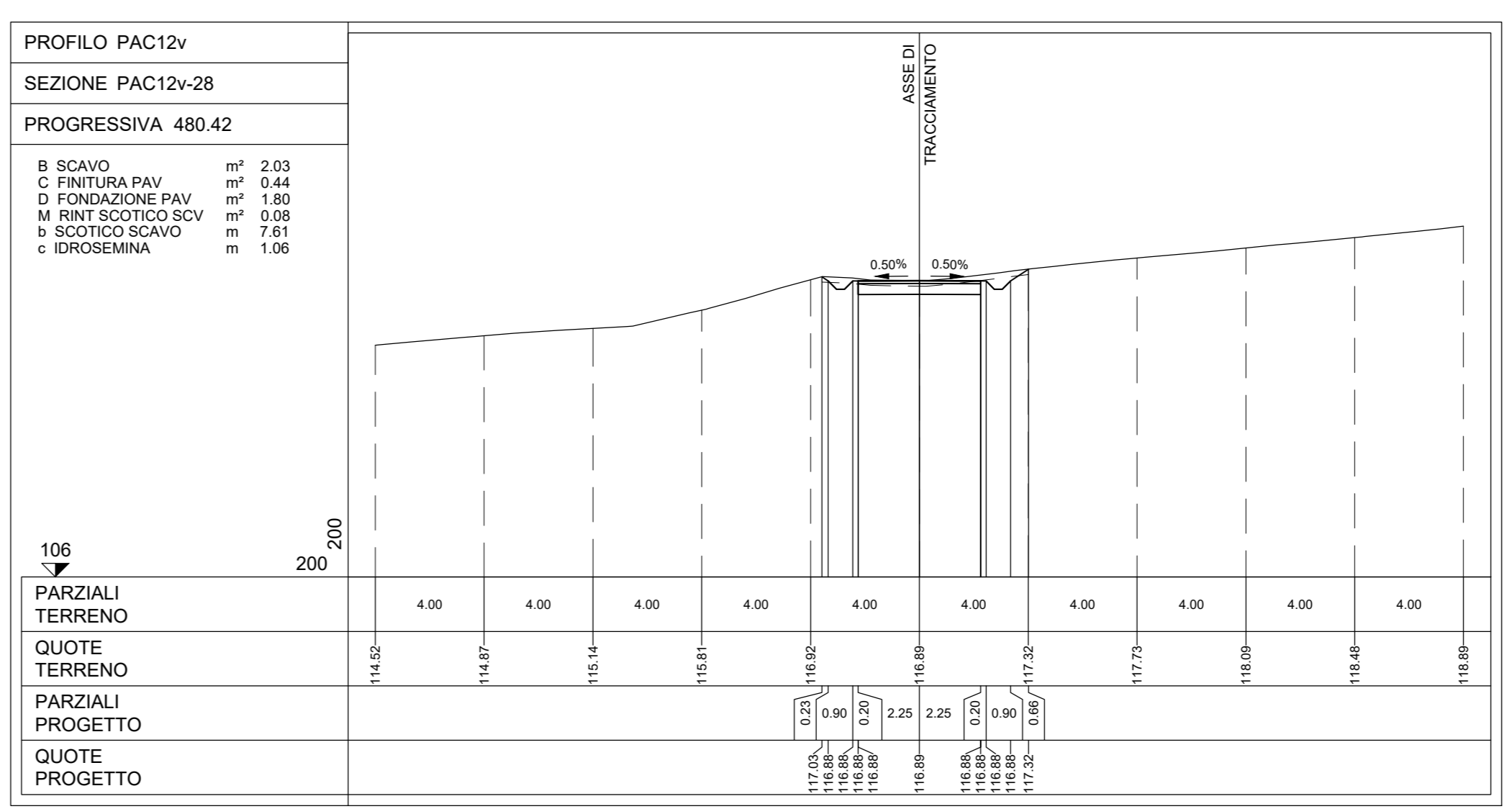
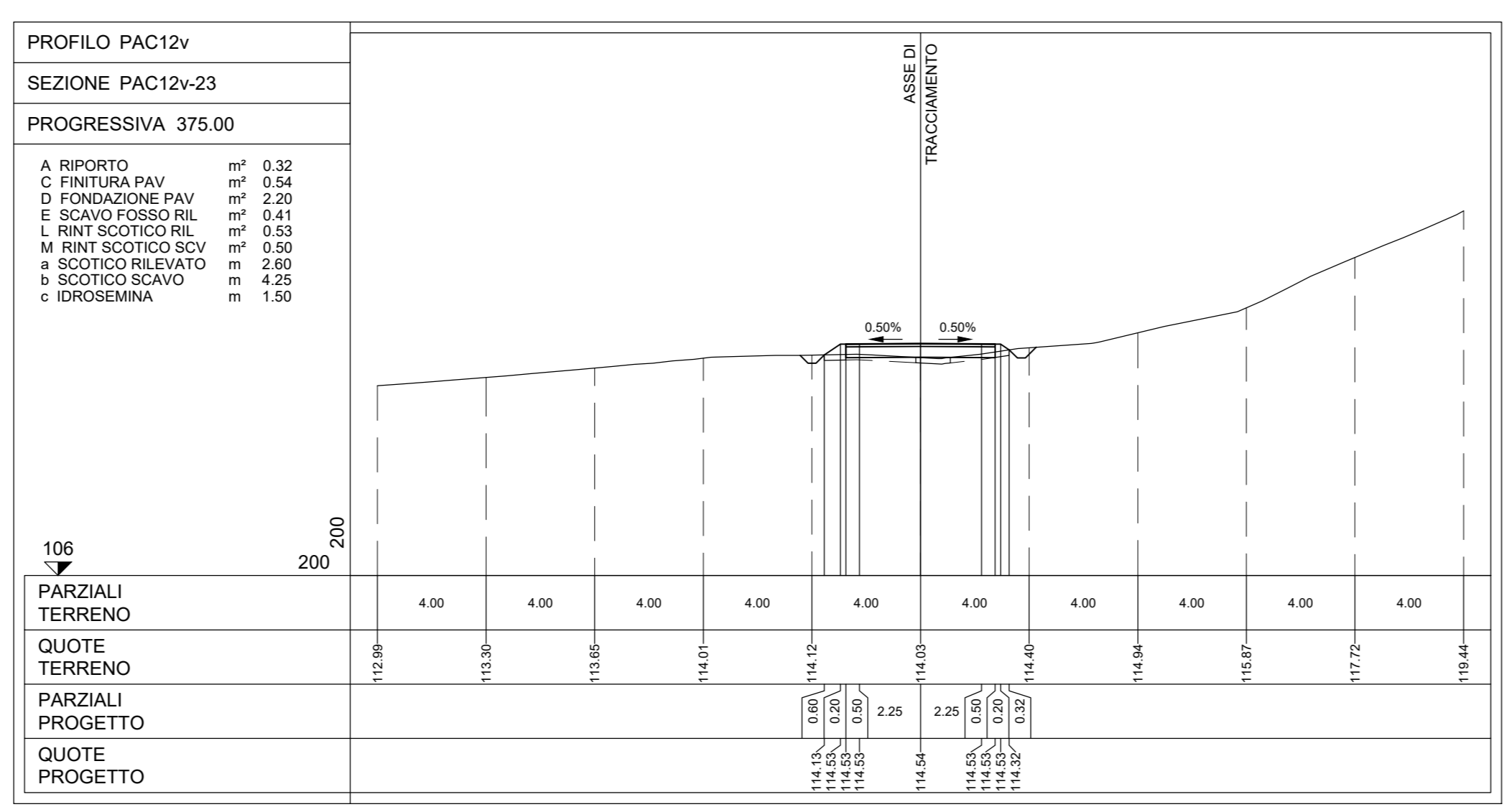
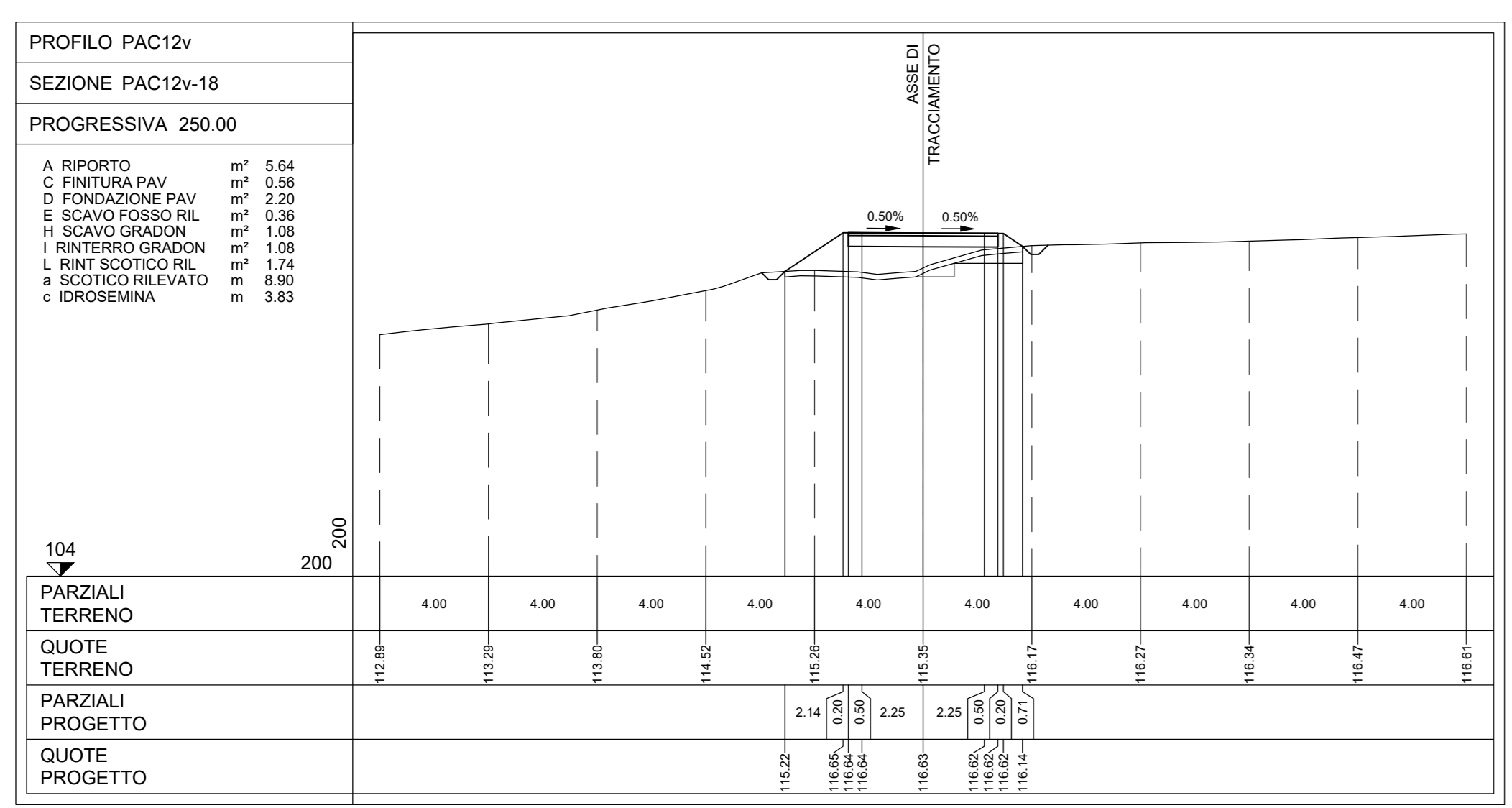
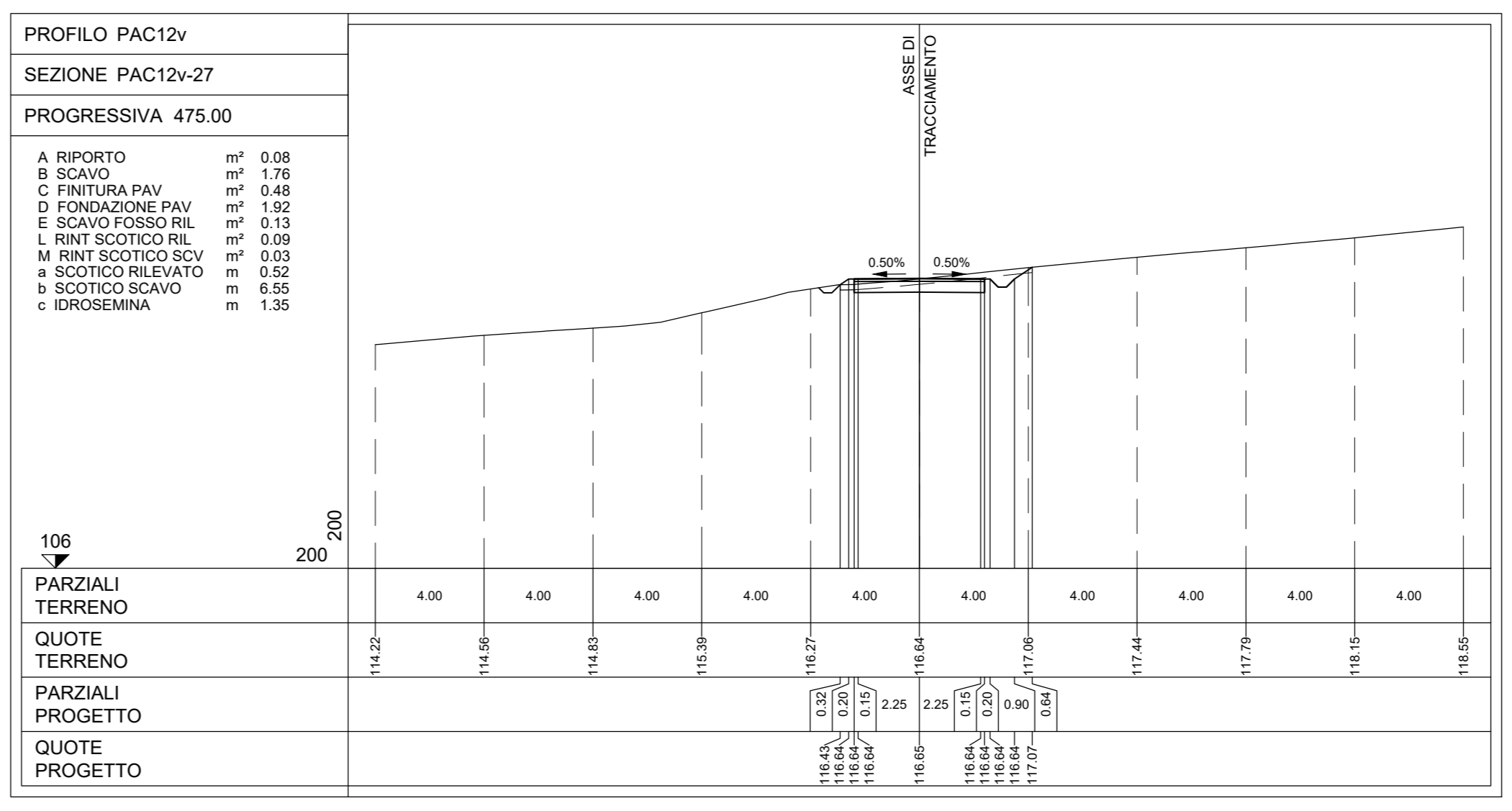
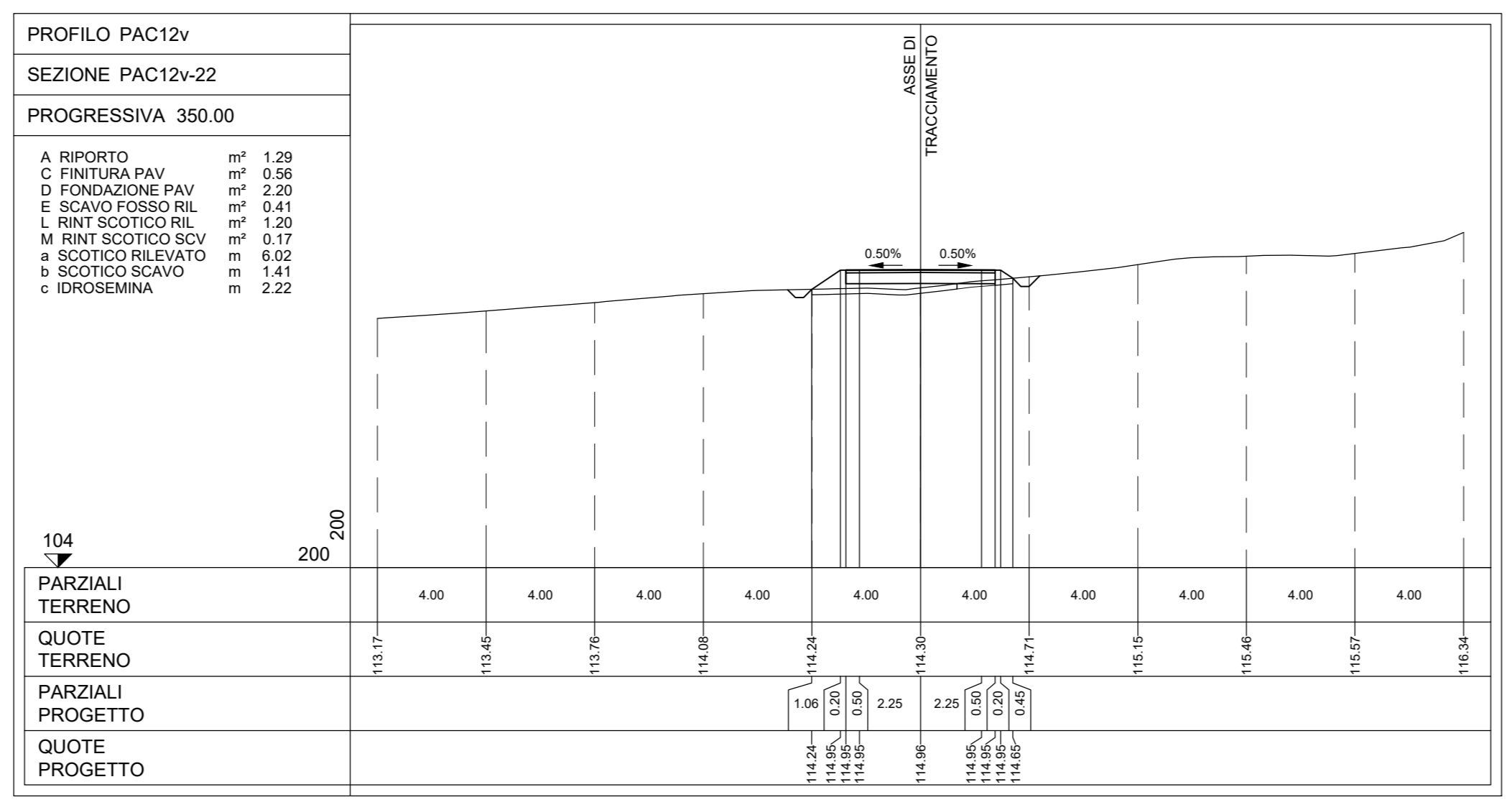
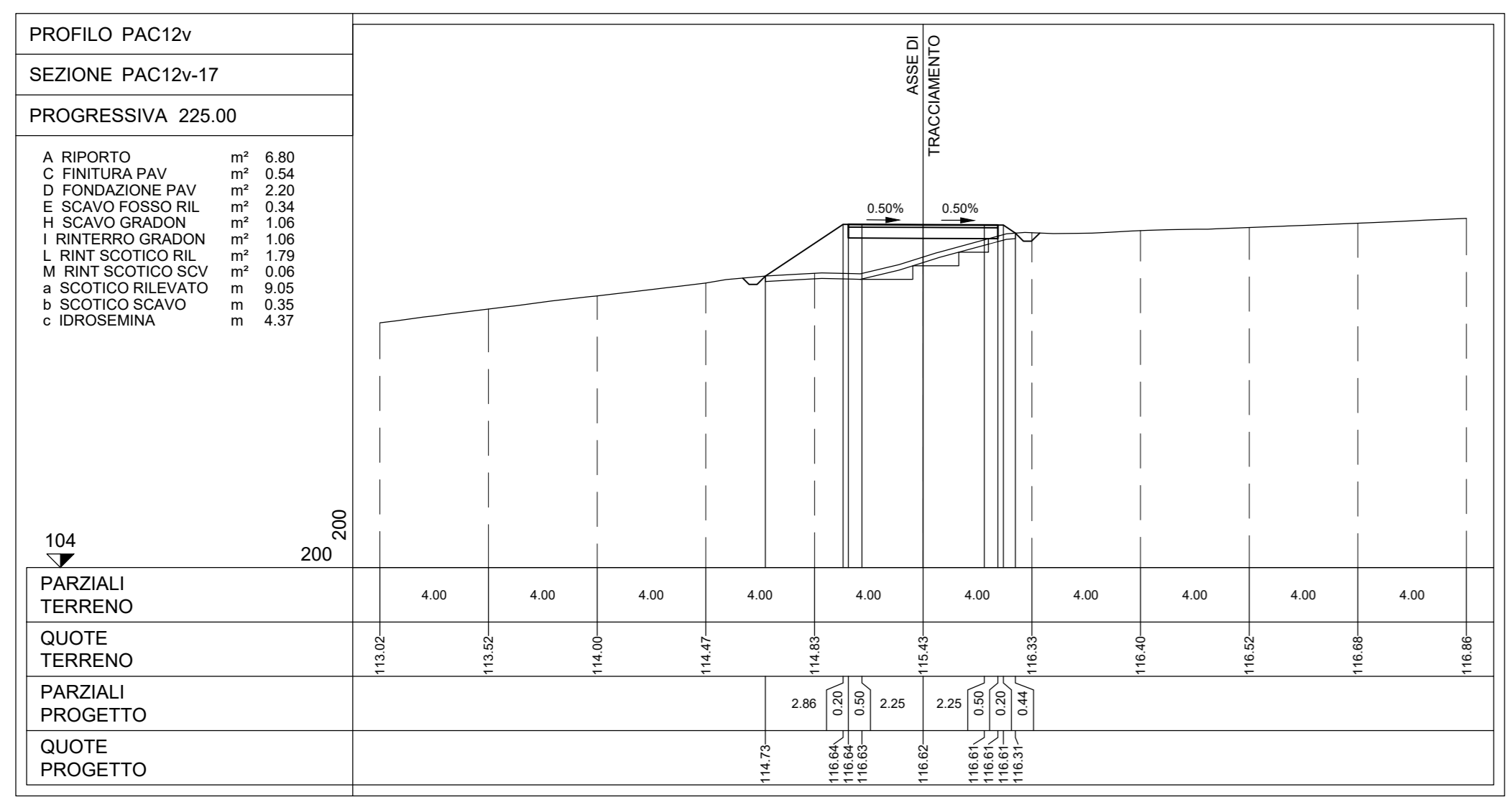
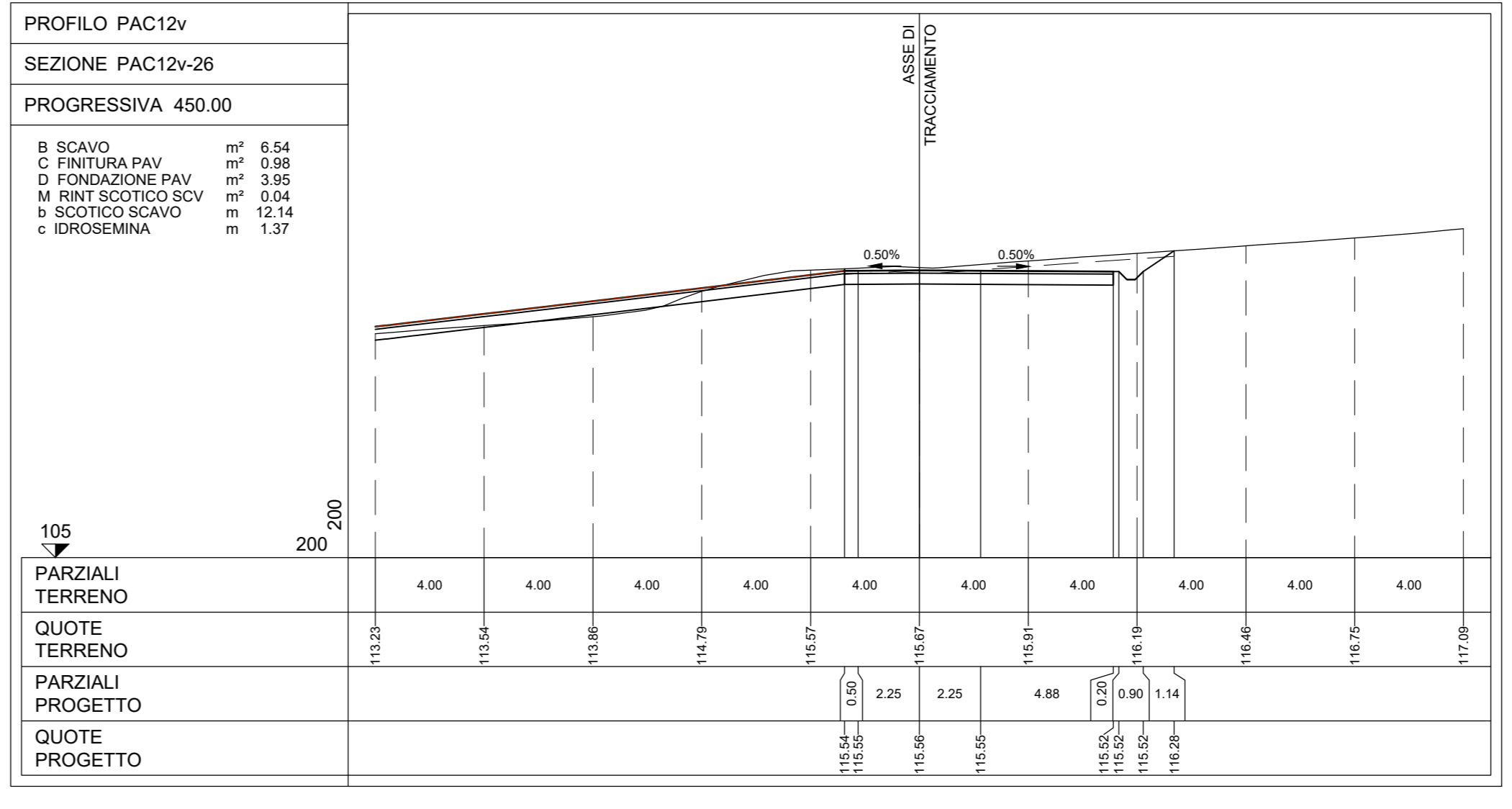
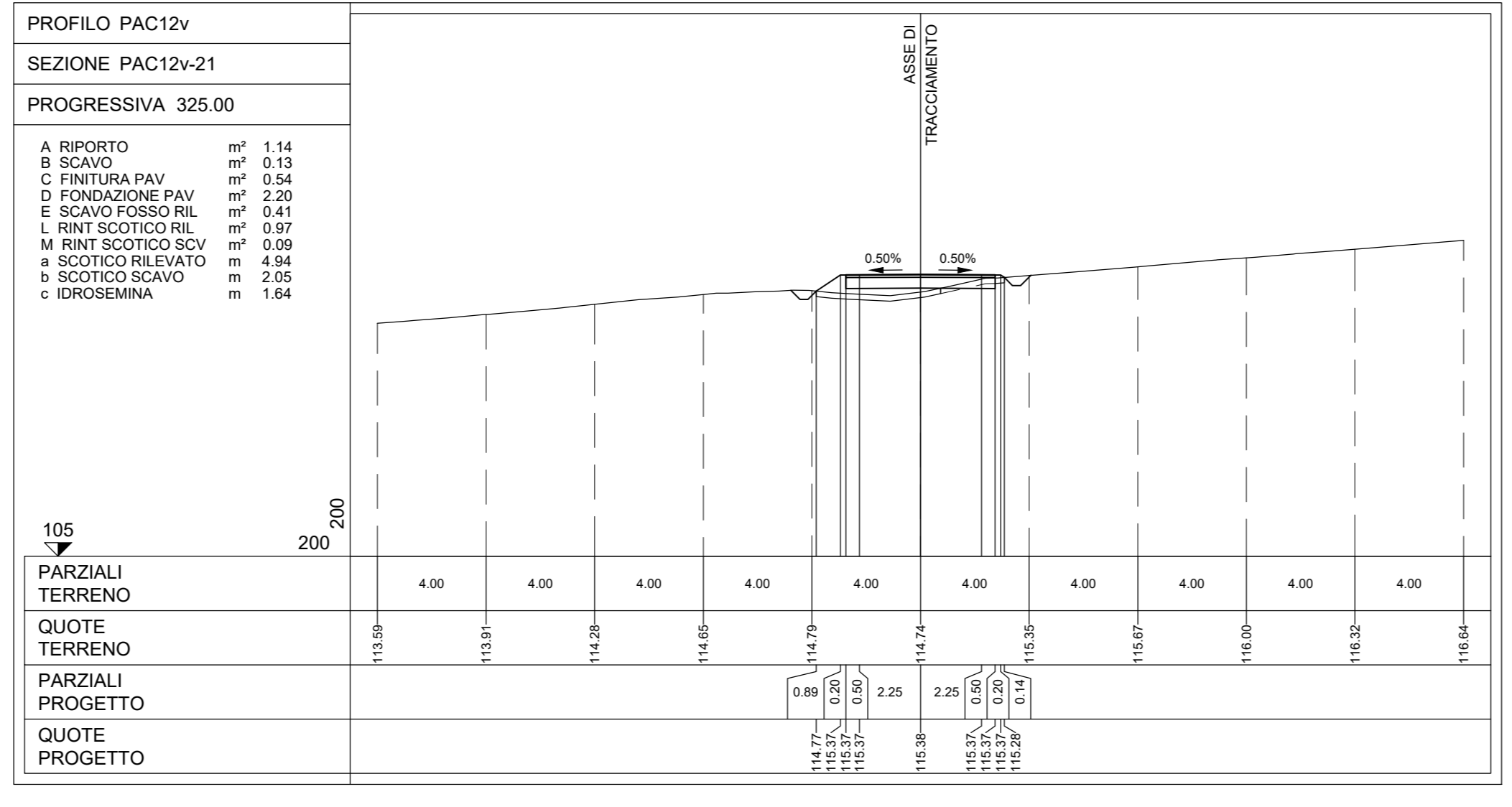
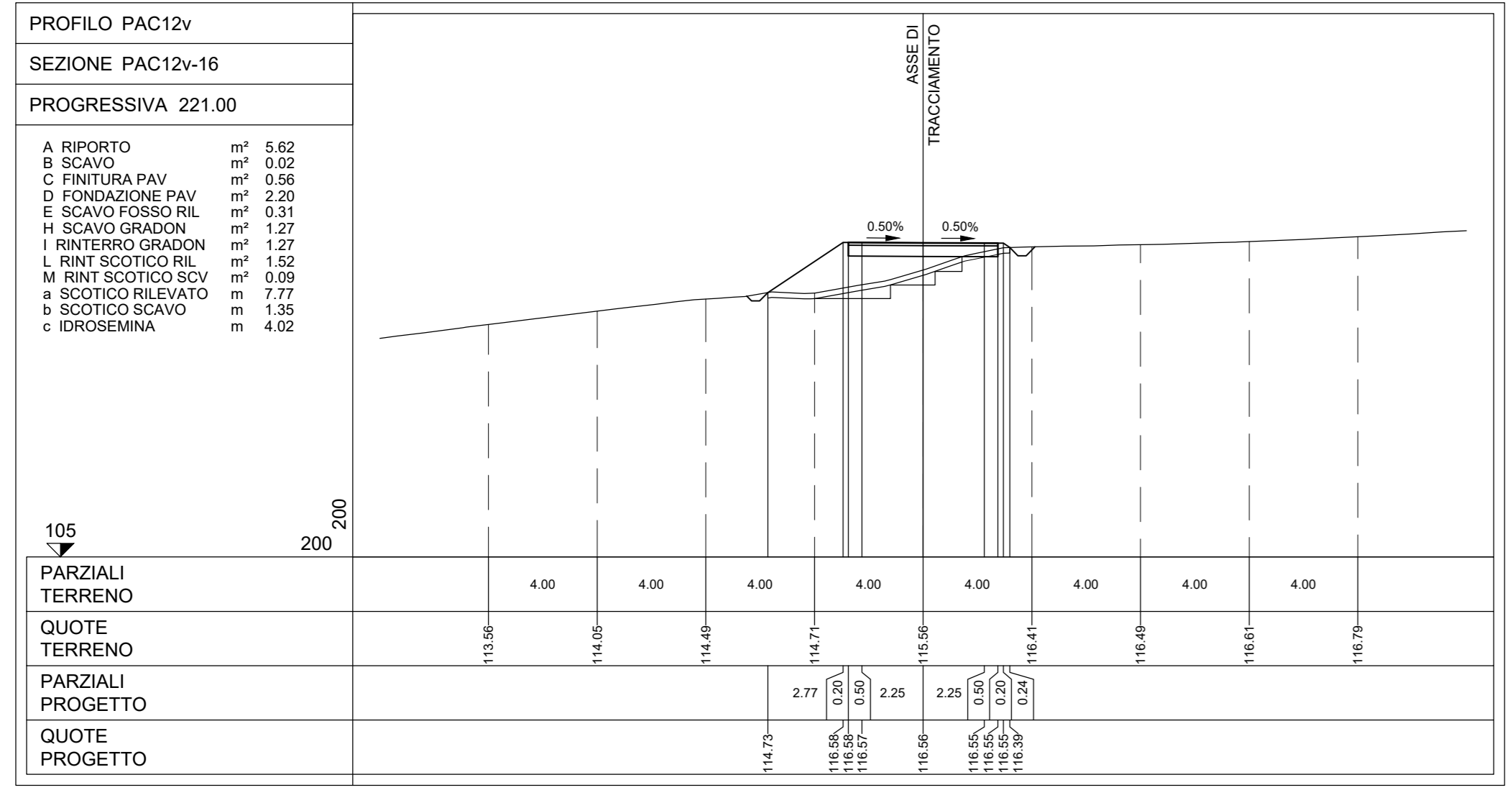

Rev.	Descrizione	%	Cl.	Cl.	07/2013	
REV.	ESCRIZIONE		REDA	CONTROL	INFER.	DATA

Montana		Montana S.p.A. - Via Salaria 111 - 00144 Roma	
Paceco S.R.L.		PACECO S.R.L. - VIA ANGELO FUMAGALLI 6, 20143 MILANO	
ING. LAURA CONTI		scritta all'Ordine degli Ingegneri della Provincia di Pavia al n. 1726	
OGGETTO		IMPIANTO EOLICO DA 105 MW - COMUNE DI PACECO (PV), MISUSCEDI (TP) e TRAPANI (TP)	
TITOLO		PAC12 - SEZIONI TRASVERSALI VIABILITA'	
N. W.		2995_5531_PAC_PFE_T13.12_REV.12_PAC12-SEZIONI TRASVERSALI VIABILITA'	
E' VIETATA LA RIPRODUZIONE DI QUESTO DOCUMENTO SENZA PREVENUTA AUTORIZZAZIONE SCRITTA DELLA MONTANA SPA		N. TAV. T13.12b	