

BARI

NAPOLI

LEGENDA

Table with 3 columns: COMPLESSO IDROGEOLOGICO, TIPO DI PERMEABILITÀ, GRADO DI PERMEABILITÀ (m/s). Includes descriptions for various geological complexes like ghiaioso-sabbioso, limoso-argilloso, etc.

LEGENDA INDAGINI GEOGNOSTICHE

Legend for geognostic investigations. Includes symbols for sondaggio a carotaggio continuo, Database indagini ISPRA, and various symbols for sondaggio interrotto per presenza di gas. Also includes symbols for sondaggi geofisici and traccie sezioni geologiche-geomorfologiche.

COMPLESSI DELLE UNITÀ DEL SUBSTRATO

Table detailing geological units (ANZ1, ANZ2, ANZ3, ANZ4, ANZ5, ANZ6, ANZ7, ANZ8, ANZ9, ANZ10, ANZ11, ANZ12, ANZ13, ANZ14, ANZ15, ANZ16, ANZ17, ANZ18, ANZ19, ANZ20, ANZ21, ANZ22, ANZ23, ANZ24, ANZ25, ANZ26, ANZ27, ANZ28, ANZ29, ANZ30, ANZ31, ANZ32, ANZ33, ANZ34, ANZ35, ANZ36, ANZ37, ANZ38, ANZ39, ANZ40, ANZ41, ANZ42, ANZ43, ANZ44, ANZ45, ANZ46, ANZ47, ANZ48, ANZ49, ANZ50, ANZ51, ANZ52, ANZ53, ANZ54, ANZ55, ANZ56, ANZ57, ANZ58, ANZ59, ANZ60, ANZ61, ANZ62, ANZ63, ANZ64, ANZ65, ANZ66, ANZ67, ANZ68, ANZ69, ANZ70, ANZ71, ANZ72, ANZ73, ANZ74, ANZ75, ANZ76, ANZ77, ANZ78, ANZ79, ANZ80, ANZ81, ANZ82, ANZ83, ANZ84, ANZ85, ANZ86, ANZ87, ANZ88, ANZ89, ANZ90, ANZ91, ANZ92, ANZ93, ANZ94, ANZ95, ANZ96, ANZ97, ANZ98, ANZ99, ANZ100). Each unit includes a description of its lithology and hydrogeological characteristics.

KEY-MAP

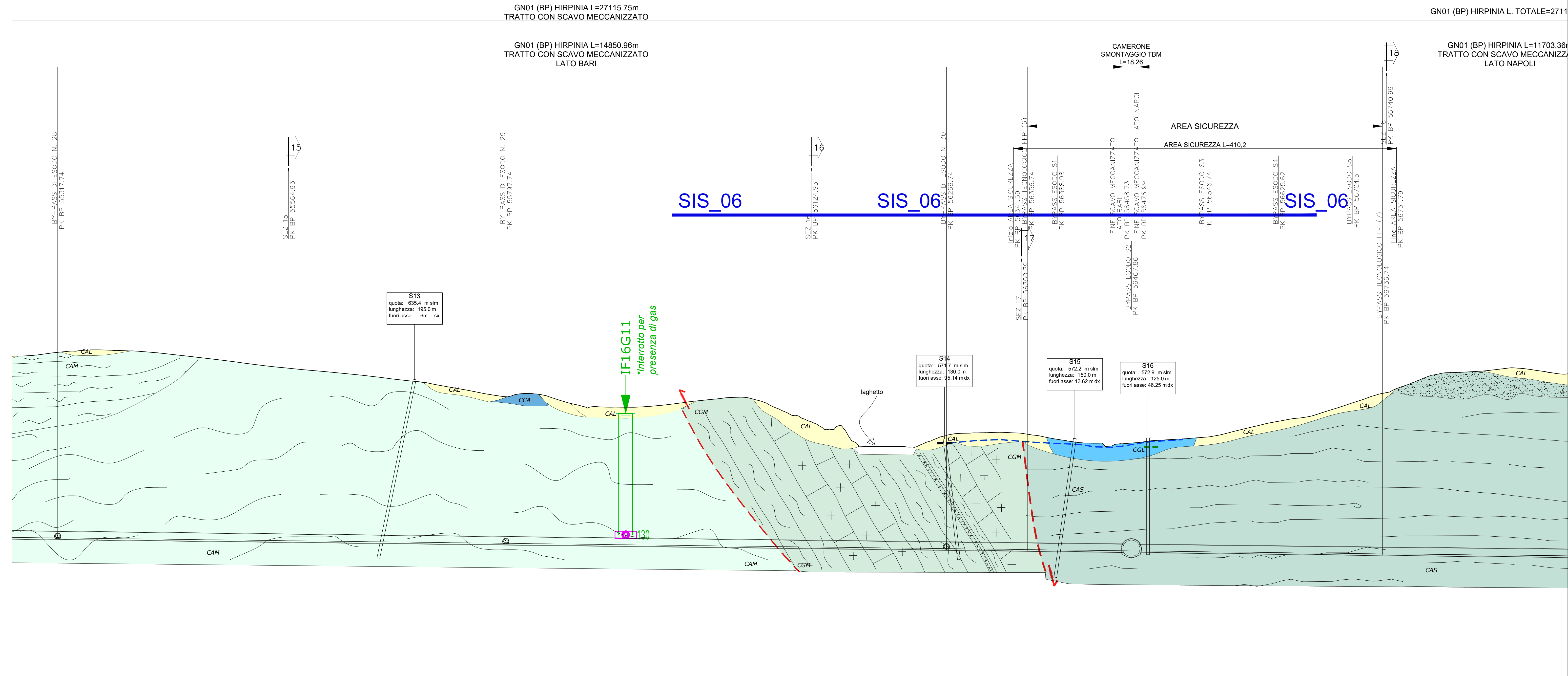
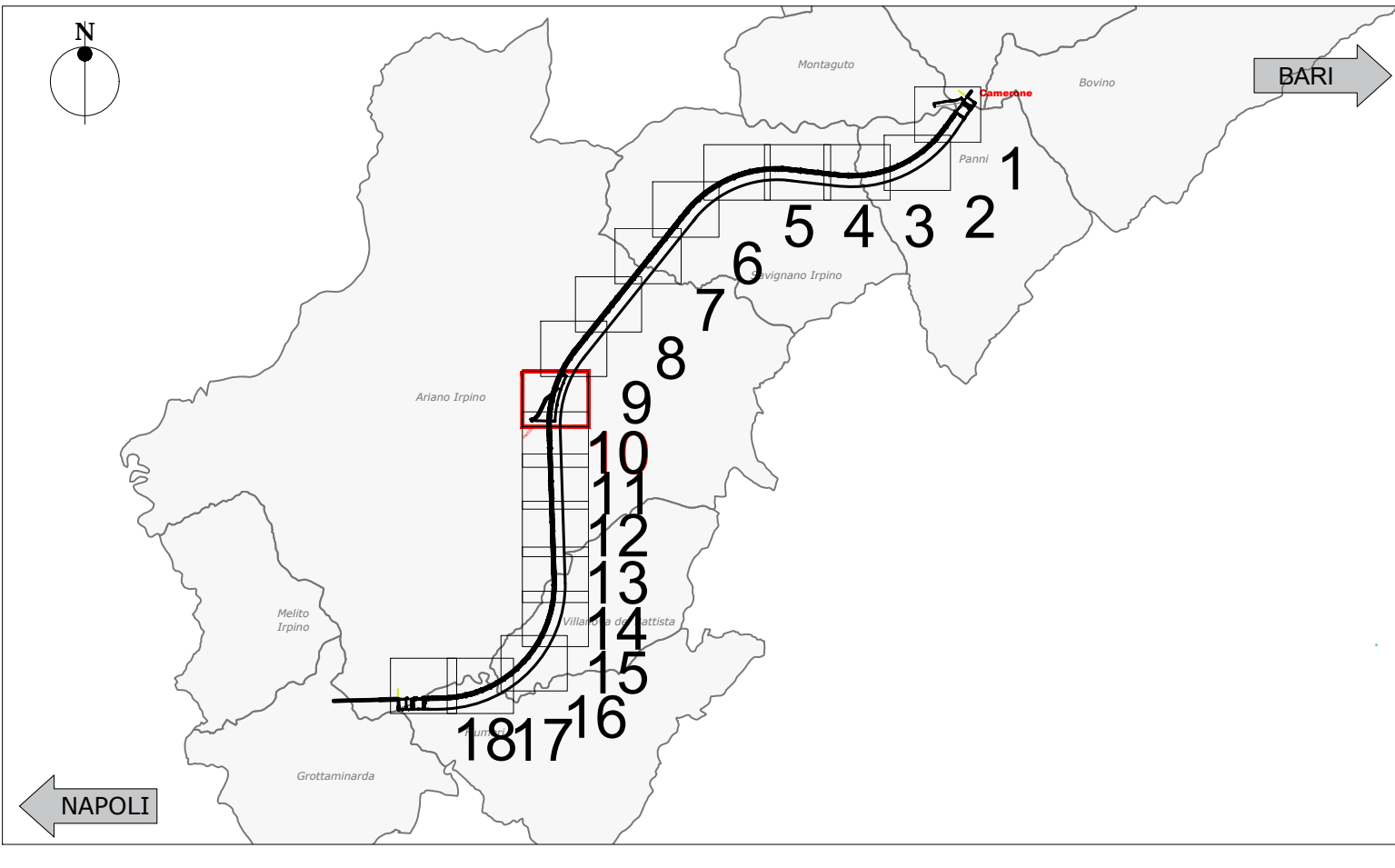

Table with 2 columns: 'N. Sezione' and 'Quota Progetto'. It provides a detailed list of elevation data for various points along the profile.

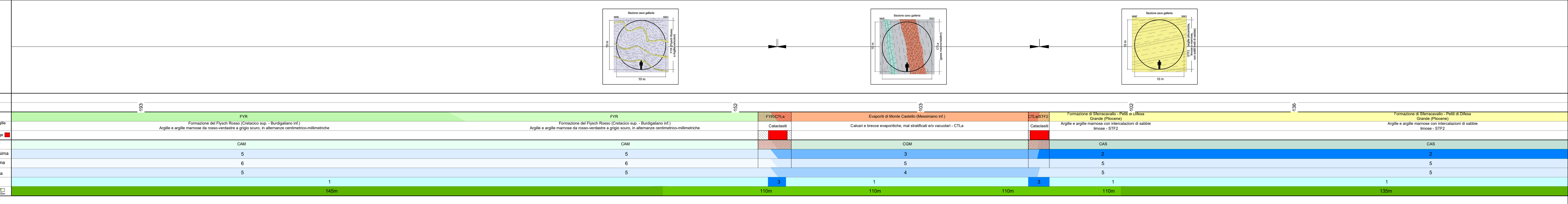

Table with 4 columns: 'Rev.', 'Descrizione', 'Data', 'Verificato', 'Data', 'Approvato', 'Data', 'Autorizzato Data'. It contains a project schedule or log with various entries and dates.

Administrative and project information section. Includes 'COMMITTENTE' (RFI), 'DIREZIONE LAVORI' (ITALFERR), 'APPALTATORE' (webuild Italia), 'PROGETTAZIONE' (Rock Soul), and 'PROGETTO ESECUTIVO' details for the BARI - ORSARA AV line.