

BARI

NAPOLI

GN01 (BD) HIRPINIA L. TOTALE=27093,78m

GN01 (BD) HIRPINIA L. TOTALE=2705

GN01 (BD) HIRPINIA L=14869,94m

TRATTO CON SCAVO MECCANIZZATO LATO BARI

CAMERONE SMONTAGGIO TBM L=16,26

AREA SICUREZZA - GN01 (BD) L=145,95m

GN01 (BD) HIRPINIA L=11662,30m

TRATTO CON SCAVO MECCANIZZATO LATO NAPOLI

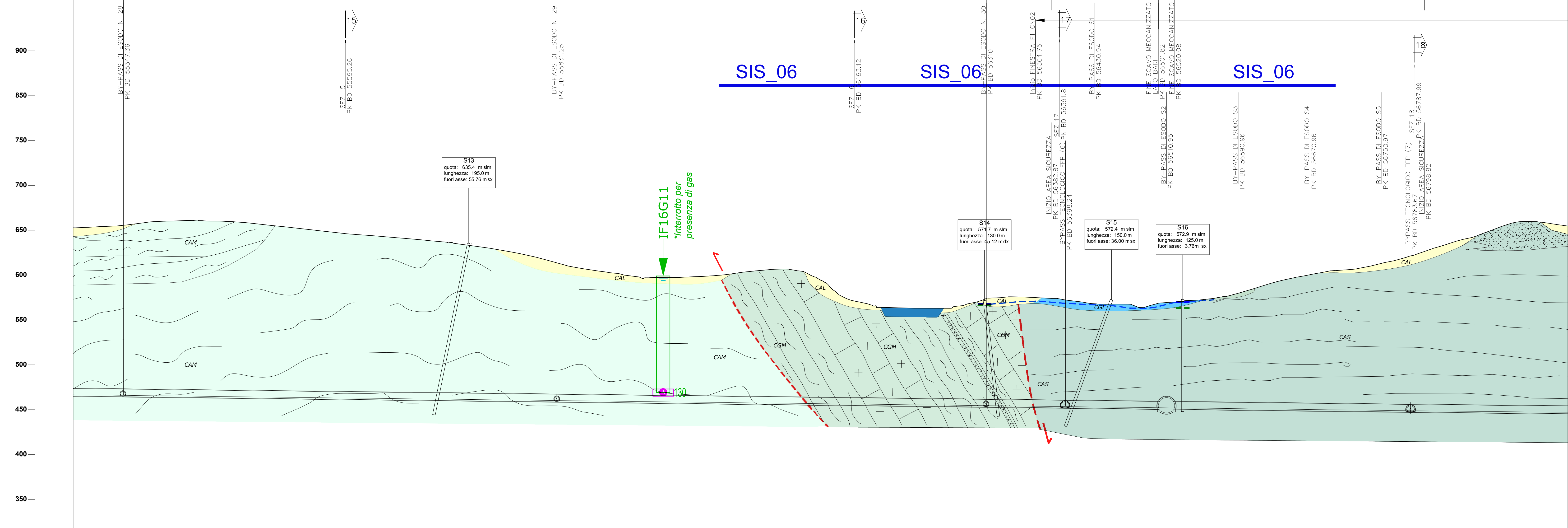

Table with 2 columns: 'N. Sezione' and 'Quota s.l.m.'. It lists various data points along the profile, including borehole identifiers and elevations.

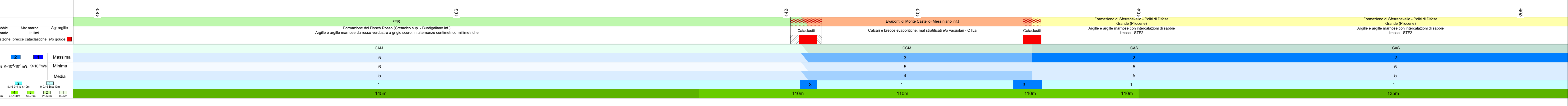
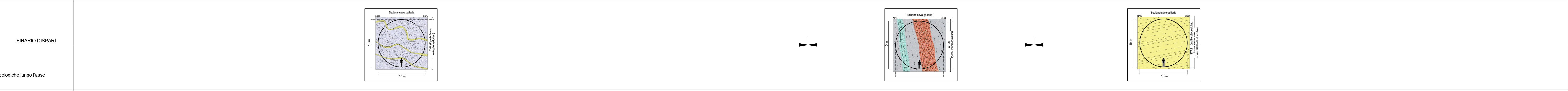

Table titled 'FASE CONOSCITIVA IDROGEOLOGICA' showing data for different geological units (CAM, CGM, CAS) including permeability values and other characteristics.

Table titled 'LEGENDA' and 'COMPLESSO IDROGEOLOGICO'. It lists various geological complexes (e.g., 'Complesso ghiaioso-sabbioso', 'Complesso limoso-argilloso') and their corresponding symbols and colors.

Table titled 'COMPLESSI DELLE UNITA' DEL SUBSTRATO'. It lists geological units (e.g., ANZ2, BVN6, FVR6) and their corresponding symbols and colors.

Table titled 'COMPLESSI DELLE UNITA' DEL SUBSTRATO'. It lists geological units (e.g., ANZ2, BVN6, FVR6) and their corresponding symbols and colors.

Table titled 'COMPLESSI DELLE UNITA' DEL SUBSTRATO'. It lists geological units (e.g., ANZ2, BVN6, FVR6) and their corresponding symbols and colors.

Table titled 'COMPLESSI DELLE UNITA' DEL SUBSTRATO'. It lists geological units (e.g., ANZ2, BVN6, FVR6) and their corresponding symbols and colors.

Table titled 'LEGENDA INDAGINI GEOGNOSTICHE'. It lists various investigation methods (e.g., 'Sondaggio a carotaggio continuo', 'Database indagini ISPRA') and their corresponding symbols and colors.

Table titled 'LEGENDA INDAGINI GEOGNOSTICHE'. It lists various investigation methods (e.g., 'Sondaggio a carotaggio continuo', 'Database indagini ISPRA') and their corresponding symbols and colors.

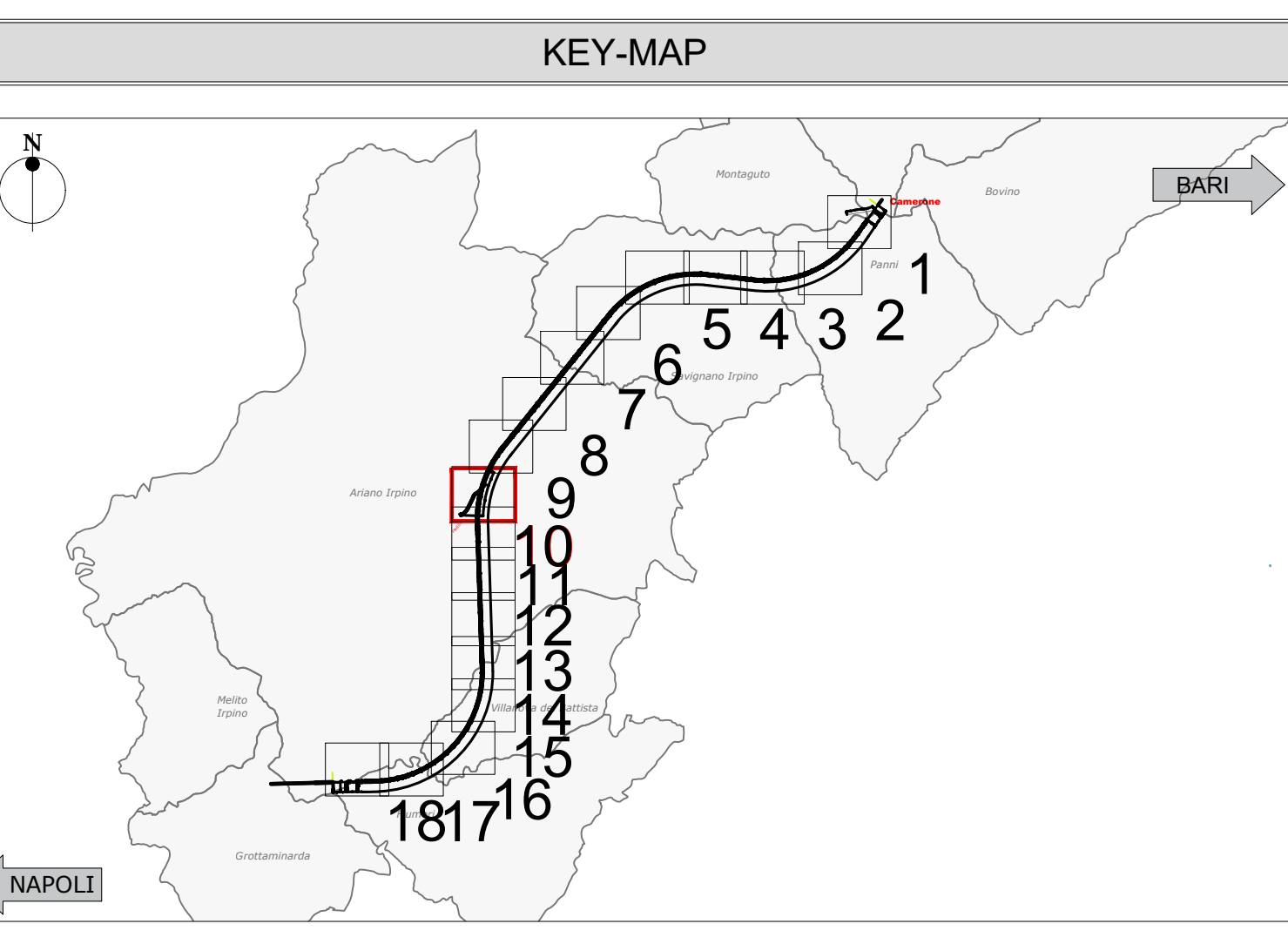

Project information block including 'COMMITTENTE' (RFI), 'DIREZIONE LAVORI' (ITALFERR), 'APPALTATORE' (webuild Italia), 'PROGETTAZIONE' (Rock Soul), and 'PROGETTO ESECUTIVO' details.