



COLLEGAMENTO AUTOSTRADALE DALMINE-COMO-VARESE-VALICO DEL GAGGIOLO E OPERE AD ESSO CONNESSE

CODICE C.U.P. F11B06000270007

PROGETTO ESECUTIVO TRATTA B2

FASCICOLO DEI SESTI D'IMPIANTO E DELLE ESSENZE VEGETALI

IDENTIFICAZIONE ELABORATO

| FASE PROGETTUALE | AMBITO | TRATTA | CATEGORIA | OPERA | PARTI DI OPERA | TIPO ELABORATO | PROGRESSIVA | REVISIONE ESTERNA |
|------------------|--------|--------|-----------|-------|----------------|----------------|-------------|-------------------|
| E | AM | B2 | 000 | AT00 | 122 | FA | 001 | A |

DATA Giugno 2023
SCALA

CONCEDENTE



CONTRAENTE GENERALE

PEDELOMBARDA NUOVA S.c.p.A.

DATA REVISIONE

| DATA | REVISIONE | |
|---------------|------------------------|-----|
| 7 aprile 2023 | Bozza | A01 |
| Giugno 2023 | Emissione per commenti | A02 |

CONCESSIONARIO

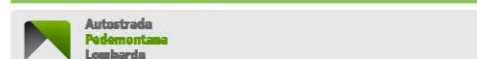

ELABORAZIONE PROGETTUALE

| PROGETTISTI | RESPONSABILE INTEGRAZIONE PRESTAZIONI SPECIALISTICHE |
|-----------------------|--|
| Proger s.p.a. | Ing. Carlo Listorti |
| Redatto Arch. A.Kipar | Visto Ing. M. Larosa |
| | Aperovato Ing. M. Sandrucci |

PROGETTISTA



Il presente documento non potrà essere copiato, riprodotto o altrimenti pubblicato in tutto o in parte senza il consenso scritto di Autostrada Pedemontana Lombarda S.p.A. Ogni utilizzo non autorizzato sarà perseguito a norma di legge. This document may not be copied, reproduced or published either in part or entirely without the written permission of Autostrada Pedemontana Lombarda S.p.A. Unauthorized use will be persecuted by law.

Filare singolo/doppio arboreo di I grandezza

Quercu - carpinetu

PAESAGGIO AGRICOLO

PAESAGGIO PERIURBANO

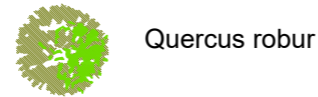
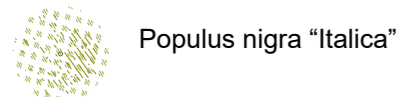
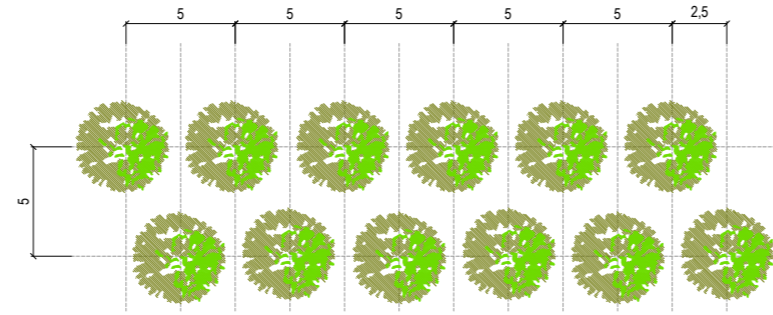
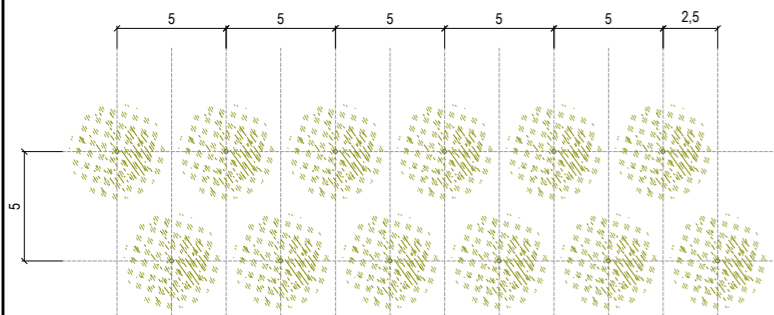
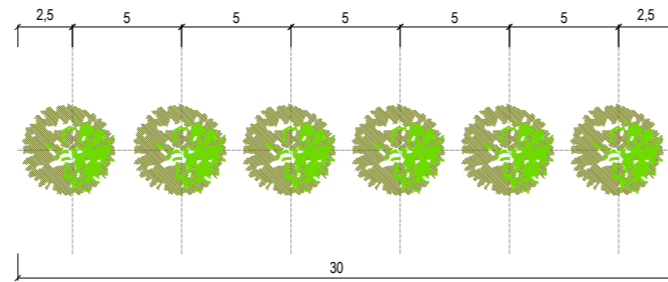
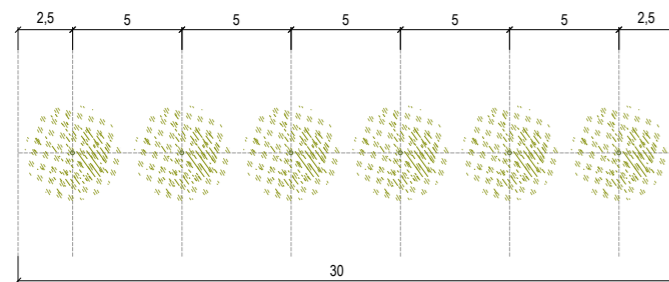

| CONSOCIAZIONI VEGETALI | AMBITI | | | | | |
|------------------------|--|-------|----------|----------------------|-------|------|
| | Agricolo | % | | Urbano-periurbano | % | |
| | | misto | puro | | misto | puro |
| Quercu-carpinetu | <i>Populus nigra Italica</i> | 0 | 100 | <i>Quercus robur</i> | 0 | 100 |
| Alneto di ontano nero | <i>Populus alba</i> | 0 | 100 | <i>Populus alba</i> | 0 | 100 |
| SCHEDA TIPOLOGICO | Dimensione: lunghezza 30m, larghezza 5m | | | | | |
| | Quantità e dimensioni d'impianto: 6 alberi (h.175-250cm p.te forestali; circ. 10-12cm per alberi ornamentali) | | | | | |
| | TOTALE | | 6 | | | |

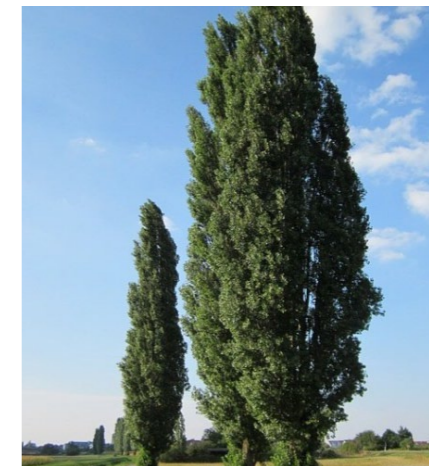

Populus nigra "Italica"



Quercus robur

Filare singolo/doppio arboreo di I grandezza

Alneto di Ontano nero

PAESAGGIO AGRICOLO E PERIURBANO

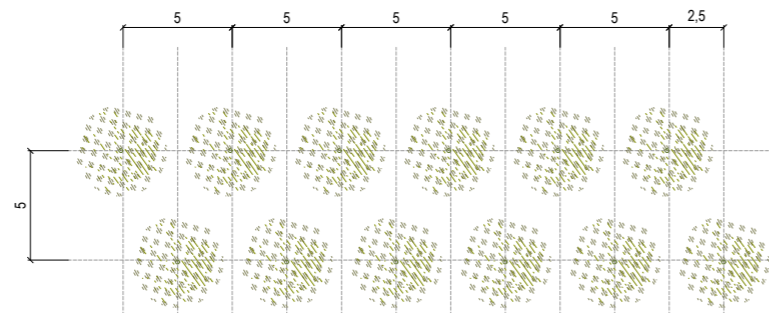
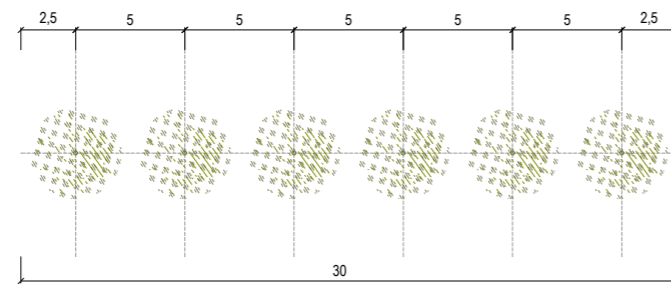

| CONSOCIAZIONI VEGETALI | AMBITI | | | | | |
|------------------------|--|-------|----------|----------------------|-------|------|
| | Agricolo | % | | Urbano-periurbano | % | |
| | | misto | puro | | misto | puro |
| Quercu-carpineto | <i>Populus nigra Italica</i> | 0 | 100 | <i>Quercus robur</i> | 0 | 100 |
| Alneto di ontano nero | <i>Populus alba</i> | 0 | 100 | <i>Populus alba</i> | 0 | 100 |
| SCHEDA TIPOLOGICO | Dimensione: lunghezza 30m, larghezza 5m | | | | | |
| | Quantità e dimensioni d'impianto: 6 alberi (h.175-250cm p.te forestali; circ. 10-12cm per alberi ornamentali) | | | | | |
| | TOTALE | | 6 | | | |



Populus nigra "Italica"

Filare singolo/doppio arboreo di II grandezza

Quercu - carpinetu

PAESAGGIO AGRICOLO

PAESAGGIO PERIURBANO

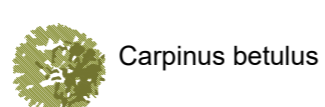
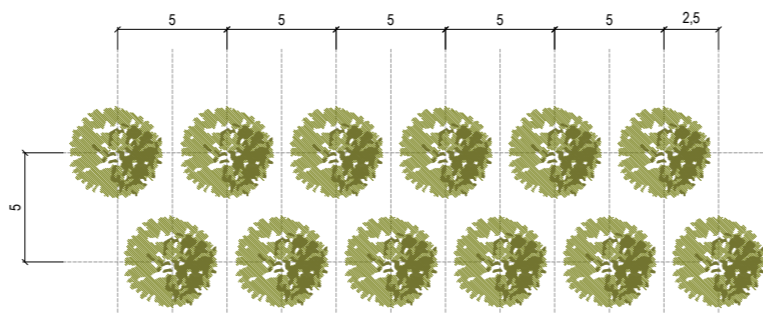
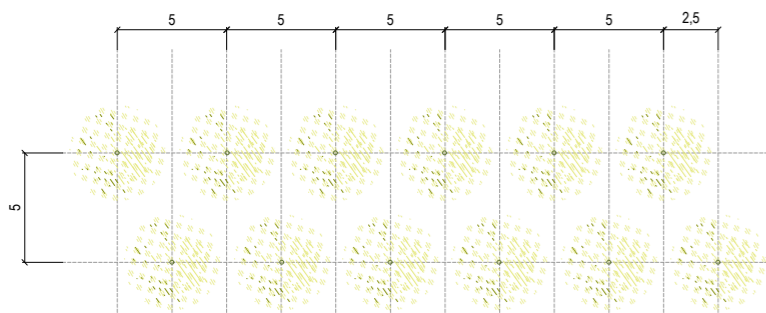
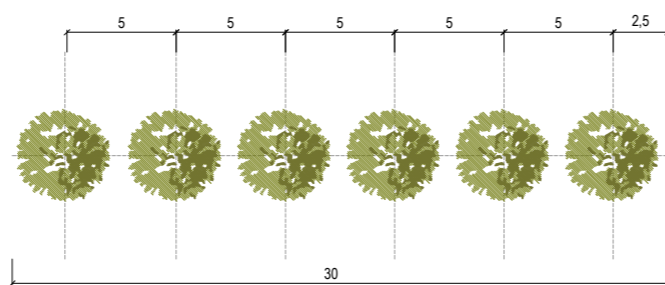
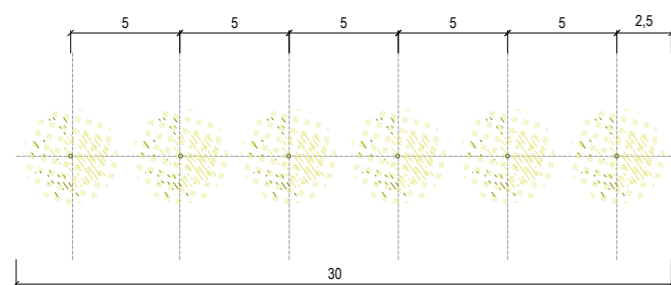
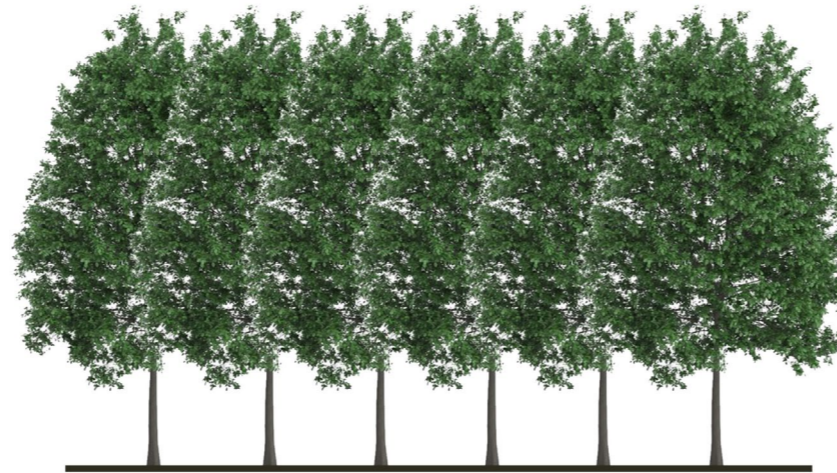

| CONSOCIAZIONI VEGETALI | AMBITI | | | | | |
|------------------------|--|-------|----------|-------------------------|-------|------|
| | Agricolo | % | | Urbano-periurbano | % | |
| | | misto | puro | | misto | puro |
| Quercu-carpinetu | <i>Salix alba</i> | 0 | 100 | <i>Carpinus betulus</i> | 0 | 100 |
| Alneto di ontano nero | <i>Alnus glutinosa</i> | 0 | 100 | <i>Alnus glutinosa</i> | 0 | 100 |
| SCHEDA TIPOLOGICO | Dimensione: lunghezza 30m, larghezza 5m | | | | | |
| | Quantità e dimensioni d'impianto: 6 alberi (h.175-250cm p.te forestali; circ. 10-12cm per alberi ornamentali) | | | | | |
| | TOTALE | | 6 | | | |



Salix alba



Carpinus betulus

Filare singolo/doppio arboreo di II grandezza

Alneto di Ontano nero

PAESAGGIO AGRICOLO E PERIURBANO

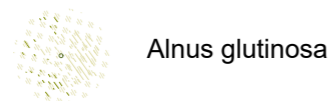
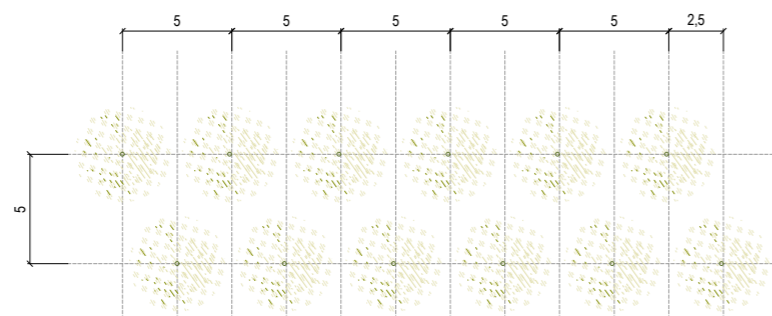
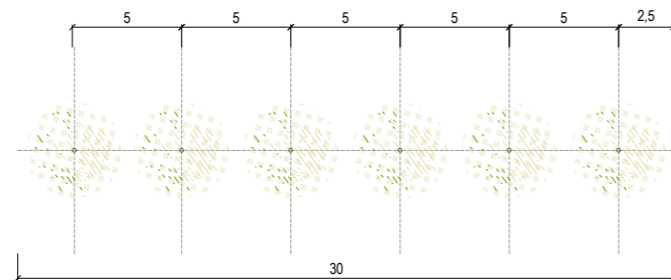

| CONSOCIAZIONI VEGETALI | AMBITI | | | | | |
|------------------------|--|-------|----------|-------------------------|-------|------|
| | Agricolo | % | | Urbano-periurbano | % | |
| | | misto | puro | | misto | puro |
| Quercu-carpineto | <i>Salix alba</i> | 0 | 100 | <i>Carpinus betulus</i> | 0 | 100 |
| Alneto di ontano nero | <i>Alnus glutinosa</i> | 0 | 100 | <i>Alnus glutinosa</i> | 0 | 100 |
| SCHEDA TIPOLOGICO | Dimensione: lunghezza 30m, larghezza 5m | | | | | |
| | Quantità e dimensioni d'impianto: 6 alberi (h.175-250cm p.te forestali; circ. 10-12cm per alberi ornamentali) | | | | | |
| | TOTALE | | 6 | | | |



Alnus glutinosa

Filare singolo/doppio arboreo di III grandezza

Quercu - carpineto

PAESAGGIO AGRICOLO

PAESAGGIO PERIURBANO

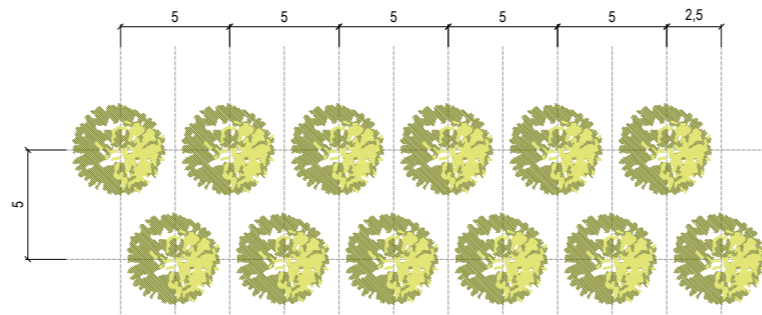
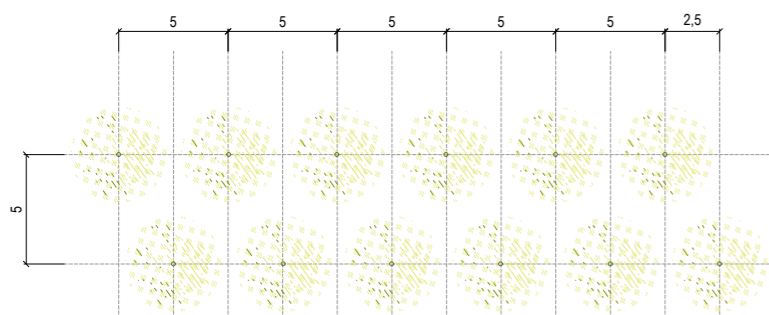
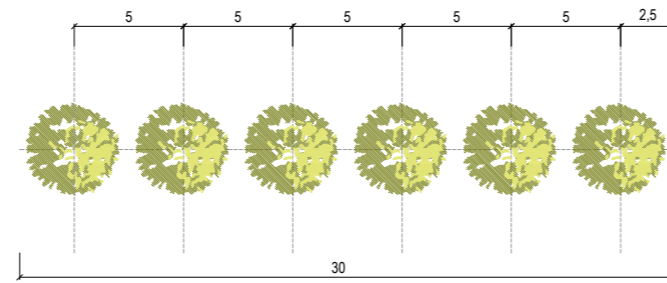
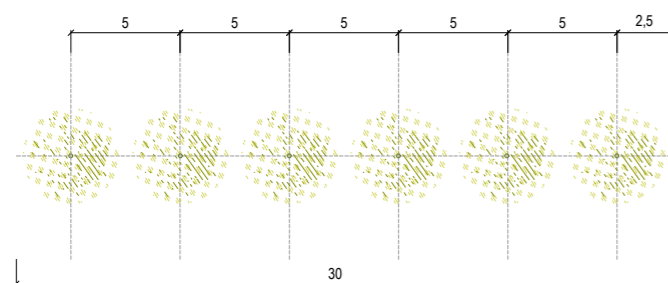

Morus alba

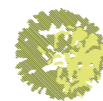

Acer campestre

| CONSOCIAZIONI VEGETALI | AMBITI | | | | | |
|------------------------|--|-------|------|-----------------------|-------|------|
| | Agricolo | % | | Urbano-periurbano | % | |
| | | misto | puro | | misto | puro |
| Quercu-carpineto | <i>Morus alba</i> | 0 | 100 | <i>Acer campestre</i> | 0 | 100 |
| Alneto di ontano nero | <i>Prunus padus</i> | 0 | 100 | <i>Prunus padus</i> | 0 | 100 |
| SCHEDE TIPOLOGICO | Dimensione: lunghezza 30m, larghezza 5m | | | | | |
| | Quantità e dimensioni d'impianto: 6 alberi (h.175-250cm p.te forestali; circ. 10-12cm per alberi ornamentali) | | | | | |
| | TOTALE 6 | | | | | |



Morus alba





Acer campestre

Filare singolo/doppio arboreo di III grandezza

Alneto di Ontano nero

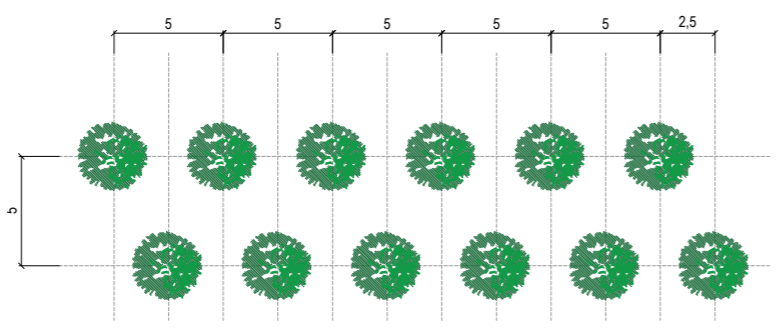
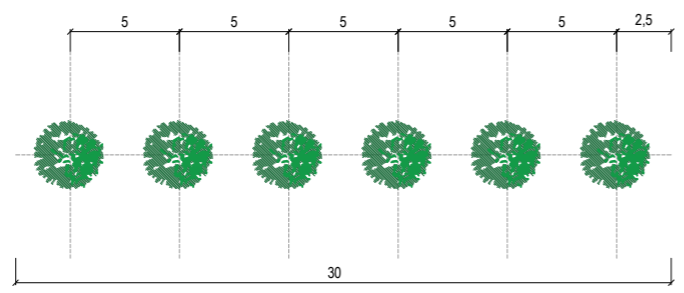
PAESAGGIO AGRICOLO E PERIURBANO



 Prunus padus

| CONSOZIAZIONI VEGETALI | AMBITI | | | | | |
|------------------------|--|-------|----------|-----------------------|-------|------|
| | Agricolo | % | | Urbano-periurbano | % | |
| | | misto | puro | | misto | puro |
| Quercu-carpineto | <i>Morus alba</i> | 0 | 100 | <i>Acer campestre</i> | 0 | 100 |
| Alneto di ontano nero | <i>Prunus padus</i> | 0 | 100 | <i>Prunus padus</i> | 0 | 100 |
| SCHEDE TIPOLOGICO | Dimensione: lunghezza 30m, larghezza 5m | | | | | |
| | Quantità e dimensioni d'impianto: 6 alberi (h.175-250cm p.te forestali; circ. 10-12cm per alberi ornamentali) | | | | | |
| | TOTALE | | 6 | | | |



Prunus padus

Filare singolo/doppio plurispecifico

Quercu - carpinetu

PAESAGGIO AGRICOLO

PAESAGGIO PERIURBANO

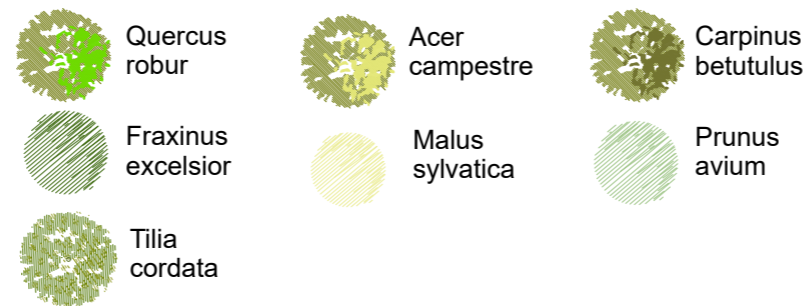
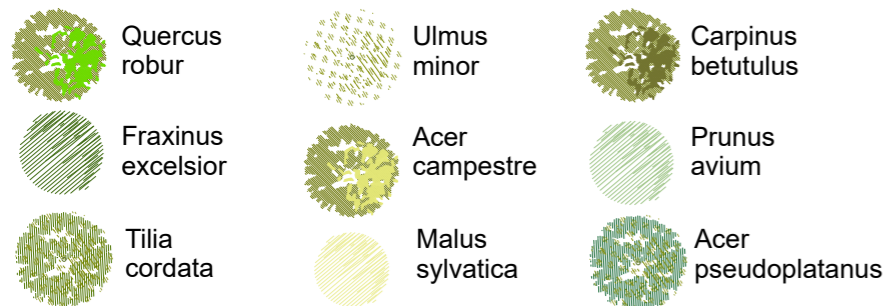
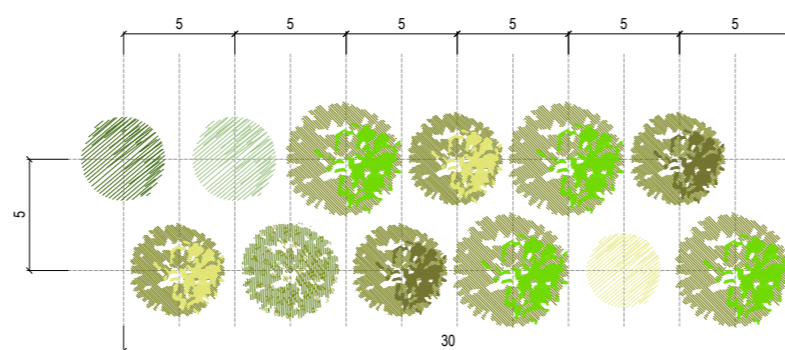
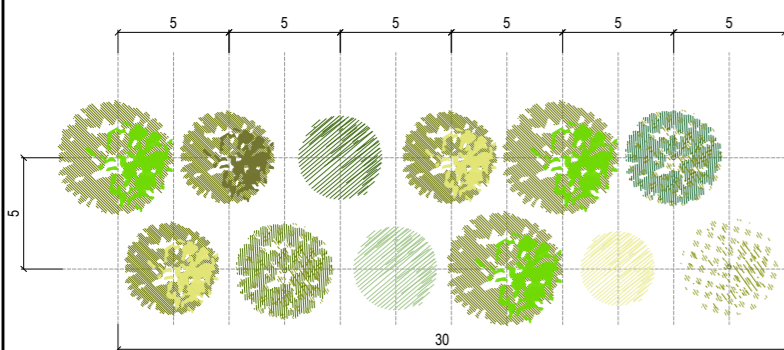
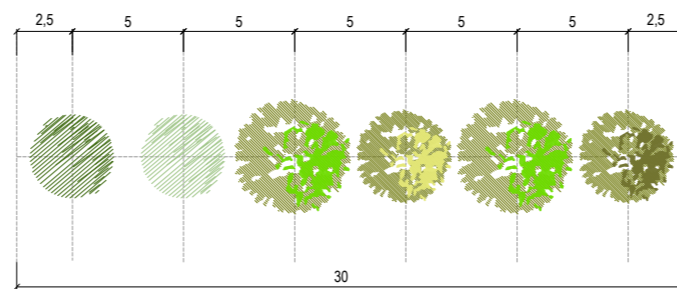
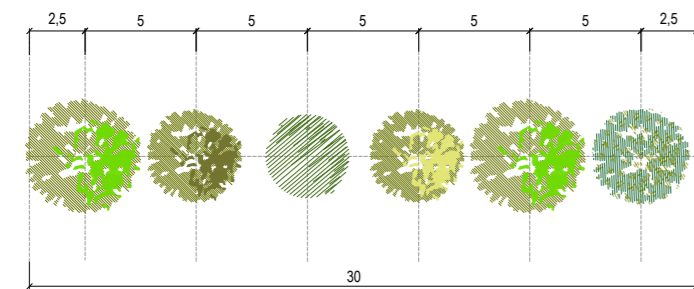

| CONSOZIAZIONI VEGETALI | AMBITI | | | | | | | | | | |
|------------------------|----------------------------|-------|------|---------------------------|-------|------------------------|----------------------------|---------------|------|-----|---|
| | Agricolo | % | | Urbano-periurbano | % | | Naturalistico | % | | | |
| | | misto | puro | | misto | puro | | misto | puro | | |
| Quercu-carpinetu | <i>Quercus robur</i> | 20 | 0 | <i>Quercus robur</i> | 30 | 100 | <i>Quercus robur</i> | 20 | 0 | | |
| | <i>Fraxinus excelsior</i> | 10 | 0 | <i>Fraxinus excelsior</i> | 10 | 0 | <i>Fraxinus excelsior</i> | 5 | 0 | | |
| | <i>Tilia cordata</i> | 10 | 0 | <i>Tilia cordata</i> | 10 | 0 | <i>Tilia cordata</i> | 10 | 0 | | |
| | <i>Ulmus minor</i> | 10 | 0 | <i>Acer campestre</i> | 10 | 0 | <i>Platanus x hybrida</i> | 5 | 0 | | |
| | <i>Acer campestre</i> | 15 | 0 | <i>Malus sylvatica</i> | 5 | 0 | <i>Quercus petrea</i> | 5 | 0 | | |
| | <i>Malus sylvatica</i> | 10 | 0 | <i>Carpinus betulus</i> | 25 | 0 | <i>Ulmus minor</i> | 10 | 0 | | |
| | <i>Carpinus betulus</i> | 10 | 0 | <i>Prunus avium</i> | 10 | 0 | <i>Carpinus betulus</i> | 15 | 0 | | |
| | <i>Prunus avium</i> | 10 | 0 | | | 0 | <i>Prunus avium</i> | 5 | 0 | | |
| | <i>Acer pseudoplatanus</i> | 5 | 0 | | | 0 | <i>Acer pseudoplatanus</i> | 10 | 0 | | |
| | | | | | | | <i>Betula pendula</i> | 3 | 0 | | |
| | | | | | | <i>Acer campestre</i> | 10 | 0 | | | |
| | | | | | | <i>Malus sylvatica</i> | 2 | 0 | | | |
| TOTALE | | 100 | 0 | TOTALE | | 100 | 0 | TOTALE | | 100 | 0 |

| SCHEDA TIPOLOGICO | Dimensione: | lunghezza 30m, larghezza 5m |
|-------------------|-----------------------------------|---|
| | Quantità e dimensioni d'impianto: | 6 alberi (h.175-250cm per p.te forestali; circ. 10-12cm per alberi ornamentali) |
| | TOTALE | 6 |



Fraxinus excelsior



Tilia cordata



Ulmus minor



Quercus robur



Acer campestre



Malus sylvatica



Carpinus betulus

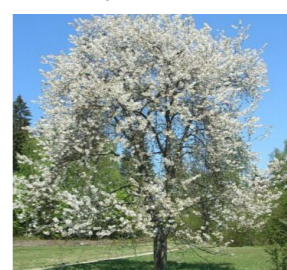

Prunus avium

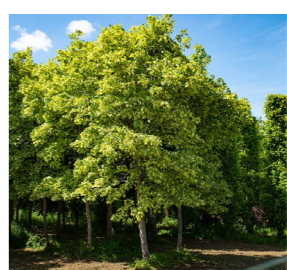

Acer pseudoplatanus

Filare singolo/doppio plurispecifico

Quercu - carpinetu

PAESAGGIO NATURALISTICO

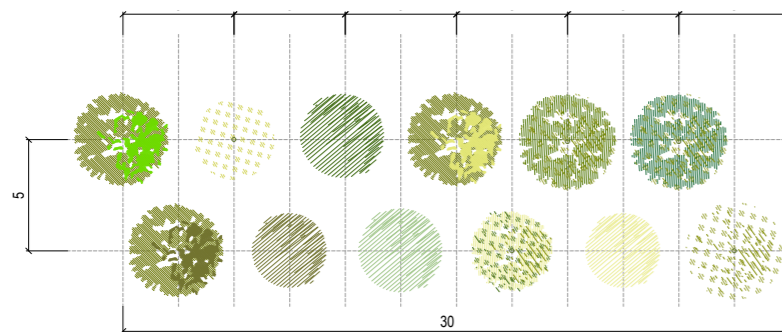
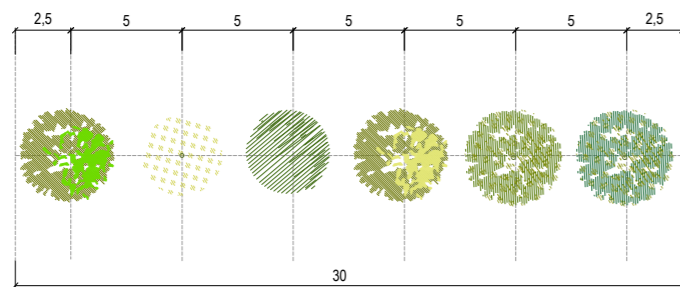

- Quercus robur**
- Fraxinus excelsior**
- Tilia cordata**
- Platanus x hybrida**
- Quercus petrea**
- Ulmus minor**
- Carpinus betulus**
- Acer pseudoplatanus**
- Prunus avium**
- Betula pendula**
- Acer campestre**
- Malus sylvatica**

| CONSOCIAZIONI VEGETALI | AMBITI | | | | | | | | |
|-------------------------|----------------------------|-------|------|---------------------------|-------|------|----------------------------|------|---|
| | Agricolo | % | | Urbano-periurbano | % | | Naturalistico | | |
| | | misto | puro | | misto | puro | misto | puro | |
| Quercu-carpinetu | <i>Quercus robur</i> | 20 | 0 | <i>Quercus robur</i> | 30 | 100 | <i>Quercus robur</i> | 20 | 0 |
| | <i>Fraxinus excelsior</i> | 10 | 0 | <i>Fraxinus excelsior</i> | 10 | 0 | <i>Fraxinus excelsior</i> | 5 | 0 |
| | <i>Tilia cordata</i> | 10 | 0 | <i>Tilia cordata</i> | 10 | 0 | <i>Tilia cordata</i> | 10 | 0 |
| | <i>Ulmus minor</i> | 10 | 0 | <i>Acer campestre</i> | 10 | 0 | <i>Platanus x hybrida</i> | 5 | 0 |
| | <i>Acer campestre</i> | 15 | 0 | <i>Malus sylvestris</i> | 5 | 0 | <i>Quercus petrea</i> | 5 | 0 |
| | <i>Malus sylvestris</i> | 10 | 0 | <i>Carpinus betulus</i> | 25 | 0 | <i>Ulmus minor</i> | 10 | 0 |
| | <i>Carpinus betulus</i> | 10 | 0 | <i>Prunus avium</i> | 10 | 0 | <i>Carpinus betulus</i> | 15 | 0 |
| | <i>Prunus avium</i> | 10 | 0 | | | 0 | <i>Prunus avium</i> | 5 | 0 |
| | <i>Acer pseudoplatanus</i> | 5 | 0 | | | 0 | <i>Acer pseudoplatanus</i> | 10 | 0 |
| | | | | | | | <i>Betula pendula</i> | 3 | 0 |
| | | | | | | | <i>Acer campestre</i> | 10 | 0 |
| | | | | | | | <i>Malus sylvatica</i> | 2 | 0 |
| TOTALE | | 100 | 0 | TOTALE | 100 | 0 | TOTALE | 100 | 0 |

| | | |
|--------------------------|--|---|
| SCHEDA TIPOLOGICO | Dimensione: | lunghezza 30m, larghezza 5m |
| | Quantità e dimensioni d'impianto: | 6 alberi (h.175-250cm per p.te forestali; circ. 10-12cm per alberi ornamentali) |
| | TOTALE | 6 |



Filare singolo/doppio plurispecifico

Alneto di Ontano nero

PAESAGGIO AGRICOLO - PERIURBANO

PAESAGGIO NATURALISTICO

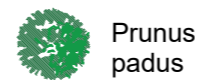
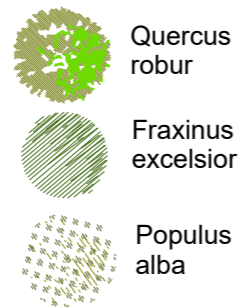
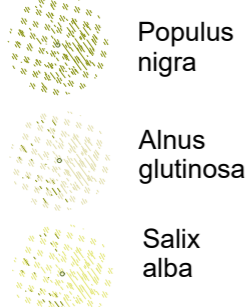
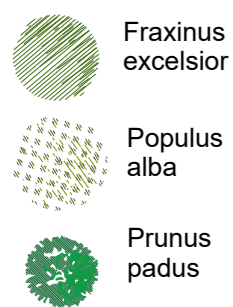
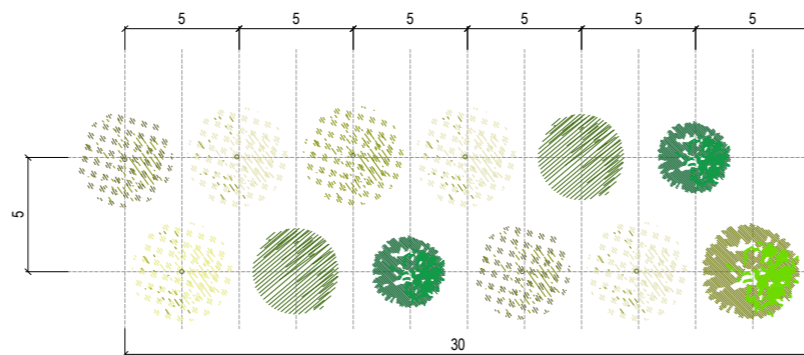
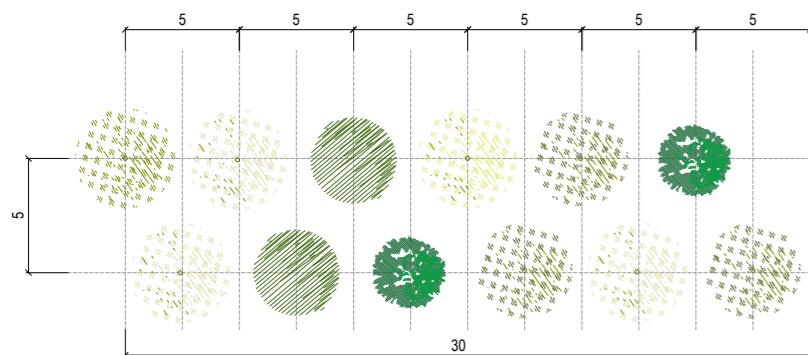
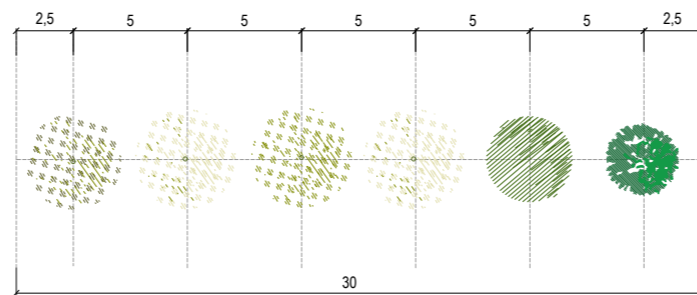
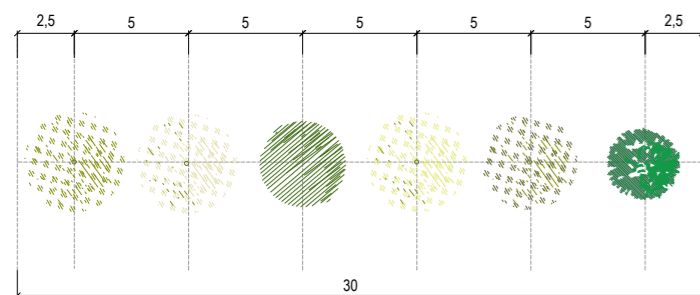

| Alneto di ontano nero | | <i>Fraxinus excelsior</i> | 8 | 0 | <i>Fraxinus excelsior</i> | 8 | 0 | <i>Quercus robur</i> | 5 | 0 |
|-----------------------|--|---------------------------|-----|---|---------------------------|----|-----|---------------------------|-----|---|
| | | <i>Populus alba</i> | 17 | 0 | <i>Populus alba</i> | 17 | 0 | <i>Fraxinus excelsior</i> | 8 | 0 |
| | | <i>Populus nigra</i> | 7 | 0 | <i>Populus nigra</i> | 7 | 0 | <i>Populus alba</i> | 15 | 0 |
| | | <i>Alnus glutinosa</i> | 50 | 0 | <i>Alnus glutinosa</i> | 50 | 0 | <i>Populus nigra</i> | 6 | 0 |
| | | <i>Salix alba</i> | 13 | 0 | <i>Salix alba</i> | 13 | 0 | <i>Alnus glutinosa</i> | 48 | 0 |
| | | <i>Prunus padus</i> | 5 | 0 | <i>Prunus padus</i> | 5 | 0 | <i>Salix alba</i> | 13 | 0 |
| | | | | | | | | <i>Prunus padus</i> | 5 | 0 |
| | | TOTALE | 100 | 0 | TOTALE | 0 | 100 | TOTALE | 100 | 0 |

| SCHEDA TIPOLOGICO | Dimensione: | lunghezza 30m, larghezza 5m |
|-------------------|-----------------------------------|---|
| | Quantità e dimensioni d'impianto: | 6 alberi (h.175-250cm per p.te forestali; circ. 10-12cm per alberi ornamentali) |
| | TOTALE | 6 |



Fraxinus excelsior



Quercus robur



Prunus padus



Populus alba



Populus nigra



Salix alba



Alnus glutinosa

Fascia arboreo arbustiva di I grandezza

Quercu - carpinetu

PAESAGGIO AGRICOLU

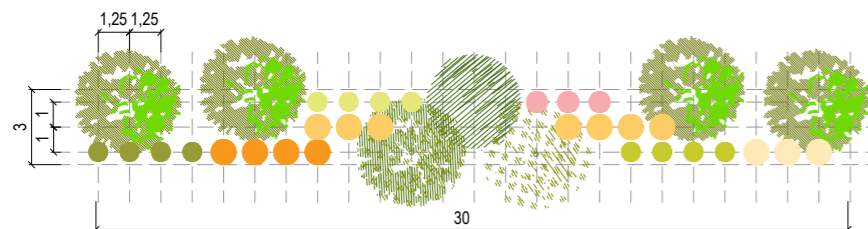

- Quercus robur
- Fraxinus excelsior
- Tilia cordata
- Ulmus minor
- Berberis vulgaris
- Ligustrum vulgare
- Euonymus europaeus
- Rosa rugosa
- Corylus avellana
- Crataegus monogyna
- Cornus mas

PAESAGGIO PERIURBANU

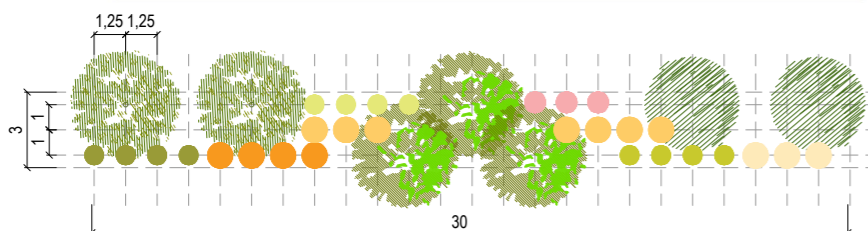

- Quercus robur
- Fraxinus excelsior
- Tilia cordata
- Berberis vulgaris
- Ligustrum vulgare
- Euonymus europaeus
- Rosa rugosa
- Corylus avellana
- Crataegus monogyna
- Cornus mas

| CONSOCIAZIONI VEGETALI | Alberi I grandezza | % | Arbusti <3m | % | Arbusti >3m | % | |
|--|---------------------------|---------------------------|-----------------------------------|--------------------------|-------------------------|-------------------------|----|
| AMBITO NATURALISTICO | | | | | | | |
| Quercu-carpinetu | <i>Quercus robur</i> | 55 | <i>Berberis vulgaris</i> | 15 | <i>Corylus avellana</i> | 19 | |
| | <i>Fraxinus excelsior</i> | 10 | <i>Ligustrum vulgare</i> | 15 | <i>C. monogyna</i> | 15 | |
| | <i>Platanus x hybrida</i> | 10 | <i>E. europaeus</i> | 12 | <i>Cornus mas</i> | 12 | |
| | <i>Tilia cordata</i> | 10 | <i>Rosa rugosa</i> | 12 | | | |
| | <i>Ulmus minor</i> | 10 | | | | | |
| | <i>Quercus petraea</i> | 5 | | | | | |
| | TOTALE | 100 | TOTALE | 54 | TOTALE | 46 | |
| | AMBITO AGRICOLU | | | | | | |
| | Quercu-carpinetu | <i>Quercus robur</i> | 55 | <i>Berberis vulgaris</i> | 15 | <i>Corylus avellana</i> | 19 |
| | | <i>Fraxinus excelsior</i> | 15 | <i>Ligustrum vulgare</i> | 15 | <i>Cr. monogyna</i> | 15 |
| <i>Tilia cordata</i> | | 15 | <i>E. europaeus</i> | 12 | <i>Cornus mas</i> | 12 | |
| <i>Ulmus minor</i> | | 15 | <i>Rosa rugosa</i> | 12 | | | |
| TOTALE | | 100 | TOTALE | 54 | TOTALE | 46 | |
| AMBITO URBANO-PERIURBANU | | | | | | | |
| Quercu-carpinetu | <i>Quercus robur</i> | 55 | <i>Berberis vulgaris</i> | 15 | <i>Corylus avellana</i> | 19 | |
| | <i>Tilia cordata</i> | 25 | <i>Ligustrum vulgare</i> | 15 | <i>C. monogyna</i> | 15 | |
| | <i>Fraxinus excelsior</i> | 20 | <i>E. europaeus</i> | 12 | <i>Cornus mas</i> | 12 | |
| | | | <i>Rosa rugosa</i> | 12 | | | |
| TOTALE | 100 | TOTALE | 54 | TOTALE | 46 | | |
| SCHEDA TIPOLOGICA | | | | | | | |
| Dimensione: | | | 90mq (3mX30m) | | | | |
| Quantità e dimensioni d'impianto: | | | 7 alberi (h.175-250cm) | | | | |
| | | | 29 arbusti (h.60-80cm) | | | | |
| TOTALE | | | 36 (7 alberi e 29 arbusti) | | | | |



Quercus robur



Fraxinus excelsior



Tilia cordata



Ulmus minor

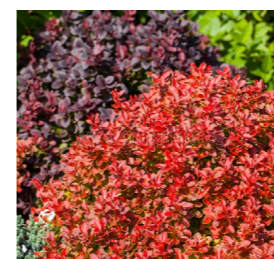

Berberis vulgaris



Ligustrum vulgare



Euonymus europaeus



Rosa rugosa



Corylus avellana



Crataegus monogyna



Cornus mas

Fascia arboreo arbustiva di I grandezza

Alneto di Ontano nero

PAESAGGIO AGRICOLO/PERIURBANO

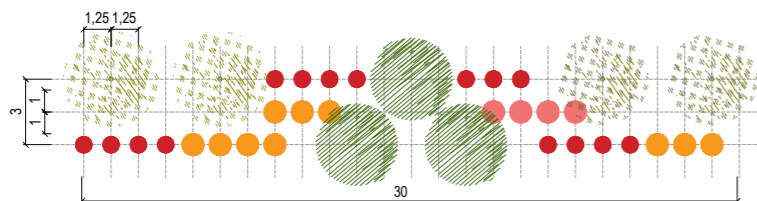

- Fraxinus excelsior
- Populus alba
- Populus nigra
- Cornus sanguinea
- Sambucus nigra
- Crataegus monogyna

| AMBITO NATURALISTICO | | | | | |
|--|------------|-----------------------------------|-----------|----------------|-----------|
| Fraxinus excelsior | 50 | Cornus sanguinea | 40 | Sambucus nigra | 30 |
| Populus alba | 20 | | | C. monogyna | 30 |
| Populus nigra | 20 | | | | |
| Quercus robur | 10 | | | | |
| TOTALE | 100 | TOTALE | 40 | TOTALE | 60 |
| AMBITO AGRICOLO | | | | | |
| Fraxinus excelsior | 50 | Cornus sanguinea | 40 | Sambucus nigra | 20 |
| Populus alba | 25 | | | C. monogyna | 40 |
| Populus nigra | 25 | | | | |
| TOTALE | 100 | TOTALE | 40 | TOTALE | 60 |
| AMBITO URBANO-PERIURBANO | | | | | |
| Fraxinus excelsior | 50 | Cornus sanguinea | 45 | Sambucus nigra | 10 |
| Populus alba | 25 | | | C. monogyna | 45 |
| Populus nigra | 25 | | | | |
| TOTALE | 100 | TOTALE | 45 | TOTALE | 55 |
| SCHEDA TIPOLOGICO | | | | | |
| Dimensione: | | 90mq (3mX30m) | | | |
| Quantità e dimensioni d'impianto: | | 7 alberi (h.175-250cm) | | | |
| | | 29 arbusti (h.60-80cm) | | | |
| TOTALE | | 36 (7 alberi e 29 arbusti) | | | |

PAESAGGIO NATURALISTICO

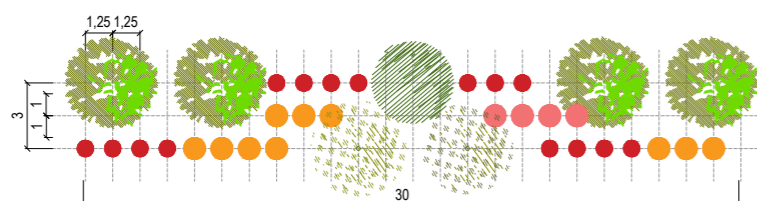

- Quercus robur
- Fraxinus excelsior
- Populus alba
- Populus nigra
- Cornus sanguinea
- Sambucus nigra
- Crataegus monogyna



Quercus robur



Fraxinus excelsior



Populus alba



Populus nigra



Cornus sanguinea

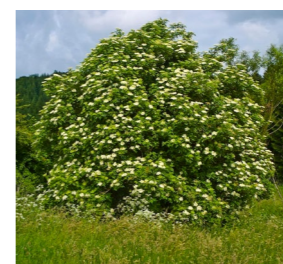

Sambucus nigra



Crataegus monogyna

Fascia arboreo arbustiva di II grandezza





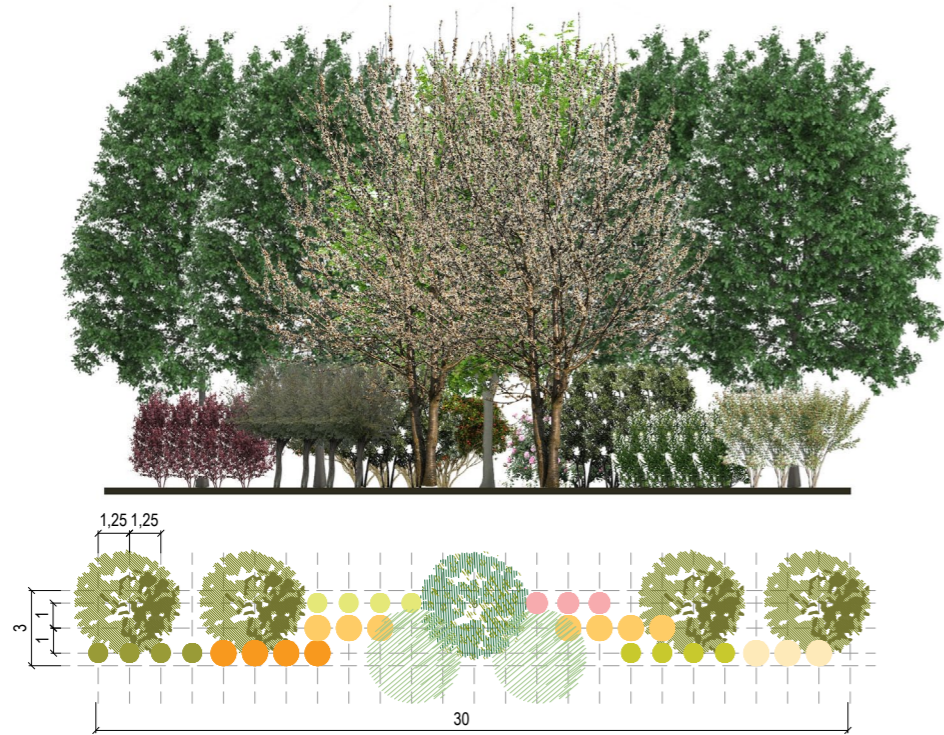



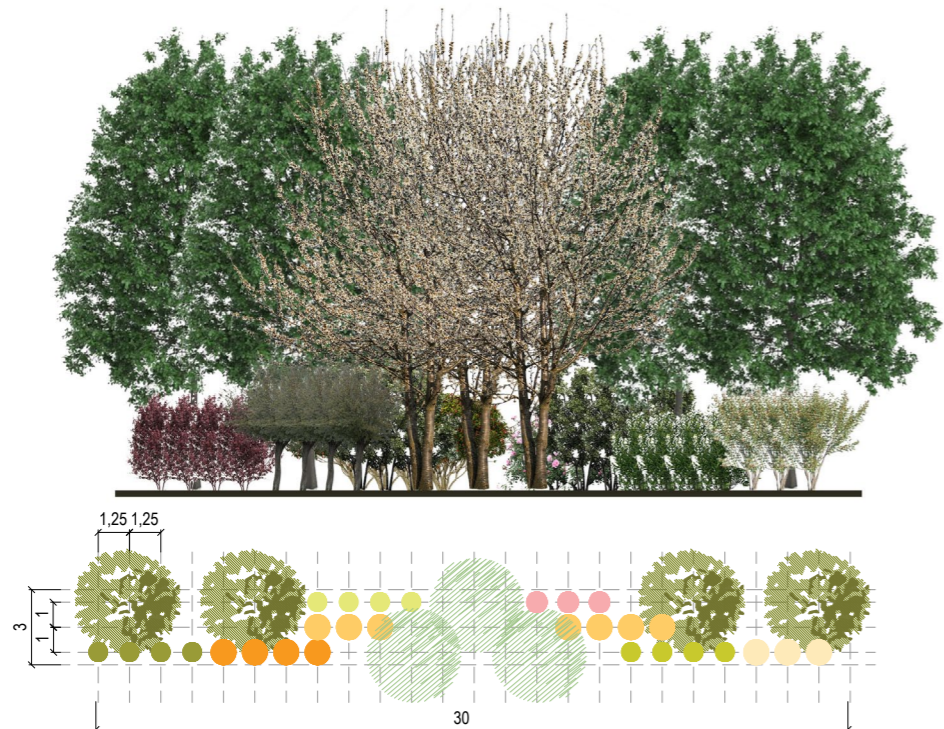

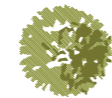
Quercu - carpinetu

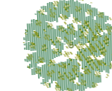
PAESAGGIO AGRICOLU



PAESAGGIU PERIURBANU



-  Carpinus betulus
-  Prunus avium
-  Acer pseudoplatanus
-  Berberis vulgaris
-  Ligustrum vulgare
-  Euonymus europaeus
-  Rosa rugosa
-  Corylus avellana
-  Crataegus monogyna
-  Cornus mas

-  Carpinus betulus
-  Prunus avium
-  Berberis vulgaris
-  Ligustrum vulgare
-  Euonymus europaeus
-  Rosa rugosa
-  Corylus avellana
-  Crataegus monogyna
-  Cornus mas

| CONSOZIAZIONI VEGETALI | Alberi II grandezza | % | Arbusti <3m | % | Arbusti >3m | % |
|---------------------------------|---|------------|--------------------------|------------|-------------------------|------------|
| AMBITO NATURALISTICO | | | | | | |
| | <i>Carpinus betulus</i> | 60 | <i>Berberis vulgaris</i> | 15 | <i>Corylus avellana</i> | 19 |
| | <i>Prunus avium</i> | 17 | <i>Ligustrum vulgare</i> | 15 | <i>C. monogyna</i> | 15 |
| | <i>Acer pseudoplatanus</i> | 13 | <i>E. europaeus</i> | 12 | <i>Cornus mas</i> | 12 |
| | <i>Betula pendula</i> | 10 | <i>Rosa rugosa</i> | 12 | | |
| | TOTALE | 100 | TOTALE | 54 | TOTALE | 46 |
| AMBITO AGRICOLU | | | | | | |
| | <i>Carpinus betulus</i> | 60 | <i>Berberis vulgaris</i> | 15 | <i>Corylus avellana</i> | 19 |
| | <i>Prunus avium</i> | 22 | <i>Ligustrum vulgare</i> | 15 | <i>C. monogyna</i> | 15 |
| | <i>Acer pseudoplatanus</i> | 18 | <i>E. europaeus</i> | 12 | <i>Cornus mas</i> | 12 |
| | | | <i>Rosa rugosa</i> | 12 | | |
| | TOTALE | 100 | TOTALE | 54 | TOTALE | 46 |
| AMBITO URBANO-PERIURBANU | | | | | | |
| | <i>Carpinus betulus</i> | 60 | <i>Berberis vulgaris</i> | 28 | <i>Corylus avellana</i> | 50 |
| | <i>Prunus avium</i> | 40 | <i>Ligustrum vulgare</i> | 28 | <i>C. monogyna</i> | 28 |
| | | | <i>E. europaeus</i> | 22 | <i>Cornus mas</i> | 22 |
| | | | <i>Rosa rugosa</i> | 22 | | |
| | TOTALE | 100 | TOTALE | 100 | TOTALE | 100 |
| SCHEDA TIPOLOGICO | Dimensione: 90mq (3mX30m) | | | | | |
| | Quantità e dimensioni d'impianto: 7 alberi (h.175-250cm) | | | | | |
| | 29 arbusti (h.60-80cm) | | | | | |
| | TOTALE 36 (7 alberi e 29 arbusti) | | | | | |





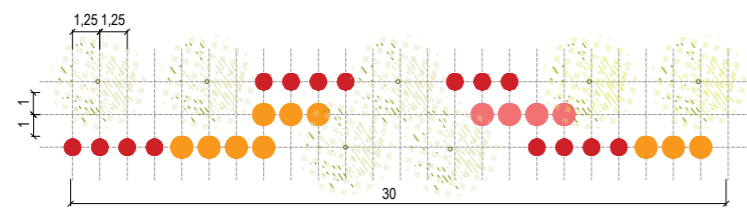

Fascia arboreo arbustiva di II grandezza

Alneto di Ontano nero

PAESAGGIO AGRICOLO/PERIURBANO/NATURALISTICO



-  *Alnus glutinosa*
-  *Salix alba*
-  *Cornus sanguinea*
-  *Sambucus nigra*
-  *Crataegus monogyna*

| | AMBITO NATURALISTICO | | | | | |
|-------------------|---|---------------|-------------------------|--------------------|-----------------------|----|
| | <i>Alnus glutinosa</i> | 70 | <i>Cornus sanguinea</i> | 40 | <i>Sambucus nigra</i> | 30 |
| <i>Salix alba</i> | 30 | | | <i>C. monogyna</i> | 30 | |
| TOTALE | 100 | TOTALE | 40 | TOTALE | 60 | |
| | AMBITO AGRICOLO | | | | | |
| | <i>Alnus glutinosa</i> | 70 | <i>Cornus sanguinea</i> | 40 | <i>Sambucus nigra</i> | 20 |
| <i>Salix alba</i> | 30 | | | <i>C. monogyna</i> | 40 | |
| TOTALE | 100 | TOTALE | 40 | TOTALE | 60 | |
| | AMBITO URBANO-PERIURBANO | | | | | |
| | <i>Alnus glutinosa</i> | 70 | <i>Cornus sanguinea</i> | 45 | <i>Sambucus nigra</i> | 10 |
| <i>Salix alba</i> | 30 | | | <i>C. monogyna</i> | 45 | |
| TOTALE | 100 | TOTALE | 45 | TOTALE | 55 | |
| SCHEDA TIPOLOGICO | Dimensione: 90mq (3mX30m) | | | | | |
| | Quantità e dimensioni d'impianto: 7 alberi (h.175-250cm) | | | | | |
| | 29 arbusti (h.60-80cm) | | | | | |
| TOTALE | 36 (7 alberi e 29 arbusti) | | | | | |



Alnus glutinosa



Salix alba



Cornus sanguinea



Sambucus nigra



Crataegus monogyna

Fascia arboreo arbustiva di III grandezza

Quercu - carpineto

PAESAGGIO AGRICOLO/PERIURBANO

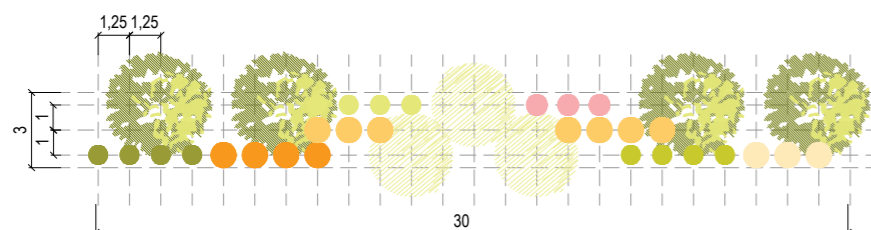

-  Acer campestre
-  Malus sylvatica
-  Berberis vulgaris
-  Ligustrum vulgare
-  Euonymus europaeus
-  Rosa rugosa
-  Corylus avellana
-  Crataegus monogyna
-  Cornus mas

| CONSOCIAZIONI VEGETALI | Alberi III grandezza | % | Arbusti <3m | % | Arbusti >3m | % |
|---------------------------------|--|--------------------------|--|-------------------------|-------------------------|-----------|
| Quercu-carpineto | AMBITO NATURALISTICO | | | | | |
| | <i>Acer campestre</i> | 60 | <i>Berberis vulgaris</i> | 15 | <i>Corylus avellana</i> | 19 |
| | <i>Malus sylvatica</i> | 40 | <i>Ligustrum vulgare</i> | 15 | <i>C. monogyna</i> | 15 |
| | | | <i>Rosa rugosa</i> | 12 | <i>Cornus mas</i> | 12 |
| | | | <i>E. europaeus</i> | 12 | | |
| | TOTALE | 100 | TOTALE | 54 | TOTALE | 46 |
| | AMBITO AGRICOLO | | | | | |
| | <i>Acer campestre</i> | 60 | <i>Berberis vulgaris</i> | 15 | <i>Corylus avellana</i> | 19 |
| | <i>Malus sylvatica</i> | 40 | <i>Ligustrum vulgare</i> | 15 | <i>C. monogyna</i> | 15 |
| | | | <i>Rosa rugosa</i> | 12 | <i>Cornus mas</i> | 12 |
| | | | <i>E. europaeus</i> | 12 | | |
| | TOTALE | 100 | TOTALE | 54 | TOTALE | 46 |
| AMBITO URBANO-PERIURBANO | | | | | | |
| <i>Acer campestre</i> | 60 | <i>Berberis vulgaris</i> | 15 | <i>Corylus avellana</i> | 19 | |
| <i>Malus sylvatica</i> | 40 | <i>Ligustrum vulgare</i> | 15 | <i>C. monogyna</i> | 15 | |
| | | <i>Rosa rugosa</i> | 12 | <i>Cornus mas</i> | 12 | |
| | | <i>E. europaeus</i> | 12 | | | |
| TOTALE | 100 | TOTALE | 54 | TOTALE | 46 | |
| SCHEDA TIPOLOGICO | Dimensione: | | 90mq (3mX30m) | | | |
| | Quantità e dimensioni d'impianto: | | 7 alberi (h.175-250cm) 29 arbusti (h.60-80cm) | | | |
| | TOTALE | | 36 (7 alberi e 29 arbusti) | | | |

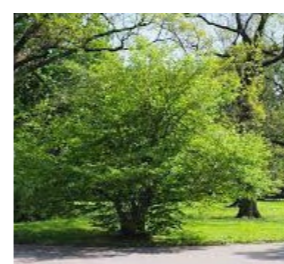

Corylus avellana



Acer campestre

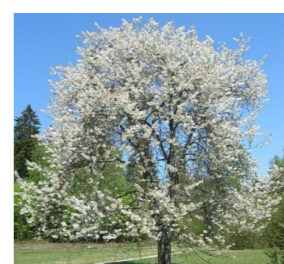

Malus sylvatica

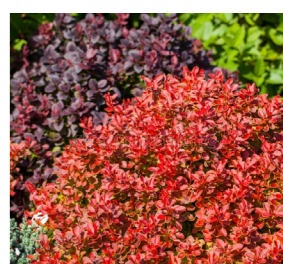

Berberis vulgaris



Crataegus monogyna



Ligustrum vulgare



Euonymus europaeus



Rosa rugosa



Cornus mas

Fascia arboreo arbustiva di III grandezza

Alneto di Ontano nero

PAESAGGIO AGRICOLO/PERIURBANO/NATURALISTICO

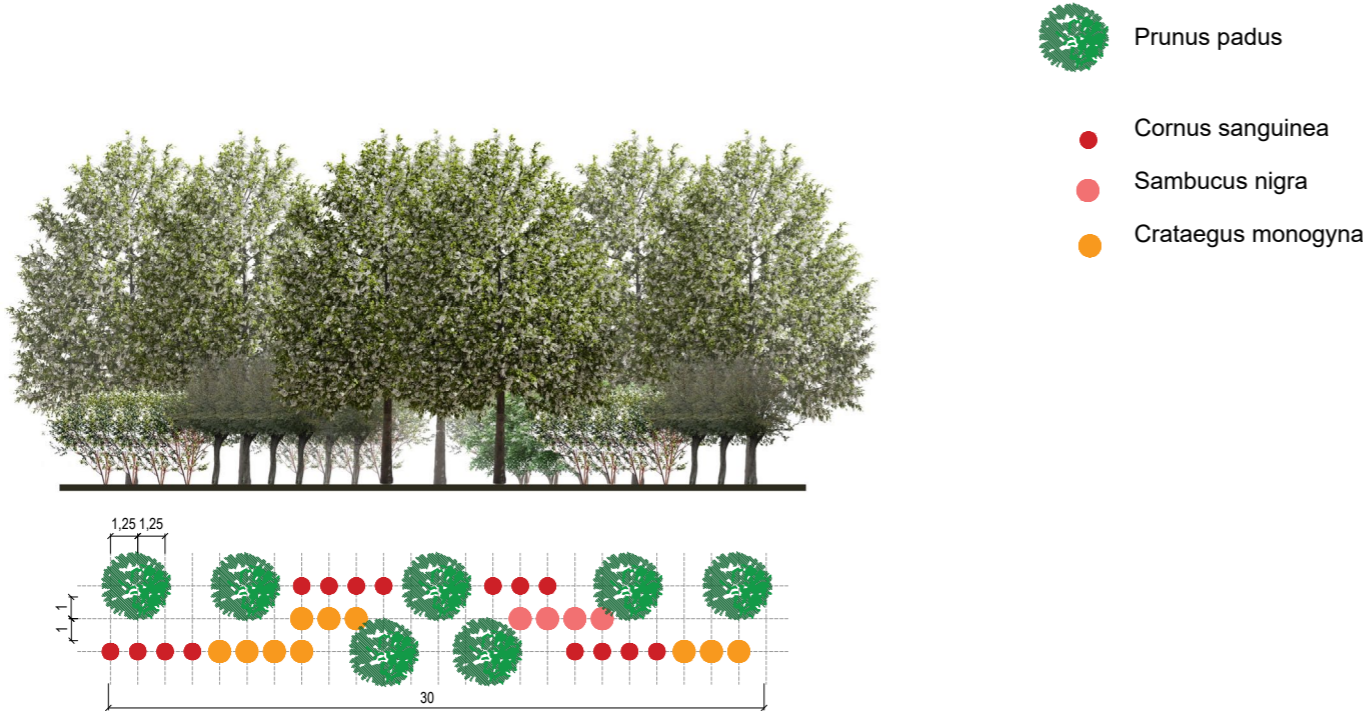

| | AMBITO NATURALISTICO | | | | | |
|-------------------|--|---------------|-----------------------------------|---------------|----------------|----|
| | Prunus padus | 100 | Cornus sanguinea | 40 | Sambucus nigra | 30 |
| | | | | C. monogyna | 30 | |
| TOTALE | 100 | TOTALE | 40 | TOTALE | 60 | |
| | AMBITO AGRICOLO | | | | | |
| | Prunus padus | 100 | Cornus sanguinea | 40 | Sambucus nigra | 20 |
| | | | | C. monogyna | 40 | |
| TOTALE | 100 | TOTALE | 40 | TOTALE | 60 | |
| | AMBITO URBANO-PERIURBANO | | | | | |
| | Prunus padus | 100 | Cornus sanguinea | 45 | Sambucus nigra | 10 |
| | | | | C. monogyna | 45 | |
| TOTALE | 100 | TOTALE | 45 | TOTALE | 55 | |
| SCHEDA TIPOLOGICO | Dimensione: | | 90mq (3mX30m) | | | |
| | Quantità e dimensioni d'impianto: | | 7 alberi (h.175-250cm) | | | |
| | TOTALE | | 36 (7 alberi e 29 arbusti) | | | |



Cornus sanguinea



Prunus padus



Crataegus monogyna



Sambucus nigra

Fascia arbustiva di arbusti h<3m

Quercu - carpineto

ARBUSTI H<3m

- Berberis vulgaris
- Ligustrum vulgare
- Euonymus europaeus
- Rosa rugosa

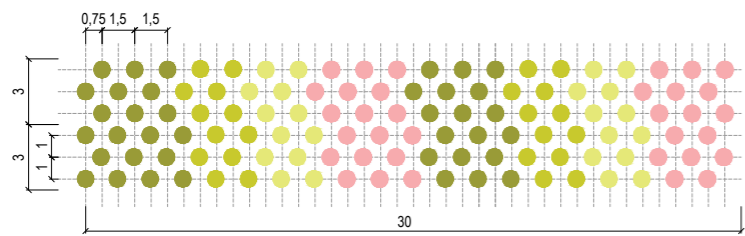
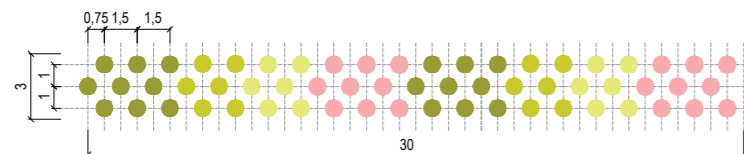

Alneto di Ontano nero

ARBUSTI H<3m

- Cornus sanguinea

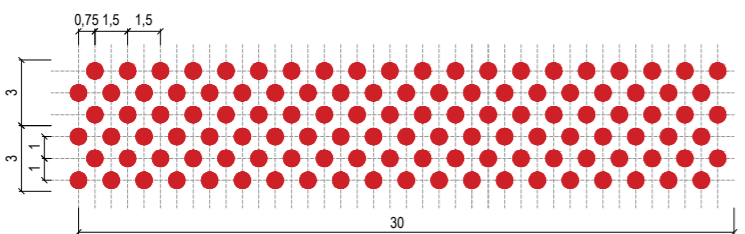
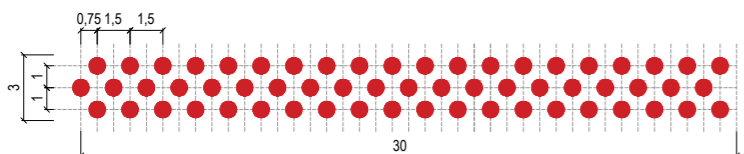

| CONSOCIAZIONI VEGETALI | AMBITO | | | | | |
|------------------------|-----------------------------------|------------|--------------------------|------------|--------------------------|------------------------|
| | Naturalistico | | Agricolo | | Urbano-periurbano | |
| | | % | | % | | % |
| Quercu-carpineto | <i>Berberis vulgaris</i> | 28 | <i>Berberis vulgaris</i> | 28 | <i>Berberis vulgaris</i> | 28 |
| | <i>Ligustrum vulgare</i> | 22 | <i>Ligustrum vulgare</i> | 22 | <i>Ligustrum vulgare</i> | 22 |
| | <i>E. europaeus</i> | 22 | <i>E. europaeus</i> | 22 | <i>E. europaeus</i> | 22 |
| | <i>Rosa rugosa</i> | 28 | <i>Rosa canina</i> | 28 | <i>Rosa rugosa</i> | 28 |
| | TOTALE | 100 | TOTALE | 100 | TOTALE | 100 |
| Alneto di ontano nero | <i>Cornus sanguinea</i> | 100 | <i>Cornus sanguinea</i> | 100 | <i>Cornus sanguinea</i> | 100 |
| | TOTALE | 100 | TOTALE | 100 | TOTALE | 100 |
| SCHEDE TIPOLOGICO | Dimensione: | | | | | 90mq (3mX30m) |
| | Quantità e dimensioni d'impianto: | | | | | 60 arbusti (h.60-80cm) |
| | TOTALE | | | | | 60 |



Barberis vulgaris



Ligustrum vulgare



Euonymus europaeus



Rosa rugosa



Cornus sanguinea

Fascia arbustiva di arbusti h>3m

Quercu - carpineto

ARBUSTI H>3m

- Corylus avellana
- Crataegus monogyna
- Cornus mas

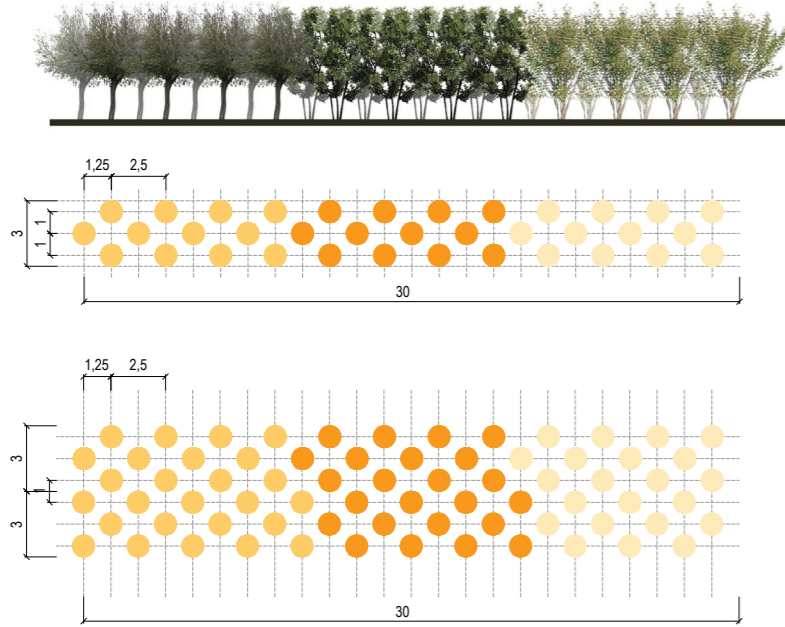

| CONSOCIAZIONI VEGETALI | AMBITO | | | | | |
|------------------------|--|------------|-------------------------|------------|-------------------------|-------------------------------|
| | Naturalistico | | Agricolo | | Urbano-periurbano | |
| | | % | | % | | % |
| Quercu-carpineto | <i>Corylus avellana</i> | 40 | <i>Corylus avellana</i> | 40 | <i>Corylus avellana</i> | 40 |
| | <i>C. monogyna</i> | 30 | <i>C. monogyna</i> | 30 | <i>C. monogyna</i> | 30 |
| | <i>Cornus mas</i> | 30 | <i>Cornus mas</i> | 30 | <i>Cornus mas</i> | 30 |
| | TOTALE | 100 | TOTALE | 100 | TOTALE | 100 |
| Alneto di ontano nero | <i>Sambucus nigra</i> | 40 | <i>Sambucus nigra</i> | 40 | <i>Sambucus nigra</i> | 40 |
| | <i>C. monogyna</i> | 60 | <i>C. monogyna</i> | 60 | <i>C. monogyna</i> | 60 |
| | TOTALE | 100 | TOTALE | 100 | TOTALE | 100 |
| SCHEDA TIPOLOGICO | Dimensione: | | | | | 90mq (3mX30m) |
| | Quantità e dimensioni d'impianto: | | | | | 36 arbusti (h.60-80cm) |
| | TOTALE | | | | | 36 |

Alneto di Ontano nero

ARBUSTI H>3m

- Sambucus nigra
- Crataegus monogyna

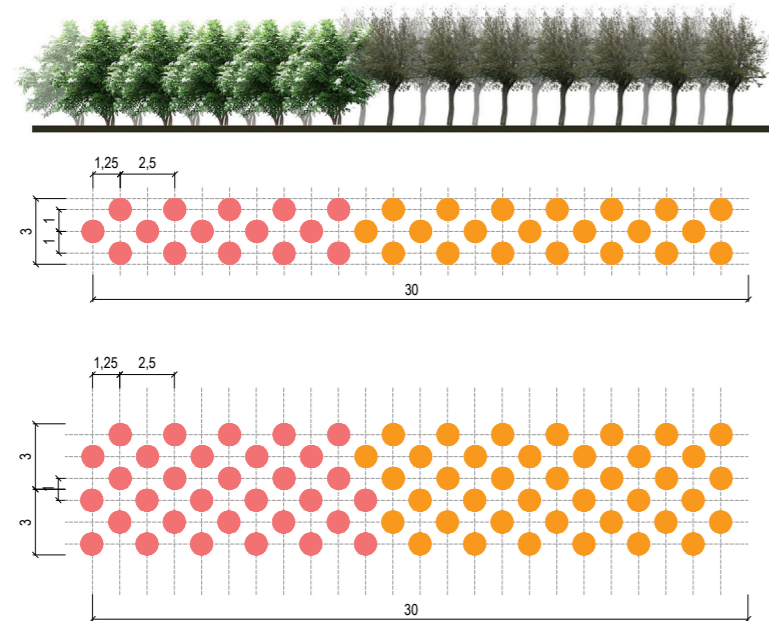

Corylus avellana



Crataegus monogyna



Cornus mas



Cornus sanguinea



Sambucus nigra



Crataegus monogyna

Fascia arbustiva mista

Quercio - carpineto

ARBUSTI MISTI

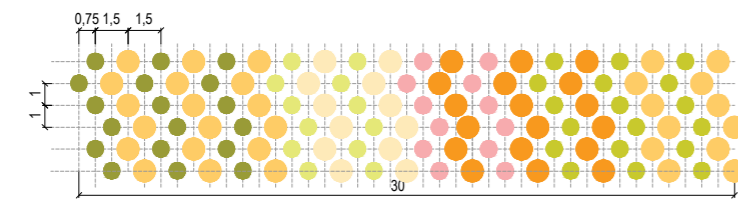
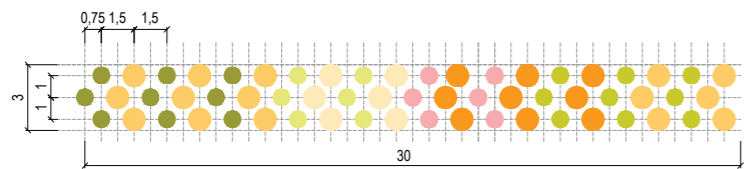

- Berberis vulgaris
- Ligustrum vulgare
- Euonymus europaeus
- Rosa canina
- Corylus avellana
- Crataegus monogyna
- Cornus mas

Alneto di Ontano nero

ARBUSTI MISTI

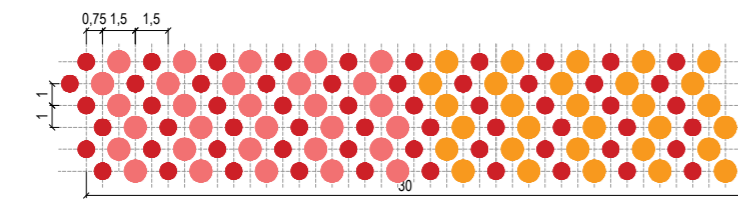
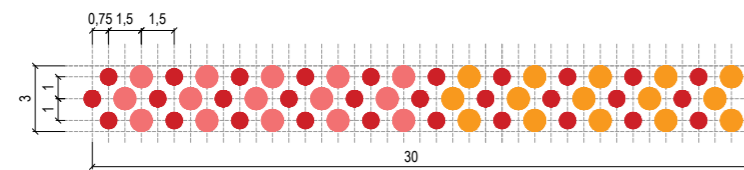

- Cornus sanguinea
- Sambucus nigra
- Crataegus monogyna

| CONSOCIAZIONI VEGETALI | AMBITO | | | | | |
|---------------------------|--|-------------------------|---------------------------|-------------------------|---------------------------|-------------------------------|
| | Naturalistico | % | Agricolo | % | Urbano-periurbano | % |
| Quercio-carpineto | <i>Berberis vulgaris</i> | 28 | <i>Berberis vulgaris</i> | 28 | <i>Berberis vulgaris</i> | 28 |
| | <i>Ligustrum vulgare</i> | 22 | <i>Ligustrum vulgare</i> | 22 | <i>Ligustrum vulgare</i> | 22 |
| | <i>E. europaeus</i> | 22 | <i>E. europaeus</i> | 22 | <i>E. europaeus</i> | 22 |
| | <i>Rosa rugosa</i> | 28 | <i>Rosa rugosa</i> | 28 | <i>Rosa rugosa</i> | 28 |
| | <i>Corylus avellana</i> | 19 | <i>Corylus avellana</i> | 19 | <i>Corylus avellana</i> | 19 |
| | <i>Crataegus monogyna</i> | 15 | <i>Crataegus monogyna</i> | 15 | <i>Crataegus monogyna</i> | 15 |
| | <i>Cornus mas</i> | 12 | <i>Cornus mas</i> | 12 | <i>Cornus mas</i> | 12 |
| | TOTALE | 100 | TOTALE | 100 | TOTALE | 100 |
| | Alneto di ontano nero | <i>Cornus sanguinea</i> | 40 | <i>Cornus sanguinea</i> | 40 | <i>Cornus sanguinea</i> |
| <i>Sambucus nigra</i> | | 30 | <i>Sambucus nigra</i> | 30 | <i>Sambucus nigra</i> | 30 |
| <i>Crataegus monogyna</i> | | 30 | <i>Crataegus monogyna</i> | 30 | <i>Crataegus monogyna</i> | 30 |
| TOTALE | | 100 | TOTALE | 100 | TOTALE | 100 |
| SCHEDA TIPOLOGICO | Dimensione: | | | | | 90mq (3mX30m) |
| | Quantità e dimensioni d'impianto: | | | | | 60 arbusti (h.60-80cm) |
| | TOTALE | | | | | 60 |

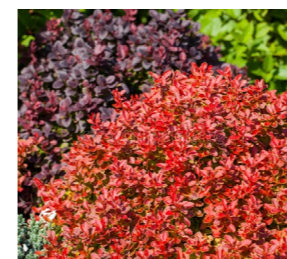

Berberis vulgaris



Ligustrum vulgare



Euonymus europaeus



Rosa rugosa



Corylus avellana



Crataegus monogyna

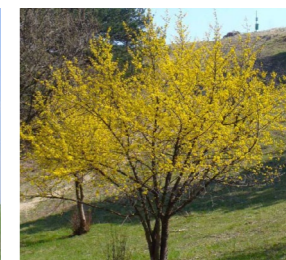

Cornus mas



Cornus sanguinea

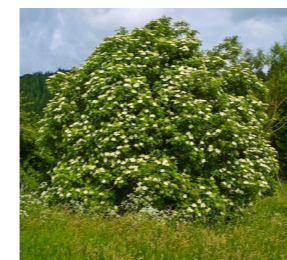

Sambucus nigra



Crataegus monogyna

Fascia arbustiva ornamentale

Quercio - carpineto

ARBUSTI MISTI

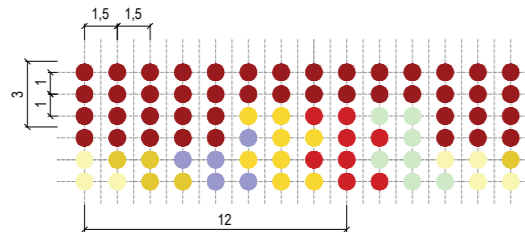
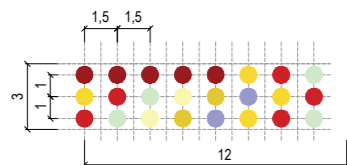

- Spartium junceum
- Cornus sanguinea
- Eleagnus x ebbingei
- Spirea x vanhouttei
- Forsitia x intermedia
- Viburnum opulus
- Cotynus coggira

| CONSOCIAZIONI VEGETALI | Dimensioni | |
|------------------------|--|------------------------------------|
| | Arbusti <2m | Arbusti >2m |
| Fascia ornamentale | <i>Spartium junceum</i> | <i>Cotinus coggira</i> |
| | <i>Cornus sanguinea</i> | |
| | <i>Eleagnus x ebbingei</i> | |
| | <i>Spirea x vanhouttei</i> | |
| | <i>Forsythia x intermedia</i> | |
| | <i>Viburnum opulus</i> | |
| SCHEDA TIPOLOGICO | Dimensione: | 36mq (12mX3m) |
| | Quantità e dimensioni d'impianto: | 24 arbusti (vaso diam 15cm) |
| | TOTALE | 24 |



Spartium junceum



Cornus sanguinea



Eleagnus x ebbingei



Spirea x vanhouttei



Cotinus coggira



Forsitia x intermedia



Viburnum opulus

Alneto di Ontano nero

ARBUSTI MISTI

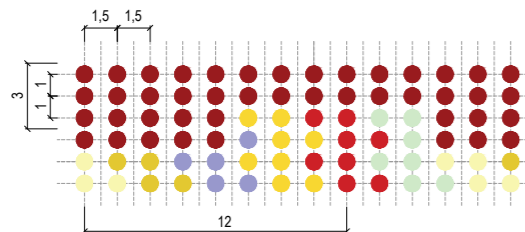
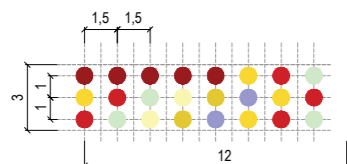





- Spartium junceum
- Cornus sanguinea
- Eleagnus x ebbingei
- Spirea x vanhouttei
- Forsitia x intermedia
- Viburnum opulus
- Cotynus coggira

Macchia arboreo arbustivo di interesse faunistico

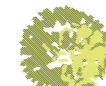
Quercu - carpinetu





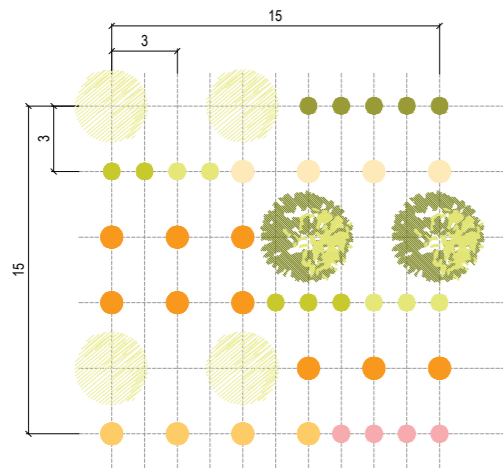

-  *Acer campestre*
-  *Malus sylvatica*
-  *Berberis vulgaris*
-  *Ligustrum vulgare*
-  *Euonymus europaeus*
-  *Rosa rugosa*
-  *Corylus avellana*
-  *Crataegus monogyna*
-  *Cornus mas*



| CONSOCIAZIONI VEGETALI | Alberi III grandezza | % | Arbusti <3m | % | Arbusti <3m | % |
|--------------------------|--|---------------|-----------------------------------|---------------|---------------------------|-----------|
| Quercu-carpinetu | <i>Acer campestre</i> | 40 | <i>Berberis vulgaris</i> | 15 | <i>Corylus avellana</i> | 10 |
| | <i>Malus sylvatica</i> | 60 | <i>Ligustrum vulgare</i> | 15 | <i>Crataegus monogyna</i> | 20 |
| | | | <i>E. europaeus</i> | 15 | <i>Cornus mas</i> | 10 |
| | | | <i>Rosa rugosa</i> | 15 | | |
| TOTALE | 100 | TOTALE | 60 | TOTALE | 40 | |
| Alneto di ontano nero | <i>Prunus padus</i> | 100 | <i>Cornus sanguinea</i> | 40 | <i>Sambucus nigra</i> | 25 |
| | | | | | <i>C. monogyna</i> | 35 |
| | TOTALE | 100 | TOTALE | 40 | TOTALE | 60 |
| SCHEDA TIPOLOGICO | Dimensione: | | 225mq (15mX15m) | | | |
| | Quantità e dimensioni d'impianto: | | 6 alberi (h.150-175cm) | | | |
| | TOTALE | | 40 (6 alberi e 34 arbusti) | | | |

Alneto di Ontano nero



-  *Prunus padus*
-  *Cornus sanguinea*
-  *Sambucus nigra*
-  *Crataegus monogyna*

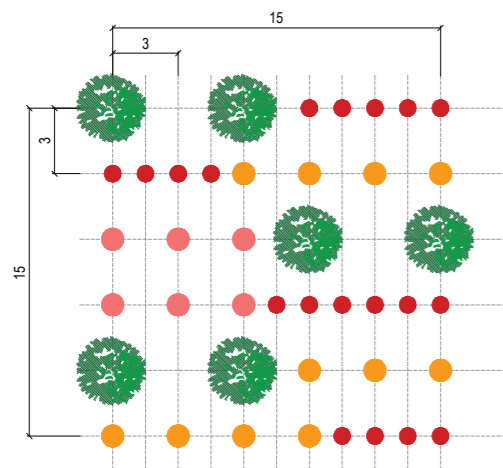

Acer campestre



Malus sylvatica



Prunus padus

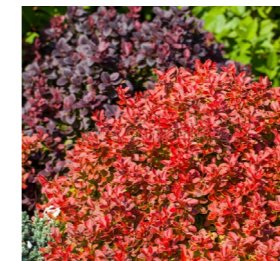

Berberis vulgaris



Ligustrum vulgare



Euonymus europaeus

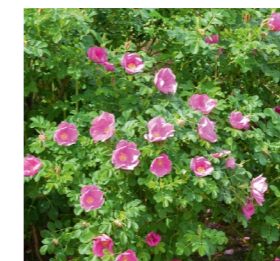

Rosa rugosa



Corylus avellana



Crataegus monogyna



Crataegus monogyna



Cornus mas



Cornus sanguinea









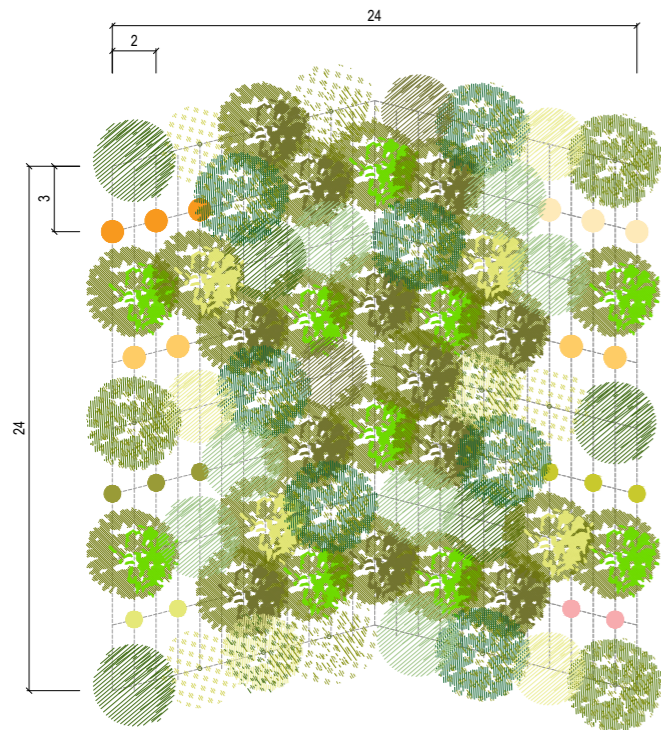

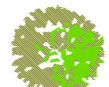

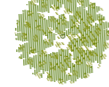
Sambucus nigra

Bosco

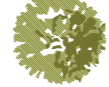
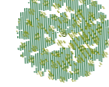
Quercio - carpinetto

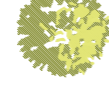

-  *Quercus robur*
-  *Fraxinus excelsior*
-  *Tilia cordata*
-  *Platanus x hybrida*
-  *Quercus petrea*
-  *Ulmus minor*
-  *Carpinus betulus*
-  *Acer pseudoplatanus*
-  *Prunus avium*
-  *Betula pendula*
-  *Acer campestre*
-  *Malus sylvatica*
- Berberis vulgaris*
- Ligustrum vulgare*
- Euonymus europaeus*
- Rosa canina*
- Corylus avellana*
- Crataegus monogyna*
- Cornus mas*



Quercus robur



Fraxinus excelsior



Tilia cordata



Ulmus minor



Platanus x hybrida



Quercus petrea

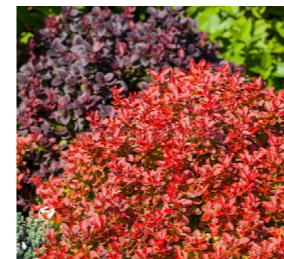

Berberis vulgaris



Ligustrum vulgare



Euonymus europaeus



Ulmus minor



Carpinus betulus



Corylus avellana



Crataegus monogyna



Cornus mas



Prunus avium



Acer pseudoplatanus



Rosa canina



Betula pendula



Acer campestre



Malus sylvatica

Bosco

Alneto di Ontano nero



-  Quercus robur
-  Fraxinus excelsior
-  Populus alba
-  Populus nigra
-  Alnus glutinosa
-  Salix alba
-  Prunus pad
-  Cornus sanguinea
-  Sambucus nigra
-  Crataegus monogyna

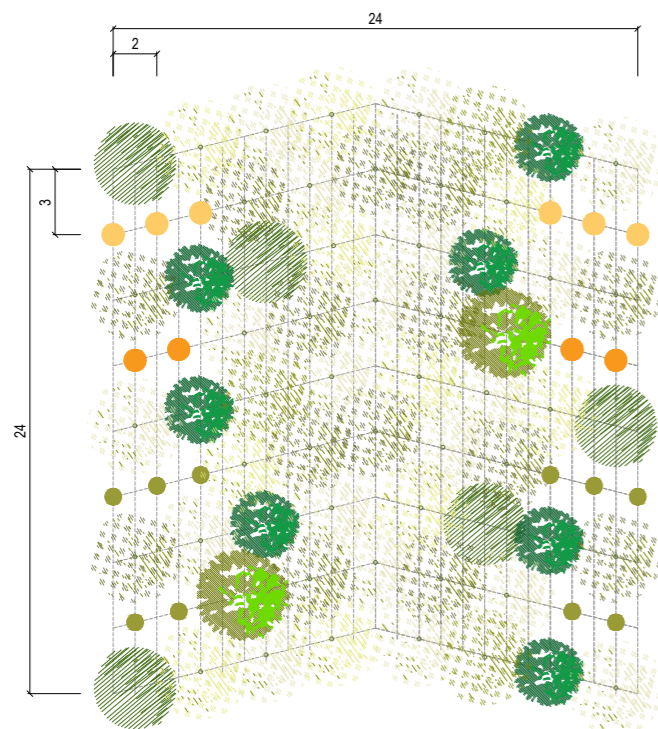

Fraxinus excelsior

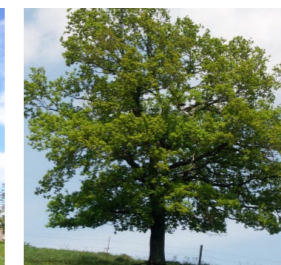

Quercus robur



Prunus padus



Populus alba



Populus nigra



Salix alba



Alnus glutinosa



Cornus sanguinea



Sambucus nigra



Crataegus monogyna

Prato arborato

Quercu - carpineto

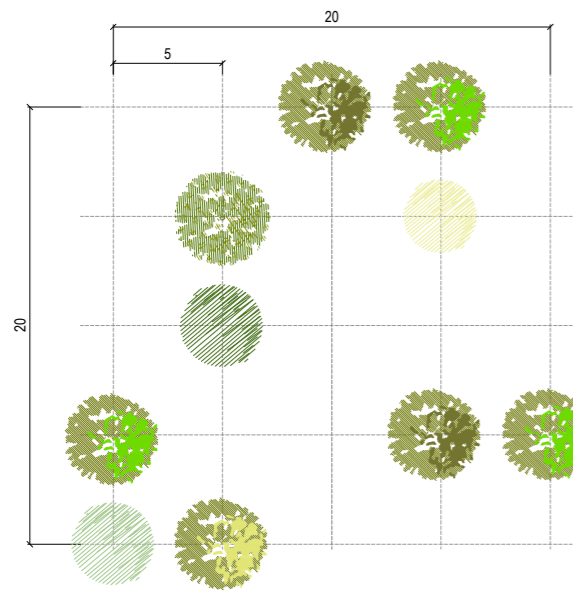

- Quercus robur
- Fraxinus excelsior
- Tilia cordata
- Carpinus betulus
- Prunus avium
- Acer campestre
- Malus sylvatica

Alneto di Ontano nero

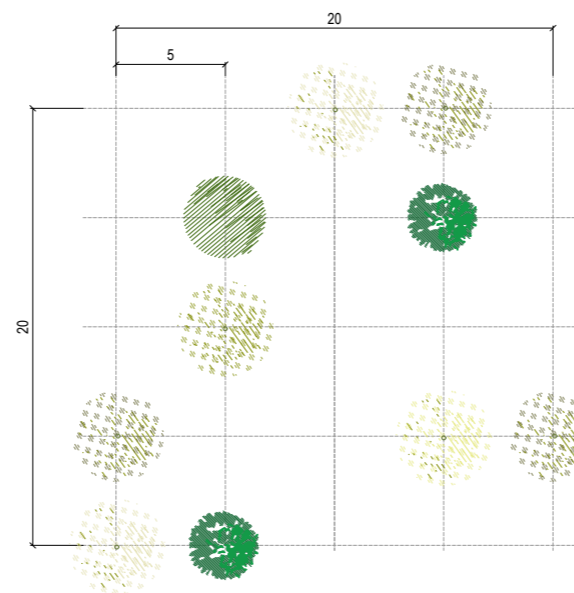

- Fraxinus excelsior
- Populus alba
- Populus nigra
- Alnus glutinosa
- Salix alba
- Prunus padus

| CONSOZIAZIONI VEGETALI | AMBITO | | | | | |
|------------------------|--|------------|--|---------------|---------------------------|---------------|
| | Naturalistico | | Agricolo | | Urb.-periurbano | |
| | | % | | % | | % |
| Quercu-carpineto | <i>Quercus robur</i> | 20 | <i>Quercus robur</i> | 20 | <i>Quercus robur</i> | 20 |
| | <i>Fraxinus excelsior</i> | 3 | <i>Fraxinus excelsior</i> | 3 | <i>Fraxinus excelsior</i> | 3 |
| | <i>Tilia cordata</i> | 3 | <i>Tilia cordata</i> | 3 | <i>Tilia cordata</i> | 3 |
| | <i>Carpinus betulus</i> | 15 | <i>Carpinus betulus</i> | 15 | <i>Carpinus betulus</i> | 15 |
| | <i>Prunus avium</i> | 4 | <i>Prunus avium</i> | 4 | <i>Prunus avium</i> | 4 |
| | <i>Acer campestre</i> | 4 | <i>Acer campestre</i> | 4 | <i>Acer campestre</i> | 4 |
| | <i>Malus sylvatica</i> | 2 | <i>Malus sylvatica</i> | 2 | <i>Malus sylvatica</i> | 2 |
| | TOTALE | 100 | | TOTALE | 100 | TOTALE |
| Alneto di ontano nero | <i>Alnus glutinosa</i> | 30 | <i>Alnus glutinosa</i> | 30 | <i>Alnus glutinosa</i> | 30 |
| | <i>Fraxinus excelsior</i> | 5 | <i>Fraxinus excelsior</i> | 5 | <i>Fraxinus excelsior</i> | 5 |
| | <i>Populus alba</i> | 10 | <i>Populus alba</i> | 10 | <i>Populus alba</i> | 10 |
| | <i>Populus nigra</i> | 3 | <i>Populus nigra</i> | 3 | <i>Populus nigra</i> | 3 |
| | <i>Salix alba</i> | 8 | <i>Salix alba</i> | 8 | <i>Salix alba</i> | 8 |
| | <i>Prunus padus</i> | 2 | <i>Prunus padus</i> | 2 | <i>Prunus padus</i> | 2 |
| | TOTALE | 100 | | TOTALE | 100 | TOTALE |
| SCHEDA TIPOLOGICO | Dimensione: | | lunghezza 30m, larghezza 5m | | | |
| | Quantità e dimensioni d'impianto: | | 10 alberi (h.175-250cm per alberi forestali; 10-12cm per alberi ornamentali) | | | |
| | TOTALE | | 10 | | | |

Specie igrofile mix erbaceo

Zone umide

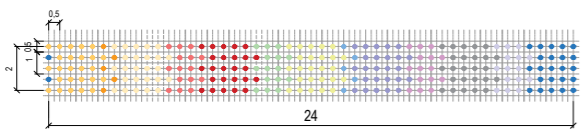

ERBACEE IGROFILE

- *Carex acutiformis*
- *Carex elata*
- *Carex vesicaria*
- *Molina caerulea*
- *Phalaris arundinacea*
- *Iris pseudocorus*
- *Juncus effusus*
- *Carex vesicaria*
- *Lithrum salicaria*
- *Phragmites australis*
- *Sagittaria sagittifolia*
- *Typha angustifolia*
- *Typha latifolia*

| Graminacee igrofile | | Altre specie igrofile | |
|-----------------------------|--|--|-------|
| Specie | pt/mq | Specie | pt/mq |
| <i>Carex acutiformis</i> | 5 | <i>Iris pseudocorus</i> | 3 |
| <i>Carex elata</i> | 5 | <i>Juncus effusus</i> | 5 |
| <i>Carex vesicaria</i> | 5 | <i>Lythrum salicaria</i> | 5 |
| <i>Molinia caerulea</i> | 3 | <i>Phragmites australis</i> | 1 |
| <i>Phalaris arundinacea</i> | 1 | <i>Sagittaria sagittifolia</i> | 5 |
| | | <i>Typha angustifolia</i> | 3 |
| | | <i>Typha latifolia</i> | 3 |
| SCHEDA TIPOLOGICO | Dimensione: | - | |
| | Quantità e dimensioni d'impianto: | vaso 15cm (graminacee igrofile) vaso 9-12cm (altre specie igrofile) | |
| | TOTALE | - | |

Rampicanti

Querco - carpineto

Alneto di Ontano nero

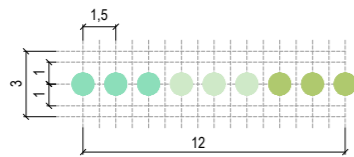

- Hedera helix
- Parthenocissus quinquefolia
- Parthenocissus trifoliatus

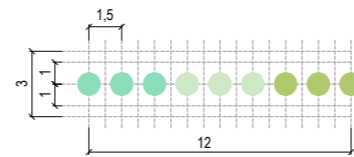

- Hedera helix
- Parthenocissus quinquefolia
- Parthenocissus trifoliatus

| <i>Hedera helix</i> | |
|------------------------------------|---|
| <i>Parthenocissus quinquefolia</i> | |
| <i>Parthenocissus trifoliatus</i> | |
| SCHEDA TIPOLOGICO | Dimensione: 12m |
| | Quantità e dimensioni d'impianto: 8 rampicanti (vaso 12cm) |
| TOTALE | 8 |



Hedera elix



Parthenocissus quinquefolia