

1 Stralcio planimetrico WBS 38
1 : 5000

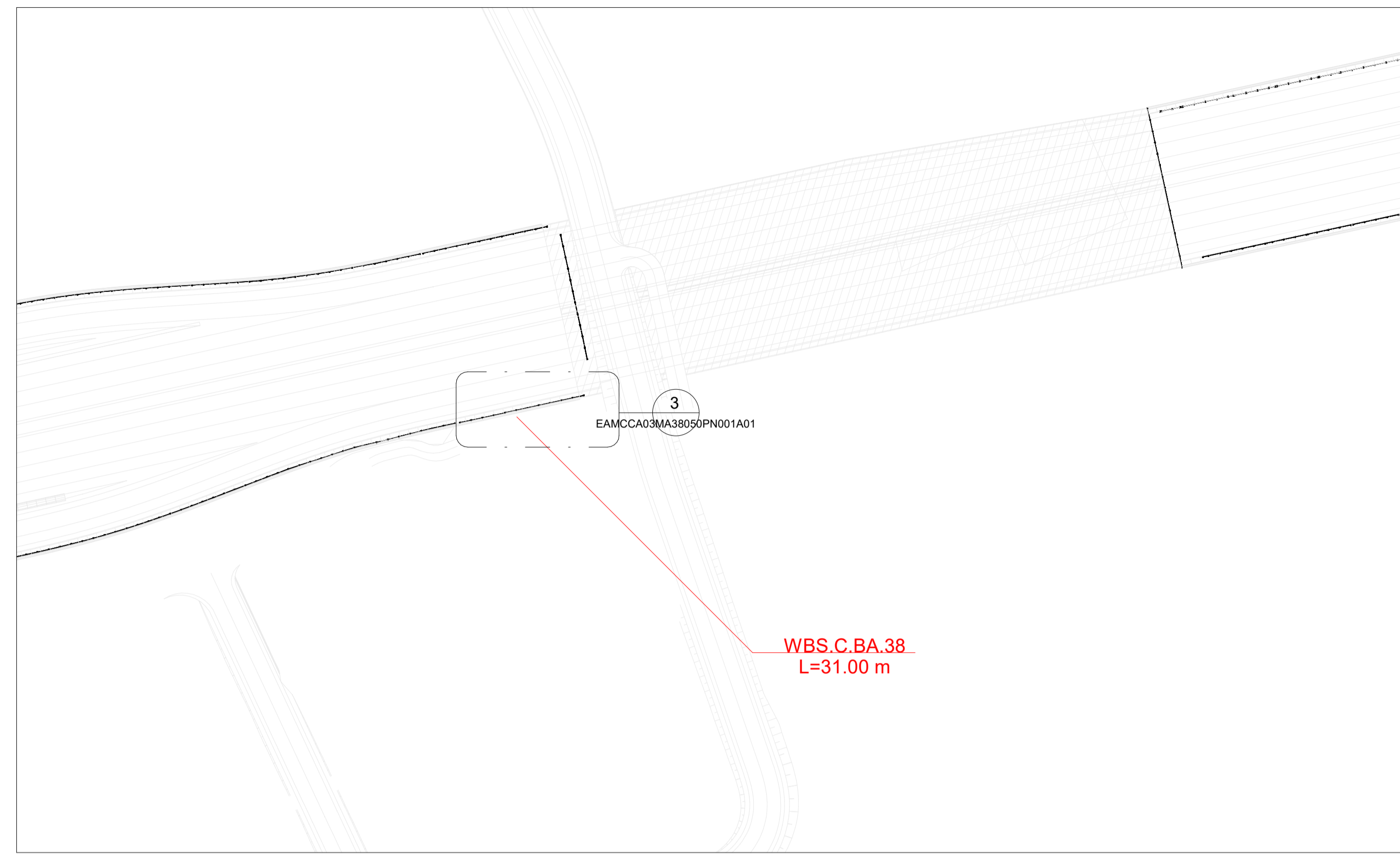

2 Stralcio planimetrico WBS 38
1 : 1000

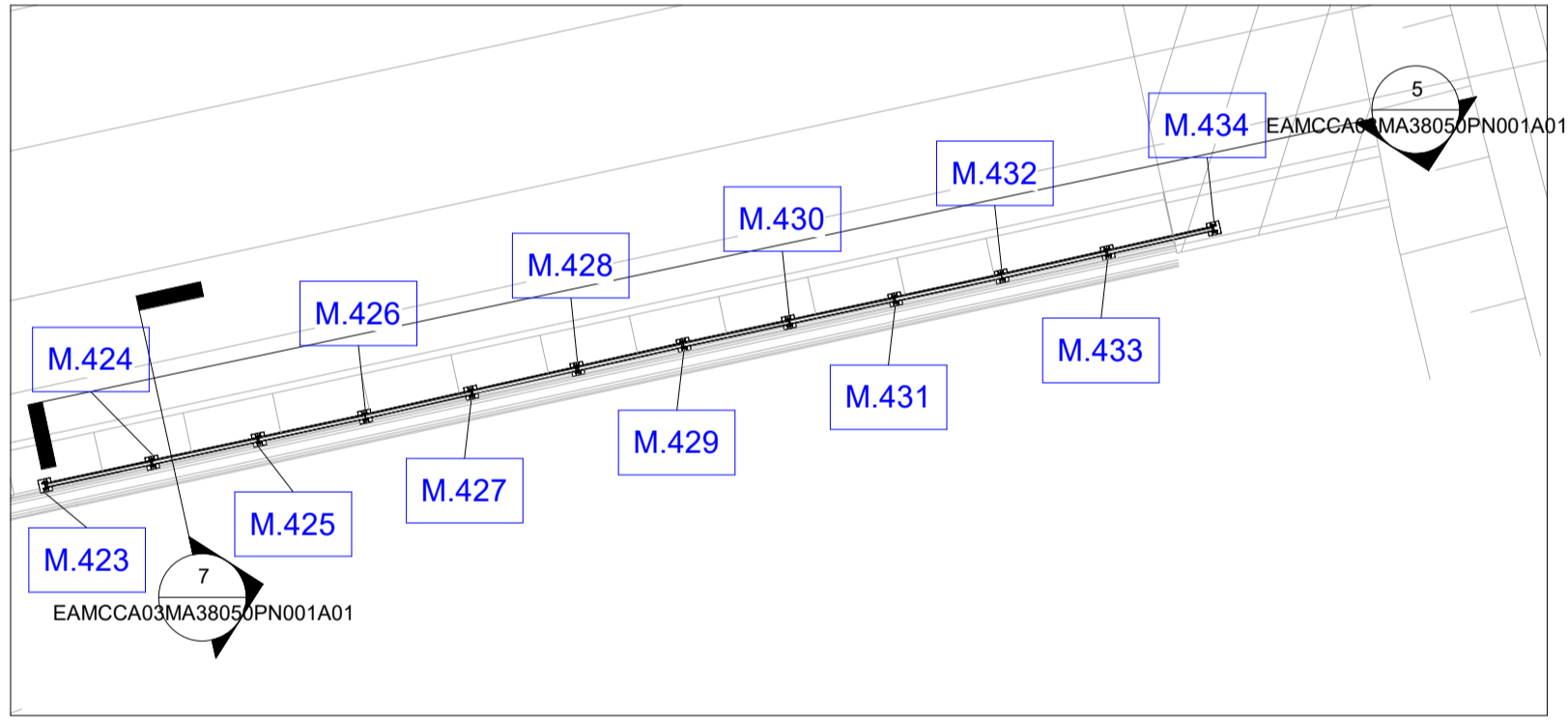

3 Stralcio planimetrico WBS 38
1 : 200

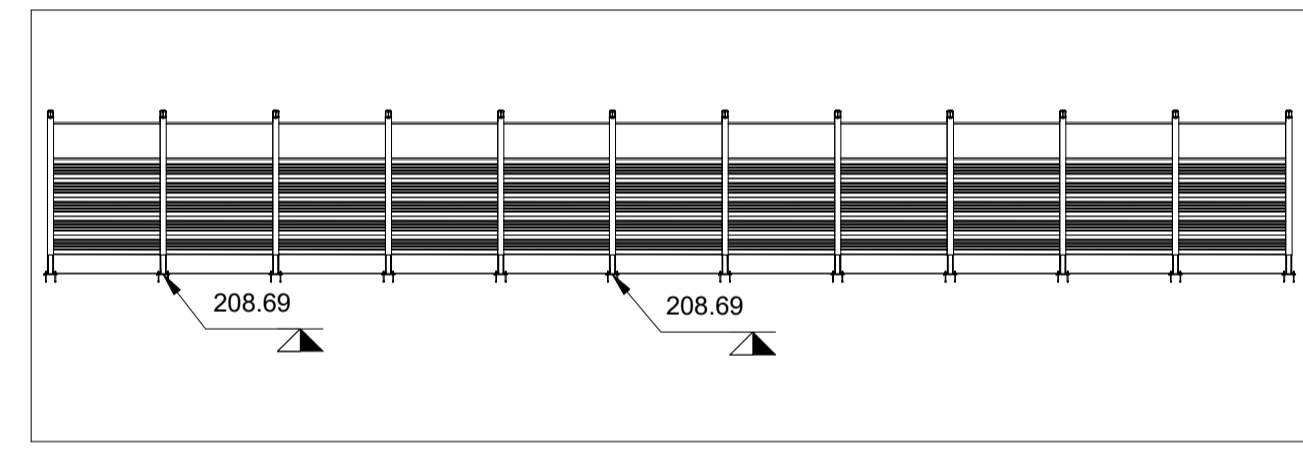

5 Sezione WBS 38
1 : 200

Abaco Coordinate di Tracciamento CBA38

PUNTO n.	E	N
M.423	154807.454437	240396.083185
M.424	154810.411604	240396.572734
M.425	154813.350759	240397.070566
M.426	154816.288064	240397.565493
M.427	154819.220634	240398.087639
M.428	154822.153305	240398.608091
M.429	154825.085282	240399.135190
M.430	154827.998351	240399.617657
M.431	154830.932621	240400.113843
M.432	154833.869926	240400.608771
M.433	154836.802496	240401.130917
M.434	154839.735074	240401.653125

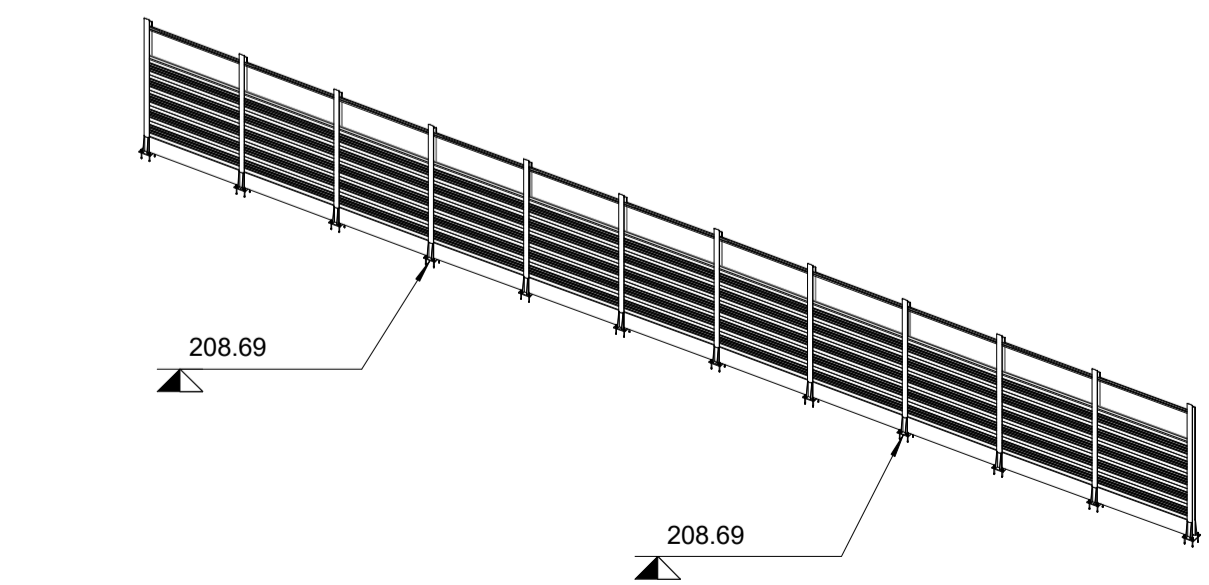

4 Assonometria WBS 38

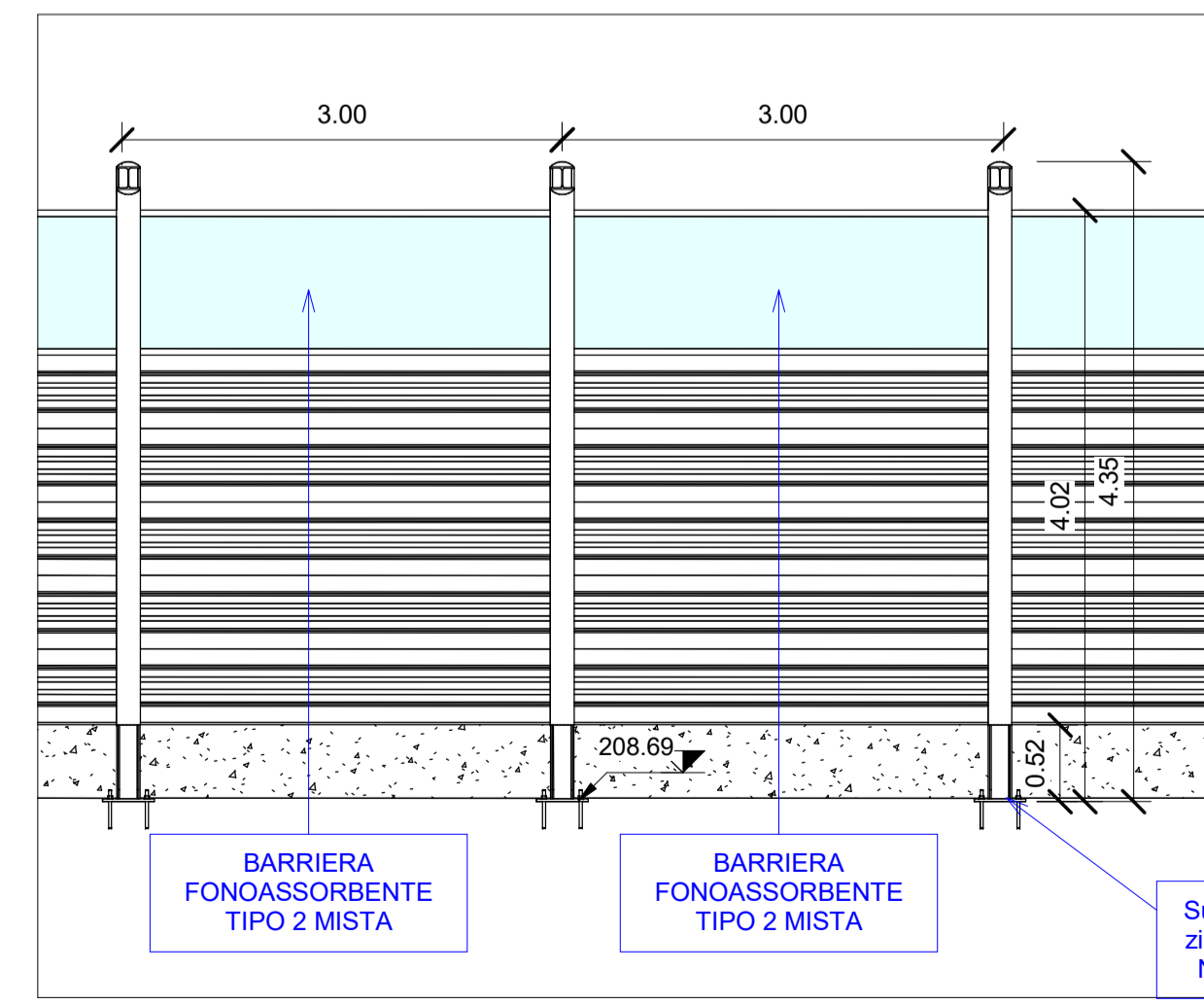

6 Sezione WBS 38
1 : 50

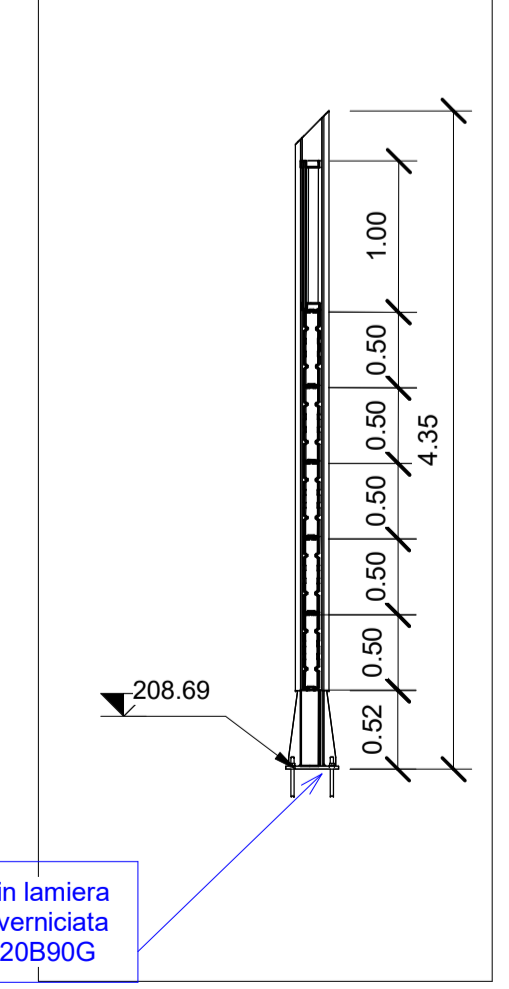

7 Sezione WBS 38
1 : 50

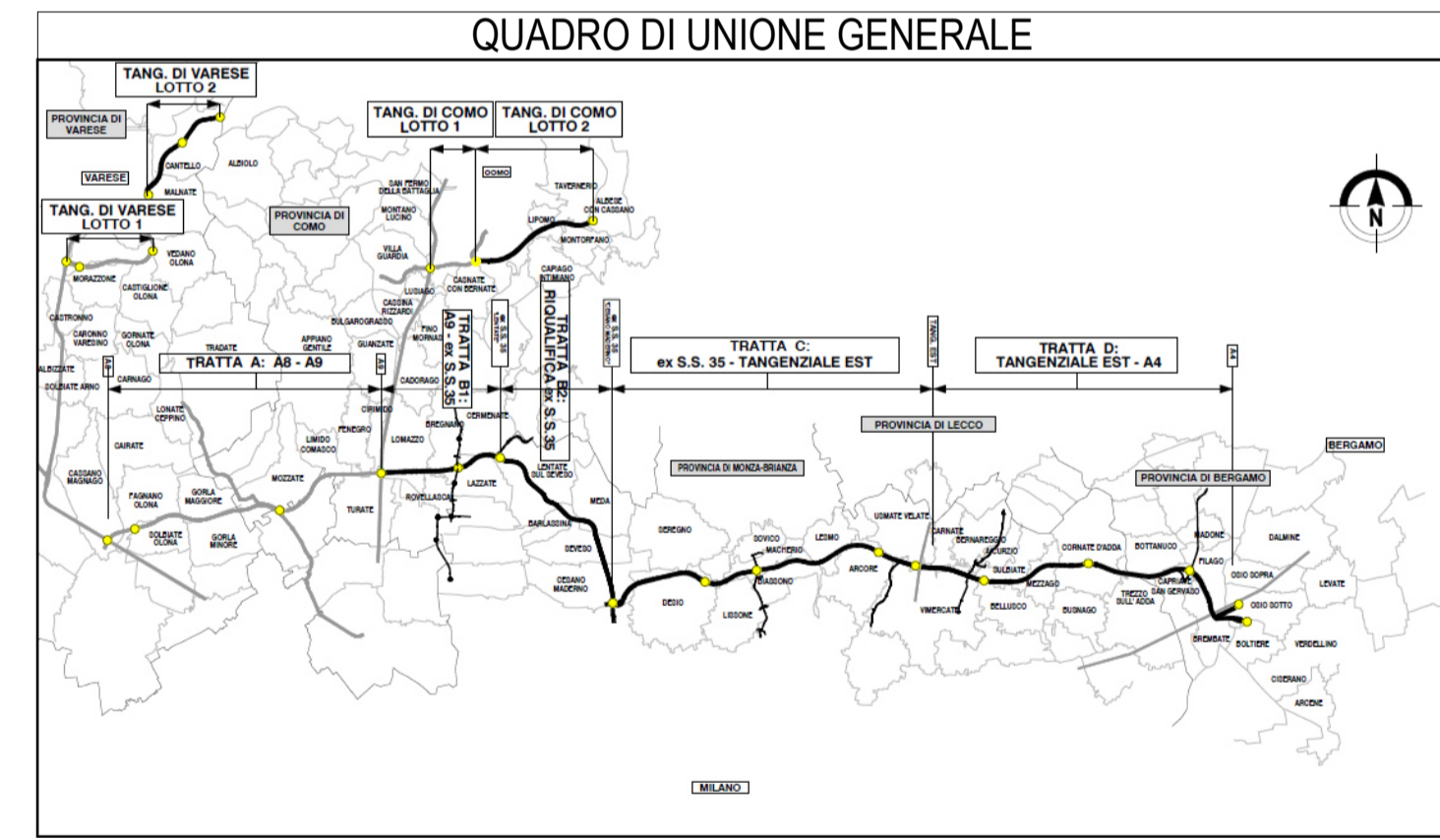
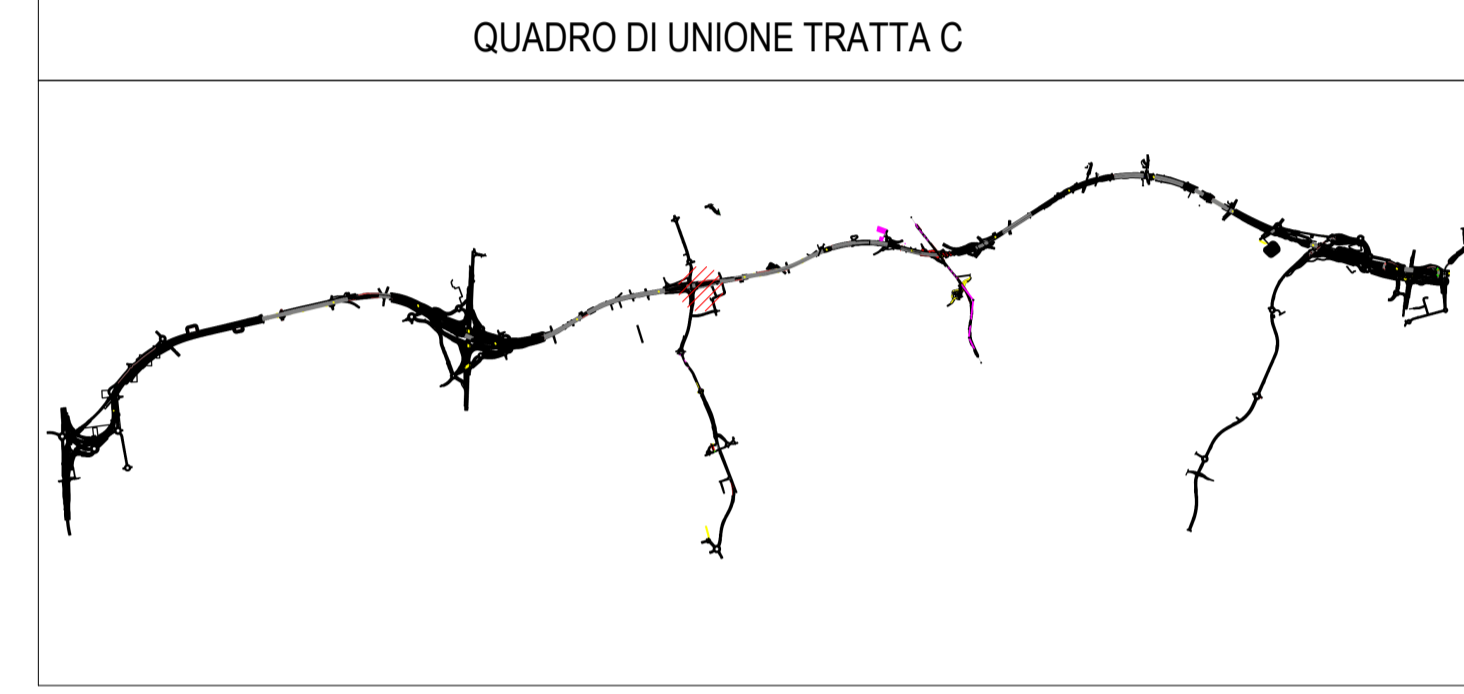
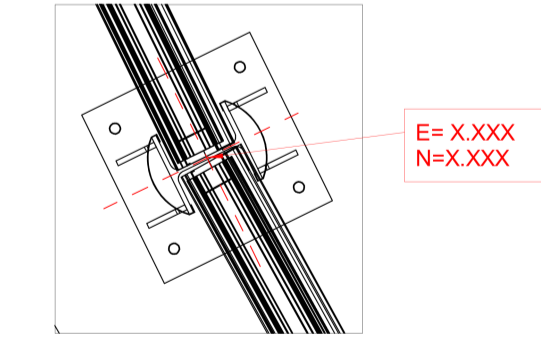

CONCESSIONARI AUTOSTRADALI LOMBARDE

Autosstrada Pademontana Lombardia

COLLEGAMENTO AUTOSTRADALE
DALMINE-COMO-VARESE-VALICO DEL GAGGIOLO E OPERE AD ESSO CONNESSE
CODICE C.U.P. F118060027001

PROGETTO ESECUTIVO
TRATTA C
Pianta WBS.C.BA.38

IDENTIFICAZIONE ELABORATO		CONTRAENTE GENERALE	
FASE PROGETTUALE	WBS	PEDELOMBARDA NUOVA S.c.p.A.	
AMBITO	TRATTA	DATA	REVISIONE
CATEGORIA	OPERA	15/09/2023	A01
CONCEDENTE	CONCESSIONARIO	ELABORAZIONE PROGETTUALE	
AMBC CC	Autosstrada Pademontana Lombardia	PROGETTISTI	RESPONSABILE
		Ing. Alberto Rinaldi	INGEGRAZIONE
		Ing. Carlo Listori	PRESTAZIONI
		Ing. Andrea Meloni	SPECIALISTICHE
		Ing. Enrico Moretti	
		PROGETTISTA	
		PROGER	