

2 Stralcio Planimetrico CC.BA.72 PT.1
1 : 200

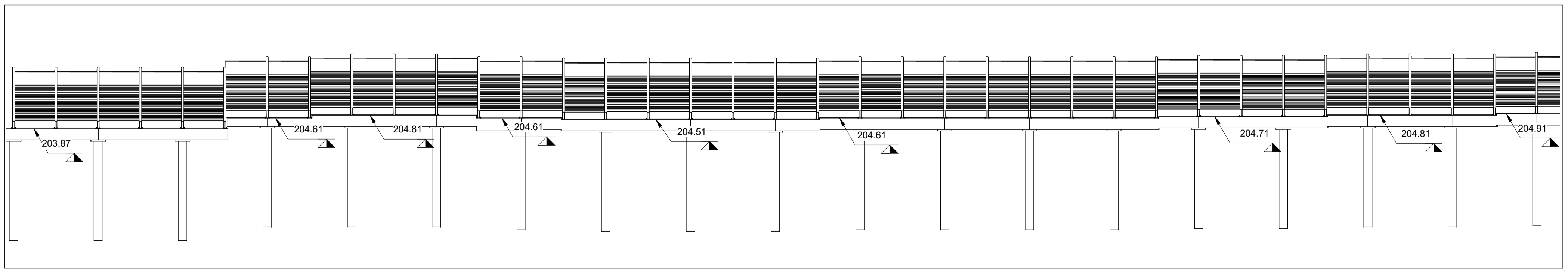

1 Sezione CC.BA.72 PT.1
1 : 200

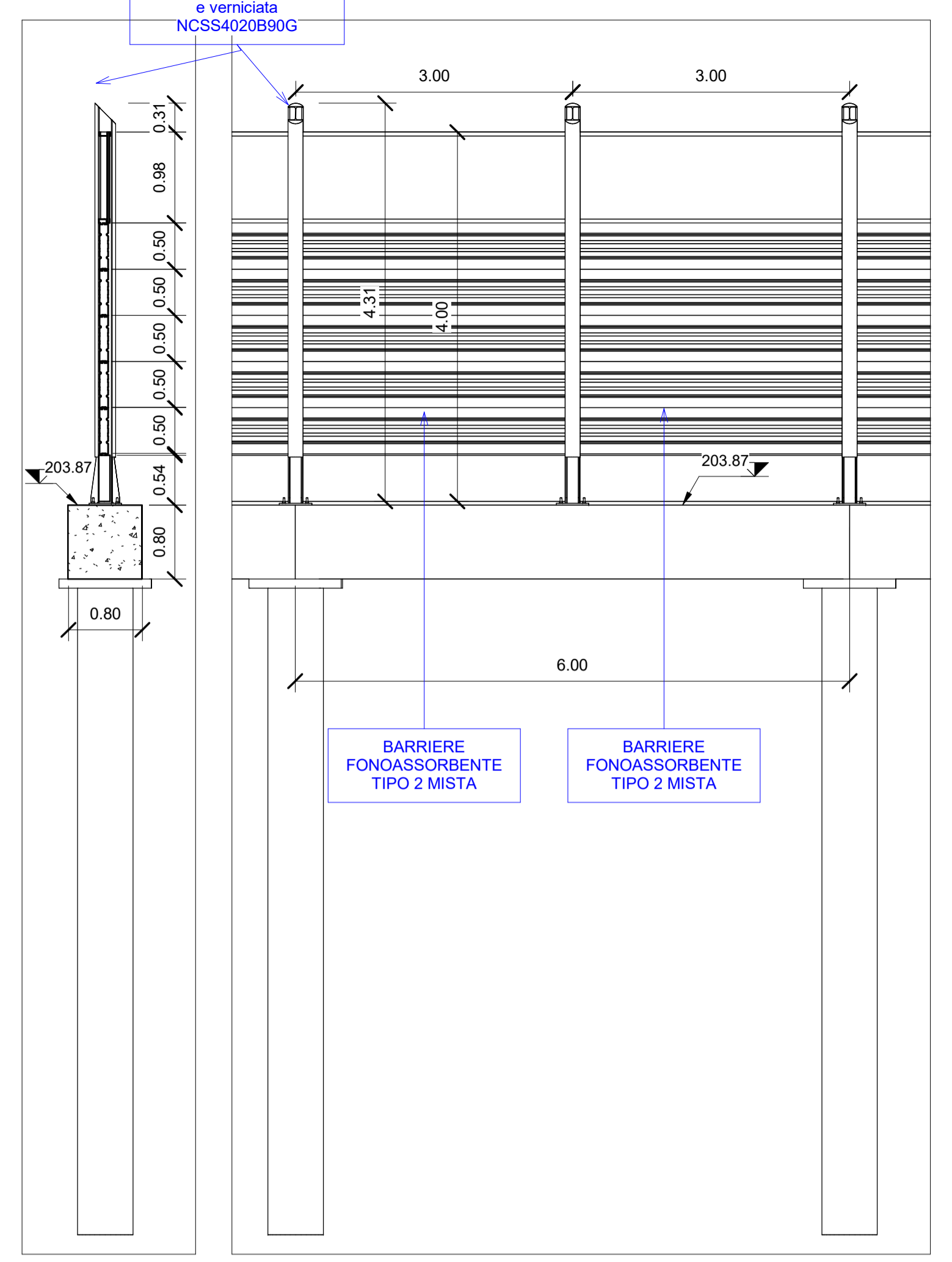

4 Sezione CC.BA.72 PT.1
1 : 50

Abaco Coordinate di Tracciamento WBS CC.BA.7...

PUNTO n.	E	N
M.283	161379.407088	240541.725407
M.284	161377.134259	240539.767283
M.285	161374.894795	240537.771130
M.286	161372.655280	240535.774975
M.287	161370.421098	240533.772430
M.288	161368.187131	240531.770085
M.289	161365.985289	240529.733164
M.290	161363.783052	240527.695925
M.291	161361.597140	240525.640117
M.292	161359.412495	240523.585521
M.293	161357.255835	240521.499907
M.294	161355.099223	240519.414370
M.295	161352.954531	240517.316827
M.296	161350.809643	240515.219105
M.297	161348.688468	240513.097901
M.298	161346.567147	240510.976581
M.299	161344.475757	240508.825387
M.300	161342.384803	240506.674673

Abaco Coordinate di Tracciamento WBS CC.BA.7...

PUNTO n.	E	N
M.301	161340.302581	240504.514779
M.302	161338.220446	240502.354984
M.303	161336.173294	240500.162003
M.304	161334.126122	240497.969039
M.305	161332.095477	240495.760766
M.306	161330.064371	240493.552008
M.307	161328.053302	240491.325935
M.308	161326.042681	240489.100388
M.309	161324.057386	240486.851254
M.310	161322.072077	240484.602130
M.311	161320.101002	240482.337913
M.312	161318.132540	240480.076714
M.313	161316.190890	240477.789917
M.314	161314.248780	240475.502608
M.315	161312.331100	240473.196310
M.316	161310.413445	240470.890074
M.317	161308.517304	240468.564408
M.318	161306.621657	240466.239359

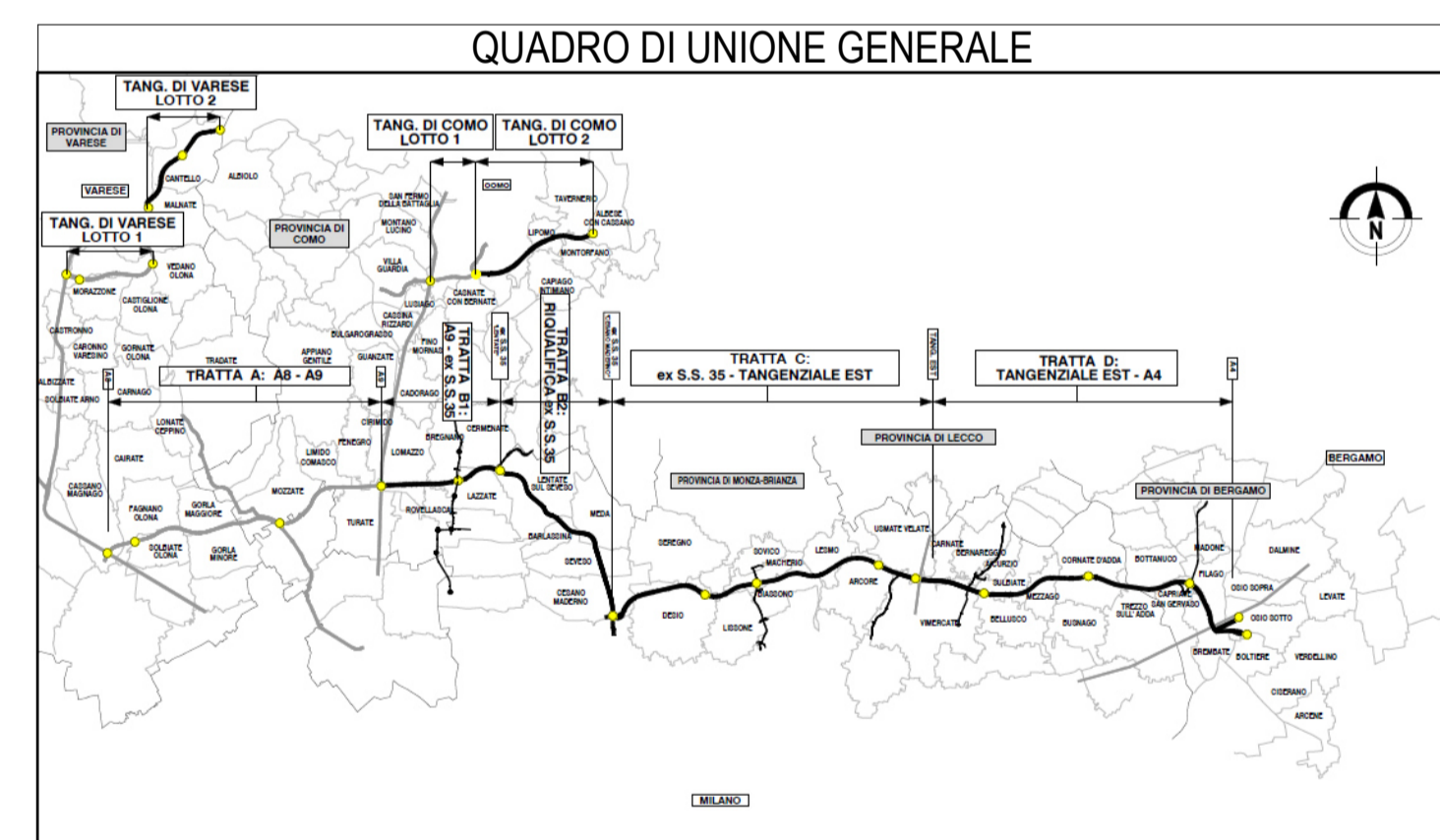
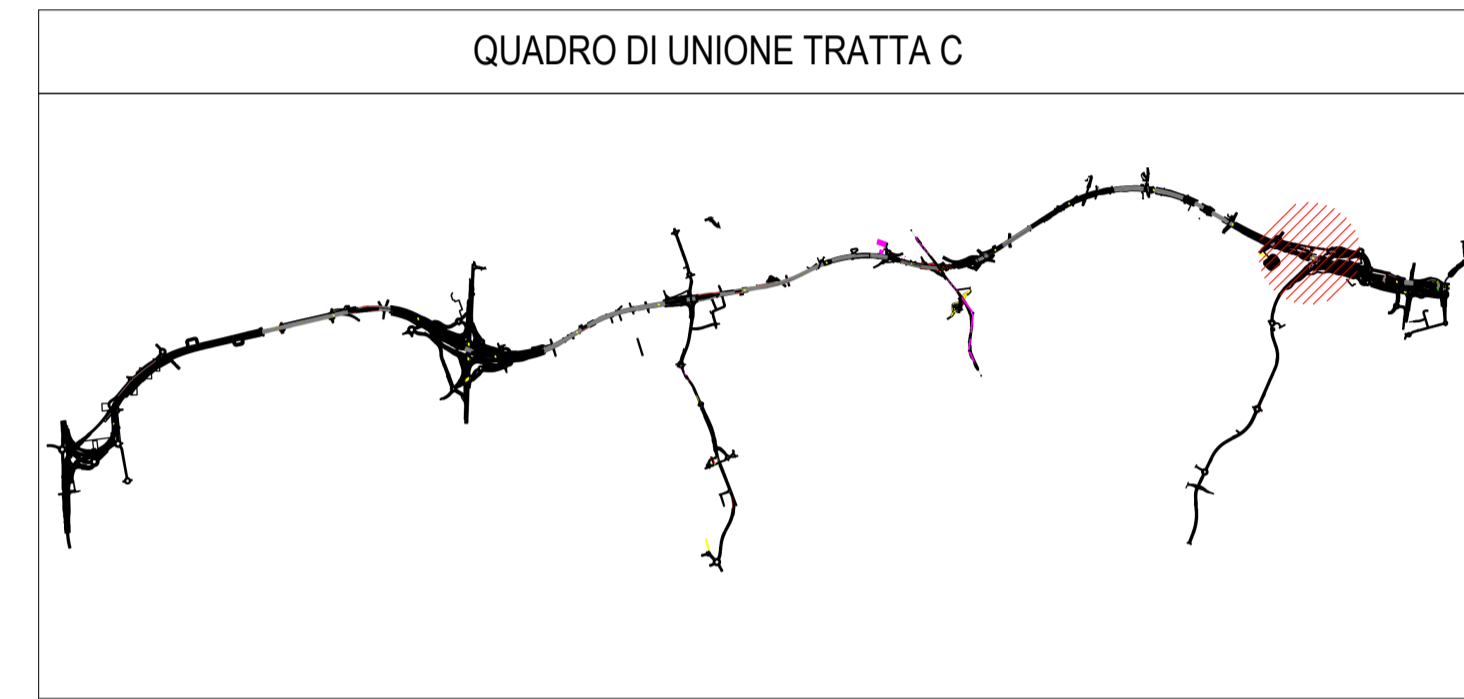

COLLEGAMENTO AUTOSTRADALE
DALMINE-COMO-VARESE-VALICO DEL GAGGIOLO E OPERE AD ESSO CONNESSE
CODICE C.U.P. F118080027001
PROGETTO ESECUTIVO
TRATTA C
WBS.C.BA.72 PT1

IDENTIFICAZIONE ELABORATO		CONTRAENTE GENERALE	
WBS	WBS	PEDELOMBARDA NUOVA S.p.A.	
AMBE CC	AMBE CC	DATA	REVISIONE
		15/09/2023	A00
		ELABORAZIONE PROGETTUALE	
		PROGETTISTI	RESPONSABILE
		Ing. Alberto Rinaldi	INGEGRAZIONE
		Erre Via A. S.r.l.	SPECIALISTICHE
		Ing. Carlo Listori	
		CONCESSIONARIO	PROGETTISTA
		CONCESSIONARI AUTOSTRADALI LOMBARDE	PROGER

This document may not be copied, reproduced or published in full or in part without the written permission of Autorisposta Pedemontana Lombarda S.p.A. Unauthorized use will be persecuted by law.