

2 Stralcio Planimetrico CC.BA.73
1 : 200

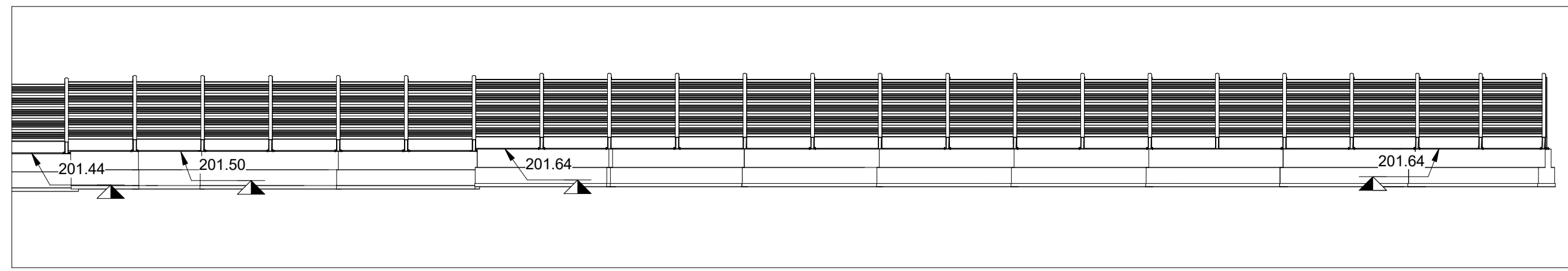

3 Sezione CC.BA.73
1 : 200

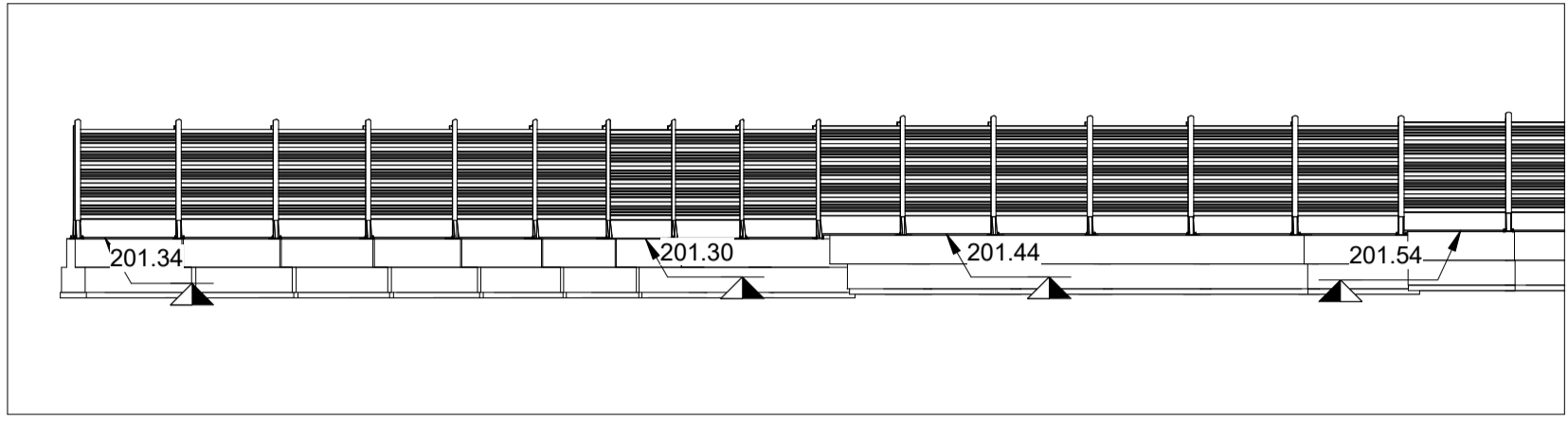

4 Sezione CC.BA.73
1 : 200

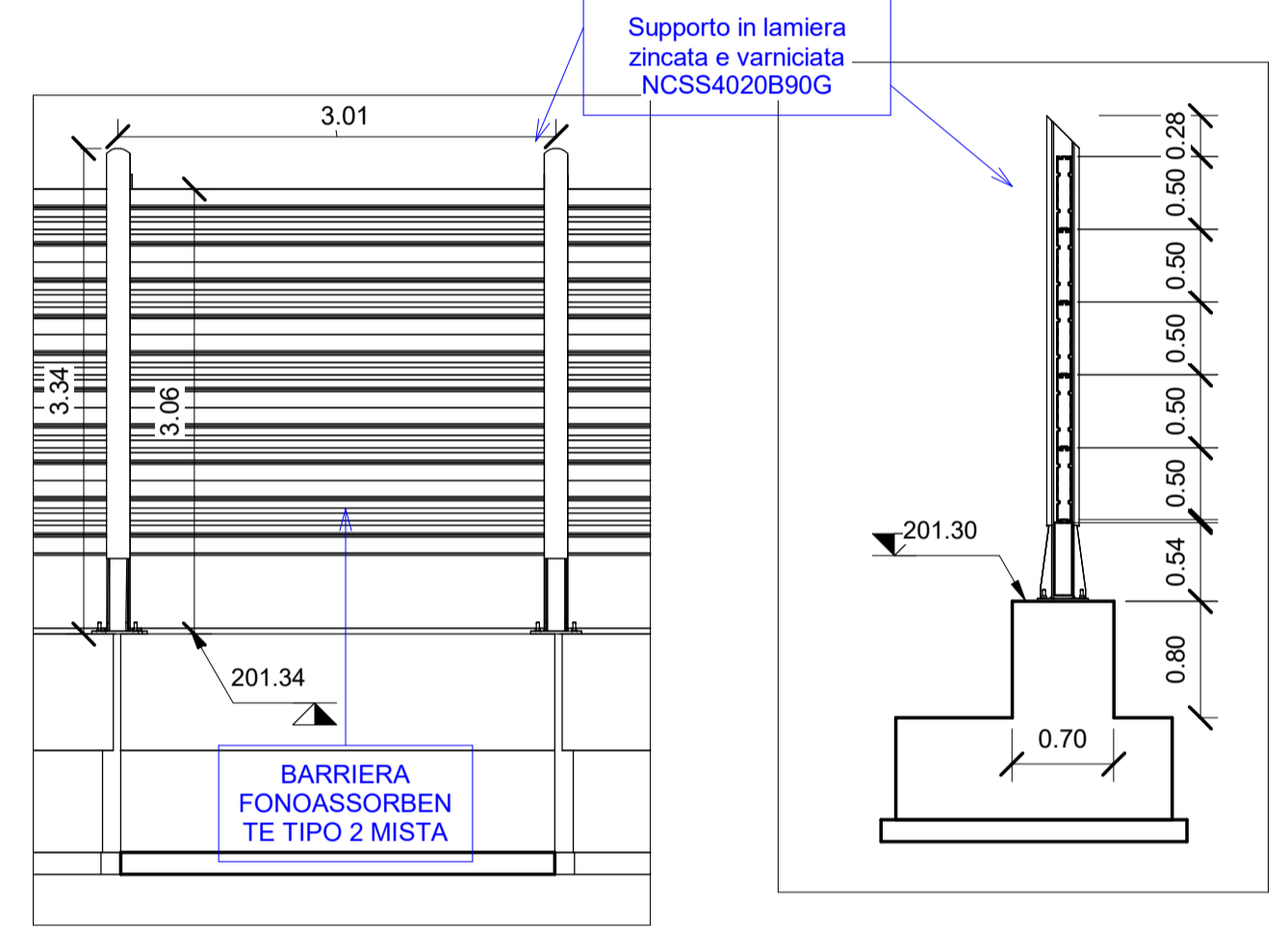

6 Sezione CC.BA.73
1 : 50

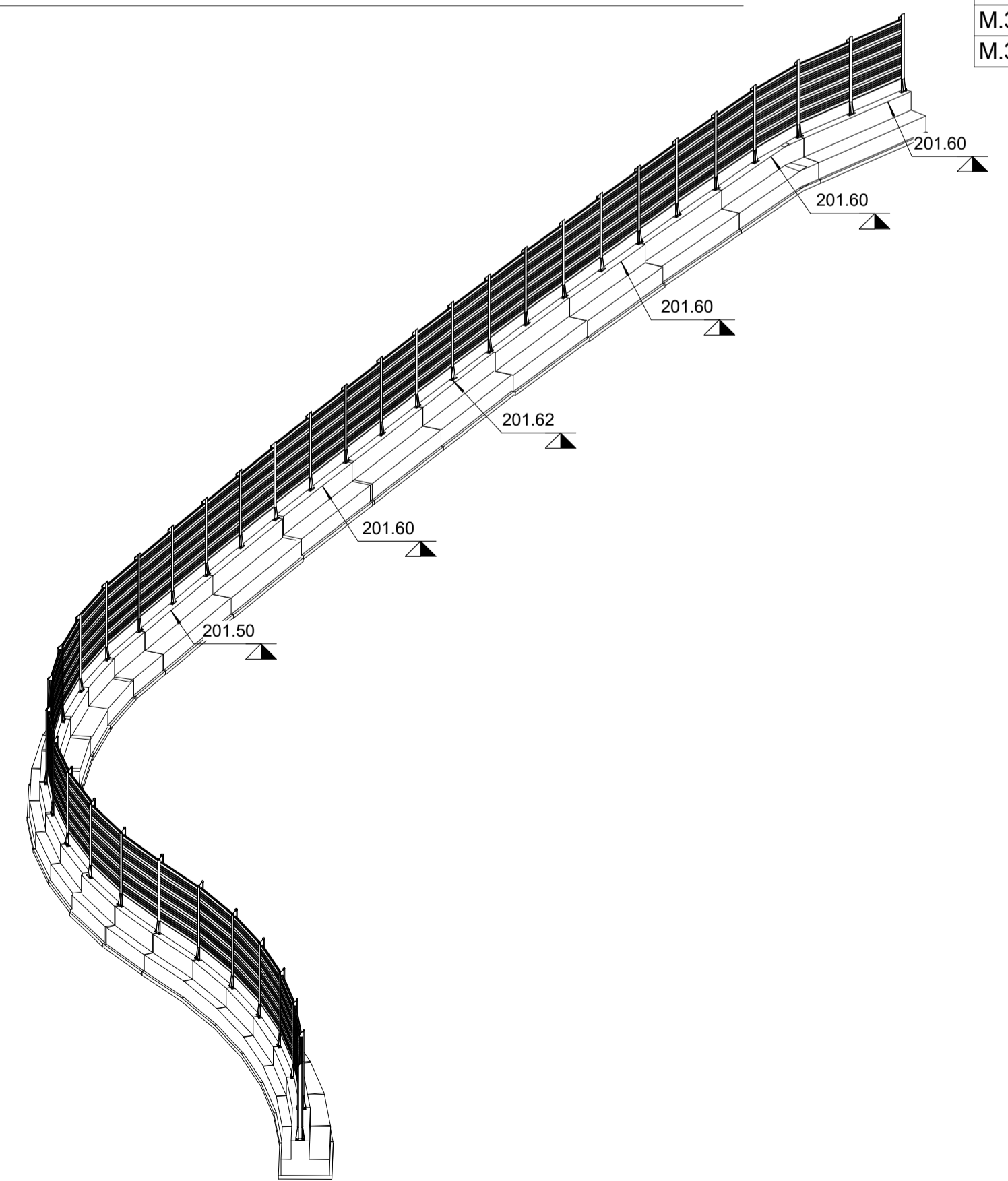

7 Assonometria BS C.BA.73

Abaco Coordinate di Tracciamento WBS CC.BA.73

PUNTO n.	E	N
M.330	161187.272329	240203.763746
M.331	161186.148509	240200.982194
M.332	161185.024689	240198.200643
M.333	161184.287927	240195.292879
M.334	161183.781679	240192.335902
M.335	161183.275431	240189.378925
M.336	161182.826297	240186.412736
M.337	161182.377163	240183.446547
M.338	161181.928029	240180.480358
M.339	161181.482292	240177.514499
M.340	161181.081465	240174.541397
M.341	161180.677845	240171.568694
M.342	161180.312193	240168.591312
M.343	161179.965937	240165.611361
M.344	161179.619681	240162.631410
M.345	161179.273426	240159.651459
M.346	161178.927170	240156.671508
M.347	161178.619404	240153.687336
M.348	161178.327836	240150.701540
M.349	161178.049173	240147.714448
M.350	161177.789613	240144.725940
M.351	161177.566162	240141.735572
M.352	161177.623624	240138.736123
M.353	161178.001258	240135.759984
M.354	161178.698916	240132.842123
M.355	161179.707045	240130.016469
M.356	161181.013897	240127.315953
M.357	161182.604242	240124.772045
M.358	161184.459547	240122.414395
M.359	161186.558313	240120.270502
M.360	161188.876062	240118.365722
M.361	161191.258445	240116.542502
M.362	161193.462190	240114.506967
M.363	161195.463501	240112.272093
M.364	161197.244428	240109.857924
M.365	161198.788998	240107.286110
M.366	161200.083360	240104.579717
M.367	161201.115198	240101.762749

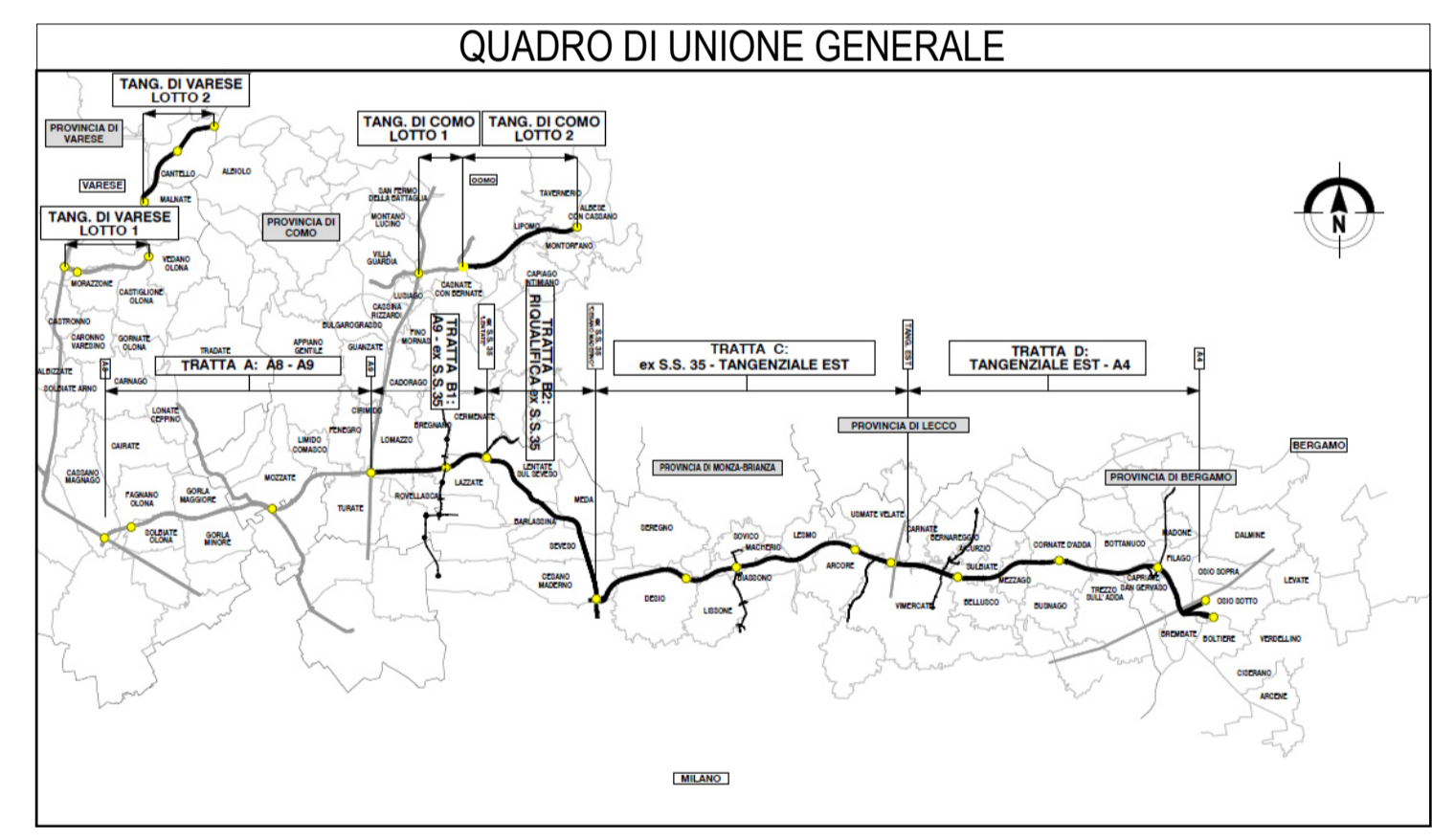
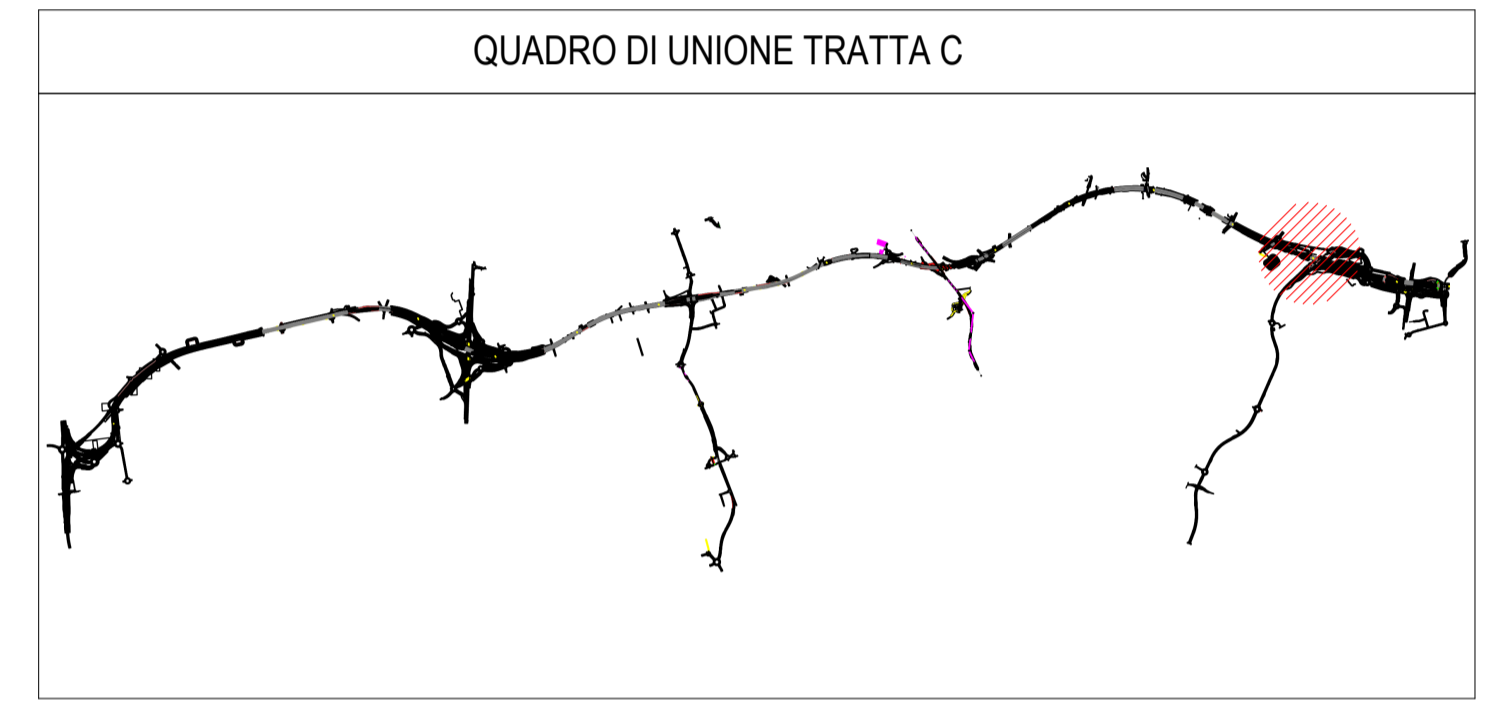
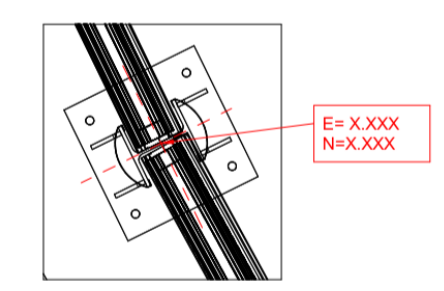

COLLEGAMENTO AUTOSTRADALE
DALMINE-COMO-VARESE-VALICO DEL GAGGIOLO E OPERE AD ESSO CONNESSE
CODICE C.U.P. F118080027001
PROGETTO ESECUTIVO
TRATTA C
WBS.C.BA.73

IDENTIFICAZIONE ELABORATO				CONTRAENTE GENERALE			
FASE PROGETTUALE	WBS	TRATTA	OPERA	PEDELOMBARDA NUOVA S.p.A.			
AMBITO	TRATTA	CATEGORIA	OPERA				
DATA	15/09/2023	REVISIONE	A00	ELABORAZIONE PROGETTUALE			
SCALA	As indicated	PROGETTISTI	Ing. Alberto Rinaldi	RESPONSABILE INTEGRAZIONE PRESTAZIONI SPECIALISTICHE			
CONCEDENTE	CONCESSIONARI AUTOSTRADALI LOMBARDE	PROGETTISTA	Ing. Carlo Listori	Ing. Carlo Listori			
CONTRATTO	CONCESSIONARI AUTOSTRADALI LOMBARDE	PROGETTISTA	Ing. Andrea Meloni	Ing. Enrico Moroni			

Il presente documento non potrà essere copiato, riprodotto o altrimenti pubblicato in tutto o in parte senza il consenso scritto di Autorisposta Pedemontana Lombarda S.p.A. Ogni utilizzo non autorizzato sarà perseguito a norma di legge. This document may not be copied, reproduced or published either in part or entirely without the written permission of Autorisposta Pedemontana Lombarda S.p.A. Unauthorized use will be persecuted by law.