

PROSPETTO LATO ISARCO

SCALA 1 : 100

NUOVA COPERTURA STAZIONE 2 DI 3

MURI IN C.A.

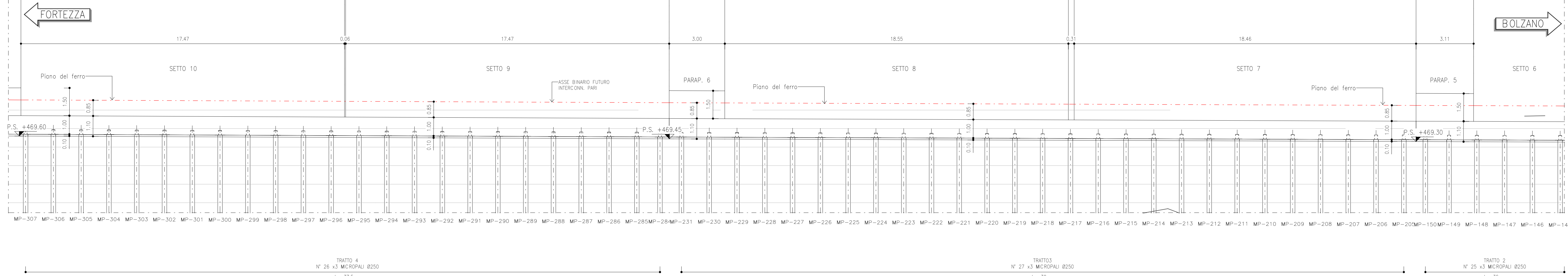

SCAVI E FONDAZIONI

SCALA 1 : 100

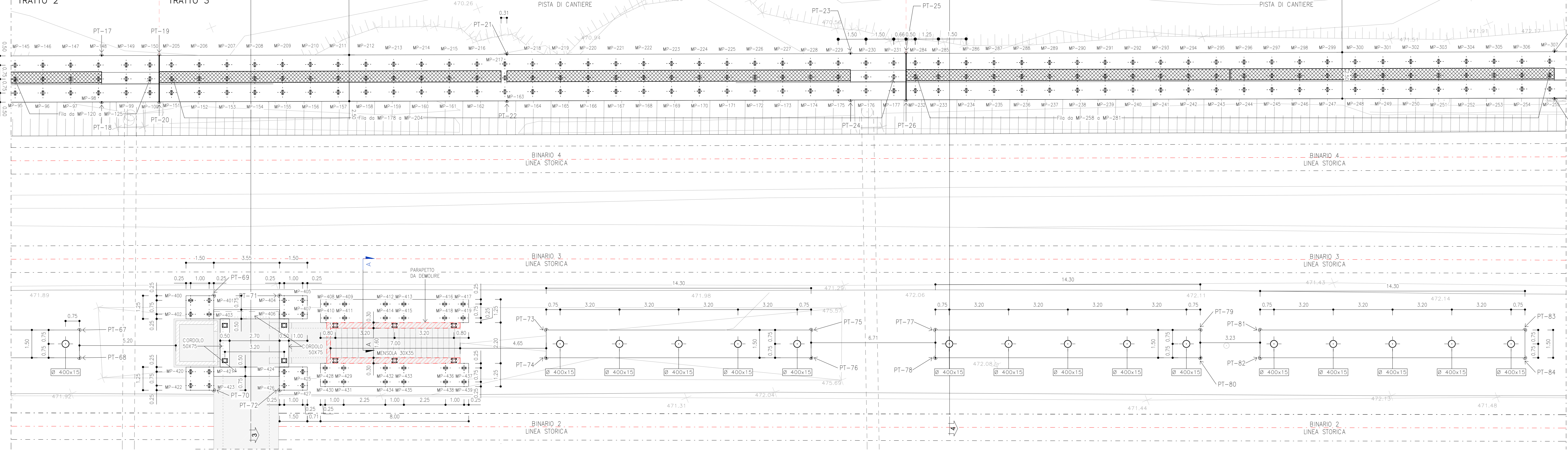
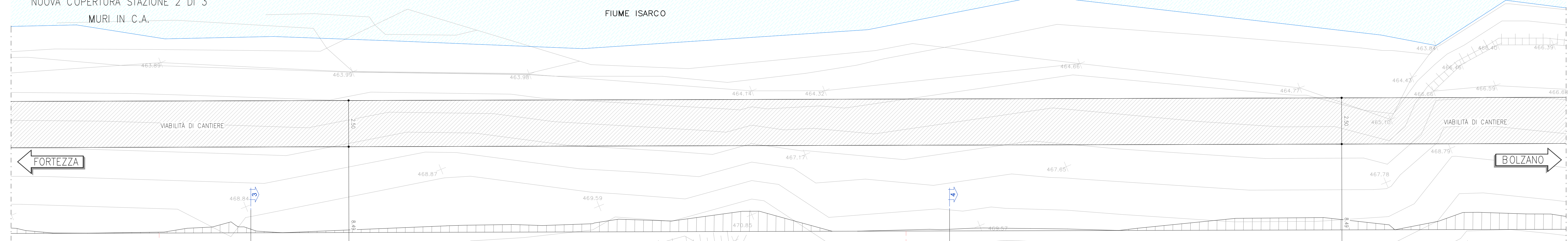

SEZIONE 3-3

SCALA 1 : 50

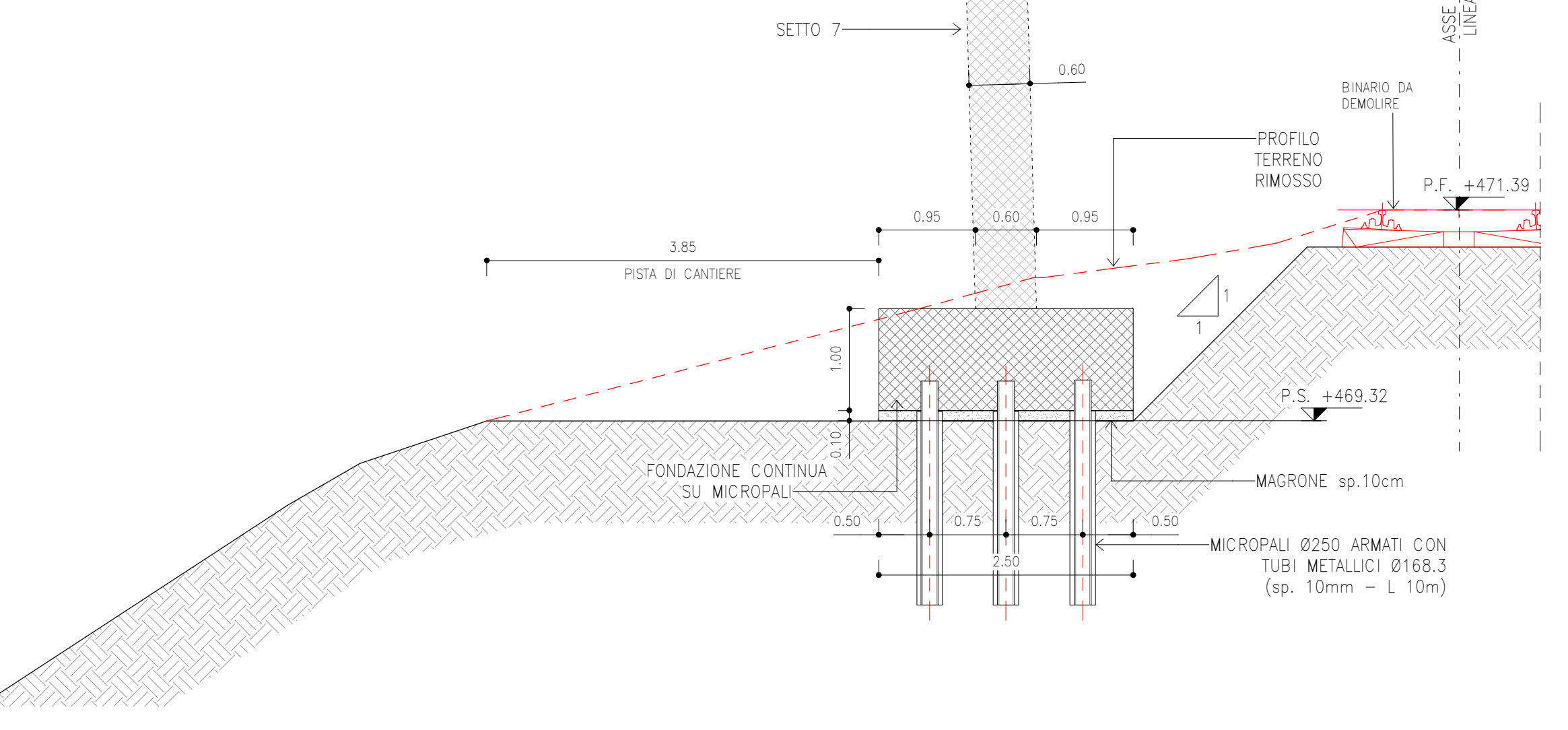

SEZIONE 4-4

SCALA 1 : 50

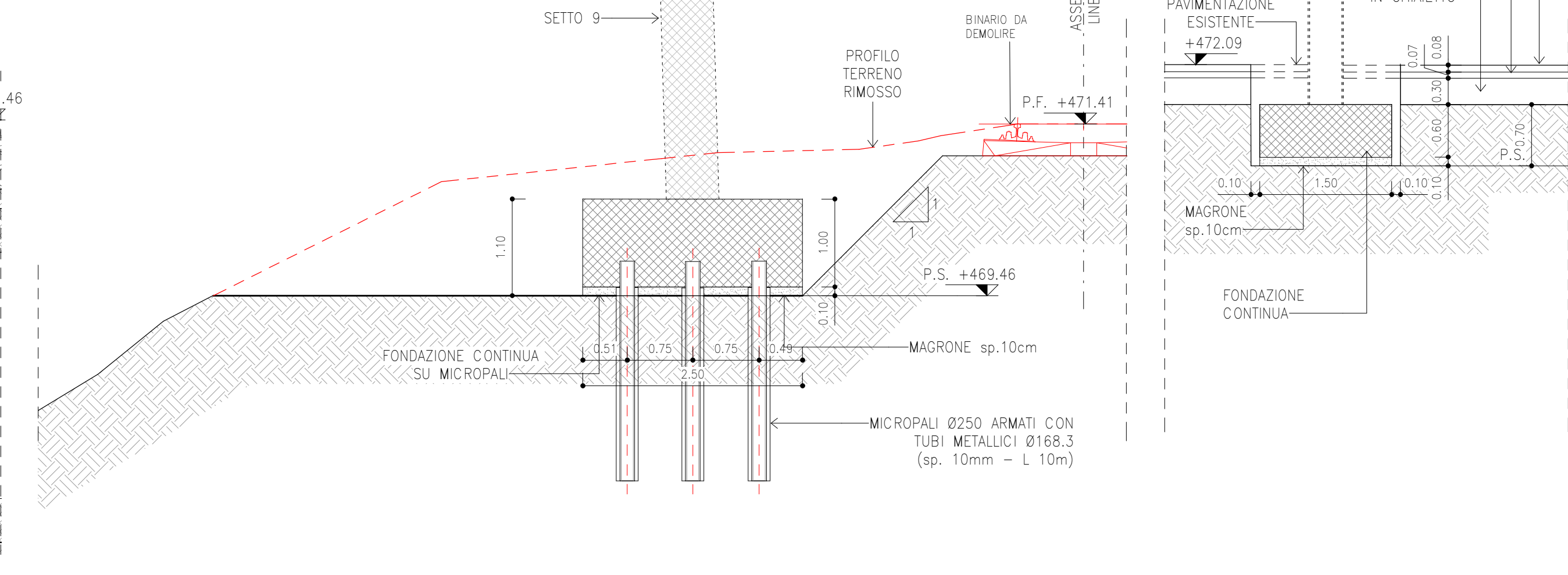

TABELLA DI TRACCIAMENTO FONDAZIONE - Pieniline			
PUNTO	E (m)	N (m)	Q.ti testa (m ² /m.l.m.)
PT-1	14143.99	20484.76	
PT-2	14142.41	20463.23	
PT-3	14143.15	20472.09	
PT-4	14143.47	20471.16	
PT-5	14143.88	20473.95	
PT-6	14146.20	20473.02	
PT-7	14147.57	20483.40	
PT-8	14148.99	20482.47	
PT-9	14148.67	20486.20	
PT-10	14150.99	20486.26	
PT-11	14152.41	20495.83	
PT-12	14154.73	20494.70	
PT-13	14155.57	20495.83	
PT-14	14155.88	20497.58	
PT-15	14159.83	20497.58	
PT-16	14162.14	20513.12	
PT-17	14166.11	20529.54	
PT-18	14169.98	20531.97	
PT-19	14172.28	20532.42	
PT-20	14174.68	20541.14	
PT-21	14174.34	20541.14	
PT-22	14174.34	20541.14	
PT-23	14181.32	20556.99	
PT-24	14183.84	20566.05	
PT-25	14192.45	20565.99	
PT-26	14186.77	20568.83	
PT-27	14195.62	20569.99	
PT-28	14197.94	20601.26	
PT-29	14196.76	20604.98	
PT-30	14197.08	20604.98	
PT-31	14199.97	20612.90	
PT-32	14202.28	20611.96	
PT-33	14201.06	20615.59	
PT-34	14203.38	20614.66	
PT-35	14206.77	20629.47	
PT-36	14209.08	20628.53	
PT-37	14212.47	20642.24	
PT-38	14212.24	20631.31	
PT-39	14215.84	20644.88	
PT-40	14212.27	20646.11	
PT-41	14215.84	20645.00	
PT-42	14215.84	20645.00	
PT-43	14216.76	20656.71	
PT-44	14216.76	20656.71	
PT-45	14216.76	20656.71	
PT-46	14216.76	20656.71	
PT-47	14222.52	20670.02	
PT-48	14222.52	20670.02	
PT-49	14152.08	20484.21	
PT-50	14153.47	20483.67	
PT-51	14156.76	20486.10	
PT-52	14158.10	20485.55	

TABELLA DI TRACCIAMENTO FONDAZIONE - Pieniline			
PUNTO	E (m)	N (m)	Q.ti testa (m ² /m.l.m.)
PT-53	14153.03	20501.23	
PT-54	14159.39	20488.93	
PT-55	14162.89	20476.83	
PT-56	14162.29	20478.26	
PT-57	14162.81	20481.72	
PT-58	14162.29	20481.72	
PT-59	14165.72	20489.06	
PT-60	14161.72	20488.41	
PT-61	14167.65	20494.04	
PT-62	14163.08	20493.48	
PT-63	14173.03	20501.23	
PT-64	14174.42	20506.75	
PT-65	14175.33	20509.02	
PT-66	14175.33	20509.02	
PT-67	14175.33	20509.02	
PT-68	14180.75	20522.25	
PT-69	14180.75	20522.25	
PT-70	14180.75	20522.25	
PT-71	14181.63	20533.56	
PT-72	14182.51	20535.83	
PT-73	14188.91	20544.14	
PT-74	14188.91	20544.14	
PT-75	14194.33	20555.36	
PT-76	14195.71	20558.81	
PT-77	14195.71	20558.81	
PT-78	14198.25	20565.02	
PT-79	14202.28	20569.99	
PT-80	14203.67	20576.25	
PT-81	14203.67	20576.25	
PT-82	14203.67	20576.25	
PT-83	14208.92	20586.24	
PT-84	14213.31	20594.48	
PT-85	14210.86	20599.77	
PT-86	14212.25	20599.21	
PT-87	14211.70	20606.72	
PT-88	14215.09	20606.15	
PT-89	14215.09	20606.15	
PT-90	14216.66	20609.91	
PT-91	14216.66	20609.91	
PT-92	14222.02	20622.73	
PT-93	14222.02	20622.73	
PT-94	14224.14	20627.64	
PT-95	14225.84	20635.50	
PT-96	14225.84	20635.50	
PT-97	14225.84	20635.50	
PT-98	14225.84	20635.50	
PT-99	14231.21	20647.90	
PT-100	14231.21	20647.90	
PT-101	14232.58	20650.91	
PT-102	14232.58	20650.91	
PT-103	14232.58	20650.91	
PT-104	14232.58	20650.91	

TABELLA DI TRACCIAMENTO MICROPALI - Nuovo coperture (Tratto 3-4)			
PUNTO	E (m)	N (m)	Q.ti testa (m ² /m.l.m.)
MP-151	14169.39	20527.27	1469.40
MP-152	14169.39	20533.06	1469.41
MP-153	14170.32	20530.50	1469.36
MP-154	14171.08	20536.44	1469.37
MP-155	14171.34	20541.63	1469.42
MP-156	14172.21	20539.22	1469.43
MP-157	14172.21	20541.63	1469.43
MP-158	14173.34	20542.00	1469.44
MP-159	14173.34	20543.39	1469.45
MP-160	14174.47	20544.78	1469.45
MP-161	14175.03	20546.17	1469.46
MP-162	14176.00	20547.56	1469.46
MP-163	14176.16	20548.95	1469.47
MP-164	14176.16	20548.95	1469.47
MP-165	14177.29	20551.73	1469.48
MP-166	14177.29	20553.12	1469.48
MP-167	14178.42	20554.51	1469.49
MP-168	14178.42	20555.90	1469.49
MP-169	14179.55	20561.28	1469.50
MP-170	14180.11	20568.46	1469.51
MP-171	14180.11	20568.46	1469.51
MP-172	14181.24	20561.46	1469.52
MP-173	14181.80	20562.85	1469.52
MP-174	14182.36	20564.24	1469.53
MP-175	14182.36	20565.63	1469.53
MP-176	14183.50	20569.02	1469.54
MP-177	14184.06	20568.40	1469.54
MP-178	14186.60	20582.50	1469.56
MP-179	14189.26	20595.99	1469.58
MP-180	14189.82	20593.33	1469.57
MP-181	14179.39	20546.42	1469.42
MP-182	14170.95	20538.11	1469.42
MP-183	14171.31	20538.11	1469.42
MP-184	14172.08	20540.89	1469.43
MP-185	14172.64	20542.28	1469.44
MP-186	14173.51	20543.67	1469.45
MP-187	14173.77	20545.06	1469.45
MP-188	14174.34	20546.45	1469.46
MP-189	14174.90	20547.84	1469.46
MP-190	14175.47	20549.23	1469.47
MP-191	14176.03	20550.62	1469.47
MP-192	14176.60	20552.01	1469.48
MP-193	14176.60	20552.01	1469.48
MP-194	14177.17	20553.40	1469.49
MP-195	14177.73	20554.79	1469.49
MP-196	14178.30	20556.18	1469.50
MP-197	14178.87	20557.57	1469.50
MP-198	14179.43	20558.96	1469.51
MP-199	14180.00	20560.35	1469.51
MP-200	14180.56	20561.74	1469.52
MP-201	14181.13	20563.13	1469.52
MP-202	14181.69	20564.52	1469.53
MP-203	14182.26	20565.91	1469.53
MP-204	14182.82	20567.30	1469.54
MP-205	14183.39	20568.69	1469.54
MP-206	14183.95	20570.08	1469.55
MP-207	14184.52	20571.47	1469.55
MP-208	14185.08	20572.86	1469.56
MP-209	14185.65	20574.25	1469.56
MP-210	14186.21	20575.64	1469.57
MP-211	14186.78	20577.03	1469.57
MP-212	14187.34	20578.42	1469.58
MP-213	14187.91	20579.81	1469.58
MP-214	14188.47	20581.20	1469.59
MP-215	14189.04	20582.59	1469.59
MP-216	14189.60	20583.98	1469.60
MP-217	14190.17	20585.37	1469.60
MP-218	14190.73	20586.76	1469.61
MP-219	14191.30	20588.15	1469.61
MP-220	14191.86	20589.54	1469.62
MP-221	14192.43	20590.93	1469.62
MP-222	14192.99	20592.32	1469.63
MP-223	14193.56	20593.71	1469.63
MP-224	14194.12	20595.10	1469.64
MP-225	14194.69	20596.49	1469.64
MP-226	14195.25	20597.88	1469.65
MP-227	14195.82	20599.27	1469.65
MP-228	14196.38	20600.66	1469.66
MP-229	14196.95	20602.05	1469.66
MP-230	14197.51	20603.44	1469.67
MP-231	14198.08	20604.83	1469.67
MP-232	14198.64	20606.22	1469.68
MP-233	14199.21	20607.61	1469.68
MP-234	14199.77	20609.00	1469.69
MP-235	14200.34	20610.39	1469.69
MP-236	14200.90	20611.78	1469.70
MP-237	14201.47	20613.17	1469.70
MP-238	14202.03	20614.56	1469.71
MP-239	14202.60	20615.95	1469.71
MP-240	14203.16	20617.34	1469.72
MP-241	14203.73	20618.73	1469.72
MP-242	14204.29	20620.12	1469.73
MP-243	14204.86	20621.51	1469.73
MP-244	14205.42	20622.90	1469.74
MP-245	14205.99	20624.29	1469.74
MP-246	14206.55	20625.68	1469.75
MP-247	14207.12	20627.07	1469.75
MP-248	14207.68	20628.46	1469.76
MP-249	14208.25	20629.85	1469.76
MP-250	14208.81	20631.24	1469.77
MP-251	14209.38	20632.63	1469.77
MP-252	14209.94	20634.02	1469.78
MP-253	14210.51	20635.41	1469.78
MP-254	14211.07	20636.80	1469.79
MP-255	14211.64	20638.19	1469.79
MP-256	14212.20	20639.58	1469.80
MP-257	14212.77	20640.97	1469.80
MP-258	14213.33	20642.36	1469.81
MP-259	14213.90	20643.75	1469.81
MP-260	14214.46	20645.14	1469.82
MP-261	14215.03	20646.53	1469.82
MP-262	14215.59	20647.92	1469.83
MP-263	14216.16	20649.31	1469.83
MP-264	14216.72	20650.70	1469.84
MP-265	14217.29	20652.09	1469.84
MP-266	14217.85	20653.48	1469.85
MP-267	14218.42	20654.87	1469.85
MP-268	14218.98	20656.26	1469.86
MP-269	14219.55	20657.65	1469.86
MP-270	14220.11	20659.04	1469.87
MP-271	14220.68	20660.43	1469.87
MP-272	14221.24	20661.82	1469.88
MP-273	14221.81	20663.21	1469.88
MP-274	14222.37	20664.60	1469.89
MP-275	14222.94	20665.99	1469.89
MP-276	14223.50	20667.38	1469.90
MP-277</			