

PIANTA STRAPASSO COPERTURA PENINSULA
scala 1:100

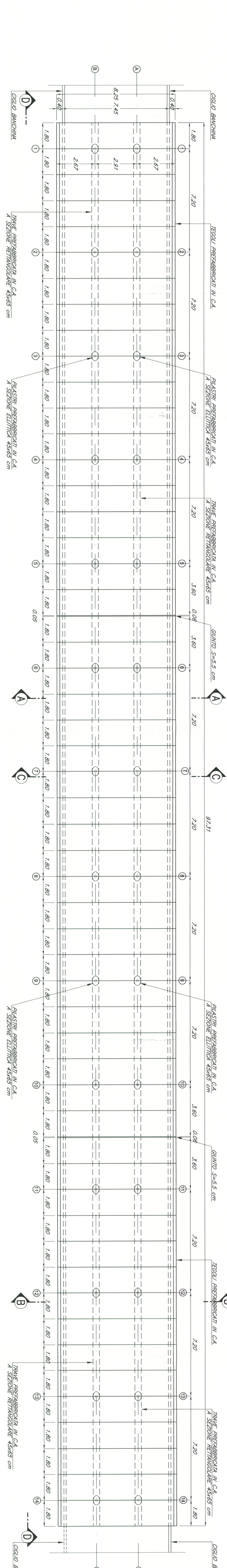

PROSPETTO PENINSULA
scala 1:100

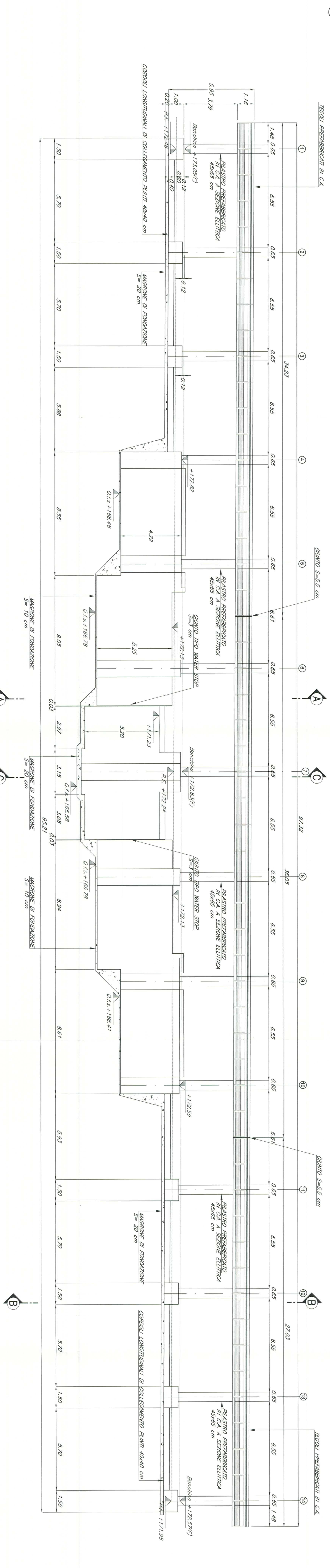

SEZIONE A-A - PENINSULA SULLE SCALE
scala 1:50

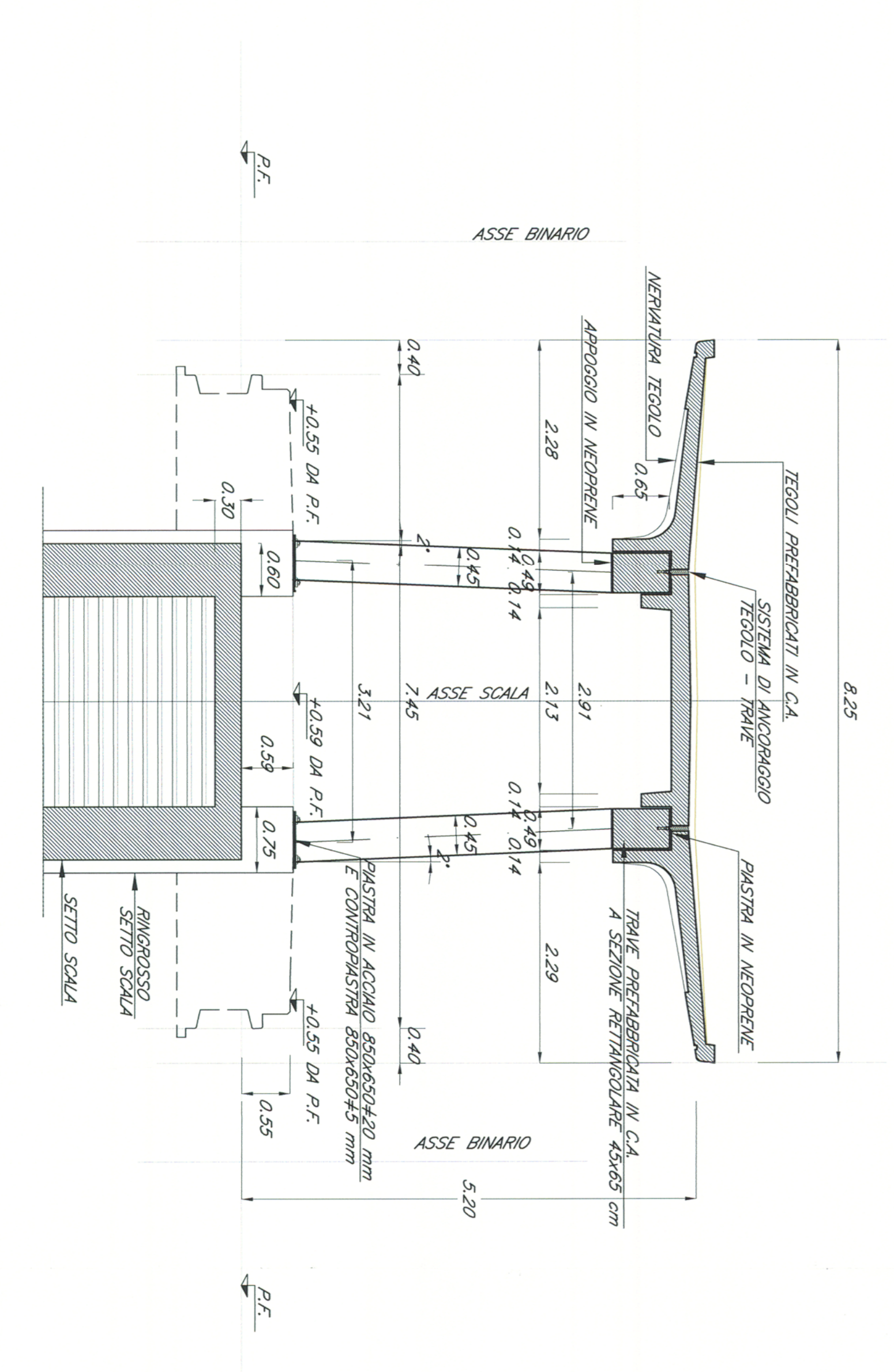

SEZIONE B-B - PENINSULA SUI PAVI
scala 1:50

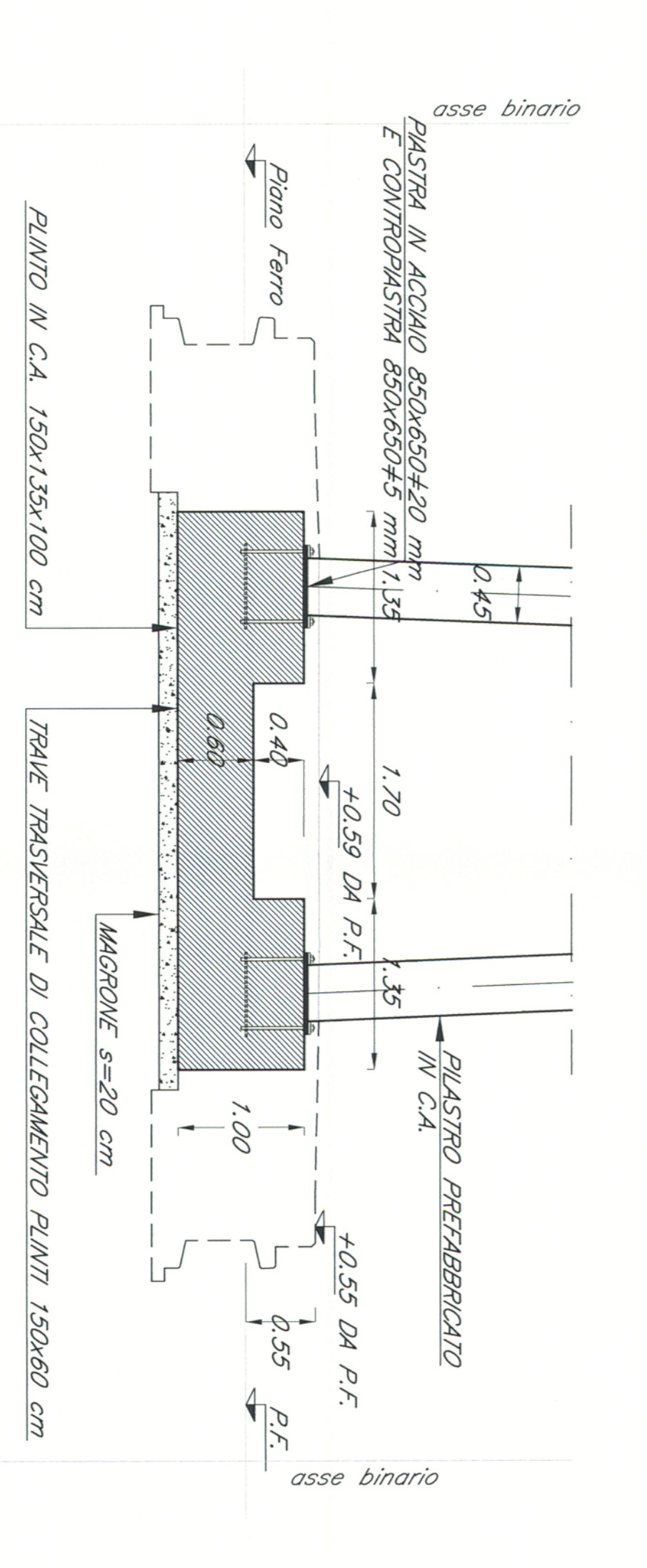

SEZIONE C-C - PENINSULA SUI SETTI ASCENSORE
scala 1:50



TABELLA MATERIALI

DESCRIZIONE	UNITA'	QUANTITA'	UNITA'	VALORE	VALORE	VALORE	VALORE
1	1	1.00	1.00	1.00	1.00	1.00	1.00
2	1	1.00	1.00	1.00	1.00	1.00	1.00
3	1	1.00	1.00	1.00	1.00	1.00	1.00
4	1	1.00	1.00	1.00	1.00	1.00	1.00
5	1	1.00	1.00	1.00	1.00	1.00	1.00
6	1	1.00	1.00	1.00	1.00	1.00	1.00
7	1	1.00	1.00	1.00	1.00	1.00	1.00
8	1	1.00	1.00	1.00	1.00	1.00	1.00
9	1	1.00	1.00	1.00	1.00	1.00	1.00
10	1	1.00	1.00	1.00	1.00	1.00	1.00
11	1	1.00	1.00	1.00	1.00	1.00	1.00
12	1	1.00	1.00	1.00	1.00	1.00	1.00
13	1	1.00	1.00	1.00	1.00	1.00	1.00
14	1	1.00	1.00	1.00	1.00	1.00	1.00
15	1	1.00	1.00	1.00	1.00	1.00	1.00
16	1	1.00	1.00	1.00	1.00	1.00	1.00
17	1	1.00	1.00	1.00	1.00	1.00	1.00
18	1	1.00	1.00	1.00	1.00	1.00	1.00
19	1	1.00	1.00	1.00	1.00	1.00	1.00
20	1	1.00	1.00	1.00	1.00	1.00	1.00
21	1	1.00	1.00	1.00	1.00	1.00	1.00
22	1	1.00	1.00	1.00	1.00	1.00	1.00
23	1	1.00	1.00	1.00	1.00	1.00	1.00
24	1	1.00	1.00	1.00	1.00	1.00	1.00
25	1	1.00	1.00	1.00	1.00	1.00	1.00
26	1	1.00	1.00	1.00	1.00	1.00	1.00
27	1	1.00	1.00	1.00	1.00	1.00	1.00
28	1	1.00	1.00	1.00	1.00	1.00	1.00
29	1	1.00	1.00	1.00	1.00	1.00	1.00
30	1	1.00	1.00	1.00	1.00	1.00	1.00
31	1	1.00	1.00	1.00	1.00	1.00	1.00
32	1	1.00	1.00	1.00	1.00	1.00	1.00
33	1	1.00	1.00	1.00	1.00	1.00	1.00
34	1	1.00	1.00	1.00	1.00	1.00	1.00
35	1	1.00	1.00	1.00	1.00	1.00	1.00
36	1	1.00	1.00	1.00	1.00	1.00	1.00
37	1	1.00	1.00	1.00	1.00	1.00	1.00
38	1	1.00	1.00	1.00	1.00	1.00	1.00
39	1	1.00	1.00	1.00	1.00	1.00	1.00
40	1	1.00	1.00	1.00	1.00	1.00	1.00
41	1	1.00	1.00	1.00	1.00	1.00	1.00
42	1	1.00	1.00	1.00	1.00	1.00	1.00
43	1	1.00	1.00	1.00	1.00	1.00	1.00
44	1	1.00	1.00	1.00	1.00	1.00	1.00
45	1	1.00	1.00	1.00	1.00	1.00	1.00
46	1	1.00	1.00	1.00	1.00	1.00	1.00
47	1	1.00	1.00	1.00	1.00	1.00	1.00
48	1	1.00	1.00	1.00	1.00	1.00	1.00
49	1	1.00	1.00	1.00	1.00	1.00	1.00
50	1	1.00	1.00	1.00	1.00	1.00	1.00
51	1	1.00	1.00	1.00	1.00	1.00	1.00
52	1	1.00	1.00	1.00	1.00	1.00	1.00
53	1	1.00	1.00	1.00	1.00	1.00	1.00
54	1	1.00	1.00	1.00	1.00	1.00	1.00
55	1	1.00	1.00	1.00	1.00	1.00	1.00
56	1	1.00	1.00	1.00	1.00	1.00	1.00
57	1	1.00	1.00	1.00	1.00	1.00	1.00
58	1	1.00	1.00	1.00	1.00	1.00	1.00
59	1	1.00	1.00	1.00	1.00	1.00	1.00
60	1	1.00	1.00	1.00	1.00	1.00	1.00
61	1	1.00	1.00	1.00	1.00	1.00	1.00
62	1	1.00	1.00	1.00	1.00	1.00	1.00
63	1	1.00	1.00	1.00	1.00	1.00	1.00
64	1	1.00	1.00	1.00	1.00	1.00	1.00
65	1	1.00	1.00	1.00	1.00	1.00	1.00
66	1	1.00	1.00	1.00	1.00	1.00	1.00
67	1	1.00	1.00	1.00	1.00	1.00	1.00
68	1	1.00	1.00	1.00	1.00	1.00	1.00
69	1	1.00	1.00	1.00	1.00	1.00	1.00
70	1	1.00	1.00	1.00	1.00	1.00	1.00
71	1	1.00	1.00	1.00	1.00	1.00	1.00
72	1	1.00	1.00	1.00	1.00	1.00	1.00
73	1	1.00	1.00	1.00	1.00	1.00	1.00
74	1	1.00	1.00	1.00	1.00	1.00	1.00
75	1	1.00	1.00	1.00	1.00	1.00	1.00
76	1	1.00	1.00	1.00	1.00	1.00	1.00
77	1	1.00	1.00	1.00	1.00	1.00	1.00
78	1	1.00	1.00	1.00	1.00	1.00	1.00
79	1	1.00	1.00	1.00	1.00	1.00	1.00
80	1	1.00	1.00	1.00	1.00	1.00	1.00
81	1	1.00	1.00	1.00	1.00	1.00	1.00
82	1	1.00	1.00	1.00	1.00	1.00	1.00
83	1	1.00	1.00	1.00	1.00	1.00	1.00
84	1	1.00	1.00	1.00	1.00	1.00	1.00
85	1	1.00	1.00	1.00	1.00	1.00	1.00
86	1	1.00	1.00	1.00	1.00	1.00	1.00
87	1	1.00	1.00	1.00	1.00	1.00	1.00
88	1	1.00	1.00	1.00	1.00	1.00	1.00
89	1	1.00	1.00	1.00	1.00	1.00	1.00
90	1	1.00	1.00	1.00	1.00	1.00	1.00
91	1	1.00	1.00	1.00	1.00	1.00	1.00
92	1	1.00	1.00	1.00	1.00	1.00	1.00
93	1	1.00	1.00	1.00	1.00	1.00	1.00
94	1	1.00	1.00	1.00	1.00	1.00	1.00
95	1	1.00	1.00	1.00	1.00	1.00	1.00
96	1	1.00	1.00	1.00	1.00	1.00	1.00
97	1	1.00	1.00	1.00	1.00	1.00	1.00
98	1	1.00	1.00	1.00	1.00	1.00	1.00
99	1	1.00	1.00	1.00	1.00	1.00	1.00
100	1	1.00	1.00	1.00	1.00	1.00	1.00

NOTE GENERALI

1. Incidenza ammanture (kg/m²):
 • TRAVE 55x55: 170
 • PILASTRO: 140
 • PAVI: 125
 • TEGOLI: 130
 • CORRELLI: 85

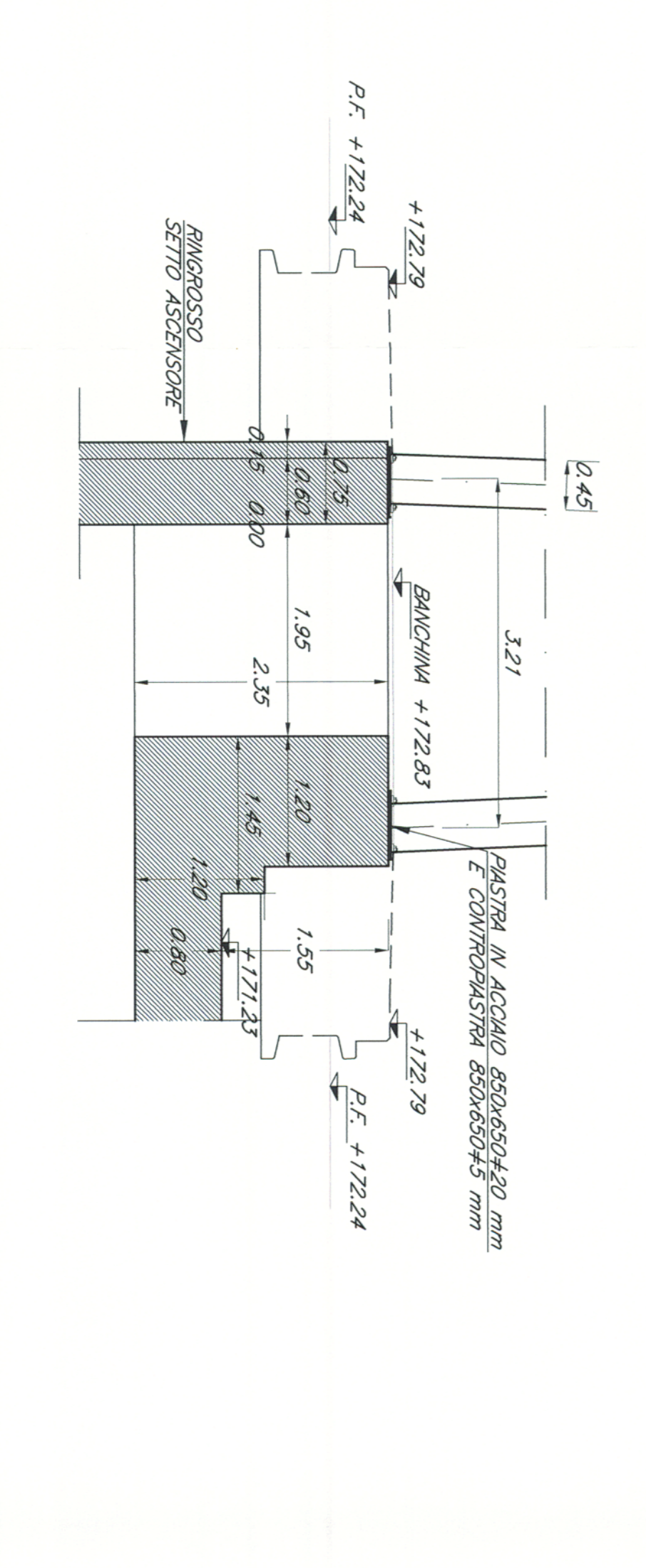
2. Incidenza ammanture (kg/m²):
 • TRAVE 55x55: 170
 • PILASTRO: 140
 • PAVI: 125
 • TEGOLI: 130
 • CORRELLI: 85

3. Incidenza ammanture (kg/m²):
 • TRAVE 55x55: 170
 • PILASTRO: 140
 • PAVI: 125
 • TEGOLI: 130
 • CORRELLI: 85

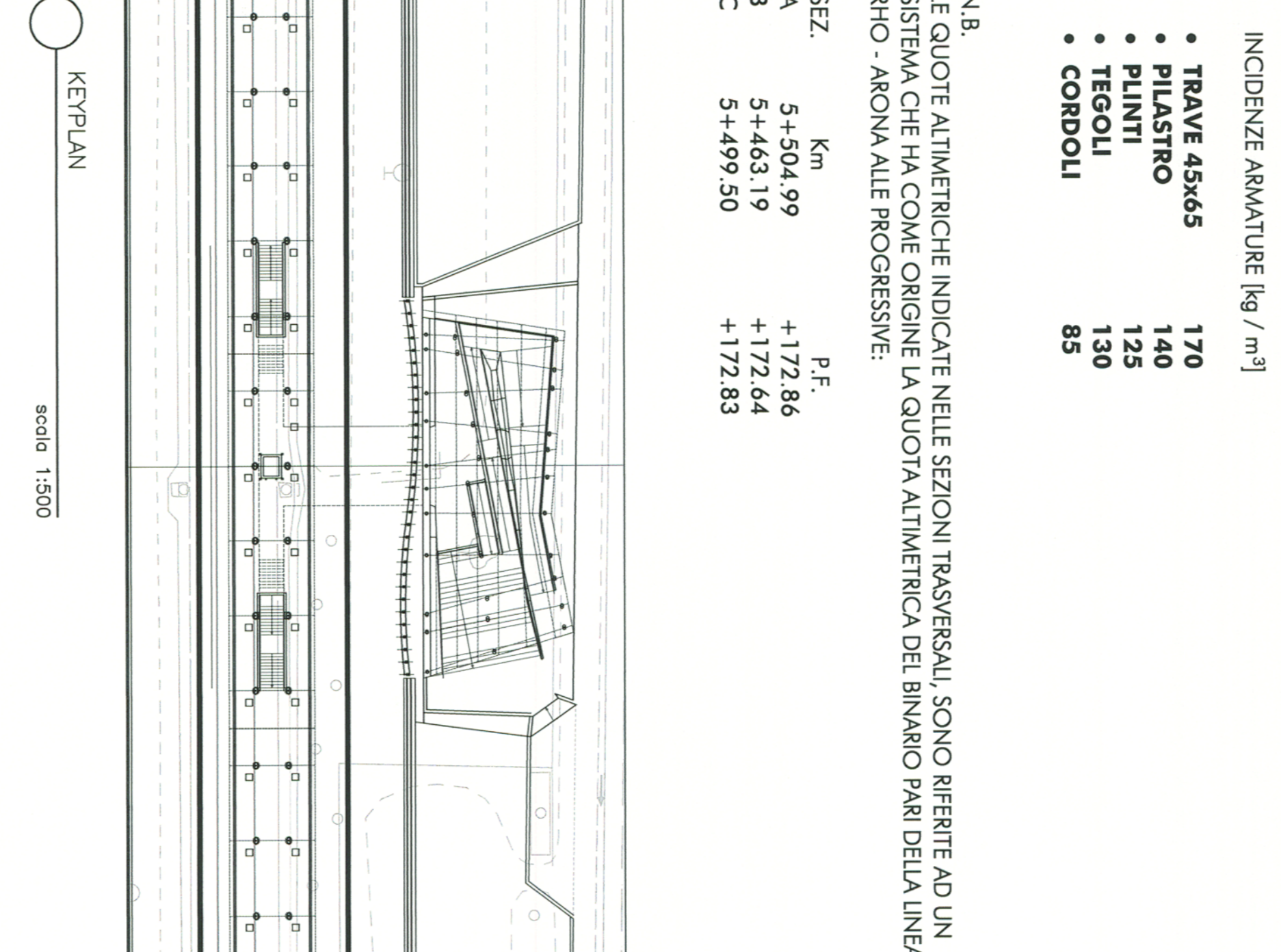

COMMITTEE
 INFRASTRUTTURE FERROVIARIE STRATEGICHE DEFINITE
 DALLA LEGGE OBBIETTIVO N. 44/01

DIREZIONE TECNICA - U.O. URBANISTICA, ARCHITETTURA E DESIGN
 PROGETTO DEFINITIVO PER APPALTO INTEGRATO
 POTenziamento della linea RHO-ARONA, TRATTA RHO-GALLARATE
 QUADRIPLICAMENTO RHO-PARABIASO E RACCORDO
 FV03 - FERMATA DI NEMANO - REALIZZAZIONE NUOVA FERMATA
 ELABORATI DI PROGETTO STRUTTURALE
 Pianta fondazioni primo copertura, prospetto e sezioni pensilina ferroviaria in c.a.

CONMESSA LOTTO FASE ENTE TIPO DOC OPERAZIONE/PROG. PROGR. REV.

MDL1 12 B 44 BZ FV0300 002 A

REDAZIONE
 A: Emidio Esposito
 B: ...
 C: ...
 D: ...
 E: ...
 F: ...
 G: ...
 H: ...
 I: ...
 J: ...
 K: ...
 L: ...
 M: ...
 N: ...
 O: ...
 P: ...
 Q: ...
 R: ...
 S: ...
 T: ...
 U: ...
 V: ...
 W: ...
 X: ...
 Y: ...
 Z: ...

SCALE
 VAR

PROGETTISTE
 GRUPPO FERROVIE DELLO STATO
 ITALFER
 GRUPPO INNOVATI DELLO STATO