

# QUADRO DI UNIONE GENERALE

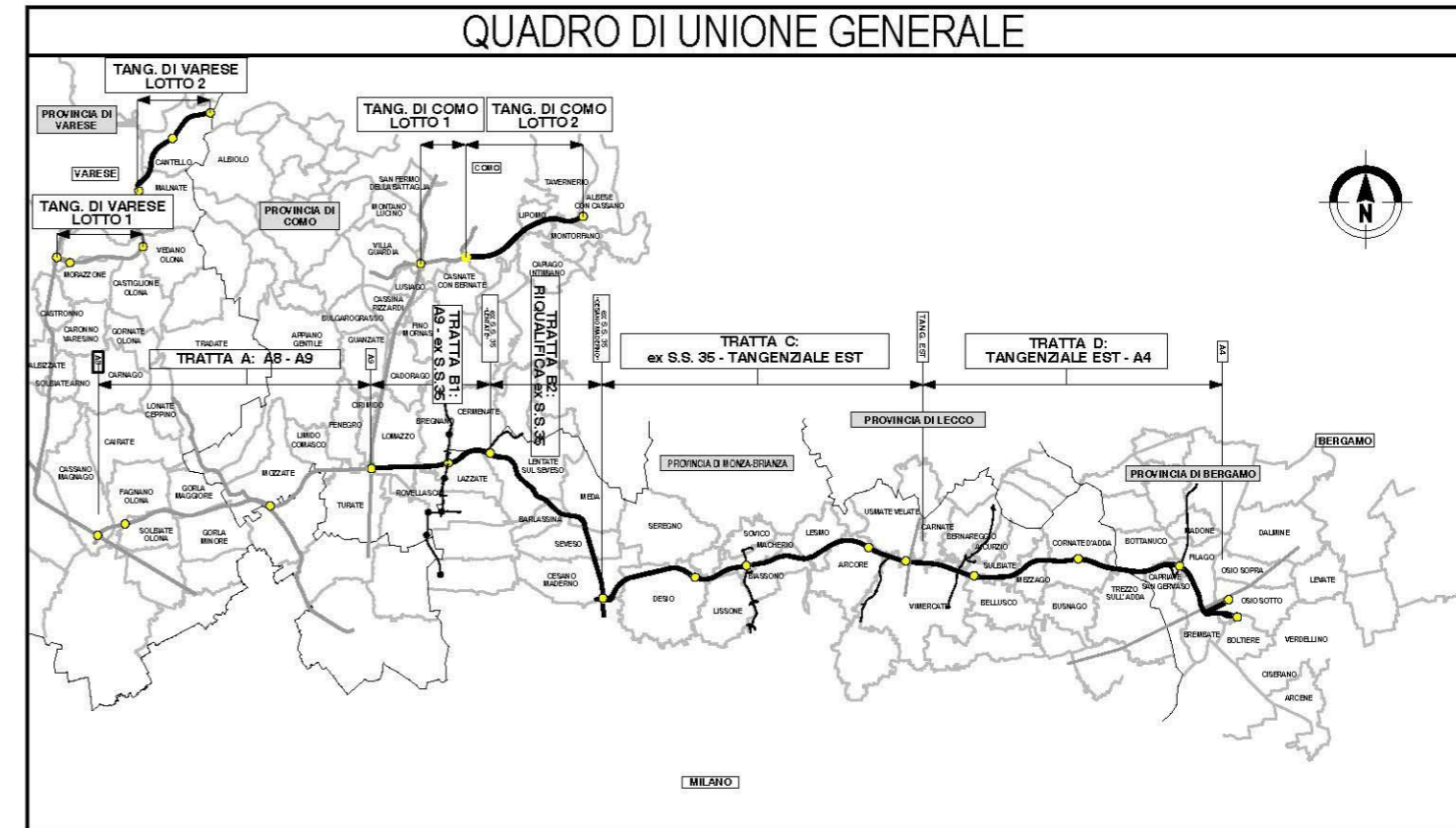

## COLLEGAMENTO AUTOSTRADALE DALMINE-COMO-VARESE-VALICO DEL GAGGIOLO E OPERE AD ESSO CONNESSE

CODICE C.U.P. F11B06000270007

### PROGETTO ESECUTIVO TRATTA B2

#### FASCICOLO DEI SESTI D'IMPIANTO E DELLE ESSENZE VEGETALI

#### IDENTIFICAZIONE ELABORATO

FASE PROGETTUALE	AMBITO	TRATTA	CATEGORIA	OPERA	PARTI DI OPERA	TIPO ELABORATO	PROGRESSIVA	REVISIONE ESTERNA
E	AM	B2	000	AT00	122	FA	001	A

DATA Giugno 2023  
SCALA

#### CONCEDENTE



#### CONTRAENTE GENERALE

PEDELOMBARDA NUOVA S.c.p.A.

#### DATA REVISIONE

DATA	REVISIONE	
7 aprile 2023	Bozza	A01
Giugno 2023	Emissione per commenti	A02

#### ELABORAZIONE PROGETTUALE

**PROGETTISTI**  
Proger s.p.a.

**RESPONSABILE INTEGRAZIONE PRESTAZIONI SPECIALISTICHE**  
Ing. Carlo Listorti



Redatto Arch. A.Kipar  
Visto Ing. M. Larosa  
Aperovato Ing. M. Sandrucci

#### CONCESSIONARIO



#### PROGETTISTA



# Filare singolo/doppio arboreo di I grandezza

Quercio - carpineto

PAESAGGIO AGRICOLO

PAESAGGIO PERIURBANO

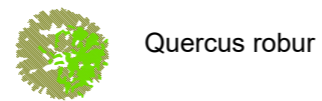
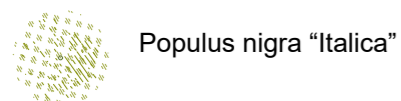
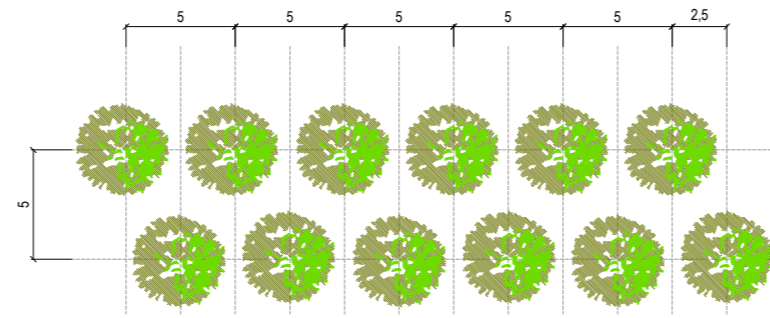
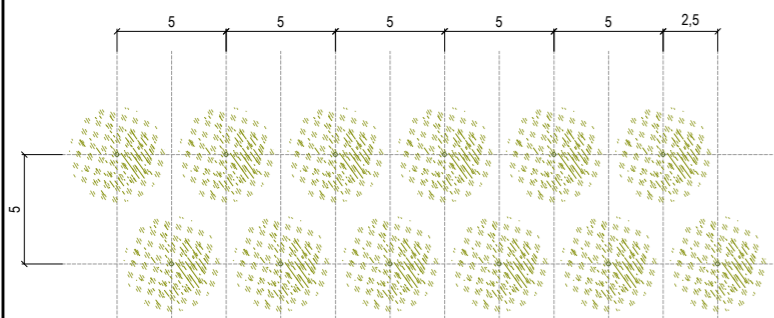
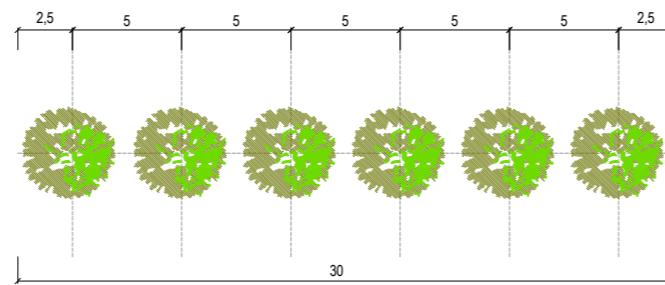
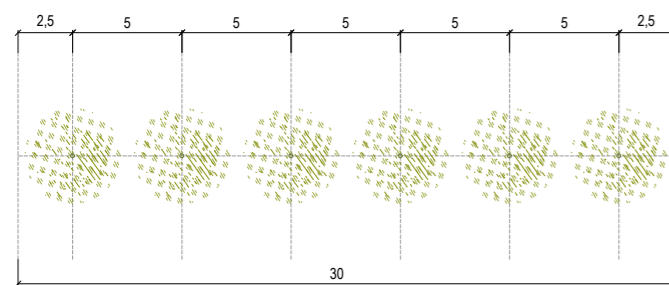

CONSOCIAZIONI VEGETALI	AMBITI					
	Agricolo	%		Urbano-periurbano	%	
		misto	puro		misto	puro
Quercio-carpineto	<i>Populus nigra Italica</i>	0	100	<i>Quercus robur</i>	0	100
Alneto di ontano nero	<i>Populus alba</i>	0	100	<i>Populus alba</i>	0	100
SCHEDA TIPOLOGICO	<b>Dimensione:</b> lunghezza 30m, larghezza 5m					
	<b>Quantità e dimensioni d'impianto:</b> 6 alberi (h.175-250cm p.te forestali; circ. 10-12cm per alberi ornamentali)					
	<b>TOTALE</b>		<b>6</b>			

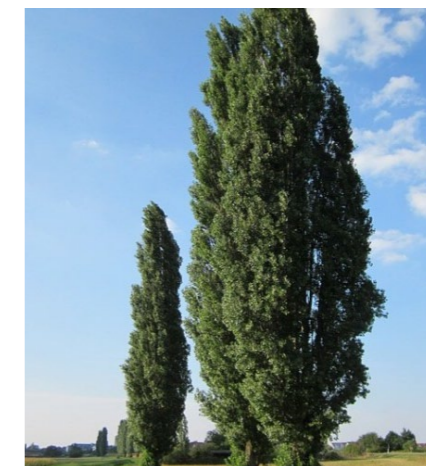

Populus nigra "Italica"



Quercus robur

# Filare singolo/doppio arboreo di I grandezza

Alneto di Ontano nero

PAESAGGIO AGRICOLO E PERIURBANO

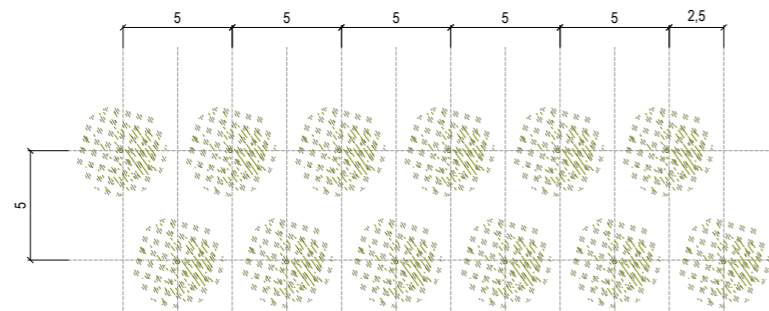
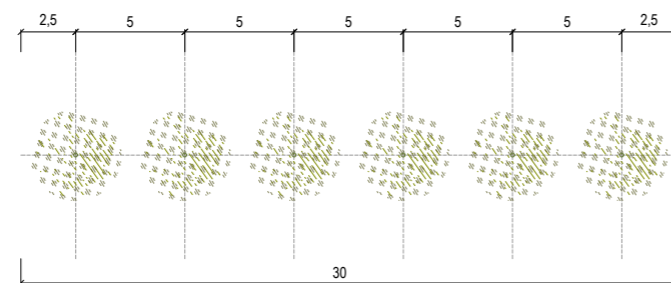

CONSOCIAZIONI VEGETALI	AMBITI					
	Agricolo	%		Urbano-periurbano	%	
		misto	puro		misto	puro
Quercu-carpineto	<i>Populus nigra Italica</i>	0	100	<i>Quercus robur</i>	0	100
Alneto di ontano nero	<i>Populus alba</i>	0	100	<i>Populus alba</i>	0	100
SCHEDA TIPOLOGICO	<b>Dimensione:</b> lunghezza 30m, larghezza 5m					
	<b>Quantità e dimensioni d'impianto:</b> 6 alberi (h.175-250cm p.te forestali; circ. 10-12cm per alberi ornamentali)					
	<b>TOTALE</b>		<b>6</b>			



Populus nigra "Italica"

# Filare singolo/doppio arboreo di II grandezza

Quercu - carpinetu

PAESAGGIO AGRICOLO

PAESAGGIO PERIURBANO

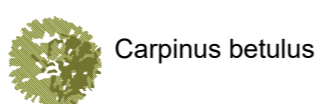
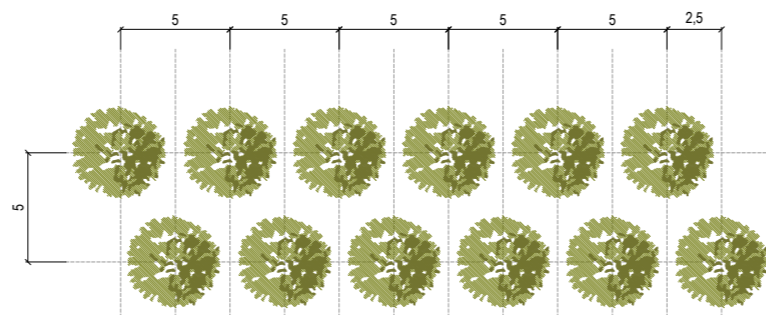
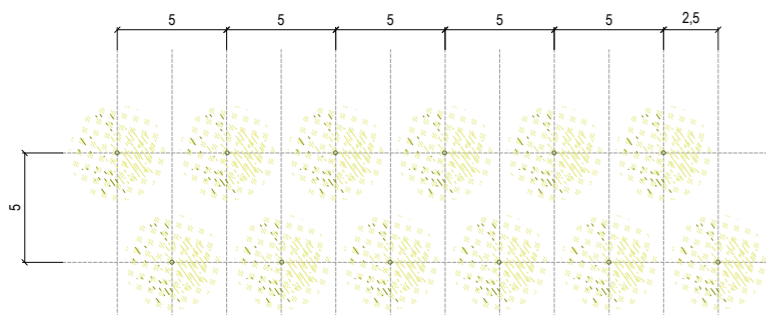
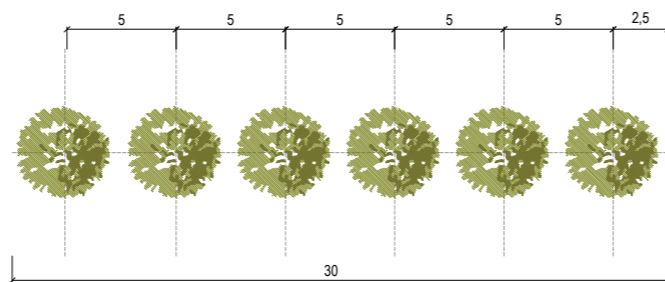
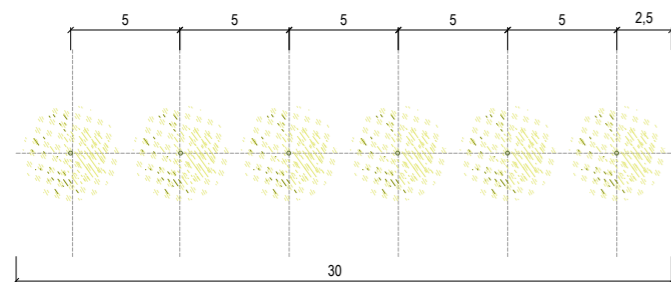

CONSOCIAZIONI VEGETALI	AMBITI					
	Agricolo	%		Urbano-periurbano	%	
		misto	puro		misto	puro
Quercu-carpinetu	<i>Salix alba</i>	0	100	<i>Carpinus betulus</i>	0	100
Alnetu di ontanu neru	<i>Alnus glutinosa</i>	0	100	<i>Alnus glutinosa</i>	0	100
SCHEDE TIPOLOGICO	<b>Dimensione:</b> lunghezza 30m, larghezza 5m					
	<b>Quantità e dimensioni d'impianto:</b> 6 alberi (h.175-250cm p.te forestali; circ. 10-12cm per alberi ornamentali)					
	<b>TOTALE</b> 6					



Salix alba



Carpinus betulus

# Filare singolo/doppio arboreo di II grandezza

Alneto di Ontano nero

PAESAGGIO AGRICOLO E PERIURBANO

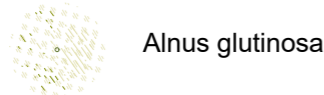
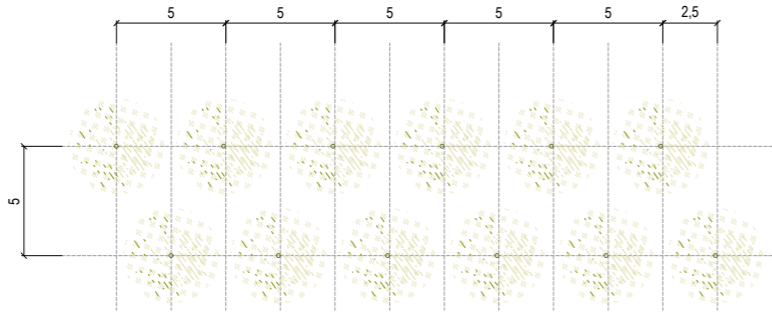
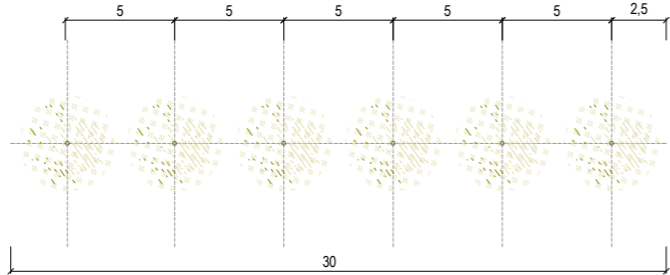

CONSOCIAZIONI VEGETALI	AMBITI					
	Agricolo	%		Urbano-periurbano	%	
		misto	puro		misto	puro
Quercu-carpineto	<i>Salix alba</i>	0	100	<i>Carpinus betulus</i>	0	100
Alneto di ontano nero	<i>Alnus glutinosa</i>	0	100	<i>Alnus glutinosa</i>	0	100
SCHEDA TIPOLOGICO	<b>Dimensione:</b> lunghezza 30m, larghezza 5m					
	<b>Quantità e dimensioni d'impianto:</b> 6 alberi (h.175-250cm p.te forestali; circ. 10-12cm per alberi ornamentali)					
	<b>TOTALE</b> 6					



Alnus glutinosa

# Filare singolo/doppio arboreo di III grandezza

Quercu - carpinetu

PAESAGGIO AGRICOLO

PAESAGGIO PERIURBANO

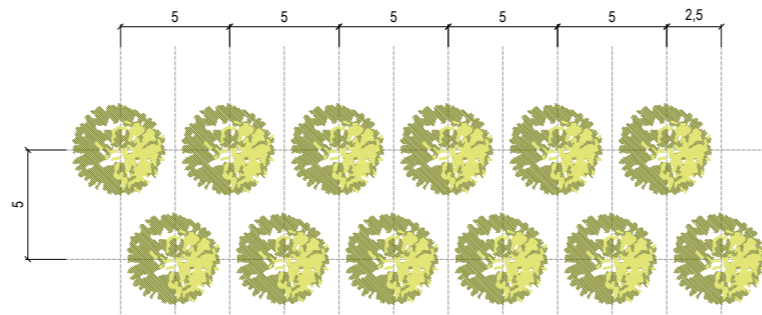
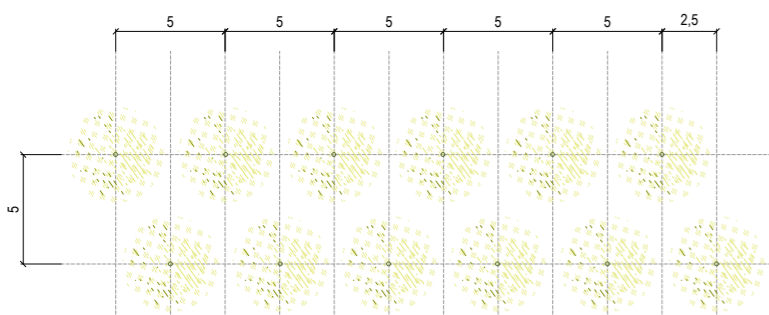
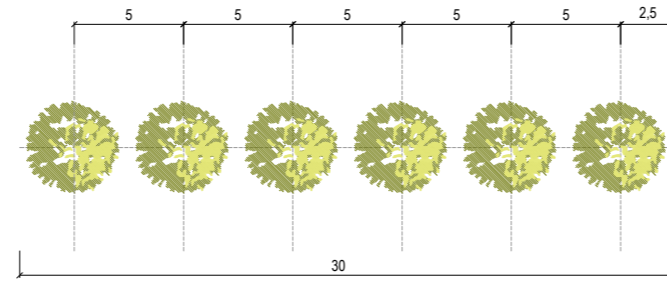
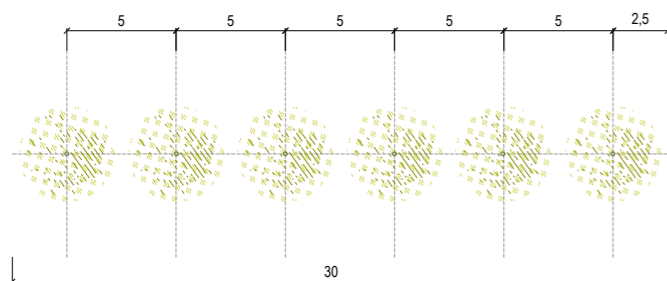

Morus alba

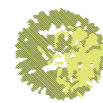

Acer campestre

CONSOCIAZIONI VEGETALI	AMBITI					
	Agricolo	%		Urbano-periurbano	%	
		misto	puro		misto	puro
Quercu-carpinetu	<i>Morus alba</i>	0	100	<i>Acer campestre</i>	0	100
Alnetu di ontanu neru	<i>Prunus padus</i>	0	100	<i>Prunus padus</i>	0	100
SCHEDE TIPOLOGICO	<b>Dimensione:</b> lunghezza 30m, larghezza 5m					
	<b>Quantità e dimensioni d'impianto:</b> 6 alberi (h.175-250cm p.te forestali; circ. 10-12cm per alberi ornamentali)					
	<b>TOTALE</b> 6					



Morus alba



Acer campestre

# Filare singolo/doppio arboreo di III grandezza

Alneto di Ontano nero

PAESAGGIO AGRICOLO E PERIURBANO

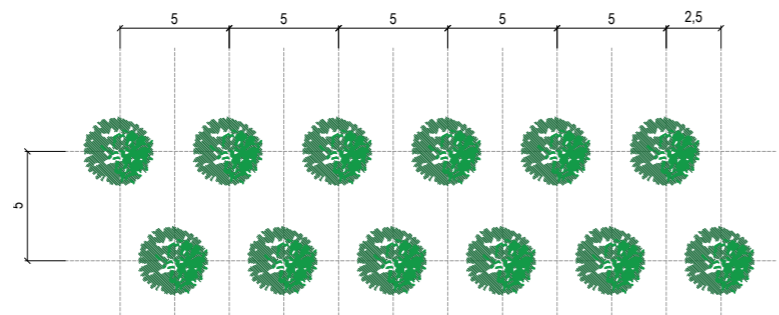
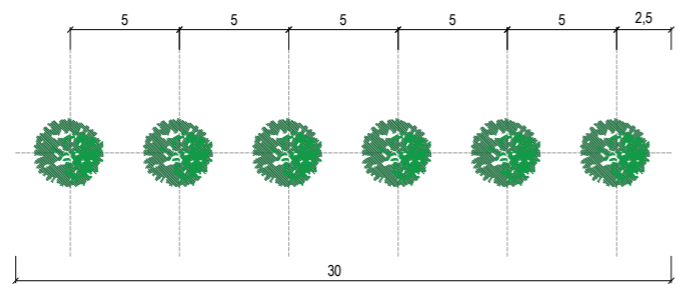

 Prunus padus

CONSOZIAZIONI VEGETALI	AMBITI					
	Agricolo	%		Urbano-periurbano	%	
		misto	puro		misto	puro
Quercio-carpineto	<i>Morus alba</i>	0	100	<i>Acer campestre</i>	0	100
Alneto di ontano nero	<i>Prunus padus</i>	0	100	<i>Prunus padus</i>	0	100
SCHEDA TIPOLOGICO	<b>Dimensione:</b> lunghezza 30m, larghezza 5m					
	<b>Quantità e dimensioni d'impianto:</b> 6 alberi (h.175-250cm p.te forestali; circ. 10-12cm per alberi ornamentali)					
	<b>TOTALE</b> 6					



Prunus padus

# Filare singolo/doppio plurispecifico

Quercu - carpinetu

PAESAGGIO AGRICOLO

PAESAGGIO PERIURBANO

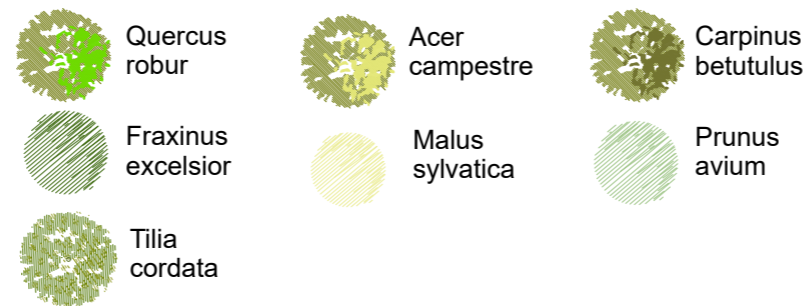
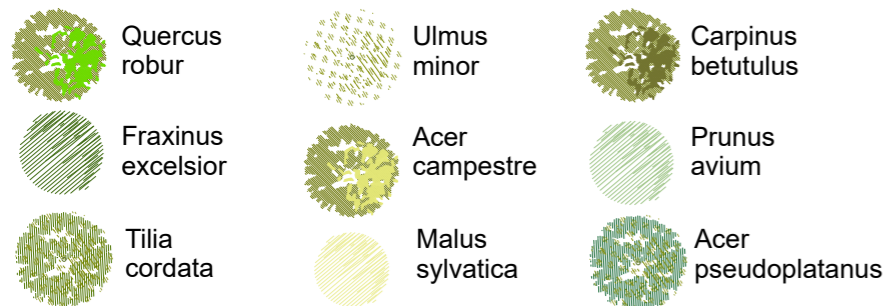
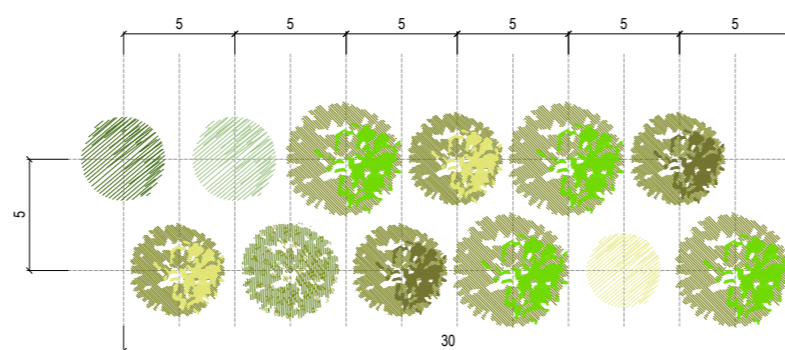
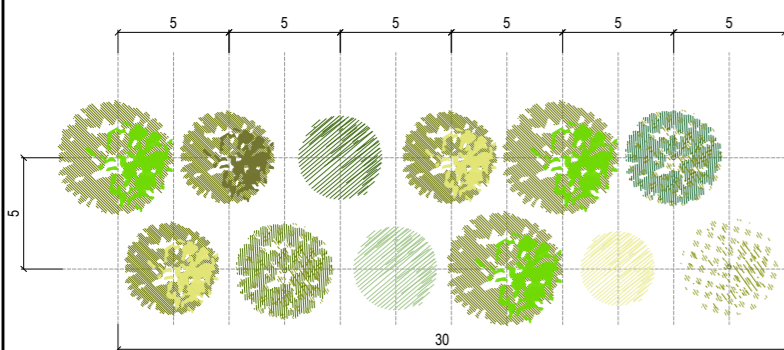
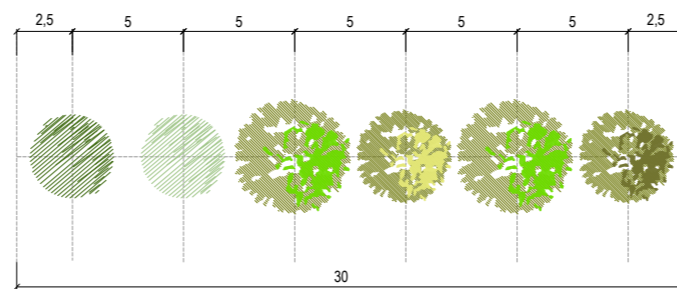
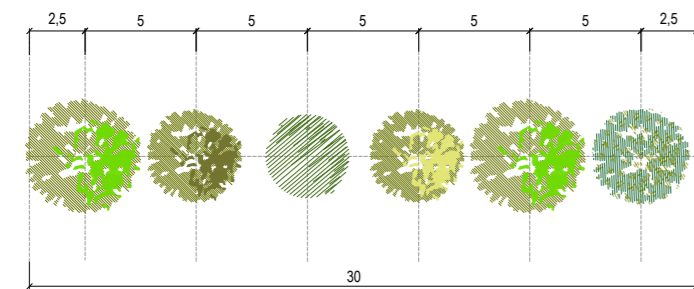

CONSOZIAZIONI VEGETALI	AMBITI								
	Agricolo	%		Urbano-periurbano	%		Naturalistico	%	
		misto	puro		misto	puro		misto	puro
Quercu-carpinetu	<i>Quercus robur</i>	20	0	<i>Quercus robur</i>	30	100	<i>Quercus robur</i>	20	0
	<i>Fraxinus excelsior</i>	10	0	<i>Fraxinus excelsior</i>	10	0	<i>Fraxinus excelsior</i>	5	0
	<i>Tilia cordata</i>	10	0	<i>Tilia cordata</i>	10	0	<i>Tilia cordata</i>	10	0
	<i>Ulmus minor</i>	10	0	<i>Acer campestre</i>	10	0	<i>Platanus x hybrida</i>	5	0
	<i>Acer campestre</i>	15	0	<i>Malus sylvatica</i>	5	0	<i>Quercus petrea</i>	5	0
	<i>Malus sylvatica</i>	10	0	<i>Carpinus betulus</i>	25	0	<i>Ulmus minor</i>	10	0
	<i>Carpinus betulus</i>	10	0	<i>Prunus avium</i>	10	0	<i>Carpinus betulus</i>	15	0
	<i>Prunus avium</i>	10	0			0	<i>Prunus avium</i>	5	0
	<i>Acer pseudoplatanus</i>	5	0			0	<i>Acer pseudoplatanus</i>	10	0
							<i>Betula pendula</i>	3	0
						<i>Acer campestre</i>	10	0	
						<i>Malus sylvatica</i>	2	0	
<b>TOTALE</b>		100	0	<b>TOTALE</b>	100	0	<b>TOTALE</b>	100	0

SCHEDA TIPOLOGICO	Dimensione:	lunghezza 30m, larghezza 5m
	Quantità e dimensioni d'impianto:	6 alberi (h.175-250cm per p.te forestali; circ. 10-12cm per alberi ornamentali)
	TOTALE	<b>6</b>



Fraxinus excelsior



Tilia cordata



Ulmus minor



Quercus robur



Acer campestre



Malus sylvatica



Carpinus betulus

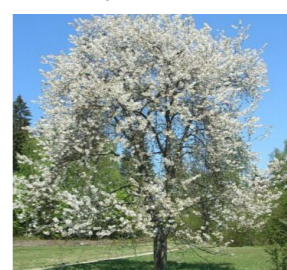

Prunus avium

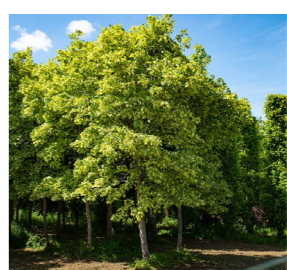

Acer pseudoplatanus



# Filare singolo/doppio plurispecifico

Quercu - carpinetu

PAESAGGIO NATURALISTICO

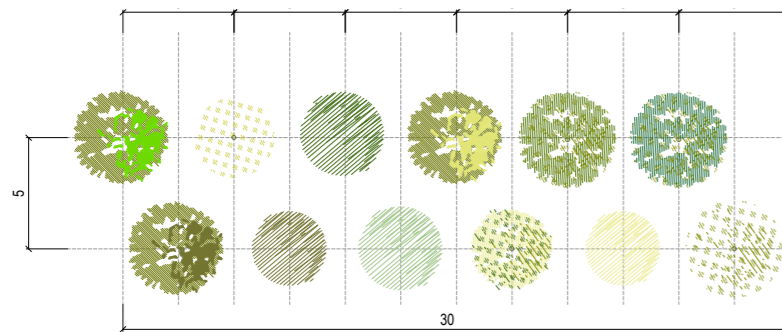
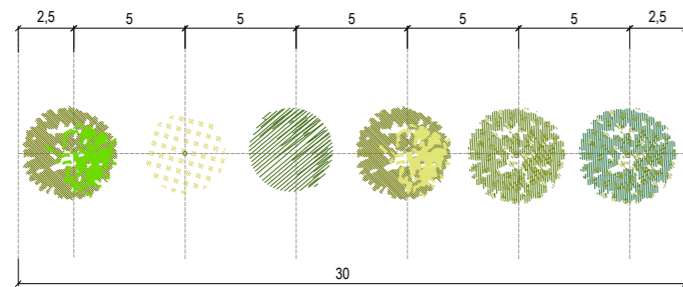

- Quercus robur**
- Fraxinus excelsior**
- Tilia cordata**
- Platanus x hybrida**
- Quercus petrea**
- Ulmus minor**
- Carpinus betulus**
- Acer pseudoplatanus**
- Prunus avium**
- Betula pendula**
- Acer campestre**
- Malus sylvatica**

CONSOCIAZIONI VEGETALI	AMBITI								
	Agricolo	%		Urbano-periurbano	%		Naturalistico		
		misto	puro		misto	puro	misto	puro	
Quercu-carpinetu	<i>Quercus robur</i>	20	0	<i>Quercus robur</i>	30	100	<i>Quercus robur</i>	20	0
	<i>Fraxinus excelsior</i>	10	0	<i>Fraxinus excelsior</i>	10	0	<i>Fraxinus excelsior</i>	5	0
	<i>Tilia cordata</i>	10	0	<i>Tilia cordata</i>	10	0	<i>Tilia cordata</i>	10	0
	<i>Ulmus minor</i>	10	0	<i>Acer campestre</i>	10	0	<i>Platanus x hybrida</i>	5	0
	<i>Acer campestre</i>	15	0	<i>Malus sylvatica</i>	5	0	<i>Quercus petrea</i>	5	0
	<i>Malus sylvatica</i>	10	0	<i>Carpinus betulus</i>	25	0	<i>Ulmus minor</i>	10	0
	<i>Carpinus betulus</i>	10	0	<i>Prunus avium</i>	10	0	<i>Carpinus betulus</i>	15	0
	<i>Prunus avium</i>	10	0			0	<i>Prunus avium</i>	5	0
	<i>Acer pseudoplatanus</i>	5	0			0	<i>Acer pseudoplatanus</i>	10	0
							<i>Betula pendula</i>	3	0
							<i>Acer campestre</i>	10	0
							<i>Malus sylvatica</i>	2	0
<b>TOTALE</b>		100	0	<b>TOTALE</b>	100	0	<b>TOTALE</b>	100	0

<b>SCHEDA TIPOLOGICO</b>	<b>Dimensione:</b>	lunghezza 30m, larghezza 5m
	<b>Quantità e dimensioni d'impianto:</b>	6 alberi (h.175-250cm per p.te forestali; circ. 10-12cm per alberi ornamentali)
	<b>TOTALE</b>	<b>6</b>

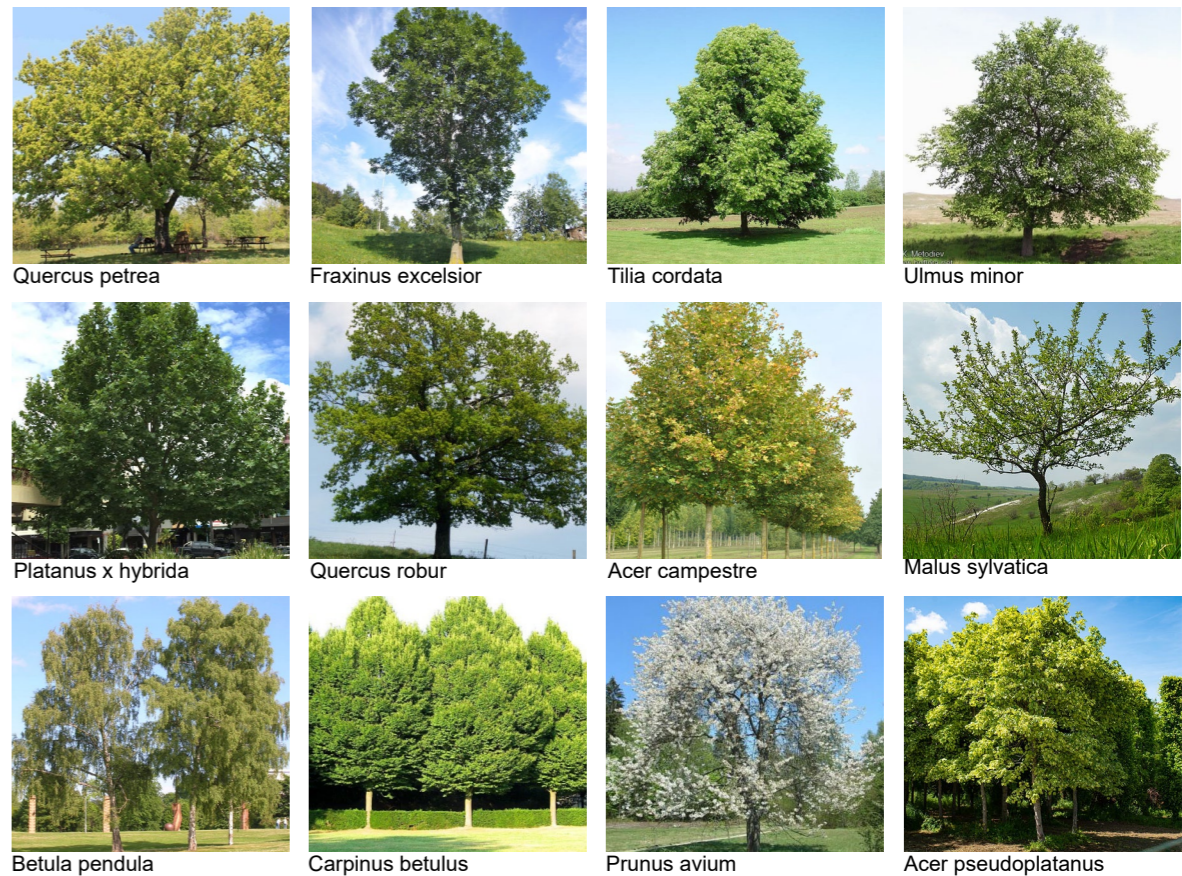

# Filare singolo/doppio plurispecifico

Alneto di Ontano nero

PAESAGGIO AGRICOLO - PERIURBANO

PAESAGGIO NATURALISTICO

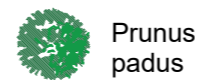
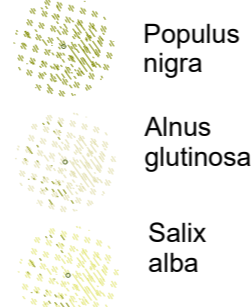
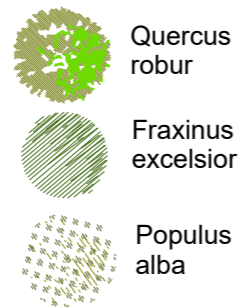
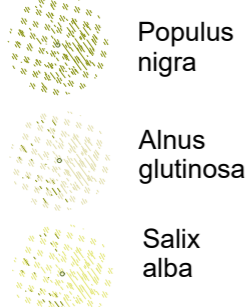
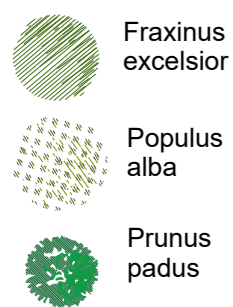
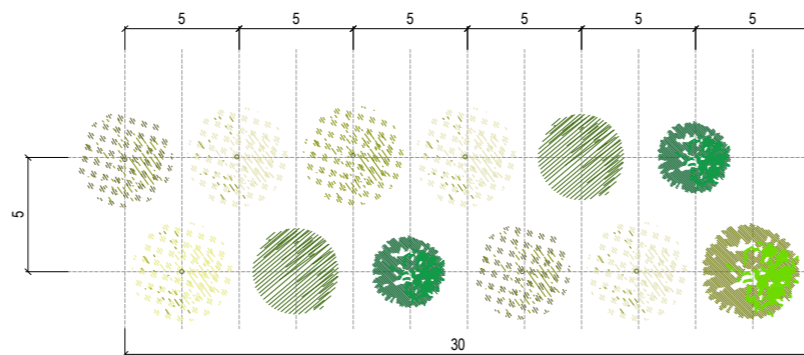
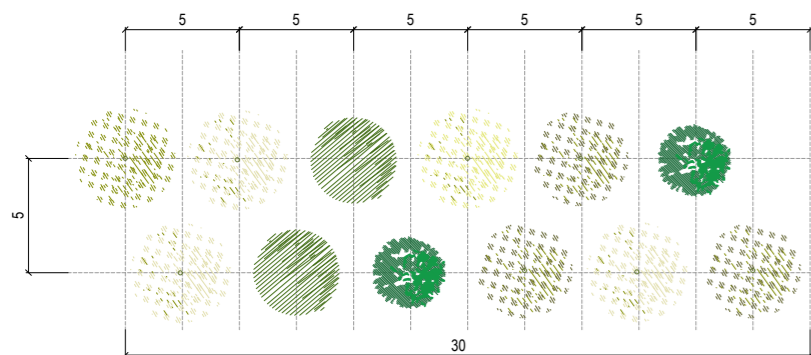
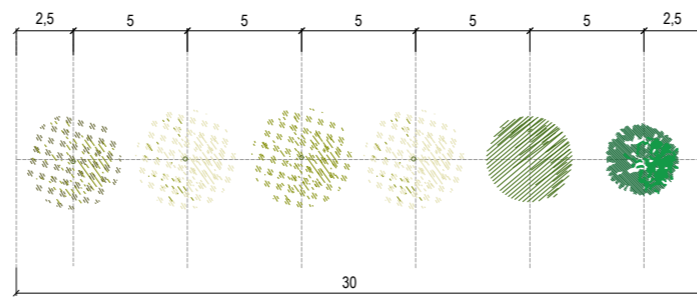
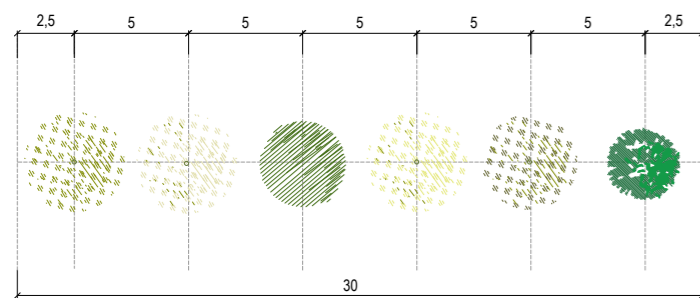

Alneto di ontano nero		Fraxinus excelsior	8	0	Fraxinus excelsior	8	0	Quercus robur	5	0
		Populus alba	17	0	Populus alba	17	0	Fraxinus excelsior	8	0
		Populus nigra	7	0	Populus nigra	7	0	Populus alba	15	0
		Alnus glutinosa	50	0	Alnus glutinosa	50	0	Populus nigra	6	0
		Salix alba	13	0	Salix alba	13	0	Alnus glutinosa	48	0
		Prunus padus	5	0	Prunus padus	5	0	Salix alba	13	0
								Prunus padus	5	0
		<b>TOTALE</b>	<b>100</b>	<b>0</b>	<b>TOTALE</b>	<b>0</b>	<b>100</b>	<b>TOTALE</b>	<b>100</b>	<b>0</b>

SCHEDA TIPOLOGICO		Dimensione:	lunghezza 30m, larghezza 5m
		Quantità e dimensioni d'impianto:	6 alberi (h.175-250cm per p.te forestali; circ. 10-12cm per alberi ornamentali)
		TOTALE	<b>6</b>



Fraxinus excelsior

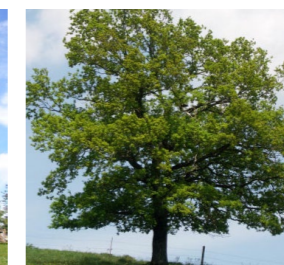

Quercus robur



Prunus padus



Populus alba



Populus nigra



Salix alba



Alnus glutinosa

# Fascia arboreo arbustiva di I grandezza

## Quercu - carpinetu

### PAESAGGIO AGRICOLU

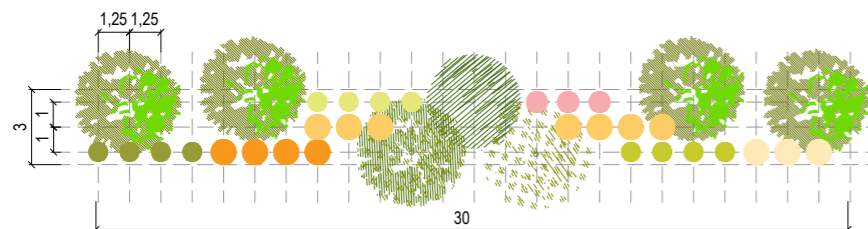

- Quercus robur
- Fraxinus excelsior
- Tilia cordata
- Ulmus minor
- Berberis vulgaris
- Ligustrum vulgare
- Euonymus europaeus
- Rosa rugosa
- Corylus avellana
- Crataegus monogyna
- Cornus mas

### PAESAGGIO PERIURBANU

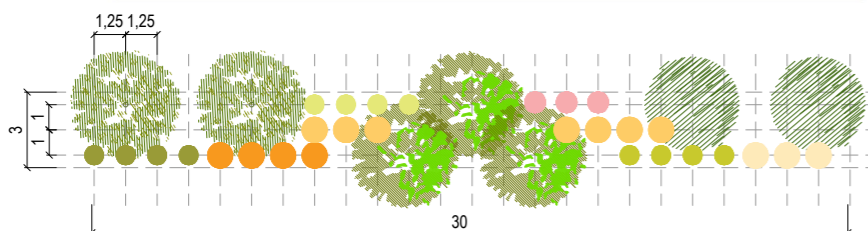

- Quercus robur
- Fraxinus excelsior
- Tilia cordata
- Berberis vulgaris
- Ligustrum vulgare
- Euonymus europaeus
- Rosa rugosa
- Corylus avellana
- Crataegus monogyna
- Cornus mas

CONSOCIAZIONI VEGETALI	Alberi I grandezza	%	Arbusti <3m	%	Arbusti >3m	%	
<b>AMBITO NATURALISTICO</b>							
Quercu-carpinetu	<i>Quercus robur</i>	55	<i>Berberis vulgaris</i>	15	<i>Corylus avellana</i>	19	
	<i>Fraxinus excelsior</i>	10	<i>Ligustrum vulgare</i>	15	<i>C. monogyna</i>	15	
	<i>Platanus x hybrida</i>	10	<i>E. europaeus</i>	12	<i>Cornus mas</i>	12	
	<i>Tilia cordata</i>	10	<i>Rosa rugosa</i>	12			
	<i>Ulmus minor</i>	10					
	<i>Quercus petraea</i>	5					
	<b>TOTALE</b>	<b>100</b>	<b>TOTALE</b>	<b>54</b>	<b>TOTALE</b>	<b>46</b>	
	<b>AMBITO AGRICOLU</b>						
	Quercu-carpinetu	<i>Quercus robur</i>	55	<i>Berberis vulgaris</i>	15	<i>Corylus avellana</i>	19
		<i>Fraxinus excelsior</i>	15	<i>Ligustrum vulgare</i>	15	<i>Cr. monogyna</i>	15
<i>Tilia cordata</i>		15	<i>E. europaeus</i>	12	<i>Cornus mas</i>	12	
<i>Ulmus minor</i>		15	<i>Rosa rugosa</i>	12			
<b>TOTALE</b>		<b>100</b>	<b>TOTALE</b>	<b>54</b>	<b>TOTALE</b>	<b>46</b>	
<b>AMBITO URBANO-PERIURBANU</b>							
Quercu-carpinetu	<i>Quercus robur</i>	55	<i>Berberis vulgaris</i>	15	<i>Corylus avellana</i>	19	
	<i>Tilia cordata</i>	25	<i>Ligustrum vulgare</i>	15	<i>C. monogyna</i>	15	
	<i>Fraxinus excelsior</i>	20	<i>E. europaeus</i>	12	<i>Cornus mas</i>	12	
			<i>Rosa rugosa</i>	12			
<b>TOTALE</b>	<b>100</b>	<b>TOTALE</b>	<b>54</b>	<b>TOTALE</b>	<b>46</b>		
<b>SCHEDA TIPOLOGICA</b>							
<b>Dimensione:</b>			90mq (3mX30m)				
<b>Quantità e dimensioni d'impianto:</b>			7 alberi (h.175-250cm)				
			29 arbusti (h.60-80cm)				
<b>TOTALE</b>			<b>36 (7 alberi e 29 arbusti)</b>				



Quercus robur



Fraxinus excelsior



Tilia cordata



Ulmus minor

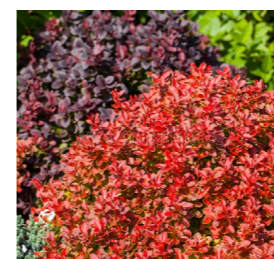

Berberis vulgaris



Ligustrum vulgare



Euonymus europaeus

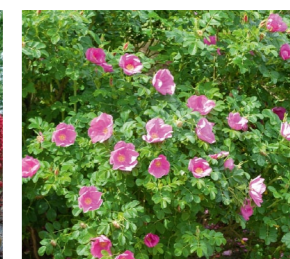

Rosa rugosa



Corylus avellana



Crataegus monogyna



Cornus mas

# Fascia arboreo arbustiva di I grandezza

Alneto di Ontano nero

PAESAGGIO AGRICOLO/PERIURBANO

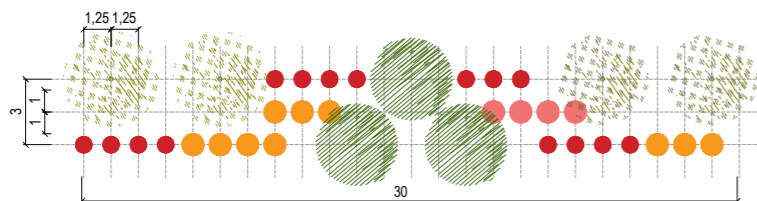

- Fraxinus excelsior
- Populus alba
- Populus nigra
- Cornus sanguinea
- Sambucus nigra
- Crataegus monogyna

		AMBITO NATURALISTICO				
	Fraxinus excelsior	50	Cornus sanguinea	40	Sambucus nigra	30
	Populus alba	20			C. monogyna	30
	Populus nigra	20				
	Quercus robur	10				
	<b>TOTALE</b>	<b>100</b>	<b>TOTALE</b>	<b>40</b>	<b>TOTALE</b>	<b>60</b>
		AMBITO AGRICOLO				
Alneto di ontano nero	Fraxinus excelsior	50	Cornus sanguinea	40	Sambucus nigra	20
	Populus alba	25			C. monogyna	40
	Populus nigra	25				
	<b>TOTALE</b>	<b>100</b>	<b>TOTALE</b>	<b>40</b>	<b>TOTALE</b>	<b>60</b>
		AMBITO URBANO-PERIURBANO				
SCHEDA TIPOLOGICO	Fraxinus excelsior	50	Cornus sanguinea	45	Sambucus nigra	10
	Populus alba	25			C. monogyna	45
	Populus nigra	25				
	<b>TOTALE</b>	<b>100</b>	<b>TOTALE</b>	<b>45</b>	<b>TOTALE</b>	<b>55</b>
<b>Dimensione:</b>		90mq (3mX30m)				
<b>Quantità e dimensioni d'impianto:</b>		7 alberi (h.175-250cm)				
		29 arbusti (h.60-80cm)				
<b>TOTALE</b>		<b>36 (7 alberi e 29 arbusti)</b>				

PAESAGGIO NATURALISTICO

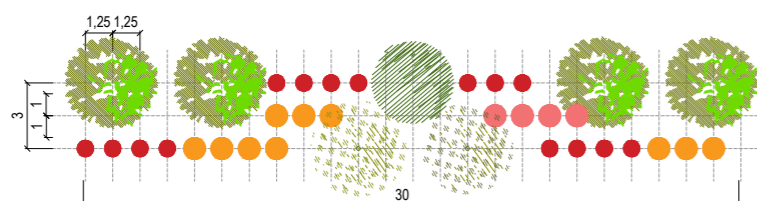

- Quercus robur
- Fraxinus excelsior
- Populus alba
- Populus nigra
- Cornus sanguinea
- Sambucus nigra
- Crataegus monogyna

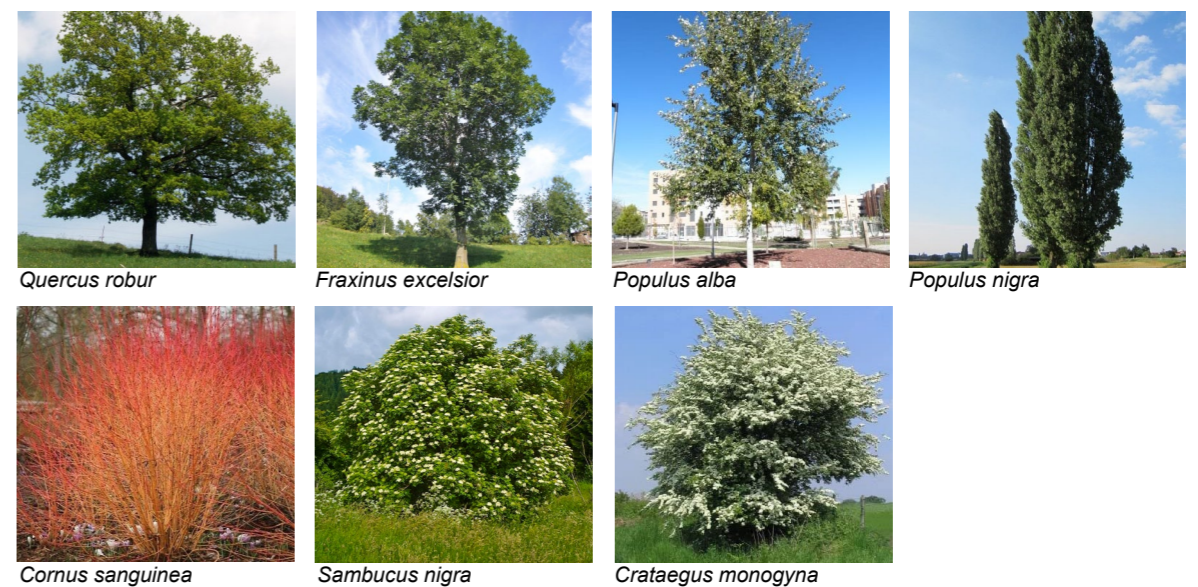

# Fascia arboreo arbustiva di II grandezza





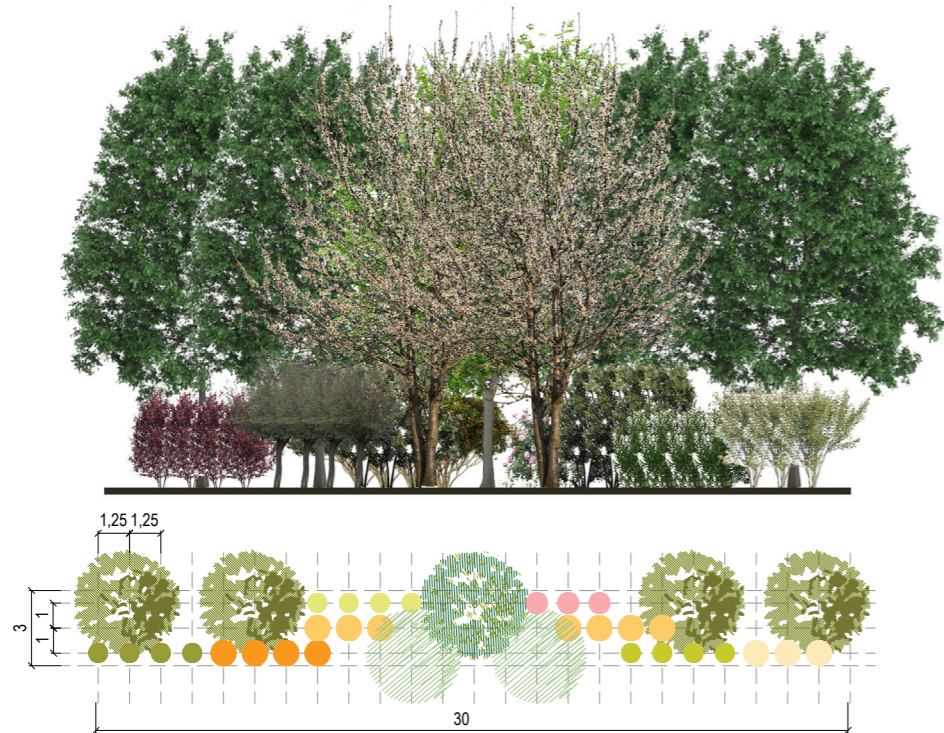



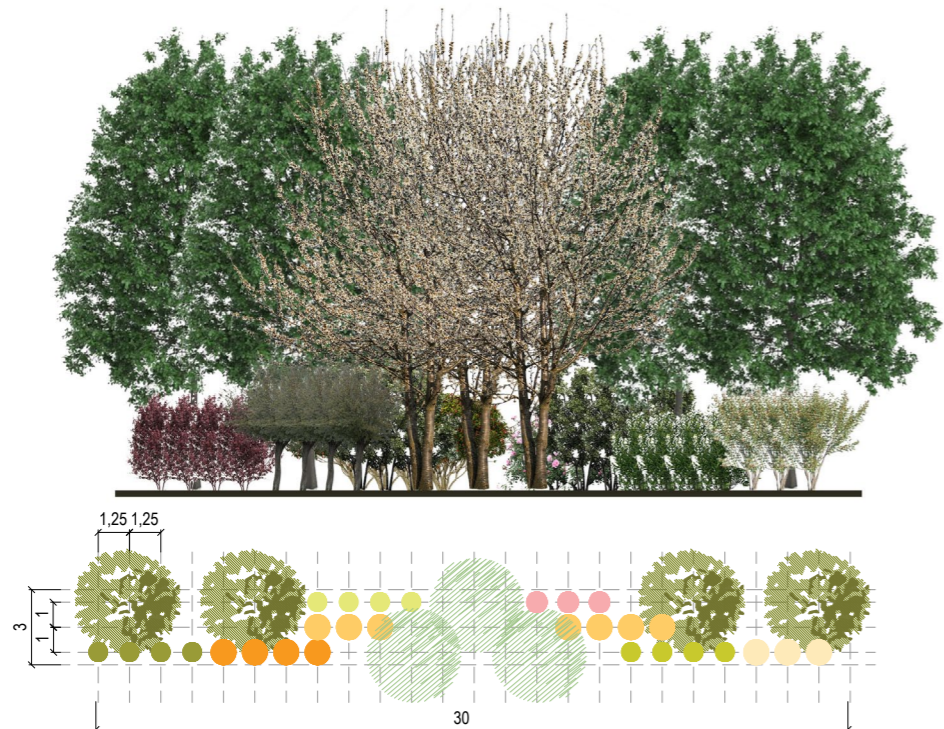

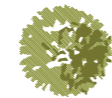
## Quercu - carpinetu

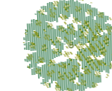
### PAESAGGIO AGRICOLU



### PAESAGGIU PERIURBANU



-  *Carpinus betulus*
-  *Prunus avium*
-  *Acer pseudoplatanus*
-  *Berberis vulgaris*
-  *Ligustrum vulgare*
-  *Euonymus europaeus*
-  *Rosa rugosa*
-  *Corylus avellana*
-  *Crataegus monogyna*
-  *Cornus mas*

-  *Carpinus betulus*
-  *Prunus avium*
-  *Berberis vulgaris*
-  *Ligustrum vulgare*
-  *Euonymus europaeus*
-  *Rosa rugosa*
-  *Corylus avellana*
-  *Crataegus monogyna*
-  *Cornus mas*

CONSOZIAZIONI VEGETALI	Alberi II grandezza	%	Arbusti <3m	%	Arbusti >3m	%
<b>AMBITO NATURALISTICO</b>						
<i>Carpinus betulus</i>	60		<i>Berberis vulgaris</i>	15	<i>Corylus avellana</i>	19
<i>Prunus avium</i>	17		<i>Ligustrum vulgare</i>	15	<i>C. monogyna</i>	15
<i>Acer pseudoplatanus</i>	13		<i>E. europaeus</i>	12	<i>Cornus mas</i>	12
<i>Betula pendula</i>	10		<i>Rosa rugosa</i>	12		
<b>TOTALE</b>	<b>100</b>		<b>TOTALE</b>	<b>54</b>	<b>TOTALE</b>	<b>46</b>
<b>AMBITO AGRICOLU</b>						
<i>Carpinus betulus</i>	60		<i>Berberis vulgaris</i>	15	<i>Corylus avellana</i>	19
<i>Prunus avium</i>	22		<i>Ligustrum vulgare</i>	15	<i>C. monogyna</i>	15
<i>Acer pseudoplatanus</i>	18		<i>E. europaeus</i>	12	<i>Cornus mas</i>	12
			<i>Rosa rugosa</i>	12		
<b>TOTALE</b>	<b>100</b>		<b>TOTALE</b>	<b>54</b>	<b>TOTALE</b>	<b>46</b>
<b>AMBITO URBANO-PERIURBANU</b>						
<i>Carpinus betulus</i>	60		<i>Berberis vulgaris</i>	28	<i>Corylus avellana</i>	50
<i>Prunus avium</i>	40		<i>Ligustrum vulgare</i>	28	<i>C. monogyna</i>	28
			<i>E. europaeus</i>	22	<i>Cornus mas</i>	22
			<i>Rosa rugosa</i>	22		
<b>TOTALE</b>	<b>100</b>		<b>TOTALE</b>	<b>100</b>	<b>TOTALE</b>	<b>100</b>
<b>SCHEDA TIPOLOGICA</b>	<b>Dimensione:</b> 90mq (3mX30m)					
	<b>Quantità e dimensioni d'impianto:</b> 7 alberi (h.175-250cm)					
	29 arbusti (h.60-80cm)					
<b>TOTALE</b>	<b>36 (7 alberi e 29 arbusti)</b>					



# Fascia arboreo arbustiva di II grandezza

Alneto di Ontano nero

PAESAGGIO AGRICOLO/PERIURBANO/NATURALISTICO

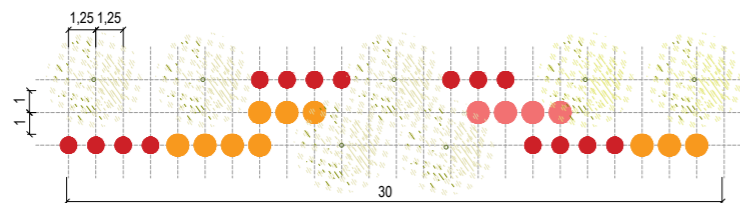

-  *Alnus glutinosa*
-  *Salix alba*
-  *Cornus sanguinea*
-  *Sambucus nigra*
-  *Crataegus monogyna*

	AMBITO NATURALISTICO					
	<i>Alnus glutinosa</i>	70	<i>Cornus sanguinea</i>	40	<i>Sambucus nigra</i>	30
<i>Salix alba</i>	30			<i>C. monogyna</i>	30	
<b>TOTALE</b>	<b>100</b>	<b>TOTALE</b>	<b>40</b>	<b>TOTALE</b>	<b>60</b>	
	AMBITO AGRICOLO					
	<i>Alnus glutinosa</i>	70	<i>Cornus sanguinea</i>	40	<i>Sambucus nigra</i>	20
<i>Salix alba</i>	30			<i>C. monogyna</i>	40	
<b>TOTALE</b>	<b>100</b>	<b>TOTALE</b>	<b>40</b>	<b>TOTALE</b>	<b>60</b>	
	AMBITO URBANO-PERIURBANO					
	<i>Alnus glutinosa</i>	70	<i>Cornus sanguinea</i>	45	<i>Sambucus nigra</i>	10
<i>Salix alba</i>	30			<i>C. monogyna</i>	45	
<b>TOTALE</b>	<b>100</b>	<b>TOTALE</b>	<b>45</b>	<b>TOTALE</b>	<b>55</b>	
SCHEMA TIPOLOGICO	<b>Dimensione:</b> 90mq (3mX30m)					
	<b>Quantità e dimensioni d'impianto:</b> 7 alberi (h.175-250cm)					
	29 arbusti (h.60-80cm)					
<b>TOTALE</b>	<b>36 (7 alberi e 29 arbusti)</b>					

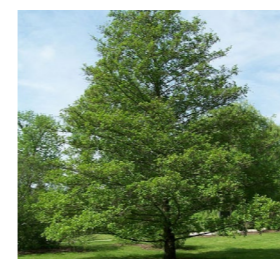

*Alnus glutinosa*



*Salix alba*



*Cornus sanguinea*

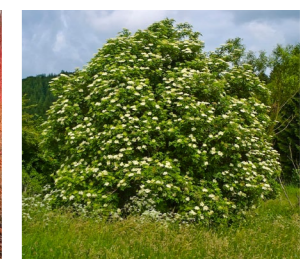

*Sambucus nigra*



*Crataegus monogyna*

# Fascia arboreo arbustiva di III grandezza

Quercu - carpineto

PAESAGGIO AGRICOLO/PERIURBANO

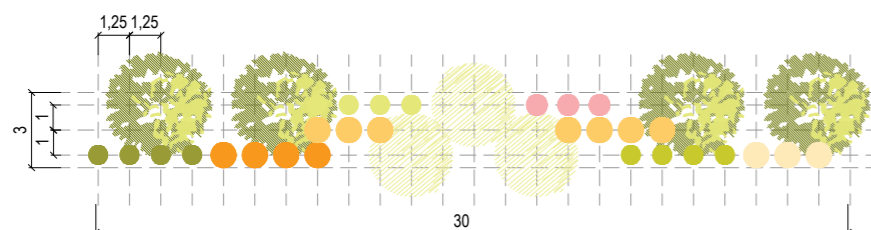

-  Acer campestre
-  Malus sylvatica
-  Berberis vulgaris
-  Ligustrum vulgare
-  Euonymus europaeus
-  Rosa rugosa
-  Corylus avellana
-  Crataegus monogyna
-  Cornus mas

CONSOCIAZIONI VEGETALI	Alberi III grandezza	%	Arbusti <3m	%	Arbusti >3m	%
Quercu-carpineto	<b>AMBITO NATURALISTICO</b>					
	<i>Acer campestre</i>	60	<i>Berberis vulgaris</i>	15	<i>Corylus avellana</i>	19
	<i>Malus sylvatica</i>	40	<i>Ligustrum vulgare</i>	15	<i>C. monogyna</i>	15
			<i>Rosa rugosa</i>	12	<i>Cornus mas</i>	12
			<i>E. europaeus</i>	12		
	<b>TOTALE</b>	<b>100</b>	<b>TOTALE</b>	<b>54</b>	<b>TOTALE</b>	<b>46</b>
	<b>AMBITO AGRICOLO</b>					
	<i>Acer campestre</i>	60	<i>Berberis vulgaris</i>	15	<i>Corylus avellana</i>	19
	<i>Malus sylvatica</i>	40	<i>Ligustrum vulgare</i>	15	<i>C. monogyna</i>	15
			<i>Rosa rugosa</i>	12	<i>Cornus mas</i>	12
			<i>E. europaeus</i>	12		
	<b>TOTALE</b>	<b>100</b>	<b>TOTALE</b>	<b>54</b>	<b>TOTALE</b>	<b>46</b>
<b>AMBITO URBANO-PERIURBANO</b>						
<i>Acer campestre</i>	60	<i>Berberis vulgaris</i>	15	<i>Corylus avellana</i>	19	
<i>Malus sylvatica</i>	40	<i>Ligustrum vulgare</i>	15	<i>C. monogyna</i>	15	
		<i>Rosa rugosa</i>	12	<i>Cornus mas</i>	12	
		<i>E. europaeus</i>	12			
<b>TOTALE</b>	<b>100</b>	<b>TOTALE</b>	<b>54</b>	<b>TOTALE</b>	<b>46</b>	
SCHEDA TIPOLOGICO	<b>Dimensione:</b>		90mq (3mX30m)			
	<b>Quantità e dimensioni d'impianto:</b>		7 alberi (h.175-250cm) 29 arbusti (h.60-80cm)			
	<b>TOTALE</b>		<b>36 (7 alberi e 29 arbusti)</b>			

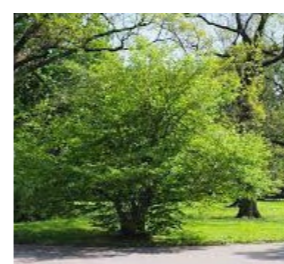

*Corylus avellana*



*Acer campestre*

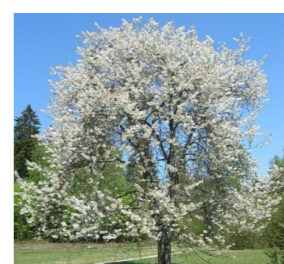

*Malus sylvatica*

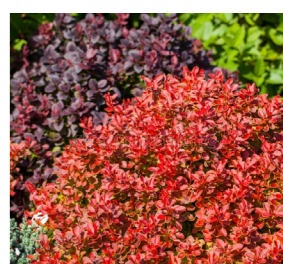

*Berberis vulgaris*



*Crataegus monogyna*



*Ligustrum vulgare*



*Euonymus europaeus*



*Rosa rugosa*



*Cornus mas*

# Fascia arboreo arbustiva di III grandezza

## Alneto di Ontano nero

PAESAGGIO AGRICOLO/PERIURBANO/NATURALISTICO

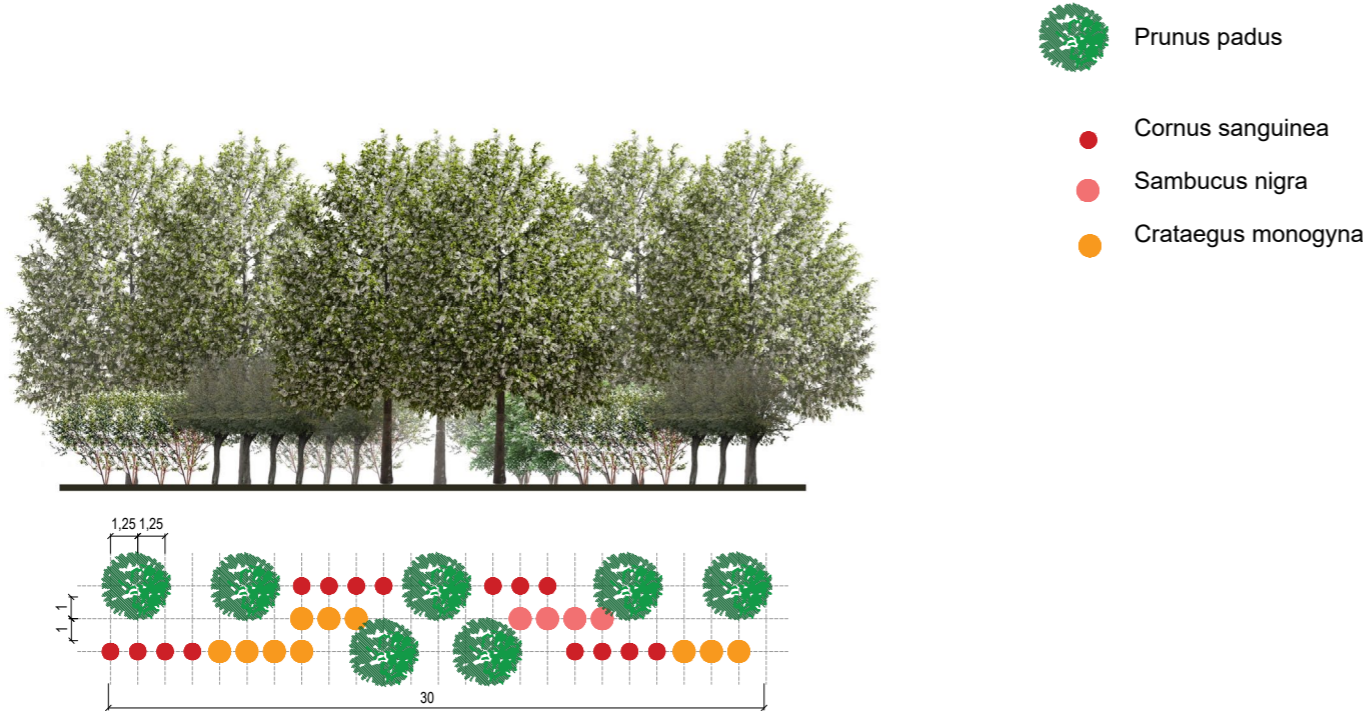

	AMBITO NATURALISTICO					
	<i>Prunus padus</i>	100	<i>Cornus sanguinea</i>	40	<i>Sambucus nigra</i>	30
				<i>C. monogyna</i>	30	
<b>TOTALE</b>	<b>100</b>	<b>TOTALE</b>	<b>40</b>	<b>TOTALE</b>	<b>60</b>	
	AMBITO AGRICOLO					
	<i>Prunus padus</i>	100	<i>Cornus sanguinea</i>	40	<i>Sambucus nigra</i>	20
				<i>C. monogyna</i>	40	
<b>TOTALE</b>	<b>100</b>	<b>TOTALE</b>	<b>40</b>	<b>TOTALE</b>	<b>60</b>	
	AMBITO URBANO-PERIURBANO					
	<i>Prunus padus</i>	100	<i>Cornus sanguinea</i>	45	<i>Sambucus nigra</i>	10
				<i>C. monogyna</i>	45	
<b>TOTALE</b>	<b>100</b>	<b>TOTALE</b>	<b>45</b>	<b>TOTALE</b>	<b>55</b>	
SCHEDA TIPOLOGICO	<b>Dimensione:</b>		90mq (3mX30m)			
	<b>Quantità e dimensioni d'impianto:</b>		7 alberi (h.175-250cm) 29 arbusti (h.60-80cm)			
	<b>TOTALE</b>		<b>36 (7 alberi e 29 arbusti)</b>			



*Cornus sanguinea*



*Prunus padus*



*Crataegus monogyna*



*Sambucus nigra*



# Fascia arbustiva di arbusti h<3m

## Quercu - carpineto

ARBUSTI H<3m

- Berberis vulgaris
- Ligustrum vulgare
- Euonymus europaeus
- Rosa rugosa

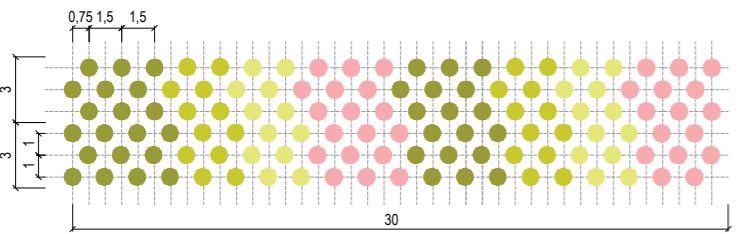
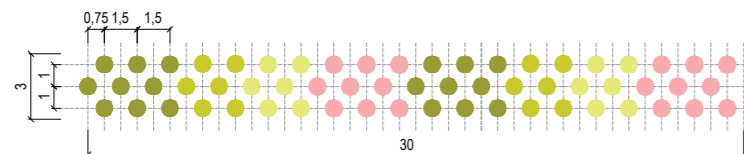

## Alneto di Ontano nero

ARBUSTI H<3m

- Cornus sanguinea

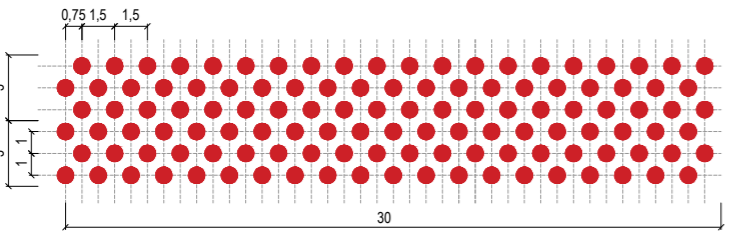
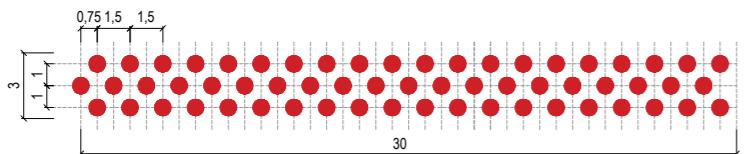

CONSOCIAZIONI VEGETALI	AMBITO					
	Naturalistico		Agricolo		Urbano-periurbano	
		%		%		%
Quercu-carpineto	<i>Berberis vulgaris</i>	28	<i>Berberis vulgaris</i>	28	<i>Berberis vulgaris</i>	28
	<i>Ligustrum vulgare</i>	22	<i>Ligustrum vulgare</i>	22	<i>Ligustrum vulgare</i>	22
	<i>E. europaeus</i>	22	<i>E. europaeus</i>	22	<i>E. europaeus</i>	22
	<i>Rosa rugosa</i>	28	<i>Rosa canina</i>	28	<i>Rosa rugosa</i>	28
	<b>TOTALE</b>	<b>100</b>	<b>TOTALE</b>	<b>100</b>	<b>TOTALE</b>	<b>100</b>
Alneto di ontano nero	<i>Cornus sanguinea</i>	100	<i>Cornus sanguinea</i>	100	<i>Cornus sanguinea</i>	100
	<b>TOTALE</b>	<b>100</b>	<b>TOTALE</b>	<b>100</b>	<b>TOTALE</b>	<b>100</b>
SCHEDA TIPOLOGICO	Dimensione:					90mq (3mX30m)
	Quantità e dimensioni d'impianto:					60 arbusti (h.60-80cm)
	<b>TOTALE</b>					<b>60</b>



Barberis vulgaris



Ligustrum vulgare



Euonymus europaeus



Rosa rugosa



Cornus sanguinea

# Fascia arbustiva di arbusti h>3m

## Quercu - carpinetu

ARBUSTI H>3m

- Corylus avellana
- Crataegus monogyna
- Cornus mas

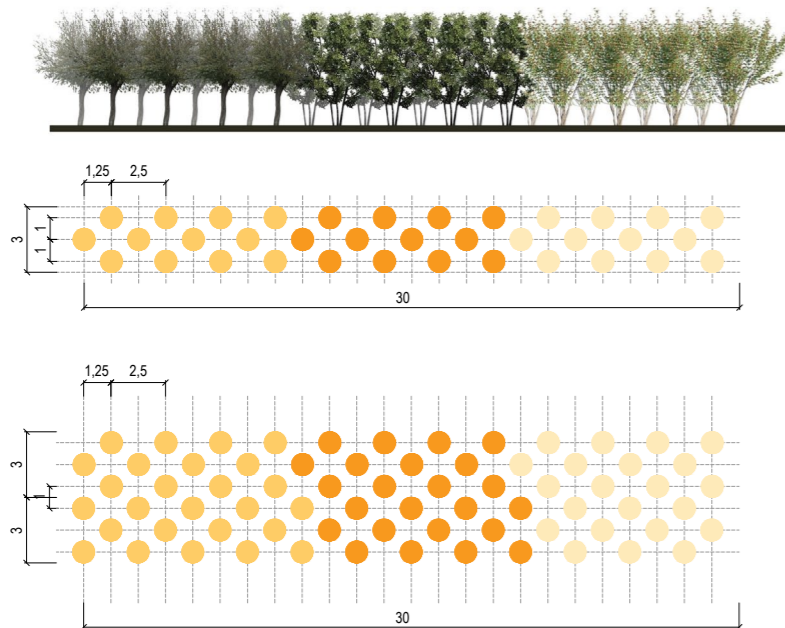

CONSOCIAZIONI VEGETALI	AMBITO					
	Naturalistico		Agricolo		Urbano-periurbano	
		%		%		%
Quercu-carpinetu	<i>Corylus avellana</i>	40	<i>Corylus avellana</i>	40	<i>Corylus avellana</i>	40
	<i>C. monogyna</i>	30	<i>C. monogyna</i>	30	<i>C. monogyna</i>	30
	<i>Cornus mas</i>	30	<i>Cornus mas</i>	30	<i>Cornus mas</i>	30
	<b>TOTALE</b>	<b>100</b>	<b>TOTALE</b>	<b>100</b>	<b>TOTALE</b>	<b>100</b>
Alneto di ontano nero	<i>Sambucus nigra</i>	40	<i>Sambucus nigra</i>	40	<i>Sambucus nigra</i>	40
	<i>C. monogyna</i>	60	<i>C. monogyna</i>	60	<i>C. monogyna</i>	60
	<b>TOTALE</b>	<b>100</b>	<b>TOTALE</b>	<b>100</b>	<b>TOTALE</b>	<b>100</b>
SCHEDE TIPOLOGICO	<b>Dimensione:</b>					<b>90mq (3mX30m)</b>
	<b>Quantità e dimensioni d'impianto:</b>					<b>36 arbusti (h.60-80cm)</b>
	<b>TOTALE</b>					<b>36</b>

## Alneto di Ontano nero

ARBUSTI H>3m

- Sambucus nigra
- Crataegus monogyna

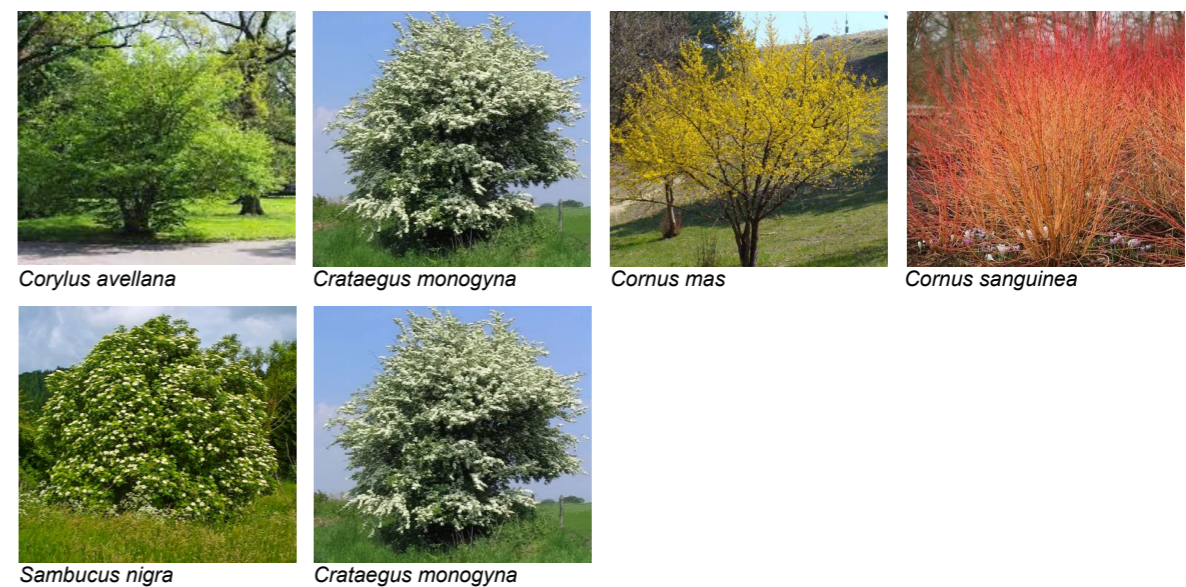
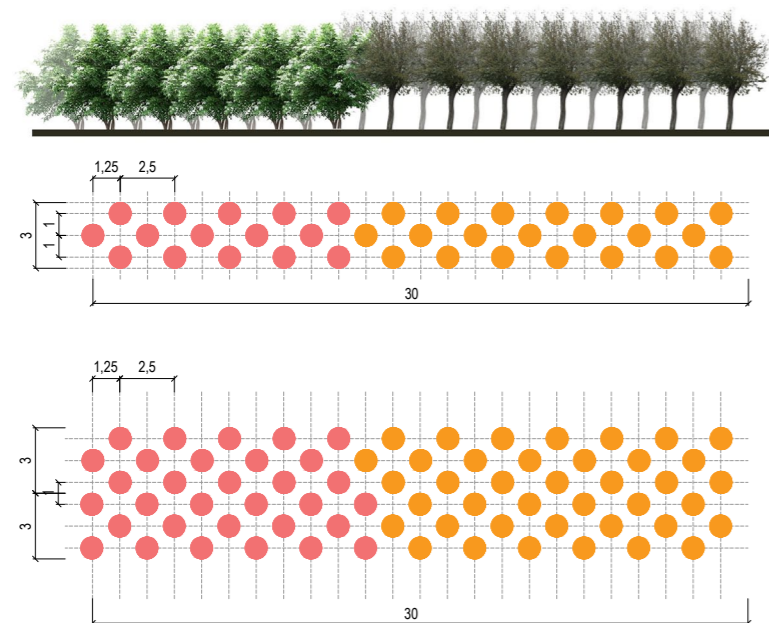

# Fascia arbustiva mista

## Quercio - carpineto

ARBUSTI MISTI

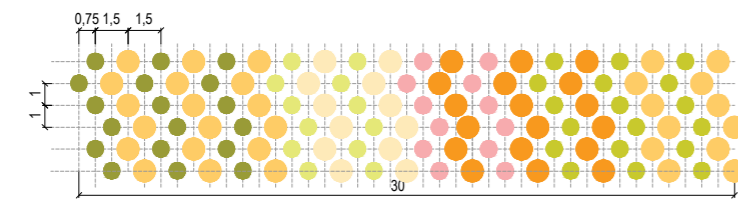
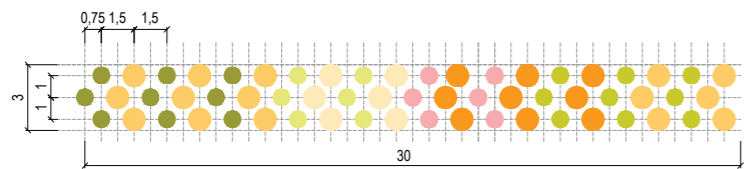

- Berberis vulgaris
- Ligustrum vulgare
- Euonymus europaeus
- Rosa canina
- Corylus avellana
- Crataegus monogyna
- Cornus mas

## Alneto di Ontano nero

ARBUSTI MISTI

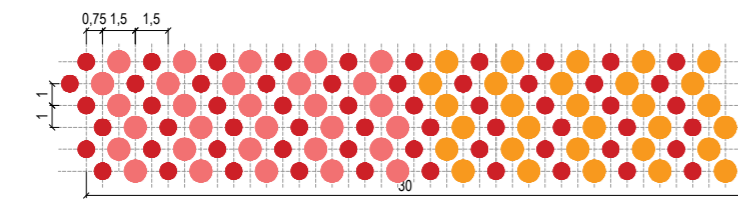
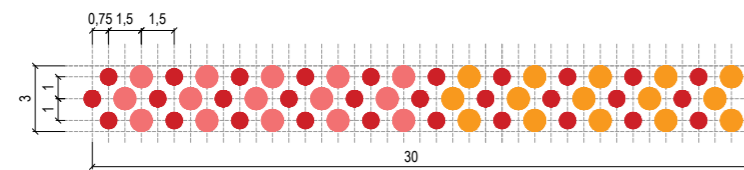

- Cornus sanguinea
- Sambucus nigra
- Crataegus monogyna

CONSOCIAZIONI VEGETALI	AMBITO					
	Naturalistico	%	Agricolo	%	Urbano-periurbano	%
Quercio-carpineto	<i>Berberis vulgaris</i>	28	<i>Berberis vulgaris</i>	28	<i>Berberis vulgaris</i>	28
	<i>Ligustrum vulgare</i>	22	<i>Ligustrum vulgare</i>	22	<i>Ligustrum vulgare</i>	22
	<i>E. europaeus</i>	22	<i>E. europaeus</i>	22	<i>E. europaeus</i>	22
	<i>Rosa rugosa</i>	28	<i>Rosa rugosa</i>	28	<i>Rosa rugosa</i>	28
	<i>Corylus avellana</i>	19	<i>Corylus avellana</i>	19	<i>Corylus avellana</i>	19
	<i>Crataegus monogyna</i>	15	<i>Crataegus monogyna</i>	15	<i>Crataegus monogyna</i>	15
	<i>Cornus mas</i>	12	<i>Cornus mas</i>	12	<i>Cornus mas</i>	12
	<b>TOTALE</b>	<b>100</b>	<b>TOTALE</b>	<b>100</b>	<b>TOTALE</b>	<b>100</b>
	Alneto di ontano nero	<i>Cornus sanguinea</i>	40	<i>Cornus sanguinea</i>	40	<i>Cornus sanguinea</i>
<i>Sambucus nigra</i>		30	<i>Sambucus nigra</i>	30	<i>Sambucus nigra</i>	30
<i>Crataegus monogyna</i>		30	<i>Crataegus monogyna</i>	30	<i>Crataegus monogyna</i>	30
<b>TOTALE</b>		<b>100</b>	<b>TOTALE</b>	<b>100</b>	<b>TOTALE</b>	<b>100</b>
SCHEDA TIPOLOGICO	<b>Dimensione:</b>					<b>90mq (3mX30m)</b>
	<b>Quantità e dimensioni d'impianto:</b>					<b>60 arbusti (h.60-80cm)</b>
	<b>TOTALE</b>					<b>60</b>



# Fascia arbustiva ornamentale

## Quercio - carpineto

ARBUSTI MISTI

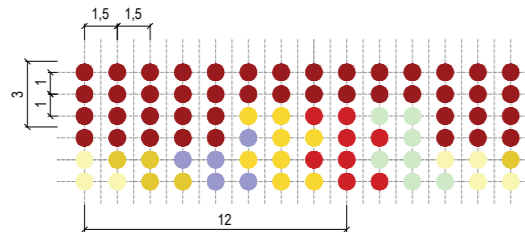
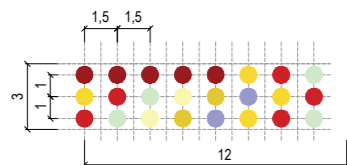

- Spartium junceum
- Cornus sanguinea
- Eleagnus x ebbingei
- Spirea x vanhouttei
- Forsitia x intermedia
- Viburnum opulus
- Cotynus coggira

CONSOCIAZIONI VEGETALI	Dimensioni	
	Arbusti <2m	Arbusti >2m
Fascia ornamentale	<i>Spartium junceum</i>	<i>Cotinus coggira</i>
	<i>Cornus sanguinea</i>	
	<i>Eleagnus x ebbingei</i>	
	<i>Spirea x vanhouttei</i>	
	<i>Forsythia x intermedia</i>	
	<i>Viburnum opulus</i>	
SCHEDA TIPOLOGICO	<b>Dimensione:</b>	<b>36mq (12mX3m)</b>
	<b>Quantità e dimensioni d'impianto:</b>	<b>24 arbusti (vaso diam 15cm)</b>
	<b>TOTALE</b>	<b>24</b>



*Spartium junceum*



*Cornus sanguinea*



*Eleagnus x ebbingei*



*Spirea x vanhouttei*



*Cotynus coggira*



*Forsitia x intermedia*



*Viburnum opulus*

## Alneto di Ontano nero

ARBUSTI MISTI

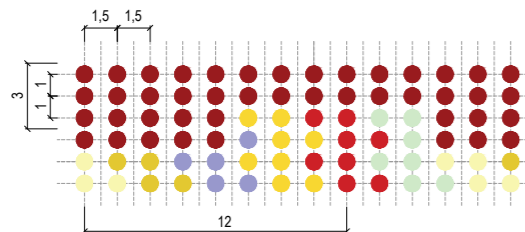
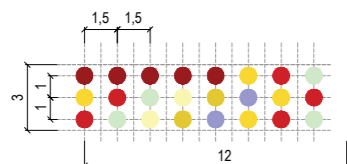





- Spartium junceum
- Cornus sanguinea
- Eleagnus x ebbingei
- Spirea x vanhouttei
- Forsitia x intermedia
- Viburnum opulus
- Cotynus coggira

# Macchia arboreo arbustivo di interesse faunistico

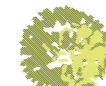
## Quercu - carpinetu





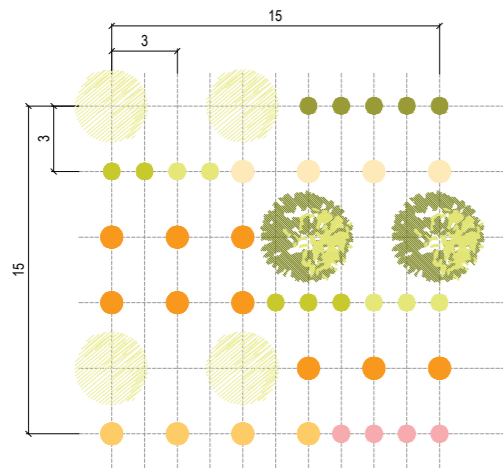

-  *Acer campestre*
-  *Malus sylvatica*
-  *Berberis vulgaris*
-  *Ligustrum vulgare*
-  *Euonymus europaeus*
-  *Rosa rugosa*
-  *Corylus avellana*
-  *Crataegus monogyna*
-  *Cornus mas*



CONSOCIAZIONI VEGETALI	Alberi III grandezza	%	Arbusti <3m	%	Arbusti <3m	%
Quercu-carpinetu	<i>Acer campestre</i>	40	<i>Berberis vulgaris</i>	15	<i>Corylus avellana</i>	10
	<i>Malus sylvatica</i>	60	<i>Ligustrum vulgare</i>	15	<i>Crataegus monogyna</i>	20
			<i>E. europaeus</i>	15	<i>Cornus mas</i>	10
			<i>Rosa rugosa</i>	15		
<b>TOTALE</b>	<b>100</b>	<b>TOTALE</b>	<b>60</b>	<b>TOTALE</b>	<b>40</b>	
Alneto di ontano nero	<i>Prunus padus</i>	100	<i>Cornus sanguinea</i>	40	<i>Sambucus nigra</i>	25
					<i>C. monogyna</i>	35
	<b>TOTALE</b>	<b>100</b>	<b>TOTALE</b>	<b>40</b>	<b>TOTALE</b>	<b>60</b>
<b>SCHEDA TIPOLOGICO</b>	<b>Dimensione:</b>		<b>225mq (15mX15m)</b>			
			<b>6 alberi (h.150-175cm)</b>			
	<b>Quantità e dimensioni d'impianto:</b>		<b>34 arbusti (h.60-80cm)</b>			
	<b>TOTALE</b>		<b>40 (6 alberi e 34 arbusti)</b>			

## Alneto di Ontano nero



-  *Prunus padus*
-  *Cornus sanguinea*
-  *Sambucus nigra*
-  *Crataegus monogyna*

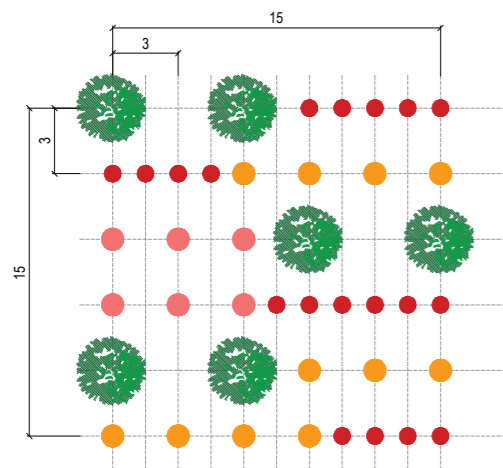

*Acer campestre*



*Malus sylvatica*



*Prunus padus*

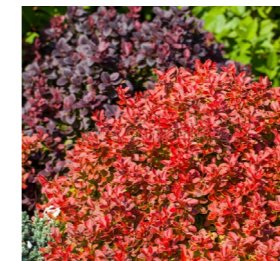

*Berberis vulgaris*



*Ligustrum vulgare*



*Euonymus europaeus*

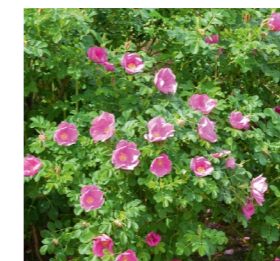

*Rosa rugosa*



*Corylus avellana*



*Crataegus monogyna*



*Crataegus monogyna*



*Cornus mas*



*Cornus sanguinea*









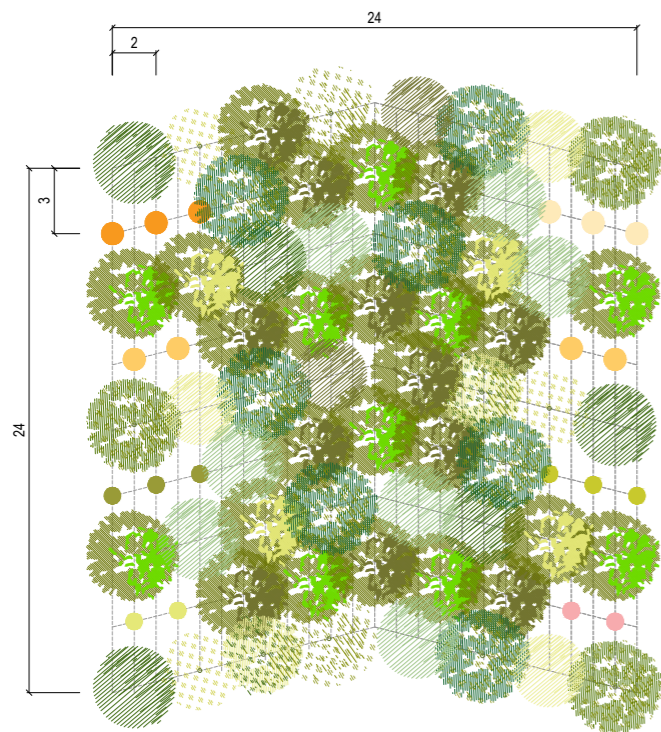

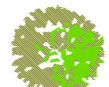

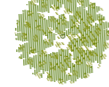
*Sambucus nigra*

Bosco

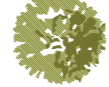
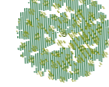
Quercio - carpineto

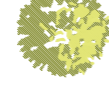

-  *Quercus robur*
-  *Fraxinus excelsior*
-  *Tilia cordata*
-  *Platanus x hybrida*
-  *Quercus petrea*
-  *Ulmus minor*
-  *Carpinus betulus*
-  *Acer pseudoplatanus*
-  *Prunus avium*
-  *Betula pendula*
-  *Acer campestre*
-  *Malus sylvatica*
- Berberis vulgaris*
- Ligustrum vulgare*
- Euonymus europaeus*
- Rosa canina*
- Corylus avellana*
- Crataegus monogyna*
- Cornus mas*



*Quercus robur*



*Fraxinus excelsior*



*Tilia cordata*



*Ulmus minor*



*Platanus x hybrida*



*Quercus petrea*

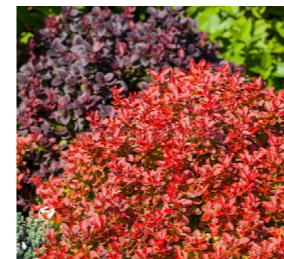

*Berberis vulgaris*



*Ligustrum vulgare*



*Euonymus europaeus*



*Ulmus minor*



*Carpinus betulus*



*Corylus avellana*



*Crataegus monogyna*



*Cornus mas*



*Prunus avium*



*Acer pseudoplatanus*



*Rosa canina*



*Betula pendula*



*Acer campestre*



*Malus sylvatica*

# Bosco

## Alneto di Ontano nero



-  *Quercus robur*
-  *Fraxinus excelsior*
-  *Populus alba*
-  *Populus nigra*
-  *Alnus glutinosa*
-  *Salix alba*
-  *Prunus pad*
-  *Cornus sanguinea*
-  *Sambucus nigra*
-  *Crataegus monogyna*

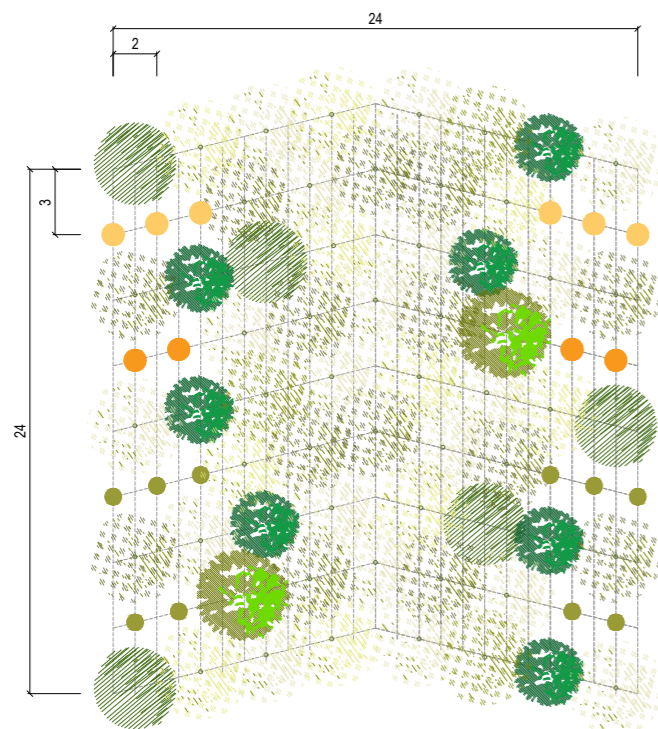

*Fraxinus excelsior*



*Quercus robur*



*Prunus padus*



*Populus alba*



*Populus nigra*



*Salix alba*



*Alnus glutinosa*



*Cornus sanguinea*



*Sambucus nigra*



*Crataegus monogyna*

# Prato arborato

## Quercu - carpineto

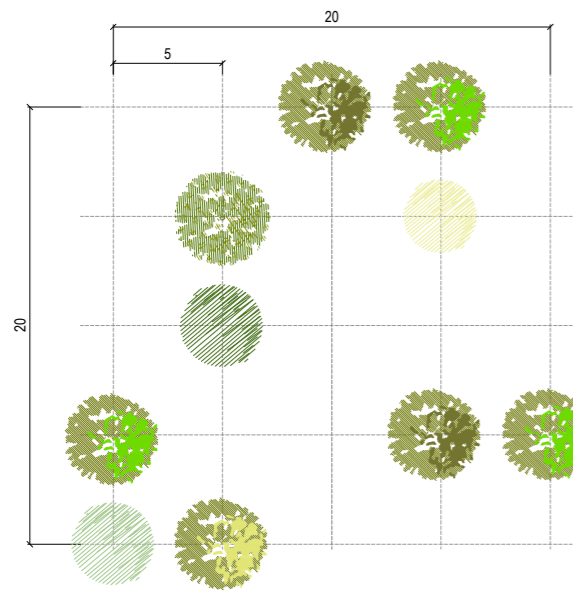

- Quercus robur
- Carpinus betulus
- Fraxinus excelsior
- Prunus avium
- Tilia cordata
- Acer campestre
- Malus sylvatica

## Alneto di Ontano nero

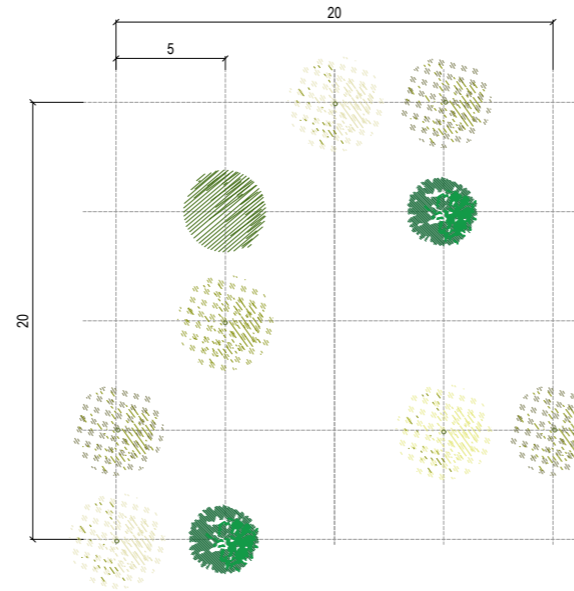

- Fraxinus excelsior
- Alnus glutinosa
- Populus alba
- Salix alba
- Populus nigra
- Prunus padus

CONSOZIAZIONI VEGETALI	AMBITO					
	Naturalistico		Agricolo		Urb.-periurbano	
		%		%		%
Quercu-carpineto	<i>Quercus robur</i>	20	<i>Quercus robur</i>	20	<i>Quercus robur</i>	20
	<i>Fraxinus excelsior</i>	3	<i>Fraxinus excelsior</i>	3	<i>Fraxinus excelsior</i>	3
	<i>Tilia cordata</i>	3	<i>Tilia cordata</i>	3	<i>Tilia cordata</i>	3
	<i>Carpinus betulus</i>	15	<i>Carpinus betulus</i>	15	<i>Carpinus betulus</i>	15
	<i>Prunus avium</i>	4	<i>Prunus avium</i>	4	<i>Prunus avium</i>	4
	<i>Acer campestre</i>	4	<i>Acer campestre</i>	4	<i>Acer campestre</i>	4
	<i>Malus sylvatica</i>	2	<i>Malus sylvatica</i>	2	<i>Malus sylvatica</i>	2
	<b>TOTALE</b>	<b>100</b>		<b>TOTALE</b>	<b>100</b>	<b>TOTALE</b>
Alneto di ontano nero	<i>Alnus glutinosa</i>	30	<i>Alnus glutinosa</i>	30	<i>Alnus glutinosa</i>	30
	<i>Fraxinus excelsior</i>	5	<i>Fraxinus excelsior</i>	5	<i>Fraxinus excelsior</i>	5
	<i>Populus alba</i>	10	<i>Populus alba</i>	10	<i>Populus alba</i>	10
	<i>Populus nigra</i>	3	<i>Populus nigra</i>	3	<i>Populus nigra</i>	3
	<i>Salix alba</i>	8	<i>Salix alba</i>	8	<i>Salix alba</i>	8
	<i>Prunus padus</i>	2	<i>Prunus padus</i>	2	<i>Prunus padus</i>	2
	<b>TOTALE</b>	<b>100</b>		<b>TOTALE</b>	<b>100</b>	<b>TOTALE</b>
SCHEDA TIPOLOGICO	<b>Dimensione:</b> lunghezza 30m, larghezza 5m					
	<b>Quantità e dimensioni d'impianto:</b> 10 alberi (h.175-250cm per alberi forestali; 10-12cm per alberi ornamentali)					
	<b>TOTALE</b>		<b>10</b>			



# Specie igrofile mix erbaceo

Zone umide

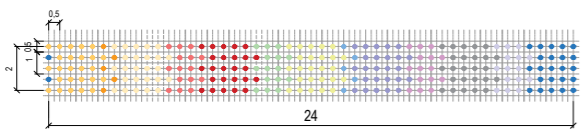

ERBACEE IGROFILE

- *Carex acutiformis*
- *Carex elata*
- *Carex vesicaria*
- *Molina caerulea*
- *Phalaris arundinacea*
- *Iris pseudocorus*
- *Juncus effusus*
- *Carex vesicaria*
- *Lithrum salicaria*
- *Phragmites australis*
- *Sagittaria sagittifolia*
- *Typha angustifolia*
- *Typha latifolia*

Graminacee igrofile		Altre specie igrofile	
Specie	pt/mq	Specie	pt/mq
<i>Carex acutiformis</i>	5	<i>Iris pseudocorus</i>	3
<i>Carex elata</i>	5	<i>Juncus effusus</i>	5
<i>Carex vesicaria</i>	5	<i>Lythrum salicaria</i>	5
<i>Molinia caerulea</i>	3	<i>Phragmites australis</i>	1
<i>Phalaris arundinacea</i>	1	<i>Sagittaria sagittifolia</i>	5
		<i>Typha angustifolia</i>	3
		<i>Typha latifolia</i>	3
<b>SCHEDA TIPOLOGICO</b>	<b>Dimensione:</b>	-	
	<b>Quantità e dimensioni d'impianto:</b>	vaso 15cm (graminacee igrofile) vaso 9-12cm (altre specie igrofile)	
	<b>TOTALE</b>	-	

# Rampicanti

Querco - carpineto

Alneto di Ontano nero

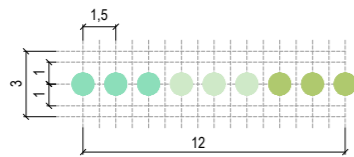

- Hedera helix
- Parthenocissus quinquefolia
- Parthenocissus trifoliatus

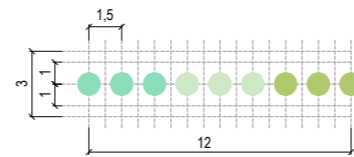

- Hedera helix
- Parthenocissus quinquefolia
- Parthenocissus trifoliatus

<i>Hedera helix</i>	
<i>Parthenocissus quinquefolia</i>	
<i>Parthenocissus trifoliatus</i>	
<b>SCHEDA TIPOLOGICO</b>	<b>Dimensione:</b> 12m
	<b>Quantità e dimensioni d'impianto:</b> 8 rampicanti (vaso 12cm)
<b>TOTALE</b>	<b>8</b>



*Hedera elix*

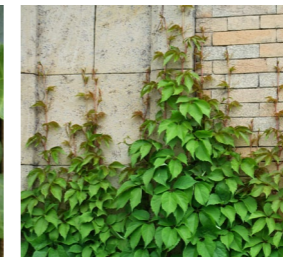

*Parthenocissus quinquefolia*