

Planimetria - Scala 1:50

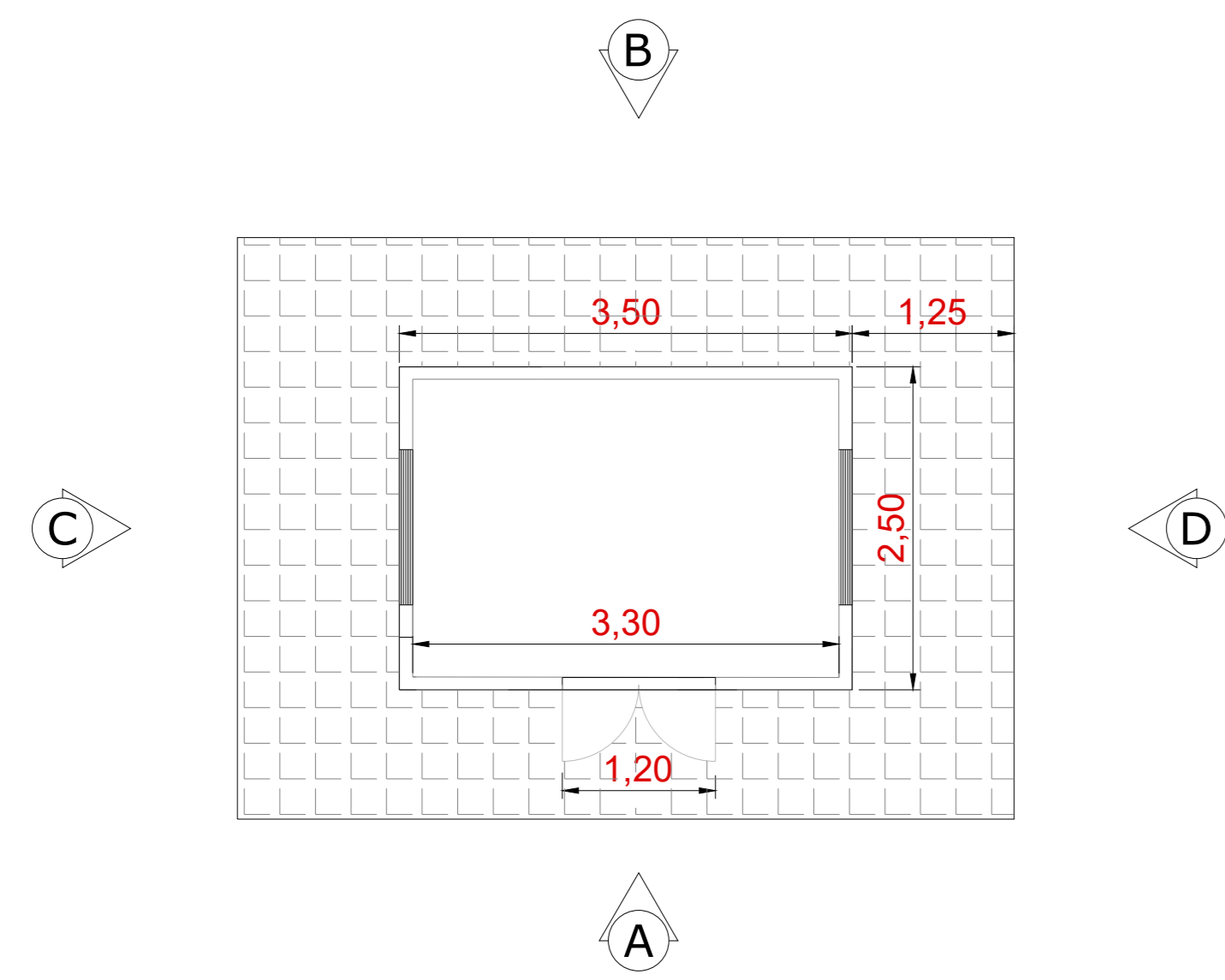

Sezione - Scala 1:50

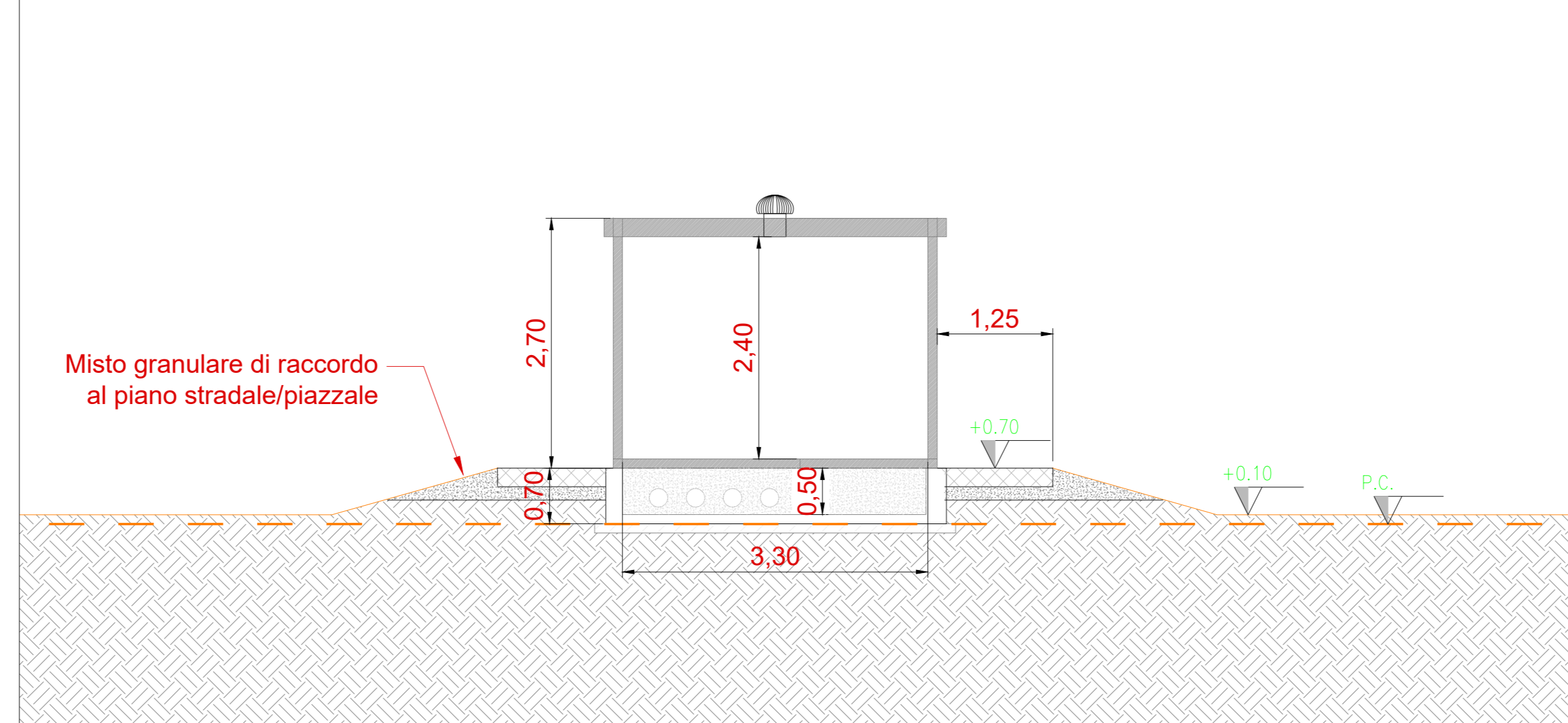

Vista A - Scala 1:50

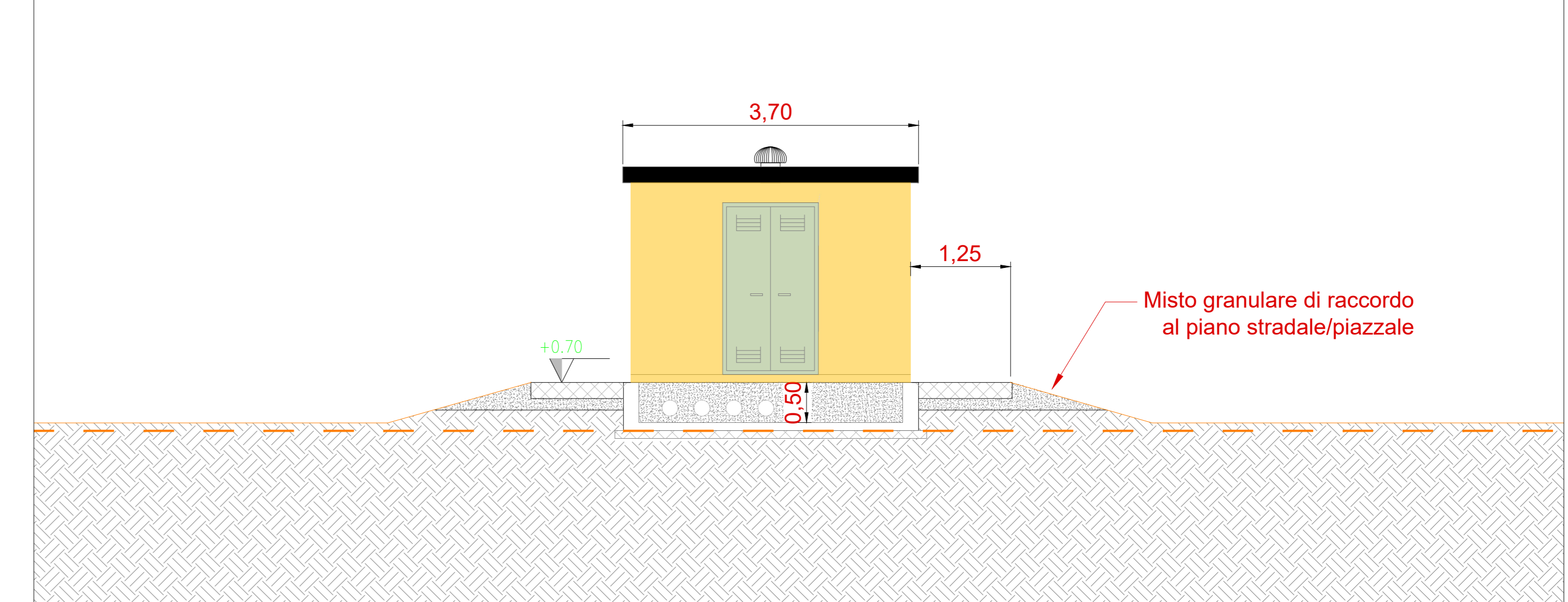

Pianta fondazioni - Scala 1:50

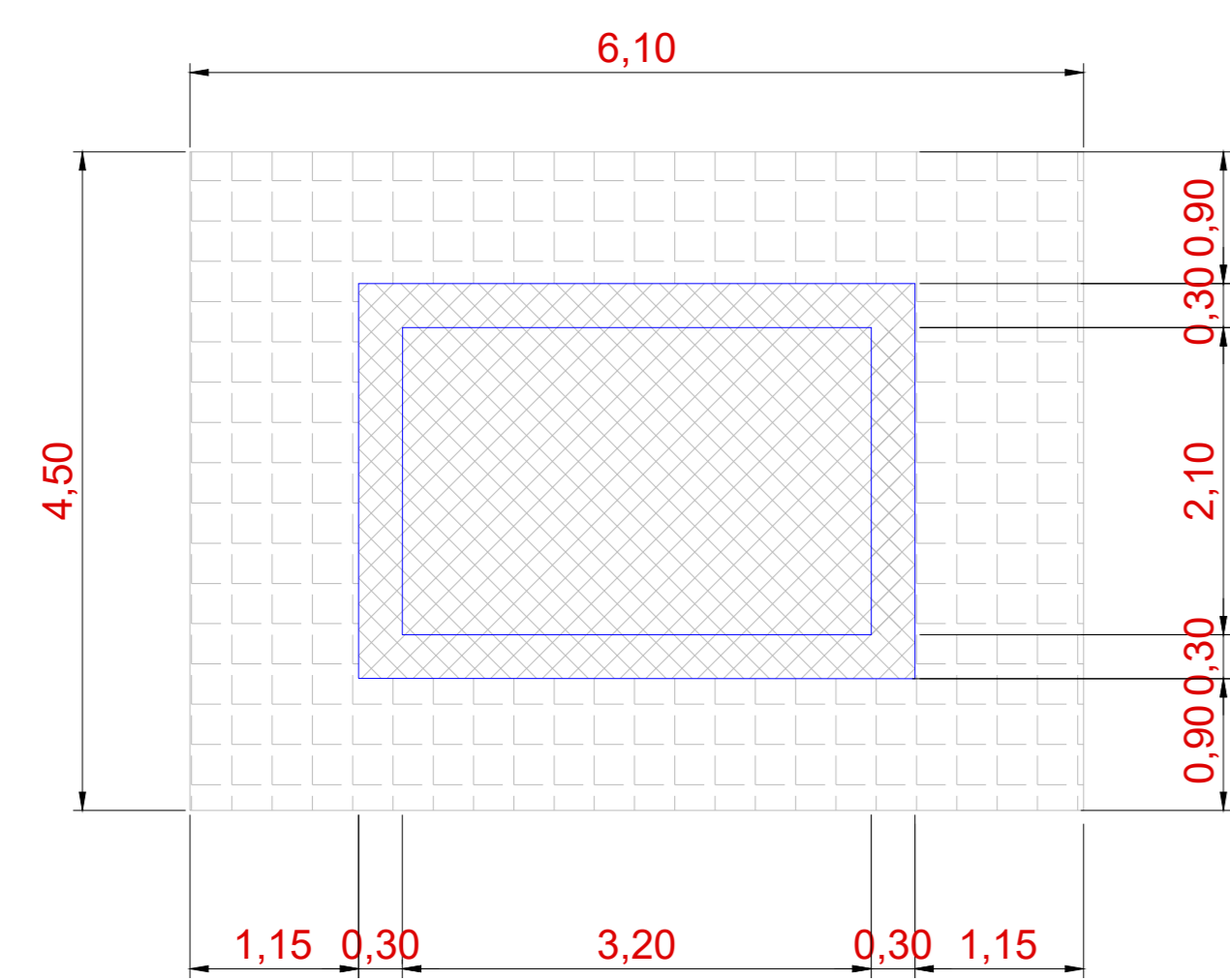

Vista B - Scala 1:50

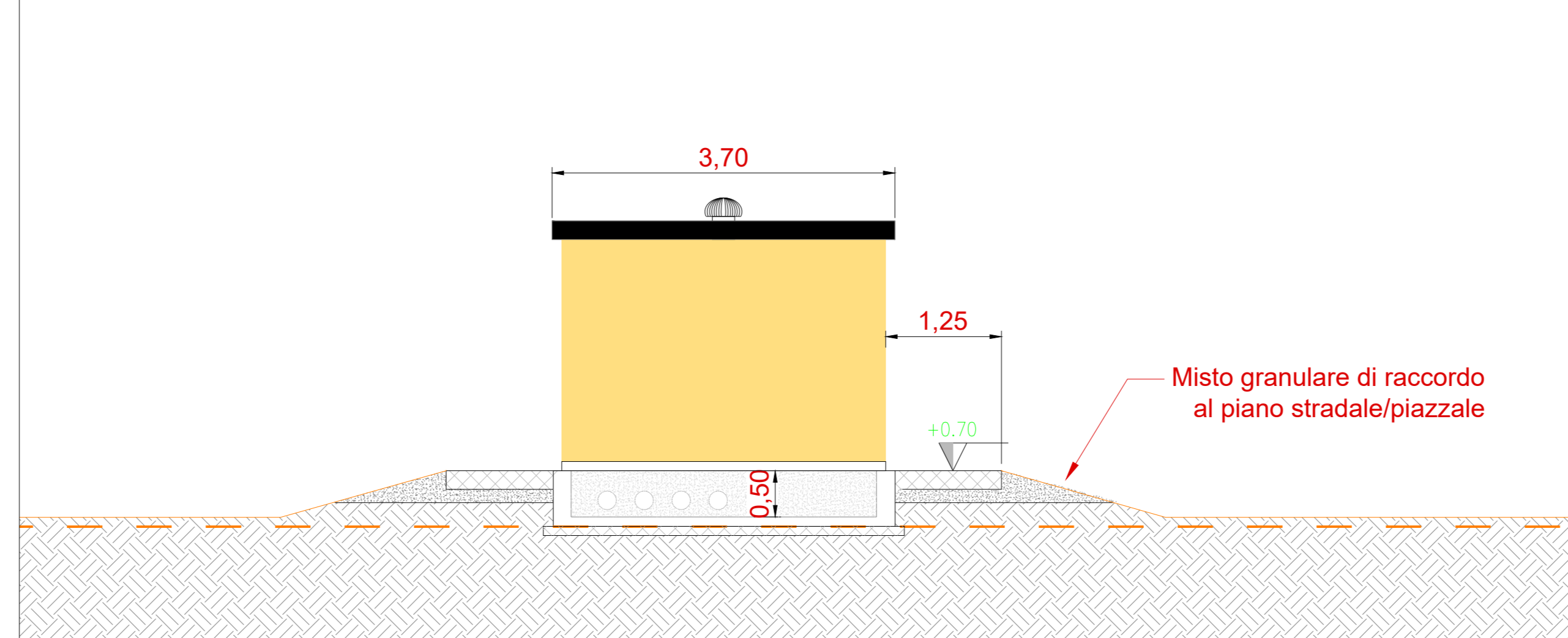

Vista C - Scala 1:50

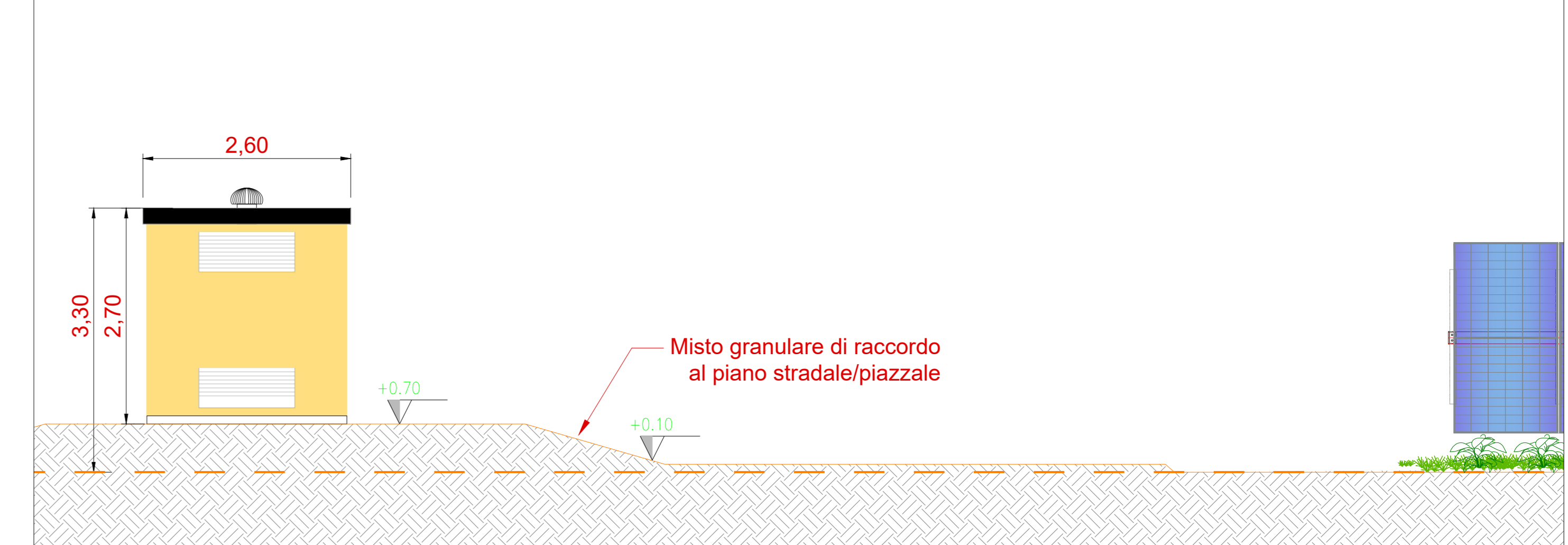

Vista dall'alto - Scala 1:50

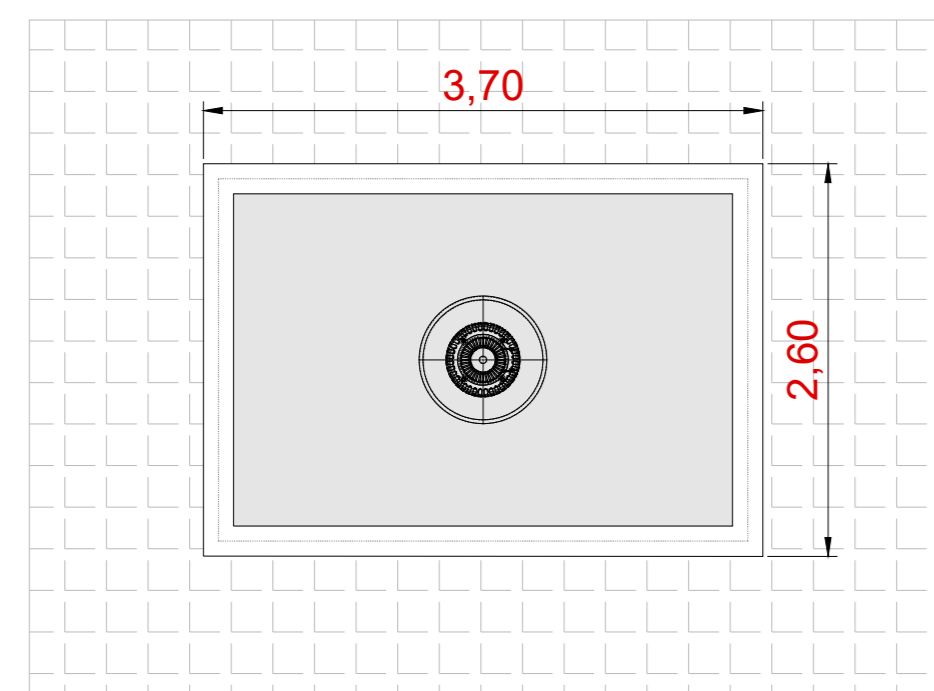

Vista D - Scala 1:50

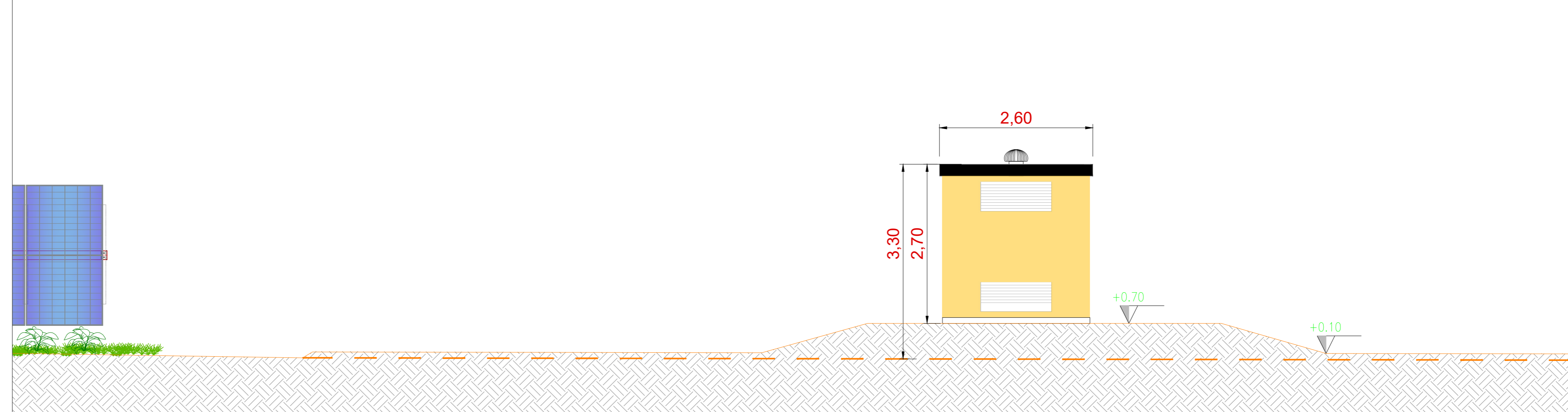

Inquadramento generale - Aree di manovra cabina ausiliaria - Scala 1:200

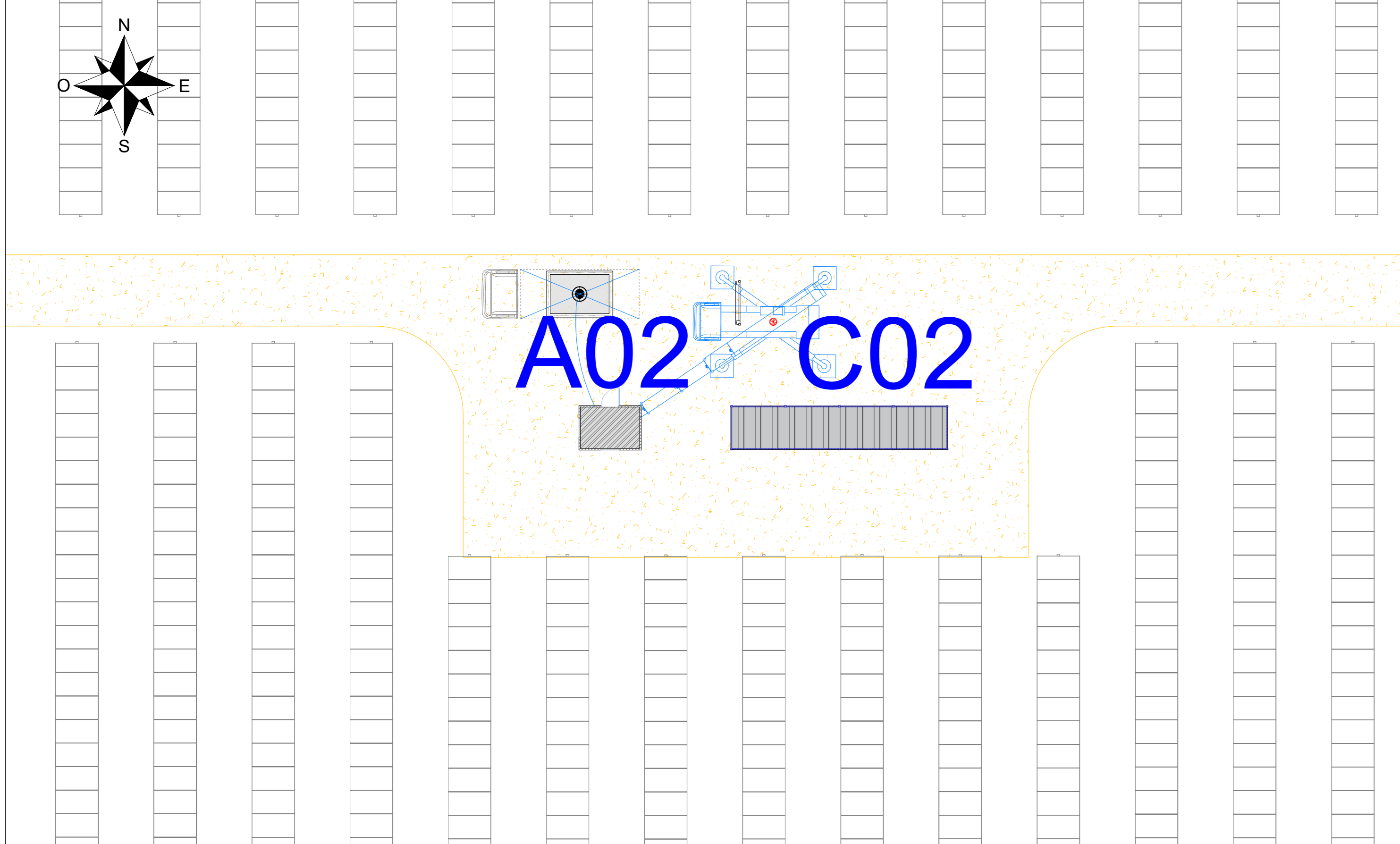

Tipico 3D cabina ausiliaria

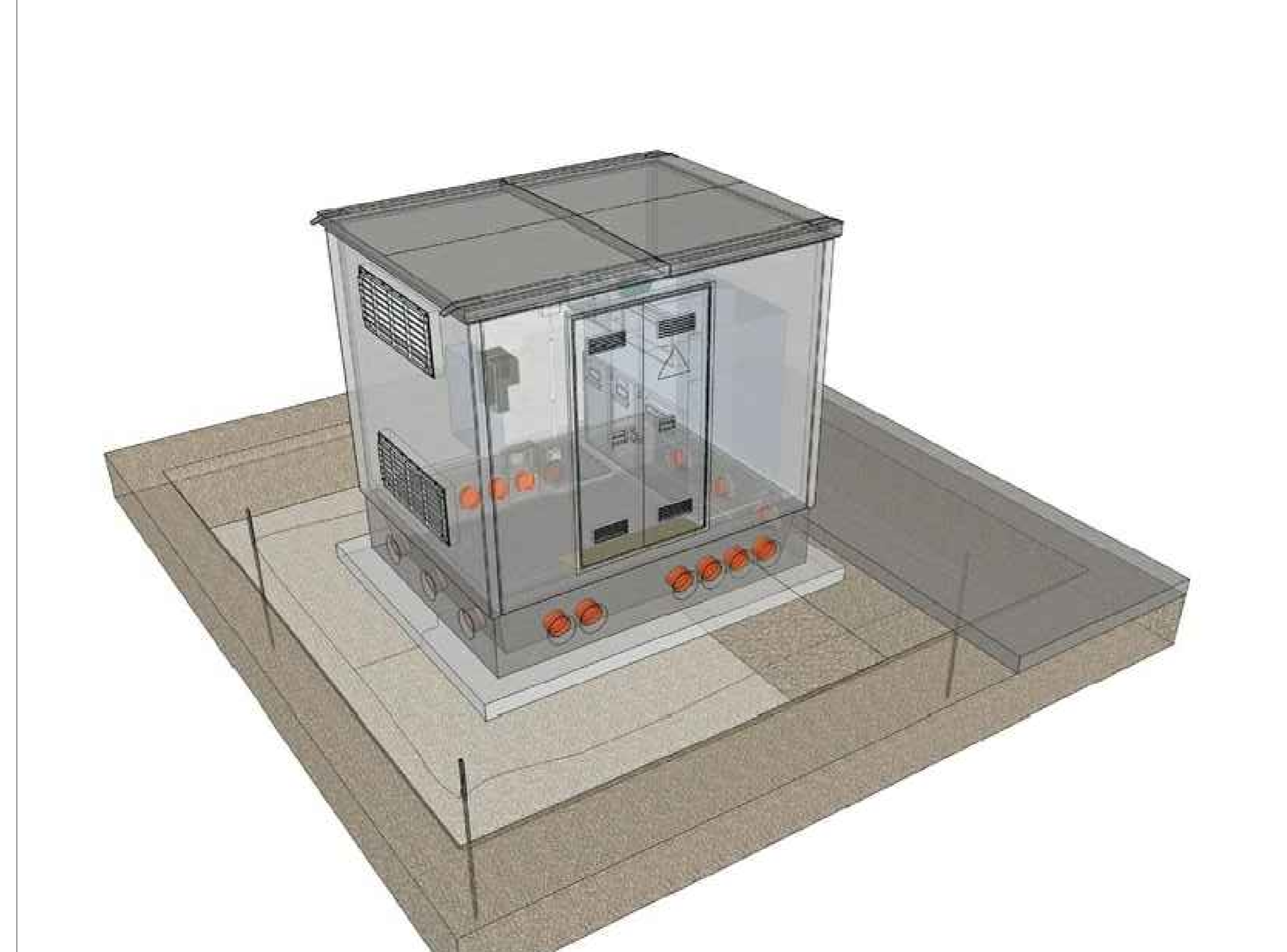

		REGIONE SICILIA COMUNE DI MONREALE (PA)			
PROGETTO IMPIANTO AGRIVOLTAICO DI POTENZA PARI A 27216 kWp (20905 kW _e IN IMMISSIONE) DENOMINATO "PRINCIPE X" ED OPERE CONNESSE INDISPENSABILI DA REALIZZARSI NEL COMUNE DI MONREALE (PA)					
TITOLO Tav.15 - Tipico cabina servizi ausiliari					
PROGETTISTI SCM Ingegneria S.r.l. Via S. Maria del Chio. 25 Tel. +39 081 238855 71023 Palermi (PA) Mail: info@scmengineering.com	PROPONENTE PRINCIPE SOLAR X S.R.L. Sede legale e Amministrativa: Viale Cirio Ruffo, 25 90144 PALERMO (PA) PEC: principesolarx@pec.it	VISTI OM Ingegneria e Ambiente S.r.l. Viale Cirio Ruffo, 25 Tel. +39 081 978353 90144 Palermo (PA) Mail: info@omengineering.it			
PROGETTAZIONE 					
Scala	Forma	Cod. Elaborato	Rev.	Nome File	Figura
Varie	A0	FVPRXD-I_Tav.15	00	Tipico cabina servizi ausiliari	1 di 1
Rev.	Data	Descrizione	Elaborato	Controllato	Approvato
00	08/23	Prima Emissione	R. Cavallò	D. Cavallò	L. Restano